



Bond Referendum

Projects Update:

Woodbury Middle School

Oltman Middle School

Lake Middle School

Cottage Grove Middle School

MAY 9, 2024



The background of the image is white and decorated with numerous circles in three colors: dark blue, teal, and beige. Some circles are solid, while others are overlapping, creating a pattern of different shades and sizes. The text "Woodbury Middle School" is centered in the middle of the image.

Woodbury Middle School

Woodbury Middle School

PROJECT SCOPE

- Relocation of main office for security
- Renovation of pool into educational space
- Renovation of existing music
- Creation of bus road



Woodbury Middle School

ADVISORY COMMITTEE MEETINGS

- Meeting #1: February 7, 2024
- Meeting #2: February 14, 2024
- Meeting #3: March 14, 2024
- User Group Input: April 3 (Round 1), April 18 (Round 2)

Guiding Principles & Design Criteria

Some Key Points

- Consistent with District Safety and Security Standards.
- Create a 3rd Music Room
- Additional Multi-Purpose Space for Physical Education

GUIDING PRINCIPLES:

- The design of the main entry should be consistent with the District's safety and security standards.

DESIGN CRITERIA:

- The main office reception should be adjacent to the main entrance, creating a secure entry sequence.
- This reception area should accommodate 3 workstations
- There should be a (10-12) person conference room adjacent to the main entrance reception.
- (1) Principal's office, (2) Assistant Principal, and (1) Dean's offices should be co-located with the main entry reception, but behind a secure line.
- There should be a second entry into the admin suite from the corridor to allow for student access without going through the main reception space.
- The Nurse's area should be adjacent to the main reception space but also allow for direct access for students from the corridor.
- There shall be a cot area with 4-5 cots that can be supervised by the Health Assistant.
- There should be a reception space where the Health Assistant is housed.

Woodbury Middle School – Overall Floor Plan

- Creation of secure entry:
Moving main office
- Music suite renovations /
creation of 3rd music
room
- Conversion to
multipurpose space



Woodbury Middle School – Main Office / Secure Entry Bubble Diagram & Layout

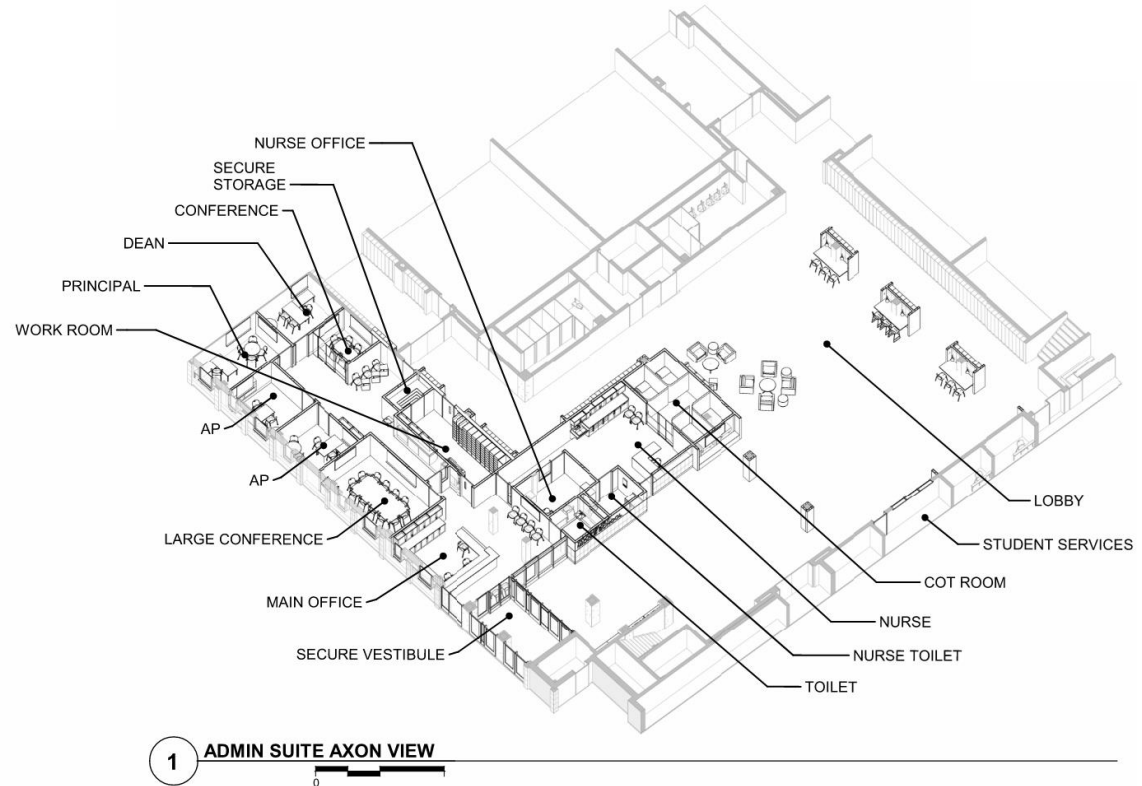
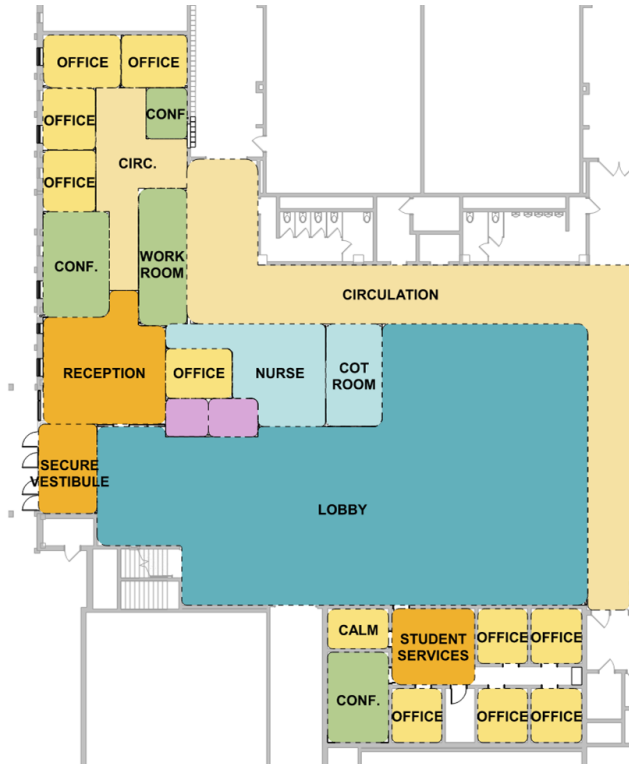

Woodbury Middle School – Music Suite Bubble Diagram

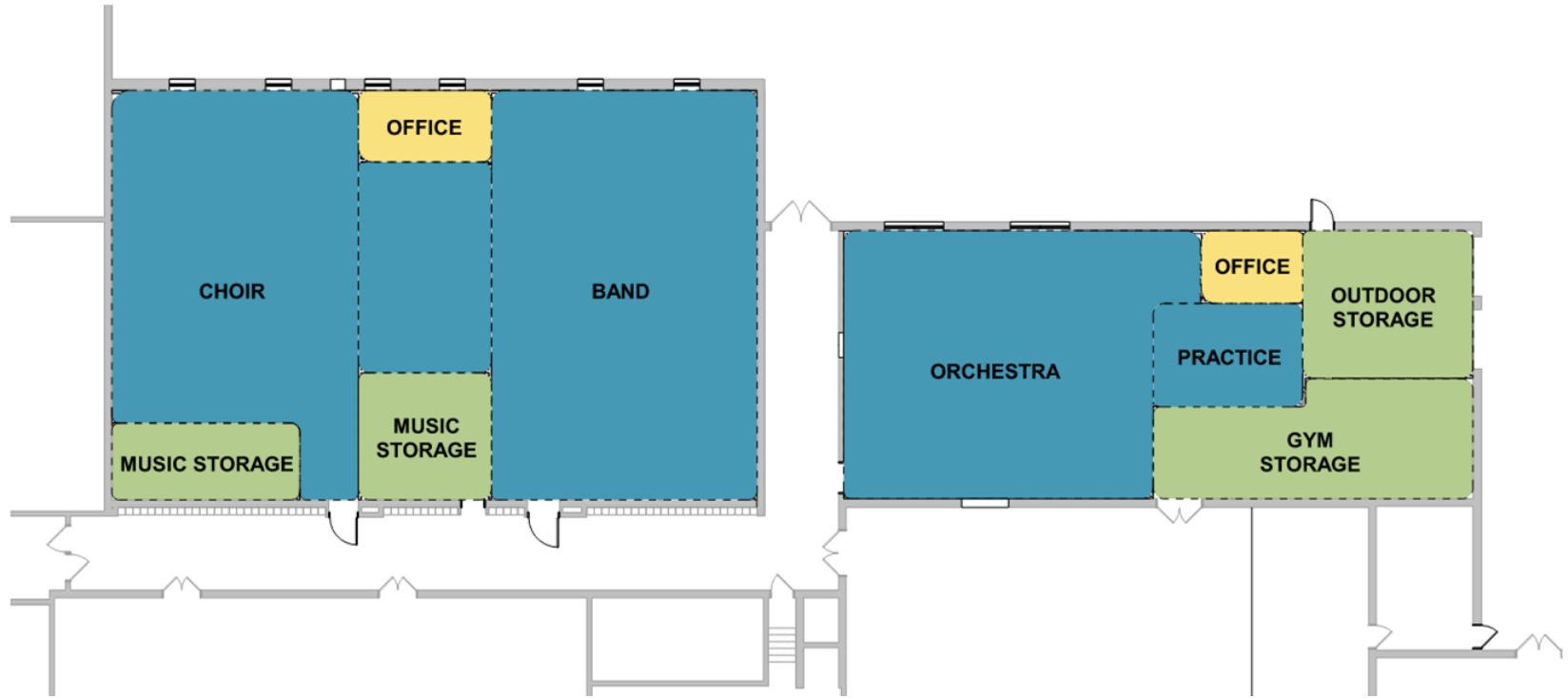

Woodbury Middle School – Music Suite Layouts

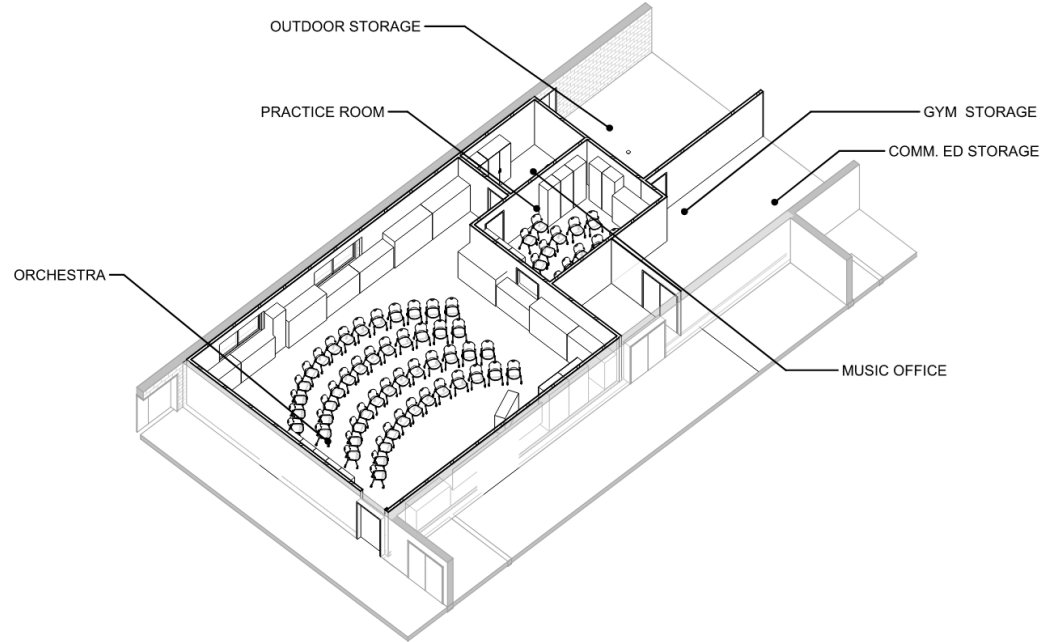
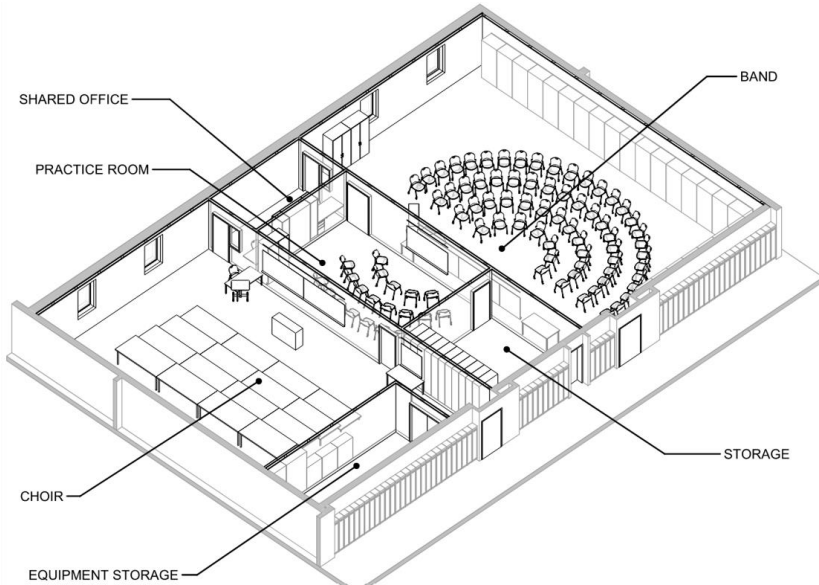

Woodbury Middle School – Multipurpose Bubble Diagram & Layout

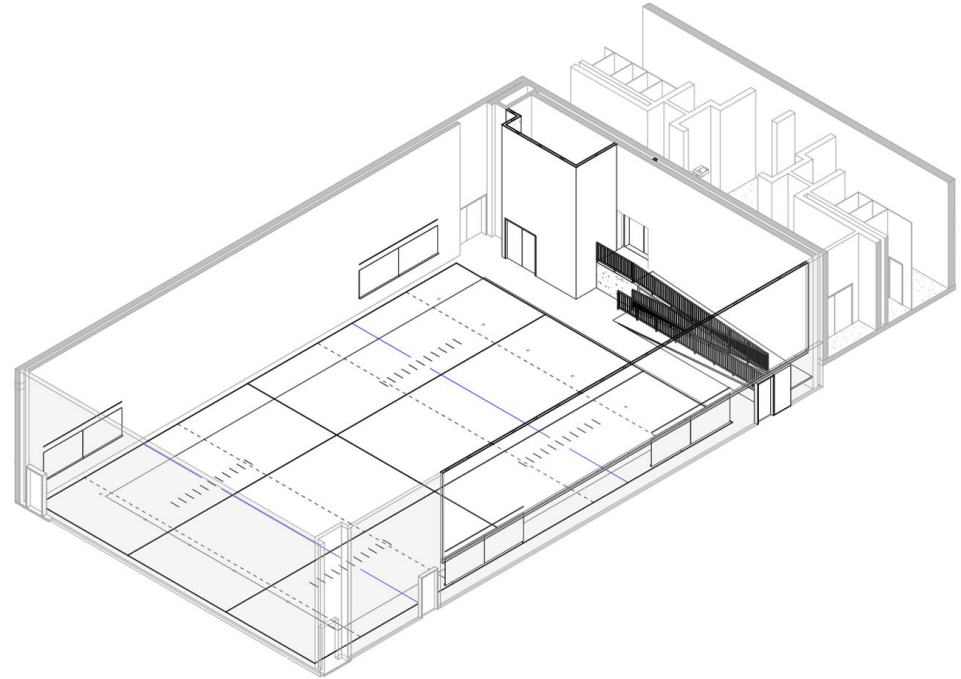
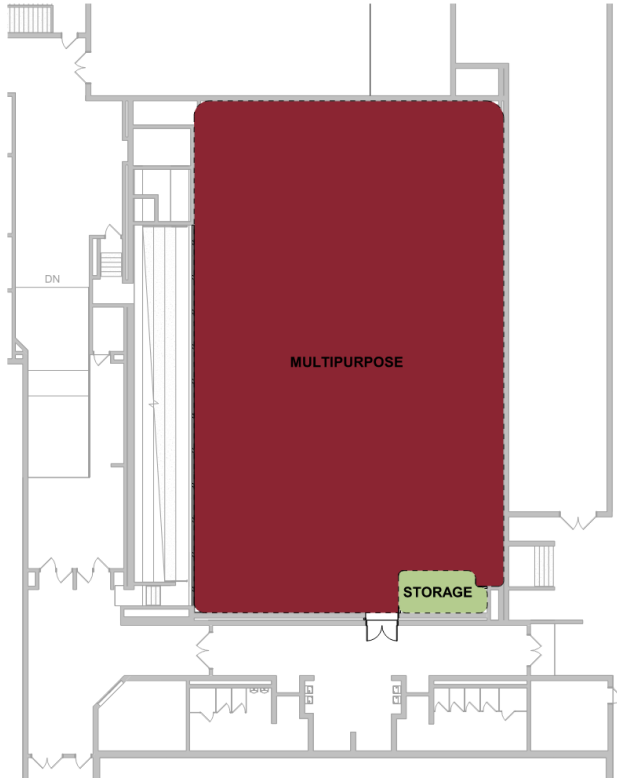

Woodbury Middle School – Site Plan Bubble Diagram

- NEW ASPHALT DRIVE
- PLAY FIELD GRASS
- PLAY FIELD DIRT

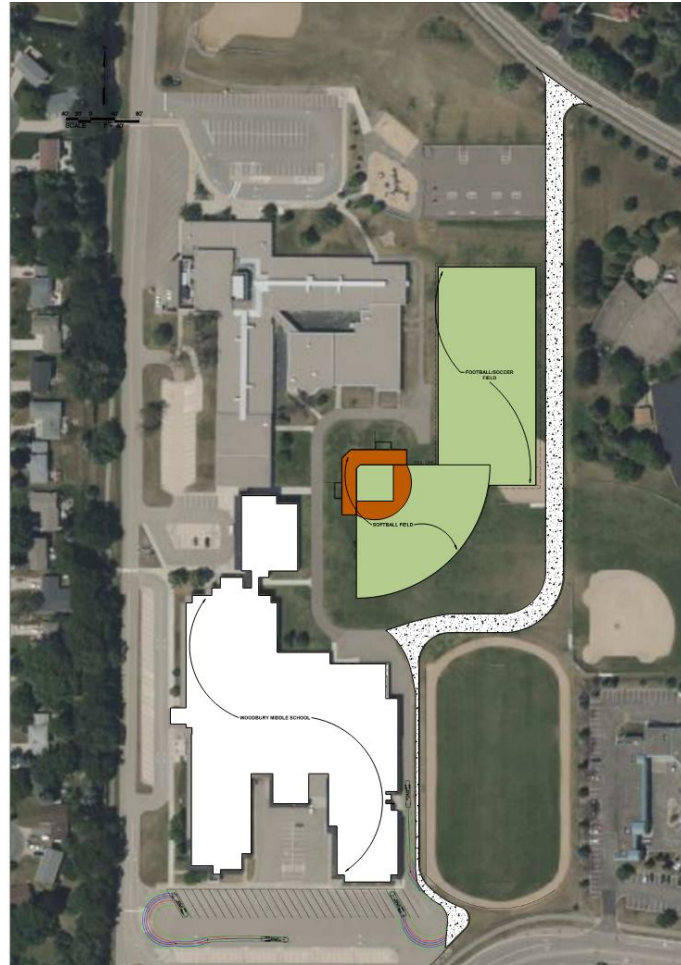

Woodbury Middle School

SCHEDULE

Design: January 2024 – September 2024

Bidding: Fall 2024

Construction: Fall 2025 – Summer 2026

Final phasing under review



The background of the image is white and decorated with numerous circles of varying sizes and colors. The colors are primarily a vibrant green and a light tan or beige. Some circles are solid, while others are overlapping, creating a layered effect. The circles are scattered across the entire page, framing the central text.

Oltman Middle School

Oltman Middle School

PROJECT SCOPE

- Addition to create capacity for ~400 students (990 currently)
- Spaces Included: 2 STEM Classrooms; 1 Multi-purpose Classroom; 3 Science Classrooms; 9 General Classrooms; 2 Medium Group Rooms; Flex / Pod
- Expansion of cafeteria/kitchen
- Needs to comply with tornado shelter requirements



Oltman Middle School

ADVISORY COMMITTEE MEETINGS

- Meeting #1: January 17, 2024
 - Meeting #2: February 6, 2024
 - Meeting #3: February 14, 2024
 - Meeting #4: February 28, 2024
 - Meeting #5: March 20, 2024
 - User Group Input: April 10 (Round 1), April 24 (Round 2)
- 

Guiding Principles & Design Criteria

SOME KEY POINTS

- Additions should look and feel like they match the rest of the building.
- Pod layout will vary from existing with updated learning opportunities.
- Find additional opportunities for flexible learning
 - Pod areas
 - New science & STEM area

Design Criteria:

- Rooms with a similar size.
- Teacher station included in each of this location.
- Classrooms with lockers should have access to the building.
- Connect to existing building.
- Multipurpose space for 65+ students.
- The pod material break provide a break for students.

Guiding Principles:

- The new addition should be organized into a house/pod layout around a shared flexible area, with additional support amenities to encourage collaboration.
- Wayfinding and room numbering should build on the existing system, and be simple and easy to understand.
- The design will be intentional about traffic flow and circulation within the building, and sensitive to any current 'pinch points'.
- Access to natural daylight / maintaining glass into pod areas is a priority.
- Designated spaces should be provided to support specialized learning, ie: STEM.
- Special education resource support spaces should be distributed in the new addition, in a similar way to the current pods.
- Furniture should be flexible and mobile, easy to clean and durable.
- Cafeteria design should be sensitive to flexible uses and providing options for dining for various students sensory needs.
- The cafeteria design should be sensitive to flexible uses and providing options for dining for various students sensory needs.

Oltman Middle School – Overall Floor Plan

- Cafeteria / Kitchen / Served Expansion
- 2 story classroom addition including: 2 STEM Classrooms; 1 Multi-purpose Classroom; 3 Science Classrooms; 9 General Classrooms; 2 Medium Group Rooms; Flex / Pod

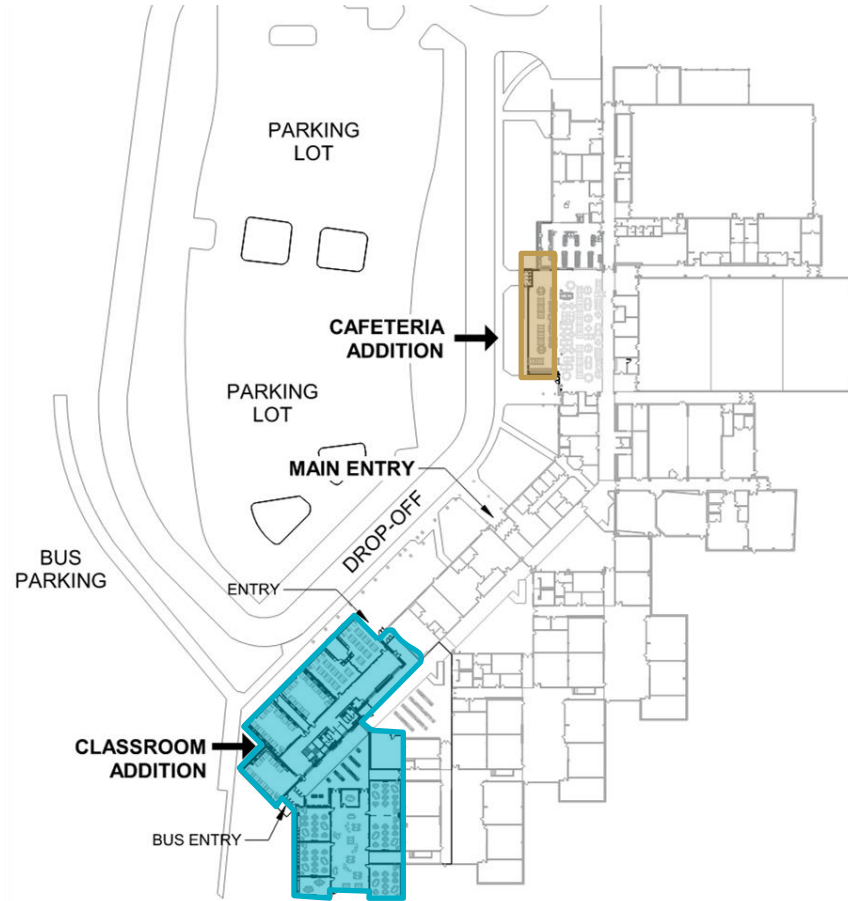

Oltman Middle School – Classroom Addition Layouts



Oltman Middle School – Classroom Pod Axon Layout

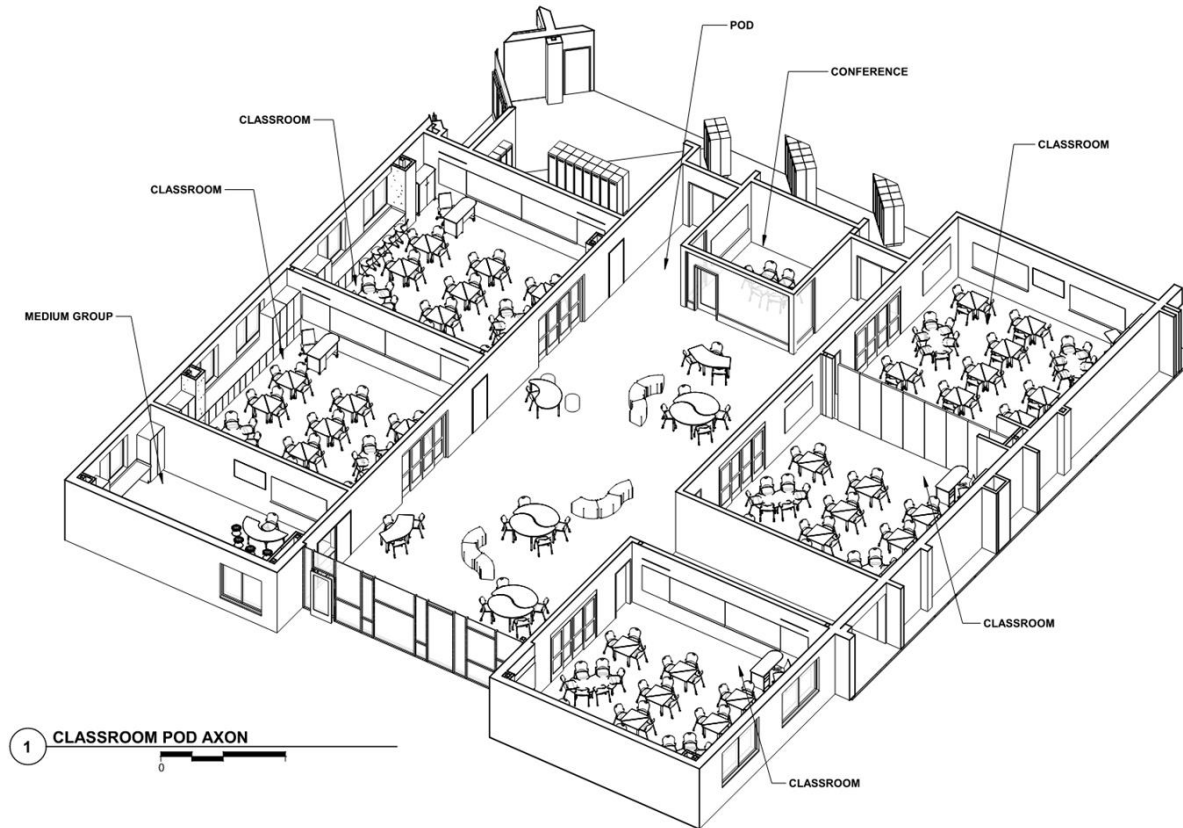

Oltman Middle School – Classroom Addition Rendering



Oltman Middle School – Cafeteria/Kitchen/Servery Addition Rendering & Layout

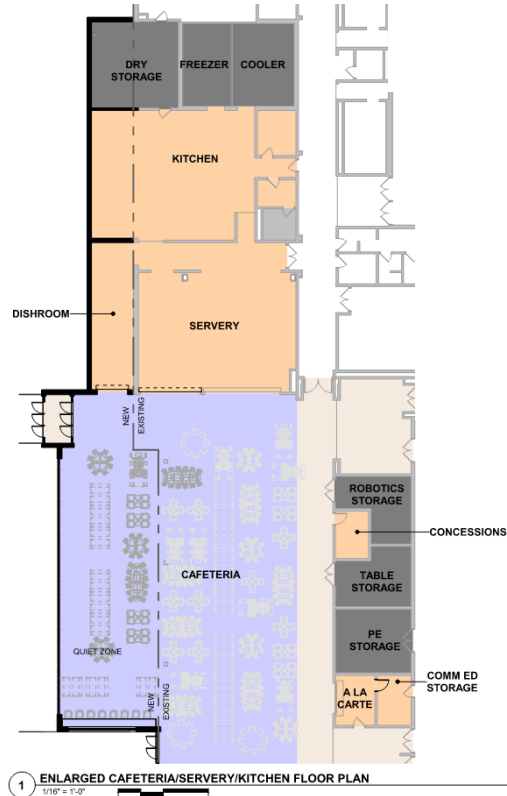

Oltman Middle School

SCHEDULE

Design: January 2024 – September 2024

Bidding: Fall 2024

Construction: Spring 2025 – Summer 2026

Final phasing under review



The background of the slide is white and decorated with numerous circles in three colors: dark green, medium green, and tan. These circles are scattered across the page, with some appearing as single circles and others as overlapping pairs. The text is centered in the middle of the slide.

Cottage Grove and Lake Middle Schools

Project Scope

- Construct secure front entrance and office for security at Cottage Grove and Lake middle schools
- Remodel portions of existing front office area



Guiding Principles & Design Criteria



GUIDING PRINCIPLES:

- The design of the main entry should be consistent with the District's safety and security standards.

DESIGN CRITERIA:

- The main office reception area should be adjacent to the main entrance, creating a secure entry sequence.
- There should be a (10-12) person conference room adjacent to the main entrance reception.
- Administrative offices and Health office area should be co-located with the main entry reception, but behind a secure line.
- There should be a second entry into the admin suite from the corridor to allow for student access without going through the main reception space.

Leadership and User Group Meetings

Cottage Grove Middle School

- Meeting #1: April 12, 2024
- Meeting #2: April 22, 2024
- Meeting #3: May 1, 2024
- Meeting #4: May 15, 2024

Lake Middle School

- Meeting #1: April 4, 2024
- Meeting #2: April 17, 2024
- Meeting #3: May 1, 2024
- Meeting #4: May 15, 2024



Site Plan: Addition of new secure office suite at existing visitor entrance



Cottage Grove Middle School



Lake Middle School

Schedule

Design: April 2024 – February 2025

Bidding: Spring 2025

Construction: January 2026 – Summer 2026

Final phasing under review

Next Steps

- **May 9:** Architects will present drafts of Middle School design concepts to School Board
- **July 18:** Architects will present drafts of High School design concepts to School Board
- **January 2025,** design and planning work will begin for our elementary school construction projects at Bailey, Crestview, Grey Cloud, Hillside, Pine Hill, Pullman, Red Rock and Royal Oaks elementary schools.

Updates and important information will be shared at
SoWashCo.org/construction

Questions?