

SUBMITTAL

Job Name: Piedmont HS 30s Building



Tag: SF-1
Customer: DMG North CV
Job ID: PHS30s
Date: April 11, 2024

DSI - Square Inline Centrifugal Fan, Direct Drive

Construction Features

- Heavy-gauge galvanized steel housing.
- Backward inclined, non-overloading, aluminum wheel statically and dynamically balanced.
- Removable side panels provide access to power assembly without removal of duct connections.
- Galvanized steel mounting brackets for easy mounting in horizontal or vertical position.
- Disconnect switch is mounted to the side panel of unit.

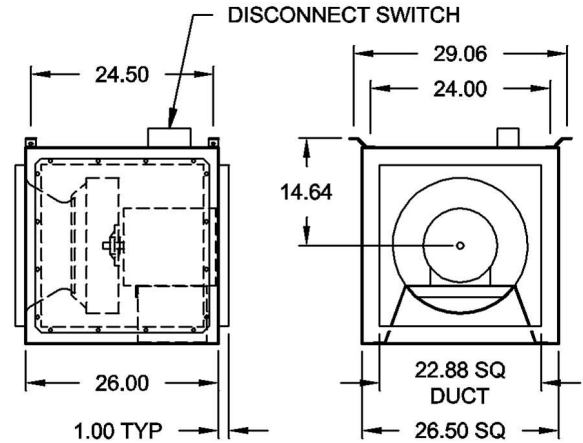

DAMPER SIZE 23.00 X 23.00

D4210D DSI 165

Description	Qty	Model	Size	Wt (lb.)
	1	DSI	165A	354

Approximate weight each, includes fan, motor and accessories.

Performance	CFM	SP (in WC)	RPM	Oper. BHP
	2,095	1.000	1,064	0.61

Temperature: 70 °F Altitude: 0 ft

Regulation Metrics	FEI	FEP (KW)	System FEI	System FEP (KW)	CA T20 Compliant/Exempt
	1.40	0.57	1.40	0.57	Yes

Fan Energy Index (FEI) is an overall efficiency (wire-to-air) metric which includes not only the impact of the fan efficiency, but also each of the drive components used to operate the fan.

Fan Electrical Input Power (FEP) is the amount of power of a given fan at an operating point characterized by a value of flow and pressure.

Motor Data	HP	RPM	Volt/Ph/Hz	Encl	Technology
	3/4	1,160	460V/3/60	ODP	Induction

Efficiency: Standard

Sound Data	Octave Bands	1	2	3	4	5	6	7	8	LwA	dBA	Sones
	Level at Inlet	70	71	76	73	69	67	61	54	75	61	11.5

LwA: The overall (single value) fan sound power level in dB re. 10^{-12} Watts, 'A' weighted.

dBA: Estimated sound pressure level (re:0.0002 microbar) based on a single ducted installation at 5 ft., using a directivity factor of 1.



Accessories Included

Backdraft Damper, ALUM
Vibration Isolators - Hanging, Spring with Hanger Brackets
Filter Box - 2" Thick Disposable Paper
Disc Switch-Unfused (NEMA 1), Shipped Loose

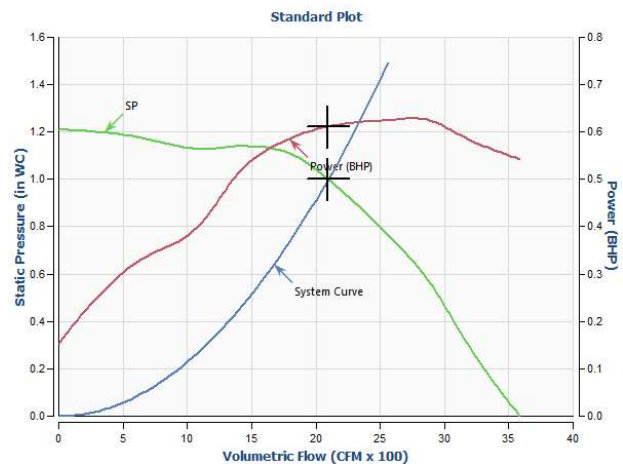

SUBMITTAL

Job Name: Piedmont HS 30s Building



Tag: SF-1

Customer: DMG North CV

Job ID: PHS30s

Date: April 11, 2024

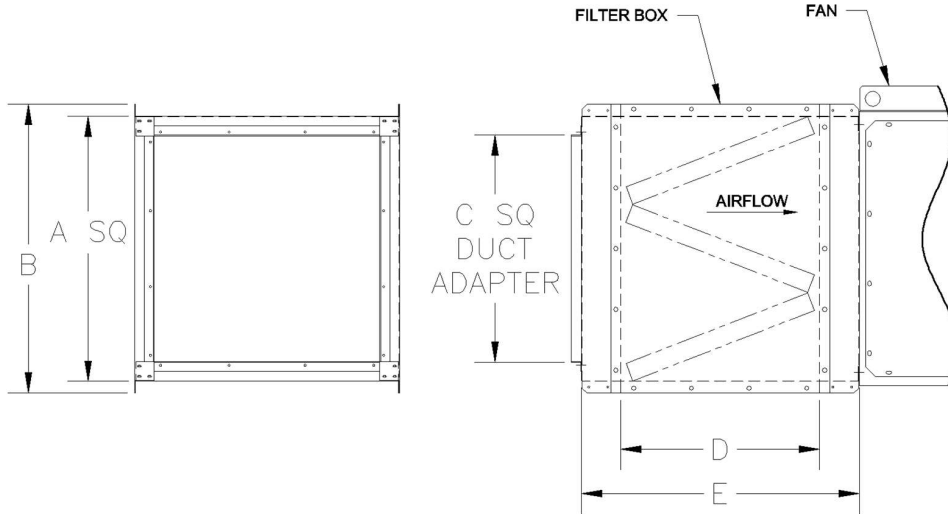

SIZE	A	B	C	D	E	FILTER SIZE	FILTER QTY
080/090	16.00	18.50	11.88	21.44	28.38	25 X 16	1
100	18.06	20.56	13.88	19.88	26.75	25 X 16	1
120/120HP	19.62	22.12	15.88	24.50	31.38	25 X 16	2
135/135HP	21.75	24.25	17.88	24.00	32.00	25 X 20	2
150/150HP	23.94	26.44	19.88	23.75	32.00	25 X 20	2
165/165HP	26.62	29.12	22.88	19.56	28.00	25 X 20	3
180/180HP	29.12	31.62	23.88	19.25	26.50	25 X 20	3
210/210HP	32.44	34.94	27.88	21.00	31.00	25 X 16	4
225/225HP	34.25	36.75	29.88	24.00	33.00	25 X 16	6
245/245HP	37.75	40.25	32.88	18.88	30.00	25 X 20	2
						25 X 16	2
270/270HP	40.25	42.75	35.88	23.00	33.00	25 X 20	6
300/300HP	44.25	46.75	39.88	24.00	33.00	25 X 20	8
330/330HP	48.94	51.44	43.88	23.50	34.00	25 X 16	12
365/365HP	50.25	52.75	45.88	19.75	30.50	25 X 20	12
402/402HP	55.50	58.00	51.88	24.75	36.00	25 X 20	12
						25 X 16	6

D4205-1 037-4104

SUBMITTAL

Job Name: Piedmont HS 30s Building



Tag: SF-1
Customer: DMG North CV
Job ID: PHS30s
Date: April 11, 2024

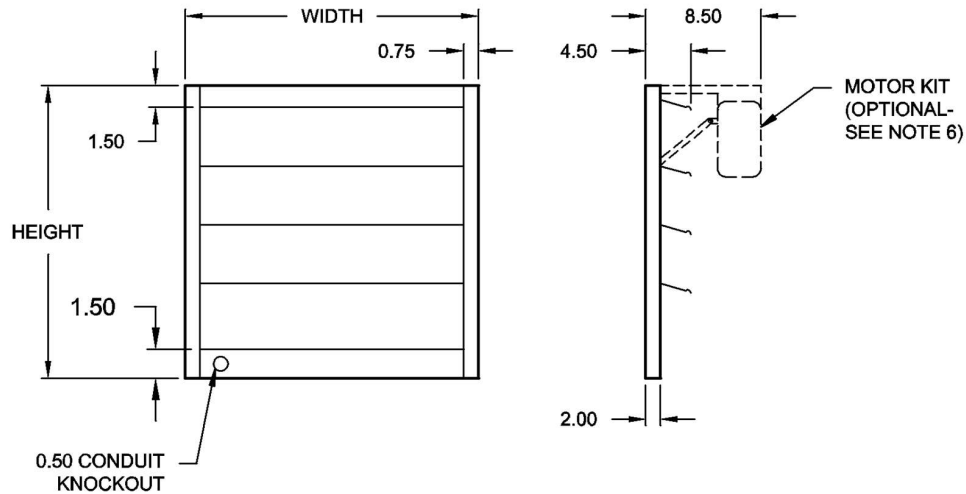

REAR EXHAUST

SIZE	HEIGHT	WIDTH
080/090	12.00	12.00
100	14.00	14.00
120	16.00	16.00
135	18.00	18.00
150	20.00	20.00
165	23.00	23.00

SIDE DISCHARGE

SIZE	HEIGHT	WIDTH
080/090		
100		
120		
135		
150		
165		

SAME AS REAR EXHAUST

NOTES:

1. FRAME: 19 GA. GALVANIZED STEEL.
2. BLADES: 26 GA. MILL FINISH ALUM.
3. FELT SEAL ON LEADING EDGE OF BLADES.
4. TIE ROD ATTACHED TO ALL BLADES.
5. DAMPERS INDIVIDUALLY PACKAGED.
6. FOR MOTORIZED APPLICATIONS (OPT.) MOTOR KITS ARE RATED AT 115/230V, 460V OR 24V. FOR 575V APPLICATIONS, A TRANSFORMER IS REQUIRED WITH A 115V MOTOR PACK.

DMP-G000 DSI 008-4101

SUBMITTAL

Job Name: Piedmont HS 30s Building



Tag: N/A
Customer: DMG North CV
Job ID: PHS30s
Date: April 11, 2024

GRV - Gravity Relief/Intake Ventilator

Construction Features

- Spun aluminum cover.
- Curb base constructed of aluminum 1/2" x 1/2" galvanized mesh bird screen.

Description	Qty	Model	Size	Wt (lb.)
	1	GRV	160B	61

Approximate weight each, includes fan, motor and accessories.

Performance	CFM	Flow	SP (in WC)
	2,095	Intake	0.241

Temperature: 70 °F

Altitude: 0 ft

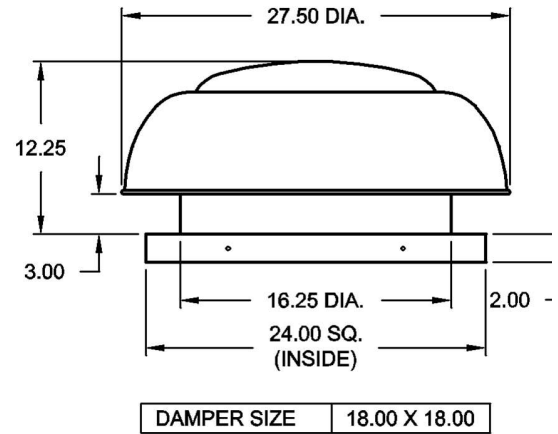

D4700 GRV

Accessories Included

Birdscreen - Galvanized
Backdraft Damper, ALUM
Roof Curb, Canted, Galv. w/ Insulation
12" H
Curb Hinge
Retaining Chain

SUBMITTAL

Job Name: Piedmont HS 30s Building



Tag: N/A
Customer: DMG North CV
Job ID: PHS30s
Date: April 11, 2024

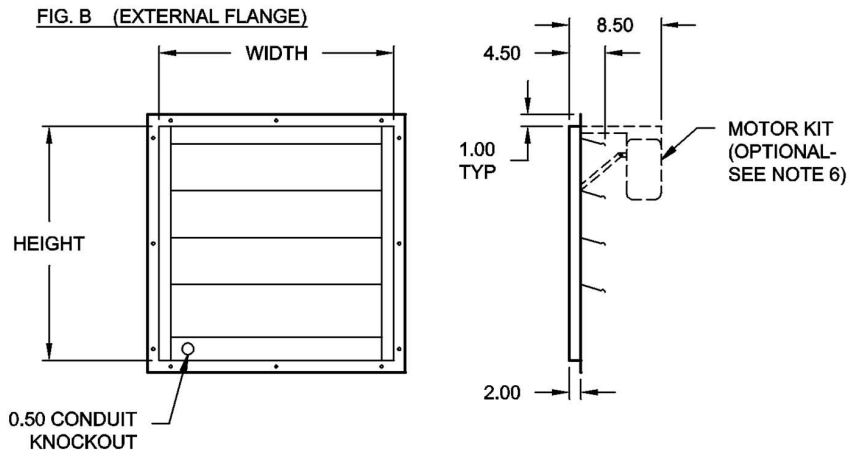
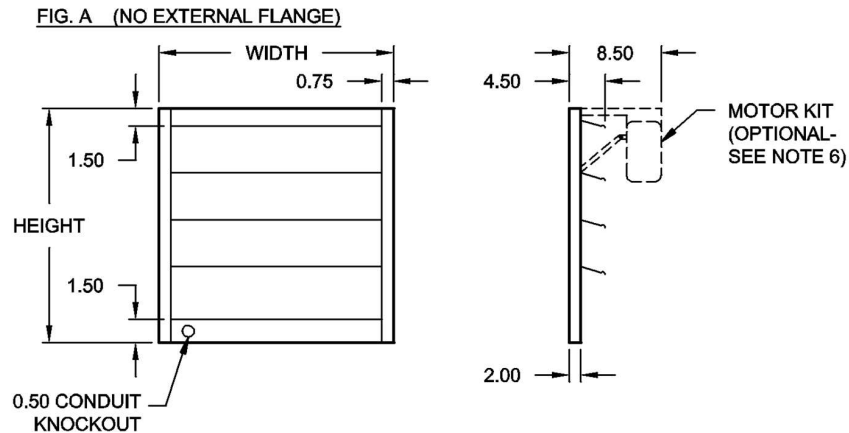

NOTES:

1. FRAME: 19 GA. GALVANIZED STEEL.
2. BLADES: 26 GA. MILL FINISH ALUM.
3. FELT SEAL ON LEADING EDGE OF BLADES.
4. TIE ROD ATTACHED TO ALL BLADES.
5. DAMPERS INDIVIDUALLY PACKAGED.
6. FOR MOTORIZED APPLICATIONS (OPT.) MOTOR KITS ARE RATED AT 115/230V, 480V OR 24V. FOR 575V APPLICATIONS, A TRANSFORMER IS REQUIRED WITH A 115V MOTOR PACK.

SIZE	FIG.	HEIGHT	WIDTH
090	A	10.00	10.00
120	A	18.00	18.00
160	A	18.00	18.00
180	A	24.00	24.00
210	A	24.00	24.00
240	A	30.00	30.00
270	A	30.00	30.00
300	A	36.00	36.00
320	A	36.00	36.00
360	A	36.00	36.00
420	A	46.00	46.00
480	B	50.00	50.00

DMP--G000 GRV 008-4101

SUBMITTAL

Job Name: Piedmont HS 30s Building



Tag: N/A
Customer: DMG North CV
Job ID: PHS30s
Date: April 11, 2024

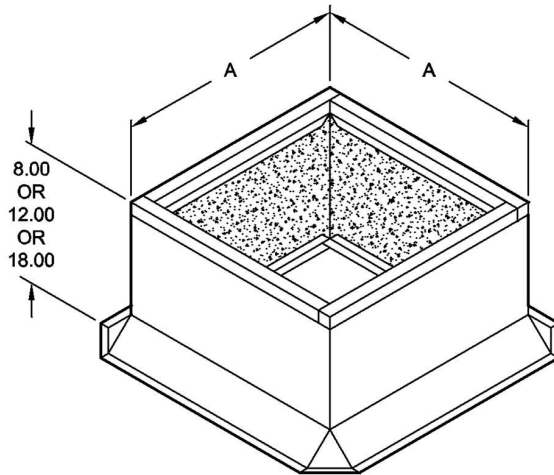

FAN SIZE	A SQ.
090	15.00 X 15.00
120	22.50 X 22.50
160	22.50 X 22.50
180	28.00 X 28.00
210	28.00 X 28.00
240	34.00 X 34.00
270	34.00 X 34.00
300	41.00 X 41.00
320	41.00 X 41.00
360	41.00 X 41.00
420	50.50 X 50.50
480	56.50 X 56.50

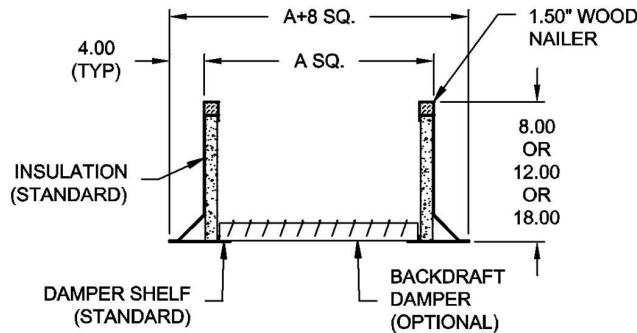

NOTES:

1. INSIDE OF CURB IS 3" LESS THAN DIMENSION "A".
2. CURBS ARE SIZED 1.50" LESS THAN FAN BASE (CAP) TO ALLOW .75" EACH SIDE FOR FLASHING MATERIAL AND CLEARANCE.
3. WHEN USING A MOTOR OPERATED DAMPER IN THE CURB, A 12" HIGH (MINIMUM) CURB IS REQUIRED.
4. ALL DIMENSIONS $\pm 1/8"$.

FEATURES

- 18 GAUGE GALVANIZED STEEL CONSTRUCTION.
- .063 INCH THICK ALUMINUM CONSTRUCTION.
- ALL WELDED WATERTIGHT CONSTRUCTION.
- WOOD NAILER STRIPS ARE STANDARD.
- DAMPER SHELF.
- LARGE 3" BUILT-IN 45° CANT TO ACCOMMODATE ROOFING MATERIAL TO TOP OF CURB. CANT IS BEVELED AT CORNERS FOR BETTER LAY OF ROOFING MATERIAL.
- LINED WITH 1.50" GLASS FIBER FIRE-RESISTANT, SOUND-ABSORBING INSULATION.

RCPF GRV 034-4106



Customer: DMG North CV

Job ID: PHS30s

Date: April 11, 2024

Regulation Statements

Fan Energy Index (FEI) is an overall efficiency (wire-to-air) metric which includes not only the impact of the fan efficiency, but also each of the drive components used to operate the fan.

Fan Electrical Input Power (FEP) is the amount of power of a given fan at an operating point characterized by a value of flow and pressure.

Regulated fans with an FEI value less than 1.0 are not for sale or use in the state of California per CA Title 20 Requirements. FEI Value shown is based on selected fan performance at standard density.