



BOARD WORK SESSION
MONDAY, AUGUST 17, 2015
5:30-7:30



OPENING COMMENTS

PRELIMINARY BUDGET INFO

- Under District tab
 - “Department List” Dropdown
 - Budget from list
 - 2015-2016 Budget Book
 - http://www.gfps.k12.mt.us/sites/default/files/2015-16%20GFPS_DistrictBudgetBook.pdf

GFHS & CMR Upgrade and Infrastructure Repair Review

- Tom Moore

Skyline Elementary Renovation Review

- Ruth Uecker



SKYLINE EDUCATION CENTER

Revised: 5.11.10
Updated 10-19-2014
LCT Auto Cad 2014

- #1 BATHROOM
- #2 EMPLOYABILITY SPECIALIST
- #3 CLASSROOM
- #4 KITCHEN STORAGE
- #5 KITCHEN
- #6 SHOWER ROOM
- #7 AWARE
- #8 HEAD START AWARE
- #9 BENEFITS THERAPY
- #10 OFFICE
- #11 LAUNDRY
- #12 MAIN OFFICE
- #13 HEAD START STORAGE
- #14 HEAD START SUPERVISOR

■ Staff
■ Title Dept
■ Staff Room
■ Male
■ Male-Purpose
■ Lounge
■ Kitchen Food
■ Comp Lab
■ Admin Offices
■ Clean Room

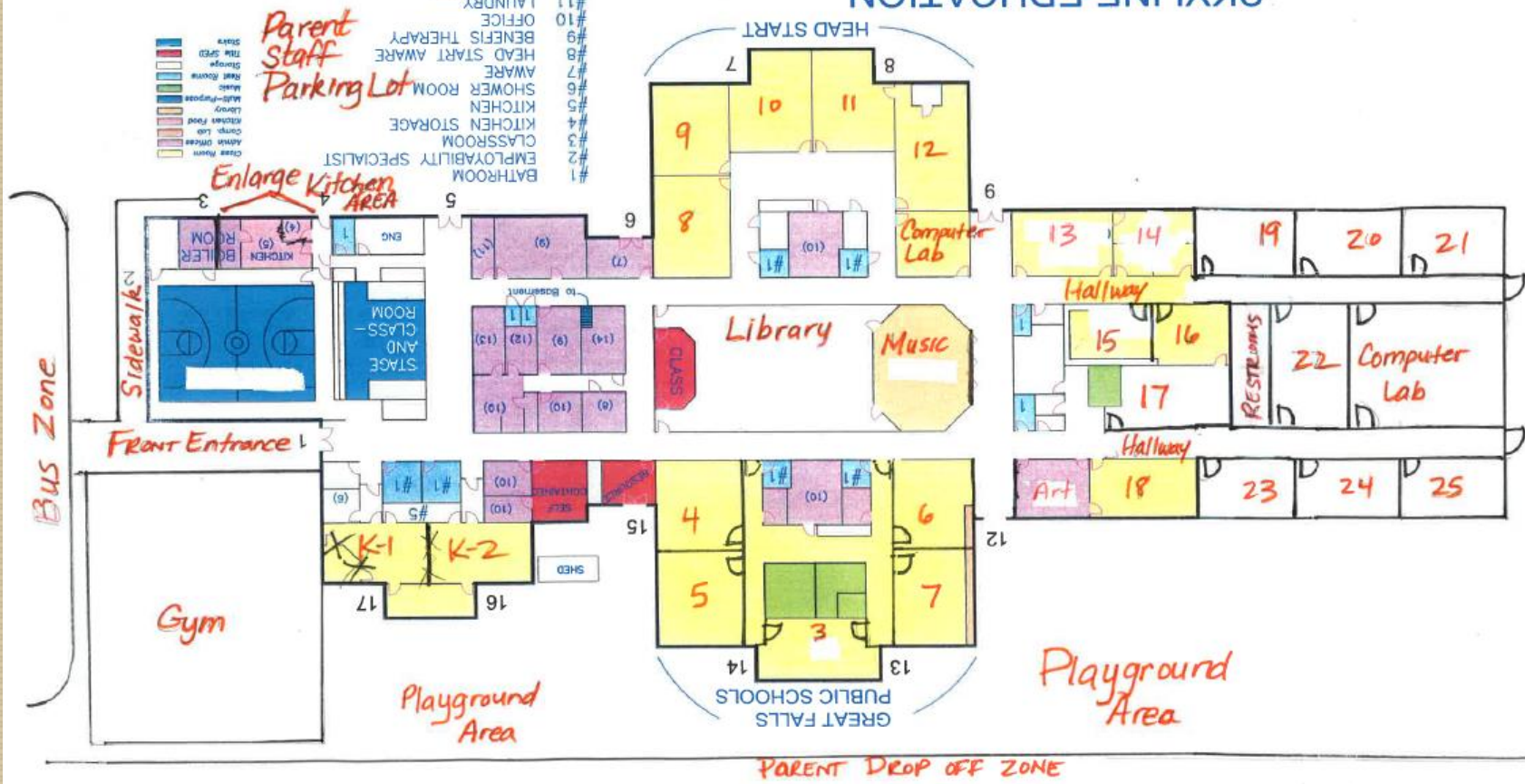

POST ESTIMATES:

• Skyline Upgrades:		
• Gymnasium addition (Metal Structure)	\$ 800,000	
• (Includes small storage area and restrooms):		
• Drop off pick-up area for parents/students: (sidewalks)	\$ 160,000 \$60,000	
• Carpet:	\$ 100,000	
• Addition and removal of interior walls (Includes electrical):	\$ 300,000	
• Fire Alarm upgrades:	\$ 60,000	
• Intercom updates:	\$ 30,000	
• Data:	\$ 50,000	
• Air Conditioning:	\$ 200,000	
• Blacktop resurfacing	\$ 100,000	
• Enlarge kitchen area	\$ 75,000	
• Furniture Estimate (\$5,400 per room)	\$ 135,000	
• Library materials (Books, Shelves)	\$ TBD	
• Playground equipment:	\$ 80,000	
• 7 Classrooms, restrooms, computer lab	\$1,400,000	
 TOTAL	 \$1,700,000 \$3,210,000	

Number of classrooms:	Functional Capacity:
• 19 classrooms	335
• 25 classrooms	440

• Preschool Relocation:		
• Purchase, remodel and move to a new site	\$1,000,000	OR
• Remodel and relocate to PGEC		
Bathrooms, etc.	75,000	
Elevator & 2 Stair Lifts	\$ 375,000	
SUBTOTAL	\$ 450,000	OR
• Remodel and relocate to LF, CJ, MV	\$ 50,000	AND
• Lease revenue potential losses	\$ 59,000	
• New Elementary Staffing:		
• Principal	\$ 95,000	
• Administrative Assistant	\$ 35,000	
• Counselor/Music/Art/Library/PE	\$ 200,000	
• Classroom Teachers (12)	\$ 600,000	
• Custodians	\$ 50,000	
• Aides	\$ 40,000	
• Elementary Entitlement	(\$ 50,000)	
TOTAL	\$ 970,000	



PGEC Preschool Plan Review

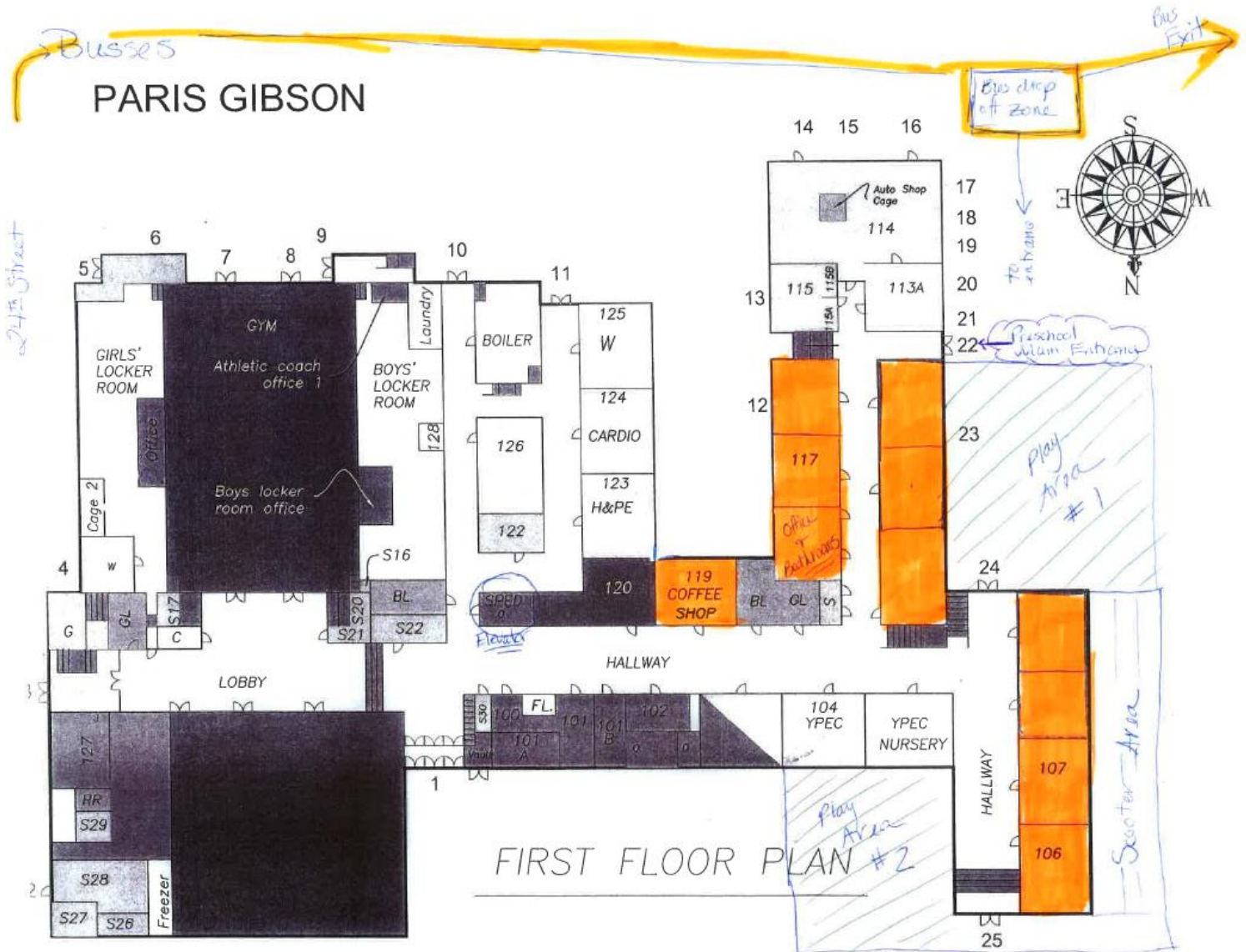

PARIS GIBSON





INFRASTRUCTURE LIST REVIEW

- **Chief Joseph:** Boiler (\$150,037), HVAC (\$214,076), Remodel Gym & Classroom Floors (\$257,590), Building Accessibility/External Warning System (\$12,214), Gym floor/Foundation (\$750,000) TOTAL: \$1,383,917
- **Lewis & Clark:** HVAC Controls (\$130,00), H & V coil #4 steam system (\$10,628) TOTAL: \$140,628
- **Lincoln:** 2-Boilers (\$235,000), Elevator/lift to connect K wing (\$65,000), HVAC (\$90,000) TOTAL: \$390,000
- ~~**Longfellow:** Boiler (\$168,247), Elevator to 2nd floor (\$225,000), Steam traps (\$245,138), Pneumatic control system upgrade (\$150,037), Steam line replacement (\$652,713), Line of site for main office (\$4,000), Limited access protocols (\$1,499), Repair crack in gym (\$16,079), B wing sinking (\$750,000), Domestic water lines (\$100,000) TOTAL: \$2,312,713~~
- **Loy:** 2-Boilers (\$225,582), Excavation of lines under school covered by gumbo (\$210,000), Parking area/bus route circular drive (\$150,000), Upgrade electrical for computer lab (40,000) TOTAL: \$625,582
- **Meadowlark:** Boiler (\$126,675), Parking Lot upgrade (\$90,000) TOTAL: \$216,675
- **Morningside:** Upgrade electrical for computer lab (\$40,000), HVAC Controls (\$126,050), Repair settling walls (\$250,000), Replace water line (\$100,000) TOTAL: \$516,050
- **Mountain View:** Storage area converted to teaching space (\$175,000) TOTAL: \$175,000
- **Riverview:** Sectional boilers (\$217,073), HVAC Controls (\$62,526) TOTAL: \$279,599
- ~~**Roosevelt:** 2-Boilers (\$231,728), Electrical upgrade (\$50,000), Elevator (\$300,000), Lower Fire Alarms to meet ADA (\$12,493), Replace domestic water system (\$150,000), Repair fire suppression system (\$75,000), Roof (\$500,000), Hallway breaker boxes (\$3,705), Structural wall moving (\$96,050), Dryvit Window panels (\$20,000) TOTAL: \$1,438,976~~
- **Sacajawea:** 2-Boilers (\$217,073) TOTAL: \$217,073
- **Sunnyside:** 2-Boilers (\$205,127), Upgrade electrical for computer lab (\$40,000) TOTAL: \$245,127
- **West:** Boiler tube replacement (\$80,000), HVAC Controls (\$296,624), Stairs outside auditorium (\$75,000) TOTAL: \$451,624
- **Valley View:** 2-Boilers (\$225,000) TOTAL: \$225,000
- **Whittier:** 2-Boilers (\$243,747), Elevator (\$225,000), Floor shifting (\$100,000) TOTAL: \$568,747
- **Skyline:** 2-Boilers (\$225,000) TOTAL: \$225,000
- **EMS:** Boilers (\$225,000), Fire alarm system (\$150,000), HVAC steam traps, valves and piping (\$334,279), Roof repair (\$28,834), Install emergency strobes in various locations (\$40,806), Window retrofit (\$950,000) TOTAL: \$1,728,919
- **NMS:** Boilers (\$285,000), Doors replacement (\$50,000), Fire alarm system (\$160,788), Fire suppression system (\$60,000), Roof (\$500,000), Emergency strobe lights (\$15,484), Foundation repair (\$2,000,000), Automatic flushers to urinals (\$71,193) TOTAL: \$3,142,465
- **Paris:** Install burner on Boiler #1 (\$8,149), Replace exterior doors (\$72,965), Elevator (\$250,000), HVAC Controls (\$426,738), Domestic water system replacement (\$200,000), Extensive plumbing throughout building (\$400,000), Shop roof (\$60,130), Roof on main building (\$650,000), Replace windows (\$288,788), Cafeteria tables (\$28,942) TOTAL: \$2,385,712

INFRASTRUCTURE TOTALS:

- All K-6 (16 buildings) \$9,411,711
- K-6 excluding Longfellow and Roosevelt \$5,660,022

- Middle Schools \$4,871,384

- PGEC \$2,385,712

- Total as per Cabinet Recommendations (K-6 excluding LF and RS), middle school and PGEC upgrades
\$12,917,118

MAINTENANCE & REPAIR HISTORY



BUILDING PURCHASE?

RFQ: OWNER'S FACILITY PLANNING/CONSTRUCTION REPRESENTATIVE

- DRAFT

More Board Discussion

- Board Meeting Agenda Items
 - August 24...September 14...:
 - Plan Adoption
 - RFQ
- Work Session?
- Other



Public Comment

Adjourn

Design Thinking

