

Roanoke County Schools

Three Year AHERA Reinspection

Glenvar Elementary School
Facility 018

Reinspection Dates:

April 22, 2008

May 27, 2008

Baratta & Associates, Inc

PO Box 293

Vinton, Virginia 24179

540-890-4875

Michael Baratta, PE

Virginia Asbestos Inspector License: 3303-000065

Virginia Asbestos Management Planner License: 3304-000208

Baratta & Associates, Inc.

Virginia Department of Education
Energy and Facilities Service

LEA Roanoke County Schools
School 018 Glenvar Elementary School
Building Main

SCHOOL BUILDINGS

Building Name	Location	Check here for the presence of:				No ACBM
		ACBM		Suspect ACBM		
		Friable	Non- friable	Friable	Non- friable	
Glenvar Elementary School (018)	4507 Malus Drive Salem, VA 24153	X		X		

Inspector:

Name: Michael Baratta Signature  Date 6/23/00
Accreditation Number: 3303 000065 Agency: Virginia DPOR

AHERA Three Year Inspection
 Glenvar Elementary School
 Roanoke County Schools
 Sample date

Building 018
 Sample Locations
 L001
 April 22, 2008; May 27, 2008

- HA-09 Gypsumboard system, white
 Sample 09-1; 09-2, 09-3
- HA-13A Floor tile 12"x12", black and white
 Samples 13A-1; 13A-2
- HA-13B Black mastic for HA-13A
 Samples 13B-1; 13B-2
- HA-16A Floor tile 9"x9", green
 Samples 16A-1; 16A-2
- HA-16B Black mastic for HA-16A
 Samples 16B-1; 16B-2
- HA-18A Floor tile 12"x12", tan
 Samples 18A-1; 18A-2
- HA-18B Black mastic for HA-18A
 Samples 18B-1; 18B-2

Positive Samples in **Bold**

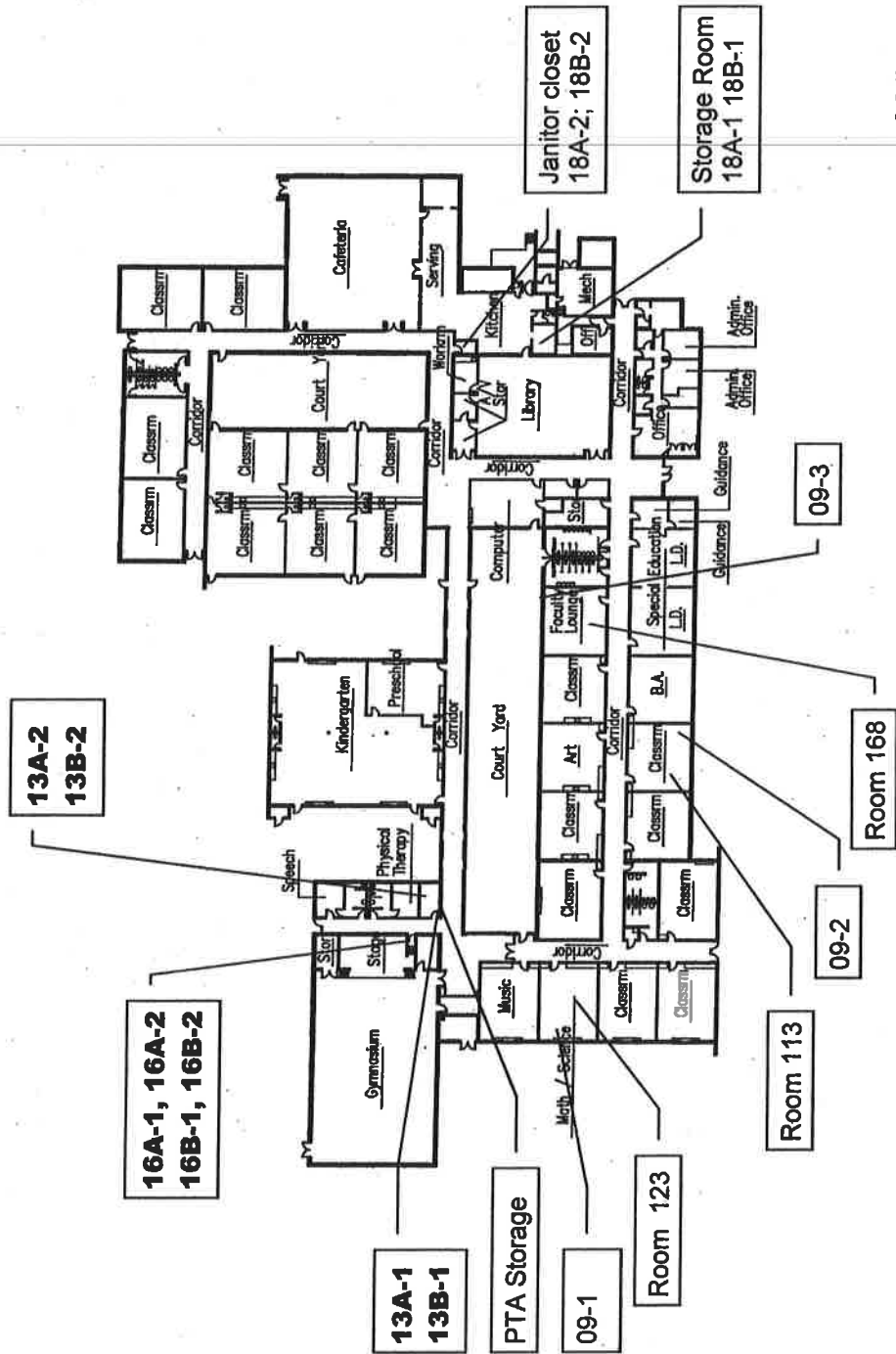

Virginia Department of Education
Energy and Facilities Services

LEA Roanoke County Schools
School: 018 Glenvar Elementary School
Building: Main
Sample Date: April 22 and May 27, 2008
Analysis Date: April 24 and June 2, 2008
Analysis Method: PLM EPA 6000/M4-82-020

BULK SAMPLE ANALYSIS

Homogeneous Area	Sample Number	Material	Asbestos Content
09	09-1	Gypsumboard system, white	NAD
	09-2		NAD
	09-3		NAD
13A	13A-1	Floor tile 12" x12", white & black	3 % chrysotile
	13A-2		3 % chrysotile
13B	13B-1	Black mastic for HA-13A	4 % chrysotile
	13B-2		4 % chrysotile
16A	16A-1	Floor tile 9"x9", green	4 % chrysotile
	16A-2		4 % chrysotile
16B	16B-1	Black mastic for HA-16A	10 % chrysotile
	16B-2		10 % chrysotile
18A	18A-1	Floor tile 12" x12", tan	NAD
	18A-2		NAD
18B	18B-1	Black mastic for HA-18A	NAD
	18B-2		NAD

NAD – no asbestos detected

See attached AmeriSci PLM Bulk Asbestos Report Numbers 108041606 & 108051782

Name: Michael Baratta Signature  Date 6/23/08
Accreditation Number: 3303 000065 Agency: Virginia DPOR



AmeriSci Richmond

13635 GENITO ROAD
MIDLOTHIAN, VA 23112
TEL: (804) 763-1200 • FAX: (804) 763-1800

April 24, 2008

Baratta & Associates, Inc.
Attn: Michael Baratta
1150 Shady Run Road
Vinton, VA 24179

RE: Baratta & Associates, Inc.
Job Number 108041606
P.O. #L001
L001; AHERA; Glenvar ELS

Dear Michael Baratta:

Enclosed are the results for PLM asbestos analysis of the following Baratta & Associates, Inc. samples received at AmeriSci on Thursday, April 24, 2008, for a 3 day turnaround:

09-1, 09-2, 09-3, 13A-1, 13A-2, 13B-1, 13B-2, 18A-1, 18A-2, 18B-1, 18B-2

The 11 samples contained in zip lock bag were shipped to AmeriSci via Fed Ex 8621 8375 0530 B. These samples were prepared and analyzed according to the EPA Interim Method (EPA 600/M4-82-020 per 40 CFR 763, subpt F, App. A). The required analytical information, analysis results, analyst signature and laboratory identification is contained in the Analyst's Report.

This report relates ONLY to the sample analysis expressed as percent asbestos. AmeriSci assumes no responsibility for customer supplied data such as "sample type", "location", or "area sampled". This report must not be used to claim product endorsement by AmeriSci, NVLAP or any agency of the U. S. Government. The National Institute of Standards and Technology Accreditation requirements, mandates that this report must not be reproduced, except in full without the written approval of the laboratory. This report may contain specific data not covered by NVLAP or ELAP accreditations respectively, if so identified in relevant footnotes.

AmeriSci appreciates this opportunity to serve your organization. Please contact us for any further assistance or with any questions.

Sincerely,

A handwritten signature in black ink that reads "T. Brian Keith for TBK". The signature is written in a cursive, flowing style.

T. Brian Keith
Asbestos Laboratory Director



AmeriSci Richmond

13635 GENITO ROAD
MIDLOTHIAN, VIRGINIA 23112
TEL: (804) 763-1200 • FAX: (804) 763-1800

PLM Bulk Asbestos Report

Baratta & Associates, Inc.
Attn: Michael Baratta
1150 Shady Run Road

Vinton, VA 24179

Date Received 04/24/08 **AmeriSci Job #** 108041606
Date Examined 04/24/08 **P.O. #**
Page 1 of 3
RE: L001; AHERA; Glenvar ELS

Client No. / HGA	Lab No.	Asbestos Present	Total % Asbestos
09-1 Location: Gypsum Board System	108041606-01	No	NAD (by CVES) by C. David Mintz on 04/24/08
Analyst Description: Off White, Heterogeneous, Non-Fibrous, Bulk Material			
Asbestos Types:			
Other Material: Cellulose 4 %, Non-fibrous 96 %			
09-2 Location: Gypsum Board System	108041606-02	No	NAD (by CVES) by C. David Mintz on 04/24/08
Analyst Description: Off White, Heterogeneous, Non-Fibrous, Bulk Material			
Asbestos Types:			
Other Material: Cellulose 8 %, Non-fibrous 92 %			
09-3 Location: Gypsum Board System	108041606-03	No	NAD (by CVES) by C. David Mintz on 04/24/08
Analyst Description: Off White, Heterogeneous, Non-Fibrous, Bulk Material			
Asbestos Types:			
Other Material: Cellulose 7 %, Non-fibrous 93 %			
13A-1 Location: Floor Tile	108041606-04	Yes	3 % (by CVES) by C. David Mintz on 04/24/08
Analyst Description: Beige/Gray, Homogeneous, Non-Fibrous, Bulk Material			
Asbestos Types: Chrysotile 3.0 %			
Other Material: Non-fibrous 97 %			
13A-2 Location: Floor Tile	108041606-05	Yes	3 % (by CVES) by C. David Mintz on 04/24/08
Analyst Description: Beige/Gray, Homogeneous, Non-Fibrous, Bulk Material			
Asbestos Types: Chrysotile 3.0 %			
Other Material: Non-fibrous 97 %			

Client Name: Baratta & Associates, Inc.

PLM Bulk Asbestos Report

L001; AHERA; Glenvar ELS

Client No. / HGA	Lab No.	Asbestos Present	Total % Asbestos
13B-1 Location: Floor Tile Mastic	108041606-06	Yes	4 % (by CVES) by C. David Mintz on 04/24/08
Analyst Description: Black, Heterogeneous, Non-Fibrous, Bulk Material Asbestos Types: Chrysotile 4.0 % Other Material: Non-fibrous 96 %			
13B-2 Location: Floor Tile Mastic	108041606-07	Yes	4 % (by CVES) by C. David Mintz on 04/24/08
Analyst Description: Black, Heterogeneous, Non-Fibrous, Bulk Material Asbestos Types: Chrysotile 4.0 % Other Material: Non-fibrous 96 %			
18A-1 Location: Floor Tile	108041606-08	No	NAD (by CVES) by C. David Mintz on 04/24/08
Analyst Description: Off White, Homogeneous, Non-Fibrous, Bulk Material Asbestos Types: Other Material: Non-fibrous 100 %			
18A-2 Location: Floor Tile	108041606-09	No	NAD (by CVES) by C. David Mintz on 04/24/08
Analyst Description: Off White, Homogeneous, Non-Fibrous, Bulk Material Asbestos Types: Other Material: Non-fibrous 100 %			
18B-1 Location: Floor Tile Mastic	108041606-10	No	NAD (by CVES) by C. David Mintz on 04/24/08
Analyst Description: Black, Heterogeneous, Non-Fibrous, Bulk Material Asbestos Types: Other Material: Cellulose 3 %, Non-fibrous 97 %			
18B-2 Location: Floor Tile Mastic	108041606-11	No	NAD (by CVES) by C. David Mintz on 04/24/08
Analyst Description: Black, Heterogeneous, Non-Fibrous, Bulk Material Asbestos Types: Other Material: Cellulose 3 %, Non-fibrous 97 %			

Client Name: Baratta & Associates, Inc.

PLM Bulk Asbestos Report

L001; AHERA; Glenvar ELS

Reporting Notes:

Analyzed by: C. David Mintz



Date

4/24/09

*NAD = no asbestos detected, Detection Limit <1%, Reporting Limits: CVES = 1%, 400 Pt Ct = 0.25%, 1000 Pt Ct = 0.1%; "Present" or NVA = "No Visible Asbestos" are observations made during a qualitative analysis; NA = not analyzed; NA/PS = not analyzed / positive stop; PLM Bulk Asbestos Analysis by EPA 600/M4-82-020 per 40 CFR 763 (NVLAP Lab Code 101904-0) and ELAP PLM Analysis Protocol 198.1 for New York friable samples (198.6 for NOB samples)(NYSDOH ELAP Lab # 10984); CA ELAP Lab # 2508; Note: PLM is not consistently reliable in detecting asbestos in floor coverings and similar NOB materials. NAD or Trace results by PLM are inconclusive, TEM is currently the only method that can be used to determine if this material can be considered or treated as non-asbestos-containing in New York State (also see EPA Advisory for floor tile, FR 59, 146, 38970, 8/1/94). NIST Accreditation requirements mandate that this report must not be reproduced except in full without the approval of the laboratory. This PLM report relates ONLY to the items tested.

Reviewed By: 



AmeriSci Richmond

13635 GENITO ROAD
MIDLOTHIAN, VA 23112
TEL: (804) 763-1200 • FAX: (804) 763-1800

June 2, 2008

Baratta & Associates, Inc.
Attn: Michael Baratta
1150 Shady Run Road
Vinton, VA 24179

RE: Baratta & Associates, Inc.
Job Number 108051782
P.O. # L001
L001; AHERA; Glenvar E/S

Dear Michael Baratta:

Enclosed are the results for PLM asbestos analysis of the following Baratta & Associates, Inc. samples received at AmeriSci on Friday, May 30, 2008, for a 3 day turnaround:

1GA-1, 1GA-2, 1GB-1, 1GB-2

The 4 samples contained in zip lock bag were shipped to AmeriSci via Fed Ex 8621 8375 0367 B. These samples were prepared and analyzed according to the EPA Interim Method (EPA 600/M4-82-020 per 40 CFR 763, subpt F, App. A). The required analytical information, analysis results, analyst signature and laboratory identification is contained in the Analyst's Report.

This report relates ONLY to the sample analysis expressed as percent asbestos. AmeriSci assumes no responsibility for customer supplied data such as "sample type", "location", or "area sampled". This report must not be used to claim product endorsement by AmeriSci, NVLAP or any agency of the U. S. Government. The National Institute of Standards and Technology Accreditation requirements, mandates that this report must not be reproduced, except in full without the written approval of the laboratory. This report may contain specific data not covered by NVLAP or ELAP accreditations respectively, if so identified in relevant footnotes.

AmeriSci appreciates this opportunity to serve your organization. Please contact us for any further assistance or with any questions.

Sincerely,

A handwritten signature in black ink, appearing to read "T. Brian Keith". The signature is stylized and somewhat cursive.

T. Brian Keith
Asbestos Laboratory Director



PLM Bulk Asbestos Report

Baratta & Associates, Inc.
Attn: Michael Baratta
1150 Shady Run Road
Vinton, VA 24179

Date Received 05/30/08
Date Examined 06/02/08
RE L001; AHERA; Glenvar E/S

AmeriSci Job No. 108051782
P.O. # L001
Page 1 of 2

Client No. / HGA	Lab No.	Asbestos Present	Total % Asbestos
1GA-1 16A-1	108051782-01 Location: Floor Tile	Yes	4 % (by CVES) by David W. Ralbovsky on 06/02/08
1GA-2 16A-2	108051782-02 Location: Floor Tile	Yes	4 % (by CVES) by David W. Ralbovsky on 06/02/08
1GB-1 16B-1	108051782-03 Location: Floor Tile Mastic	Yes	10 % (by CVES) by David W. Ralbovsky on 06/02/08
1GB-2 16B-2	108051782-04 Location: Floor Tile Mastic	Yes	10 % (by CVES) by David W. Ralbovsky on 06/02/08

See Reporting notes on last page

Client Name: Baratta & Associates, Inc.

PLM Bulk Asbestos Report

L001; AHERA; Glenvar E/S

Client No. / HGA	Lab No.	Asbestos Present	Total % Asbestos
------------------	---------	------------------	------------------

Reporting Notes:

Analyzed by: David W. Falbovsky

David W. Falbovsky

Date

9/2/18

*NAD = no asbestos detected, Detection Limit < 1%, Reporting Limits: CVES = 1%, 400 Pt Ct = 0.25%, 1000 Pt Ct = 0.1%; "Present" or NVA = "No Visible Asbestos" are observations made during a qualitative analysis; NA = not analyzed; NA/PS = not analyzed / positive stop; PLM Bulk Asbestos Analysis by EPA 600/M4-82-020 per 40 CFR 763 (NVLAP Lab Code 101904-0) and ELAP PLM Analysis Protocol 198.1 for New York friable samples (198.6 for NOB samples)(NYSDOH ELAP Lab # 10984); CA ELAP Lab # 2508; Note: PLM is not consistently reliable in detecting asbestos in floor coverings and similar NOB materials. NAD or Trace results by PLM are inconclusive, TEM is currently the only method that can be used to determine if this material can be considered or treated as non-asbestos-containing in New York State (also see EPA Advisory for floor tile, FR 59, 146, 38970, 8/1/94). NIST Accreditation requirements mandate that this report must not be reproduced except in full without the approval of the laboratory. This PLM report relates ONLY to the items tested.

Reviewed By: *TJN*

Baratta & Associates, Inc.
P.O. Box 293
Vinton, Virginia

LEA Roanoke County Schools
School 018 Glenvar Elementary School
Building Main

REASSESSMENT OF MATERIALS

Past or Initial Assessment: Hall-Kimbrell April 1989

Homogeneous Area	Description	Past Assessment Category #	Reassessment Category #
02	Heating water fitting TSI	1	removed 1994
03	Heating water pipe TSI	1	removed 1994
04	Domestic HW fitting TSI	1	6
05	Domestic HW pipe TSI	Non-ACM	-
06	Domestic CW fitting TSI	1	6
07	Domestic CW pipe TSI	Non-ACM	-
08	Heating water fitting TSI (gymnasium mechanical room)	Non-ACM	-
09	Gypsumboard system, white	Not evaluated	Non-ACM
10	LIC all floors	Non-ACM	-
11	LIC all floors	Non-ACM	-
12	LIC all floors	Non-ACM	-
13A	Floor tile 12" x12", white & black	5	5
13B	Black mastic for HA-13A	Not evaluated	5
14	Floor tile, non descript	5	removed
15	Floor tile 9"x9", brown	5	removed
16A	Floor tile 9"x9", green	5	5
16B	Black mastic for HA-16A	5	5
17	Floor tile 9"x9", tan	5	removed
18A	Floor tile 12" x12", beige with tan	Non-ACM	Non-ACM
18B	Black mastic for HA-18A	Not evaluated	Non-ACM
19	Breeching TSI, Main Boiler Room	1	removed 1994
20	Pipe fitting TSI, Main Boiler Room	1	removed 1994
21	Pipe run TSI, Main Boiler Room	1	removed 1994
22	Tank TSI, Main Boiler Room	1	removed 1994
23	Breeching TSI, 5 th Grade Boiler Room	1	6
24	Pipe fitting TSI, 5 th Grade Boiler Room	1	1 ¹

Note 1 Minor damage to fitting at top of boiler

AHERA - Physical Assessment Categories - 763.88(a)(2)(b)

- 1 Damaged or significantly damaged TSI-ACBM
- 2 Damaged friable surfacing ACBM
- 3 Significantly damaged friable surfacing ACBM
- 4 Damaged or significantly damaged friable miscellaneous ACBM
- 5 ACBM with potential for damage
- 6 ACBM with potential for significant damage
- 7 Any remaining friable ACBM or friable suspect ACBM

Inspector:

Name: Michael Baratta

Signature 

Date

6/23/06

Accreditation Number: 3303 000065 Agency: Virginia DPOR

LOCATION OF ACBMs

018

Glenvar Elementary School

Scale: see drawing

Reinspection Dates: April 22 & May 27, 2008

TSI-ACM (HA-23 & 24) observed in 5th Grade Boiler Room

TSI-ACM (HA-04 & 06) observed in Janitor Closet

TSI-ACM hidden inside walls and ceiling spaces and other areas - Typical

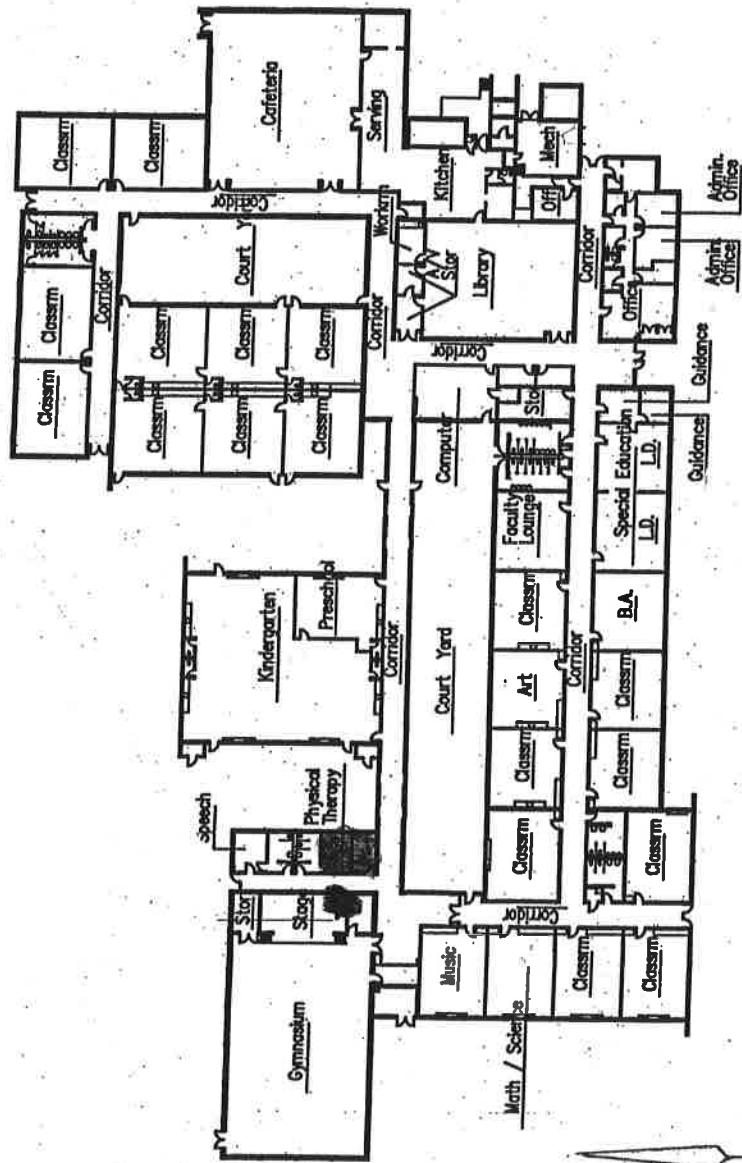

	Asbestos containing floor tiles and mastics (HA-13 & 16)
---	--

Virginia Department of Education
Energy and Facilities Service

LEA Roanoke County Schools
School 018 Glenvar Elementary School
Building: Main

**RESPONSE ACTIONS
RECOMMENDED**

Total cost to remove \$22,000

Each Location	Recommended Response Actions	Scheduled To Begin	Scheduled To Be Completed	Est. Cost To Remove
Floor tile and mastic (HA-13A, 13B, 16A & 16B)	Maintain floor coverings until other needs require these floor coverings to be removed	none	none	\$2,000
TSI through out building	Place in O & M plan until other needs require the TSI be removed	none	none	20,000

Management Planner:
Name: Michael Baratta Signature  Date 6/23/02
Accreditation Number: 3304 000208 Agency: Virginia DPOR

ASBESTOS MANAGEMENT, OPERATIONS AND MAINTENANCE PLAN

018 Glenvar Elementary School
June 23, 2008

This Asbestos Management Operations and Maintenance Plan is based on the Three Year AHERA Reinspection performed by Baratta & Associates, Inc on April 24 and May 27, 2008. It covers procedures to be followed in dealing with the Asbestos-Containing Materials (ACMs) found in the Glenvar Elementary School.

SUMMARY

Most of the asbestos containing thermal system insulation (TSI) was removed from this building. Exposed asbestos containing TSIs can be seen in the Fifth Grade Boiler Room and in the janitor closets. Additional ACM-TSI remains inside concealed spaces.

The grey 12"x12" black & white tiles in the PTA Storage Room and the green 9" x 9" floor tiles at the stage steps across the hall tested to be Asbestos Containing Materials. The black mastics associated with these tiles are also deemed ACMs. These floor coverings are in good condition. They do not currently present an asbestos related health risk to building occupants in their current condition.

STAFF NOTIFICATION

The School should send all staff members a brief notice stating that Asbestos-Containing Materials exist in the Glenvar Elementary School.

ACM IDENTIFICATION

The following products were found to be Asbestos-Containing Materials (ACMs):

HA Number	Material
04	Domestic HW fitting TSI
06	Domestic CW fitting TSI
13A	Floor tile 12" x12", white & black
13B	Black mastic for HA-13A
16A	Floor tile 9"x9", green
16B	Black mastic for HA-16A
23	Breeching TSI, 5 th Grade Boiler Room
24	Pipe fitting TSI, 5 th Grade Boiler Room

CARE OF THE FLOOR TILES

No drilling, sanding, or other abrasive or penetrating activities shall be used on the asbestos containing floor tiles. To do so may release asbestos fibers into the environment.

The flooring is tough and non-friable. It is doubtful anything other than forceful vandalism will deteriorate this material to a point where significant fiber release will occur.

CARE OF THE THERMAL SYSTEM INSULATION (TSI) EXPOSED IN CLOSETS

In there current condition, these materials do not present an asbestos related health hazard to building occupants. Custodial and maintenance personnel should take care not to damage or disturb these TSIs while performing their duties. Any damaged areas should be reported to the Principal so repairs can be made.

Any patching, repair work or removal should be carried out by a licensed asbestos abatement contractor.

CARE OF THE THERMAL SYSTEM INSULATION (TSI) IN CONCEALED SPACES

These ACMs are hidden in the walls and ceiling spaces. They do not present an asbestos related health hazard to those occupying the building.

Care should be taken when removing any ceiling tiles as TSI debris may have fallen on top of the tiles.

Should you notice any suspect asbestos containing debris in the ceiling space, please contact the Principal so an evaluation can be made and appropriate action taken,

PERMIT REQUIREMENTS

Before any work that may require the disturbance of the noted Asbestos Containing Materials is performed, maintenance personnel or contractors shall obtain an Asbestos Work Area Permit from the School System's Asbestos Program Manager.