



HOUSE

Total Audience Capacity:	561	Seating Style:	American
Lower Level Seats:	206	Internal Aisles:	2
Upper Level Seats:	355	Transverse Aisle:	1

STAGE

Stage		Dimensions	
Type:	Proscenium Arch	Proscenium:	49' W x 22'4" H
Material:	Sprung Wood	Stage Height:	3'7"
Color:	Black	Stage Depth:	31'
ADA Access:	Ramp from house right to front of stage	Apron:	55' x 13'10"
		SR Wing:	40'5" x 19'
		SL Wing:	40'5" x 13'
		Crossover:	100'5" x 9'4"
Net Playing Space			
Net Stage Width: <i>(leg to leg)</i>	41'		
Net Stage Depth: <i>(front of apron to back curtain)</i>	45'		

Note: unless otherwise noted, all US/DS dimensions are taken from the plasterline

STAGE EQUIPMENT

Dance Floor:	5 lanes Rosco Dance Floor	Choir Risers:	5 Wenger Tourmaster
Dance Booms:	8	Pianos:	1 Upright 1 Yamaha Clavinova Digital Grand

SUPPORT SPACES

Lobby		Loading Area	
Ticket Booth:	1	Loading Dock:	Yes
Concessions Stand:	1	Building Access:	Large double doors to performance hallway
Backstage		Stage Access:	Garage door from performance hallway
Dressing Rooms:	2		
Greenroom:	Not available		
Scene Shop:	1		

CA JOHNSON THEATRE

Technical Specifications

AUDIO

Console:	Midas M32
Control Locations:	Control Booth, iPad App

Amplifiers

Crown CDi 1000	1
Crown DSi 1000	3
Crown DSi 4000	1

Playback

RapcoHorizon Laptop Interface	1
Denon DN-200BR Bluetooth Receiver	1

HOUSE SPEAKERS

Additional monitors available on request

<u>Location</u>	<u>Make/Model</u>	<u>Qty.</u>
Mains:	Renkus-Heinz P-15	3
Delay:	Renkus-Heinz CFX81	3
Stage Fill:	Renkus-Heinz CFX121M	2
Portable Monitors:	JBL JRX-100	2

INPUTS & OUTPUTS

	<u>Inputs</u>	<u>Type</u>	<u>Channels</u>	<u>Outputs</u>	<u>Type</u>	<u>Channels</u>
DSR Wing:	6	XLR	1-6	3	Speakon	Mon 1-2
DSL Wing:	6	XLR	7-12	3	Speakon	Mon 1-2
USR Wing:	6	XLR	13-18	2	Speakon	Mon 1-2
USL Wing:	6	XLR	19-24	2	Speakon	Mon 1-2

MICROPHONES

Additional microphones available on request

	<u>Qty</u>	<u>Model</u>
Wireless Receivers:	2	Sennheiser EM 100 G3
Microphones		
Wireless Handheld:	2	Sennheiser SKM 100-835 G3
Wireless Lavalier:	1	Sennheiser SK 100 G3

INTERCOM

Base Station:	Clear-Com MS-702	Headsets:	4
Channels:	2	Beltpacks:	4

CA JOHNSON THEATRE

Technical Specifications

LIGHTING

Console:	ETC Ion 1000 with 20 sub fader wing
Control Locations:	Control Booth, SL Wing

DIMMERS

Theatrical Lighting:	ETC Sensor+ Dimmer Racks	Architectural Lighting:	ETC Unison
Total Dimmers:	192	Architectural Dimmers:	14
Stage Dimmers:	172	Type:	Wall Sconces & Incandescent
LED Power Dimmers:	6		
Wattage:	2400w		
Connector Type:	Stage Pin		

CIRCUITS

<u>Positions</u>	<u>Qty</u>	<u>Total Circuits</u>	<u>Dimmers</u>	<u>ETCnet</u>
Front of House Catwalk:	1	24	1-24	1
Box Booms:	2	12	25-34	2 (1 ea.)
Overhead Electrics:	4	98	37-134	1 (4 th Elec)
Grid Drop Boxes:	4	24	139-162	
Offstage Wall Boxes:	4	16	163-178	1 (DSL)

HOUSE PLOT

Additional instruments available on request

	<u>Position/Purpose</u>	<u>Colors</u>	<u>Fixtures</u>
Washes	FOH/Stage Front:	2 (warm/cool)	10 ETC Source 4 26° Fixtures 12 ETC Source 4 36° Fixtures
	Overhead/Down:	2 (warm/cool)	48 ETC Source 4 PARNels (6 per wash per electric)
	Pipe-ends/High Side:	1 (lav)	8 ea. ETC Source 4 26° & 36° Fixtures
	Cyc:	-	9 Chauvet Ovation C-805FC LED Cyc Lights
	Dance Booms: (if set up)	3	18 ETC Source 4 36° Fixtures
Specials	Front of House:	3 (SL, CS, SR)	ETC Source 4 36° Fixtures
		3 (SL, CS, SR)	ETC Source 4 25-50° Zooms
	Overhead:	12 (3 per electric - L/R/C)	ETC Source 4 Jr. 25-50° Zooms
	Box Booms:	6 (3 ea.)	ETC Source 4 14° & 26° Fixtures
	Followspots:	1	Lycian Midget HP Followspot

POWER DISTRIBUTION

<u>Type</u>	<u>Location</u>	<u>Qty.</u>	<u>Amps.</u>	<u>Connectors</u>	<u>Dimmers</u>
Company Switch	USR Wall	1	400	Tie-In	
Dimmer Power	Box Booms	2	20a	Edison	35-36
	Overhead	4	20a	Edison	135-138
Constant Power	Catwalk	6	20a	Edison	

CA JOHNSON THEATRE

Technical Specifications

PROJECTION

Projector

Model: BenQ LU9715
Location: Back of House

Screen

Location: Lineset 6 CS
Control Location: Counterweight Rail
Dimensions: 16' W x 12' H

INPUTS

	<u>Type</u>	<u>Qty.</u>	<u>Type</u>	<u>Qty.</u>
Booth:	HDMI	1	VGA	1

RIGGING

FRONT OF HOUSE

Catwalk

Distance from Proscenium: 22'3"
Trim: 23'9"
Length: 99'

Box Booms

Distance from Proscenium: 32'
Trim: 32' (to bottom)
Light Positions: 3 (ea.)

OVERHEAD

Recommended Drop Dimensions: 48-60' W x 20-24' H

Single-Purchase Counterweight

Total Linesets: 35
Available Linesets: 15
Batten Length: 65'
Capacity: 2000 lbs.

Locking Rail: SL Wing
Mid-Rail: Yes
Loading Bridge: Yes
Walk-able Grid: Yes

Motorized Electrics

Qty: 4
Manufacturer: Vortek
Capacity: 2000 lbs.

Traveler Tracks

Total Linesets: 2
Bi-parting Tracks: Main, Mid-stage

CA JOHNSON THEATRE

Technical Specifications

LINESET SCHEDULE

Purple = Lineset cannot be moved or changed

Green = Motorized Electric

Lineset	Position	Trim	Description	Dimensions	Material
1	2' 3"	23'	MAIN VALENCE	64' W x 12' H	Green Velour
2	2'11"	23'	MAIN CURTAIN	33' W x 22' H (2 panels)	Green Velour
3	3' 7"				
4	4' 3"	25'	1 ST ELECTRIC		
5	4'11"				
6	5' 7"		PROJECTION SCREEN	17' W x 13' H	
7	6'11"		DEAD SET		
8	7' 7"				
9	8' 3"				
10	8'11"	23' 6"	BORDER	64' W x 12' H	Black Velour
11	9' 7"	22'	LEGS	15' W x 22' H (2 panels)	Black Velour
12	10' 3"				
13	10'11"	25'	2 ND ELECTRIC		
14	11' 7"				
15	12' 3"				
16	14' 3"	23' 6"	BORDER	64' W x 12' H	Black Velour
17	14'11"	23'	MID-STAGE TRAVELER	33' W x 22' H (2 panels)	Black Velour
18	15' 7"	23' 6"	BORDER	64' W x 12' H	Black Velour
19	16' 3"	22'	LEGS	15' W x 22' H (2 panels)	Black Velour
20	16'11"		DEAD SET		
21	17' 7"	25'	3 RD ELECTRIC		
22	18' 3"				
23	18'11"				
24	19' 7"				
25	20'11"		DEAD SET		
26	21' 7"				
27	22' 3"	23' 6"	BORDER	64' W x 12' H	Black Velour
28	22'11"	22'	LEGS	15' W x 22' H (2 panels)	Black Velour
29	23' 7"		DEAD SET		
30	24' 3"	25'	4 TH ELECTRIC		
31	24'11"				
32	25' 7"	23' 6"	BORDER	64' W x 12' H	Black Velour
33	26' 3"				
34	28' 3"	22'	LEGS	15' W x 22' H (2 panels)	Black Velour
35	28'11"				
36	29' 7"				
37	30' 3"	22'	SCRIM	59'5" W x 21'3" H	Black Sharkstooth
38	30'11"	22'	CYCLORAMA	64' W x 22' H	Blue Muslin
39	31' 7"	22'	REAR CURTAIN	64' W x 22' H	Black Velour

CA JOHNSON THEATRE

FLOOR PLAN: STAGE LEVEL

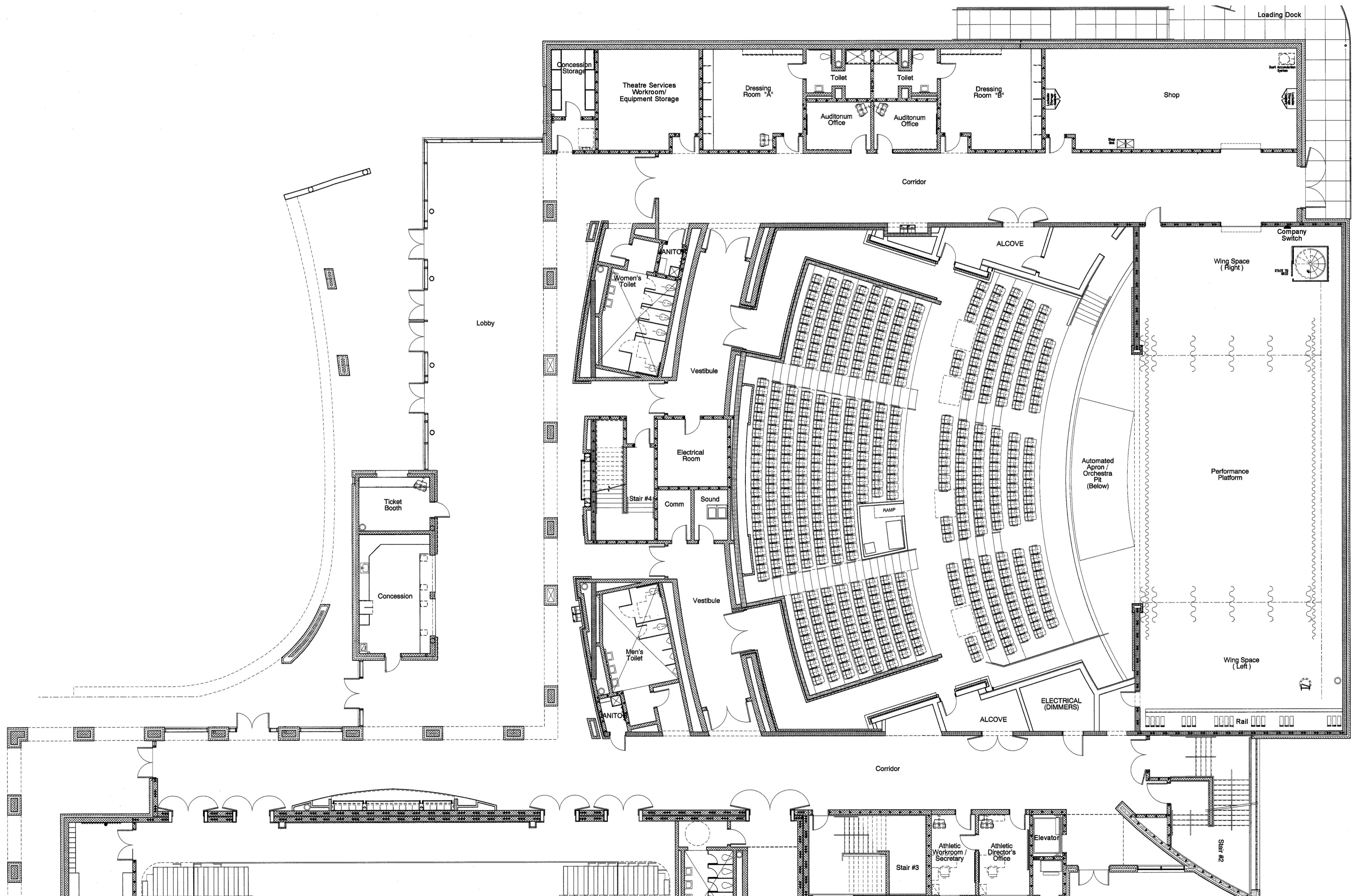

CA JOHNSON THEATRE FLOOR PLAN: MEZZANINE LEVEL

