



## ADDENDUM

Project:	<b>University High - Seal Abandoned Wells, Project No. 2448045</b>	
SEG Job No:	23010	
Modification:	<b>Revision 1 - Addendum 1</b>	<b>1 page(s)</b>
Issue Date:	4/16/2024	

Owner:	<b>School Board of Volusia County, Florida</b> 200 N. Clara Avenue DeLand, FL 32720	
Owner's PM:	Paul Martino	

Engineer:	<b>Sabiston Engineering Group, Inc.</b> 322 Kentucky Blue Circle Apopka, FL 32712 Phone: 407.884.6769 Fax: 407.884.6764	
-----------	--	--

The following modifications shall be incorporated to the previously distributed construction documents.  
Any questions regarding these modifications should be emailed to SEG for consideration.

**The Drawings and Specifications are hereby modified as follows:**

### **Mechanical Drawing Modifications:**

Item MD-1: Replace drawing M100 with attached, revised M100.

***End of Addendum***

RHODE ISLAND AVE

**Geothermal Well Information Schedule**

Mark	SJRWMD Well ID	Casing		Total Well Depth (Ft)	Bentonite Chip Quantity (50lb Bags)	Portland Cement Quantity (94lb Bags)
		Dia (Inches)	Depth (Ft)			
GWP-1A	39716	12	100	400	400	25
GWP-1B	442299	12	180	500	400	25
GWP-2	39717	12	103	500	225	25
GWP-3	39718	12	103	400	400	25
GWP-4	39719	12	100	400	400	25
GWR-1	39720	14	360	700	1150	33
GWR-1B	242460	14	90	425	800	33
GWR-2	39721	14	360	700	1150	33
GWR-2B	242462	14	90	500	800	33
GWR-3	39722	14	350	700	1150	33
TEST WELL	442298	5	84	500	110	4

Total Quantities: 6985  
 10% Safety: 699  
**Bid Quantity: 7684 294**

- Notes:**
1. Indicated quantities are to be used for contractor bids.
  2. #57 Limestone gravel may be substituted for Bentonite chips to the extent a substitution is preapproved by the SJRWMD in an abandonment permit.

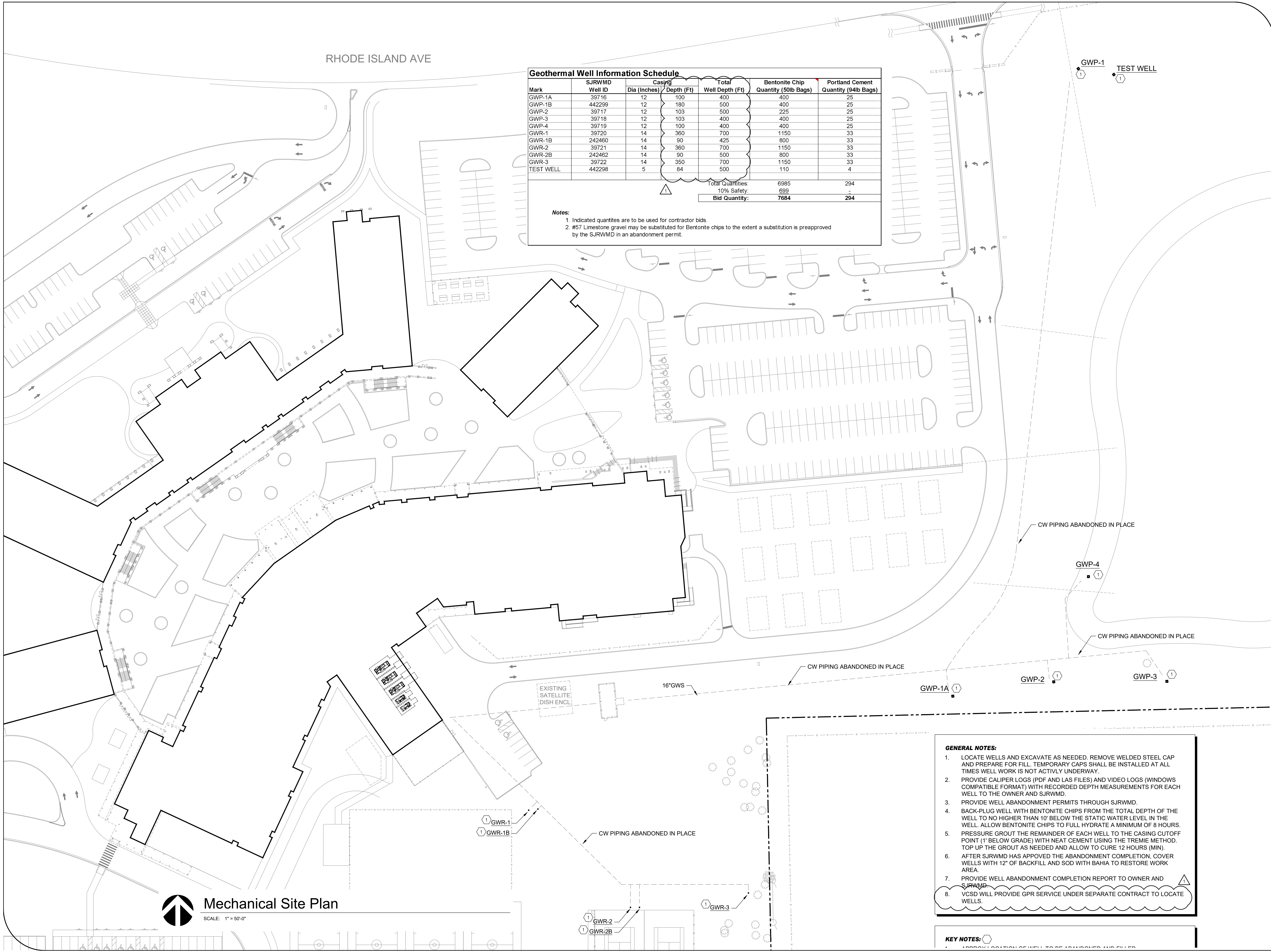

- GENERAL NOTES:**
1. LOCATE WELLS AND EXCAVATE AS NEEDED. REMOVE WELDED STEEL CAP AND PREPARE FOR FILL. TEMPORARY CAPS SHALL BE INSTALLED AT ALL TIMES WELL WORK IS NOT ACTIVELY UNDERWAY.
  2. PROVIDE CALIPER LOGS (PDF AND LAS FILES) AND VIDEO LOGS (WINDOWS COMPATIBLE FORMAT) WITH RECORDED DEPTH MEASUREMENTS FOR EACH WELL TO THE OWNER AND SJRWMD.
  3. PROVIDE WELL ABANDONMENT PERMITS THROUGH SJRWMD.
  4. BACK-PLUG WELL WITH BENTONITE CHIPS FROM THE TOTAL DEPTH OF THE WELL TO NO HIGHER THAN 10' BELOW THE STATIC WATER LEVEL IN THE WELL. ALLOW BENTONITE CHIPS TO FULL HYDRATE A MINIMUM OF 8 HOURS.
  5. PRESSURE GROUT THE REMAINDER OF EACH WELL TO THE CASING CUTOFF POINT (1' BELOW GRADE) WITH NEAT CEMENT USING THE TREMIE METHOD. TOP UP THE GROUT AS NEEDED AND ALLOW TO CURE 12 HOURS (MIN).
  6. AFTER SJRWMD HAS APPROVED THE ABANDONMENT COMPLETION, COVER WELLS WITH 12" OF BACKFILL AND SOD WITH BAHIA TO RESTORE WORK AREA.
  7. PROVIDE WELL ABANDONMENT COMPLETION REPORT TO OWNER AND SJRWMD.
  8. VCS WILL PROVIDE GPR SERVICE UNDER SEPARATE CONTRACT TO LOCATE WELLS.

**KEY NOTES:**

**Mechanical Site Plan**  
 SCALE: 1" = 50'-0"

SABISTON ENGINEERING GROUP, INC.  
 322 KENTUCKY AVENUE, SUITE 200  
 FT. LAUDERDALE, FL 33301  
 WWW.SABISTONENGINEERING.COM  
 STATE OF FLORIDA CERTIFICATE NO. 9811  
 SEB PROJECT NO. 23010

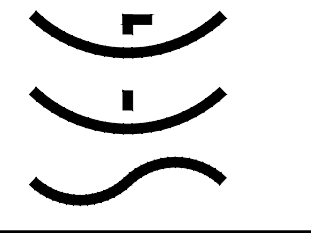

Donald J. Sabiston, P.E.  
 State of Florida No. 54889

**REVISIONS**

NO.	DATE	DESCRIPTION
1	11/16/2023	GENERAL REVISIONS

**UNIVERSITY HIGH**  
**SEAL ABANDONED WELLS**  
**VCS Project NO. 2448045**  
 1000 W RHODE ISLAND AVE,  
 ORANGE CITY, FL 32763

ARCHITECT OF RECORD  
 Engineer Donald J. Sabiston P.E.  
 DESIGNED BY DJS DRAWN BY DJS  
 ISSUE DATE 11/16/2023 AE PROJECT NUMBER SEG No. 23010  
 SHEET TITLE Mechanical Site Plan  
 DRAWING NO. M100