

OLD GOODRICH ROAD
Always exit here for pick-up & drop-off

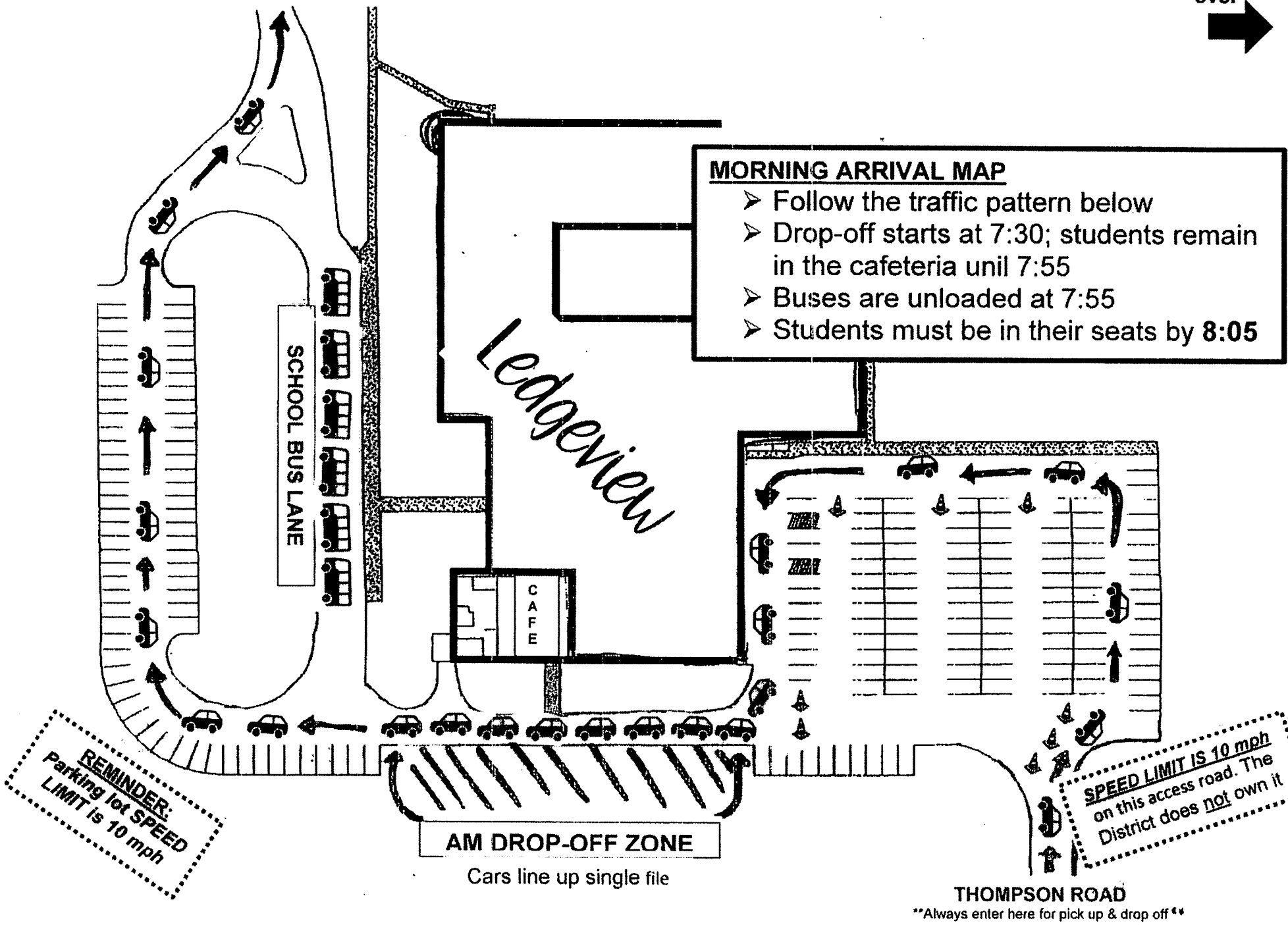

MORNING ARRIVAL MAP

- Follow the traffic pattern below
- Drop-off starts at 7:30; students remain in the cafeteria until 7:55
- Buses are unloaded at 7:55
- Students must be in their seats by 8:05

REMEMBER:
Parking lot SPEED
LIMIT is 10 mph

AM DROP-OFF ZONE

Cars line up single file

SPEED LIMIT IS 10 mph
on this access road. The
District does not own it

THOMPSON ROAD

Always enter here for pick up & drop off

OLD GOODRICH ROAD

Always exit here for pick-up & drop-off

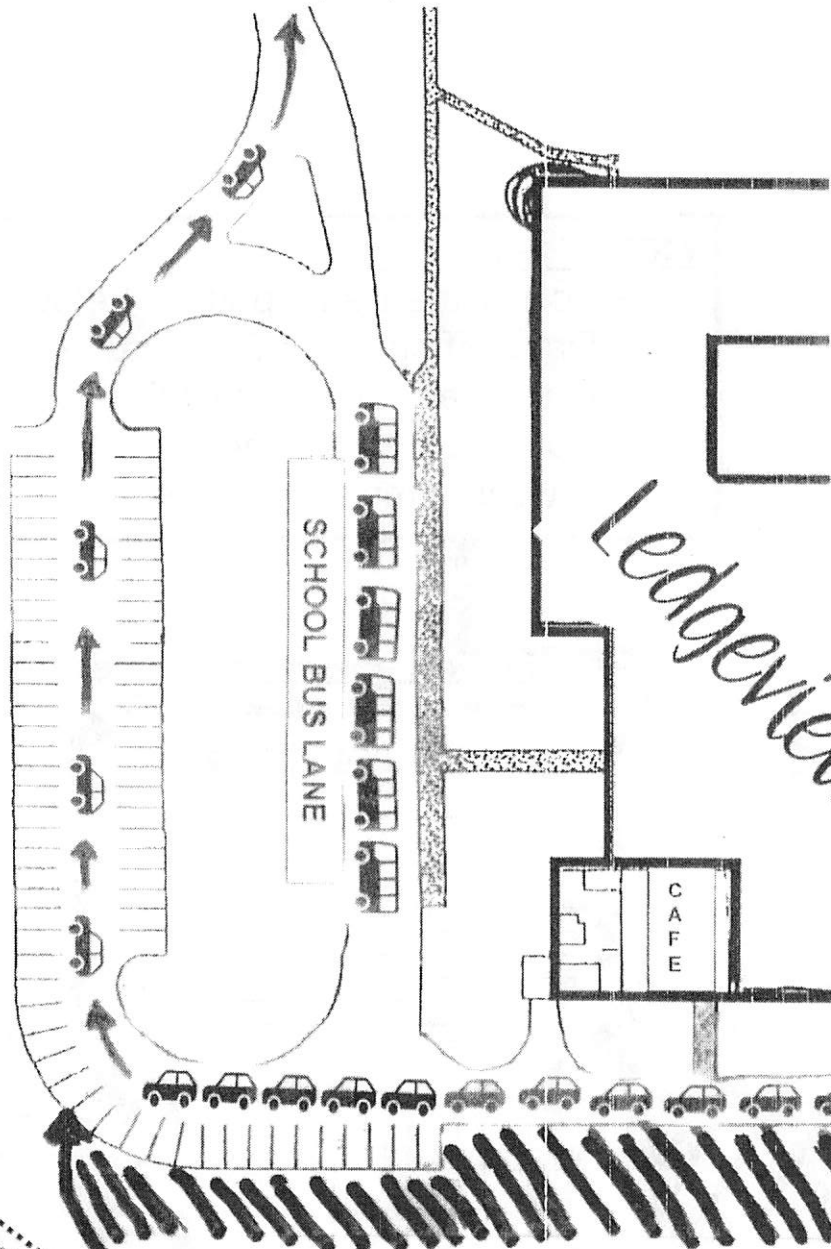

AFTERNOON DISMISSAL MAP

- Note that the traffic pattern for dismissal is a bit different
- Students getting picked up will be dismissed to the cafeteria at 2:22
- Shortly after, students will begin coming out to their designated vehicle
- Buses begin loading at 2:22

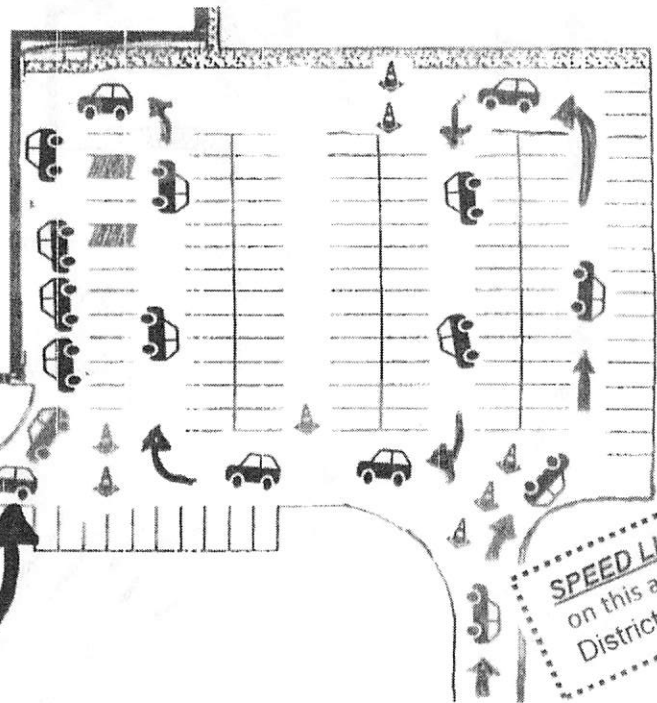

REMINDER:
Parking lot SPEED
LIMIT is 10 mph

PM PICK-UP ZONE
Cars line up single file

SPEED LIMIT IS 10 mph
on this access road. The
District does not own it

THOMPSON ROAD

**Always enter here for pick up & drop off