



Crabtree, Rohrbaugh & Associates

CONEWAGO VALLEY SCHOOL DISTRICT

Conewago Township ES &
New Oxford ES

Project Update
April 1, 2024

AGENDA

1 Project Update

2 School Tours

3 Schematic Design

4 Next Steps



PROJECT UPDATE

Project Status Report

PROJECT UPDATE

1. Finalize Schematic Design layouts - **completed**
2. Civil Engineering due diligence: Traffic study, Geotech, Zoning requirements – **on-going**
3. MEP Basis of Design scope of work - **completed**
4. Building tours – Penn Manor SD, Cumberland Valley SD & Mechanicsburg SD - **completed**
5. Expand Design Professional Team: MEP & Structural Engineers, Food Service Consultant - **on-going**



SCHOOL TOURS

Members of Admin team visited local schools



Winding Creek Elementary School
Cumberland Valley SD









Broad Street Elementary School
Mechanicsburg Area SD









A wide-angle photograph of the exterior of Hambright Elementary School. The building features a prominent white overhang with a wooden slat ceiling and large glass windows. The name 'HAMBRIGHT ELEMENTARY SCHOOL' is displayed in large, dark, sans-serif capital letters on the white overhang. Below the overhang, the building has a brick base and more windows. A group of children, mostly girls, are walking on a wide, light-colored concrete sidewalk in front of the school. They are dressed in casual clothing like t-shirts and jeans. The scene is set on a clear, sunny day with a bright blue sky. The shadows of the children and the building are cast onto the sidewalk. In the background, a long, single-story brick building with several windows is visible, along with a grassy area and a street lamp.

HAMBRIGHT ELEMENTARY SCHOOL

Hambright Elementary School
Penn Manor SD — Lancaster, Pa









SCHEMATIC DESIGN

Update on Design

CTE – SITE PLAN

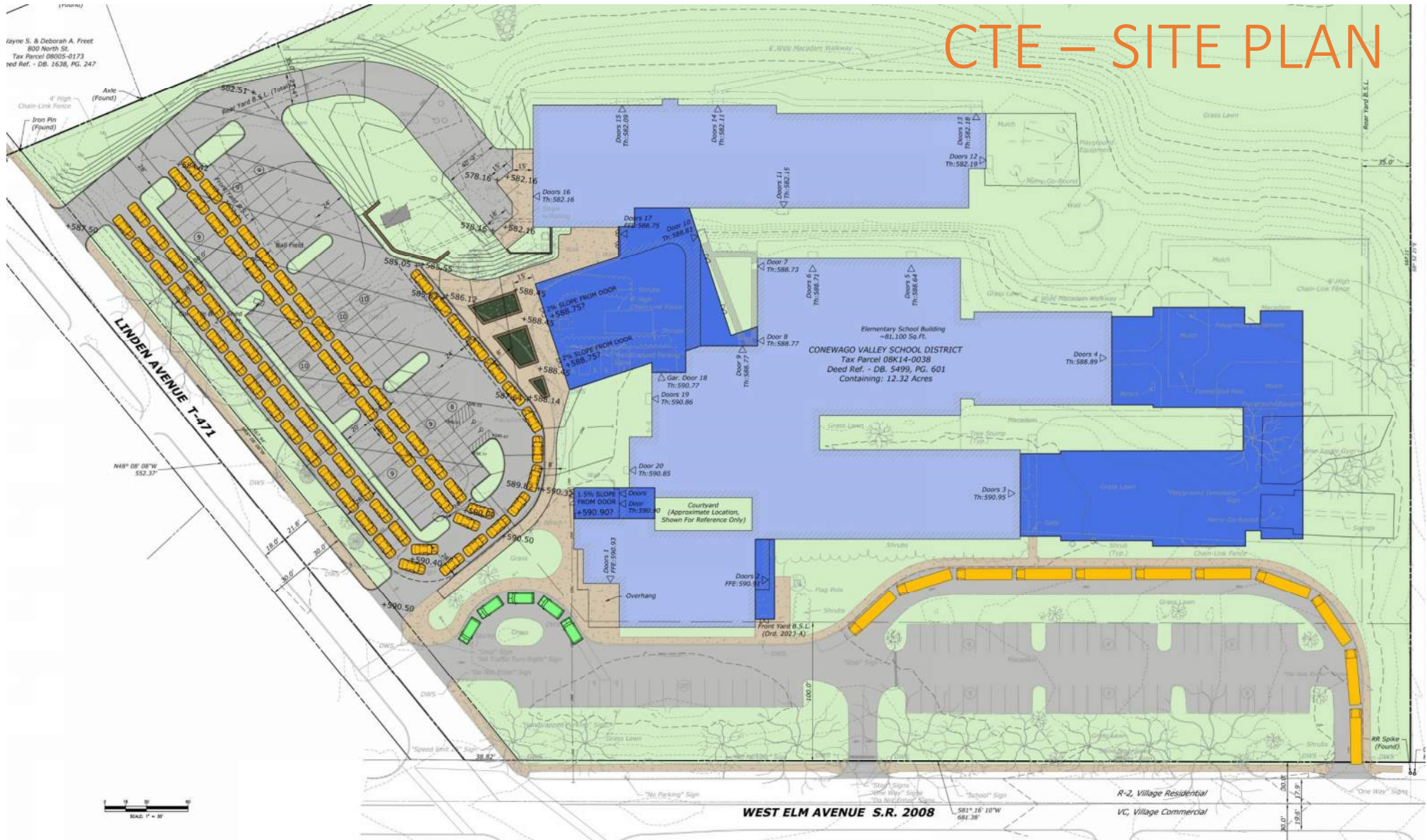

CTE – FLOOR PLAN

Floor Plan

- General Classrooms
- Special Education
- Small Group Instruction
- Music
- Art
- Library/Cafeteria/Gymnasium
- Faculty
- Building Support

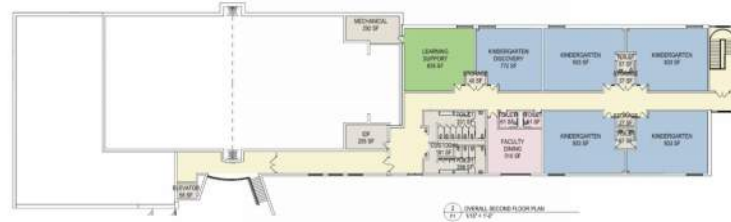

NOE – SITE PLAN PREVIOUS CONCEPT

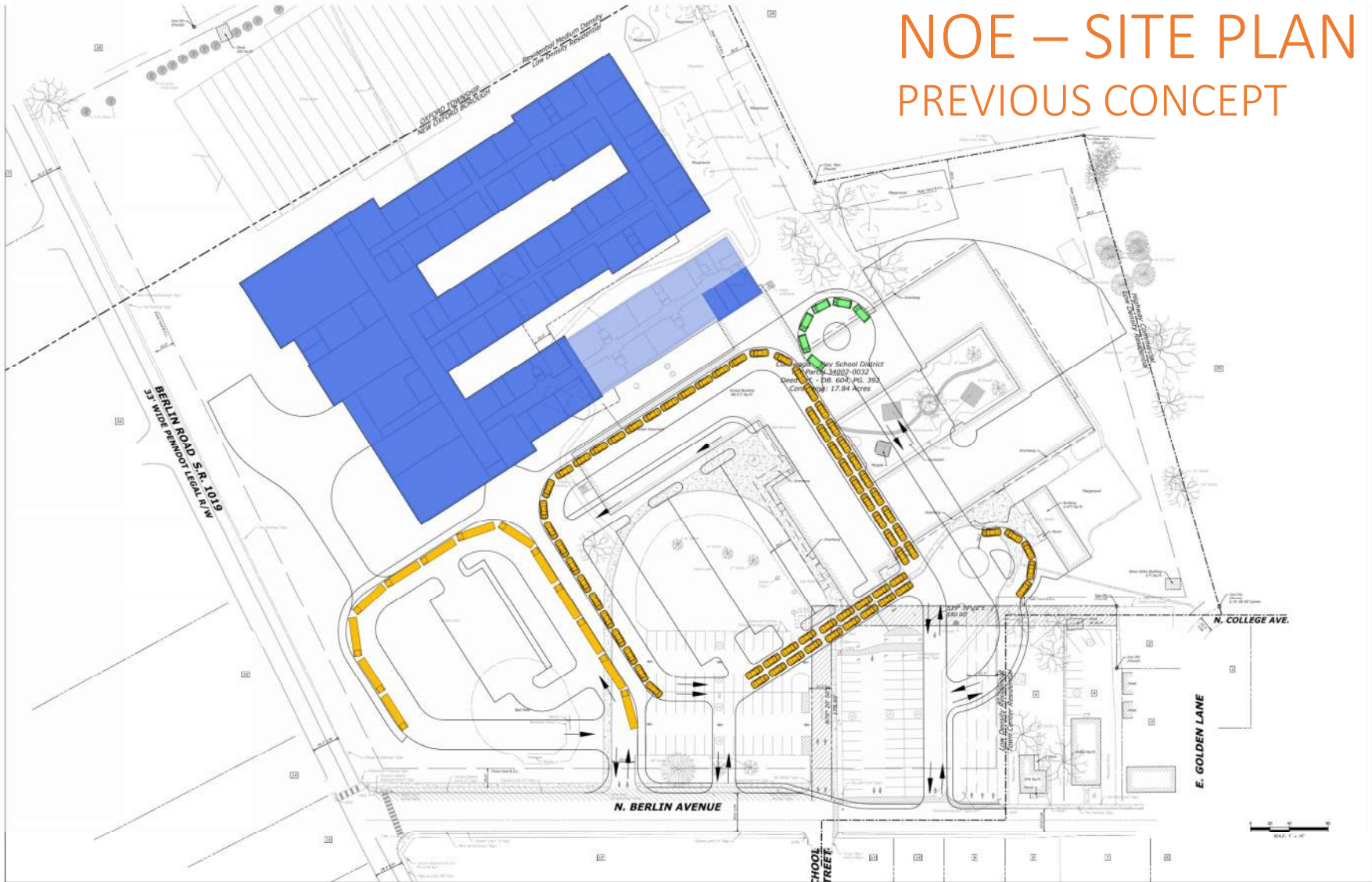

The second floor plan includes the following rooms and their areas:

- Gymnasium:** 820 SF
- Storage:** 326 SF
- Stage:** 1274 SF
- Toilet:** 797 SF
- Cafeteria:** 4334 SF
- Kitchen Mech:** 2831 SF
- Faculty Dining:** 972 SF
- Media:** 3289 SF
- Admin Nurse/Glad:** 4528 SF
- Mech:** 1280 SF
- 3rd Grade:** 883 SF (multiple rooms)
- Learning Support:** 883 SF
- 2nd Grade:** 888 SF (multiple rooms)
- IPC:** 452 SF
- Storage:** 425 SF
- CLA:** 884 SF
- IPC:** 429 SF
- Storage:** 425 SF
- 1st Grade:** 883 SF (multiple rooms)
- Toilet:** 883 SF
- Art Reading:** 427 SF
- 2nd Grade:** 843 SF
- 3rd Grade:** 843 SF
- ELL:** 441 SF
- Art Reading:** 427 SF
- 1st Grade:** 883 SF
- Learning Support:** 874 SF
- 1st Grade:** 883 SF
- 1st Grade:** 883 SF
- Autistic Support:** 883 SF
- PAC TLT:** 78 SF
- Toilet:** 48 SF
- Autistic Support:** 886 SF
- Breakery:** 88 SF
- CLIA:** 983 SF
- Emotional Support:** 783 SF
- Speech:** 376 SF
- Kindergarten:** 775 SF
- Toilet:** 87 SF
- Kindergarten:** 819 SF
- Kindergarten:** 838 SF
- Kindergarten:** 848 SF
- MEG:** 883 SF
- Chinning:** 83 SF
- LIFE SKILLS:** 797 SF
- Toilet:** 270 SF
- Toilet:** 88 SF
- IPC:** 423 SF
- Storage:** 188 SF
- ART:** 1420 SF
- Gifted:** 453 SF
- Kindergarten:** 734 SF
- Kindergarten:** 842 SF
- Kindergarten:** 848 SF
- Kindergarten:** 852 SF
- Kindergarten:** 847 SF
- Art Reading:** 395 SF
- Kindergarten:** 847 SF

[illegible]

NOE – FLOOR PLAN

Floor Plan

- General Classrooms
- Special Education
- Small Group Instruction
- Music
- Art
- Library/Cafeteria/Gymnasium
- Faculty
- Building Support

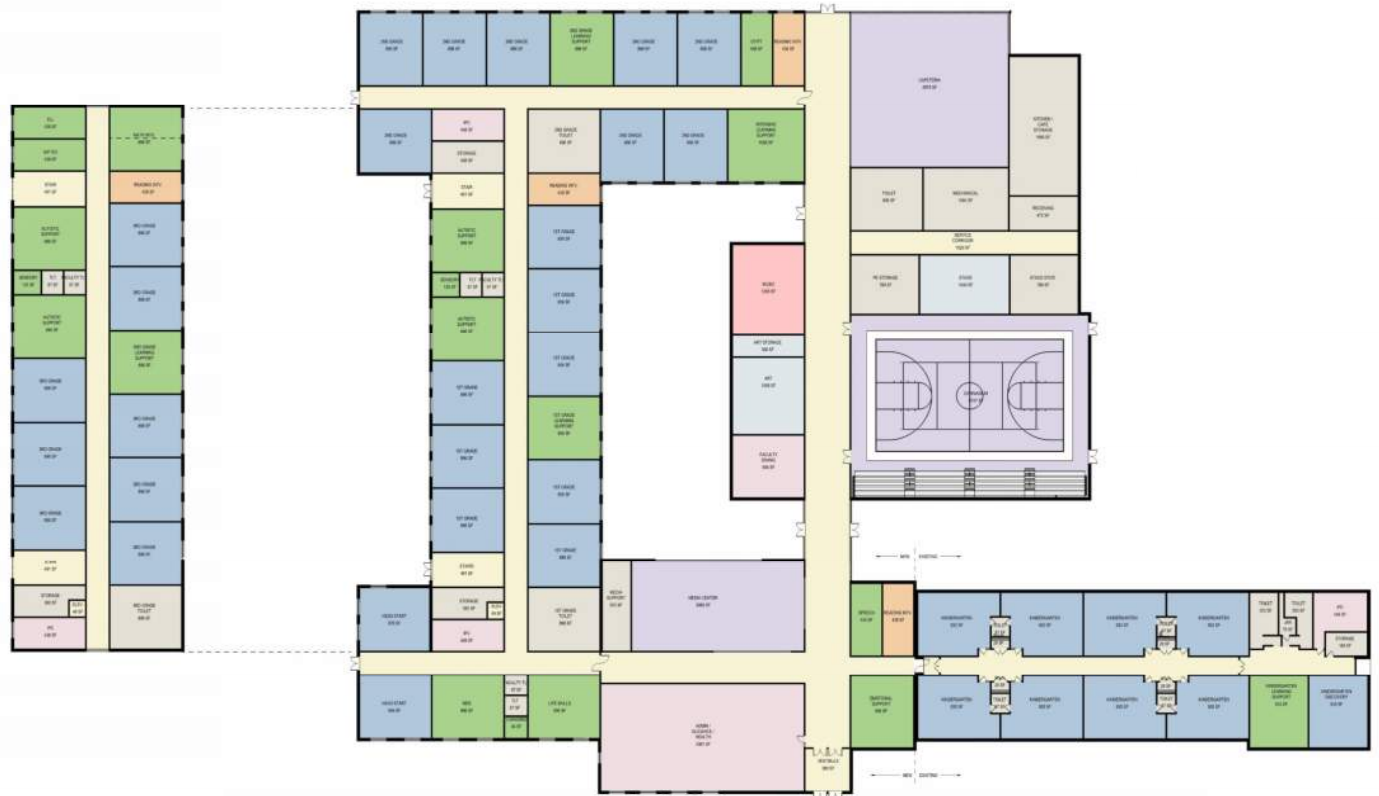

NOE - Overall Second Floor Plan
11/17/17

NOE - Overall First Floor Plan
11/17/17



NEXT STEPS

Upcoming Tasks

NEXT STEPS

1. Civil Engineering due diligence: Traffic study, Geotech, Zoning requirements – on-going
2. Determine Municipal Approval timeline to determine Project Schedule
3. Expand Design Professional Team: Structural Engineers & Food Service Consultant - on-going
4. Visual Listening Exercise with faculty and students – on-going

Questions?



Crabtree, Rohrbaugh & Associates
www.cra-architects.com