

# Nick H. Barnard Architect LLC

697 W. 175 N., BLACKFOOT, ID 83221

E-MAIL: nhb63@outlook.com

TEL: 208.242.6564

**ADDENDUM NO. TWO**

**TO: Bidders**

**DATE: March 20, 2024**

**RE: Highland High School  
Athletic Field Facility  
1800 Bench Road  
Pocatello, Idaho**

This Addendum forms a part of the Contract Documents and modifies the original Bidding Drawings dated **February 2024**, as noted below. Acknowledge receipt of this Addendum in the space provided on the Bid Form. Failure to do so may subject the Bidder to disqualification. The following information is being issued to General Contractors only. It is the obligation of the Contractor to notify his Subcontractors and suppliers of items relating to their bids prior to bid opening. This Addendum consists of 4 page(s) and no drawing(s).

**I - CHANGES TO PRIOR ADDENDA: NONE**

**II - CHANGES TO BIDDING REQUIREMENTS: NONE**

**III - CHANGES TO CONDITIONS OF THE CONTRACT:**

**Item III-1.** Supplementary Conditions, Article 3.5. Add the following: 3.5.2. Unless otherwise directed in specific sections of the contract documents, warranty shall be a minimum of twelve (12) months from date of substantial completion.

**IV - CHANGES TO AGREEMENT & OTHER CONTRACT FORMS: NONE**

**V - CHANGES TO SPECIFICATIONS:**

**Item V-1.** Section 07 6113, Article 2.1, B, 2. Add Berridge Double-Z Lock to approved systems.

**Item V-2.** Section 07 4619, Article 2.1, E. Add Berridge L-Panel.

**VI - CHANGES TO DRAWINGS:**

**Item VI-1.** Sheet SD1.1. Change length of new work (Detail D & E/SD2.1) from 120'-6" +/- to 126' +/- .

**Item VI-2.** Sheet SD1.1. The 126' +/- new work includes grinding down the existing metal post stubs along the existing concrete retaining wall prior to installing new work. The new chain link fence posts shall be anchored to the new concrete walk (Detail E/SD2.1) with 6"x6"x1/4" steel plate with 4" minimum embedded anchor bolts. Post welded to base plate.

**Item VI-3.** Sheet SD2.2, Detail A. New metal grate and catch basin shall be replaced with 10 LF of trench drain such as ABT Drain Channel with #412 Galvanized steel grate (704-528-9806), or EZ-Track trench drain by NDS (800-726-1994). See 2 pages attached. Connect to existing catch basin with 6" pipe as shown.

**Item VI-4.** Sheet A1.1S. Add roof notes 1 & 2 from sheet A4.1.

**Item VI-5.** Sheet C-2.0. The water line stub out is located a few feet to the West of the existing sewer clean out shown at the rear of the building.

**Item VI-6.** Sheet SD1.1. Item V1-6, Addendum 1 indicates location of new underground power line. The power line will cross the existing water and sewer line. Contractor to take proper precautions at the utility crossings.

**Item VI-7.** Sheet A7.1. Shower rod and curtain at showers by owner.

**Item VI-8.** Sheet A7.1, Detail Q. HDPE bench shall be 1 1/4" x 9 1/2" solid color type by Scranton Products (800-445-5148).

**END of ADDENDUM**

The Pre-bid Conference attendance sign-in sheet is attached to this document. Project Bids will be received from the General Contractors who attended the mandatory Pre-bid Conference as advertised.

Name of School: Highland High School

Date: 3/20/2024

Purpose of Walk-Through: Athletic Facility

| Name            | Title          | Company Name         | Phone        | Fax | E-Mail Address                         |
|-----------------|----------------|----------------------|--------------|-----|--|
| ROD SAUNDERSOON | owner          | SAUNDERSOON Elect.   | 221-8982     |     | SAUNDERSOON Electric @ GMAIL           |
| Mike Mullins    | owner          | MS Development       | 208-247-6889 |     | MSdevelopmentconstruction@gmail.com    |
| William White   | superintendent | Anderson             | 208-957-9752 |     | WWhite@Anderson-Const.com              |
| LENNIE PINCOCK  | owner          | Westlin Fence        | 208-680-1444 |     | WESTLIN FENCE @ yahoo.com              |
| GARRETT GARADE  | PM             | CM CO                | 208-220-6341 |     | GARRETT@CMCOMPANY.COM                  |
| Matt Vitano     | Estimator      | CM Co                | 208-384-0300 |     | matv@cmcompany.com                     |
| ROB FRASER      | PM             | FRASER               | 208-869-9524 |     | robfr@faberconstruction.com            |
| MASON LEWIS     | Estimator      | Lewis Corp           | 208-235-1202 |     | mason@Lcorp.com                        |
| Ryan Judge      | PM             | EKC INC.             | 208-995-6285 |     | RyanJudge@EKCCONSTRUCTION.COM          |
| Derek Fynn      | PM             | ESI                  | 208-881-2940 |     | DerekFynn@ESICONSTRUCTION.COM          |
| Mike Santos     | Superintendent | ALM                  | 208-716-0929 |     | MSantos@buildwithalm.com               |
| Garin Speegle   | PE             | ESI                  | 208-972-1483 |     | garinspeegle@jesiconstruction.com      |
| Scott Sweet     | Estimator      | Petersen Bros        | 208-613-9096 |     | Bids@PBCBuilds.com/Scott@PBCBuilds.com |
| Eric Turner     | owner          | Mechanical Solutions | 208-242-8390 |     | Eric@MechSolutions.co                  |
| TOM ROBISON     |                | Robison Roofing      | 208-785-4600 |     | tom@robisonroofing.com                 |
|                 |                |                      |              |     |  |
|                 |                |                      |              |     |  |
|                 |                |                      |              |     |  |
|                 |                |                      |              |     |  |
|                 |                |                      |              |     |  |



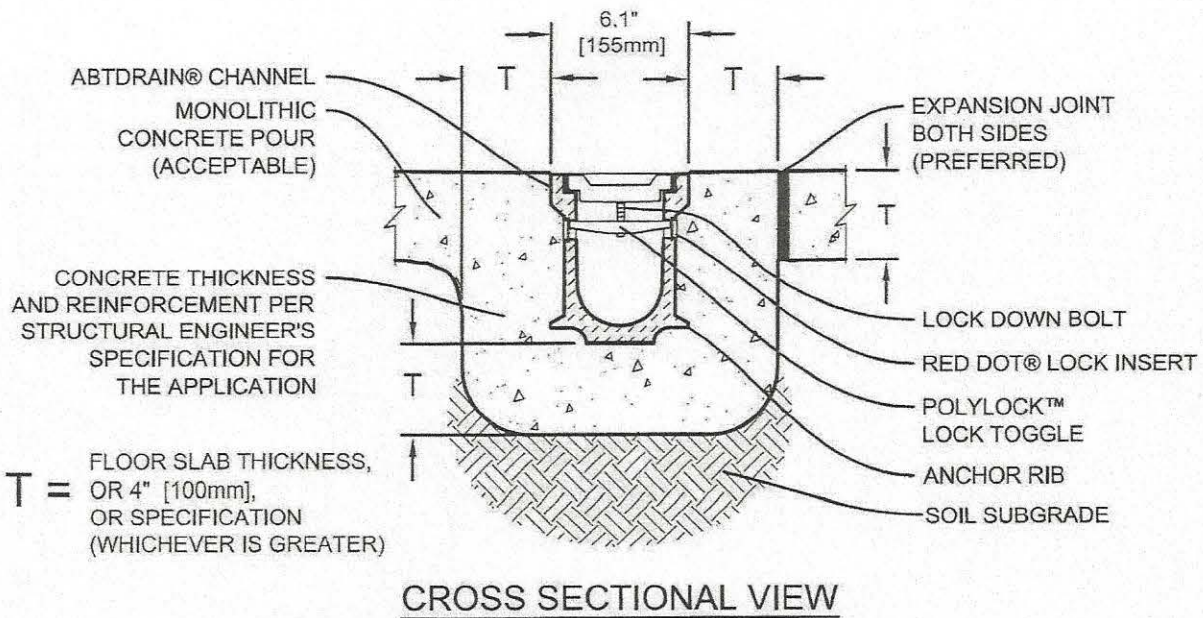
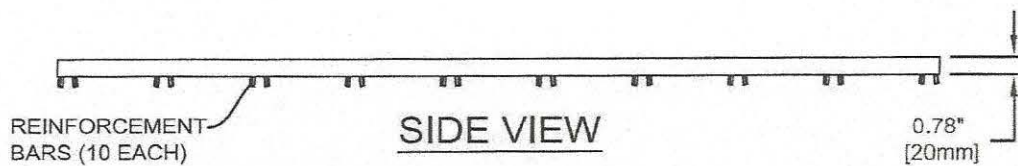
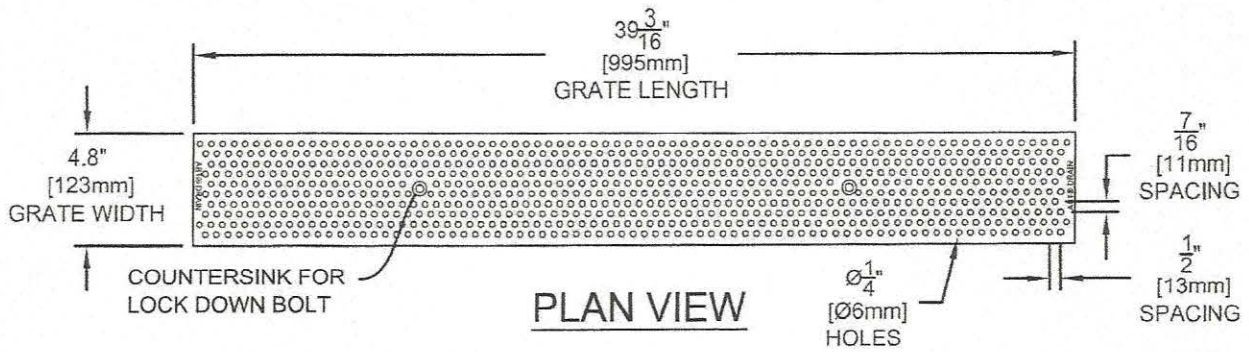

**ABT, INC.**

P.O. BOX 837, 259 MURDOCK ROAD  
TROUTMAN, NC 28166  
(704) 528-9806

SPECIFICATION DRAWING ©2005 ABT, Inc.  
**INLAY GRATE - REINFORCED  
PERFORATED GALVANIZED STEEL**

FILE: **S-2412-01**

PART: **2412**

Proprietary rights of ABT, Inc. are included in the information disclosed herein. The recipient, by accepting this document, agrees that neither this document nor the information disclosed herein nor any part thereof shall be copied, reproduced or transferred to others for manufacturing or for any other purpose except as specifically authorized in writing by ABT, Inc.

**DISCLAIMER:** The customer and the customer's architects, engineers, consultants and other professionals are completely responsible for the selection, installation, and maintenance of any product purchased from ABT, and EXCEPT AS EXPRESSLY PROVIDED IN ABT'S STANDARD WARRANTIES, ABT MAKES NO WARRANTY, EXPRESS OR IMPLIED, AS TO THE SUITABILITY, DESIGN, MERCHANTABILITY, OR FITNESS OF THE PRODUCT FOR CUSTOMER'S APPLICATION. Copies of ABT's standard warranties are available upon request.



## LOAD CLASS INSTALLATION

Note: For all load class installations recess Dura Slope below grade: 1/4" for vehicular traffic, 1/8" for pedestrian traffic. When using iron frame DS-200 no additional recess is needed.

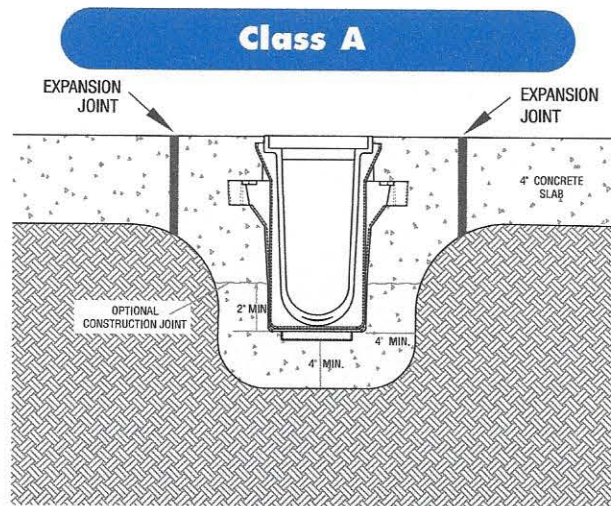

Set trench drain in channel surrounded by 4" of concrete or thickness of the concrete slab with a minimum of 2,500 psi.

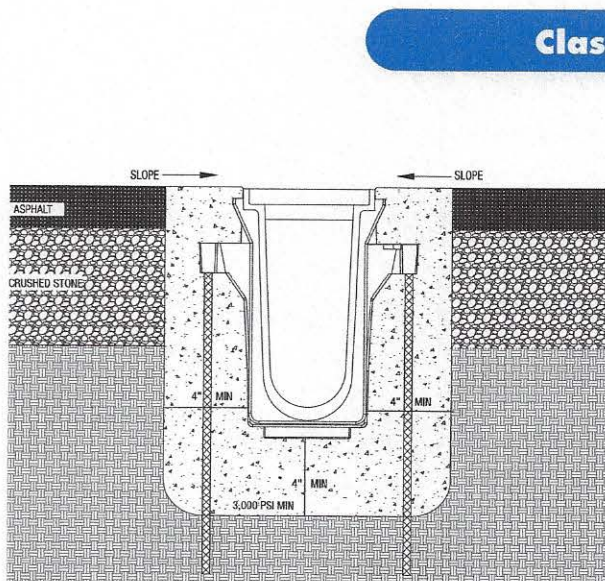

Set trench drain in channel surrounded by 4" of concrete with a minimum of 3,000 psi. Install #4 re-bar to stabilize drain while concrete is being poured. Make sure re-bar is 1" below finished surface.

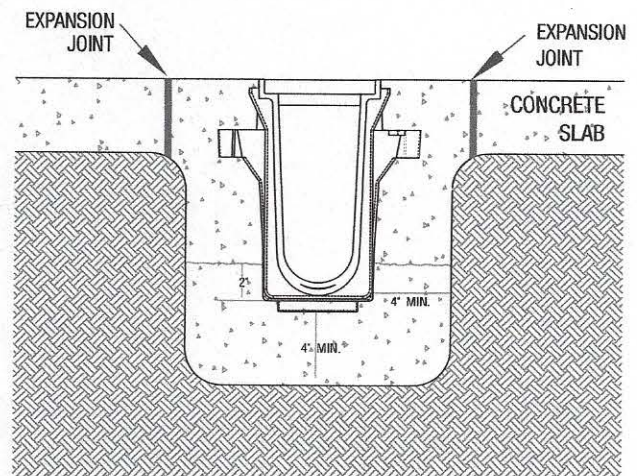

Set trench drain in channel surrounded by 4" of concrete or thickness of the concrete slab with a minimum of 3,000 psi.