

Bridge View Elementary School

360 Colborne Street

Project Summary:

At Bridge View, our students don't face barriers, just challenges that can be overcome. We serve students with severe developmental disabilities from early childhood to high school. Our one-story building offers a therapeutic pool and gymnasium that help build skills for independence. We also believe that outdoor play is an important part of school for our students.

It was originally constructed in 1973 at 46,471 square feet. Later additions were completed in 1974. It is now 49,392 square feet.

Issues Identified By School Community In 2015

1. Size Walls and Doors Appropriately
2. Accessible Environments, Restrooms, and Doors
3. Storage Equipment
4. Shared Performance Space
5. Welcoming and Secure Entry and Office with Health
6. Quiet Flexible Space
7. Shared Library
8. Update Interiors
9. Technology Integration Ceiling Mount
10. Building Connect through Visual Technology

General Notes:

Existing utilization shown is for School Year 2014-2015

The Conceptual Utilization Plans are exploratory rather than actual construction plans and represent the design at one moment in time, which will change as the design and funding process progresses.

The Conceptual Plans are included as a way to organize scopes of work into logical, efficient and meaningful projects. There is no prioritization implied in a work scope title (e.g. "Work Scope A" is not necessarily the most critical work to be done).

The plans in this document are not comprehensive of the entire building's needs as maintenance and replacement of existing building systems such as roofs and mechanical systems are omitted to maintain graphic clarity of the overall vision generated during the Facilities Master Plan Process.

Formal zoning reviews have not been undertaken for the proposed work shown in these plans. A review with zoning and building code authorities will occur once the funding is secured.



Grade Levels:
SY 2014/15 Enrollment:
Design Enrollment:

Bridge View Site Concept

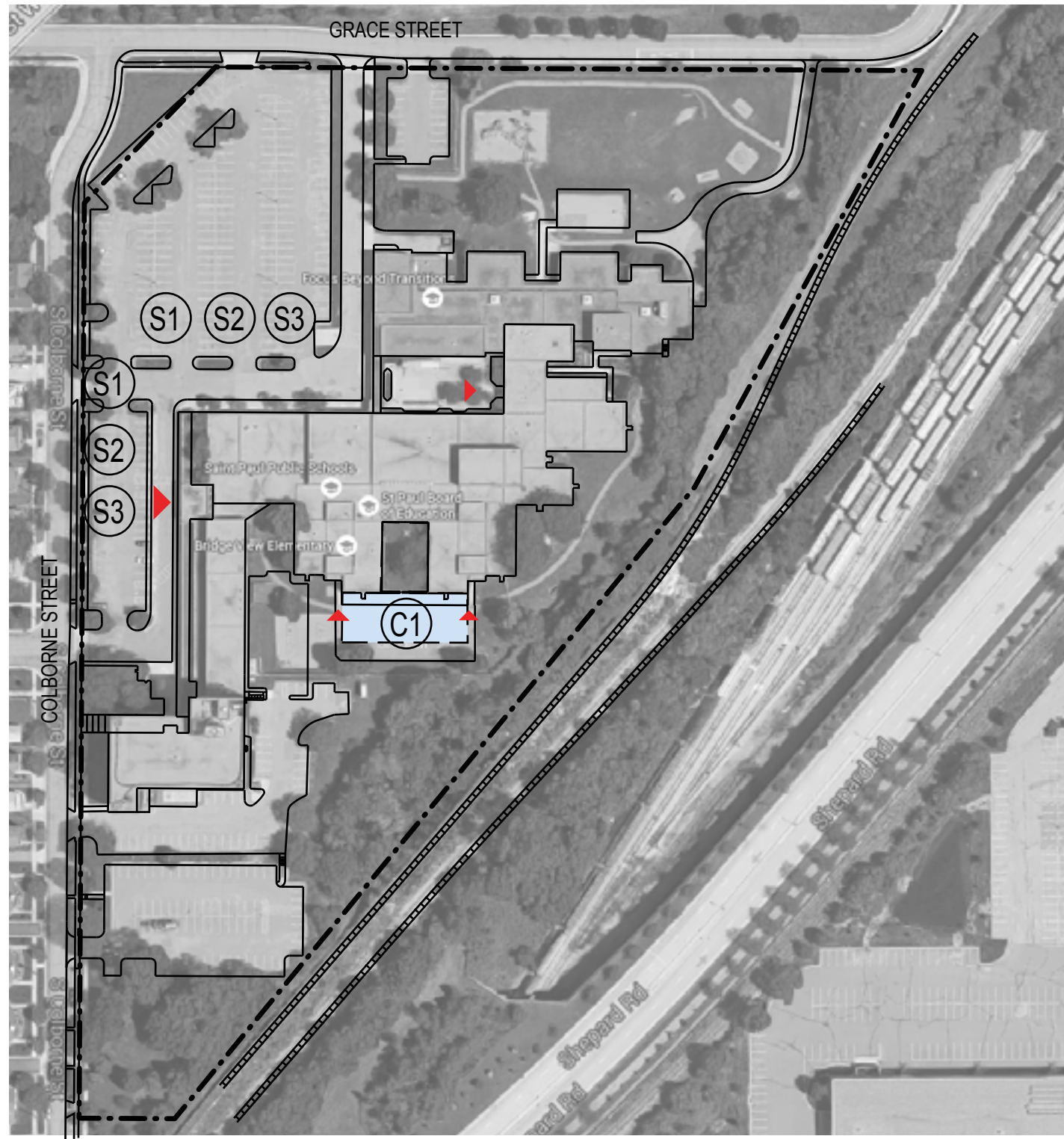

Legend:

- S1. Provide Clear Identifiable Entry with New Signage
- S2. Improve Bus Drop Off Area for Both Programs
- S3. Provide Safe and Secure Entry
- C1. Classroom Expansion

- Property Line
- ▲ Main Entry
- ▲ Secondary Entry
- ▲ Service Entry

- New Landscape and Playground
- Parking and Hardscape
- New Building Construction

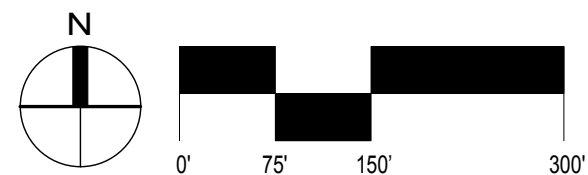

Bridge View

Existing Utilization

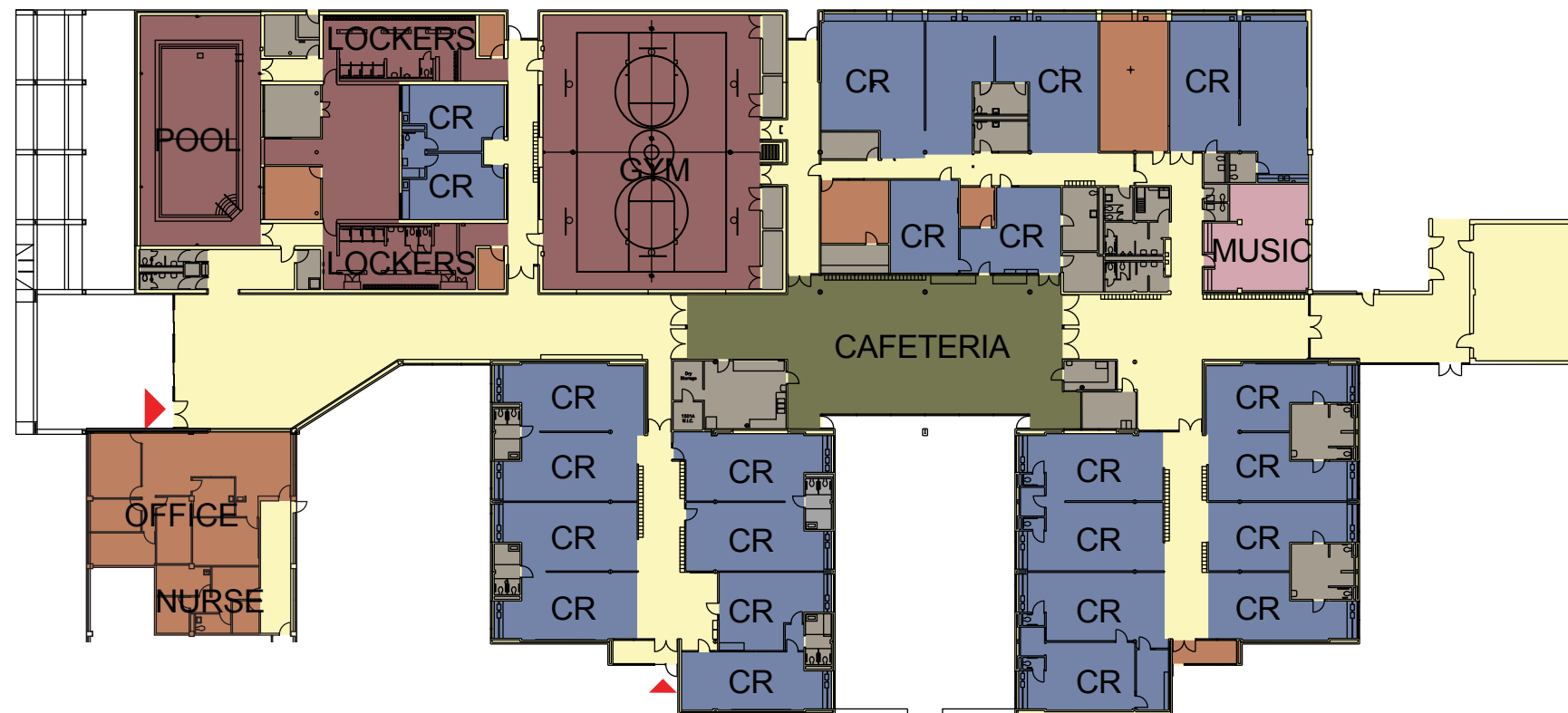

- General Learning
- Science
- Performing Arts
- Career & Tech Education
- Media Center
- Dining
- Athletics
- Circulation
- Facilities Support
- Administration
- Art

- ▲ Main Entry
- ▲ Secondary Entry
- ▲ Service Entry

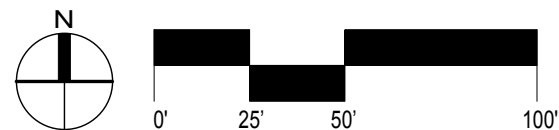



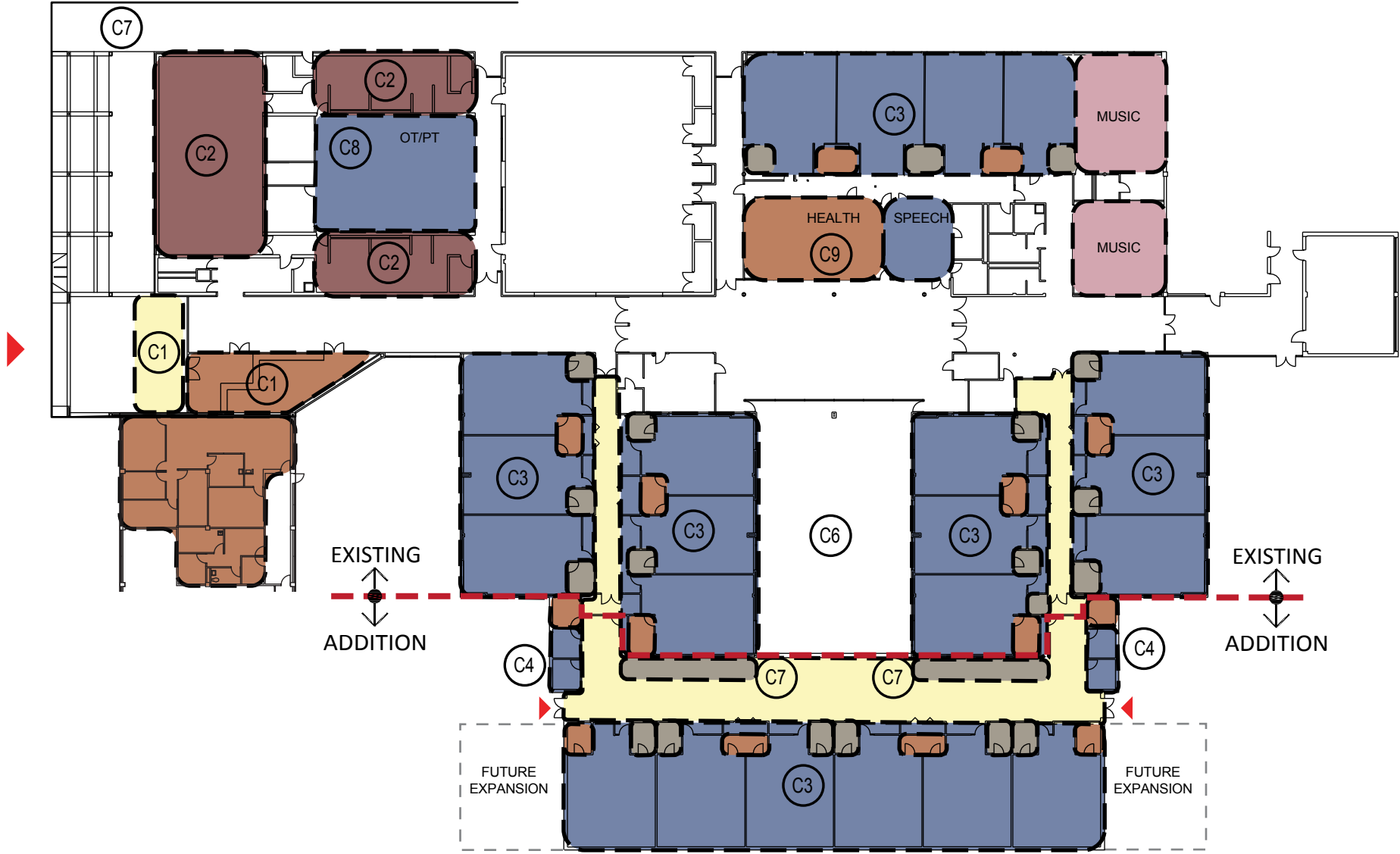











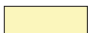

Bridge View Conceptual Utilization Plan



Legend:

- C1. Create New Safe and Secure Entry with New Vestibule and Administrative Office
- C2. Update Pool and Locker Room Furnishings
- C3. Renovate/Add Specialized Learning Areas with:
 - Walls and Doors
 - Appropriate Changing and Restroom Facilities
 - Enclosed Staff Space with Full View of Classroom
- C4. Small Group Individual Learning and Sensory Space
- C5. Staff Resource Space
- C6. Outdoor Learning Space
- C7. Additional Storage
- C8. Renovate to Expand OT/PT
- C9. New Health Office Adjacent to Student Learning

	General Learning
	Science
	Performing Arts
	Career & Tech Education
	Media Center
	Dining
	Athletics
	Circulation
	Facilities Support
	Administration
	Art

	Demolition/Removal
	New/Existing
	Property Line
	Main Entry
	Secondary Entry
	Service Entry

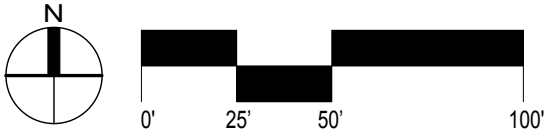

Bridge View

Conceptual Construction Plan

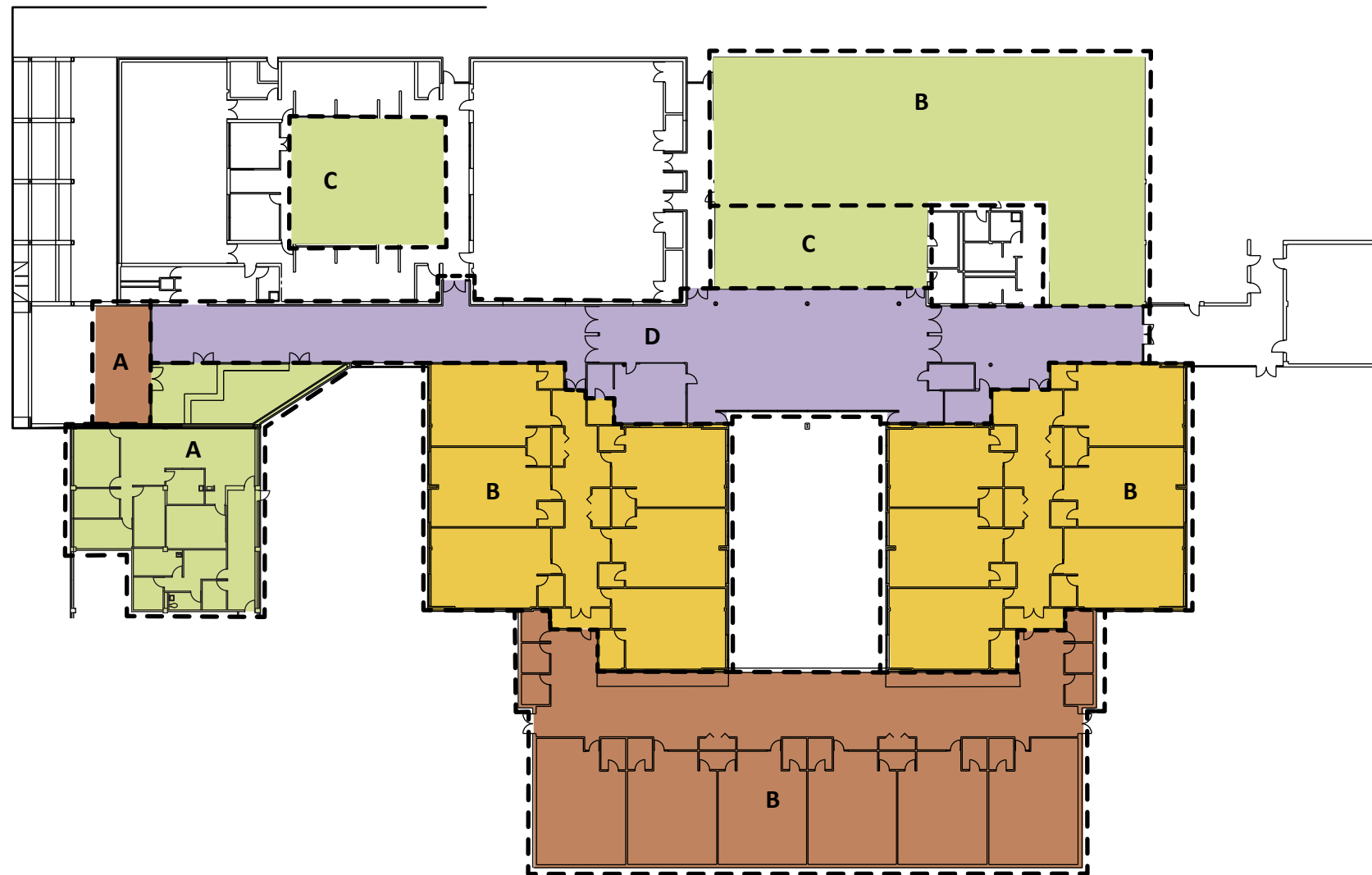

Scope Package	New Construction	Heavy Remodel	Medium Remodel	Light Remodel	Finishes Only
A	625 SF		3,925 SF		
B	10,850 SF	14,000 SF	6,700 SF		
C			3,500 SF		
D					7,000 SF
TOTAL	11,475 SF	14,000 SF	14,125 SF		7,000 SF

Line Items	New Construction	Heavy Remodel	Medium Remodel	Light Remodel	Finishes Only

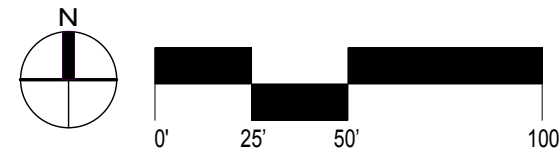

-  Demolition/Removal
-  New/Existing
-  New Construction
-  Heavy Remodel
-  Medium Remodel
-  Light Remodel
-  Finishes Only
-  No Work