

AGAPE

1037 University Avenue

Project Summary:

AGAPE High School offers a complete high school education for pregnant or parenting teens. Students can concentrate on school while their child visits the on-site Health Start clinic or childcare center. We also provide additional services to help students address barriers that may affect their educational success.

It was originally constructed as a commercial building in 1936 at 20,100 square feet. Later additions were completed in 1965 and 2011. It is now 24,883 square feet.

Issues Identified By School Community In 2015

1. Film on windows
2. More security cameras
3. Full kitchen for more lunch options
4. Facility storage (TBD)
5. Office space (TBD)
6. Personal instructional space (TBD)
7. Gym
8. Assembly area auditorium
9. Green space for students
10. Outdoor recreation space



Grade Levels:	ALC (9-12)
SY 2014/15 Enrollment:	XXXXX
Design Enrollment:	XXXXX

General Notes:

Existing utilization shown is for School Year 2014-2015

The Conceptual Utilization Plans are exploratory rather than actual construction plans and represent the design at one moment in time, which will change as the design and funding process progress.

The Conceptual Plans are included as a way to organize scopes of work into logical, efficient and meaningful projects. There is no prioritization implied in a work scope title (e.g. "Work Scope A" is not necessarily the most critical work to be done).

The plans in this document are not comprehensive of the entire building's needs as maintenance and replacement of existing building systems such as roofs and mechanical systems are omitted to maintain graphic clarity of the overall vision generated during the Facilities Master Plan Process.

Formal zoning reviews have not been undertaken for the proposed work shown in these plans. A review with zoning and building code authorities will occur once the funding is secured.

AGAPE

Site Concept

Legend:

- S1. Relocate existing mechanical system to roof of new addition (0 SF)
- S2. Cafeteria / fitness center addition (2,740 SF)
- S3. Outdoor recreation area (2,800 SF)
- S4. New landscape buffer at University (2,640 SF)

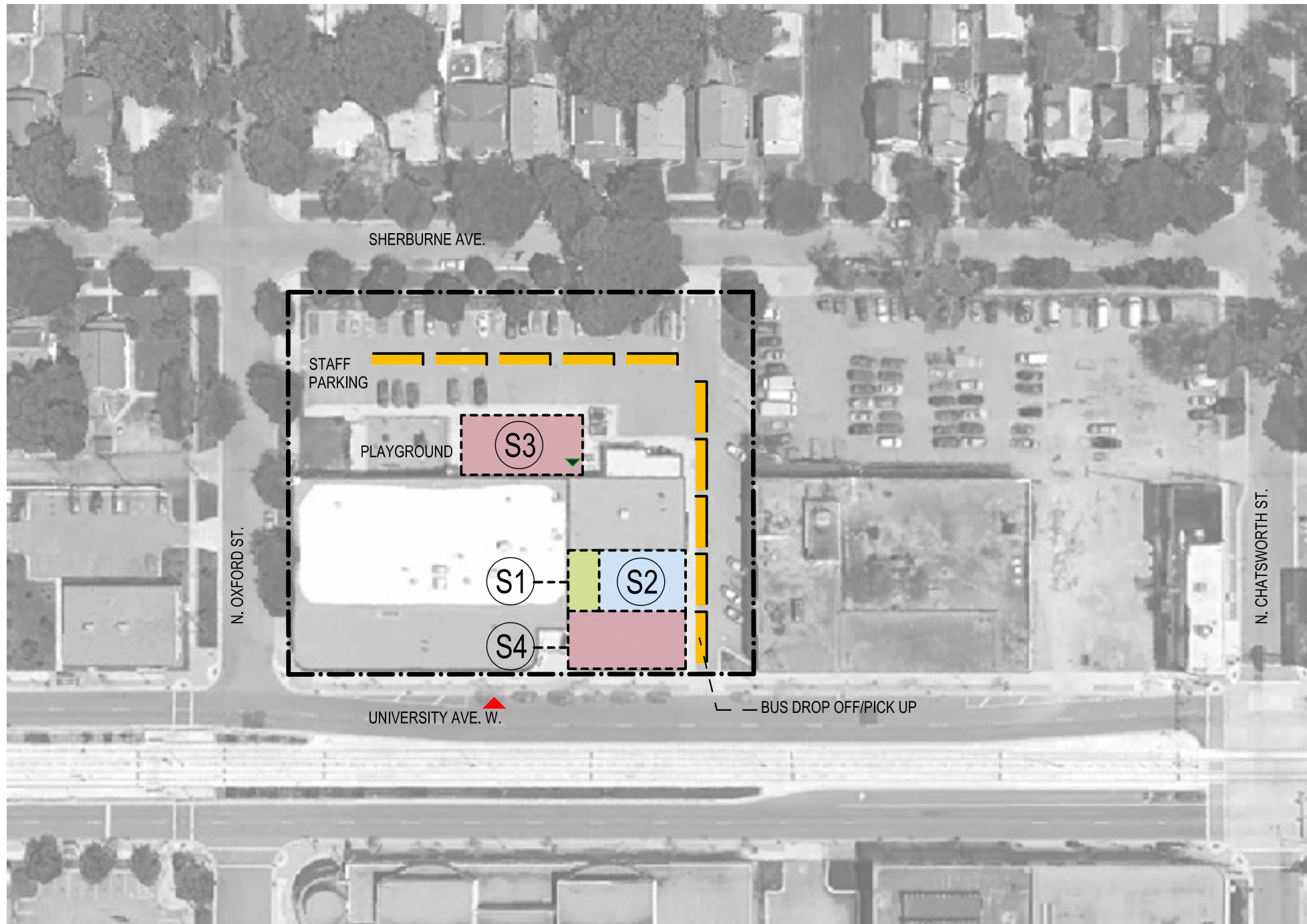

- Property Line
- ▲ Main Entry
- ▲ Secondary Entry
- ▲ Service Entry

- Alterations
- New Landscape Construction
- New Building Construction

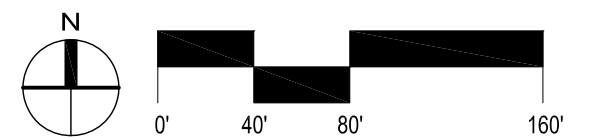

AGAPE

Existing Utilization

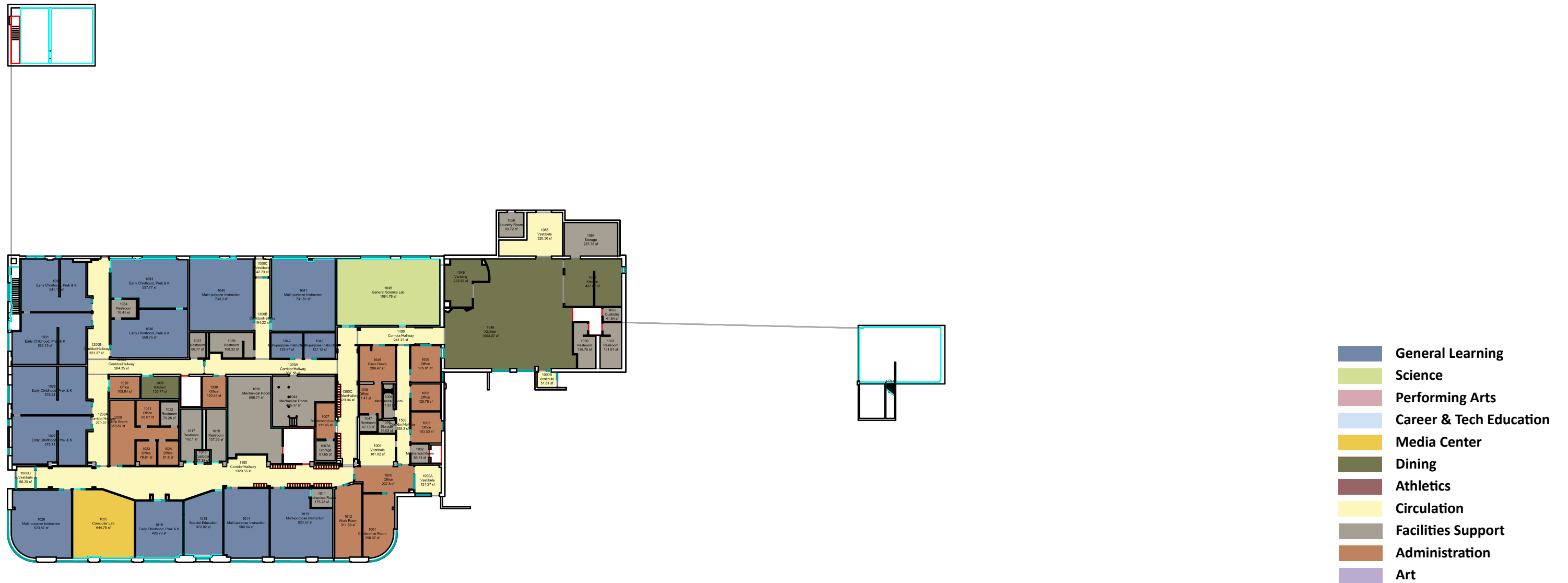

FIRST FLOOR

AGAPE

Conceptual Utilization Plan

Legend:

C1.	New conference and work room	(712 SF)
C2.	New health clinic closer to Main Entry	(615 SF)
C3.	Renovate Main Entry with better security	(232 SF)
C4.	Expand Cafeteria/Assembly space	(1,708 SF)
C5.	Upgrade kitchen	(432 SF)
C6.	Fitness center addition	(1032 SF)

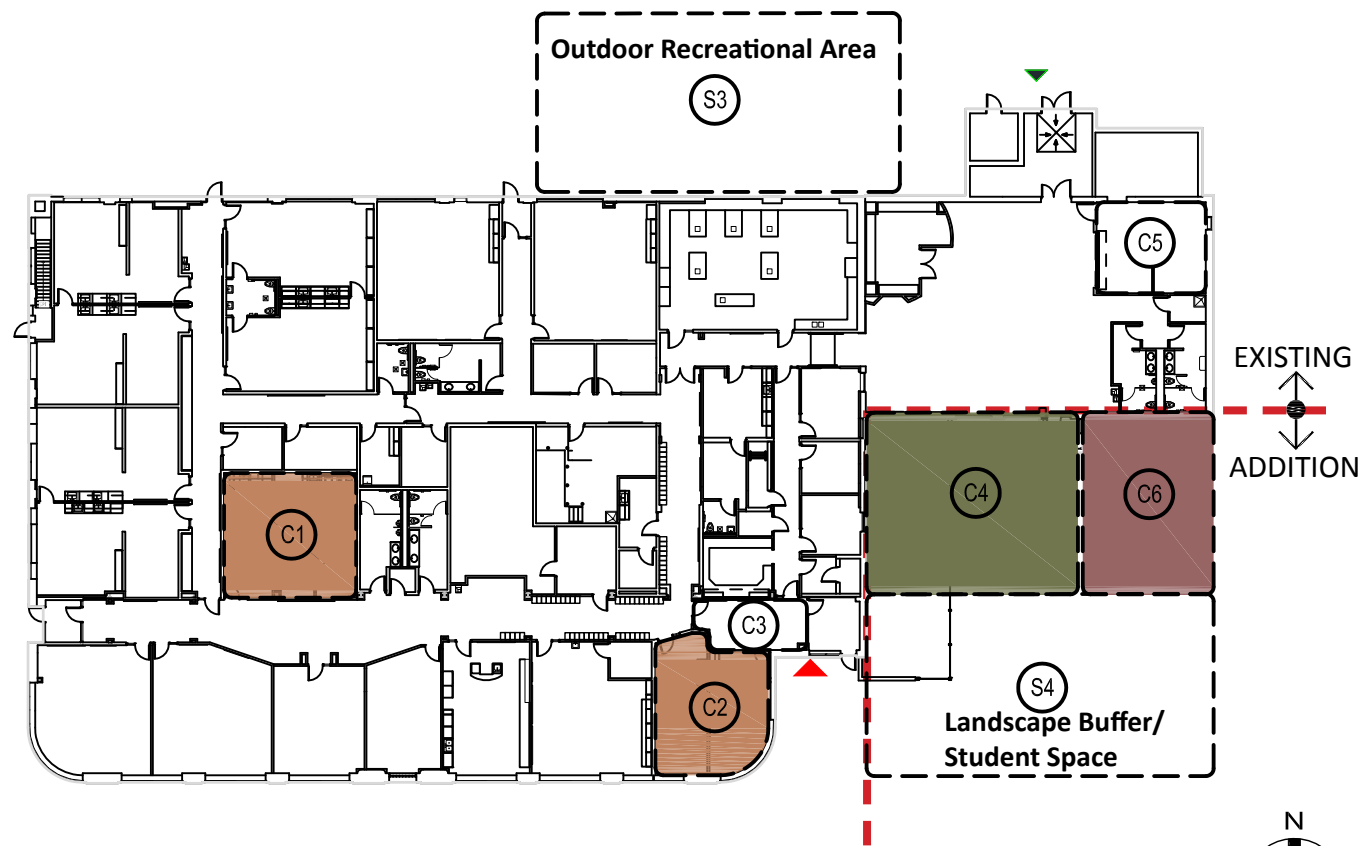

FIRST FLOOR

	General Learning
	Science
	Performing Arts
	Career & Tech Education
	Media Center
	Dining
	Athletics
	Circulation
	Facilities Support
	Administration
	Art

	Demolition / Removal
	New / Existing
	Property Line
	Main Entry
	Secondary Entry
	Service Entry

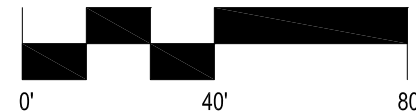
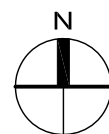







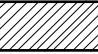

AGAPE

Conceptual Construction Plan

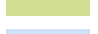

Scope Package	New Construction	Heavy Remodel	Medium Remodel	Light Remodel	Finishes Only
A	2,740 SF		432 SF		
B			1,332 SF		
C				232 SF	
TOTAL	2,740 SF		1,764 SF	232 SF	

Line Items	Unit	Lump Sum
Security Cameras		
Window film at West/South Elevations		

-  Demolition / Removal
-  New / Existing
-  New Construction
-  Heavy Remodel
-  Medium Remodel
-  Light Remodel
-  Finishes Only
-  No Work

FIRST FLOOR