

SUSD 2010 BOND Progress

SUSD Governing Board Meeting

13 August 2013

By: Rick Freeman

Executive Director of Facilities and Operations

The Summer of 2013
was a very productive
time for our Bond
Projects.

Cocopah Middle School May 2011



An aerial photograph of the Cocopah Middle School campus. The school consists of several interconnected buildings with flat roofs, some featuring green and blue accents. A central courtyard with green grass and trees is surrounded by the buildings. To the right, there are two baseball fields with red dirt and green grass. A large parking lot with several cars is located near the center-right. A multi-lane road runs along the left side of the campus. The surrounding area includes residential houses and other buildings.

Cocopah Middle School: August 2013

Cocopah Enrichment Building: August 1, 2013





Cocopah Enrichment – 8/1/2013



Cocopah Enrichment Classroom



New Faculty Parking Lot



Mohave Middle School August 2012



Mohave Middle School January 1, 2013

New Classrooms

Library

New Administration and
Parking Lot Location

MDA

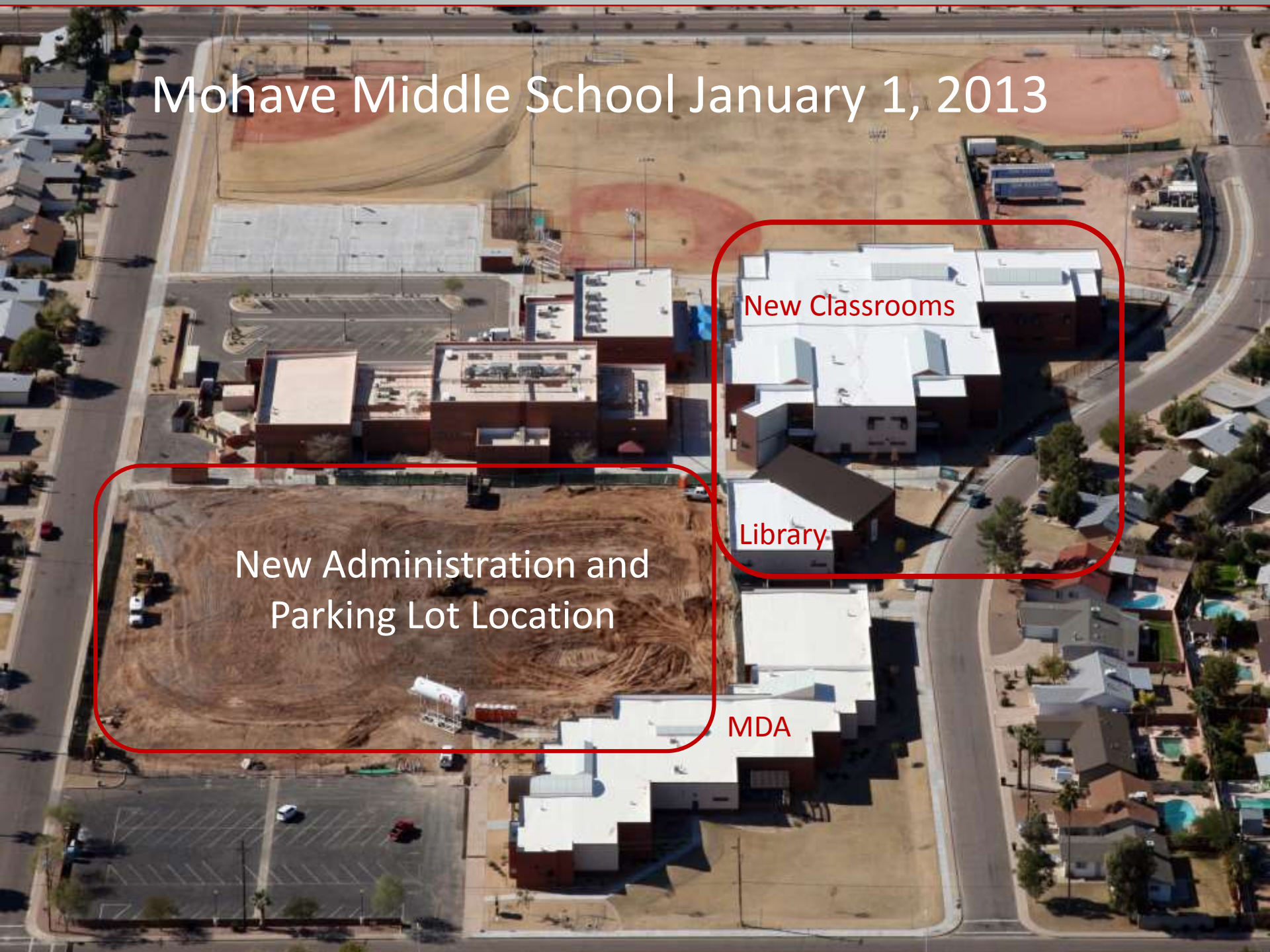



Mohave 7-15-2013

An aerial photograph of a school campus. At the top, there are two baseball fields with green grass and brown dirt bases. Below the fields is a large, multi-story school building with a complex roofline. To the left of the main building is a large, paved parking lot. A red rounded rectangle is drawn around the parking lot and the adjacent building section. The surrounding area includes residential houses with swimming pools and a curved road on the right side.

New Administration and
Parking Lot Location

Mohave Middle School 08-06-13



08.06.2013

Mohave Nurse's Area



08.06.2013

MDA Building B



08.06.2013

Mohave & MDA Parking Lot



08.06.2013

Ingleside Middle School 5/30/13



Ingleside Middle School: August 2013







Ongoing Projects:

Apache Bus Maintenance Facility

Tonalea Multipurpose Building

Cholla SUSD/SHC N.O.A.H. Facility



An aerial photograph of a large industrial or commercial facility, identified as the Apache Facility. The facility consists of several large, dark-roofed buildings. Numerous white semi-trailers are parked in organized rows along the perimeter of the buildings. In the lower-left corner, there is a paved area with basketball court markings. A green rounded rectangle highlights a portion of this area, labeled 'New Maintenance Facility Location'. A blue dashed rectangle highlights a larger area below the green one, labeled 'Relocate Courts'. The surrounding landscape includes some trees and a road on the left side.

Apache Facility

New
Maintenance
Facility
Location

Relocate Courts

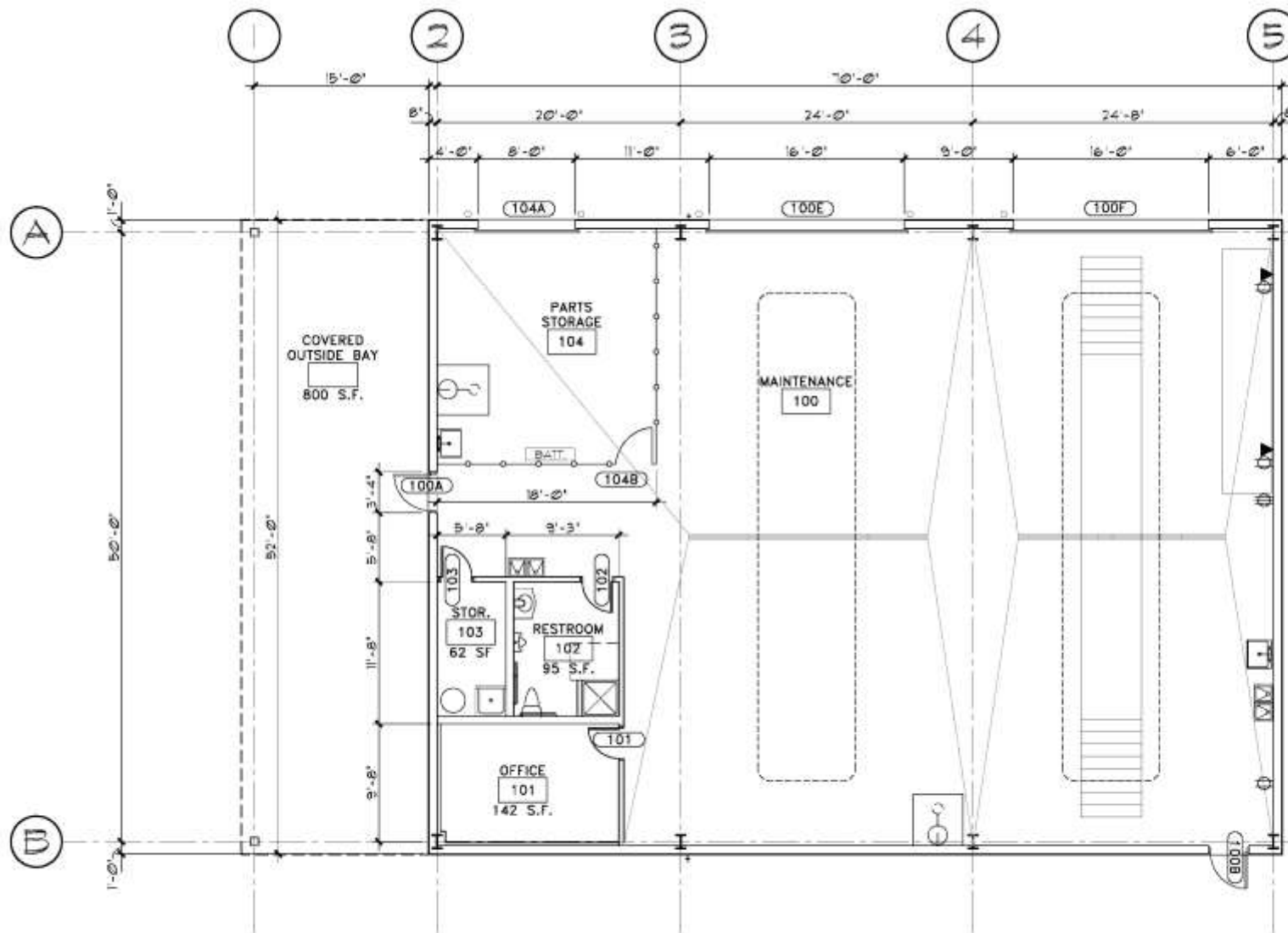

APACHE MAINTENANCE FACILITY

Scottsdale Unified School District
85th Place and Moreland
Scottsdale, AZ

scale: 1/8" = 1'-0"



adm group, inc.
2100 west 15th street
tempe, arizona 85281-6942
tel: 480.285.3800
fax: 480.285.3801

07 January 2013
5766-100

BUILDING SQUARE FOOTAGE: 3,657 S.F.
COVERED EXTERIOR BAY: 800 S.F.
TOTAL: 4,457 S.F.

Floor Plan

Apache Bus Maintenance Facility 8-6-13





Tonalea New Multipurpose Building Rendering





A collection of construction tools is arranged on a white surface against a warm, orange-toned background. In the center is a bright yellow hard hat. To its left is a hammer with a black head and a light-colored wooden handle, resting on a pair of brown leather work gloves. To the right of the hard hat is a hand saw with a silver blade and a yellow and black handle. A yellow and black tape measure is partially visible at the bottom center.

Thank You!