



NORTH SPRINGS HIGH SCHOOL | BOARD PRESENTATION

FULTON COUNTY SCHOOLS | **24 OCTOBER 2023**



CONCEPT SITE & FLOORPLANS

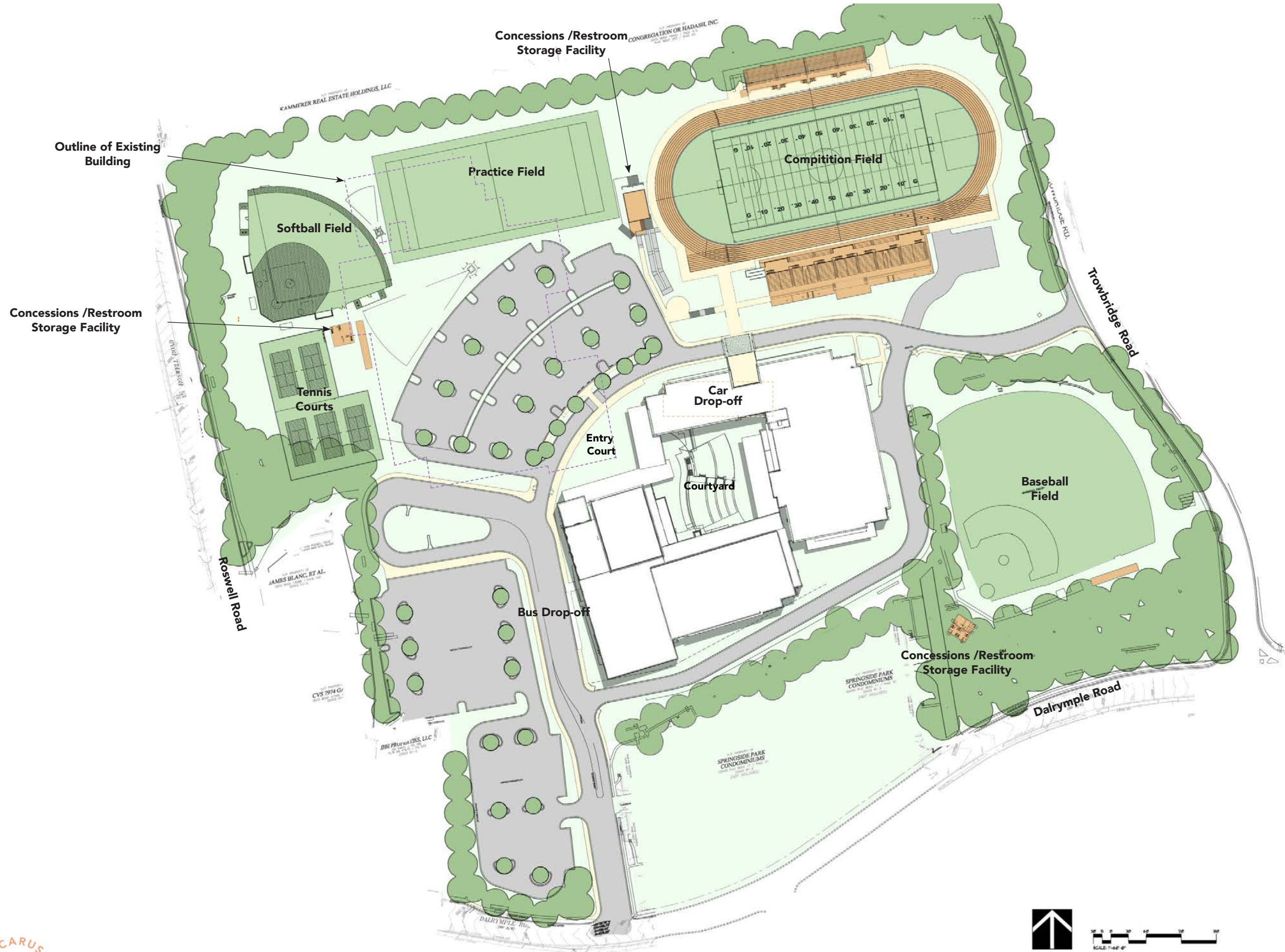

OVERALL SITE PLAN





AERIAL VIEW FROM NORTH WEST

3D VIEWS



AERIAL VIEW FROM NORTH EAST

3D VIEWS

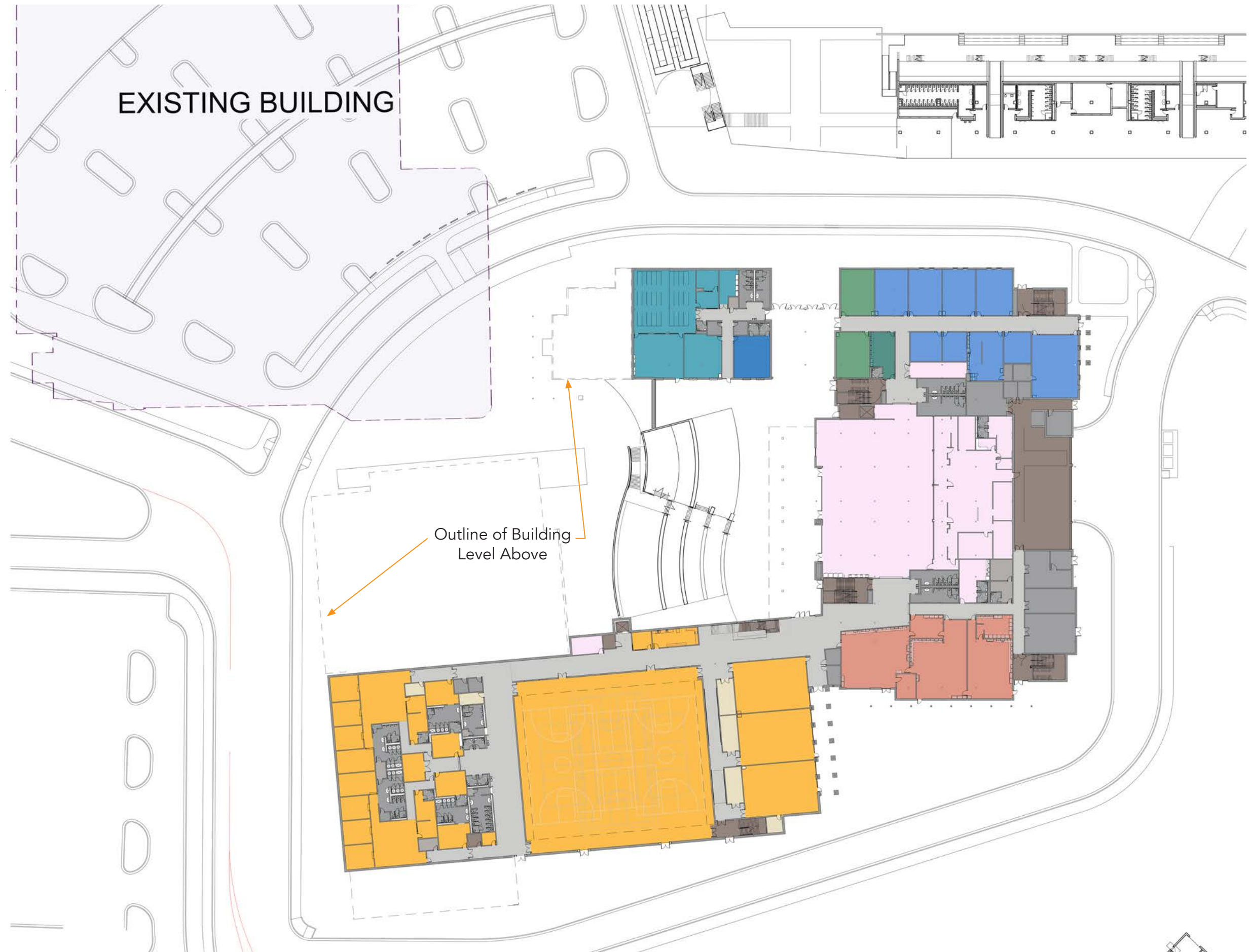

LEGEND

- Athletic Facilities
- Physical Education
- Visual Arts
- Vertical Circ.
- Horizontal Circ.
- Support
- Custodial
- Food Service
- Administrative
- Exceptional Students
- CTAE
- Classroom Support
- Classrooms

LEVEL 1



EXISTING BUILDING

LEGEND

- Athletic Facilities
- Physical Education
- Performing Arts - Academic
- Performing Arts
- Vertical Circ.
- Horizontal Circ.
- Support
- Custodial
- Food Service
- Media Center
- Administrative
- Exceptional Students
- CTAE
- Classroom Support
- Classrooms

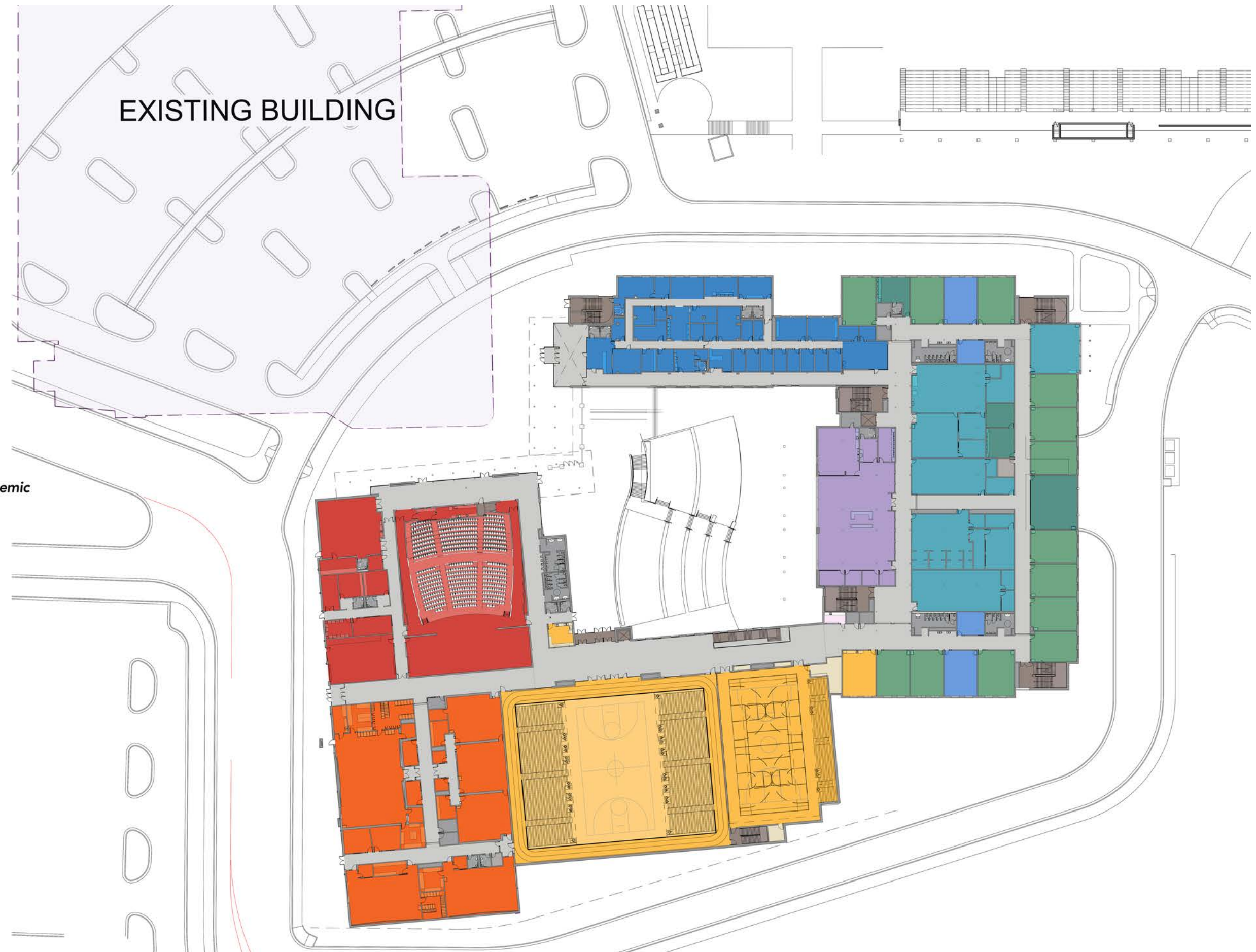

LEVEL 2

NORTH SPRINGS HIGH SCHOOL
FULTON COUNTY SCHOOLS
2023.10.24

EXISTING BUILDING

LEGEND

- Athletic Facilities
- Physical Education
- Performing Arts - Academic
- Performing Arts
- Vertical Circ.
- Horizontal Circ.
- Support
- Custodial
- Food Service
- Media Center
- Administrative
- Exceptional Students
- CTAE
- Classroom Support
- Classrooms

LEVEL 3

STADIUM

STADIUM OVERVIEW

- State-of-the-art stadium with 2,500 seats in the home grandstand and 1,500 seats in the visitor bleachers.
- Essential amenities such as restrooms, concessions, team rooms, and storage facilities are located below the home grandstand for convenience.
- Connected press box with sound system for optimal coverage.
- Adjacent building for storage, restrooms, and concessions.
- Versatile facilities including an 8-lane track, synthetic turf field, lighting, and secure fencing.

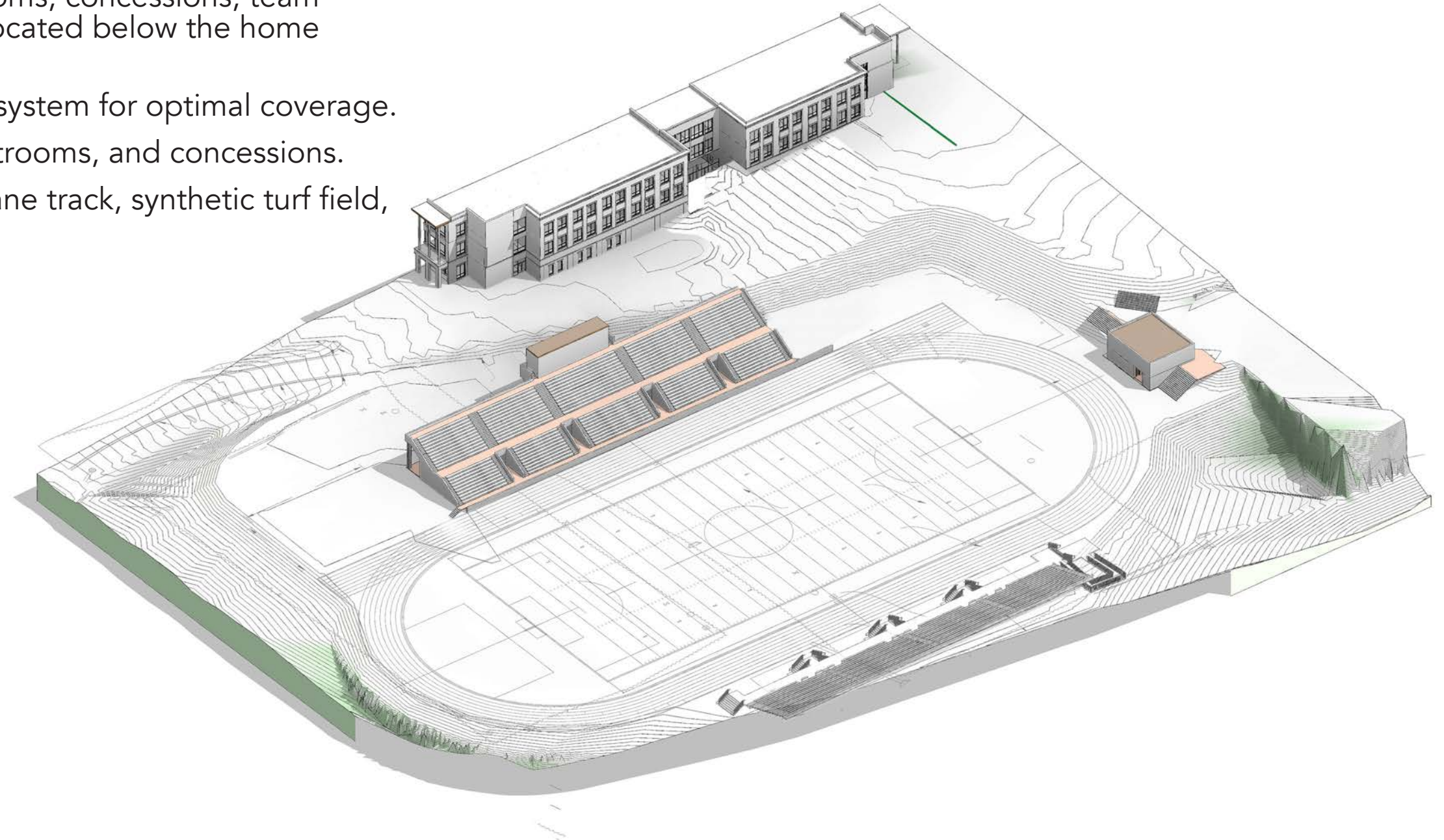

COMPETITION STADIUM

RENDERINGS



VIEW FROM MAIN ENTRY PLAZA

3D VIEWS



VIEW OF THE COURTYARD FROM DINING PATIO

GOAL

- Utilizing architectural features to create a sense of learning.

INSPIRATION

- Emphasize the connection between inside and outside
- Respect of the natural site
- Balance of passive and active interior spaces.

AESTHETIC

- Clean and modern.
- High lighting quality.
- Fresh color palette.
- Balance of passive and active interior spaces.

STRATEGY

- Emphasize geometry pattern in corridor to define the flow of the space.
- Utilize of punch colors for branding and environmental graphics.
- Use of bold color in classroom to active learning.
- Simplified use of materials for modern and fresh aesthetic.

URBAN PARK WALK





Media Center - View Looking to Entry



Media Center - View Looking into Courtyard



Auditorium Lobby



Entrance Lobby

Interior Concept Studies



Gymnasium Entry Lobby

Interior Concept Studies

QUESTIONS