



**TO:** PARENTS OF CHILDREN IN NEED OF SUMMER CARE  
**FROM:** CINDY KARRIKER AND STAFF  
**SUBJECT:** SUMMER CARE REGISTRATION PACKET  
**DATE:** 2/02/2024

PARENTS,

Thank you for choosing the Mooresville Graded School District's Before & After School Summer Care Program. Attached you will find all the forms to enroll a child that is currently active in BASP for **Summer Care 2024**.

**If your child was not enrolled in our program for the regular school year 2023-2024 please fill out a regular application in addition to this summer enrollment packet, located on the Registration, Enrollment and Medical Forms section of the website.**

<https://www.mgsd.k12.nc.us/departments/before-and-after-school-program>

This regular application is **required prior to acceptance** into the summer care program. All information needs to be filled out in its entirety and submitted online (with a \$25.00 yearly registration fee for those students **not** currently enrolled with BASP, this is separate from the deposit) with your Summer Camp Registration.

THE PACKET INCLUDES THE FOLLOWING:

1. WELCOME TO SUMMER CARE 2024 LETTER, SUMMER AMENDMENTS, SITE MAP
  2. SUMMER CARE REGISTRATION FORM (Please print clearly) (60-80 student slots are available)  
**PLEASE, ONLY RETURN THE LAST 6 PAGES**
  3. FIELDTRIP CARD (**TWO PART, PLEASE FILL OUT BOTH SECTIONS**),
  4. AQUATIC POLICY FORM
  5. **FIELD TRIPS Will not be published until Summer Care Starts due to the fact that most of our reservations can not be confirmed this early.** Some of the possibilities from past summers have included swimming, bowling, On-Site presenters, Baseball game, Aquarium, visits to the animals (several different possibilities) Laser Tag, Greensboro and Durham Science Centers, Farm visits. As soon as the fieldtrips are confirmed we will post the list on our web page.
- ◆ Please be aware that we will operate Summer Care at East Mooresville Intermediate School for K – 5<sup>th</sup>.
  - ◆ The South, PV, MIS and RR BASP sites will be closed for the summer.
  - ◆ Enrollment is on a first come first serve basis. You will receive an email confirmation notice to verify that your application and deposit have been received and that we have reserved a space for your child or that you have been placed on the waiting list as soon as we get the applications entered – this could take up to three weeks.

**BASP SUMMER CAMP WILL BE CLOSED**  
**May 23-28, June 19, July 1-5, July 26-August 6**



### IMPORTANT INFORMATION FOR SUMMER CARE

There will only be one site operating for summer care again this year.

We will be at East Mooresville Intermediate School located at 1711 Landis Hwy.

**May 29-June 18, 20-27, July 8-25, 2024**

Tuition bills/invoices will come out once this summer. Tuition will be line itemed by the week (1-8) on your invoice. Tuition is a flat rate this year, no part time care available, no refunds or adjustments. **We will operate Monday through Thursday only**. There will be a \$25.00 registration fee for those students **not** currently enrolled in BASP during the 2023/24 school year along with our regular application

(<https://www.mgsd.k12.nc.us/departments/before-and-after-school-program> )

and is due at time of application. It is a requirement that you place a \$100.00 non-refundable deposit when you register for the Summer Care program. This amount will be applied to your account at the end of the **last full week of care** and is due at time of registration to secure your child's spot. The **Flat rate is \$170 (no Part Time care will be available)**. Online Tuition payments are due **the week before the scheduled week of care, no later than Friday**. If tuition payment is not received by Friday, care may be denied on Monday when you arrive to drop off your child. The **summer tuition payments** will be accepted using the Online School Payment system, the link is on the left hand side of our web page.

Your June/July bill will be **EMAILED** the week of April 29th, so please check your email frequently during that week.

Summer Applications are in a computer fillable PDF format. Please see our website for the instructions on how to return the application.

**BASP**

**1438 Coddle Creek Hwy**

**Mooresville, NC 28115**

**Payments may be paid online using the ONLINE SCHOOL PAYMENT link on the left side of our web page.**

**Weekly fees may be paid using the ONLINE SCHOOL PAYMENT site beginning May 13, 2024.**

**\*\*on Regular days All students must arrive no later than 9:00 A.M.** If your child is not here by 9:00 you will be turned away for the day. Our activities begin at 9:00 and we want the children to have the time to enjoy themselves and not miss out on anything. The teachers have full classes, when a child arrives late this disrupts the activities and the teacher has to re-teach/explain everything that has been done up to that point making the other children wait, and causing them to redo attendance and lunch counts which are due by 9:15 AM every day. Exceptions to the arrival time will be: on fieldtrip days when we must leave earlier (students must arrive **no later** than the time posted at the sign in/out table on these days, we will not hold the bus), or if you have a doctor or dentist appointment – please let us know in advance and bring a school note from the appointment. \*\*

The last day for students at PV, SO, RR & MIS for this school year is Wednesday May 22nd, 2024. **Wednesday May 29, 2024. South, Park View, Rocky River and MIS students attending Summer Care will need to attend East Mooresville Intermediate BASP.** Please make sure all arrangements have been made in advance so that records can be transferred for the summer. Care will resume at South, PV, RR and MIS August 7th, 2024 at 6:30 A.M.

#### **Summer 2024**

**WE WILL BE CLOSED June 19 and THE WEEK OF July 1-5, 2024**

You may add, change weeks or withdraw, **all in writing**, from this Summer Care plan up to **April 1<sup>st</sup>**. Any students **added after April 1<sup>st</sup>** will be charged a \$10.00 processing fee. **Deposits are due when you receive your child's confirmation of summer enrollment email from the staff. Once you have reserved your spot for a week you will be charged for that week regardless if your child attends or not.** We must schedule staff, make reservations and order supplies in advance. Thank you for your understanding.

#### **Fieldtrip Eligibility:**

If your child makes poor behavior choices resulting in a write up slip, this will make them ineligible for the next fieldtrip. Fieldtrips are a privilege and taking the children off campus requires a certain level of behavior expectations for their safety. If they cannot behave while on campus then we cannot trust them to behave off campus. If there is a group on campus then your child may stay with them while we are on our field trip, otherwise you will need to make separate arrangements for their care for that particular day. We will inform you if there is an available group for them to stay with on campus.

# Important Information to Remember for Summer Care 2024

Parents,

The staff and I have a few reminders for you for the summer.

- ✚ **Drop-off and Pick-up** At EMIS 5/29/24-7/25/24, please use the back parking lot (Hwy 150 & Wiggins Rd.). Pull down to the sidewalk near the fenced in picnic area and bring child to side cafeteria door. You will pick-up at the same door. I have attached a map with the areas we will be using highlighted for your convenience.
- ✚ **Dress Code for the Summer** We will follow the School Dress Code for the summer, shorts must meet at the end of finger tips, no spaghetti strap tops or thin strap tank tops for boy or girls. Students must have tennis shoes with them everyday. No flip flops allowed. Students that have River Shoes (water sandals that have a back strap and or clip that keeps them on the foot) may wear these but they must have tennis shoes and socks in their bag to change into for outdoor activities and gym time. We will be doing a lot of messy crafts so please send your child in play clothes that won't hurt to get messed up. Please send a lightweight shirt to put over your child's bathing suit that they can swim in in the event that their sunscreen is not enough protection.
- ✚ **Arrival Time** Arrival time is 9:00 A.M. at the latest on regular days. If we have fieldtrip days the arrival time will be posted, children must be on campus 45 minutes prior to leave time. There could be days that we would be leaving before 9:00 A.M., please make sure you check the weekly Parent Square we send to your email for changes in times. There will not be any staff left on site for child care on fieldtrip days for safety supervision reasons.
- ✚ **Sunscreen** Sunscreen must be supplied from home and a permission slip completed and returned by May 10<sup>th</sup> to your site director. We will log and transport these to EMIS in advance of the first day of camp.
- ✚ **Map** I have included a map of your summer site for your convenience.
- ✚ **Payments** Payments are due the Thursday/Friday before the week of care.
- ✚ **Cell Phone #** South, Park View, Rocky River and MIS will have their cell phones at EMIS for the summer.
  - **South** Cell Phone 704-662-2697
  - **Park View** Cell Phone 704-663-9985
  - **Rocky River** Cell Phone 704-345-2699
  - **MIS** Cell Phone 704-477-3803
  - **EMIS Cell Phone # 704-345-2702**
- ✚ **EMIS Site: Land Line # 704-658-2691 option 3** (the Site Director on duty should have this number forwarded to their cell if they are away from the cafeteria)

Thank you for your attention to these items.

Cindy Karriker, Gina Gajus, Celeste Kunneke, Michelle Howell

**PLEASE REMEMBER** that payments are due the Thursday if you are paying in person and Friday if you are paying online BEFORE the week of care and that we will not allow any charging this summer. For security we are asking that you make your payment on FRIDAY MORNING so that we do not have any money on site during the weekend.

### What NOT to bring from home:

Hand held digital devices, cell phones, smart watches,  
Movies, Toys, unhealthy snacks

### Signing in an

### Signing out

#### Sign in

- Ⓢ Please note that we do not open before 6:30 A.M. by OUR CLOCK.
- Ⓢ Children must be on site by 9:00AM or by the posted Fieldtrip arrival time.
- Ⓢ Please allow yourself enough time in the morning to drop your child off because there could be a line at drop off
- Ⓢ We will escort your child to their location
- Ⓢ Please speak to the staff member on duty each morning so they know your child has arrived.

#### Sign Out

- Ⓢ Please note that we close at 6:00 P.M. and late fees will be charged at 6:01 P.M. by OUR CLOCK.
- Ⓢ Please speak to the staff member on duty each evening so they know your child is leaving.
- Ⓢ Please check your Parent Square regularly for information updates.

**Drop-off and Pick-up** At EMIS please use the back parking lot (Hwy 150 & Wiggins Rd.). Pull down to the sidewalk near the fenced in picnic area and bring child to side cafeteria door. You will pick-up at the same door.

### CONTACT NUMBERS:

South Elementary BASP  
Cell: 704-662-2697

Park View Elementary BASP  
Cell: 704-663-9985

**EMIS BASP**  
Cell: 704-345-2702  
Office: 704-658-2691 opt. 3

MIS BASP Phone  
Cell: 704-477-3803  
Business Office: 704-658-2681

RR BASP Phone  
Cell: 704-345-2699

### Dress Code:

- Ⓢ Tennis Shoes every day.
- Ⓢ No shoulder straps less than 3 fingers wide
- Ⓢ Shorts/Skirts no shorter than the tips of your fingers with your arm at your side.
- Ⓢ Skirts – wear shorts underneath.
- Ⓢ Wear Bathing suit under clothes to school on swim day – bring a change of clothes for after we get back, bring water shoes to change into.

**Sunscreen Pump Spray** Sunscreen must be supplied from home and a permission slip completed and returned to your Site Director by May 10<sup>th</sup>, 2024.



## BASP Summer Instructions & Phone #'s

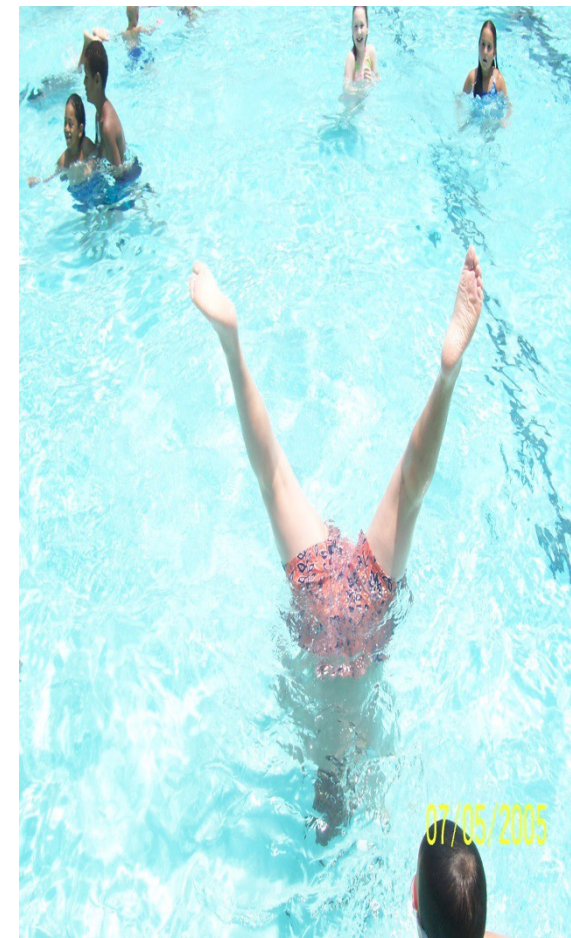



Parents,

This summer the Summer Care Camp will be held at East Mooresville Intermediate School for K-5<sup>th</sup> grades. Our base of operation will be out of the Cafeteria. **Drop-off and Pick-up will be in** the back parking lot off of Hwy 150 & Wiggins Road. Pull down to the sidewalk near dumpsters and the fenced in picnic area and bring child to side cafeteria door. You will pick-up at the same door. If nobody is at the door or you need to see a Site Director please call 704-658-2691 opt. 3. There will be a Site Director on duty all day if you should need one.

Thank you for your assistance and we are looking forward to having your child with us this summer.

Cindy Karriker  
Program Director

Playground

Playground

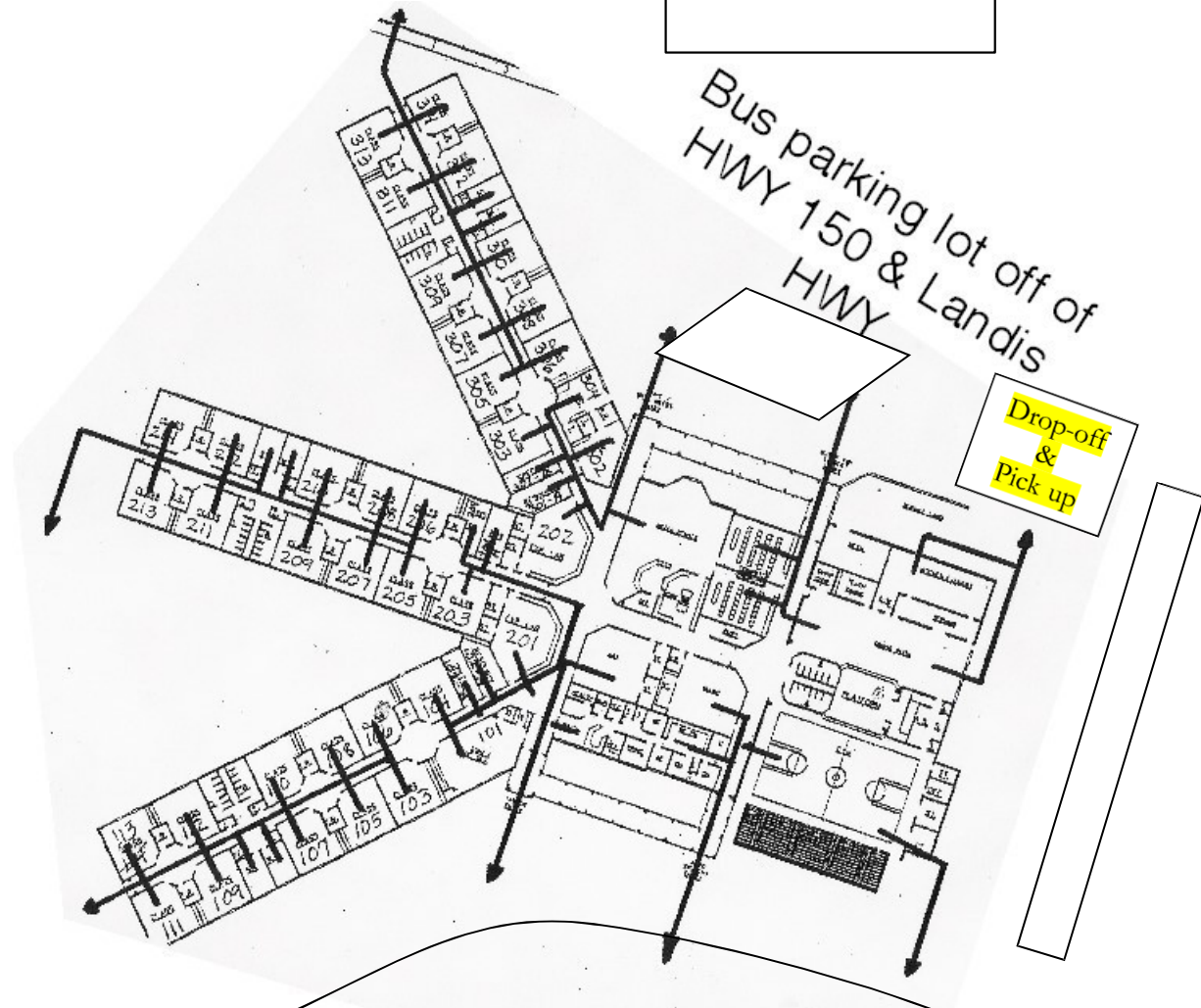

Front drive way from Main Street

## Information to have ready for Registration Day

The weeks you **NEED** to register for

The Dates you will **NOT** need care

The child's allergy list, special dietary needs, Health conditions, medications they need to take while in our care.

Doctor's Name and Phone Numbers

Dentist's Name and Phone Number

Health Insurance Company and Policy Number

A School Photo of your child to attach to the email with the application (we travel for field trips and a photo is attached to their emergency information in our travel bags)

Parent Names and Phone numbers

Emergency contact Names and Phone Numbers

**IF your child DID NOT use Before and/or After School during the school year for the 2023/2024 school year then you will need to fill out our regular application and required forms located below the summer camp application link ONCE YOU ARE NOTIFIED THAT YOU HAVE RECEIVED A SUMMER CAMP SLOT.**

**You do not need to complete this step UNTIL you are notified.**

Summer Camp [Information](#) Packet - Please read PRIOR to Registration Day

**Summer Camp [Application Link 2024](#)** (will activate 2/24/24 @10:00AM)

If you were **not** enrolled during this school year (2023/24) please click on the links below and complete the remainder of the registration requirements.

[BASP Application](#) (NC DCDEE requirement)

[Additional Forms](#) (hard signature requirement - NC DCDEE requirement)

[ProCare REGISTRATION](#) (accounting/invoicing)

*Topical Ointment Permission Slip Please print, sign and return to BASP Director by May 10, 2024. Please send Pump spray sunscreen (no aerosols please) . We MUST have the EXACT name of the sunscreen on this form for the form to be complete. We do not provide sunscreen.*

Field Trips and Menus will be posted as soon as they have been finalized.