



Elgin ISD Elementary School #4

ideation | meeting #2

March 9, 2022

pfluger



Establishing the Vision

- Define Goals and Objectives
- Identify Problems to Solve Project
- Visualization
- Precedents
- Partnerships
- Tours

Shaping the Building

- Guiding Principles
- Program Verification
- Program block Options
- Workshops
- Story Telling

Sculpting the Environment

- Charrette
- Conceptual design
- Project Visualization

Agenda

1	Guiding Principles	10 min
2	Overview of Visual Listening	10 min
3	Visual Progression Exercise	40 min
4	Break	10 min
5	Program Overview	30 min
6	TEA Requirements	20 min

Padlet

We will be using Padlet throughout the project to share and collaborate in the design process. Please use it to *share ideas, comment and share between yourselves and the design team*. We will be posting to it regularly, so stay tuned and feel free to add and engage further in the conversation.

https://padlet.com/garrett62/elgin_isd_4



Guiding Principles

1 Caring Space

Humans on guard cannot take new knowledge or ideas. We will create a physical, mental and emotional safe space for learners to thrive. We will create a caring physical environment where equality and freedom are key values and where people are allowed to be vulnerable.

2

Sense of

Community

The aim of this project is to foster the sense of community to create a culture of trust, where learners feel safe to express themselves freely and try things out, fail, try again, and to continue to experiment and learn.

3

Collaboration

at the center

Through working with others, we develop higher-level thinking skills, we learn faster, and we develop empathy and social skills. Therefore, we will create different spaces for learners to influence each other, meet up, create friendships, and join forces. Our school supports as many options of interaction and collaboration as possible: working alone, together, in small or bigger groups and in different constellations. We utilize design strategies that stimulate socializing, collaboration, and cooperation.

4

Connect to the

Outdoor

Nature stimulates imagination and provides a space that fosters and facilitates various kind of activities. In nature, we get exposed to all kinds of different sensory experiences that changes from time to time. Therefore, in designing our school, we focus on creating a strong connection between indoors and outdoors, making it easy and convenient to utilize the outdoor environment for various learning activities.

Overview of Visual Listening

Visual Listening

Identify areas and images that could **help design and shape the physical environment** for new Elementary School. When voting, consider surroundings, culture, students and the future impact this new school will have in its community and inhabitants. There are 3 distinct areas you would be able to identify and provide feedback: 1) **Exterior**, 2) **Interior**, 3) **Outdoor Environment**

Visual listening feedback tools:

Green Dot



Love it! 😍

Red Dot



No way Jose 😡

Post-it



Feed back 💬

evaluated and when comments can be provided they should be included and placed on in the comment section to the right of the images.



1

LAYOUT

2

MATERIALITY

3

FEEL

INTERIOR



Evaluate the images based on their **layout and organization** of the interior space. What are your thoughts on the **harmony of components** and their interaction with each other?

Evaluate the images based on their **use of material** and their use on the interior and to enhance the space. Consider **texture, color, pattern, finish** and **interaction of materials**.

Evaluate the images based on how **they make you feel about spending time in this space**.

Comment about the first picture

Comment about the first picture

Wow!
This is It.

Comment about the first picture

ELEMENTARY
SCHOOL #4
ELGIN ISD

VISUAL LISTENING

INSTRUCTIONS

Each member of the evaluation team is given 5 green dots and 5 red dots to place on images as a vote of something about the image they like or something they dislike. It can be feeling overall, or something more specific.

The below images should be carefully evaluated and when comments can be provided they should be included and placed on in the comment section to the right of the images.

EXTERIOR



✓

1
SCALE

2
MATERIALITY

3
STYLE

Evaluate the images based on their size, height, presence and harmony of components in addition to the scale of the building within its context and surroundings.

Evaluate the images based on their use of material in all areas including the building, site and landscape. Consider texture, color, pattern, finish and interaction of materials.

Evaluate the images based on their architectural style and character.

too boxy

looks weird

will colors look over time

Opportunity for light

Not enough windows

lots of windows / green space

COMMEN

T ARE

AREA

doesn't look like a school

prison

GENERAL COMMENTS

Exterior



ELEMENTARY
SCHOOL #4
ELGIN ISD

VISUAL LISTENING

INSTRUCTIONS

Each member of the evaluation team is given 5 green dots and 5 red dots to place on images as a vote of something about the image they like or something they dislike. It can be a feeling overall, or something more specific.

The below images should be carefully evaluated and when comments can be provided they should be included and placed on in the comment section to the right of the images.

INTERIOR



✓	LAYOUT	MATERIALITY	FEEL
---	--------	-------------	------

Evaluate the images based on their layout and organization of the interior space. What are your thoughts on the harmony of components and their interaction with each other?

Evaluate the images based on their use of material and their use on the interior space. What are your thoughts on the texture, color, pattern, finish and interaction of materials?

Evaluate the images based on how they make you feel about spending time in this space.

Colorful & open

Hard space to manage

Flowing

Making interior courtyard part of access to classroom

New idea needs better execution

Lots of learning needs

Good quiet spaces

Easy to bring outside in

Good color palette

GENERAL COMMENTS

Interior



ELEMENTARY
SCHOOL #4
ELGIN ISD

VISUAL LISTENING

INSTRUCTIONS

Each member of the evaluation team is given 5 green dots and 5 red dots to place on images as a scale of something about the image they like or something they dislike. It can be a feeling overall, or something more specific.

The below images should be carefully evaluated and when comments can be provided they should be included and placed on in the comment section to the right of the images.



✓ **FUNCTION** **MATERIALITY** **INTERACTION**

SITE/LANDSCAPE



COMMENT AREA

Love the open spaces

Native Plants
Pollinator
Plants
trees

Open patio level

Kids love
grazing and
being a part
of it

Places to
climb, sit
or gather

Over looks
to windows
don't mix

Playground
needs trees
or cover

GENERAL COMMENTS

Outdoor spaces



Visual Progression Exercise

Scale Exercise

What is your temperature on these different topics? Place one dot on your point in the scale where the photos above align with your vision for the space. Use one additional dot to indicate your favorite image!

Color coded:

Blue Dot



Administration

Yellow Dot

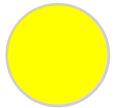

Educator

Green Dot



Community

Red Dot



Student

our **classrooms connection** to the **corridor**



our **classrooms connection** to the **corridor**



our **classrooms** will be **flexible**

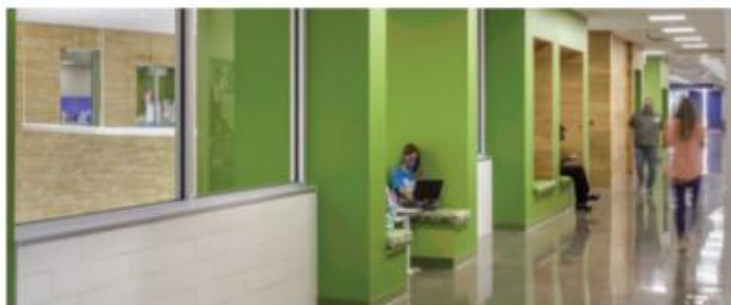
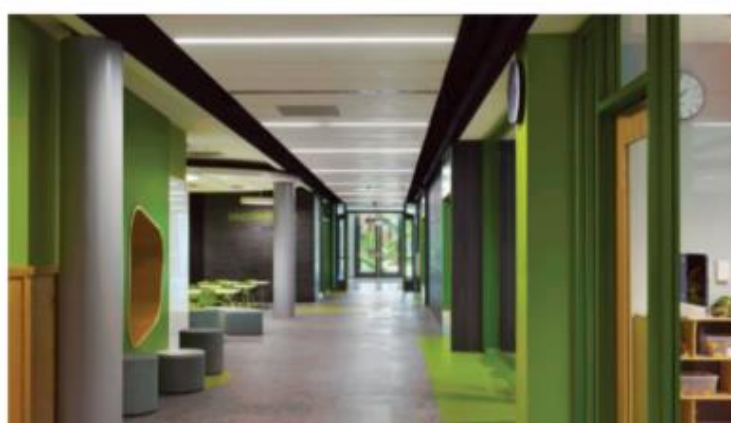

our *learning* is **adaptive**



our *students* will be **hands on learners**



our *library* will feel



our *learning* will be connected to the **outdoors**

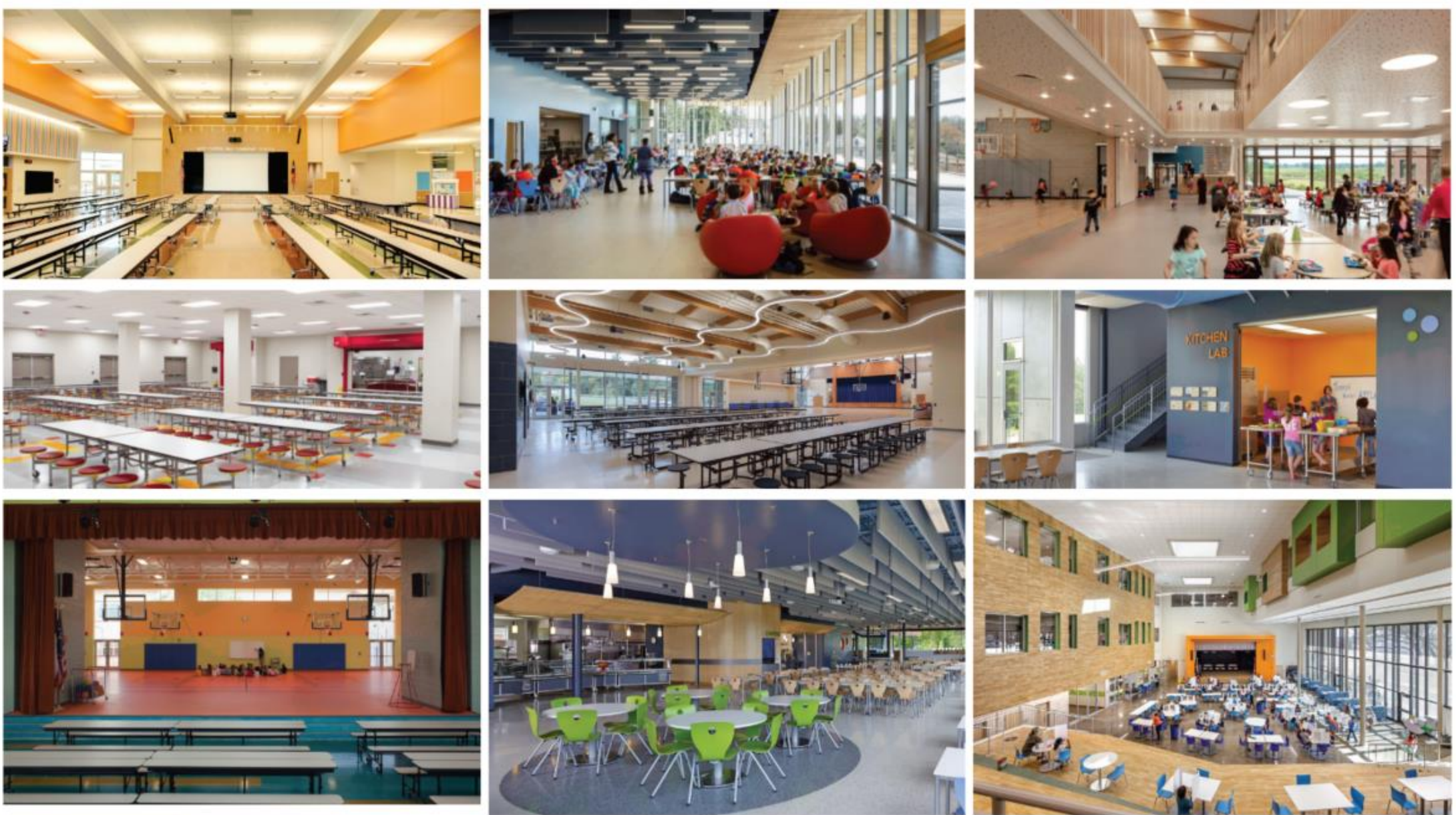

our **cafeteria** will be **multipurpose**



our **gym** will **provide**



our *school* environment will be **sustainable & healthy**

Break

Program Overview

Features

Approximately 92,000 SF, one & two-story spaces

Site is 12.91 Acres in Harvest Ridge neighborhood

Designed for 800 Students / Core for 900 Students

Construction Budget: \$29,597,400

Open for Fall of 2024

Program Spaces	Totals					
	Capacity				Net Area	
	Staff	TS	Stud.		NSF	
01.00.000	Academics	40	40	871		35,060
02.00.000	Collaboration	0	0	0		0
03.00.000	Media Center	0	0	0		5,615
04.00.000	Science & Technology	0	0	0		0
05.00.000	Special Education	8	6	42		3,925
06.00.000	Performing & Fine Arts	2	2	0		2,600
07.00.000	Physical Ed & Athletics	1	0	0		4,920
08.00.000	Food Service	0	0	0		9,265
09.00.000	Administration	0	0	0		4,220
21.00.000	Support & Plant Services	0	0	0		1,020
Total Teaching Stations		51	48	913	TOTAL NET AREA	66,625
Total Net Unassignable(Grossing)						1.30
TOTAL GROSS AREA						86,613

Summary

40 general education classrooms

(6) Pre-Kindergarten classrooms	800 SF	4,800 SF
(6) toilets	65 SF	390 SF
(6) Kindergarten classrooms	800 SF	4,800 SF
(6) toilets	65 SF	390 SF
(6) First Grade classrooms	800 SF	4,800 SF
(6) toilets	65 SF	390 SF
(6) Second Grade classrooms	800 SF	4,800 SF
(6) Third Grade classrooms	800 SF	4,800 SF
(5) Fourth Grade classrooms	800 SF	4,000 SF
(5) Fifth Grade classrooms	800 SF	4,000 SF

Summary

Other Classrooms

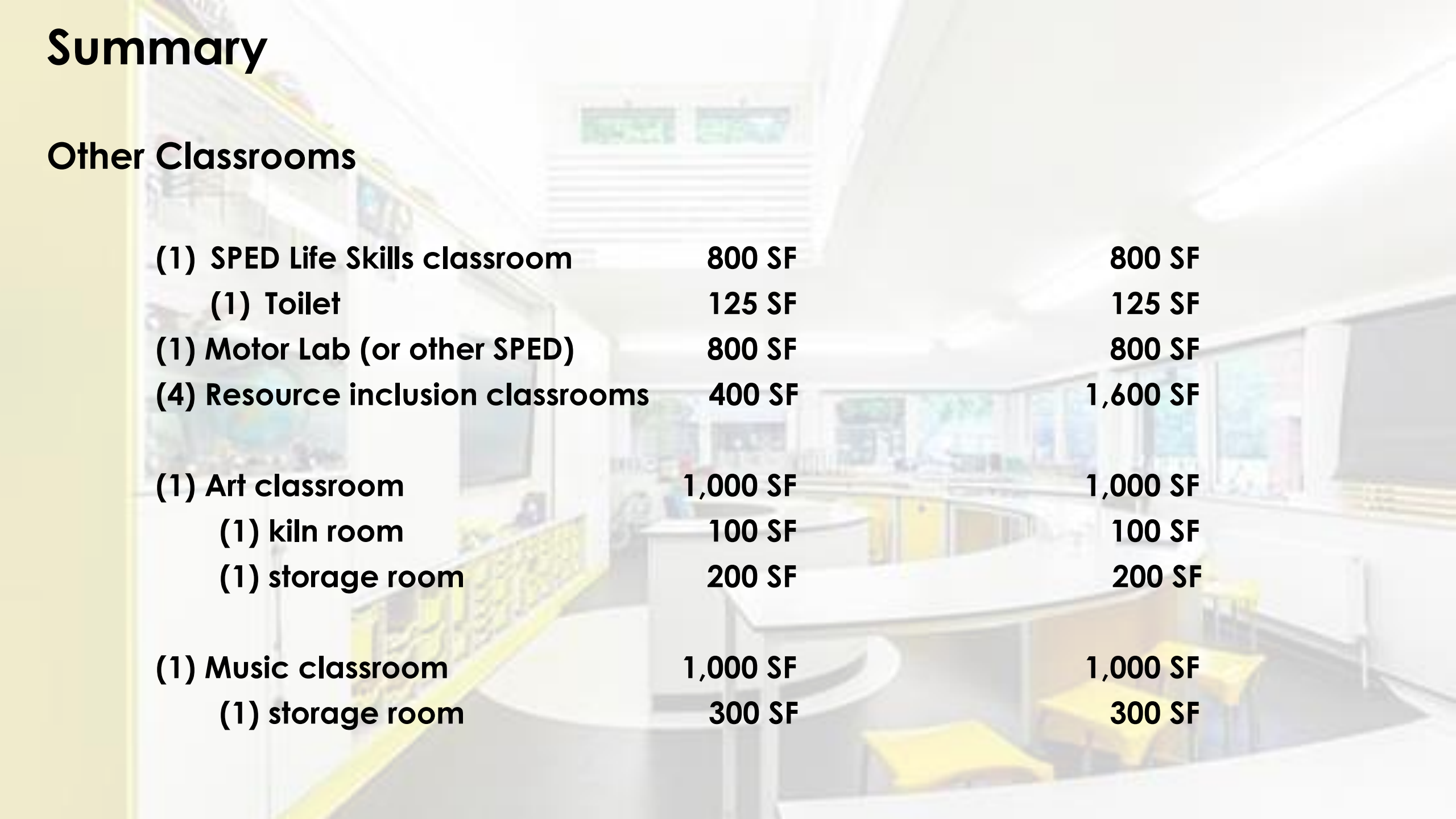

(1) SPED Life Skills classroom	800 SF	800 SF
(1) Toilet	125 SF	125 SF
(1) Motor Lab (or other SPED)	800 SF	800 SF
(4) Resource inclusion classrooms	400 SF	1,600 SF
(1) Art classroom	1,000 SF	1,000 SF
(1) kiln room	100 SF	100 SF
(1) storage room	200 SF	200 SF
(1) Music classroom	1,000 SF	1,000 SF
(1) storage room	300 SF	300 SF

Summary

PE & Cafetorium

(1) Gym (50x84 court)	4,500 SF	4,500 SF
(1) storage	300 SF	300 SF
(1) office	120 SF	120 SF
(1) Cafeteria (307 lunch)	4,600 SF	4,600 SF
(1) storage	300 SF	300 SF
(1) Platform	800 SF	800 SF
(1) Storage	200 SF	200 SF
(1) Kitchen & Serving area	3,000 SF	3,000 SF
(2) Student restrooms	150 SF	300 SF
(1) Janitor	65 SF	65 SF

Summary

Office Space

- (1) Secure reception and vestibule
- (8) Offices (inc. counseling & SPED)
- (2) Conference rooms
- (4) Storage rooms (various sizes)
- (1) ISS
- (2) restroom

- (1) Health Services
- (1) Teacher work center

600 SF

148 SF

250 SF

145 SF

150 SF

65 SF

500 SF

1,130 SF

600 SF

1,180 SF

500 SF

580 SF

150 SF

130 SF

500 SF

1,130 SF

Summary

Library

(1) Stack area & circulation desk	1,500 SF	1,500 SF
(1) Reading/Instruction	1,000 SF	1,000 SF
(1) office, work room, AV storage	550 SF	550 SF
(1) restroom	65 SF	65 SF
(1) Computer / digital media lab	1,000 SF	1,000 SF
(1) Science / maker space	1,250 SF	1,250 SF
(1) Prep room	250 SF	250 SF

Art

Library

Computer

**Maker
Space**

Computer

Music

**Gathering
Space**

Maker Space

Science

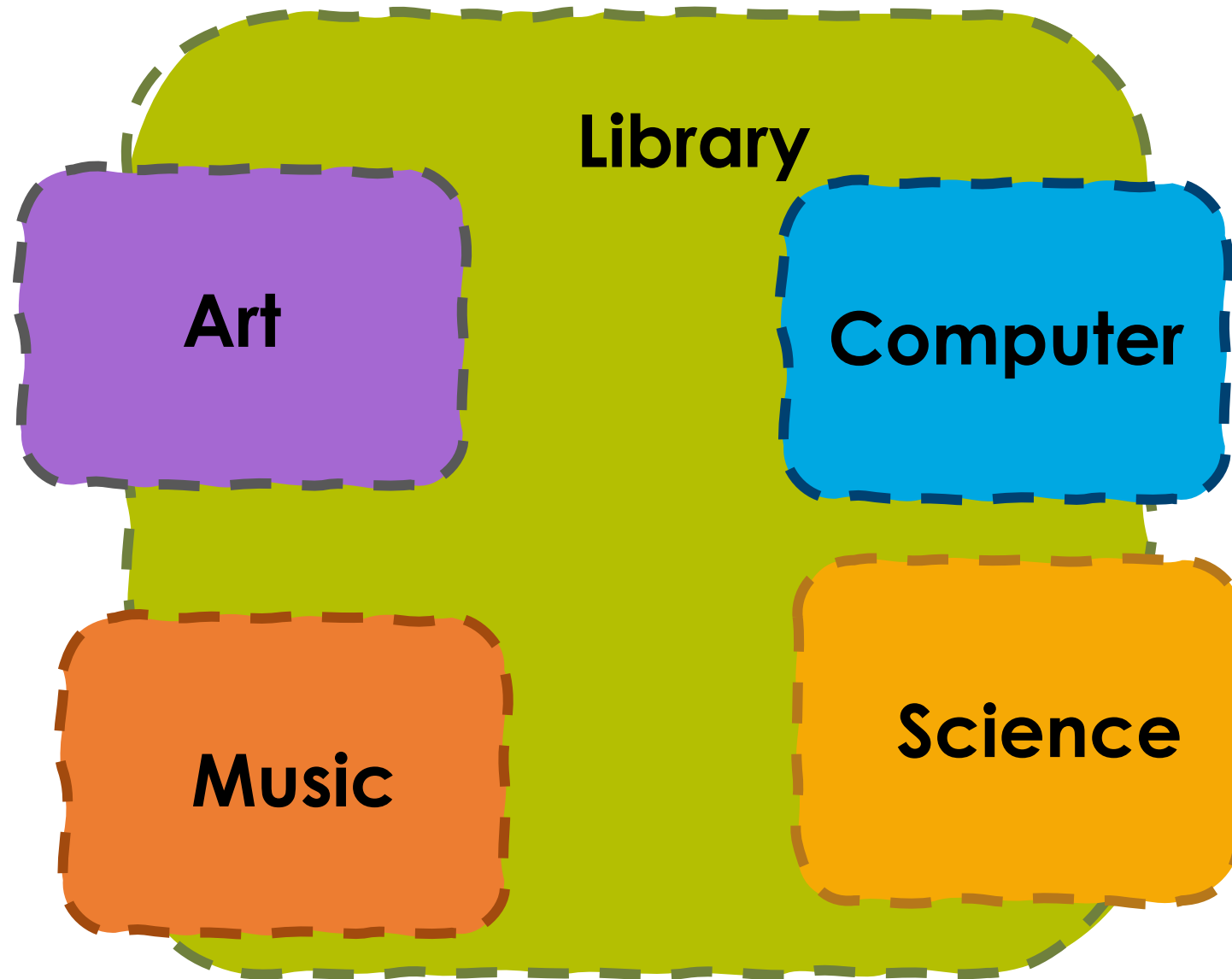

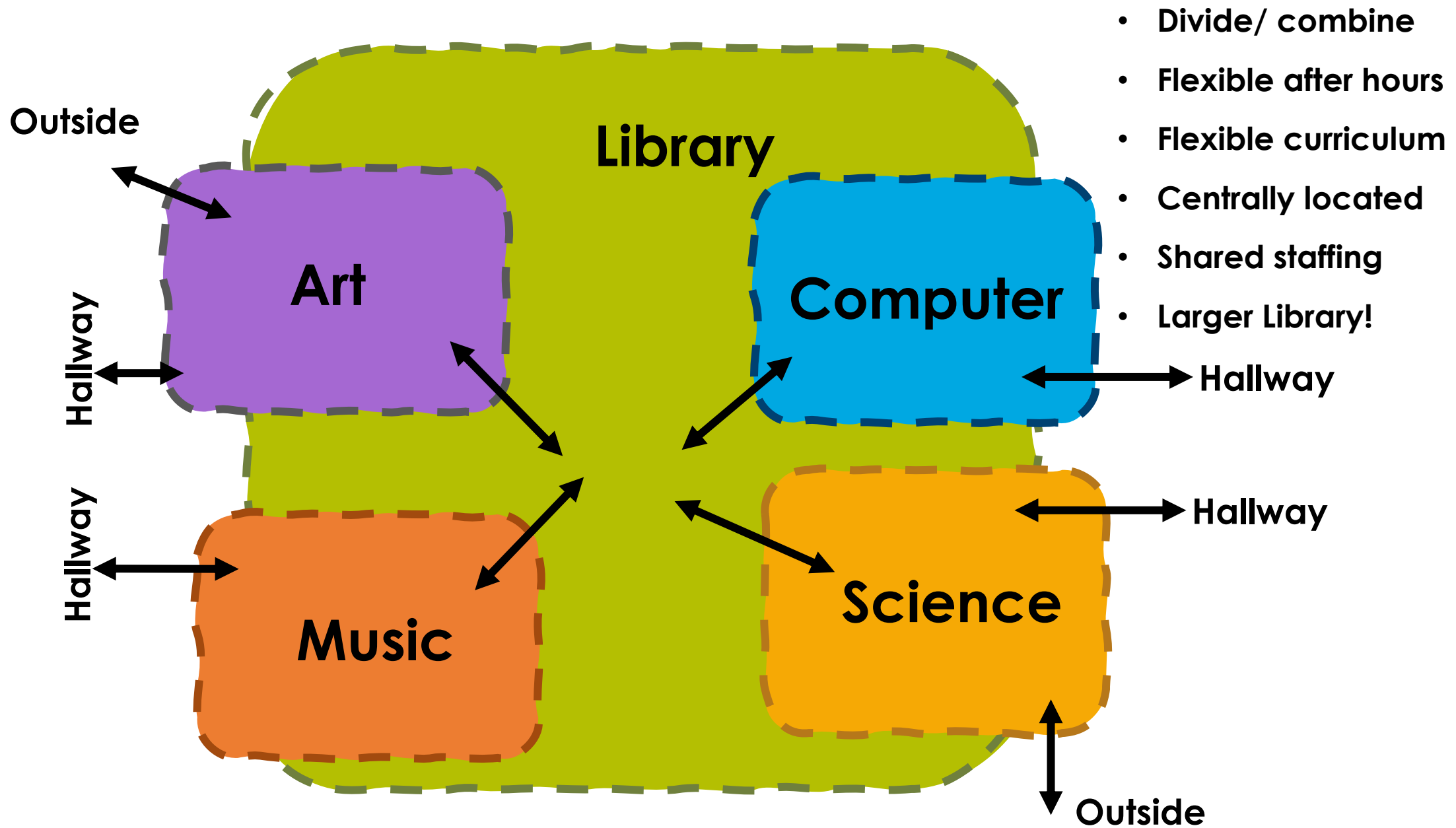

Texas Education Agency

Texas Educational Agency Analysis

Approve TEA Flexibility Level – Level 2 (36 SF/ Student)

Approximately 39,450 SF of Building Area that counts towards this factor

At Flexibility Level 2, 1,095 students could be housed on the campus

(At Flexibility Level 3, 939 students)

Recommend adopting Flexibility Level 2

Approve TEA Compliance Path:

Recommend approving the Quantitative Method

Special Education:

45 SF/Student in lieu of 40 SF/Student

Proposed spaces comply

Science Labs:

50 SF per student for a room between 24-28 students (assume 25) = 1,250 SF

10 SF per student for prep room = 250 SF per Science Lab

Proposed spaces comply

Proposed Gymnasium, Library, and computer classrooms comply with new guidelines

Educational Specifications

- (i) The district mission, vision, goals, and pedagogy

Mission: Elgin ISD ensures a high-quality education that guarantees a life-changing experience for all.

Vision: Elgin ISD changes lives

Goals:

1. Elgin ISD will increase its student achievement performance in the areas of writing, literacy, and numeracy.
2. Elgin ISD will increase teacher and administrator retention rates.
3. Elgin ISD will increase the percentage of graduating seniors that are college, career, and/or military ready (CCMR)
4. Elgin ISD will ensure consistent enforcement of safety and behavioral expectations for students and staff.

Educational Specifications

- (i) The district mission, vision, goals, and pedagogy

EISD Core Values: REACH

RESPECT: every voice matters

ELGIN PRIDE: our strength comes from embracing our diversity, community and shared history

ACCOUNTABILITY FOR ALL: shared responsibility for success

COLLABORATION: One town, one team, one family

HIGH EXPECTATIONS: Working hard and having fun

Educational Specifications

- (ii) Preliminary details related to facility type, grades served, and maximum enrollment;
 - Elementary School
 - Pre-K through 5th grades
 - Designed for 800 Students / Core for 900 Students

Educational Specifications

(iii) Pertinent provisions of the multi-hazard emergency operations plan that may inform the functionality of the built environment, including how the district complies with TEC, 37.108;

Provided by EISD

Educational Specifications

(iv) A written statement that includes:

(I) Inclusive design goals and considerations supported by the school district; and

Guiding Principles, we are developing as a team

(II) How inclusive design should be addressed in new and renovated facility designs;

The district shall follow the guiding principles, applicable adopted codes, TAS, and TEA guidelines to ensure new and renovated facilities are safe and equitable across the district.

New facilities shall follow the approved program of spaces, with some flexibility for unique circumstances and design/construction tolerances. Renovated facilities shall endeavor to comply with the approved program of spaces where feasible.

Educational Specifications

(v) Minimum total square footage required to comply with the quantitative method of compliance:

The area included in all general academic classrooms, art, music, SPED classrooms, science, and computer labs shall be no less than 28,800 SF for an 800-student campus, or 32,400 SF for a campus that can grow to 900 students.

Educational Specifications

(vi) Innovative teaching or operational practices intended for implementation at the instructional facility that may lead to the use of the qualitative method of compliance

Instructional or operational practice that distributes or manages student capacity in an innovative or non-traditional manner.

- Blended learning
- Flip classroom
- Increase in student capacity

Educational Specifications

- (B) Schedule. An educational specification shall be created for each campus type. If the design and construction of a new campus or major renovation of an existing campus differs substantially from an education specification that exists for the same campus type, a separate educational specification must be developed. Educational specifications shall be initiated upon the first proposed project of its type and must be completed prior to initiating the planning or programming phase of a project. Each educational specification must be updated after five years from the date of approval
- (C) Compliance. The requirement for educational specification is met when a school district delivers the approved document to the architect.

Next Steps...

- Workshop #3 – March 30th
- Padlet feedback

