



ELGIN ISD

ONE TOWN • ONE TEAM • ONE FAMILY

Elgin High School: CLASSROOMS & CAFETERIA

Design Meeting #3

April 21, 2022



S & P

Talking Points

Project Overview, Scope & Program

Review Refined Site Plan Options

Review Refined Floor Plan Options

Next Steps

Project Overview and Scope



ELGIN HIGH SCHOOL IMPROVEMENTS DESIGN & CONSTRUCTION SCHEDULE - REV. 03/04/2022

YEAR	2022												2023												2024											
WORK ITEM	FEB	MAR	APR	MAY	JUN	JUL	AUG	SEP	OCT	NOV	DEC	JAN	FEB	MAR	APR	MAY	JUN	JUL	AUG	SEP	OCT	NOV	DEC	JAN	FEB	MAR	APR	MAY	JUN	JUL	AUG	SEP	OCT	NOV	DEC	
Design Phase (02/2022 - 06/2022)																																				
Schematic Design : February - April 2022																																				
Project Kick-Off Meeting - 02/15/2022																																				
Programming Meeting - 02/24/2022																																				
Design Meeting No. 1 - 03/10/2022																																				
Design Meeting No. 2 - 03/31/2022																																				
Design Meeting No. 3 - 04/21/2022																																				
Design Development : May - June 2022																																				
Department Meeting No. 1 - Week of 05/02/2022																																				
Department Meeting No. 2 - Week of 05/23/2022																																				
50% VE Review - 06/06/2022																																				
Department Meeting No. 3 - Week of 06/20/2022																																				
Construction Documents Phase (07/2022 - 11/2022)																																				
50% Hard copies to the EISD & LAN - 09/12/2022																																				
LAN VE Review - Week of 09/26/2022																																				
75% Hard copies to EISD & LAN - 10/17/2022																																				
75% Page Turn Review with EISD & LAN - TBD																																				
95% Hard copies to EISD & LAN - 11/18/2022																																				
95% Page Turn Review with EISD & LAN - TBD																																				
100% Issue for Proposal/Permit - 11/30/2022																																				
Bidding (12/2022 - 01/2023)																																				
Bid Day - TBD																																				
GMP to Elgin ISD - TBD																																				
GMP Board Approval - TBD																																				
Permit (TBD)																																				
Construction Phase (02/2023 - 10/2024)																																				
Closeout Phase (10/2024 - 11/2024)																																				





ELGIN HIGH SCHOOL ADDITIONS AND CTE EXPANSION

DETAILED DESIGN SCHEDULE

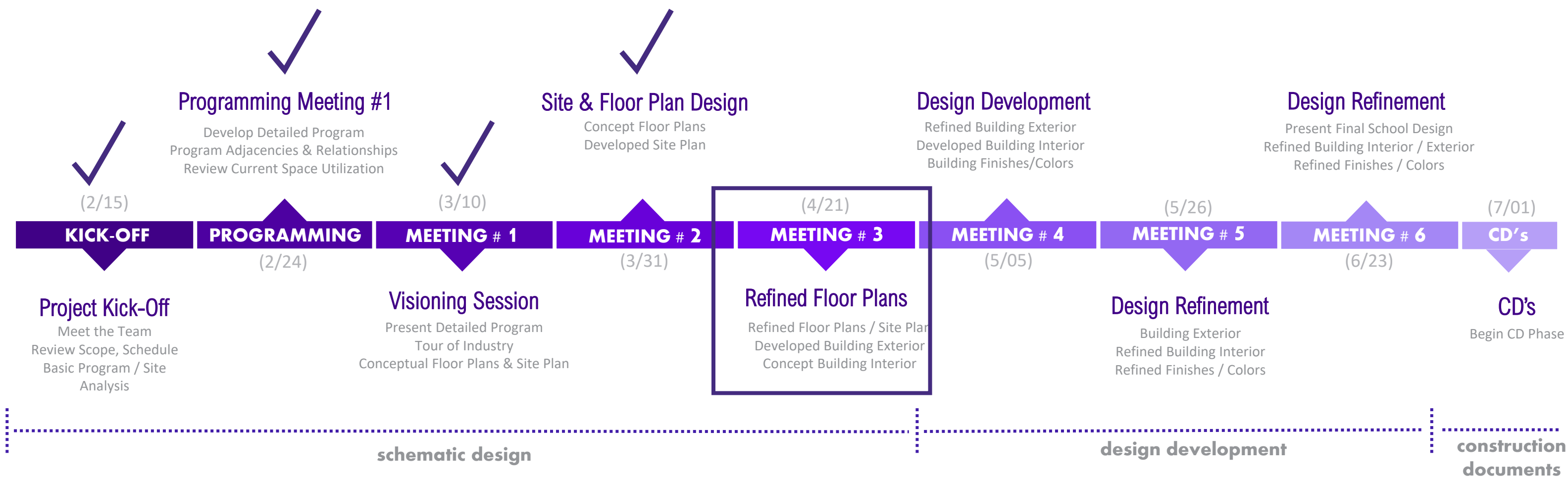

ELGIN HIGH SCHOOL: OVERALL EXISTING SITE PLAN



country line rd



Floor Plan Concepts – Site Plan

ELGIN HIGH SCHOOL: OVERALL SITE PLAN - CONCEPT 1A

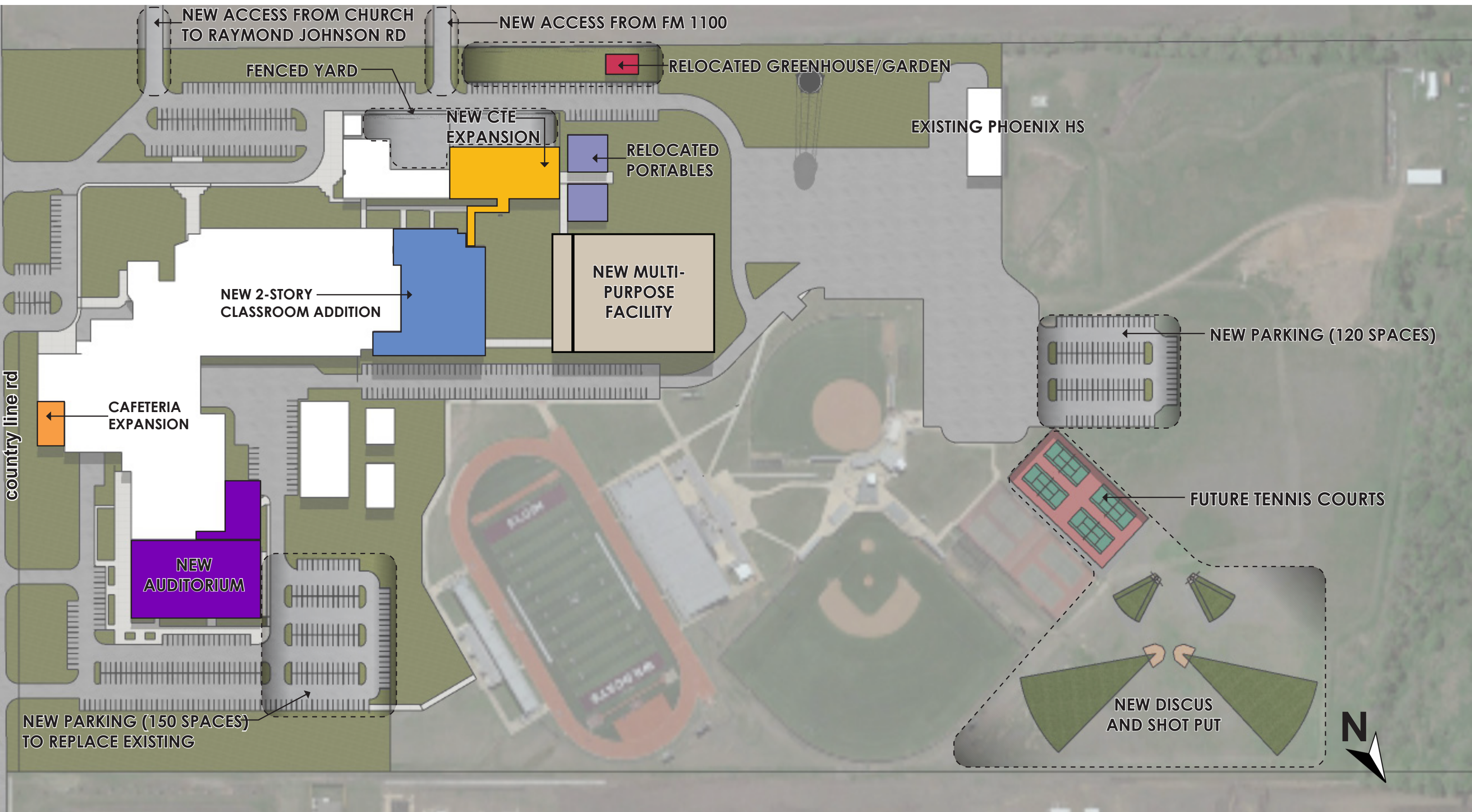

ELGIN HIGH SCHOOL: OVERALL SITE PLAN - CONCEPT 1B

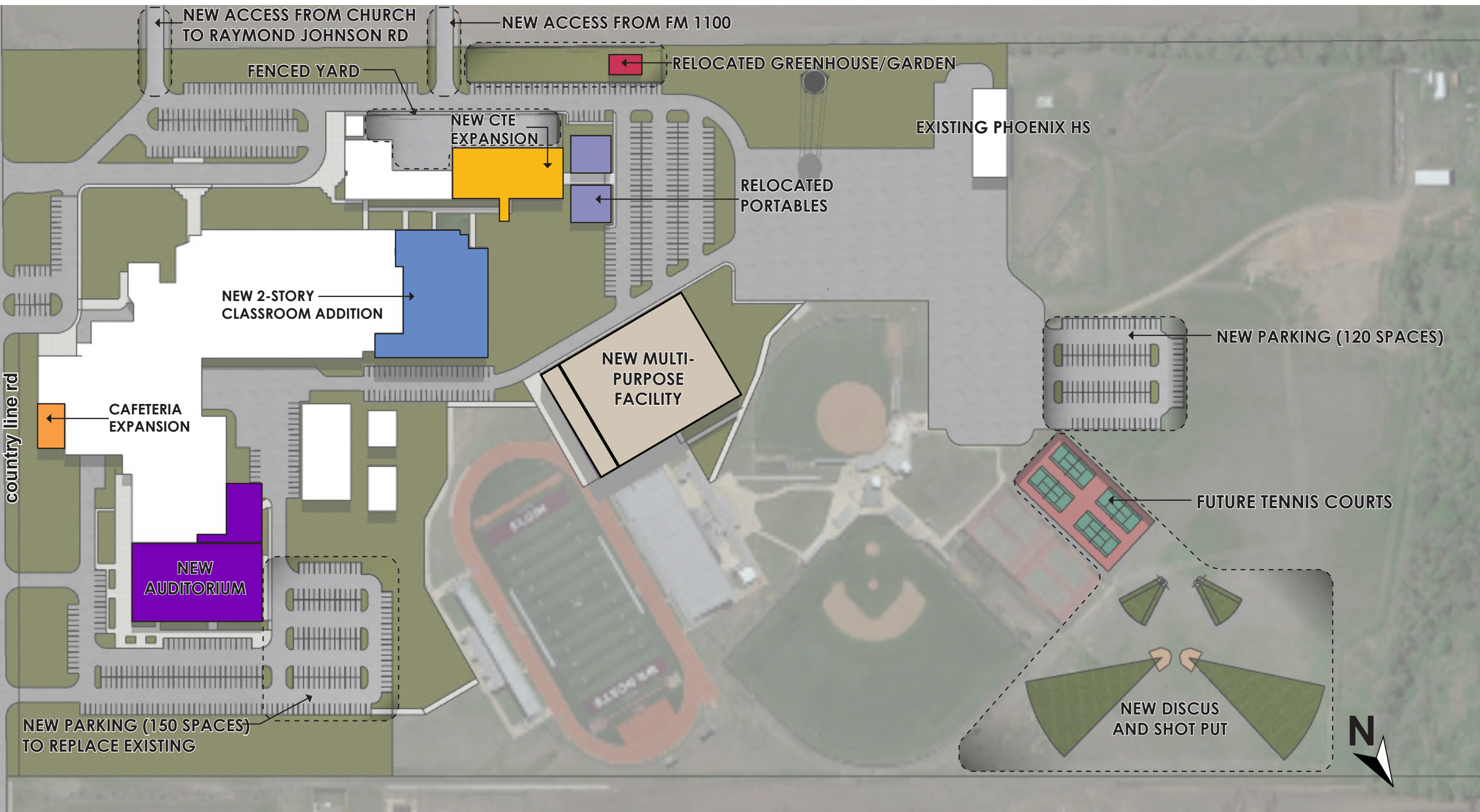

ELGIN HIGH SCHOOL ADDITIONS AND CTE EXPANSION

ELGIN INDEPENDENT SCHOOL DISTRICT

April 21, 2022



ELGIN HIGH SCHOOL: OVERALL SITE PLAN - CONCEPT 2A

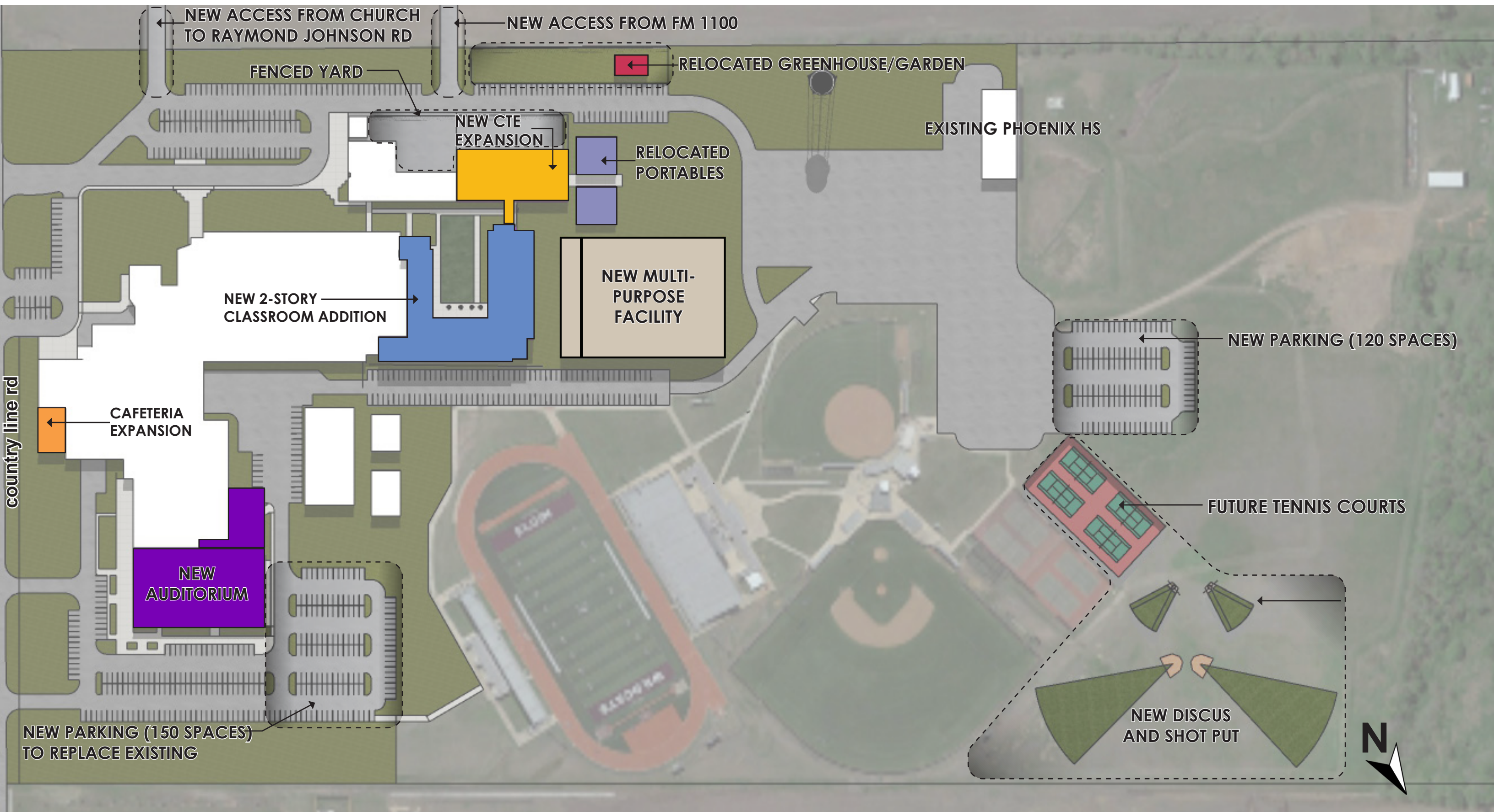

ELGIN HIGH SCHOOL: OVERALL SITE PLAN - CONCEPT 2B

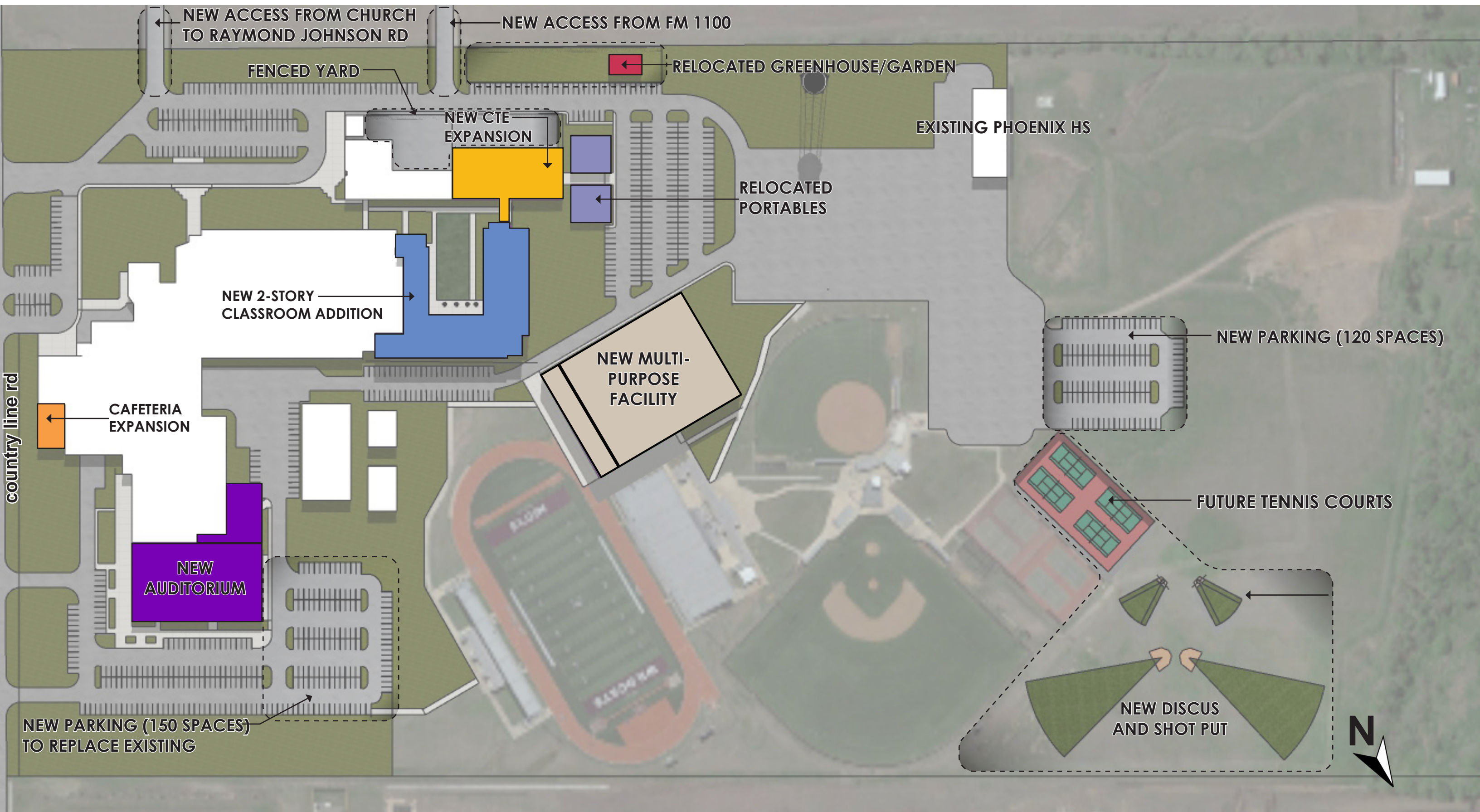

Floor Plan Concepts

CLASSROOMS: CONCEPT 2 FIRST & SECOND FLOOR PLAN



FIRST FLOOR PLAN

ELGIN HIGH SCHOOL ADDITIONS AND CTE EXPANSION

ELGIN INDEPENDENT SCHOOL DISTRICT



SECOND FLOOR PLAN

CAFETERIA: CONCEPT FLOOR PLAN

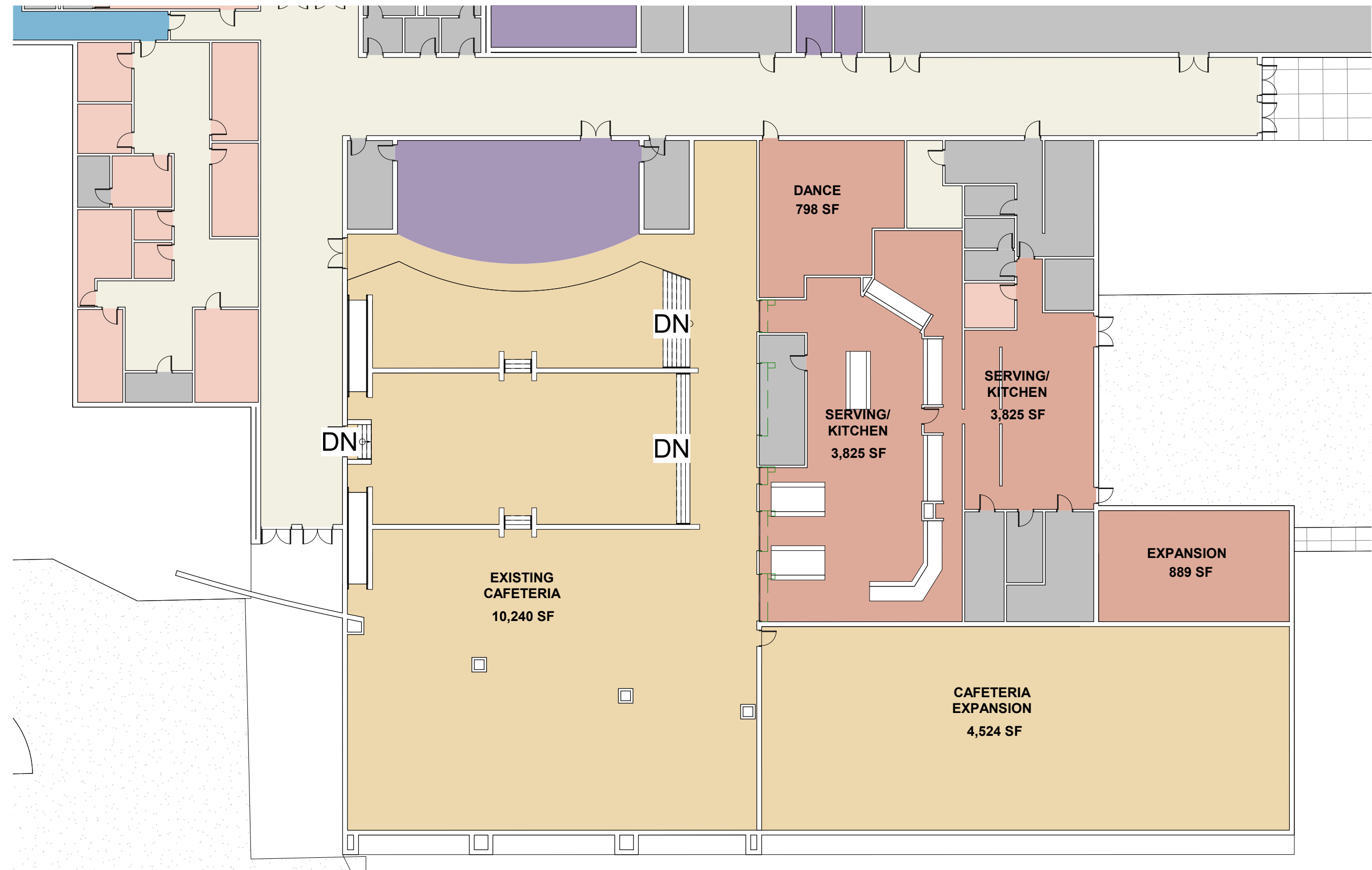

CAFETERIA: CONCEPT FLOOR PLAN WITH KIOSK

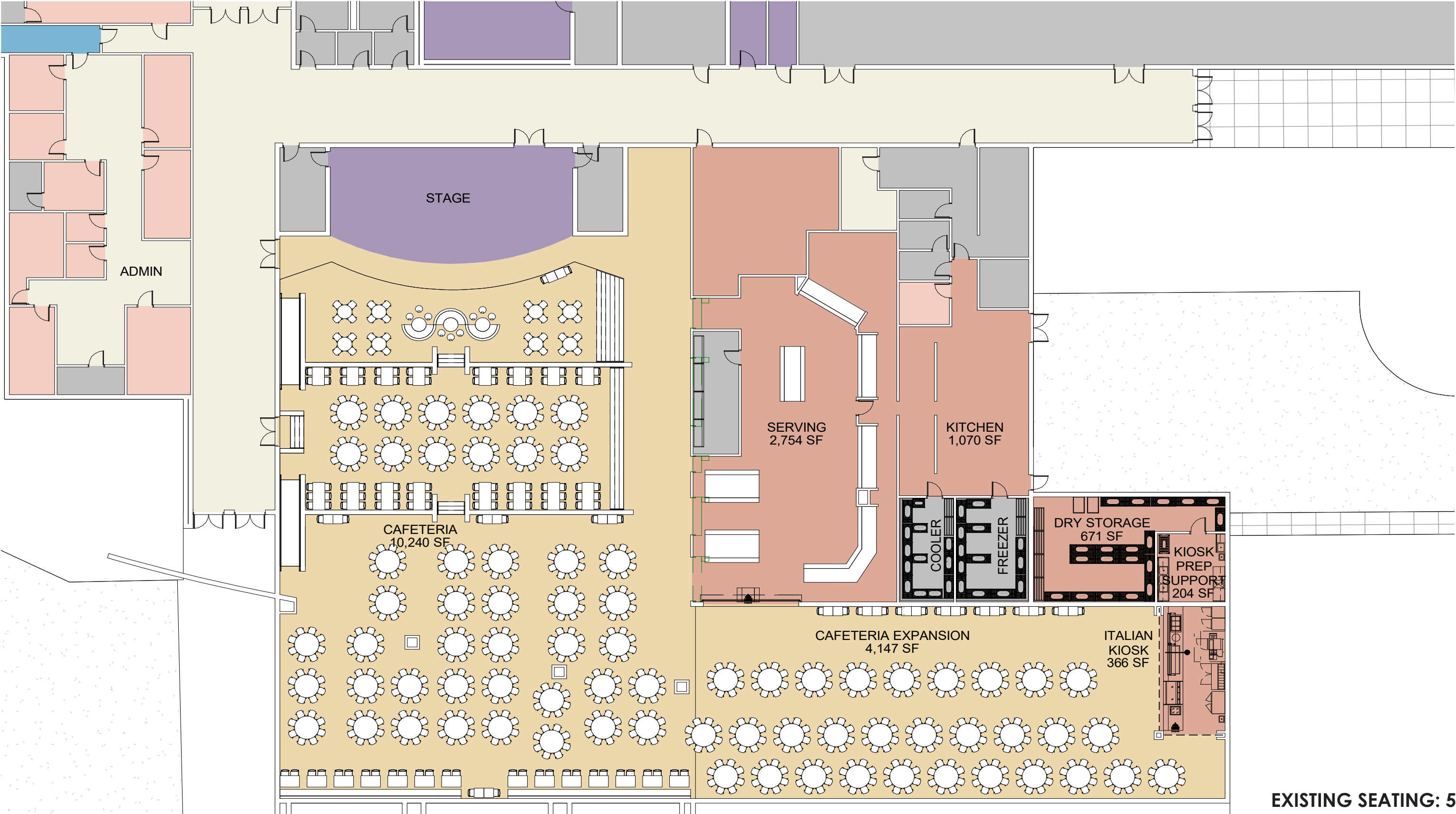

EXISTING SEATING: 592
NEW SEATING: 802

Interior Renderings

CAFETERIA: INTERIOR RENDERING



CAFETERIA: INTERIOR RENDERING



CAFETERIA: INTERIOR RENDERING



Next Steps

Refine building exterior, refine building interior, review options for building finishes and color selection.

Design Development Commences

Department Meeting #1 - May 5, 2022



ELGIN ISD

ONE TOWN • ONE TEAM • ONE FAMILY

thank you!

CLASSROOM OPTIONS : COST ESTIMATE

Elgin ISD - HS Additions & CTE - Concept #0				
Scope	Quantity	Unit	Extension	
Concrete @ Parking Lot	82,260	SF	Included Below	
Exterior Perimeter of Classroom addition (32' H)	18,518	SF	Included Below	
Flooring - Classroom Add. 1st Floor	32,800	SF	\$	11,478,360
Flooring - Classroom Add. 2nd Floor	32,200	SF	\$	11,268,390
Flooring - Auditorium	30,020	SF	\$	17,887,417
CTE Expansion	17,500	SF	\$	7,044,625
Cafeteria	5,000	SF	\$	1,527,250
			\$	-
			\$	49,206,042
Estimate Variance from Concept #0			\$	-

CONCEPT #0: \$49,206,042

Elgin ISD - HS Additions & CTE - Concept #1				
Scope	Quantity	Unit	Extension	
Concrete @ Parking Lot (180 + 150 Spaces)	84,371	SF	Included Below	
Concrete @ Parking Lot (180 + 150 Spaces) - Delta	2,111	SF	\$	52,775
Exterior Perimeter of Classroom addition	18,518	SF	Included Below	
Flooring - Classroom Add. 1st Floor	32,800	SF	\$	11,478,360
Flooring - Classroom Add. 2nd Floor	32,200	SF	\$	11,268,390
Flooring - Auditorium	30,080	SF	\$	17,923,168
Existing Conditions at HS Demolition/Tie Ins	1	LS	\$	225,000
CTE Expansion	17,500	SF	\$	7,044,625
Cafeteria	5,000	SF	\$	1,527,250
			\$	-
			\$	49,519,568
Estimate Variance from Concept #0			\$	313,526

CONCEPT #1: \$49,519,568

Elgin ISD - HS Additions & CTE - Concept #2				
Scope	Quantity	Unit	Extension	
Concrete @ Parking Lot (180 + 150 Spaces)	84,371	SF	Included Below	
Concrete @ Parking Lot (180 + 150 Spaces) - Delta	2,111	SF	\$	52,775
Exterior Perimeter of Classroom addition - Delta	17,657	SF	\$	723,178
Flooring - Classroom Add. 1st Floor	32,900	SF	\$	11,513,355
Flooring - Classroom Add. 2nd Floor	31,800	SF	\$	11,128,410
Flooring - Auditorium	30,080	SF	\$	17,923,168
Existing Conditions at HS Demolition/Tie Ins	1	LS	\$	225,000
CTE Expansion	17,500	SF	\$	7,044,625
Cafeteria	5,000	SF	\$	1,527,250
Courtyard Expansion	15,806	SF	\$	250,000
			\$	50,387,761
Estimate Variance from Concept #0			\$	1,181,719

CONCEPT #2: \$50,387,761