



**ELGIN ISD**

ONE TOWN • ONE TEAM • ONE FAMILY

# *Elgin High School: CLASSROOMS*

*Design Meeting #2*

*March 31, 2022*



S & P

Talking Points

**Project Overview, Scope & Program**

**Review Concept Floor Plans**

**Next Steps**

# *Project Overview and Scope*



ELGIN HIGH SCHOOL IMPROVEMENTS DESIGN & CONSTRUCTION SCHEDULE - REV. 03/04/2022

YEAR	2022												2023												2024											
WORK ITEM	FEB	MAR	APR	MAY	JUN	JUL	AUG	SEP	OCT	NOV	DEC	JAN	FEB	MAR	APR	MAY	JUN	JUL	AUG	SEP	OCT	NOV	DEC	JAN	FEB	MAR	APR	MAY	JUN	JUL	AUG	SEP	OCT	NOV	DEC	
Design Phase (02/2022 - 06/2022)																																				
Schematic Design : February - April 2022																																				
Project Kick-Off Meeting - 02/15/2022																																				
Programming Meeting - 02/24/2022																																				
Design Meeting No. 1 - 03/10/2022																																				
Design Meeting No. 2 - 03/31/2022																																				
Design Meeting No. 3 - 04/21/2022																																				
Design Development : May - June 2022																																				
Department Meeting No. 1 - Week of 05/02/2022																																				
Department Meeting No. 2 - Week of 05/23/2022																																				
50% VE Review - 06/06/2022																																				
Department Meeting No. 3 - Week of 06/20/2022																																				
Construction Documents Phase (07/2022 - 11/2022)																																				
50% Hard copies to the EISD & LAN - 09/12/2022																																				
LAN VE Review - Week of 09/26/2022																																				
75% Hard copies to EISD & LAN - 10/17/2022																																				
75% Page Turn Review with EISD & LAN - TBD																																				
95% Hard copies to EISD & LAN - 11/18/2022																																				
95% Page Turn Review with EISD & LAN - TBD																																				
100% Issue for Proposal/Permit - 11/30/2022																																				
Bidding (12/2022 - 01/2023)																																				
Bid Day - TBD																																				
GMP to Elgin ISD - TBD																																				
GMP Board Approval - TBD																																				
Permit (TBD)																																				
Construction Phase (02/2023 - 10/2024)																																				
Closeout Phase (10/2024 - 11/2024)																																				





# ELGIN HIGH SCHOOL ADDITIONS AND CTE EXPANSION

DETAILED DESIGN SCHEDULE

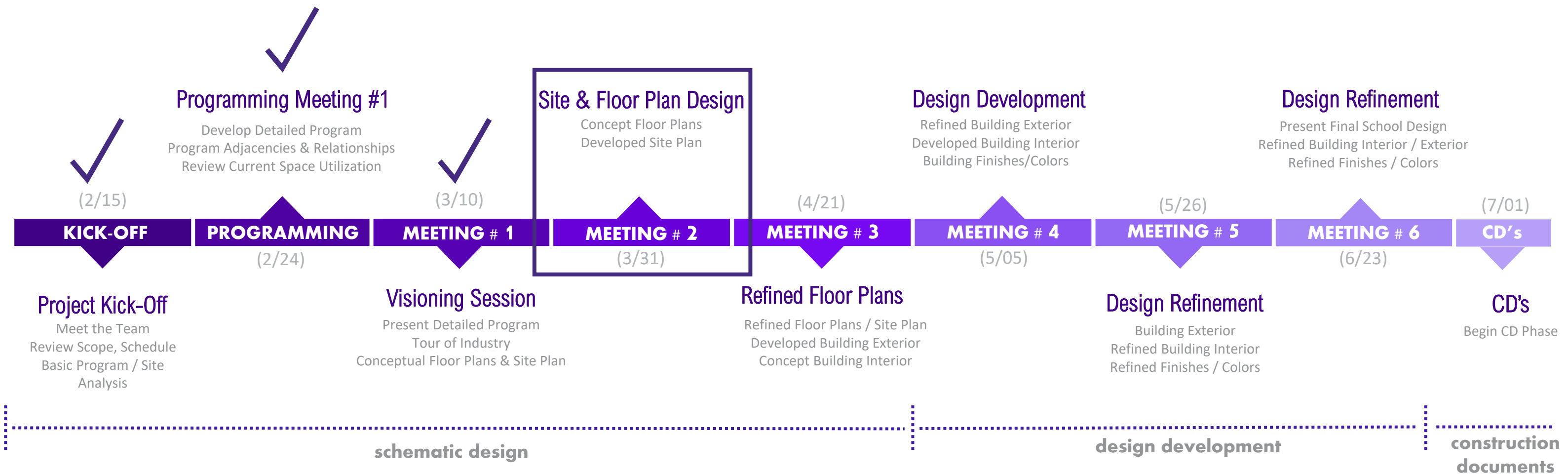



ELGIN HIGH SCHOOL: OVERALL EXISTING SITE PLAN



country line rd





# *Capacity Study & Program Recap*

# CLASSROOM ADDITIONS: CAPACITY STUDY

## Capacity Study: Current and Future

Space / Function	Teaching Spaces	Student/Space	% Utilization	Total Students	Notes
Existing Academic Teaching Station					
General Classrooms	48	24	85%	979	
Science Labs	9	24	85%	184	
Existing Elective / Career Tech Stations					
CTE Classrooms	8	24	85%	163	existing portable to be reused
Elective Classrooms	6	24	85%	122	
Bio-Tech Lab	1	24	85%	20	
Ag Shop	1	24	85%	20	
Auto Tech Lab	1	24	85%	20	
Choir	1	25	85%	21	
Drama	1	25	85%	21	
Band	1			-	not counted for capacity
Special Ed	2			-	not counted for capacity
Computer Labs	1			-	not counted for capacity
Current Total Student Capacity				1,552	85% Utilization
New Additions					
General Classrooms	17	25	85%	361	
ECHS Classrooms	10	25	85%	213	
Science Labs	8	24	85%	163	
Art Labs	3	24	85%	61	reuse existing art lab for classroom space
HVAC/ Electrical Lab Classrooms	2	24	85%	41	
Health Lab Classrooms	2	24	85%	41	
Welding Shop Classroom	1	24	85%	20	
Dance	1	40	85%	34	
Total Future Student Capacity				2,486	85% Utilization



# CLASSROOM ADDITIONS: PROGRAM

Program of Spaces (DRAFT)				
Space / Function	Quantity	SF/Unit	Total NSF	Notes
Academic Spaces				
General Classrooms	17	800	13,600	25 students / classroom (32 SF/student)
ECHS Classrooms	10	800	8,000	operable partitions/ close to buses
Science Lab Combo	8	1,400	11,200	24 students / lab (58 SF/student)
Science Prep Rooms	4	240	960	minimum TEA
Resource Rooms	2	400	800	
Specialized Classrooms (lifeskills)		1,000	-	repurpose existing art lab space
Lifeskills kitchen / washer/dryer		200	-	repurpose existing art lab storage
Lifeskills restroom / changing		200	-	repurpose existing art lab storage and office
Art Labs	3	1,200	3,600	school currently has one art lab; need 3 total
Art storage	2	200	400	
Kiln	1	150	150	
Total Net Academic			38,710	
Teacher/Admin Spaces				
AP Office	2	175	350	1 AP / 350 students (currently have 5)
Counselors Office	3	200	600	1 counselor / 350 students (currently have 4)
ECHS Office	1	150	150	close to ECHS classrooms
Department Storage	2	200	400	
Teacher Workroom	1	800	800	centrally located
Total Net Teacher/ Admin			2,300	
Building Support				
SRO Office	1	175	175	centrally located
Restrooms	4	280	1,120	
Staff Restrooms	4	100	400	
Custodial Closets	2	120	240	
Custodial General Storage	1	200	200	
Electrical Room	4	120	480	confirm quantity with MEP
IDF Room	4	110	440	confirm quantity with MEP
Total Net Building Support			3,055	
Building Total NSF			44,065	
				Circulation and walls subject to change depending on configuration
Circulation / Walls			19,829	45.00%
Total Gross Square Feet (GSF)			63,894	

*floor plan concepts*



# OVERALL SITE PLAN: CONCEPT 2

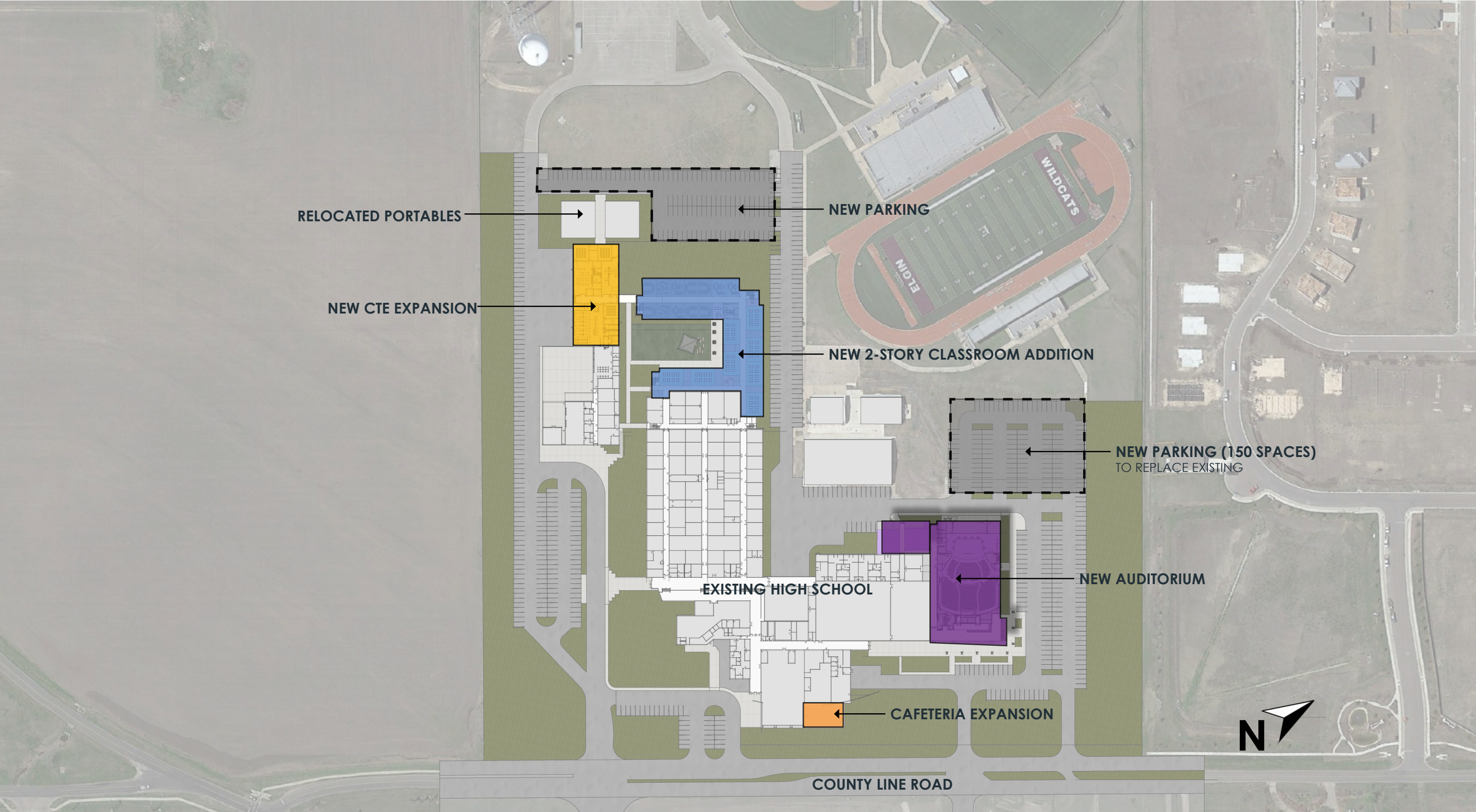



# OVERALL SITE PLAN: CONCEPT 3

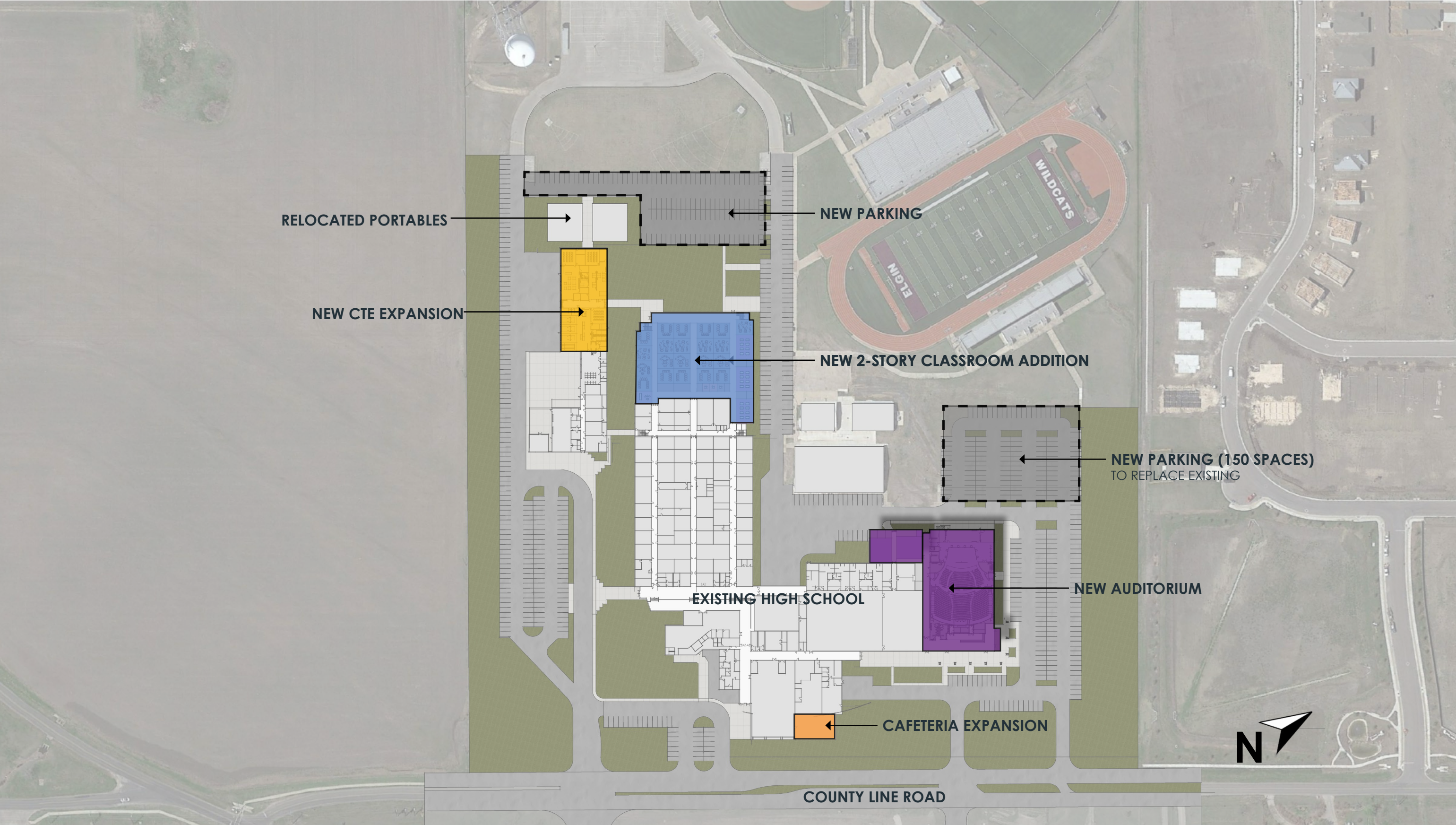



# CLASSROOMS: CONCEPT 1 FIRST & SECOND FLOOR PLAN

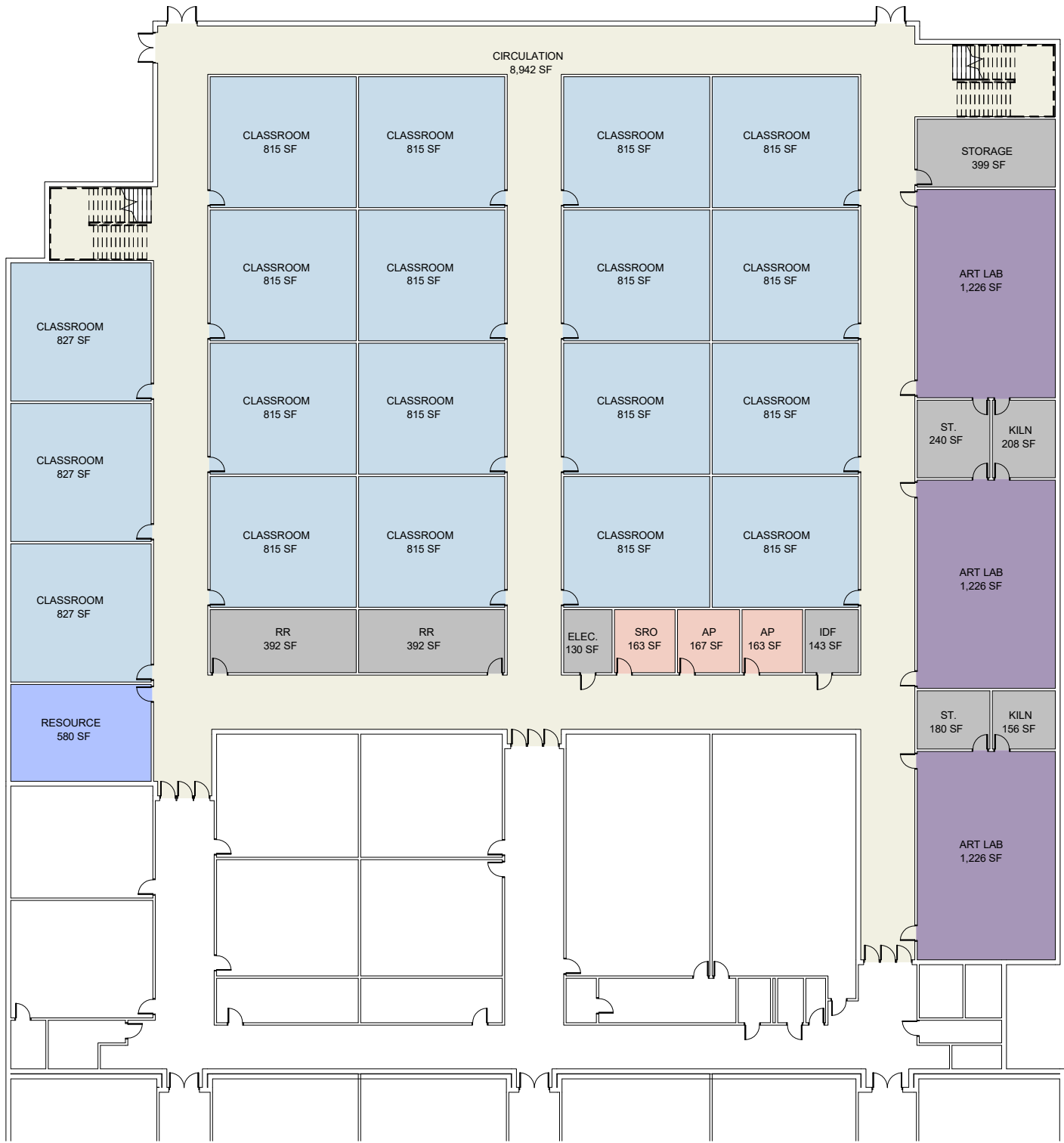

FIRST FLOOR PLAN



SECOND FLOOR PLAN

## CLASSROOMS: CONCEPT 2 FIRST & SECOND FLOOR PLAN



## FIRST FLOOR PLAN

## ELGIN HIGH SCHOOL ADDITIONS AND CTE EXPANSION

ELGIN INDEPENDENT SCHOOL DISTRICT



## SECOND FLOOR PLAN

March 31, 2022





# CAFETERIA: CONCEPT FLOOR PLAN

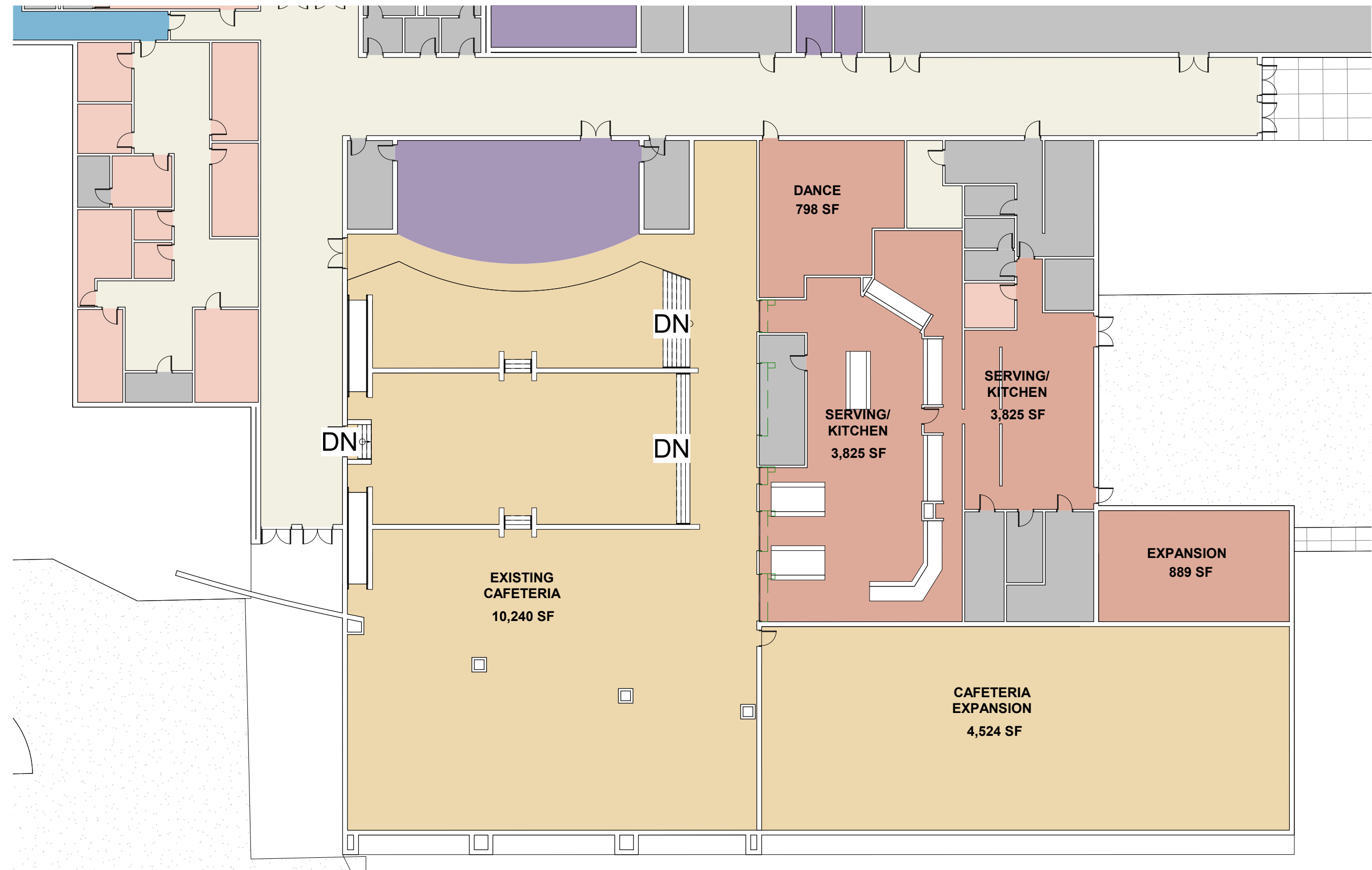

# Next Steps

Continue to develop floor plans and site based on today's feedback  
Develop Classroom and Cafe expansion exterior and interior spaces

SD Meeting #3: April 21, 2022



**ELGIN ISD**

ONE TOWN • ONE TEAM • ONE FAMILY

*thank you!*