



May 19, 2023

Sent via email to: [sfranco@mpcsd.org](mailto:sfranco@mpcsd.org)

Ms. Sandra Guevara  
Menlo Park City School District  
181 Encinal Avenue  
Atherton, CA 94027

**Re: Lead in Drinking/Cooking Water Sampling  
Hillview Middle School**  
1100 Elder Avenue, Menlo Park, CA  
ACC Project No: 3238-001.01

Dear Ms. Guevara:

ACC presents this project documentation package, summarizing project activities designed and/or supervised by ACC Environmental Consultants, Inc. (ACC). ACC was authorized by Sandra Guevara with Menlo Park City School District to provide water-monitoring services for Hillview Middle School, located at 1100 Elder Avenue, Menlo Park, California. Services were performed in accordance with the scope of work outlined in ACC proposal 81302, dated Tuesday, April 18, 2023.

## CONTAMINANTS OF CONCERN

ACC conducted water sampling during zero occupancy periods at the site. The primary contaminant of concern surveyed in this assessment is total lead. The California State Water Resource Control Board regulates these contaminants under AB2370. The CSWRCB has set the lead water limits to 5 parts per billion (ppb).

The primary exposure to lead in this setting is the ingestion of lead dissolved or suspended in water. Symptoms of lead exposure include weakness or exhaustion (lassitude), insomnia, weight loss, malnutrition, constipation and abdominal pain, anemia, tremors, kidney disease hypertension, and others. Lead is particularly harmful to young children and developing embryos and can lead to a range of developmental problems.

## SAMPLING METHODOLOGIES

Water sampling was conducted by Rachael Gehrman of ACC Environmental Consultants on April 19, 2023, following the recommended sampling procedures for lead in water as outlined below:

### Sampling

Activities began and were completed before the first person arrived on site in the morning, aside from the sampler and the site representative. Activities included:

- Verification that no tampering or outlet use has been conducted.
- Verification that no leaks were present.
- Verification that adequate stagnation time had passed (a minimum of 8-hours).

[www.accenv.com](http://www.accenv.com)

Southern California: 1055 Wilshire Boulevard, Suite 1450 • Los Angeles, CA 90017 • (213) 353-1240 • Fax (213) 353-1244  
Northern California: 7977 Capwell Drive, Suite 100 • Oakland, CA 94621 • (510) 638-8400 • Fax (510) 638-8404

- Verification that the map was complete and updated.
- Removal of the bagging and signage for the sample outlets.
- Sampling each sample outlet and obtaining 100% of flow without spillage.
- Sampling final flush sample after 30-second flush has occurred and without spillage.
- Removal of all signage throughout facility after sampling is completed.
- Completion of facility checklist, facility and yard map, and self-certification questionnaire.
- Completion of sample chain of custody.

## SAMPLING RESULTS

The results of sampling are outlined below:

Sample ID	Sample Location	Analyte	Concentration (ppb)	Limit (ppb)
W-1-1	Staff Room Kitchen	Lead	<1.00	5
W-1-2	Staff Room Kitchen – Post Flush	Lead	<1.00	5
W-2-1	Library Kitchen Faucet	Lead	<1.00	5
W-2-2	Library Kitchen Faucet – Post Flush	Lead	<1.00	5
W-3-1	G-8 Fountain (3 <sup>rd</sup> from left)	Lead	<1.00	5
W-3-2	G-8 Fountain (3 <sup>rd</sup> from left) – Post Flush	Lead	<1.00	5
W-4-1	G-8 Fountain (5 <sup>th</sup> from left)	Lead	1.74	5
W-4-2	G-8 Fountain (5 <sup>th</sup> from left) – Post Flush	Lead	<1.00	5
W-5-1	G-9 Fountain (left most)	Lead	1.25	5
W-5-2	G-9 Fountain (left most) – Post Flush	Lead	1.18	5
W-6-1	G-9 Fountain (4 <sup>th</sup> from left)	Lead	<1.00	5
W-6-2	G-9 Fountain (4 <sup>th</sup> from left) – Post Flush	Lead	<1.00	5
W-7-1	G-9 Fountain (3 <sup>rd</sup> from left)	Lead	1.13	5
W-7-2	G-9 Fountain (3 <sup>rd</sup> from left) – Post Flush	Lead	<1.00	5
W-8-1	G-9 Fountain (6 <sup>th</sup> from left)	Lead	<1.00	5
W-8-2	G-9 Fountain (6 <sup>th</sup> from left) – Post Flush	Lead	<1.00	5
W-9-1	C-8 Fountain	Lead	<1.00	5
W-9-2	C-8 Fountain – Post Flush	Lead	<1.00	5

## RESULTS AND RECOMENDATIONS

The results did not indicate concentrations above the threshold of 5 ppb.

## CLOSING

Eighteen (18) total samples were collected from sample outlets utilized at the facility. All eighteen samples were direct pulls from the active outlets. Lead was not detected above the Reporting Limit in any of the samples. This should not pose a risk to health.

The attached documents provide further details for this Lead Assessment. Please contact ACC Project Manager, Rachael Gehrman at (510) 710-8543, or email [rgehrman@accenv.com](mailto:rgehrman@accenv.com) if you have any questions. Thank you for including ACC in this project. We are available to help with any of the findings and recommendations contained in this report.

Sincerely,  
ACC Environmental Consultants, Inc.



Rachael C. Gehrman  
Associate Project Manager  
Certified Asbestos Consultant #22-7069  
CDPH Lead I/A/PM (LRC#6277 & 7004)

## ATTACHMENTS

- LA Testing Report – 4/25/2023 – Lead via Method 200.8 – LA Testing Order #332307134
- Chain of Custody – 4/19/2023
- 5/25/2023 –Self Certification Form
- Facility Map



## LA Testing

5431 Industrial Drive, Huntington Beach, CA 92649

Phone: (714) 828-4999 Fax: (714) 828-4944 Email: [gardengrovelab@latesting.com](mailto:gardengrovelab@latesting.com)

---

Attn: **Michael Burrows**  
**ACC Environmental Consultants, Inc.**  
**7977 Capwell Drive**  
**Suite 100**  
**Oakland, CA 94621**

4/25/2023

Phone: (510) 638-8400  
Fax:

The following analytical report covers the analysis performed on samples submitted to LA Testing on 4/20/2023. The results are tabulated on the attached data pages for the following client designated project:

**HILLVIEW MIDDLE SCHOOL: 1100 ELDER AVE. MENLO PARK,  
CA: 3238-001.01**

The reference number for these samples is EMSL Order #332307134. Please use this reference when calling about these samples. If you have any questions, please do not hesitate to contact me at (714) 828-4999.

Approved By:

---

Michael Chapman, Laboratory Manager

Chemical Testing

The samples associated with this report were received in good condition unless otherwise noted. This report relates only to those items tested as received by the laboratory. This report may not be reproduced except in full and without written approval by EMSL Analytical, Inc. A2LA accredited chemical testing laboratory for Lead in Paint by Inductively Coupled Plasma (ICP), Total Lead in Children's Metal Jewelry and Phthalates.



# LA Testing

5431 Industrial Drive, Huntington Beach, CA 92649  
 Phone/Fax: (714) 828-4999 / (714) 828-4944  
<http://www.LATesting.com> [gardengrovelab@latesting.com](mailto:gardengrovelab@latesting.com)

LA Testing Order: 332307134  
 CustomerID: ACCE56  
 CustomerPO:  
 ProjectID:

Attn: **Michael Burrows**  
**ACC Environmental Consultants, Inc.**  
**7977 Capwell Drive**  
**Suite 100**  
**Oakland, CA 94621**

Phone: (510) 638-8400  
 Fax:  
 Received: 4/20/2023 10:40 AM  
 Collected: 4/19/2023

Project: HILLVIEW MIDDLE SCHOOL: 1100 ELDER AVE. MENLO PARK, CA: 3238-001.01

## Analytical Results

**Client Sample Description** W-1-1  
STAFF ROOM KITCHEN  
**Collected:** 4/19/2023  
**Lab ID:** 332307134-0001

Method	Parameter	Result	RL	Units	Prep Date & Analyst	Analysis Date & Analyst
<b>METALS</b>						
200.8	Lead	<1.00	1.00	µg/L	4/21/2023 XL	4/24/2023 XL

**Client Sample Description** W-1-2  
STAFF ROOM KITCHEN - POST FLUSH  
**Collected:** 4/19/2023  
**Lab ID:** 332307134-0002

Method	Parameter	Result	RL	Units	Prep Date & Analyst	Analysis Date & Analyst
<b>METALS</b>						
200.8	Lead	<1.00	1.00	µg/L	4/21/2023 XL	4/24/2023 XL

**Client Sample Description** W-2-1  
LIBRARY KITCHEN FAUCET  
**Collected:** 4/19/2023  
**Lab ID:** 332307134-0003

Method	Parameter	Result	RL	Units	Prep Date & Analyst	Analysis Date & Analyst
<b>METALS</b>						
200.8	Lead	<1.00	1.00	µg/L	4/21/2023 XL	4/24/2023 XL

**Client Sample Description** W-2-2  
LIBRARY KITCHEN FAUCET - POST FLUSH  
**Collected:** 4/19/2023  
**Lab ID:** 332307134-0004

Method	Parameter	Result	RL	Units	Prep Date & Analyst	Analysis Date & Analyst
<b>METALS</b>						
200.8	Lead	<1.00	1.00	µg/L	4/21/2023 XL	4/24/2023 XL

**Client Sample Description** W-3-1  
G-8 FOUNTAIN (3RD FROM LEFT)  
**Collected:** 4/19/2023  
**Lab ID:** 332307134-0005

Method	Parameter	Result	RL	Units	Prep Date & Analyst	Analysis Date & Analyst
<b>METALS</b>						
200.8	Lead	<1.00	1.00	µg/L	4/21/2023 XL	4/24/2023 XL

**Client Sample Description** W-3-2  
G-8 FOUNTAIN (3RD FROM LEFT) - POST FLUSH  
**Collected:** 4/19/2023  
**Lab ID:** 332307134-0006

Method	Parameter	Result	RL	Units	Prep Date & Analyst	Analysis Date & Analyst
<b>METALS</b>						



# LA Testing

5431 Industrial Drive, Huntington Beach, CA 92649  
 Phone/Fax: (714) 828-4999 / (714) 828-4944  
<http://www.LATesting.com> [gardengrovelab@latesting.com](mailto:gardengrovelab@latesting.com)

LA Testing Order: 332307134  
 CustomerID: ACCE56  
 CustomerPO:  
 ProjectID:

Attn: **Michael Burrows**  
**ACC Environmental Consultants, Inc.**  
**7977 Capwell Drive**  
**Suite 100**  
**Oakland, CA 94621**

Phone: (510) 638-8400  
 Fax:  
 Received: 4/20/2023 10:40 AM  
 Collected: 4/19/2023

Project: HILLVIEW MIDDLE SCHOOL: 1100 ELDER AVE. MENLO PARK, CA: 3238-001.01

## Analytical Results

**Client Sample Description** W-3-2  
 G-8 FOUNTAIN (3RD FROM LEFT) - POST FLUSH  
**Collected:** 4/19/2023 **Lab ID:** 332307134-0006

Method	Parameter	Result	RL	Units	Prep Date & Analyst	Analysis Date & Analyst
<b>METALS</b>						
200.8	Lead	<1.00	1.00	µg/L	4/21/2023 XL	4/24/2023 XL

**Client Sample Description** W-4-1  
 G-8 FOUNTAIN (5TH FROM LEFT)  
**Collected:** 4/19/2023 **Lab ID:** 332307134-0007

Method	Parameter	Result	RL	Units	Prep Date & Analyst	Analysis Date & Analyst
<b>METALS</b>						
200.8	Lead	1.74	1.00	µg/L	4/21/2023 XL	4/24/2023 XL

**Client Sample Description** W-4-2  
 G-8 FOUNTAIN (5TH FROM LEFT) - POST FLUSH  
**Collected:** 4/19/2023 **Lab ID:** 332307134-0008

Method	Parameter	Result	RL	Units	Prep Date & Analyst	Analysis Date & Analyst
<b>METALS</b>						
200.8	Lead	<1.00	1.00	µg/L	4/21/2023 XL	4/24/2023 XL

**Client Sample Description** W-5-1  
 G-9 FOUNTAIN (LEFT MOST)  
**Collected:** 4/19/2023 **Lab ID:** 332307134-0009

Method	Parameter	Result	RL	Units	Prep Date & Analyst	Analysis Date & Analyst
<b>METALS</b>						
200.8	Lead	1.25	1.00	µg/L	4/21/2023 XL	4/24/2023 XL

**Client Sample Description** W-5-2  
 G-9 FOUNTAIN (LEFT MOST) - POST FLUSH  
**Collected:** 4/19/2023 **Lab ID:** 332307134-0010

Method	Parameter	Result	RL	Units	Prep Date & Analyst	Analysis Date & Analyst
<b>METALS</b>						
200.8	Lead	1.18	1.00	µg/L	4/21/2023 XL	4/24/2023 XL



# LA Testing

5431 Industrial Drive, Huntington Beach, CA 92649

Phone/Fax: (714) 828-4999 / (714) 828-4944

<http://www.LATesting.com>

[gardengrovelab@latesting.com](mailto:gardengrovelab@latesting.com)

LA Testing Order: 332307134

CustomerID: ACCE56

CustomerPO:

ProjectID:

Attn: **Michael Burrows**  
**ACC Environmental Consultants, Inc.**  
**7977 Capwell Drive**  
**Suite 100**  
**Oakland, CA 94621**

Phone: (510) 638-8400  
Fax:  
Received: 4/20/2023 10:40 AM  
Collected: 4/19/2023

Project: HILLVIEW MIDDLE SCHOOL: 1100 ELDER AVE. MENLO PARK, CA: 3238-001.01

## Analytical Results

**Client Sample Description** W-6-1  
G-9 FOUNTAIN (4TH FROM LEFT) **Collected:** 4/19/2023 **Lab ID:** 332307134-0011

Method	Parameter	Result	RL	Units	Prep Date & Analyst	Analysis Date & Analyst
<b>METALS</b>						
200.8	Lead	<1.00	1.00	µg/L	4/21/2023 XL	4/24/2023 XL

**Client Sample Description** W-6-2  
G-9 FOUNTAIN (4TH FROM LEFT) - POST FLUSH **Collected:** 4/19/2023 **Lab ID:** 332307134-0012

Method	Parameter	Result	RL	Units	Prep Date & Analyst	Analysis Date & Analyst
<b>METALS</b>						
200.8	Lead	<1.00	1.00	µg/L	4/21/2023 XL	4/24/2023 XL

**Client Sample Description** W-7-1  
G-9 FOUNTAIN (3RD FROM LEFT) **Collected:** 4/19/2023 **Lab ID:** 332307134-0013

Method	Parameter	Result	RL	Units	Prep Date & Analyst	Analysis Date & Analyst
<b>METALS</b>						
200.8	Lead	1.13	1.00	µg/L	4/21/2023 XL	4/24/2023 XL

**Client Sample Description** W-7-2  
G-9 FOUNTAIN (3RD FROM LEFT) - POST FLUSH **Collected:** 4/19/2023 **Lab ID:** 332307134-0014

Method	Parameter	Result	RL	Units	Prep Date & Analyst	Analysis Date & Analyst
<b>METALS</b>						
200.8	Lead	<1.00	1.00	µg/L	4/21/2023 XL	4/24/2023 XL

**Client Sample Description** W-8-1  
G-9 FOUNTAIN (6TH FROM LEFT) **Collected:** 4/19/2023 **Lab ID:** 332307134-0015

Method	Parameter	Result	RL	Units	Prep Date & Analyst	Analysis Date & Analyst
<b>METALS</b>						
200.8	Lead	<1.00	1.00	µg/L	4/21/2023 XL	4/24/2023 XL



# LA Testing

5431 Industrial Drive, Huntington Beach, CA 92649  
 Phone/Fax: (714) 828-4999 / (714) 828-4944  
<http://www.LATesting.com> [gardenrovelab@latesting.com](mailto:gardenrovelab@latesting.com)

LA Testing Order: 332307134  
 CustomerID: ACCE56  
 CustomerPO:  
 ProjectID:

Attn: **Michael Burrows**  
**ACC Environmental Consultants, Inc.**  
**7977 Capwell Drive**  
**Suite 100**  
**Oakland, CA 94621**

Phone: (510) 638-8400  
 Fax:  
 Received: 4/20/2023 10:40 AM  
 Collected: 4/19/2023

Project: HILLVIEW MIDDLE SCHOOL: 1100 ELDER AVE. MENLO PARK, CA: 3238-001.01

## Analytical Results

**Client Sample Description** W-8-2  
 G-9 FOUNTAIN (6TH FROM LEFT) - POST FLUSH  
**Collected:** 4/19/2023 **Lab ID:** 332307134-0016

Method	Parameter	Result	RL	Units	Prep Date & Analyst	Analysis Date & Analyst
<b>METALS</b>						
200.8	Lead	<1.00	1.00	µg/L	4/21/2023 XL	4/24/2023 XL

**Client Sample Description** W-9-1  
 C-8 FOUNTAIN  
**Collected:** 4/19/2023 **Lab ID:** 332307134-0017

Method	Parameter	Result	RL	Units	Prep Date & Analyst	Analysis Date & Analyst
<b>METALS</b>						
200.8	Lead	<1.00	1.00	µg/L	4/21/2023 XL	4/24/2023 XL

**Client Sample Description** W-9-2  
 C-8 FOUNTAIN - POST FLUSH  
**Collected:** 4/19/2023 **Lab ID:** 332307134-0018

Method	Parameter	Result	RL	Units	Prep Date & Analyst	Analysis Date & Analyst
<b>METALS</b>						
200.8	Lead	<1.00	1.00	µg/L	4/21/2023 XL	4/24/2023 XL

### Definitions:

- MDL - method detection limit
- J - Result was below the reporting limit, but at or above the MDL
- ND - indicates that the analyte was not detected at the reporting limit
- RL - Reporting Limit (Analytical)
- D - Dilution Sample required a dilution which was used to calculate final results



EMSL ANALYTICAL, INC.  
TESTING LABS • PRODUCTS • TRAINING

# Industrial Hygiene - Chain of Custody

EMSL Order Number / Lab Use Only

# 3 3 2 3 0 7 1 3 4

EMSL Analytical, Inc.  
5431 Industrial Dr.  
Huntington Beach, CA 92649

PHONE: (800) 755-1794  
EMAIL: c@emsl.com

If Bill-To is the same as Report-To leave this section blank. Third-party billing requires written authorization.

Customer Information	Customer ID:			Billing ID:	Same	
	Company Name:	ACC Environmental Consultants		Company Name:		
	Contact Name:	Michael Burrows		Billing Contact:		
	Street Address:	7977 Capwell Drive, Ste 100		Street Address:		
	City, State, Zip:	Oakland CA 94621	Country:	USA	City, State, Zip:	Country:
	Phone:	(818) 640-7946		Phone:		
	Email(s) for Report:	mburrows@accenv.com		Email(s) for Invoice:	cindy.lee@accenv.com	

Project Name/No: Hillview Middle School: 1100 Elder Ave. Menlo Park CA: 3238-001.01 Purchase Order:

EMSL LIMS Project ID: (If applicable, EMSL will provide) US State where samples collected: CA State of Connecticut (CT) must select project location:  
 Commercial (Taxable)  Residential (Non-Taxable)

Media Type: Water Media Manufacturer/Part Number: Media Lot Number:

Sampled By Name: Rachael Gehrman Sampled By Signature: No. Samples in Shipment: 18

Turnaround Time (TAT) Options - Please check:  
 (If no selection made, Standard 2 Week (EOD) TAT will apply)  2 Week  1 Week  4 Day  3 Day  2 Day  1 Day  Other (Call Lab)

Client Sample ID	Location/Description	Analyte/Method	Media	Flow (lpm)	Sample Time		Volume/Area	Sample Type	Sample Date	Comments
					On	Off				
W-1-1	Staff Room Kitchen	200.8/Lead	Water	n/a	6:19 am		n/a	<input type="checkbox"/> Area <input type="checkbox"/> Personal	04/19/2023	
W-1-2	Staff Room Kitchen - Post Flush	200.8/Lead	Water	n/a	6:45 am		n/a	<input type="checkbox"/> Area <input type="checkbox"/> Personal	04/19/2023	
W-2-1	Library Kitchen Faucet	200.8/Lead	Water	n/a	6:21 am		n/a	<input type="checkbox"/> Area <input type="checkbox"/> Personal	04/19/2023	
W-2-2	Library Kitchen Faucet - Post Flush	200.8/Lead	Water	n/a	6:48 am		n/a	<input type="checkbox"/> Area <input type="checkbox"/> Personal	04/19/2023	
W-3-1	G-8 Fountain (3rd from left)	200.8/Lead	Water	n/a	6:23 am		n/a	<input type="checkbox"/> Area <input type="checkbox"/> Personal	04/19/2023	
W-3-2	G-8 Fountain (3rd from left) - Post Flush	200.8/Lead	Water	n/a	6:51 am		n/a	<input type="checkbox"/> Area <input type="checkbox"/> Personal	04/19/2023	
W-4-1	G-8 Fountain (5th from left)	200.8/Lead	Water	n/a	6:25 am		n/a	<input type="checkbox"/> Area <input type="checkbox"/> Personal	04/19/2023	
W-4-2	G-8 Fountain (5th from left) - post flush	200.8/Lead	Water	n/a	6:53 am		n/a	<input type="checkbox"/> Area <input type="checkbox"/> Personal	04/19/2023	

Special Instructions and/or Regulatory Requirements (Sample Specifications, Processing Methods, Limits of Detection, etc.)  
 For CA SB2370 - Lead; Please send results to ACC, Client (emails above) and upload results to CA State Water Board Laboratory Information Management System (DDW-CCC@waterboards.ca.gov)

Method of Shipment: Sample Condition Upon Receipt:

Relinquished by: Rachael Gehrman Date/Time: 04/19/2023 Received by: Jonathan Nomura Date/Time: 4/19/23 3:00PM

Relinquished by: Jonathan Nomura Date/Time: 4/19/23 5:30 PM Received by: Jonathan Santora (FX) Date/Time: 4/20/23 10:40a

Controlled Document - COC-21 Industrial Hygiene R4 05/12/2021  AGREE TO ELECTRONIC SIGNATURE (By checking, I consent to signing this Chain of Custody document by electronic signature.)

EMSL Analytical, Inc.'s Laboratory Terms and Conditions are incorporated into this Chain of Custody by reference in their entirety. Submission of samples to EMSL Analytical, Inc. constitutes acceptance and acknowledgment of all terms and conditions by Customer.

OrderID: 332307134

Page 1 of 3



EMSL ANALYTICAL, INC.  
TESTING LABS • PRODUCTS • TRAINING

# Industrial Hygiene - Chain of Custody

EMSL Order Number / Lab Use Only

## # 3 3 2 3 0 7 1 3 4

EMSL Analytical, Inc.  
5431 Industrial Dr.  
Huntington Beach, CA 92649

PHONE: (800) 755.1794  
EMAIL: c@emsl.com

If Bill-To is the same as Report-To leave this section blank. Third-party billing requires written authorization.

<b>Customer Information</b>	Customer ID:		Billing ID: <b>Same</b>	
	Company Name: <b>ACC Environmental Consultants</b>		Company Name:	
	Contact Name: <b>Michael Burrows</b>		Billing Contact:	
	Street Address: <b>7977 Capwell Drive, Ste 100</b>		Street Address:	
	City, State, Zip: <b>Oakland CA 94621</b>	Country: <b>USA</b>	City, State, Zip:	Country:
	Phone: <b>(818) 640-7946</b>		Phone:	
Email(s) for Report: <b>mburrows@accenv.com</b>		Email(s) for Invoice: <b>cindy.lee@accenv.com</b>		

Project Name/No: **Hillview Middle School: 1100 Elder Ave. Menlo Park CA: 3238-001.01** Purchase Order:

EMSL LIMS Project ID: (If applicable, EMSL will provide) US State where samples collected: **CA** State of Connecticut (CT) must select project location:  Commercial (Taxable)  Residential (Non-Taxable)

Media Type: **Water** Media Manufacturer/Part Number: Media Lot Number:

Sampled By Name: **Rachael Gehrman** Sampled By Signature: No. Samples in Shipment: **18**

Turnaround Time (TAT) Options - Please check: (If no selection made, Standard 2 Week (EOD) TAT will apply)  2 Week  1 Week  4 Day  3 Day  2 Day  1 Day  Other (Call Lab)

Client Sample ID	Location/Description	Analyte/Method	Media	Flow (lpm)	Sample Time		Volume/Area	Sample Type	Sample Date	Comments
					On	Off				
W-5-1	G-9 Fountain (left most)	200.8/Lead	Water	n/a	6:28 am		n/a	<input type="checkbox"/> Area <input type="checkbox"/> Personal	04/19/2023	
W-5-2	G-9 Fountain (left most) - Post Flush	200.8/Lead	Water	n/a	6:55 am		n/a	<input type="checkbox"/> Area <input type="checkbox"/> Personal	04/19/2023	
W-6-1	G-9 Fountain (4th from left)	200.8/Lead	Water	n/a	6:29 am		n/a	<input type="checkbox"/> Area <input type="checkbox"/> Personal	04/19/2023	
W-6-2	G-9 Fountain (4th from left) - Post Flush	200.8/Lead	Water	n/a	6:57 am		n/a	<input type="checkbox"/> Area <input type="checkbox"/> Personal	04/19/2023	
W-7-1	G-9 Fountain (3rd from left)	200.8/Lead	Water	n/a	6:31 am		n/a	<input type="checkbox"/> Area <input type="checkbox"/> Personal	04/19/2023	
W-7-2	G-9 Fountain (3rd from left) - Post Flush	200.8/Lead	Water	n/a	6:59 am		n/a	<input type="checkbox"/> Area <input type="checkbox"/> Personal	04/19/2023	
W-8-1	G-9 Fountain (6th from left)	200.8/Lead	Water	n/a	6:33 am		n/a	<input type="checkbox"/> Area <input type="checkbox"/> Personal	04/19/2023	
W-8-2	G-9 Fountain (6th from left) - post flush	200.8/Lead	Water	n/a	7:01 am		n/a	<input type="checkbox"/> Area <input type="checkbox"/> Personal	04/19/2023	

Special Instructions and/or Regulatory Requirements (Sample Specifications, Processing Methods, Limits of Detection, etc.)  
For CA SB2370 - Lead; Please send results to ACC, Client (emails above) and upload results to CA State Water Board Laboratory Information Management System (DDW-CCC@waterboards.ca.gov)

Method of Shipment:		Sample Condition Upon Receipt:	
Relinquished by: <b>Rachael Gehrman</b>	Date/Time: <b>04/19/2023</b>	Received by:	Date/Time:
Relinquished by:	Date/Time:	Received by:	Date/Time:

Controlled Document - COC-21 Industrial Hygiene R4 05/12/2021  AGREE TO ELECTRONIC SIGNATURE (By checking, I consent to signing this Chain of Custody document by electronic signature)

EMSL Analytical, Inc.'s Laboratory Terms and Conditions are incorporated into this Chain of Custody by reference in their entirety. Submission of samples to EMSL Analytical, Inc. constitutes acceptance and acknowledgment of all terms and conditions by Customer.

OrderID: 332307134

Page 2 of 3



EMSL ANALYTICAL, INC.  
TESTING LABS • PRODUCTS • TRAINING

# Industrial Hygiene - Chain of Custody

EMSL Order Number / Lab Use Only

## # 3 3 2 3 0 7 1 3 4

EMSL Analytical, Inc.  
5431 Industrial Dr.  
Huntington Beach, CA 92649

PHONE: (800) 755.1794  
EMAIL: c@emsl.com

If Bill-To is the same as Report-To leave this section blank. Third-party billing requires written authorization.

<b>Customer Information</b>	Customer ID:			<b>Billing Information</b>	Billing ID:	Same			
	Company Name:	ACC Environmental Consultants			Company Name:	--			
	Contact Name:	Michael Burrows			Billing Contact:				
	Street Address:	7977 Capwell Drive, Ste 100			Street Address:				
	City, State, Zip:	Oakland CA 94621	Country:		USA	City, State, Zip:		Country:	
	Phone:	(818) 640-7946			Phone:				
Email(s) for Report:	mburrows@accenv.com		Email(s) for Invoice:	cindy.lee@accenv.com					

Project Name/No: Hillview Middle School: 1100 Elder Ave. Menlo Park CA: 3238-001.01 Purchase Order:

EMSL LIMS Project ID: (If applicable, EMSL will provide) US State where samples collected: CA State of Connecticut (CT) must select project location:  
 Commercial (Taxable)  Residential (Non-Taxable)

Media Type: Water Media Manufacturer/Part Number: Media Lot Number:

Sampled By Name: Rachael Gehrman Sampled By Signature: No. Samples in Shipment: 18

Turnaround Time (TAT) Options - Please check:  
 (If no selection made, Standard 2 Week (EOD) TAT will apply)  2 Week  1 Week  4 Day  3 Day  2 Day  1 Day  Other (Call Lab)

Client Sample ID	Location/Description	Analyte/Method	Media	Flow (lpm)	Sample Time		Volume/Area	Sample Type	Sample Date	Comments
					On	Off				
W-9-1	C-8 Fountain	200.8/Lead	Water	n/a	6:36 am		n/a	<input type="checkbox"/> Area <input type="checkbox"/> Personal	04/19/2023	
W-9-2	C-8 Fountain - Post Flush	200.8/Lead	Water	n/a	7:06 am		n/a	<input type="checkbox"/> Area <input type="checkbox"/> Personal	04/19/2023	
				n/a			n/a	<input type="checkbox"/> Area <input type="checkbox"/> Personal		
				n/a			n/a	<input type="checkbox"/> Area <input type="checkbox"/> Personal		
				n/a			n/a	<input type="checkbox"/> Area <input type="checkbox"/> Personal		
				n/a			n/a	<input type="checkbox"/> Area <input type="checkbox"/> Personal		
				n/a			n/a	<input type="checkbox"/> Area <input type="checkbox"/> Personal		

Special Instructions and/or Regulatory Requirements (Sample Specifications, Processing Methods, Limits of Detection, etc.)  
 For CA SB2370 - Lead; Please send results to ACC, Client (emails above) and upload results to CA State Water Board Laboratory Information Management System (DDW-CCC@waterboards.ca.gov)

Method of Shipment:	Sample Condition Upon Receipt:		
Relinquished by: Rachael Gehrman	Date/Time: 04/19/2023	Received by:	Date/Time:
Relinquished by:	Date/Time:	Received by:	Date/Time:

Controlled Document - COC-21 Industrial Hygiene R4 05/12/2021  AGREE TO ELECTRONIC SIGNATURE (By checking, I consent to signing this Chain of Custody document by electronic signature.)

EMSL Analytical, Inc.'s Laboratory Terms and Conditions are incorporated into this Chain of Custody by reference in their entirety. Submission of samples to EMSL Analytical, Inc. constitutes acceptance and acknowledgment of all terms and conditions by Customer.

OrderID: 332307134

Page 3 of 3

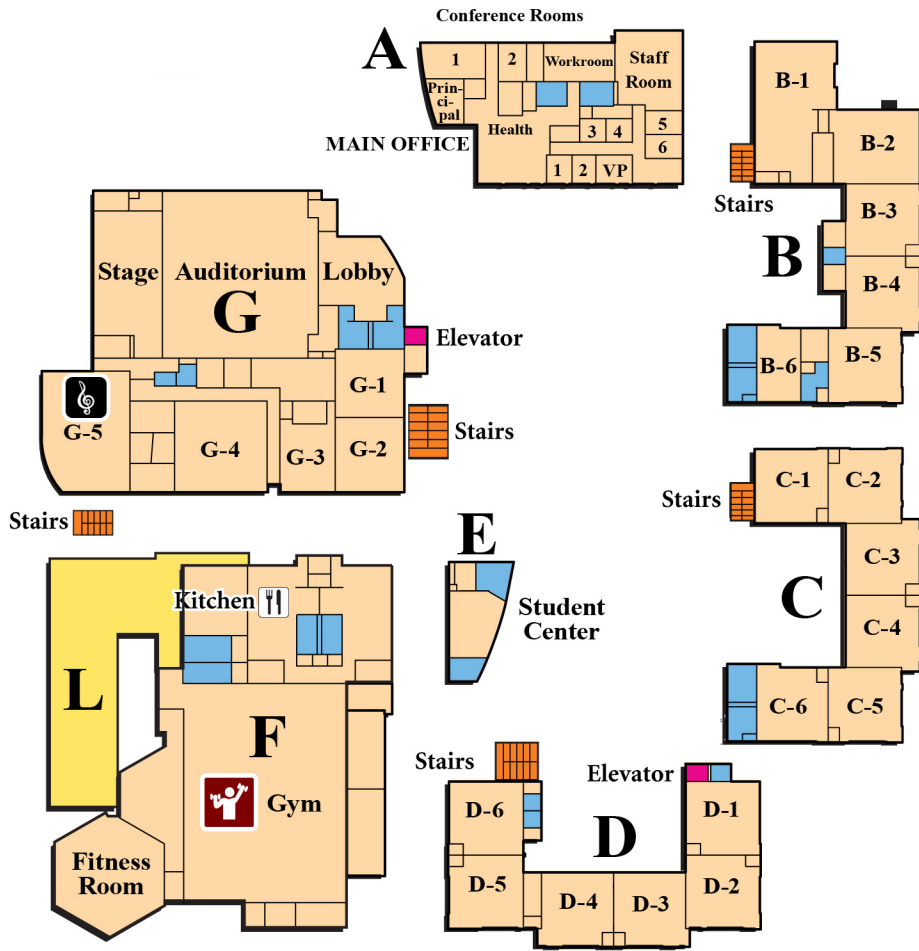

*First Floor*

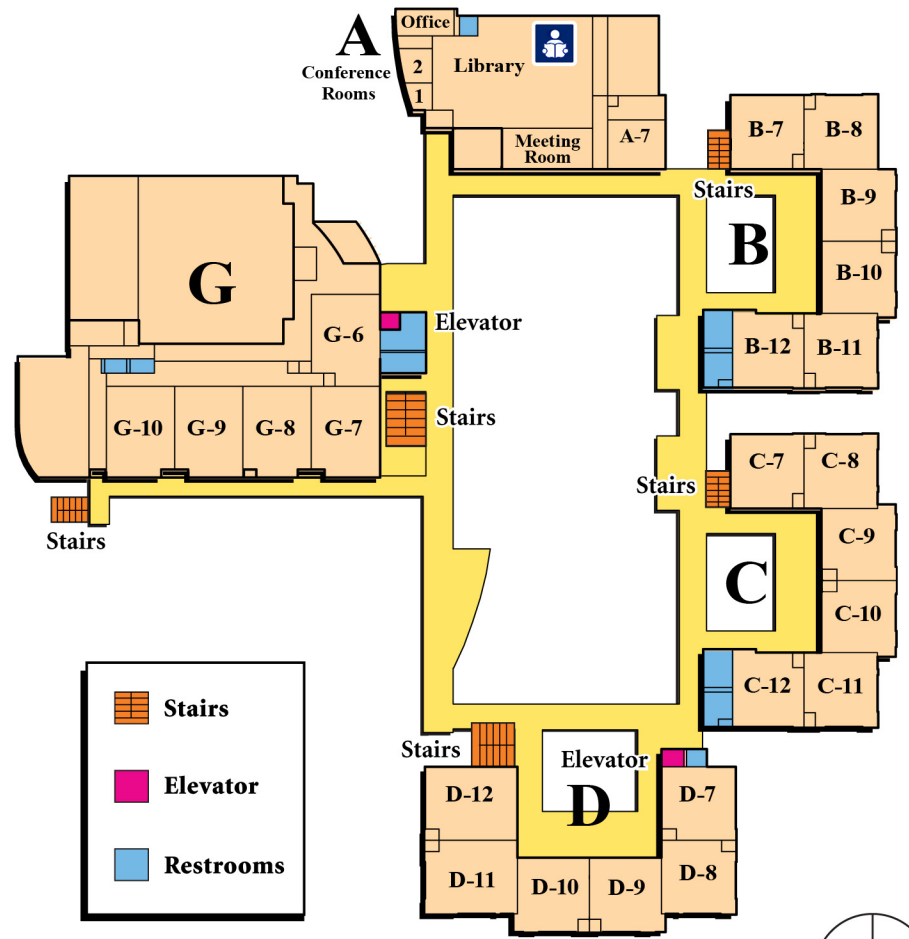

*Second Floor*

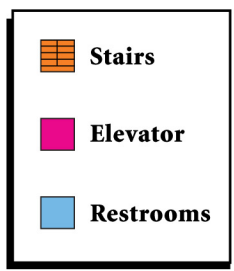

# HILLVIEW MIDDLE SCHOOL

## First and Second Floor Map

LEGEND			
A:	1st Floor – Main Office	F:	Gymnasium
A:	2nd Floor – Library	G:	1st Floor – Auditorium
B, C, D:	Classrooms	G:	2nd Floor – Science Rooms
E:	Student Activity	L:	Lunch Shelter