



Crabtree, Rohrbaugh & Associates

**PEQUEA VALLEY
SCHOOL DISTRICT
BOARD MEETING**

December 5, 2023

- **FUTURE PHASES: EXISTING HIGH SCHOOL /
INTERMEDIATE SCHOOL**
- **REVIEW UPDATED DESIGN SOLUTION**
- **REVIEW PHASING PLAN**
- **REVIEW DRAFT SCHEDULE**
- **UPDATED ESTIMATE OF PROBABLE COST**
 - **PREVIOUS DESIGN SOLUTION**
 - **UPDATED DESIGN SOLUTION**
- **DECISION MAKING TIMELINE**



NOVEMBER 2023 SITE PLAN & RENDERED VIEWS

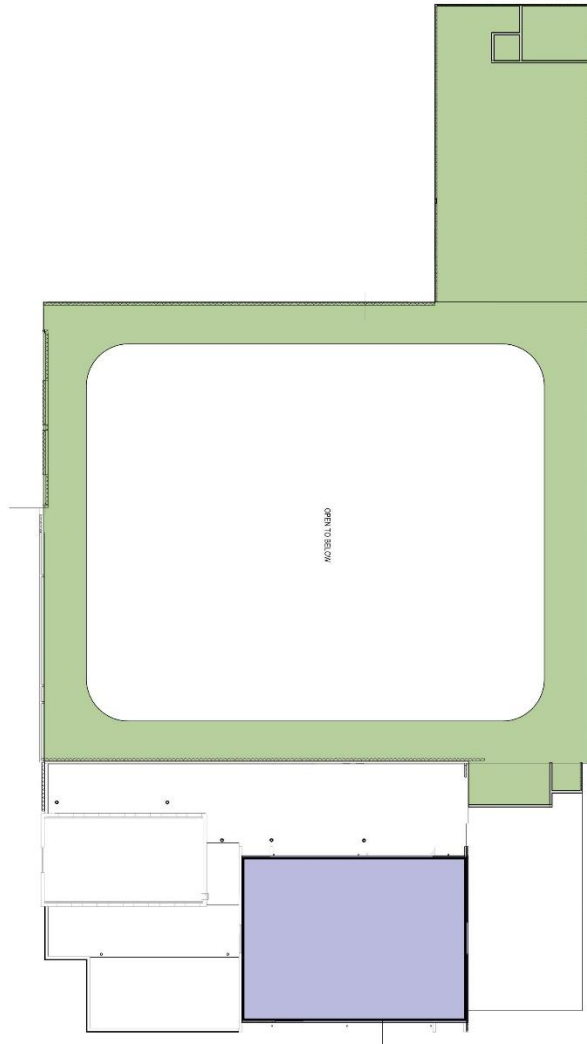

SECOND FLOOR

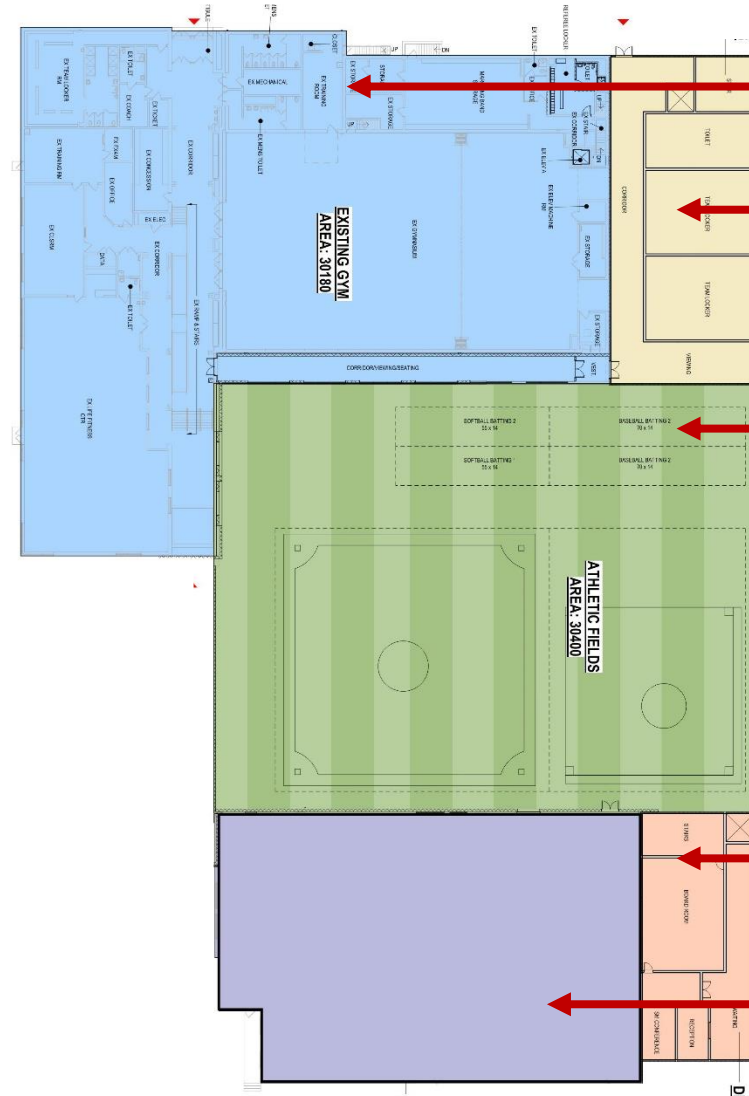

FIRST FLOOR

EXISTING GYM / FITNESS CENTER

NEW LOCKERS / RESTROOMS

NEW INDOOR TURFED FIELD

NEW DISTRICT OFFICE
COMPONENTS / ENTRY

RENOVATED HIGH SCHOOL AS
DISTRICT OFFICE

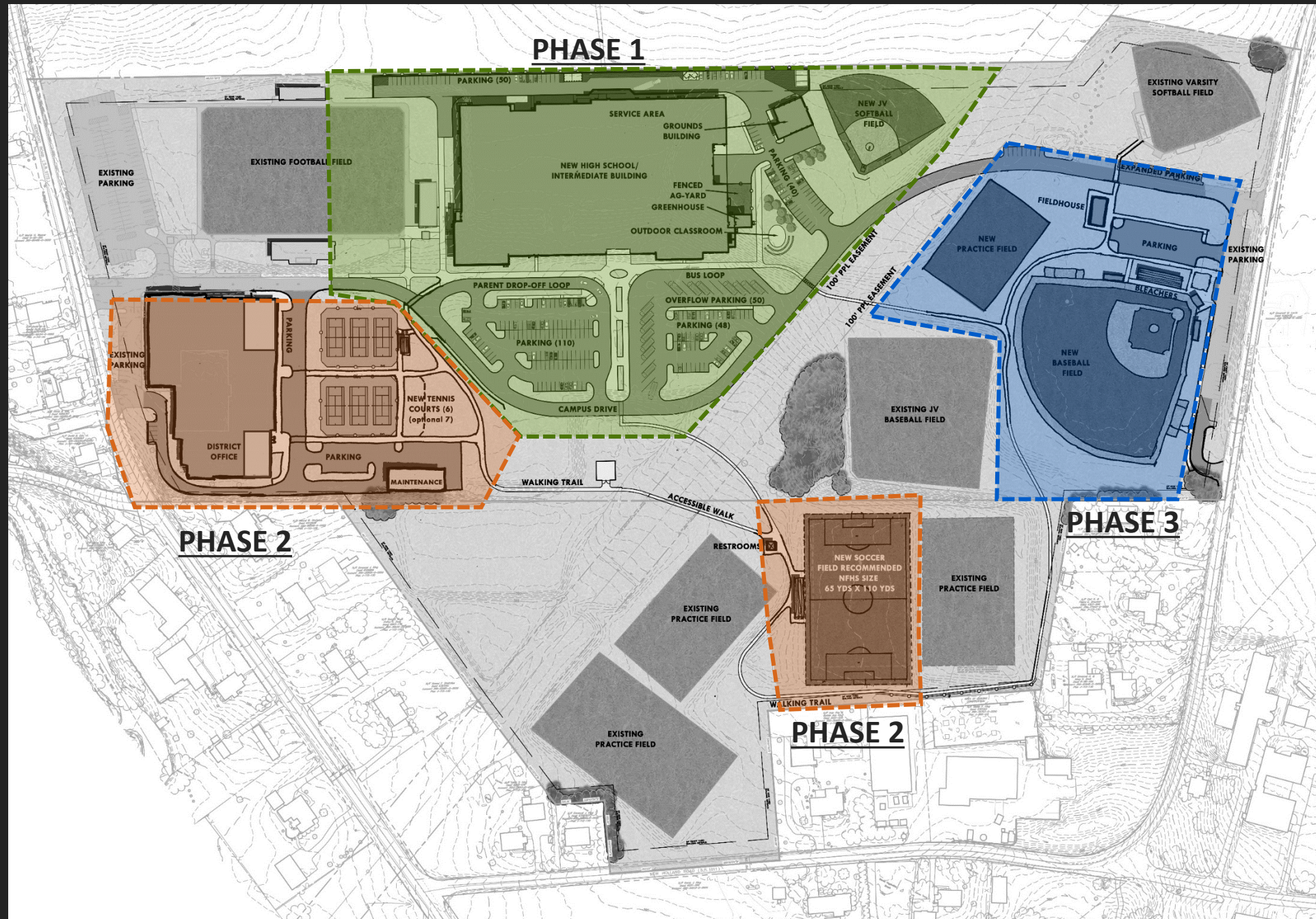

PEQUEA VALLEY CONSTRUCTION PROJECTS

PRELIMINARY TIMELINE 11/7/2023

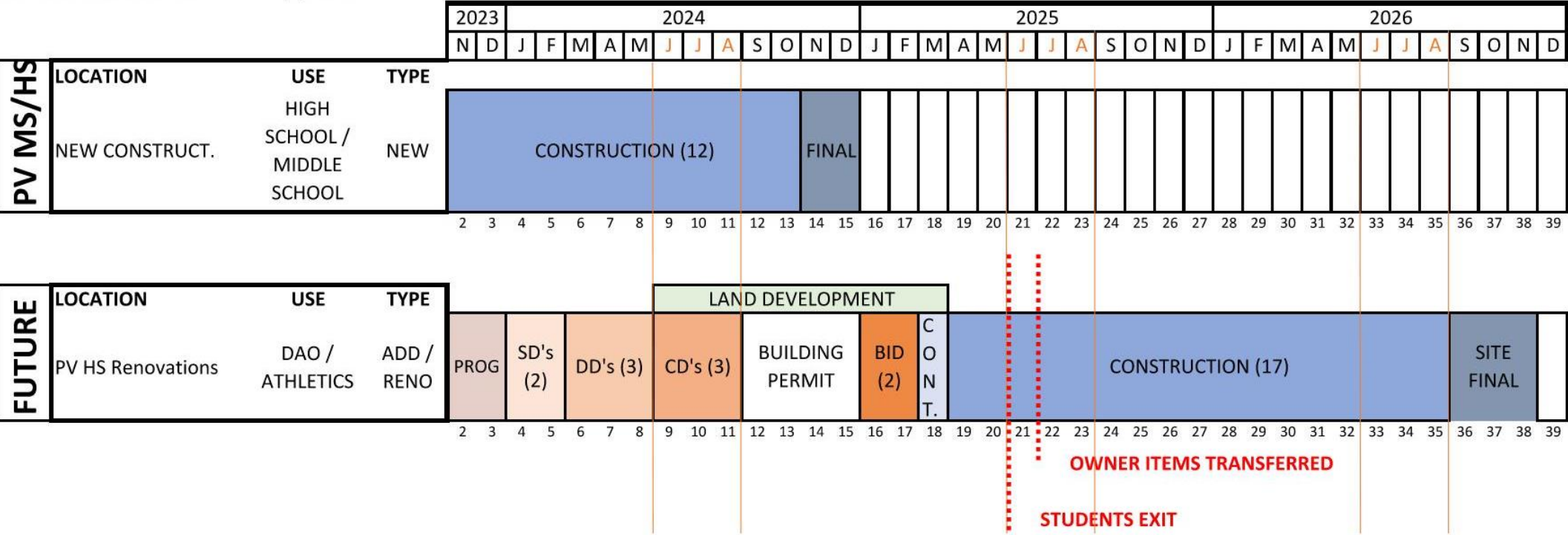

Budget Development Worksheet

Cost Escalation Analysis

RS Means Historical Cost Index											
		Location	July 2016	July 2017	July 2018	July 2019	July 2020	July 2021	July 2022	July 2023	January 2024
RS Means 2023			Actual	Actual	Actual	Actual	Actual	Actual	Actual	Est	Est
Historical Cost Index											
		Lancaster	207.3	213.6	222.9	232.2	234.60	257.5	297.1	314.926	333.82156
			0.53%	3.04%	4.35%	4.17%	1.03%	9.76%	15.38%	6.00%	3.00%

3% WAS BUDGETED FOR 2023
6% CURRENT PROJECTIONS FOR 2023

3% PROJECTED FOR 2024 (2025 MS/IS OPEN)

6% TOTAL ADDITIONAL COST ESCALATION

	3/1/2022 Update
Total Building Construction Cost	\$15,920,000
Site Work	\$1,500,000
Total Project Costs	\$17,420,000
10% Estimating Range	

	3/1/2022 Update		12/5/2023 Budget Update
Total Building Construction Cost	\$15,920,000	6% Inflation	\$ 16,875,200
Site Work	\$1,500,000	Budget Update	\$ 3,307,642
Total Project Costs	\$17,420,000		\$ 20,182,842
10% Estimating Range			\$ 22,201,126

	3/1/2022 Update		12/5/2023 Budget Update	12/5/2023 Revised Design Solution
Total Building Construction Cost	\$15,920,000	6% Inflation	\$ 16,875,200	\$ 18,546,196
Site Work	\$1,500,000	Budget Update	\$ 3,307,642	\$ 3,307,642
Total Project Costs	\$17,420,000		\$ 20,182,842	\$ 21,853,838
10% Estimating Range			\$ 22,201,126	\$24,039,222

POTENTIAL COST SAVINGS - ALTERNATES

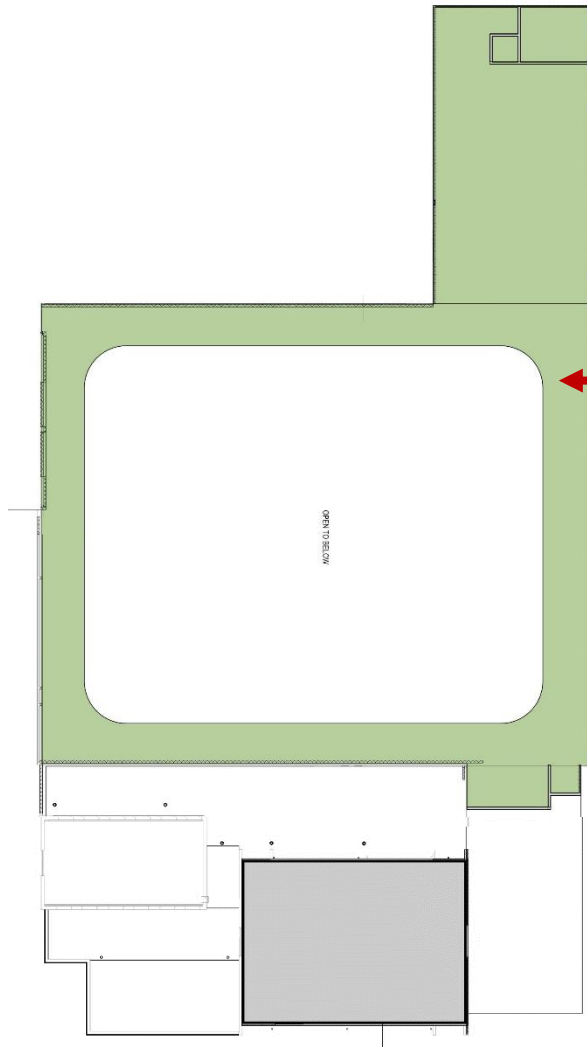

SECOND FLOOR

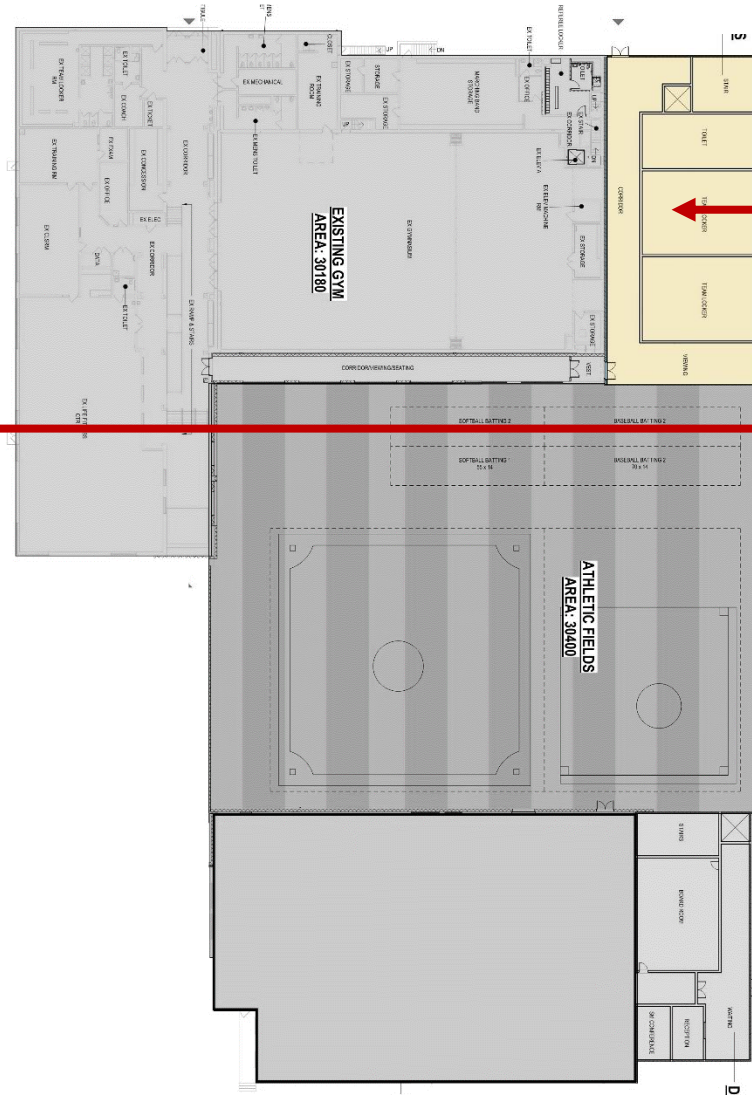

FIRST FLOOR

NEW LOCKERS / RESTROOMS

SECOND FLOOR WALKING TRACK
AND MULTI-PURPOSE SPACE

ASSOCIATED STAIRS AND
ELEVATORS

+/- 13,800 sf TRADITIONAL
CONSTRUCTION
+/- \$4,000,000

+/-10,000 SF ELEVATED TRACK
+/- \$350,000 SF

ESTIMATE OF PROBABLE COST

	3/1/2022 Update		12/5/2023 Budget Update	12/5/2023 Revised Design Solution
Total Building Construction Cost	\$15,920,000	6% Inflation	\$ 16,875,200	\$ 18,546,196
Site Work	\$1,500,000	Budget Update	\$ 3,307,642	\$ 3,307,642
Total Project Costs	\$17,420,000		\$ 20,182,842	\$ 21,853,838
10% Estimating Range			\$ 22,201,126	\$24,039,222
Less Cost Savings				\$ (4,350,000)
Total Project Costs				\$ 17,503,838
10% Estimating Range				\$ 19,254,221

PEQUEA VALLEY CONSTRUCTION PROJECTS

PRELIMINARY TIMELINE 11/7/2023

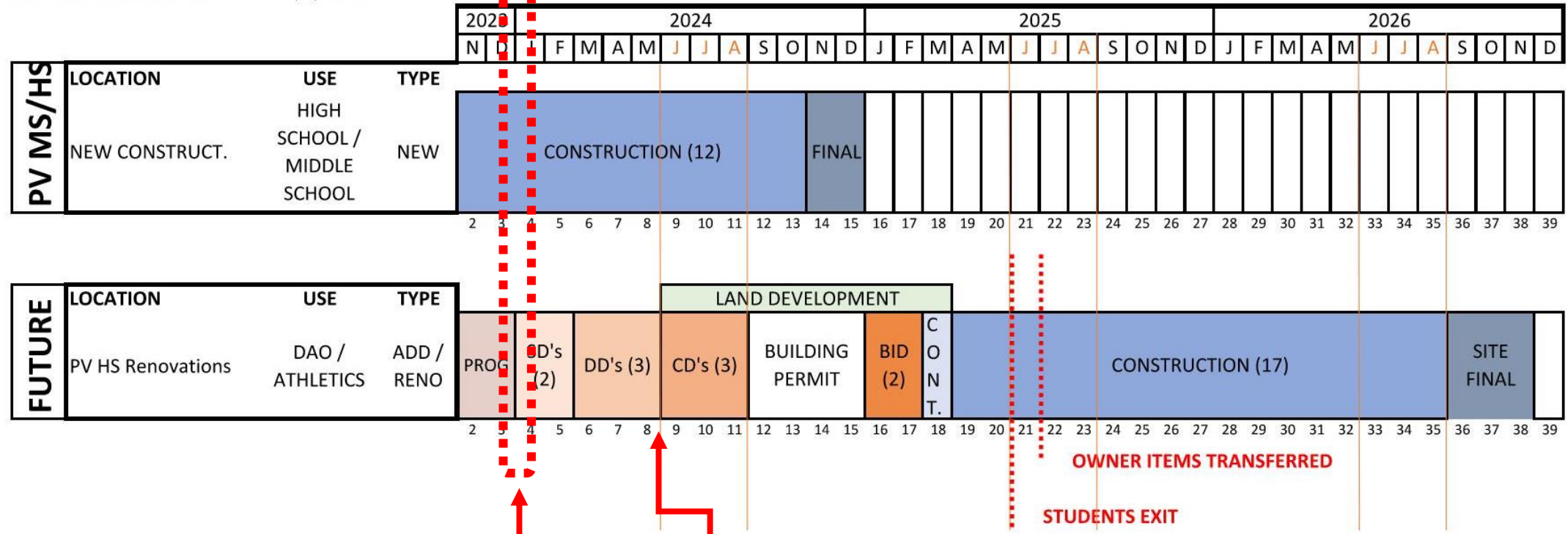

LAND DEVELOPMENT PROCESS

AUTHORIZE START OF DESIGN PROCESS



Pequea Valley School District

Where Each Learner Counts



Crabtree, Rohrbaugh & Associates

www.cra-architects.com

MARCH 2022 SITE PLAN & RENDERED VIEWS



PROGRAM

- DISTRICT ADMIN. OFFICE
- EARLY EDUCATION CENTER
- EXISTING GYMNASIUM
- EXISTING FITNESS CENTER



SECOND FLOOR

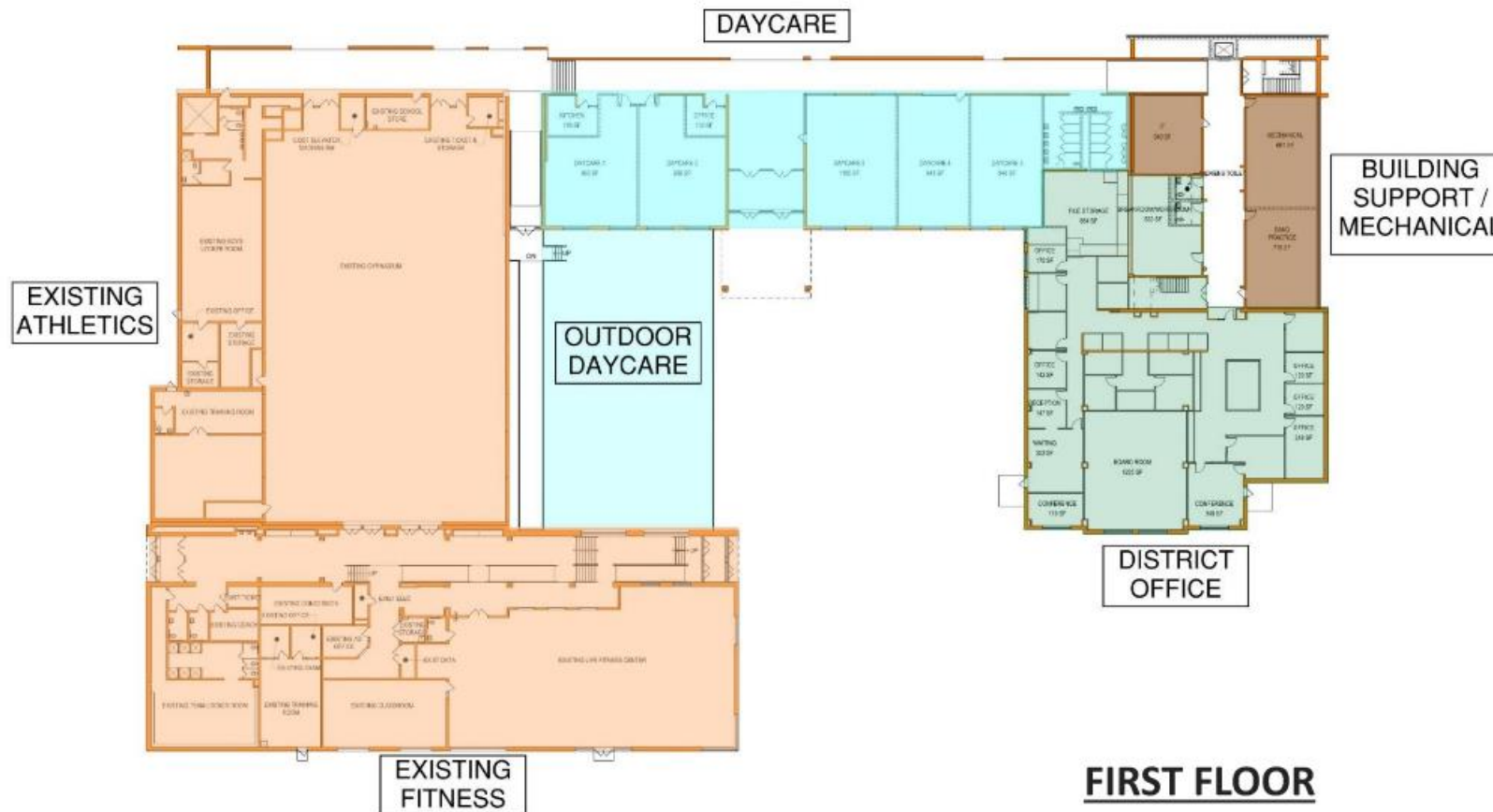

FIRST FLOOR

MARCH 2022

PROGRAM

- CONCESSIONS
- PUBLIC RESTROOMS
- FIELD SUPPORT STORAGE
 - BASEBALL
 - TENNIS
 - SOFTBALL
- GENERAL STORAGE & RESTROOMS
- (2) BASEBALL BATTING
- (2) SOFTBALL BATTING
- BASEBALL INFIELD
- SOFTBALL INFIELD
- GOLF NETTING
- TRAINER ROOM
- +/- 5,000 SF MAINTENANCE

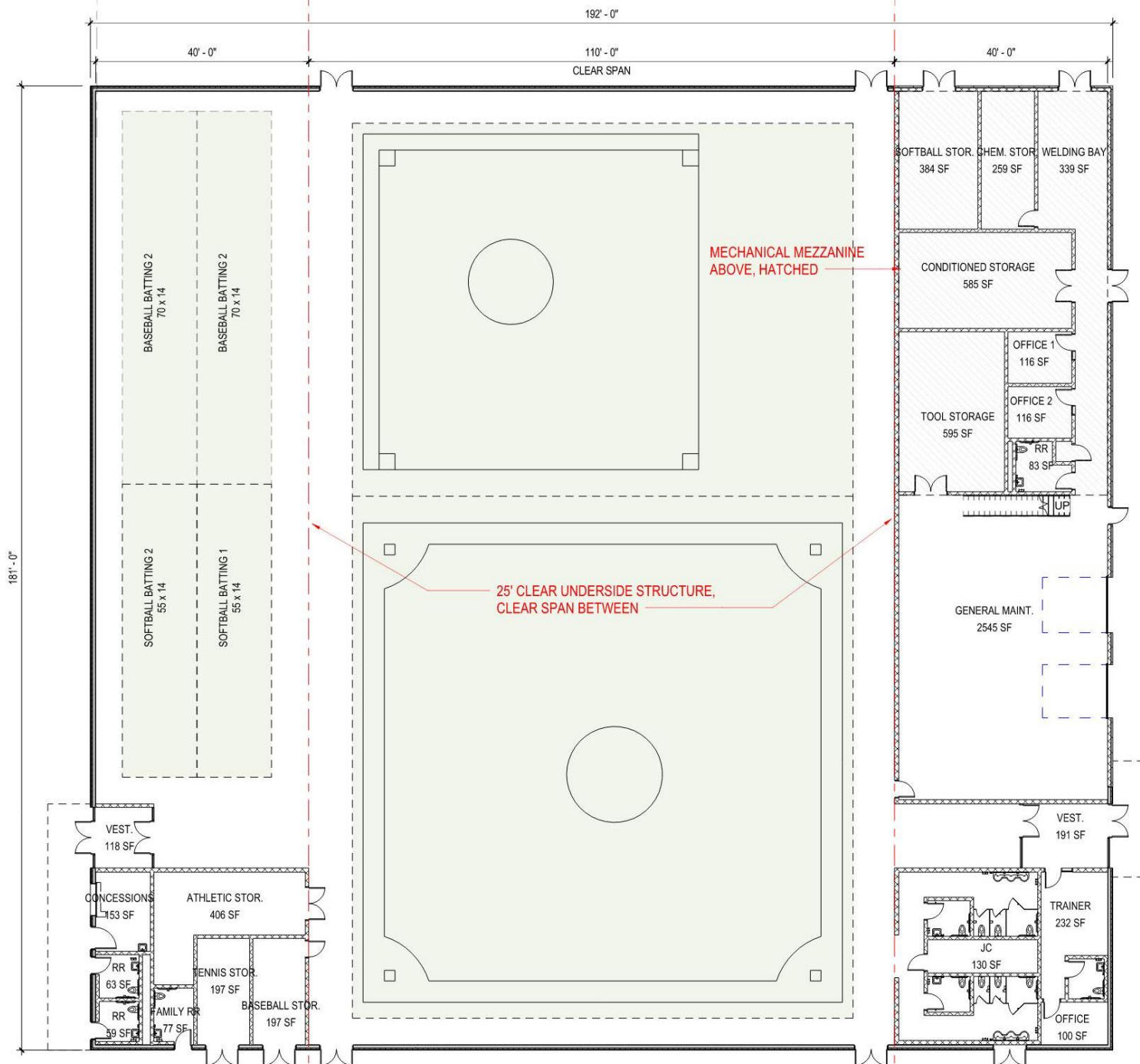

WHAT CHANGED?



- REVISIT BUDGET
 - FORTHCOMING
 - EXPLORE POTENTIAL COST SAVINGS
- REVISED PROGRAM
 - EARLY EDUCATION PROGRAM
- IMPRESSIONS FROM SIMILAR FACILITIES



IMPRESSIONS FROM SCHUYLKILL HAVEN

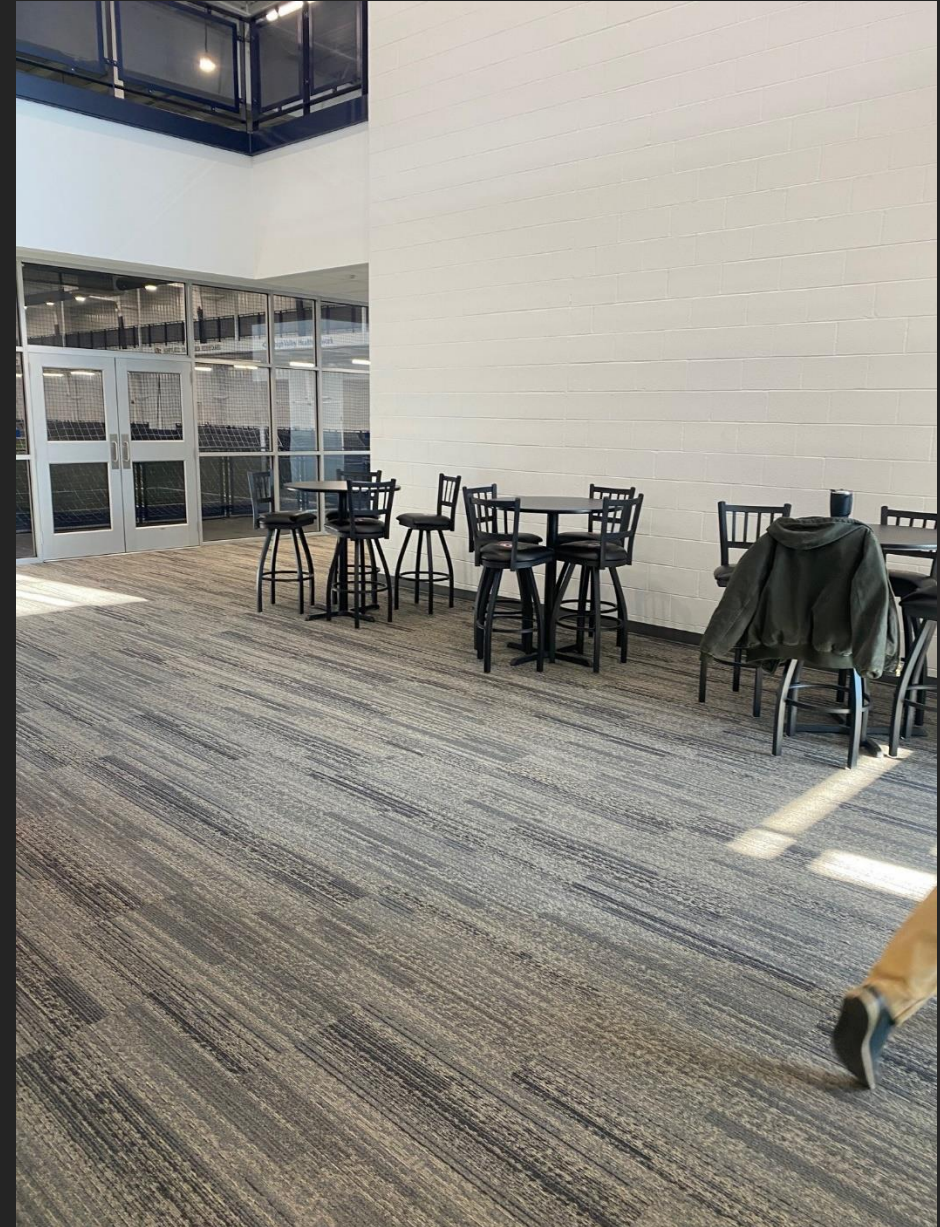

IMPRESSIONS FROM SCHUYLKILL HAVEN



IMPRESSIONS FROM SCHUYLKILL HAVEN



IMPRESSIONS FROM SCHUYLKILL HAVEN

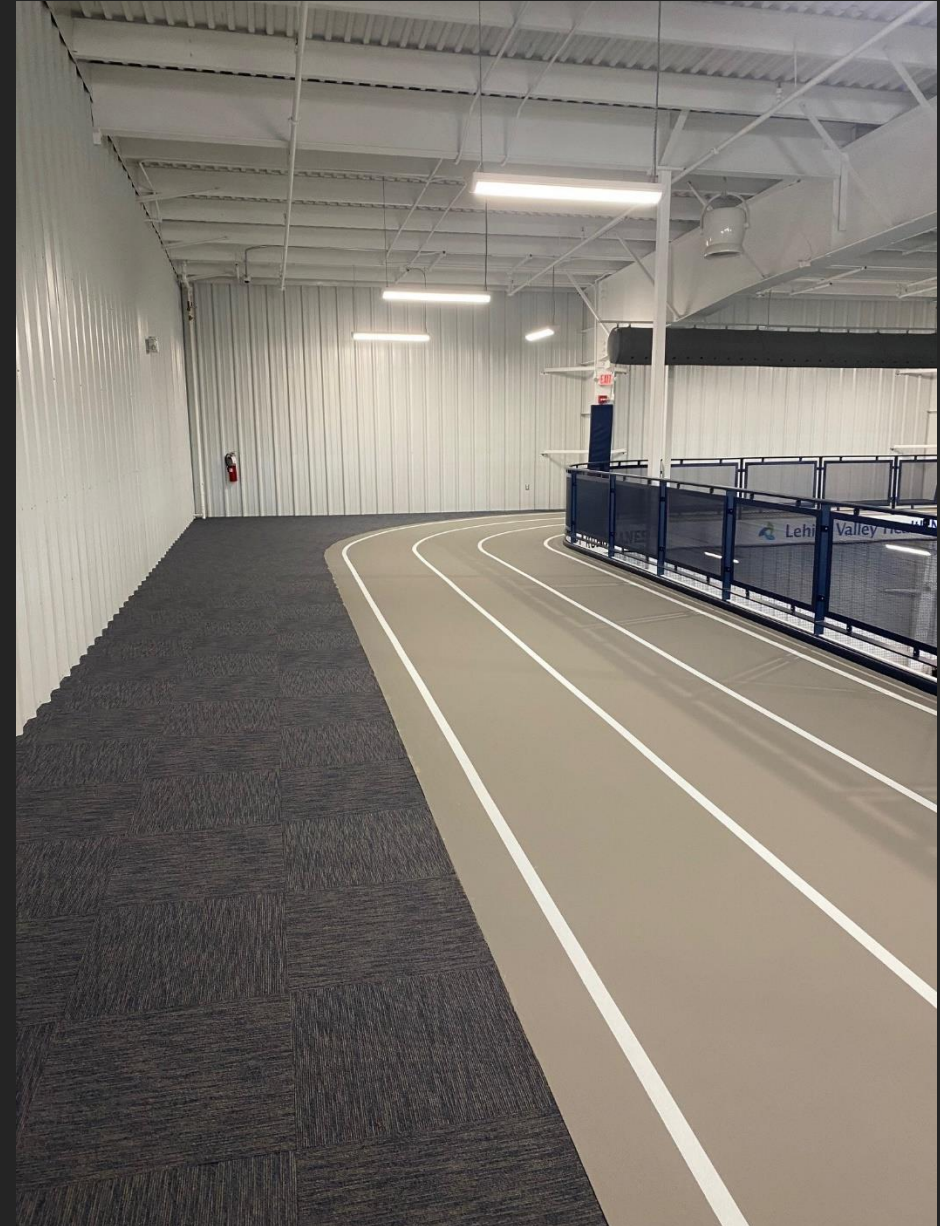

IMPRESSIONS FROM SCHUYLKILL HAVEN

