

ADDENDUM NO. 02

Issued: 12.15.23

Project: Franklin Elementary School, 201 West Mill Street, Liberty, Missouri 64068
Alexander Doniphan Elementary School, 1900 Clay Drive, Liberty, Missouri 64068

Project No. 23027
23028

Owner: Liberty Public Schools
8 Victory Lane
Liberty, MO 64068

Bidding Documents Issued: 11.30.23

This Addendum includes these 1 page[s] and the following attachments:

Project Manual:
No changes

Drawings:
Revised Architectural Sheets: No Changes
Refer to Smith & Boucher, MEP Franklin Addendum No. 1
Refer to Smith & Boucher, MEP Alexander Doniphan Addendum No. 1

DRAWINGS REVISIONS

E1 REFERENCE ATTACHED MEP ADDENDUM NO. 1

END OF ADDENDUM NO 2



**Liberty School District 2023 – Franklin Elementary School
Smith & Boucher Project No. 2314712**

12/15/2023

To Documents Titled:

100% Construction Documents
11/10/2023

Architect-of-Record:

Hollis and Miller
1828 Walnut Street Suite 922
Kansas City, MO 64108

The Contract Documents for the above referenced project and the Work covered thereby are modified as described herein.

DRAWINGS

1. Sheet DE101A
 - a. Note added salvage all electrical circuitry.

Attachments

- Sheets listed above

END OF MEP ITEMS FOR ADDENDUM NO. 2

ADDENDUM No. 2

**Liberty School District 2023 – Alexander Doniphan Elementary School
Smith & Boucher Project No. 2314713**

12/15/2023

To Documents Titled:
100% Construction Documents
11/10/2023

Architect-of-Record:
Hollis and Miller
1828 Walnut Street Suite 922
Kansas City, MO 64108

The Contract Documents for the above referenced project and the Work covered thereby are modified as described herein.

DRAWINGS

1. Sheet DE101B
 - a. Added note to salvage all electrical circuitry.
2. Sheet DE201C
 - a. Added note to salvage all parts and pieces of intercom system.

Attachments

- Sheets listed above

END OF MEP ITEMS FOR ADDENDUM NO. 2



SHEET KEYNOTE LEGEND

DEMOLITION GENERAL NOTES:

1. DASHED LINES INDICATE ELECTRICAL FIXTURES, DEVICES OR EQUIPMENT THAT SHALL BE REMOVED. SOLID LINES REPRESENT EXISTING EQUIPMENT OR MATERIAL TO REMAIN UNLESS NOTED OTHERWISE.
2. THE EXISTING CONDITIONS INDICATED ON THE DRAWINGS ARE TAKEN FROM THE BEST INFORMATION AVAILABLE AND FROM VISUAL SITE INSPECTIONS AND ARE NOT TO BE CONSTRUED AS "AS-BUILT" CONDITIONS. THE INFORMATION IS SHOWN TO HELP ESTABLISH THE EXTENT OF THE NEW WORK. VERIFY ALL ACTUAL EXISTING CONDITIONS AT THE PROJECT SITE AND PERFORM THE WORK AS REQUIRED TO MEET EXISTING EXISTING CONDITIONS AND THE EXTENT OF THE NEW WORK INDICATED.
3. VERIFY AND RESTORE THE CONTINUITY OF ALL EXISTING CIRCUITRY INDICATED TO REMAIN IN USE. WHERE REMOVAL OF EXISTING WIRING INTERRUPTS ELECTRICAL CONTINUITY OF CIRCUITS WHICH ARE TO REMAIN, FURNISH AND INSTALL ALL REQUIRED CIRCUITRY, CONDUIT, JUNCTION BOXES, ETC. TO INSURE CONTINUED ELECTRICAL CONTINUITY.
4. PATCH ROOFS, WALLS, AND CEILINGS WHERE ANY SERVICES ARE REMOVED. PATCH AND REPAIR ALL OPENINGS THAT PENETRATE FIRE RATED WALLS, FLOORS, AND CEILING USING UL APPROVED METHODS AND MATERIALS CONSISTENT WITH THE RATING OF THE SURFACE PENETRATED.
5. WHERE MECHANICAL AND ELECTRICAL FIXTURES OR EQUIPMENT ARE REMOVED, CAP ALL UNUSED CONDUIT, WIRING, AND PIPING BEYOND THE FLOOR LINE OR WALL LINE AND PROVIDE RESTORATION OF FINISH.
6. SALVAGE ALL CIRCUITRY FOR REUSE IN NEW WORK.

we design the future[®]

1828 Walnut Street Suite 922
Kansas City, MO 64108
816.442.7700

115 Wilcox Street Suite 210
Castle Rock, CO 80104
720.949.1689

HOLLISANDMILLER.COM

Holls + Miller Architects
Missouri State Certificate of Authority
Architecture # 0000161

hollis + miller architects[®]

Structural Engineer
Bob D Campbell
State Certificate of Authority #000442
4338 Bellevue Ave.
Kansas City, MO 64111
816.531.4144

Smith & Boucher
Mechanical/Electrical/Plumbing
State Certificate of Authority #EGC000178
25618 West 103rd St
Olathe, KS 66061
913.345.2127 phone

100% CONSTRUCTION DOCUMENTS

Franklin Elementary School
Liberty Public Schools
201 W Mill St.
Liberty, MO 64068

REVISIONS:

#	Description	Date
2	Addendum #2	12/15/23

smith & boucher
engineers

25618 west 103rd St olathe, ks 66061
phone 913.345.2127 fax 913.345.0617
project number 2314712

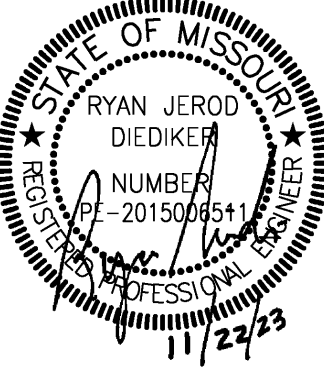

JOB NO: 23027
DRAWN BY: SBI
CHECKED BY: RJD
DATE: 11.10.2023

DE101A

KEY PLAN

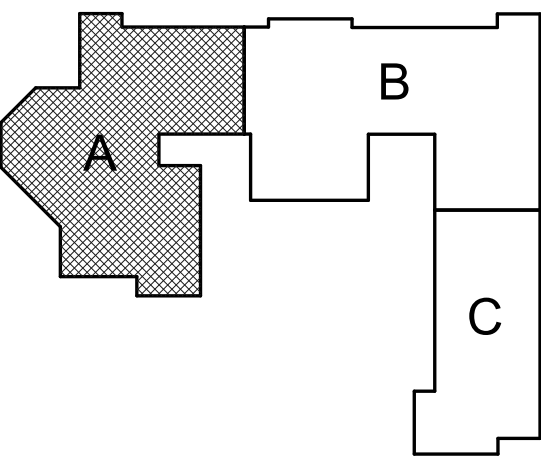

DEMOLITION LIGHTING PLAN - LEVEL 1 - AREA A

