



CommunityEd
Edina Public Schools



Summer 2024

**Camps, classes and programs
for youth ages 2-18**

Registration opens February 13 at 8 am | edina.ce.eleyo.com

Join us this summer

Edina Public Schools has meaningful adventures for early learners through twelfth grade to discover their possibilities and thrive. Summer is an opportunity for extended learning and a way for your child to explore and develop new skills and passions.

Edina Community Ed invites you to help your child find a place to belong within an array of program options.



Summer Highlights:

- ➔ Intentional focus on hiring young people to serve and support our young people
- ➔ Lunch Bunch opportunity extended to middle school students
- ➔ Expanded middle school offerings
 - New! Career Exploration class
 - Helping Hands class as an introduction to the Community Service Letter program
- ➔ Surrounding experiences in nature and the outdoors including:
 - “Learn to Fish at Normandale Lake”
 - “Writing in the Woods,” “Art in the Woods,” and more classes offered in partnership with Green Crew of the Minnesota Valley Chapter of the Izaak Walton League of MN

I look forward to seeing you and your family engaged in summer learning.

Sincerely,

Dr. Anne Marie Leland

Director of Community Education
and Strategic Partnerships
Edina Public Schools





Registration opens
February 13 at
8am. Register at
edina.ce.eleyo.com

What's Inside:

- Summer Overview..... 2
- Kids Club – School Age Care..... 4
- Summer Fun for Younger Ones 6
- Preview Week: June 3-6..... 7
- Week 1: June 10-13 8
- Week 2: June 17-20 12
- Week 3: June 24-27..... 18
- Week 4: July 8-11 22
- Week 5: July 15-18..... 28
- Week 6: July 22-25 32
- Week 7: July 29-August 1 36
- Week 8: August 5-8..... 40
- Encore Week 44
- Multi-Week Classes..... 46
- Early Childhood Family Education..... 49
- Building Community..... 50
- Community Ed for All 52
- Registration Information 53



Edina Community Ed offers classes, programs, and events for all ages. If you need help to register in Spanish, call 952-848-4064.

Edina Community Ed waxay bixisaa xiisado, barnaamijyo, iyo dhacdooyin da' kasta ah. Si aad u heshid caawimaad ku saabsan diiwaangelinta, fadlan wac 952-848-3985.

To register, visit edina.ce.eleyo.com

Summer Learning Overview

2024

A lot goes into planning a well-rounded summer of intention, purpose and fun for the young people in our community, and Edina Public Schools has a lot to offer. To help you build that summer calendar and know in advance what your options may be, we've assembled this overview of summer learning opportunities offered through Edina Community Ed and our District colleagues and partners.

Program	Description	Ages	Dates
Early Childhood Special Education (ECSE) Extended School Year (ESY)	Students continue work on goals outlined in their Individual Family Service Plan (IFSP) or Individual Education Plan (IEP).	Birth-incoming K	June 17-29, July 8-20
Early Childhood Family Education (ECFE)	Caregivers and children learn and grow together with licensed parent educators.	Birth-incoming K	June 10-August 10 No classes June 19, week of July 4
Preschool Enrichment	70+ play-based, developmentally appropriate classes taught by Early Learning Center staff and other qualified teachers.	Ages 2-5	June 10-August 10 No classes June 19, week of July 4
Kids Club	School age care offering a balance between structured and choice activities. Open 7:00am-6:00pm, M-F.	Incoming grades K-6	June 10-August 9 No care June 19, July 4-5
Enrichment Camps and Classes	400+ camps and classes nurture a love of learning, support academics and grow skills in technology, the arts, sports, and more. Most camps run 9:00am-12:00pm or 1:00-4:00pm, M-TH.	Incoming grades K-12	June 3-August 15 No classes June 19, week of July 4
excitED! Summer Targeted Services	Students able to be safe, independent and successful build academic, organizational and social/emotional skills to draw nearer to grade-level academic expectations. 9:00 am-3:00 pm, M-TH.	Incoming grades 1-6	July 8-18
Extended School Year (ESY)	Students with disabilities continue to work on goals outlined in their Individual Education Plan (IEP).	Incoming grades 1-12	June 17-28, July 8-19
Credit Recovery	Students who have fallen behind in their graduation plan may recover up to two credits toward graduation. 8:30-10:30am; 10:45am-12:45 pm.	Incoming grades 10-12	June 3-June 29



Location	Registration	Details	Questions?
Early Learning Center	By invitation	Free	Early Childhood Special Education/Student Support Services 952-848-4236
Early Learning Center	Edina.ce.eleyo.com Registration opens 8:00am February 13	Sliding fee scale	Edina Early Learning Center/ Community Ed and Strategic Partnerships 952-848-3908
Early Learning Center	Edina.ce.eleyo.com Registration opens 8:00am February 13	Tuition assistance available	Edina Early Learning Center/ Community Ed and Strategic Partnerships 952-848-3908
Creek Valley Normandale Cornelia	Edina.ce.eleyo.com Registration opens 8:00am February 13	Tuition assistance available	Kids Club/Community Ed and Strategic Partnerships 952-848-3947
Valley View, Edina High School, Edina Community Center, more	Edina.ce.eleyo.com Registration opens 8:00am February 13	Tuition assistance available	Enrichment Team/ Community Ed and Strategic Partnerships 952-848-3952
Countryside	By invitation. Invitations extended by March 15	Free	Youth Development Team/ Community Ed and Strategic Partnerships
Countryside (grades 1-5) Valley View (grades 6-8) Edina High (grades 9-12)	By invitation. Invitations extended by June 1	Free	Student Support Services Department 952-848-4960 x3946
Edina High School	By invitation based on school grades. Register by June 1	Free	Edina High School Options Alternative Learning Program 952-848-3084

Kids Club

Edina Public Schools' school age care program balances structured enrichment and choice-based activities with small group sizes to build strong relationships between students and staff.

Summer 2024

Dates: June 10–August 9*

Times: 7:00am–6:00 pm

Contract Info:

3 days/week, 6 week minimum

Locations:

Our locations are organized by grade level and school for age-appropriate opportunities to learn, grow, and connect.

Creek Valley Elementary: grades K-3 students who attend Creek Valley, Countryside or Cornelia

Normandale Elementary: grades K-3 students who attend Normandale, Concord, or Highlands

Cornelia Elementary: all students grades 4-6

Fees:

Registration Fee: \$40/contract

Field Trip Fee: \$155/contract

Schedule Change Fee: \$15

Tuition:

7:00 am–5:00 pm – \$53.50/day

7:00 am–6:00 pm – \$59/day

Registration: The contract request window is February 13, 8 am to February 26, 11:59 pm. Contract requests will be accepted during this two-week window. If more contracts are requested than available at a specific site, a random computerized lottery will be held. There will be no preference given for when the contract request was submitted. Registration details are available at edinacommunityed.com/kidsclub.

*Care will not be provided on June 19, July 4-5.



Scan here or visit
edinacommunityed.com/kidsclub to register for
Kids Club

School Year 2024-25

Dates: August 28–May 30

Times: 7:00 am–6:00 pm

Contract Info: Consistent Weekly Schedule (2 days/week minimum) or Non School Day Only

Fees:

Registration Fee: \$60/contract

Schedule Change Fee: \$15

Tuition:

Concord, Cornelia, Countryside, Creek Valley, Highlands:

7:00 am–7:50 am – \$9.10/day

2:25–5:00 pm – \$22.75/day

2:25–6:00 pm – \$31.55/day

Normandale:

7:00 am–8:40 am – \$14.25/day

3:15–5:00 pm – \$15.40/day

3:15–6:00 pm – \$24.25/day

Registration:

The contract request window is March 26, 8 am to April 8, 11:59 pm. Contract requests will be accepted during this two-week window. If more contracts are requested than available at a specific site, a random computerized lottery will be held. There will be no preference given for when the contract request was submitted. Registration details are available at edinacommunityed.com/kidsclub.

Need care on non school days?

Register for non school days to ensure you have the care you need all year!

2024-25 Non School Days

Oct 4, 17-18, Nov 27, Dec 23, 26-27, 30-31

Jan 2-3, 17, Feb 18, Mar 14, 31, Apr 1-4, 23*

Contract Info: Non school day only contract

Fees:

Registration Fee: \$60/contract

Schedule Change Fee: \$15

Tuition: 7:00 am–6:00 pm – \$59/day

Registration: Students with an accepted school year contract will be prioritized for non school day care requests. All other non school day contracts will be accepted on a first-come, first-serve basis. Non school day care must be requested at least ten business days before the non school day.

*Care will not be provided on Aug 26/27 (Connect & Assess) and Nov 5 (Election Day)



Discovering the Power of Play and Nature with Outdoor Programming

Letting kids be kids is at the heart of Edina Community Ed's outdoor nature program. This hands-off, child-led approach taps into children's innate creativity, imagination and sense of adventure.

Jonah, a 25-year veteran staff member with Kids Club, is one of the pioneering forces behind bringing this program to Kids Club. After completing an intensive training program in New Hampshire, Jonah and a colleague launched its pioneer program at Highlands Elementary in summer 2022. Plans are in place to expand the program to Countryside Elementary.

The nature camp method is all about restoring play, especially unstructured, outdoor play. "It's a catalyst for bringing creative play back and letting kids flourish and thrive by exploring, using their imagination and just being kids," Jonah explained.

Each day revolves around a different theme, often tied to beloved children's stories like "Where the Wild Things Are." Kids are encouraged to dress up,

build forts and structures, and role play along with the theme. Adults supervise but take a hands-off approach, allowing students to take the lead.

This child-directed, sensory-rich outdoor play fosters teamwork, cooperation, conflict resolution and other critical life skills. Unplugged from technology and given the freedom of open-ended play, children engage their senses and exercise creativity.

The pandemic amplified the need for programs like this that get young people outdoors and interacting in a meaningful way. Jonah has seen the profound impact firsthand. "It's one of the more meaningful programs the kids have gotten to experience," he said.

Parent feedback highlights the benefits of outdoor exploration, imagination, and emerging interests that come through the nature-based approach. As demand grows, Edina Community Ed has plans to continue increasing accessibility and expanding more offerings community-wide.



Summer Fun for Younger Ones

We want everyone to have the best summer ever! So for our youngest friends, we’ve got some classes to enjoy in between trips to the park, pool and lake.

Summer at a Glance

Summer camps especially for younger learners appear in their own section, “Preschool Enrichment,” on the following pages.

Preview week: June 3–6	7
Week 1: June 10–13	8
Week 2: June 17–20	12
Week 3: June 24–27	18
Week 4: July 8–11	22
Week 5: July 15–18	28
Week 6: July 22–25	32
Week 7: July 29–Aug 1	36
Week 8: Aug 5–8	40
Encore Week: Aug 12–15	44
Multi-Week Camps and Classes	46
Early Childhood Family Education	49

Kids Club welcomes students entering kindergarten. See page 4 for details.

2024 Highlights

We offer loads of fun classes, developed and taught by Edina Early Learning Center teachers. Options range from learning some Spanish and cooking, to gardening and STEAM.

- Morning and afternoon classes are available each week of summer
- For budding athletes, we have late afternoon/early evening sports options
- Class sizes are intentionally set small, so register early!

Early Childhood Family Education

The Early Learning Center offers ECFE classes for families with children ages birth through five years. See summer ECFE classes on page 51.

PreK Lunch Bunch

Taught by an ELC Teacher: Looking for an extra hour for your child to be with other kids? Join for a supervised Lunch Bunch after a morning camp, or between camps! Please provide your child’s nut-free lunch. Offered Monday through Thursday every week.

Edina Learning Center
 Mon-Thurs 11:30am-12:30pm
 3 sessions \$52





Preview Week

JUNE 3-6

Sports, Health & Fitness

Edina Dance Team Dance Camp: Ages 4-12

Edina Community Center 9 am-12 pm
\$179 603-B2031

Hornet Tennis Camp: Gr. 6-8

Edina Community Center 9 am-12 pm
\$195 603-L1037

Hornet Track and Field Camp

Gr. K-2

Edina Community Center 9 am-12 pm
\$169 603-L1033

Gr. 3-5

Edina Community Center 9 am-12 pm
\$169 603-L1034

Gaard Performance Academy Jr. Hitters Tennis Camp: Grades K-5

Creek Valley 10 am-12 pm
\$165 603-B2032

Gaard Performance Academy Girls' Basketball Summer Camp: Grades K-5

Edina Community Center 1-3 pm
\$165 603-B2035



Scan here or visit
[edinacommunityed.com/
summer2024](https://edinacommunityed.com/summer2024) for summer
class descriptions



Multi-Week Classes Starting This Week

See pages 46-48 for details

Driver's Education: Classroom Instruction
& Behind the Wheel: Ages 14.5-18

Online: Driver's Education: Classroom
Instruction & Behind the Wheel: Ages 14.5-18

Young Summer Band: Gr. 6-7

Jumpstart Band for Beginners: Gr. 5

HS Summer Jazz Band: Gr. 10 & 11

OK Summer Jazz Band: Gr. 9-10

YK Summer Jazz Band: Gr. 7-8

Hornet Summer Band: Gr. 8 -10

Hornet Flag Football Camp: Gr. K-2

Edina Community Center 1-4 pm
\$169 603-L1036

Hornet Flag Football Camp: Boys Gr. 3-5

Edina Community Center 1-4 pm
\$169 603-L1035

Hornet Flag Football Camp: Girls Gr. 3-5

Edina Community Center 1-4 pm
\$169 603-L1072

Hornet Tennis Camp: Gr. K-5

Edina Community Center 1-4 pm
\$195 603-L1038

To register, visit edinac.ce.eleyo.com

Week 1

JUNE 10-13



Most of our summer camps run Monday-Thursday from 9:00 am to 12:00 pm or 1:00 pm to 4:00 pm as listed. Please review your choices carefully as some times differ.



Multi-Week Classes Starting This Week

See pages 46-48 for details

Mikkonen Music: Summer Piano, Guitar, and Ukulele Lessons

Online: Private ACT Tutoring for the July 2024 Exam: Gr. 10-12

Little Musikkmakers: Ages 2 - 4

Hornet Girls Basketball Camp: Gr. 4-12

Summer Ballet Fundamentals I: Ages 3-5.5

Summer Ballet Fundamentals II/III: Ages 5.5-7

Summer Pre-Teen Ballet: Ages 8-13

Kung Fu- Wu Shu for Self-Defense and Fitness

Swim Team Prep: Ages 6-10

Sunshine Saturdays; Schoolyard Fun for All Ages: Gr. K-8

Lunch Bunch

Lunch Bunch and MS Sandwich Society are fun ways for students to bridge the gap between the morning camps and the afternoon camps. Pack a lunch and enjoy some down time with new bodies and old pals. Campers will be picked up from their morning camps by Community Ed Enrichment Rec Leaders. Please note: these programs are available at the Early Learning Center and Valley View Middle School sites only.

Lunch Bunch: 3.5-5 yrs old

Edina Community Center 11:30 am-12:30 pm
\$52 610-L5141

Lunch Bunch: K-5

Valley View Middle School 12-1 pm
\$44 610-B2180

MS Sandwich Society: 6-8

Valley View Middle School 12-1 pm
\$44 610-B2189

Preschool Enrichment

I Can Do It!: Preschool Independence & Emotions

Edina Learning Center 8:30-11:30 am
\$170 610-L5139

PreK Adventure Camp: All About Bugs

Edina Learning Center Mon-Fri, 8:30 am-2:30 pm
\$390 610-L5134

Preschool LEGO Camp

Edina Learning Center 8:30-11:30 am
\$170 610-L5135

Sprinkles of Spanish: Bajo el Mar

Edina Learning Center 8:30-11:30 am
\$170 610-L5140



Scan here or visit
[edinacommunityed.com/
summer2024](https://www.edinacommunityed.com/summer2024) for summer
class descriptions

Super Science Summer Camp: Animals

Edina Learning Center Mon-Fri, 8:30 am-2:30 pm
\$390 610-L5137

Culinary Kids

Edina Learning Center 12:30-3:30 pm
\$170 610-L5138

Preschool LEGO Camp

Edina Learning Center 12:30-3:30 pm
\$170 610-L5136

DASH Soccer Tykes: Ages 2-4

Edina Community Center 4:30-5:00 pm
\$79 610-L5203

DASH Soccer Tykes: Ages 4-5

Edina Community Center 5:15-6:00 pm
\$89 610-L5204

DASH T-Ball Tykes: Ages 2-3

Edina Community Center 4:30-5:00 pm
\$79 610-L5205

DASH T-Ball Tykes: Ages 4-6

Edina Community Center 5:15-6:00 pm
\$89 610-L5206

Art, Theater, Music & Creativity**Paint and Clay: Gr. K-5**

Valley View Middle School 9 am-12 pm
\$205 610-B2016

Summer Orchestra Lessons: Gr. 5

Valley View Middle School Mon-Fri, 9 am-12 pm
\$100 610-B2101

Fun and Funky Jewelry: Gr. 3-5

Valley View Middle School 1-4 pm
\$200 610-B2107

Expand Your World & Enrichment**Bicycle Repair and Maintenance: Gr. 7-12**

Valley View Middle School 9-11 am
\$314 610-B2140

Clay for Days!: Gr. 2-5

Valley View Middle School 9 am-12 pm
\$175 610-B2123

College Application Bootcamp: Seniors

First Step to College Admission: Gr. 12
Valley View Middle School 9 am-12 pm
\$100 610-B2109

**College Application & Essay Writing Camp: Gr. 10-12**

Valley View Middle School 9 am-12 pm
\$159 610-L1047

Living in the Past: Ages 6-10

Cahill School 9 am - 1:30 pm
\$228 (camp only) 610-B2228
\$372 (camp + aftercare 1:30-3:30pm)

Money Explorers: Gr. 5-9

Valley View Middle School 9 am-12 pm
\$143 610-B2104

Unified Sensory Explorations: Gr. K-5

Valley View Middle School 9 am-12 pm
\$155 610-L1155

Unified Sensory Explorations: Gr. 6-12

Valley View Middle School 9 am-12 pm
\$155 610-L1156

College Application Bootcamp: Seniors

First Step to College Admission: Gr. 12
Valley View Middle School 1-4 pm
\$100 610-B2110

Safe Sitter: Babysitter Training: Gr. 4-8

Valley View Middle School 1-4 pm
\$125 610-L1157

Sports, Health & Fitness**DASH T-ball Camp: Gr. K-2**

Edina Community Center 9 am-12 pm
\$169 610-L1000

Edina Summer Wrestling Camp: Gr. K-6

Edina High School 9-11 am
\$110 610-L1070

Hornet Running Camp: Gr. 4-8

Edina Community Center 9 am-12 pm
\$169 610-L1039

Hornet Tennis Camp

Gr. K-5

Edina Community Center 9 am-12 pm
\$195 610-L1040

Gr. 6-8

Edina Community Center 9 am-12 pm
\$195 610-L1041

Schoolyard Games: Gr. K-5

Edina High School 9 am-12 pm
\$135 610-L1071

Gaard Performance Academy Jr. Hitters

Tennis Camp: Grades K-5

Creek Valley 10 am-12 pm
\$165 610-B2033

DASH Baseball Camp: Gr. 3-5

Edina Community Center 1-4 pm
\$169 610-L1001

Gaard Performance Academy Girls'

Basketball Summer Camp: Grades K-5

Edina Community Center 1-3 pm
\$165 610-B2036

Hornet Tennis Camp

Gr. K-5

Edina Community Center 1-4 pm
\$195 610-L1042

Gr. 6-8

Edina Community Center 1-4 pm
\$195 610-L1043

Schoolyard Games: Gr. K-5

Edina High School 1-4 pm
\$135 610-L1083

Edina Gymnastics June Session I: Gr. 2-10

Edina High School Tue-Thu, 5-8pm
\$125 611-L1800

STEM

Mega Boat Engineering using LEGO® Bricks:

Gr. 1-5

Valley View Middle School 9 am-12 pm
\$211 610-B2000

Project Knit: Gr. 6-9

Valley View Middle School 9 am-12 pm
\$235 610-L1018

Robotics 2.0: Grades 2-5

Valley View Middle School 9 am-12 pm
\$155 610-B2063

Virtual Reality Coding with JavaScript:

Gr. 5-8

Valley View Middle School 9 am-12 pm
\$179 610-B2073

3D Printing: Minecraft Creations: Gr. 4-8

Valley View Middle School 1-4 pm
\$215 610-B2088

Hogwarts' Secret Magic Lab: Gr. 1-5

Valley View Middle School 1-4 pm
\$211 610-B2001

Jr. Camp Fancy: Gr. K-3

Valley View Middle School 1-4 pm
\$215 610-B2087

Salon & Spa Products at Home: Gr. 6-9

Valley View Middle School 1-4 pm
\$235 610-L1019

Do it Best **JERRY'S**
HARDWARE

www.jerryshardware.com

\$5 OFF

Purchase of \$25 or More



CO5ALD
On regular priced merchandise. One coupon per visit. May not be combined with any other offers. See store for details. Expires 8/31/24. EDH

JERRY'S HAS IT!

Housewares & Cleaning Supplies

Lawn & Garden

Weber Grills

Wild Bird Center

Pet Food & Supplies

Stihl Chainsaws

Window & Screen Repair

Plumbing &

Electrical Supplies

Keys Made

Pick-Up & Delivery Service

Sharpening Service

Small Engine Repair

ST. LOUIS PARK | EDINA | BLOOMINGTON | EDEN PRAIRIE | MAPLE GROVE
Hours: Mon-Fri 8am-8pm | Sat 8am-6pm | Sun 10am-5pm



Edina Education Fund is the mission-aligned partner of the Edina Public Schools, working to bring MORE to each and every student in the areas of Literacy, STEAM and Mental Health and Wellness.

Become a member of the Sustainers Circle and **learn more at www.edinaedfund.org**



BAND TOGETHER



Edina Education Fund

**Join us for an outdoor concert event benefiting
Mental Health in our schools!**

Wednesday, August 21

6:00 - 10:00PM

Edina High School, main parking lot

Enjoy local bands, grab a treat from a food-truck, reconnect with friends and neighbors after summer break and support mental health services in all 10 Edina Public Schools



Week 2

JUNE 17-20

In observance of Juneteenth, there are no classes on Wednesday, June 19th. Please note that most classes this week will run Monday/Tuesday/Thursday. Most of our camps run 9:00 am to 12:00 pm or 1:00 pm to 4:00 pm as listed. Please review your choices carefully as some times differ.

Lunch Bunch

Lunch Bunch and MS Sandwich Society are fun ways for students to bridge the gap between the morning camps and the afternoon camps. Pack a lunch and enjoy some down time with new buddies and old pals. Campers will be picked up from their morning camps by Community Ed Enrichment Rec Leaders. Please note: these programs are available at the Early Learning Center and Valley View Middle School sites only.

Lunch Bunch: 3.5-5 yrs old
 ECC Mon, Tue/Thu, 11:30 am-12:30 pm
 \$39 617-L5150

Lunch Bunch: K-5
 Valley View Middle School Mon, Tue/Thu, 12-1 pm
 \$33 610-B2181

MS Sandwich Society: 6-8
 Valley View Middle School Mon, Tue/Thu, 12-1 pm
 \$33 610-B2190

Preschool Enrichment

All About Bugs!
 Edina Learning Center Mon, Tue/Thu, 8:30-11:30 am
 \$128 617-L5147

Disney STEAM Camp: Animals (inspired by The Lion King)
 ECC Mon, Tue/Thu, 8:30 am-12:30 pm
 \$165 617-L5143

PreK Adventure Camp: Wild Jungle
 ECC Mon/Wed-Fri, 8:30 am-2:30 pm
 \$312 617-L5142

Super Science Summer Camp: Light
 ECC Mon, Tue/Thu, Fri, 8:30 am-2:30 pm
 \$312 617-L5145

The Eras Tour: Preschool Edition
 Edina Learning Center Mon, Tue/Thu, 8:30-11:30 am
 \$128 617-L5148

Unicorns & Rainbows
 Edina Learning Center Mon, Tue/Thu, 8:30-11:30 am
 \$128 617-L5144

An Enchanted Garden: Preschool Whimsy
 Edina Learning Center Mon, Tue/Thu, 12:30-3:30 pm
 \$128 617-L5149

Culinary Kids
 Edina Learning Center Mon, Tue/Thu, 12:30-3:30 pm
 \$128 617-L5146

DASH Intro to Tennis Tykes: Ages 4-6
 Edina Community Center Mon, Tue/Thu, 4:30-5:15 pm
 \$69 617-L5207



Scan here or visit [edinacommunityed.com/summer2024](https://www.edinacommunityed.com/summer2024) for summer class descriptions

Art, Theater, Music & Creativity

Art Blast!: Gr. K-5

Valley View Middle School Mon, Tue/Thu, 9 am-12 pm
\$154 617-B2017

Kids on Canvas: Gr. K-5

Valley View Middle School Mon, Tue/Thu, 1-4 pm
\$154 617-B2018

Expand Your World & Enrichment

Green Crew Adventure: Gr. 6-8

Valley View Middle School Mon, Tue/Thu, 9 am-4 pm
\$260 617-L1500



Sports, Health & Fitness

DASH Sports Sampler Camp: Gr. K-5

Edina Community Center Mon, Tue/Thu, 9 am-12 pm
\$129 617-L1002

Hornet Tennis Camp

Gr. K-5

Edina Community Center Mon, Tue/Thu, 9 am-12 pm
\$146 617-L1048

Gr. 6-8

Edina Community Center Mon, Tue/Thu, 9 am-12 pm
\$146 617-L1049

Schoolyard Games: Gr. K-5

Edina High School Mon, Tue/Thu, 9 am-12 pm
\$100 617-L1075

Edina Boys Basketball & Will DeBerg Basketball Camp

Gr. K-3

Edina High School Mon, Tue/Thu, Fri, 10:30 am-12 pm
\$150 617-L1130

Gr. 4-6

Edina High School Mon, Tue/Thu, Fri, 1-2:30 pm
\$150 617-L1131

Gr. 7-9

Edina High School Mon, Tue/Thu, Fri, 2:30-4 pm
\$150 617-L1133

DASH Pickleball Camp: Gr. K-5

Edina Community Center Mon, Tue/Thu, 1-4 pm
\$129 617-L1003

Schoolyard Games: Gr. K-5

Edina High School Mon, Tue/Thu, 1-4 pm
\$100 617-L1084

Edina Gymnastics June Session II: Gr. 2-10

Edina High School Tue/Thu, 5-8pm
\$85 611-L1801



Get your hands dirty and protect the environment

Monthly Project Days | Eco-Jeopardy Nights | Tree Planting | Camping

Environmental Board Game Nights | Water Quality Testing

Leave No Trace | Remove Invasive Species |

Pollinator Habitat | *and so much more!*

RSVP Today!

100% Free!



Leadership | Science | Service

www.GreenCrew.club/Summer24

The **Green Crew** is the youth-led leadership development and conservation service program of the Minnesota Valley Chapter of the Izaak Walton League, 6601 Auto Club Road Bloomington MN 55438



STEM

Art Studio: Gr. 6-9

Valley View Middle School Mon, Tue/Thu, 9 am-12 pm
\$176 617-L1020

Jr. Animal Crossing Engineering Camp: Gr. K-3

Valley View Middle School Mon, Tue/Thu, 9 am-12 pm
\$162 617-B2089

Kids vs. Wild: Gr. 1-4

Valley View Middle School Mon, Tue/Thu, 9 am-12 pm
\$177 617-B2002

Web Design and Development: Gr. 6-8

Valley View Middle School Mon, Tue/Thu, 9am-12pm
\$135 617-B2074

Jr. Digging for Dinos: Gr. K-3

Valley View Middle School Mon, Tue/Thu, 1-4 pm
\$162 617-B2090

Robotic Pet Lab: Gr. 1-4

Valley View Middle School Mon, Tue/Thu, 1-4 pm
\$177 617-B2003

Rocket Builder Design Camp: Gr. 5-9

Valley View Middle School Mon, Tue/Thu, 1-4 pm
\$176 617-L1021







Piano, Guitar & Ukulele Lessons

Edina Community Education & Mikkonen Music LLC

- 1 on 1 Instruction
- Experienced Teachers
- Grades 1 - 12
- Great for "Kids Club" Kids

Book a lesson time at:

www.bookeo.com/mikkonenmusic_scheduling

henry@mikkonenmusic.com | (651) 253-5957







Edina
Give and Go

Give Help
so all EPS students
can participate



20% of students
(that's 1 in 5) can't afford
to participate in sports,
theater, camp, band, tutoring,
and other out-of-school
activities with their peers.

**Donate to Edina Give
and Go to support a
student today!**



Need Help
paying for summer
activities?



Edina Give and Go
provides individual
activity grants in the
summer for each
qualifying Edina Public
Schools student.

**Scan the code to
learn more and
apply for a grant.**



LEARN MORE AT [EDINAGIVEANDGO.ORG](https://www.edinagiveandgo.org) OR 952-848-4483



Expanded Offerings for Middle and High School Students

From driver's education to babysitting certification, Edina Community Ed has long provided programs tailored to middle and high school students. Last summer, 141 middle school students attained their babysitter certification and 346 students took driver's ed. However, families may be unaware of the wide range of new courses Community Ed also offers this age group.

“Beyond the traditional classes people expect, we're actively growing advanced, career-oriented, and creative class options where students can explore passions and interests,” explained Edina Community Ed Community Involvement Programs Coordinator, Cheryl Guinness.

Recent course examples span coding, architecture design, Mexican culture and cuisine, unified sports, theater improv, music, and clothing design. The summer 2024 catalog also introduces new nature programs at Valley View Middle School, lunch options for students taking back-to-back Community Ed classes, and career exploration initiatives.

With volunteer and paid job opportunities, Edina Community Ed also prompts students to engage in their community. High schoolers ages 16 and older can obtain certifications to work as lifeguards, swim instructors, and summer Kids Club and enrichment leads. Volunteer positions help students connect with younger learners



“Beyond the traditional classes people expect, we’re actively growing advanced, career-oriented, and creative class options where students can explore passions and interests.”

CHERYL GUNNESS

Community Involvement Programs Coordinator

both in and out of the classroom and pursue service hours towards community service letters. Students will also have chances to delve into diverse career fields, with activities such as guest speaker sessions and off-site visits. Through these opportunities, students will gain insights from professionals across a range of career paths.

“By collaborating with our partners, we hope to meet student and family demand for engaging enrichment beyond academics,” Gunness shared.

From personal hobbies to future careers, Community Ed’s middle and high school programming encourages students to pursue passions, learn life skills, and uncover their purpose.



Scan here or visit edinacommunityed.com/summer2024 for summer class descriptions



Week 3

JUNE 24-27

Most of our summer camps run Monday-Thursday from 9:00 am to 12:00 pm or 1:00 pm to 4:00 pm as listed. Please review your choices carefully as some times differ.



Multi-Week Classes Starting This Week

See pages 46-48 for details

Driver's Education: Classroom Instruction & Behind the Wheel: Ages 14.5-18 (June/July)

Lunch Bunch

Lunch Bunch and MS Sandwich Society are fun ways for students to bridge the gap between the morning camps and the afternoon camps. Pack a lunch and enjoy some down time with new buddies and old pals. Campers will be picked up from their morning camps by Community Ed Enrichment Rec Leaders. Please note: these programs are available at the Early Learning Center and Valley View Middle School sites only.

Lunch Bunch: 3.5-5 yrs old

Edina Community Center 11:30 am-12:30 pm
\$52 624-L5161

Lunch Bunch: K-5

Valley View Middle School 12-1 pm
\$44 610-B2182

MS Sandwich Society: 6-8

Valley View Middle School 12-1 pm
\$44 610-B2191

Preschool Enrichment

Disney STEAM Camp: Creepy Crawlies (inspired by A Bug's Life)

Edina Learning Center 8:30 am-12:30 pm
\$220 624-L5153

Paw Patrol Preschool Adventure

Edina Learning Center 8:30-11:30 am
\$170 624-L5154

Pete the Cat Book Club

Edina Learning Center 8:30-11:30 am
\$170 624-L5158

PreK Adventure Camp: Spectacular Space

Edina Learning Center Mon-Fri, 8:30 am-2:30 pm
\$390 624-L5152

Preschool Travelers

Edina Learning Center 8:30-11:30 am
\$170 624-L5159

Super Science Summer Camp: Plants

Edina Learning Center Mon-Fri, 8:30 am-2:30 pm
\$390 624-L5156

Culinary Kids

Edina Learning Center 12:30-3:30 pm
\$170 624-L5157

Paw Patrol Preschool Adventure

Edina Learning Center 12:30-3:30 pm
\$170 624-L5155

Sprinkles of Spanish: Explorando la Naturaleza

Edina Learning Center 12:30-3:30 pm
\$170 624-L5160

DASH Floor Hockey Tykes: Ages 3-5

Valley View Middle School 4:30-5:15 pm
\$89 624-L5208

Art, Theater, Music & Creativity

Dream Space - Ultimate Interior Designer: Gr. 2-5

Valley View Middle School 9 am-12 pm
\$205 624-B2019

Hip Hop Dance Party: Gr. K-3

Valley View Middle School 10 am-12 pm
\$135 624-B2117

Beginning Guitar: Gr. 4-8

Valley View Middle School 1-4 pm
\$245 624-B2064

Hip Hop Dance Party: Gr. 3-5

Valley View Middle School 1-3 pm
\$135 624-B2118

Watercolor Studio: Gr. K-5

Valley View Middle School 1-4 pm
\$205 624-B2020

Expand Your World & Enrichment

Introduction to Novel Writing: Gr. 6-9

Valley View Middle School 1-4 pm
\$195 624-L1023

Pioneers and Trailblazers: Ages 6-10

Cahill School 9 am-1:30 pm
\$228 (camp only) 624-B2230
\$372 (camp + aftercare 1:30-3:30pm)



Scan here or visit edinacommunityed.com/summer2024 for summer class descriptions



Be a Girl Scout!



Learn more at gsrv.gs/join

Sweet Summertime (Children’s Cooking Class): Gr. K-5

Edina Community Center Tue, 10-11 am
\$40 625-B2222

Red, White, and BOOM! (Children’s Cooking Class): Gr. K-5

Edina Community Center Thu, 10-11 am
\$40 627-B2223

Sports, Health & Fitness

DASH Multisport Camp: Gr. K-5

Valley View Middle School 9 am-12 pm
\$169 624-L1004

Fencing: Gr. 2-5

Valley View Middle School 9 am-12 pm
\$172 624-B2065

Hornet Tennis Camp

Gr. K-5
Edina Community Center 9 am-12 pm
\$195 624-L1050

Gr. 6-8

Edina Community Center 9 am-12 pm
\$195 624-L1051

Hockey Training Camp: Gr. 4-8

Edina High School 9 am-12 pm
\$225 624-L1145

Schoolyard Games: Gr. K-5

Edina High School 9 am-12 pm
\$135 624-L1076

DASH Floor Hockey Camp: Gr. K-5

Valley View Middle School 1-4 pm
\$169 624-L1005

Edina Boys Basketball & Will DeBerg Basketball Camp

Gr. K-3
Edina High School 10:30 am-12 pm
\$150 624-L1126

Gr. 4-6

Edina High School 1-2:30 pm
\$150 624-L1128

Gr. 7-9

Edina High School 2:30-4 pm
\$150 624-L1129

Fencing: Gr. 6-12

Valley View Middle School 1-4 pm
\$172 624-B2066

Learn To Fish At Lake Normandale: Gr. 5-12

Normandale Lake 1-5 pm
\$335 624-L1099

Schoolyard Games: Gr. K-5

Edina High School 1-4 pm
\$135 624-L1085

Edina Gymnastics June Session III: Gr. 2-10

Edina High School Tue-Thu, 5-8pm
\$125 625-L1802



Scan here or visit edinacommunityed.com/summer2024 for summer class descriptions



STEM

Intro to Computer Science with Python: Gr. 5-8

Valley View Middle School 9 am-12 pm
\$179 624-B2075

Jr. Explorers: Wings, Wheels and Sails Camp: Gr. K-3

Valley View Middle School 9 am-12 pm
\$215 624-B2091

Minecraft Pokémon Adventures: Gr. 2-5

Valley View Middle School 9 am-12 pm
\$217 624-B2004

Strategy Game Buffet: Gr. 5-9

Valley View Middle School 9 am-12 pm
\$195 624-L1022

3D Printing: Product Development & Fabrication: Gr. 5-8

Valley View Middle School 1-4 pm
\$192 624-B2076

Candy Lab: Gr. K-4

Valley View Middle School 1-4 pm
\$217 624-B2005



YES.
Life CAN be better.

Call for FREE Adult
ESL (English) Classes

- ADULT DIPLOMA
- COLLEGE PREP
- CAREER PATHWAYS
- GED

952-681-6170
METROSOUTH.ORG

Metro South | Adult Basic Education
ESL • ADULT DIPLOMA • GED

This program is partially funded with a grant from the Minnesota Department of Education using state and/or federal funding, Minnesota Statute Section 124D.522 and/or CFDA 84.002, Adult Basic Education-Grants to States. A proud partner of the American Job Center network.

A D U L T B A S I C E D U C A T I O N



Week 4

JULY 8-11

Most of our summer camps run Monday-Thursday from 9:00 am to 12:00 pm or 1:00 pm to 4:00 pm as listed. Please review your choices carefully as some times differ.



Multi-Week Classes Starting This Week

See pages 46-48 for details

- Theater for Kids: Finding Nemo: Gr. 3-8
- Craft, Cut Glue - Create Projects to enter in the MN State Fair: Gr. K-1, Gr. 2-7
- Green Crew: Writing In The Woods: Gr 9-12
- Online: Driver's Education: Classroom Instruction & Behind the Wheel: Ages 14.5-18 (July)
- Swim Lessons: Levels 1 - 4

Lunch Bunch

Lunch Bunch and MS Sandwich Society are fun ways for students to bridge the gap between the morning camps and the afternoon camps. Pack a lunch and enjoy some down time with new bodies and old pals. Campers will be picked up from their morning camps by Community Ed Enrichment Rec Leaders. Please note: these programs are available at the Early Learning Center and Valley View Middle School sites only.

- Lunch Bunch: K-5**
Valley View Middle School 12-1 pm
 \$44 610-B2183
- MS Sandwich Society: 6-8**
Valley View Middle School 12-1 pm
 \$44 610-B2192
- Lunch Bunch: 3.5-5 yrs old**
Edina Community Center 11:30 am-12:30 pm
 \$52 708-L5169

Preschool Enrichment

Art and the Park

Edina Learning Center 8:30–11:30 am
\$170 708-L5167

Disney STEAM Camp: Underwater World (inspired by Finding Nemo and The Little Mermaid)

Edina Learning Center 8:30 am–12:30 pm
\$220 708-L5164

PreK Adventure Camp: Cool Communities

Edina Learning Center Mon-Fri, 8:30 am–2:30 pm
\$390 708-L5165

Sprinkles of Spanish: Explorando la Naturaleza

Edina Learning Center 8:30–11:30 am
\$170 708-L5168

Super Science Summer Camp: Exercise & Health

Edina Learning Center Mon-Fri, 8:30 am–2:30 pm
\$390 708-L5166

Under the Sea

Edina Learning Center 8:30–11:30 am
\$170 708-L5163

Making Musical Memories

Edina Learning Center 9 am–12 pm
\$220 708-L5162

DASH Soccer Tykes

Ages 2-4

Edina Community Center 4:30–5 pm
\$79 708-L5209

Ages 4-6

Edina Community Center 5:15–6 pm
\$89 708-L5210

Art, Theater, Music & Creativity

Best Ever Silly, Messy, Wacky Art Camp: Gr. K-4

Valley View Middle School 9 am–12 pm
\$205 708-B2021

Project Runway: Gr. 4-8

Valley View Middle School 9 am–12 pm
\$190 708-B2067

Art and Yoga: Gr. K-4

Valley View Middle School 1–4 pm
\$205 708-B2022



Expand Your World & Enrichment

Choose Your Own Adventure Writing Camp: Gr. 4-6

Valley View Middle School 9 am–12 pm
\$189 708-L1057

College Application Bootcamp: Seniors First Step to College Admission: Gr. 12

Valley View Middle School 9 am–12 pm
\$100 708-B2111

Pioneers and Trailblazers: Ages 6-10

Cahill School 9 am–1:30 pm
\$228 (camp only) 708-B2231
\$372 (camp + aftercare 1:30-3:30pm)

Choose Your Own Adventure Writing Camp: Gr. 4-6

Valley View Middle School 1–4 pm
\$189 708-L1058

College Application Bootcamp: Seniors First Step to College Admission: Gr. 12

Valley View Middle School 1–4 pm
\$100 708-B2112

Discover Magic - Orange Wand: Gr. 3-6

Valley View Middle School 1–4 pm
\$250 708-B2105

Dungeons and Dragons Adventures: Gr. 4-12

Valley View Middle School 1–4 pm
\$200 708-L1106



Scan here or visit
[edinacommunityed.com/
summer2024](https://edinacommunityed.com/summer2024) for summer
class descriptions

Sports, Health & Fitness

DASH MLS GO Soccer Camp: Gr. K-2

Gr. K-2

Edina High School 9 am-12 pm
 \$169 (camp only) 708-L1180
 \$199 (camp + optional jersey)

Gr. 3-6

Edina High School 1-4 pm
 \$169 (camp only) 708-L1181
 \$199 (camp + optional jersey)

Hornet Tennis Camp

Gr. K-5

Edina Community Center 9 am-12 pm
 \$195 708-L1055

Gr. 6-8

Edina Community Center 9 am-12 pm
 \$195 708-L1056

Hornet Track and Field Camp

Gr. K-2

Edina Community Center 9 am-12 pm
 \$169 708-L1052

Gr. 3-5

Edina Community Center 9 am-12 pm
 \$169 708-L1053

Schoolyard Games: Gr. K-5

Edina High School 9 am-12 pm
 \$135 708-L1077

Edina Boys Basketball & Will DeBerg Basketball Camp

Gr. K-3

Edina High School 10:30 am-12 pm
 \$150 708-L1134

Gr. 4-6

Edina High School 1-2:30 pm
 \$150 708-L1136

Gr. 7-9

Edina High School 2:30-4 pm
 \$150 708-L1137

Hornet Flag Football Camp: Gr. K-2

Edina Community Center 1-4 pm
 \$169 708-L1054

Hornet Flag Football Camp: Boys Gr. 3-5

Edina Community Center 1-4 pm
 \$169 708-L1073

Hornet Flag Football Camp: Girls Gr. 3-5

Edina Community Center 1-4 pm
 \$169 708-L1074

Hornet HOT SHOTS: Gr. K-2

Edina Community Center 1-4 pm
 \$169 610-L1044

Hornet HOT SHOTS: Boys Gr. 3-5

Edina Community Center 1-4 pm
 \$169 610-L1046

Hornet HOT SHOTS: Girls Gr. 3-5

Edina Community Center 1-4 pm
 \$169 610-L1045

Schoolyard Games: Gr. K-5

Edina High School 1-4 pm
 \$135 708-L1086

STEM

Dungeon Adventures: Gr. 5-9

Valley View Middle School 9 am-12 pm
 \$195 708-L1024

Jr. World Games Engineering Camp: Gr. K-3

Valley View Middle School 9 am-12 pm
 \$215 708-B2092

Strategy Game Coding: Tower Defense:

Gr. 6-8

Valley View Middle School 9 am-12 pm
 \$179 708-B2077

X-Treme Build & Race! RC Cars using LEGO®: Gr. K-3

Valley View Middle School 9 am-12 pm
 \$211 708-B2006

Bloxel Builders: Video Game Design Camp: Gr. 4-8

Valley View Middle School 1-4 pm
 \$215 708-B2093

Drone Racing and Rocket Launching:

Gr. 2-5

Valley View Middle School 1-4 pm
 \$211 708-B2007

Extreme Robotics: Bionic Beasts & Creatures: Gr. 5-8

Valley View Middle School 1-4 pm
 \$179 708-B2078

Rock & Roll Band Camp: Gr. 6-9

Valley View Middle School 1-4 pm
 \$235 708-L1025



Scan here or visit edinacommunityed.com/summer2024 for summer class descriptions

CREATE AT HOME

Strawberries and Cream Popsicles

Materials needed:

- 8 oz strawberries (canned, fresh, frozen)
- $\frac{1}{2}$ cup sweetened condensed milk
- $\frac{1}{3}$ cup heavy cream



Instructions

1. In a medium saucepan over low heat, combine strawberries, sweetened condensed milk and heavy cream. Heat, stirring constantly, until ingredients are well combined and just slightly warm.
2. Remove from the heat and pour into popsicle molds, being sure to leave $\frac{1}{2}$ inch of space at the top of the molds.
3. Freeze at least 12 hours.
4. To serve, run molds under hot water to release pops. Serve immediately.

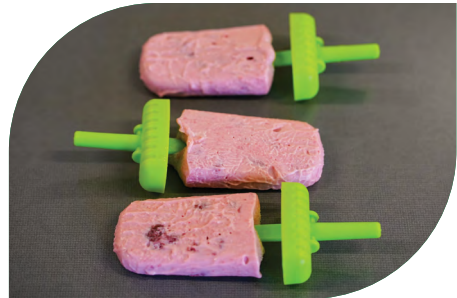



AmeriCorps Fellows Cultivate Connections

In summer 2023, a cohort of AmeriCorps fellows had the opportunity to serve local students through partnerships with Edina Community Ed. Fellows Oliver Leupold, Brian Maginnis, and Nathan Blum recently reflected on their rewarding experiences helping advance Edina Community Ed's work.

The collaboration originated from Community Ed's desire to expand access and impact with enrichment programs. AmeriCorps assigns fellows to communities and helps fill in the community's greatest need and opportunity. Together they're cultivating connections.

Leupold previously worked as a Community Ed summer enrichment lead, so he eagerly applied for the fellowship. Retiree and Edina High School grad Maginnis appreciated the chance to volunteer and give back within his hometown

district. Blum discovered the posting after seeking roles where he could gain teaching experience with youth.

In addition to online training, the AmeriCorps fellows gained hands-on practice thanks to flexible Community Ed programming options. They provided academic support with the elementary scholastic program and assisted various summer camps.

Blum fondly recalled a breakthrough moment helping a nonverbal student beam with pride and literally jump for joy. Maginnis enjoyed bonding with four budding chefs in the cooking camp kitchen and working one on one with elementary students on reading and math skills. Leupold's environmental justice camp overnight allowed him to broaden access to underserved students.



All three fellows emphasized how the experience honed patience and communication skills useful for any career, even if they don't ultimately pursue education roles. They appreciated discovering Community Ed's variety of community programs available.

With enriching results already evident in year one, Community Ed and AmeriCorps are excited to continue this service partnership. "There's an opportunity for anyone interested who wants experience working with youth in a learning environment," said Blum.

By tapping local talent through AmeriCorps fellowships, Edina Community Ed can further its mission to help all students thrive as part of an inclusive and dynamic learning community.



Edina Community Ed will again be hosting AmeriCorps Youth Learning and Enrichment Fellows in summer 2024. Interested in learning more? Please visit www.ampact.us/summer AND contact Cheryl Gunness, Community Involvement Programs Coordinator, for details. Cheryl.Gunness@edinaschools.org



Week 5

JULY 15-18

Most of our summer camps run Monday-Thursday from 9:00 am to 12:00 pm or 1:00 pm to 4:00 pm as listed. Please review your choices carefully as some times differ.



Multi-Week Classes Starting This Week

See pages 46-48 for details

Driver's Education: Classroom Instruction & Behind the Wheel: Ages 14.5-18 (July)

Summer Ballet Fundamentals I: Ages 3-5.5

Summer Ballet Fundamentals II/III: Ages 5.5-7

Summer Pre-Teen Ballet: Ages 8-13

Online: Private ACT Tutoring for the September 2024 Exam: Gr. 10-12

Lunch Bunch

Lunch Bunch and MS Sandwich Society are fun ways for students to bridge the gap between the morning camps and the afternoon camps. Pack a lunch and enjoy some down time with new bodies and old pals. Campers will be picked up from their morning camps by Community Ed Enrichment Rec Leaders. Please note: these programs are available at the Early Learning Center and Valley View Middle School sites only.

Lunch Bunch: K-5

Valley View Middle School
\$44

12-1 pm
610-B2184

MS Sandwich Society: 6-8

Valley View Middle School
\$44

12-1 pm
610-B2193

Lunch Bunch: 3.5-5 yrs old

Edina Community Center
\$52

11:30 am-12:30 pm
715-L5176



Preschool Enrichment

Cool Crafts for Preschoolers

Edina Learning Center 8:30–11:30 am
\$170 715-L5172

Disney STEAM Camp: Cooking! (inspired by Ratatouille)

Edina Learning Center 8:30 am–12:30 pm
\$220 715-L5171

PreK Adventure Camp: Ocean Adventures

Edina Learning Center Mon–Fri, 8:30 am–2:30 pm
\$390 715-L5170

Summer Growing: A Preschooler's Garden Club

Edina Learning Center 8:30–11:30 am
\$170 715-L5175

Super Science Summer Camp: Bugs & Insects

Edina Learning Center Mon–Fri, 8:30 am–2:30 pm
\$390 715-L5173

Culinary Kids

Edina Learning Center 12:30–3:30 pm
\$170 715-L5174

DASH NFL Flag Football Tykes: Ages 2-4

Edina Community Center 4:30–5 pm
\$79 715-L5211

DASH NFL Flag Football Tykes: Ages 4-6

Edina Community Center 5:15–6 pm
\$89 715-L5212

Art, Theater, Music & Creativity

Fantastic Camp of Art and Imagination: Gr. K-5

Valley View Middle School 9 am–12 pm
\$205 715-B2103

Middle School Orchestra Camp: Grades 6-9

Valley View Middle School Mon–Fri, 9 am–2 pm
\$172 715-B2103

Marvelous, Magical Creatures: Gr. K-4

Valley View Middle School 1–4 pm
\$205 715-B2024

Expand Your World & Enrichment

Sweet Treats: Gr. 6-9

Valley View Middle School 1–4 pm
\$235 715-L1144

Donuts for Days (Children's Cooking Class): Gr. K-5

Edina Community Center Wed, 10–11 am
\$40 717-B2227

Junior Historians: Ages 10-13

Cahill School 9 am–1:30 pm
\$228 (camp only) 715-B2233
\$372 (camp + aftercare 1:30–3:30pm)



Scan here or visit
[edinacommunityed.com/
summer2024](https://edinacommunityed.com/summer2024) for summer
class descriptions



Sports, Health & Fitness

DASH NFL Flag Football Camp: Gr. K-2

Edina Community Center 9 am-12 pm
 \$169 class only, \$199 class + jersey 715-L1008

DASH NFL Flag Football Camp: Gr. 3-6

Edina Community Center 1-4 pm
 \$169 class only, \$199 class + jersey 715-L1009

Hornet Tennis Camp

Gr. K-5
 Edina Community Center 9 am-12 pm
 \$195 715-L1059

Gr. 6-8
 Edina Community Center 9 am-12 pm
 \$195 715-L1060

Edina High School Volleyball Camp: Gr. 6-8 (Boys & Girls)

Edina High School 4:30-6 pm
 \$150 715-L1182

Schoolyard Games: Gr. K-5

Edina High School 9 am-12 pm
 \$135 715-L1078

Edina Boys Basketball & Will DeBerg Basketball Camp

Gr. K-3
 Edina High School 10:30 am-12 pm
 \$150 715-L1138

Gr. 4-6
 Edina High School 1-2:30 pm
 \$150 715-L1140

Gr. 7-9
 Edina High School 2:30-4 pm
 \$150 715-L1141



Will DeBerg Girls Only Basketball Camp

Gr. 3-5
 Edina Community Center 1-2:30 pm
 \$170 715-L1148

Gr. 6-8
 Edina Community Center 2:30-4 pm
 \$170 715-L1149

Schoolyard Games: Gr. K-5

Edina High School 1-4 pm
 \$135 715-L1087

Edina Gymnastics July Session I: Gr. 2-10

Edina High School Tue-Thu, 5-8pm
 \$125 716-L1803

STEM

Artificial Intelligence and Machine Learning with Python: Gr. 6-8

Valley View Middle School 9 am-12 pm
\$179 715-B2079

Jr. Engineer: Battle Bots: Gr. 1-4

Valley View Middle School 9 am-12 pm
\$211 715-B2008

Jr. Phineas & Ferb's Ingenious Engineers Camp: Gr. K-3

Valley View Middle School 9 am-12 pm
\$215 715-B2094

Robotics Evolution: Gr. 4-8

Valley View Middle School 9 am-12 pm
\$205 715-B2068

Extreme Robotics: Medieval Battlebots: Gr. 5-8

Valley View Middle School 1-4 pm
\$172 715-B2080

Jr. Target Games Engineering Camp: Gr. K-3

Valley View Middle School 1-4 pm
\$215 715-B2095

Minecraft World Edit: Gr. 2-5

Valley View Middle School 1-4 pm
\$217 715-B2009

Role Playing and World Building: Dungeon Master Camp: Gr. 5-9

Valley View Middle School 1-4 pm
\$195 715-L1026



Scan here or visit
[edinacommunityed.com/
summer2024](https://edinacommunityed.com/summer2024) for summer
class descriptions

CAMP WOODS KIDS

Summer program for kids

June 10-13, 2024 | 9 a.m. - 12 p.m. daily

Ages: 3 years old - grade 4

Edina & Eden Prairie locations

Camp Woods Kids is a half-day summer program filled with undersea-themed activities, learning, music and crafts.



Register at wooddale.org/camp-woods-kids



Week 6

JULY 22-25

Most of our summer camps run Monday-Thursday from 9:00 am to 12:00 pm or 1:00 pm to 4:00 pm as listed. Please review your choices carefully as some times differ.



Multi-Week Classes Starting This Week

See pages 46-48 for details

Green Crew: Shakespeare in The Woods:
Gr. 9-12

Swim Lessons: Levels 1-4



Scan here or visit edinacommunityed.com/summer2024 for summer class descriptions

Lunch Bunch

Lunch Bunch and MS Sandwich Society are fun ways for students to bridge the gap between the morning camps and the afternoon camps. Pack a lunch and enjoy some down time with new bodies and old pals. Campers will be picked up from their morning camps by Community Ed Enrichment Rec Leaders. Please note: these programs are available at the Early Learning Center and Valley View Middle School sites only.

Lunch Bunch: 3.5-5 yrs old

Edina Community Center 11:30 am-12:30 pm
\$52 722-L5185

Lunch Bunch: K-5

Valley View Middle School 12-1 pm
\$44 610-B2185

MS Sandwich Society: 6-8

Valley View Middle School 12-1 pm
\$44 610-B2194

Preschool Enrichment

Dinosaur Excavation Camp

Edina Learning Center 8:30–11:30 am
\$170 722-L5179

Disney STEAM Camp: Ice (inspired by Frozen)

Edina Learning Center 8:30 am–12:30 pm
\$220 722-L5178

PreK Adventure Camp: Awesome Art

Edina Learning Center Mon-Fri, 8:30 am–2:30 pm
\$390 722-L5177

Sprinkles of Spanish: Semana del Arcoiris

Edina Learning Center 8:30–11:30 am
\$170 722-L5183

Summer Growing: A Preschooler's Garden Club

Edina Learning Center 8:30–11:30 am
\$170 722-L5182

Super Science Summer Camp: Water

Edina Learning Center Mon-Fri, 8:30 am–2:30 pm
\$390 722-L5180

Culinary Kids

Edina Learning Center 12:30–3:30 pm
\$170 722-L5181

Sprinkles of Spanish: Bajo el Mar

Edina Learning Center 12:30–3:30 pm
\$170 722-L5184

DASH Athleticism Tykes: Ages 2-4

Edina Community Center 4:30–5 pm
\$79 722-L5213

DASH Athleticism Tykes: Ages 4-6

Edina Community Center 5:15–6 pm
\$89 722-L5214



Art, Theater, Music & Creativity

Cookies and Art: Gr. K-5

Valley View Middle School 9 am–12 pm
\$205 722-B2025

Ultimate Art Effects: Gr. K-5

Valley View Middle School 1–4 pm
\$205 722-B2026

Unified Theater Together

Gr. K-5
Valley View Middle School 1–4 pm
\$155 722-L1158

Gr. 6-12

Valley View Middle School 1–4 pm
\$155 722-L1160

Expand Your World & Enrichment

Bicycle Repair and Maintenance: Gr. 7-12

Valley View Middle School 9–11 am
\$314 722-B2141

Chess Summer Camp: Gr. 1-5

Valley View Middle School 9 am–12 pm
\$162 722-B2069

Clay for Days!: Gr. 2-5

Valley View Middle School 9 am–12 pm
\$175 722-B2123

Green Crew Adventure: Gr 6-8

Valley View Middle School 9 am–4 pm
\$260 617-L1503

Learn Spanish with Language Sprout!:

Gr. K-5
Valley View Middle School 9 am–12 pm
\$257 722-B2171



Safe Sitter: Babysitter Training: Gr. 4-8

Valley View Middle School 9 am-12 pm
\$125 722-L1168

Living in the Past: Ages 6-10

Cahill School 9 am-1:30 pm
\$228 (camp only) 722-B2229
\$372 (camp + aftercare 1:30-3:30pm)

We all Scream for Ice Cream (Children’s Cooking Class): Gr. K-5

Edina Community Center Wed, 10-11 am
\$40 724-B2224

Bonjour French Camp

Gr. K

Valley View Middle School 10 am-12 pm
\$160 722-B2125

Valley View Middle School 1-3 pm
\$160 722-B2130

Gr. 1

Valley View Middle School 10 am-12 pm
\$160 722-B2126

Valley View Middle School 1-3 pm
\$160 722-B2131

Gr. 2

Valley View Middle School 10 am-3 pm
\$395 722-B2127

Gr. 3

Valley View Middle School 10 am-3 pm
\$395 722-B2128

Gr. 4-5

Valley View Middle School 10 am-3 pm
\$395 722-B2129

Beginner Bicycle Repair and Maintenance:

Gr. 6-8

Valley View Middle School Thursday, 12:30-2:30 pm
\$79 722-B2142

Sports, Health & Fitness

DASH Intro to Lacrosse Camp: Gr. K-5

Edina Community Center 9 am-12 pm
\$169 722-L1012

Hornet Tennis Camp

Gr. K-5

Edina Community Center 9 am-12 pm
\$195 722-L1061

Gr. 6-8

Edina Community Center 9 am-12 pm
\$195 722-L1062

Schoolyard Games: Gr. K-5

Edina High School 9 am-12 pm
\$135 722-L1079



Soccer Around The World!: Gr. 2-3

Valley View Middle School 9 am-12 pm
\$180 722-L1100

Will DeBerg Youth Basketball Skills Camp and League: Boys Only

Gr. 3-4

Edina High School 9 am-12 pm
\$170 skills camp, \$170 league only, 722-L1112
\$249 skills camp + league

Gr. 5-6

Edina High School 9 am-12 pm
\$170 skills camp, \$170 league only, 722-L1113
\$249 skills camp + league

Gr. 7-9

Edina High School 12:15-3:15 pm
\$170 skills camp, \$170 league only, 722-L1114
\$249 skills camp + league



Scan here or visit [edinacommunityed.com/summer2024](https://www.edinacommunityed.com/summer2024) for summer class descriptions

Will DeBerg Little Dribblers Basketball:**Grades K-2**

Edina High School 1-2:30 pm
\$170 722-L1111

Will DeBerg Girls Only Basketball Camp**Gr. 3-5**

Edina Community Center 1-2:30 pm
\$170 722-L1150

Gr. 6-8

Edina Community Center 2:30-4 pm
\$170 722-L1151

Archery and Adventure: Grades 4-12

Edina Community Center 1-4 pm
\$225 722-L1105

DASH Athleticism Camp: Gr. K-5

Edina Community Center 1-4 pm
\$169 722-L1013

Schoolyard Games: Gr. K-5

Edina High School 1-4 pm
\$135 722-L1088

Edina Gymnastics July Session II: Gr. 2-10

Edina High School Tue-Thu, 5-8pm
\$125 723-L1804

STEM**Crazy Concoctions and Insane Inventions:
Gr. K-3**

Valley View Middle School 9 am-12 pm
\$217 722-B2010

DIY Crafting: Gr. 6-9

Valley View Middle School 9 am-12 pm
\$235 722-L1027

Mobile Game and App Development: Gr. 5-8

Valley View Middle School 9 am-12 pm
\$179 722-B2081

Drone Maker Engineering Camp: Gr. 4-8

Valley View Middle School 1-4 pm
\$215 722-B2097

Glam Lab - Stunning Science: Gr. 1-4

Valley View Middle School 1-4 pm
\$217 722-B2011

Global Cuisine from Scratch: Gr. 6-9

Valley View Middle School 1-4 pm
\$235 722-L1028

Jr. Wizards Engineering Camp: Gr. K-3

Valley View Middle School 1-4 pm
\$215 722-B2096





Week 7
JULY 29-AUGUST 1

Most of our summer camps run Monday-Thursday from 9:00 am to 12:00 pm or 1:00 pm to 4:00 pm as listed. Please review your choices carefully as some times differ.



Multi-Week Classes Starting This Week

See pages 46-48 for details

Driver's Education: Classroom Instruction & Behind the Wheel: Ages 14.5-18 (July/Aug)

Lunch Bunch

Lunch Bunch and MS Sandwich Society are fun ways for students to bridge the gap between the morning camps and the afternoon camps. Pack a lunch and enjoy some down time with new bodies and old pals. Campers will be picked up from their morning camps by Community Ed Enrichment Rec Leaders. Please note: these programs are available at the Early Learning Center and Valley View Middle School sites only.

Lunch Bunch: 3.5-5 yrs old

Edina Community Center 11:30 am-12:30 pm
 \$52 729-L5194

Lunch Bunch: K-5

Valley View Middle School 12-1 pm
 \$44 610-B2186

MS Sandwich Society: 6-8

Valley View Middle School 12-1 pm
 \$44 610-B2195



Scan here or visit edinacommunityed.com/summer2024 for summer class descriptions

Preschool Enrichment

Disney STEAM Camp: Things That Go (inspired by Cars and Planes)

Edina Learning Center 8:30 am-12:30 pm
\$220 729-L5187

My Very Own Art Museum

Edina Learning Center 8:30-11:30 am
\$170 729-L5190

PreK Adventure Camp: All About the Olympics

Edina Learning Center Mon-Fri, 8:30 am-2:30 pm
\$390 729-L5186

Silly Circus Fun for Preschoolers

Edina Learning Center 8:30-11:30 am
\$170 729-L5188

Summer Growing: A Preschooler's Garden Club

Edina Learning Center 8:30-11:30 am
\$170 729-L5192

Super Science Summer Camp: Weather

Edina Learning Center Mon-Fri, 8:30 am-2:30 pm
\$390 729-L5189

The Eras Tour: Preschool Edition

Edina Learning Center 8:30-11:30 am
\$170 729-L5193

Culinary Kids

Edina Learning Center 12:30-3:30 pm
\$170 729-L5191

DASH Basketball Tykes: Ages 2-4

Valley View Middle School 4:30-5 pm
\$79 729-L5215

DASH Basketball Tykes: Ages 4-6

Valley View Middle School 5:15-6 pm
\$89 729-L5216

DASH Intro to Track & Field Tykes: Ages 4-6

Edina Community Center 4:30-5:15 pm
\$89 729-L5217

Art, Theater, Music & Creativity

Can you Doodle That?: Gr. K-4

Valley View Middle School 9 am-12 pm
\$205 729-B2027

Wish Musical Theater Camp: Gr. K-2

Valley View Middle School 9 am-12 pm
\$145 729-B2119



Ultimate Pokémon Art Fun!: Gr. K-5

Valley View Middle School 1-4 pm
\$205 729-B2028

Wonka Musical Theater Camp: Gr. 3-5

Valley View Middle School 1-4 pm
\$145 729-B2120

Expand Your World & Enrichment

Fairy World: Gr. 2-5

Valley View Middle School 9 am-12 pm
\$175 729-B2124

How to Choose a College Bootcamp for Rising High School Juniors: Gr. 11

Valley View Middle School Mon/Tue, 9 am-12 pm
\$250 729-B2115

Writing Magic: Gr. 2-5

Valley View Middle School 9 am-12 pm
\$159 729-L1065

Bonjour French Camp

Gr. K

Valley View Middle School 10 am-12 pm
\$160 729-B2132

Valley View Middle School 1-3 pm
\$160 729-B2133

Gr. 1

Valley View Middle School 10 am-12 pm
\$160 729-B2134

Valley View Middle School 1-3 pm
\$160 729-B2135

Gr. 2

Valley View Middle School 10 am-3 pm
\$395 729-B2136

Gr. 3

Valley View Middle School 10 am-3 pm
\$395 729-B2137

Gr. 4-5

Valley View Middle School 10 am-3 pm
\$395 729-B2138

Safe Sitter: Babysitter Training: Gr. 4-8

Valley View Middle School 1-4 pm
\$125 729-L1169

Writing Magic: Gr. 6-8

Valley View Middle School 1-4 pm
\$159 729-L1066

How to Choose a College Bootcamp for Rising High School Juniors: Gr. 11

Valley View Middle School Wed/Thu, 9 am-12 pm
\$250 729-B2116

Sports, Health & Fitness

DASH Jr. NBA Basketball Camp: Gr. K-2

Valley View Middle School 9 am-12 pm
\$169 class only, \$194 class + jersey 729-L1010

Hockey Training Camp: Gr. 4-8

Edina High School 9 am-12 pm
\$225 729-L1146

Hornet Tennis Camp

Gr. K-5

Edina Community Center 9 am-12 pm
\$195 729-L1063

Gr. 6-8

Edina Community Center 9 am-12 pm
\$195 729-L1064

Schoolyard Games: Gr. K-5

Edina High School 9 am-12 pm
\$135 729-L1080

Soccer Around The World!: Gr. 2-3

Valley View Middle School 9 am-12 pm
\$180 729-L1101



Scan here or visit [edinacommunityed.com/summer2024](https://www.edinacommunityed.com/summer2024) for summer class descriptions



Will DeBerg Youth Basketball Skills Camp and League: Boys Only

Gr. 3-4

Edina High School 9 am-12 pm
\$170 skills camp, \$170 league only, 729-L1116
\$249 skills camp + league

Gr. 5-6

Edina High School 9 am-12 pm
\$170 skills camp, \$170 league only, 729-L1117
\$249 skills camp + league

Gr. 7-9

Edina High School 12:15-3:15 pm
\$170 skills camp, \$170 league only, 729-L1118
\$249 skills camp + league

Will DeBerg Little Dribblers Basketball:

Grades K-2

Edina High School 1-2:30 pm
\$170 729-L1115

Will DeBerg Girls Only Basketball Camp

Gr. 3-5

Edina Community Center 1-2:30 pm
\$170 729-L1153

Gr. 6-8

Edina Community Center 2:30-4 pm
\$170 729-L1154

DASH Jr. NBA Basketball Camp: Gr. 3-6

Valley View Middle School 1-4 pm
\$169 class only, \$194 class + jersey 729-L1011

Gaard Performance Academy: Girls'

High School Tennis Prep Camp Grades 7-12

Creek Valley Elementary 1-3 pm
\$165 729-B2034

Hockey Training Camp: Gr. 4-8

Edina High School 1-4 pm
\$225 729-L1152



Schoolyard Games: Gr. K-5

Edina High School 1-4 pm
\$135 729-L1089

Beginner Synchronized Swimming

Gr. 1-5

Valley View Middle School 3-4:30 pm
\$100 729-L1172

Gr. 6-12

Valley View Middle School 4:30-6 pm
\$100 729-L1174

STEM

Alien Ooze & Terrific Tech Lab: Gr. K-3

Valley View Middle School 9 am-12 pm
\$211 729-B2012

Destination Mars Rocketry: Gr. 2-5

Valley View Middle School 9 am-12 pm
\$190 729-B2070

Unified Cooking Magic

Gr. K-5

Valley View Middle School 9 am-12 pm
\$155 729-L1159

Gr. 6-12

Valley View Middle School 9 am-12 pm
\$155 729-L1161

Video Production for YouTube: Gaming:

Gr. 5-8

Valley View Middle School 9 am-12 pm
\$185 729-B2082

Coding: Hacking Java Games: Gr. 5-8

Valley View Middle School 1-4 pm
\$179 729-B2083

Genius Gizmos and Gadgets Lab: Gr. 1-4

Valley View Middle School 1-4 pm
\$211 729-B2013

Jr. State Fair Engineering Camp: Gr. K-3

Valley View Middle School 1-4 pm
\$215 729-B2098





Week 8

AUGUST 5-8

Most of our summer camps run Monday-Thursday from 9:00 am to 12:00 pm or 1:00 pm to 4:00 pm as listed. Please review your choices carefully as some times differ.



Multi-Week Classes Starting This Week

See pages 46-48 for details

Green Crew: Art In The Woods: Gr. 9-12

Online: Driver's Education: Classroom Instruction & Behind the Wheel: Ages 14.5-18 (August)

Swim Lessons: Levels 1-4



Scan here or visit [edinacommunityed.com/summer2024](https://www.edinacommunityed.com/summer2024) for summer class descriptions

Lunch Bunch

Lunch Bunch and MS Sandwich Society are fun ways for students to bridge the gap between the morning camps and the afternoon camps. Pack a lunch and enjoy some down time with new bodies and old pals. Campers will be picked up from their morning camps by Community Ed Enrichment Rec Leaders. Please note: these programs are available at the Early Learning Center and Valley View Middle School sites only.

Lunch Bunch: 3.5-5 yrs old

Edina Community Center 11:30 am-12:30 pm
\$52 805-L5201

Lunch Bunch: K-5

Valley View Middle School 12-1 pm
\$44 610-B2187

MS Sandwich Society: 6-8

Valley View Middle School 12-1 pm
\$44 610-B2196

Preschool Enrichment

My Very Own Art Museum

Edina Learning Center 8:30-11:30 am
\$170 805-L5198

PreK Adventure Camp: Digging for Dinosaurs

Edina Learning Center Mon-Fri, 8:30 am-2:30 pm
\$390 805-L5196

Summer Growing: A Preschooler's Garden Club

Edina Learning Center 8:30-11:30 am
\$170 805-L5200

Super Science Summer Camp: Space

Edina Learning Center Mon-Fri, 8:30 am-2:30 pm
\$390 805-L5197

Making Musical Memories

Edina Learning Center 9 am-12 pm
\$220 805-L5195

Culinary Kids

Edina Learning Center 12:30-3:30 pm
\$170 805-L5199

DASH Intro to Volleyball Tykes: Ages 4-6

Valley View Middle School 4:30-5:15 pm
\$89 805-L5218



Art, Theater, Music & Creativity

Frozen 2 Musical Theater Camp: Gr. K-2

Valley View Middle School 9 am-12 pm
\$145 805-B2121

Summer Orchestra Lessons: Gr. 5

Valley View Middle School Mon-Fri, 9 am-12 pm
\$100 805-B2102

Yummy Yum Art Camp: Gr. K-5

Valley View Middle School 9 am-12 pm
\$205 805-B2029

Descendants 2 Musical Theater Camp: Gr. K-2

Valley View Middle School 1-4 pm
\$145 805-B2122

Epic Mess!: Gr. K-5

Valley View Middle School 1-4 pm
\$205 805-B2030

Expand Your World & Enrichment

College Application Bootcamp: Seniors First Step to College Admission: Gr. 12

Valley View Middle School 9 am-12 pm
\$100 805-B2113

College Application & Essay Writing Camp: Gr. 10-12

Valley View Middle School 9 am-12 pm
\$159 805-L1069

Safe Sitter: Babysitter Training: Gr. 4-8

Valley View Middle School 9 am-12 pm
\$125 805-L1170

Pioneers and Trailblazers: Ages 6-10

Cahill School 9 am-1:30 pm
\$228 (camp only) 805-B2232
\$372 (camp + aftercare 1:30-3:30pm)

College Application Bootcamp: Seniors First Step to College Admission: Gr. 12

Valley View Middle School 1-4 pm
\$100 805-B2114

Add Festive Fair Foods (Children's Cooking Class): Gr. K-5

Edina Community Center Thu, 10-11 am
\$40 808-B2225

Sports, Health & Fitness

DASH Volleyball Camp: Gr. K-2

Valley View Middle School 9 am-12 pm
\$169 805-L1014

Hornet Girls Basketball Camp: Gr. 4-12

Valley View Middle School 9 am-12 pm
\$225 805-L1143

Hornet Tennis Camp

Gr. K-5

Edina Community Center 9 am-12 pm
\$195 805-L1067

Gr. 6-8

Edina Community Center 9 am-12 pm
\$195 805-L1068

Schoolyard Games: Gr. K-5

Edina High School 9 am-12 pm
\$135 805-L1081

Soccer Around The World!: Gr. 4-5

Valley View Middle School 9 am-12 pm
\$180 805-L1102

Will DeBerg Youth Basketball Skills Camp and League: Boys Only

Gr. 3-4

Edina High School 9 am-12 pm
\$170 skills camp, \$170 league only,
\$249 skills camp + league 805-L1120

Gr. 5-6

Edina High School 9 am-12 pm
\$170 skills camp, \$170 league only,
\$249 skills camp + league 805-L1121

Gr. 7-9

Edina High School 12:15-3:15 pm
\$170 skills camp, \$170 league only,
\$249 skills camp + league 805-L1122

Will DeBerg Little Dribblers Basketball: Grades K-2

Edina High School 1-2:30 pm
\$170 805-L1119

DASH Volleyball Camp: Gr. 3-6

Valley View Middle School 1-4 pm
\$169 805-L1015

Schoolyard Games: Gr. K-5

Edina High School 1-4 pm
\$135 805-L1090

Unified Fit and Active

Gr. K-5

Valley View Middle School 1-4 pm
\$155 805-L1162

Gr. 6-12

Valley View Middle School 1-4 pm
\$155 805-L1165

Beginner Synchronized Swimming

Gr. 1-5

Valley View Middle School 3-4:30 pm
\$100 805-L1173

Gr. 6-12

Valley View Middle School 4:30-6 pm
\$100 805-L1175

Edina Gymnastics August Session I: Gr. 2-10

Edina High School Mon-Thu, 5-8pm
\$160 805-L1805



Scan here or visit [edinacommunityed.com/summer2024](https://www.edinacommunityed.com/summer2024) for summer class descriptions





STEM

Computer Typing Skills: Gr. 4-7

Valley View Middle School 9 am-12 pm
\$220 805-B2139

Cooking with Chemistry: Gr. 6-9

Valley View Middle School 9 am-12 pm
\$235 805-L1029

Intro to Java: Gr. 5-8

Valley View Middle School 9 am-12 pm
\$179 805-B2084

Jr. Engineering Electrified Camp: Gr. K-3

Valley View Middle School 9 am-12 pm
\$215 805-B2099

Ultimate Pokémon STEAM Adventure: Gr. 1-4

Valley View Middle School 9 am-12 pm
\$211 805-B2014



Woodworking: Gr. 4-8

Valley View Middle School 9 am-12 pm
\$212 805-B2071

Architecture & Design Camp: Gr. 5-8

Valley View Middle School 1-4 pm
\$179 805-B2085

Chess Camp: Strategies & Tactics: Gr. 4-7

Valley View Middle School 1-4 pm
\$195 805-L1030

Glow in the Dark Engineering: Gr. 1-4

Valley View Middle School 1-4 pm
\$211 805-B2015

Jr. Animal Crossing Engineering Camp: Gr. K-3

Valley View Middle School 1-4 pm
\$215 805-B2100





Encore Week

AUG 12-15

Lunch Bunch

Lunch Bunch and MS Sandwich Society are fun ways for students to bridge the gap between the morning camps and the afternoon camps. Pack a lunch and enjoy some down time with new buddies and old pals. Campers will be picked up from their morning camps by Community Ed Enrichment Rec Leaders. Please note: these programs are available at the Early Learning Center and Valley View Middle School sites only.

Lunch Bunch: K-5

Valley View Middle School 12-1 pm
\$44 610-B2188

MS Sandwich Society: 6-8

Valley View Middle School 12-1 pm
\$44 610-B2197

Preschool Enrichment

DASH Soccer Tykes

Ages 2-4

Edina Community Center 4:30-5 pm
\$79 812-L5219

Ages 4-5

Edina Community Center 5:15-6 pm
\$89 812-L5220

Art, Theater, Music & Creativity

Fun and Funky Jewelry: Gr. 3-7

Valley View Middle School 1-4 pm
\$200 812-B2108

Expand Your World & Enrichment

Bicycle Repair and Maintenance: Gr. 7-12

Valley View Middle School 9-11 am
\$314 812-B2143

Career Exploration Gr: 6-8

Valley View Middle School 9 am-12 pm
\$125 812-L1300

Unified Team Building Games

Gr. K-5

Valley View Middle School 9 am-12 pm
\$155 812-L1166

Gr. 6-12

Valley View Middle School 9 am-12 pm
\$155 812-L1167

Safe Sitter: Babysitter Training: Gr. 4-8

Valley View Middle School 1-4 pm
\$125 812-L1171

**DASH Sports Sampler Full Day Camp:
Gr. K-5**

Edina Community Center 9 am–4 pm
\$299 812-L1016

Soccer Around The World!: Gr. 4-5

Valley View Middle School 9 am–12 pm
\$180 812-L1103

Sports, Health & Fitness

**Will DeBerg Youth Basketball Skills Camp
and League: Boys Only**

Gr. 3-4
Edina Community Center 9 am–12 pm
\$170 skills camp, \$170 league only, 812-L1124
\$249 skills camp + league

Gr. 5-6
Edina Community Center 9 am–12 pm
\$170 skills camp, \$170 league only, 812-L1125
\$249 skills camp + league

Gr. 7-9
Edina Community Center 12:15–3:15 pm
\$170 skills camp, \$170 league only, 812-L1126
\$249 skills camp + league

**Will DeBerg Little Dribblers Basketball:
Grades K-2**

Edina Community Center 1–2:30 pm
\$170 812-L1123

Schoolyard Games: Gr. K-5

Edina High School 1–4 pm
\$135 812-L1091

**DASH Sports Sampler Full Day Camp:
Gr. K-5**

Edina Community Center 9 am–4 pm
\$299 819-L1017

Schoolyard Games: Gr. K-5

Edina High School 9 am–12 pm
\$135 812-L1082

**Edina Gymnastics August Session II:
Gr. 2-10**

Edina High School Mon-Thu, 5-8pm
\$160 812-L1806

STEM

MN Fair Foods at Home: Gr. 6-9

Valley View Middle School 9 am–12 pm
\$235 812-L1031

Valley View Middle School 1–4 pm
\$235 812-L1032

**Engineers' Odyssey Auto Innovators:
Gr. 3-8**

Valley View Middle School 9 am–12 pm
\$154 812-B2072

Java Game Coding: Gr. 5-8

Valley View Middle School 9 am–12 pm
\$179 812-B2086



Scan here or visit
[edinacommunityed.com/
summer2024](https://edinacommunityed.com/summer2024) for summer
class descriptions

Multi Week Classes



Preschool Enrichment

Little Musikmakers: Ages 2-4

Early Learning Center

Mondays, 9-9:45 am June 10-August 5
\$145 610-L5151

Tuesdays, 9-9:45 am June 11-August 6
\$145 610-L5202

Art, Theater, Music & Creativity

Young Summer Band: Gr. 6-7

Edina High School

Tuesday-Thursday, 8-9 am June 4-20
\$185 603-B2061

HS Summer Jazz Band: Gr. 10 & 11

Edina High School

Tuesday-Thursday, 9-10 am June 4-20
\$180 603-B2062

OK Summer Jazz Band: Gr. 9-10

Edina High School

Tuesday-Thursday, 9-10 am June 4-20
\$180 603-B2059

YK Summer Jazz Band: Gr. 7-8

Edina High School

Tuesday-Thursday, 9-10 am June 4-20
\$180 603-B2060

Hornet Summer Band: Gr. 8-10

Edina High School

Tuesday-Thursday, 10-11:45 am June 4-July 4
\$200 603-B2058



Scan here or visit
[edinacommunityed.com/
summer2024](https://edinacommunityed.com/summer2024) for summer
class descriptions

Jumpstart Band for Beginners, Gr. 5

Edina High School

Flute

Tuesday-Thursday, 8:45-9:30 am June 4-20
\$180 603-B2049

Clarinet

Tuesday-Thursday, 9:30-10:15 am June 4-20
\$180 603-B2050

Alto Sax

Tuesday-Thursday, 10:15-11 am June 4-20
\$180 603-B2051

Trumpet

Tuesday-Thursday, 11-11:45 am June 4-20
\$180 603-B2052

French Horn

Tuesday-Thursday, 11-11:45 am June 4-20
\$180 603-B2053

Trombone

Tuesday-Thursday, 11:45 am-12:30 pm June 4-20
\$180 603-B2054

Baritone/Euphonium

Tuesday-Thursday, 11:45 am-12:30 pm June 4-20
\$180 603-B2055

Percussion

Tuesday-Thursday, 12:30-1:15 pm June 4-20
\$180 603-B2056

Tuba

Tuesday-Thursday, 12:30-1:15 pm June 4-20
\$180 603-B2057

Mikkonen Music: Summer Piano, Guitar, and Ukulele Lessons (30 min time slots)

Monday-Thursday, 1-4 pm June 10-August 22

Cornelia \$258 610-B2146

Creek Valley \$258 610-B2145

Normandale \$258 610-B2147

Valley View \$258 610-B2144

Sports, Health & Fitness

Hornet Girls Basketball Camp: Gr. 4-12

Edina Community Center

Monday-Friday, 9 am-12 pm June 10-21
\$425 610-L1142

Swim Team Prep: Ages 6-10

Valley View Middle School

Wednesdays, 8-8:45 am June 12-August 7
\$250 610-L1093

Sunshine Saturdays; Schoolyard Fun for All Ages: Gr. K-8

Edina Community Center

Saturdays, 11 am-1:30 pm June 15-August 10
\$395 610-L1153

Kung Fu—Wu Shu for Self-Defense and Fitness: Ages 5-Adult

Valley View Middle School

Beginners & White Belt

Tuesdays, 6-6:30 pm June 11-July 30
\$90 617-L1094

Yellow-Green Belt

Tuesdays, 6:35-7:05 pm June 11-July 30
\$90 617-L1095

2nd Green-3rd Purple Belt

Tuesdays, 7:10-7:40 pm June 11-July 30
\$90 617-L1096

Instruments & Sparring

Tuesdays, 7:45-8:15 pm June 11-July 30
\$90 617-L1097

Red-Black Belt

Tuesdays, 8:20-8:50 pm June 11-July 30
\$90 617-L1098

Swim Lessons - Level 1: Ages 5+

Valley View Middle School

Monday-Thursday, 9-9:35 am July 8-18
\$105 708-B2198

Monday-Thursday, 9-9:35 am July 8-18
\$105 708-B2199

Monday-Thursday, 9:45-10:20 am July 8-18
\$105 708-B2200

Monday-Thursday, 9:45-10:20 am July 8-18
\$105 708-B2201

Monday-Thursday, 9-9:35 am July 22-August 1
\$105 722-B2206

Monday-Thursday, 9-9:35 am July 22-August 1
\$105 722-B2207

Monday-Thursday, 9:45-10:20 am July 22-August 1
\$105 722-B2208

Monday-Thursday, 9:45-10:20 am July 22-August 1
\$105 722-B2209

Monday-Thursday, 9-9:35 am August 5-15
\$105 805-B2206

Monday-Thursday, 9-9:35 am August 5-15
\$105 805-B2207

Monday-Thursday, 9:45-10:20 am August 5-15
\$105 805-B2208

Monday-Thursday, 9:45-10:20 am August 5-15
\$105 805-B2209

Swim Lessons - Level 2: Ages 5+

Valley View Middle School

Monday-Thursday, 10:30-11:05 am July 8-18
\$105 708-B2202

Monday-Thursday, 10:30-11:05 am July 8-18
\$105 708-B2203

Monday-Thursday, 10:30-11:05 am July 22-August 1
\$105 722-B2210

Monday-Thursday, 10:30-11:05 am July 22-August 1
\$105 722-B2211

Monday-Thursday, 10:30-11:05 am August 5-15
\$105 805-B2210

Monday-Thursday, 10:30-11:05 am August 5-15
\$105 805-B2211

Swim Lessons - Level 3: Ages 8+

Valley View Middle School

Monday-Thursday, 11:15-11:50 am July 8-18
\$105 708-B2204

Monday-Thursday, 11:15-11:50 am July 22-August 1
\$105 722-B2212

Monday-Thursday, 11:15-11:50 am August 5-15
\$105 805-B2212

Swim Lessons - Level 4: Ages 8+

Valley View Middle School

Monday-Thursday, 11:15-11:50 am July 8-18
\$105 708-B2205

Monday-Thursday, 11:15-11:50 am July 22-August 1
\$105 722-B2213

Monday-Thursday, 11:15-11:50 am August 5-15
\$105 805-B2213

Summer Diving Classes

Due to our summer facility updates, diving offerings are to be determined. Look for details from Community Ed this spring.



Scan here or visit [edinacommunityed.com/summer2024](https://www.edinacommunityed.com/summer2024) for summer class descriptions



Early Childhood Family Education

Our hallmark program for infants, toddlers, and their parents is “Early Childhood Family Education” or “ECFE.” Unique to Minnesota, ECFE has been supporting families since 1973.

Sliding fee scale

For classes with a parent education (ECFE) component, tuition is charged on a sliding fee scale based on family household income. The price shown in the catalog is the most a family will pay. Please see our website for full details.



ECFE Outdoors

Arden Park

Wednesdays, 9:30–10:30 am
\$100

June 12–July 24
612-L5221

Taste of Preschool for Twos

Edina Community Center

Tuesdays, 9–11 am
\$150

June 11–25
611-L5222

Thursdays, 9–11 am
\$150

June 13–27
613-L5223

Tuesdays, 9–11 am
\$150

July 9–23
709-L5224

Thursdays, 9–11 am
\$150

July 11–25
711-L5225



Building Community

Summer Volunteer Opportunities

Our summer camps and programs are elevated by the support of high school volunteers. We are looking for eager, committed students who want to engage with and inspire our younger community members. Volunteers must have completed 8th grade.

Student volunteers get to choose which program they're most passionate about supporting:

- Youth enrichment camps
- Preschool summer camps
- Unified camps
- excitED! (Summer Targeted Services)
- Kids Club

The ideal student volunteer:

- Is an incoming 9-12th grade student
- Is ready to commit to (at least) two weeks of volunteering over the summer
- Is excited to learn and share their knowledge with others

Summer volunteer applications will be available in April. Students are required to attend an orientation to learn best practices before starting to volunteer.

[communityed.edinaschools.org/
get-involved/volunteer](http://communityed.edinaschools.org/get-involved/volunteer)

Edina Resource Center

The Edina Resource Center is committed to making local resources, services and information easily accessible to our community. Services are free and confidential for anyone who lives, works or goes to school in Edina.

We are here to help connect you to:

- Youth Activities
- Scholarships
- Tutoring Services
- Financial Assistance
- Food Resources
- Housing
- Childcare
- Health Insurance
- Clinics
- Mental Health
- Info about Edina and more

Phone: 952-848-3936

Email: contact@EdinaResourceCenter.com

In Person: Edina Community Center-Door 3,
5701 Normandale Road

www.EdinaResourceCenter.com



CREATE AT HOME

Summer Beaded Bugs

Materials:

25 inches jewelry wire
(24 GAUGE)

Large bead
(20 MM, FOR BODY)

Medium bead
(10 MM, FOR HEAD)

~100 small beads
(2-5 MM, FOR LEGS)

Equipment:

Ruler

Wire Cutters

Needle Nose Pliers

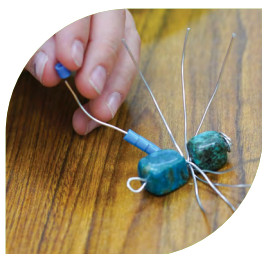

Step 1: Cut wires

- Cut 5 lengths of wire that are each 5 inches long.

Step 2: Attach body bead

- Take one piece of wire and use needle nose pliers to bend the end of it into a tight spiral.
- Continue bending the wire into a tight coil that is large enough to cover the hole in the largest bead (used for the bug's body). Think that the coil is about 5 mm in size.
- Now take the other end of the wire and feed it through the center of the coil.
- Pull the end of the wire completely through. This secures the coil and ensures that the hole of the large bead will sit in the center of the coil.
- Now slide the largest bead (the body) onto the wire until it's resting against the coil.

Step 3: Connect legs

- Grab one of the other four wires and bend it roughly in half in a "U" shape to find the middle.
- Slide the folded wire around the first wire, so it's sitting against the body bead.
- Cross the folded wire around itself.
- Pull the wire down on each side, securing it into place.
- You've just added the first two bug legs!
- Repeat these steps with the next three wires and pinch the legs in place with your pliers.
- Don't worry about the legs intertwining—it only makes the bug more sturdy.

Step 4: Attach and secure head bead

- You can now slide the medium sized head bead onto the center wire and press it tightly against the legs.
- Cut off any excess wire, leaving at least 2 cm (or 3/4 inch).
- Use the pliers to twist and push the end of the wire back into the head bead, creating a small loop to secure it.

Step 5: Bead legs

- Bend and separate the 8 legs into their positions.
- Begin beading the first leg. It's best to start with a small seed bead so it will rest right up against the bug's body.
- Use a mix of beads in a variety of sizes. We used 12 beads per leg, but the number will depend on the exact size of your beads.
- Make sure to leave 5-10 mm at the end of the wire to finish off the leg. Use the needle nose pliers to create a small loop, just large enough to ensure the beads won't slide off.
- Bead the other 7 legs, and your bug is almost ready!

Step 6: Arrange legs

- Bend each of the 8 legs, somewhere around the middle of the leg, to create the leg joint.
- Flip the bug over and adjust the legs so they all touch the table and are evenly spaced out.

Your beaded bug is complete!



Community Ed for All

We're committed to connecting all members of the community with our programming, and to helping them get the most out of it.

Accommodations

Edina Community Ed is “a place to belong.” Every day, we strive to make our classes, programs and events welcoming, supportive and inclusive for all learners, including students who may require extra support to participate safely and successfully.

For EPS students:

Support in choice-based, out of school time programs, including school age care, enrichment and early learning programs, may look different from support students receive during the school day.



For more information on inclusion support and programming, visit our website or contact Inclusion Manager Tim Fakis at Tim.Fakis@edinaschools.org

Financial Assistance

We are committed to ensuring that all learners have access to our classes and programs. We regularly offer financial assistance and partner with Edina Give & Go for additional resources. For more information, call 952-848-3952 or go to <https://edinacommunityed.com/FinancialAssistance>.

Non-Discrimination

Policy Edina Public Schools District 273 has a nondiscrimination policy on the basis of race, color, creed, religion, national origin, sex, age, disability, marital status or status with regard to public assistance in its educational programs, activities and employment practices.

Registration Information

Registration opens 8 am February 13



Have questions? We're here to help!



Email: communityed@edinaschools.org



Phone: (952) 848-3952



In Person:

M-F, 8am-4pm at the Edina
Community Center

Edina Community Center
5701 Normandale Road,
Edina, MN 55424

Register online!
Edina.ce.eleyo.com

Registration Details

- Online registration with an email address will be confirmed immediately.
- Classes/camps are open to all interested! Edina residency is not necessary.
- Registration closes at 4 pm on the Thursday before the first day of camp.
- Don't hesitate to add yourself to the waitlist. We work hard to create new sections so everyone can join the fun!

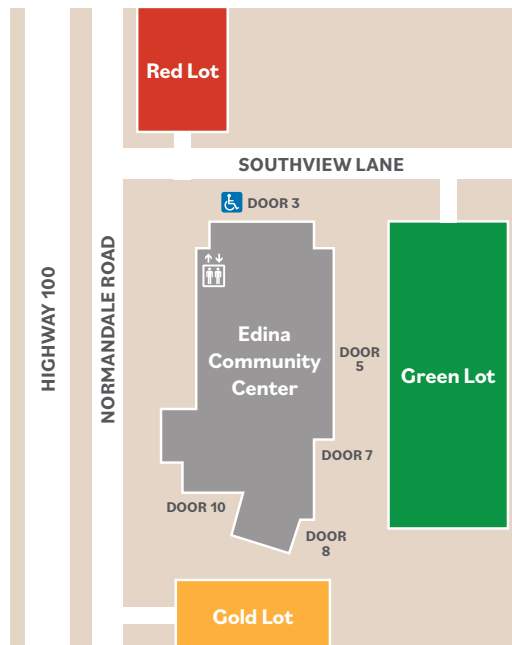

Satisfaction Guaranteed

If for any reason you are not happy with the quality of one of our community education programs, classes or activities, we want to know about it. We work hard to offer high-quality programming that meets the needs of learners of all ages, stages, abilities, and interests. We strive to recruit dynamic, enthusiastic teachers who care about learning for life and connecting community. Please call us at 952-848-3952 to offer your constructive feedback, and we will be glad to work with you to make things right.

Cancellation and Refund Policy

You may cancel your class registration at least 5 business days prior to the start of the class/camp and we will gladly refund your fees. Cancellations received five to one business day before the start of a class will result in a credit slip. Credits do not expire. Community Ed cannot offer refunds or credits for cancellations received less than one business day before the start of a class. Participants will be notified by email and/or SMS if there is a change in the date/location of the class. If the class is canceled you will be notified by a phone call and/or email. Edina Community Ed confirms registrations via email with participants who include their email addresses in their family profile.

Check-In and Emergency Contact Information

We look forward to making sure that your child not only has a great time this summer, but also is safe while in our care. We ask that you help us by following the guidelines below.

- Students enrolled in a camp or class during the summer should be checked in and out of the camp by a parent or caregiver unless otherwise arranged.
- We request written permission (email is acceptable) from a parent or guardian when a student will be leaving the building on their own.
- Please make sure that your emergency contact information is current and that any special needs or allergies are included in your child's profile.

Prorating

We do not prorate classes or camps. Classes are designed to allow enough time to complete course curriculum.

Weather

Refunds are not available due to inclement weather, i.e., extreme heat or rain. We reserve Friday of each week as a rain date for outdoor camps.

Late Pick-Up Fees

Parents or caregivers arriving later than 5 minutes past the end of class will be charged \$1 per minute. Payment is due at pick-up.

Non-Discrimination Policy

Edina Public Schools District 273 has a policy of nondiscrimination on the basis of race, color, creed, religion, national origin, sex, age, disability, marital status or status with regard to public assistance in its educational programs, activities, and employment practices.

Data Privacy

Your privacy is important to us. The registration information you provide to Edina Community Ed is considered private data under state and federal law. We use the information you provide for the purposes of administering the activity and to contact you about upcoming activities. While you may choose to register without this information, there may be consequences that could limit the distribution of information to the participant (e.g., no team roster or class confirmation). Access to contact information is limited to individuals involved in the activity.

Photo Consent

Unless you notify Edina Community Ed, photos taken within community ed classes/programs/activities may be included in Edina Community Ed publications.

Licensures

LEGO® is a trademark of the LEGO Group of companies which does not sponsor, authorize or endorse this site.

Spend your summer with us!



Volunteer with us!

Our summer camps and programs are elevated by the support of high school volunteers. When you volunteer you can:

- Connect with and inspire younger students
- Gain valuable leadership experiences
- Earn service hours toward EHS Community Service Letter



Work for us!

We're looking for some amazing humans to bring their imagination and creativity to our summer programs. Our Kids Club and Enrichment Rec Leaders get to invent activities and encourage play. Sounds fun! Learn more!



Learn more about these opportunities at:

communityed.edinaschools.org/get-involved