

# SHIELDS VALLEY SCHOOL DISTRICT

feasibility study

# Agenda



1. Why?
2. Process Timeline
3. Facility assessment findings
4. Design Options + Investment
5. Let's hear from you!

# Why?

*Why are we pursuing new masterplanning efforts for the school district?*

- Deteriorating facilities + code compliance issues
- Outdated education spaces
- Anticipation of future needs + growth
- Need to address safety and security



# Guiding Principles

*What are the school and community values that we want to prioritize and promote with this project?*

- Continue to provide high quality education that cultivates socially, Emotionally, and academically connected Students and promotes accessibility and inclusion for all kids
- Prioritize current needs, then address future needs
- Continue to provide and use of the schools as a community center and encourage community involvement, culture, core values, and pride
- Promote and improve safety and security
- Prioritize sustainability – in Longevity + Efficiency of our buildings, and health of our students
- Honor History of the Valley and maintain Agricultural values
- Embrace progress and innovation while maintaining our traditions and values

# Process Timeline



## ASSESS

- Establish Mission
- Identify Committee
- Assess, Research
- Identify Needs
- Listen, Vision
- Set Guiding Principles



## EXPLORE

- Generate Options
- Cost Analysis
- Explore Concepts
- Evaluate + Refine

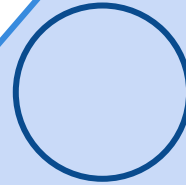

## FEASIBILITY

- Should we move forward?
- Listening + Seeking Feedback
- Staff Engagement
- Community Engagement
- Survey + poll
- Taxpayer investment
- Report out

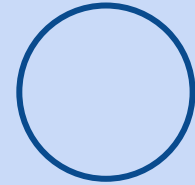

## CAMPAIGN?

- Board direction
- Board approval
- Preferred concept
- Produce renderings

→ NEXT STEPS



# Facility Assessment - Elementary Red Building

poor

fair

good

*What have we discovered about the current state of our school facilities?*

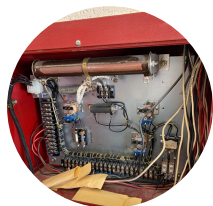

- Widespread accessibility deficiencies
- Aged kitchen + food service equipment
- Code non compliance - means of egress, electrical equipment, fire alarm system, etc.
- Aged roof + energy-inefficient single-pane windows
- Outdated learning spaces
- Safety and security concerns related to disconnected buildings + no secure vestibule

# Facility Assessment - Elementary White Building

poor

fair

good

*What have we discovered about the current state of our school facilities?*



- Widespread accessibility deficiencies and egress-related code non-compliance
- Hazardous materials - asbestos
- Energy-inefficient single pane windows, deteriorated walls and foundation, cracked roof structure
- Code non compliant electrical systems, fire alarm, and lighting, aged mechanical systems
- Outdated learning spaces
- Security concerns

# Facility Assessment - JR High / High School

poor

fair

good

*What have we discovered about the current state of our school facilities?*



- Accessibility deficiencies
- Hazardous materials - asbestos
- Energy-inefficient single pane windows + aged gym roof
- CMU block walls, mortar, concrete sidewalks cracked and in need of maintenance
- Plumbing and roof drains in need of maintenance
- Non-code compliant electrical equipment, fire alarm, and lighting



# Design Option Iterations

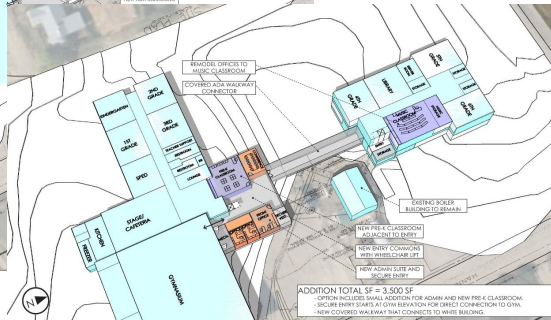
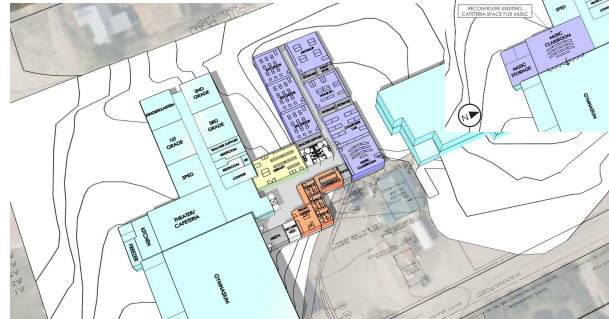
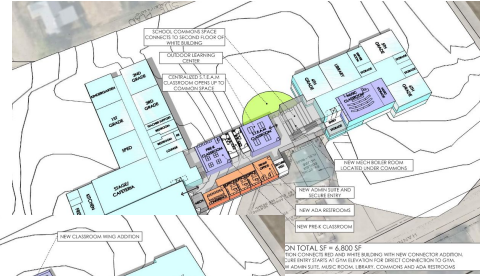
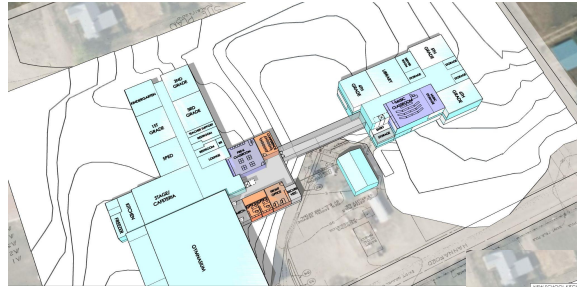

Elem. op 1

Elem. op 2

Jr high / HS

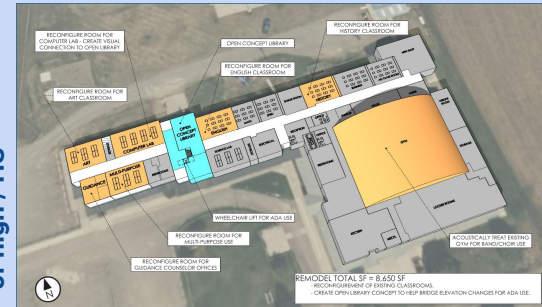
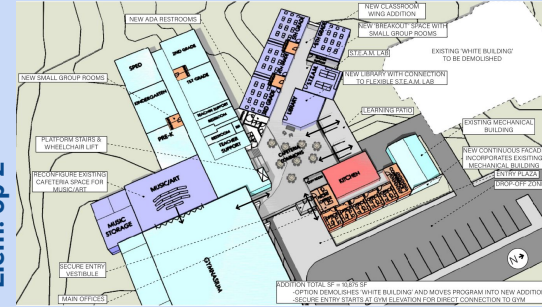
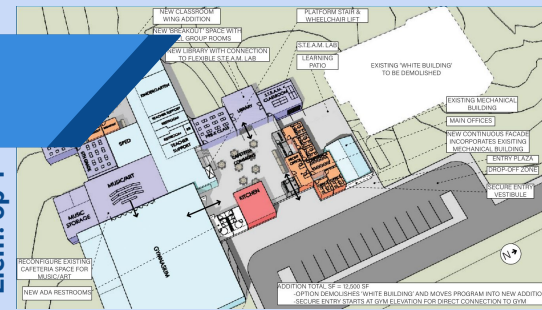

# Investment

*What does the investment from the community look like to make this project happen?*

## ELEMENTARY

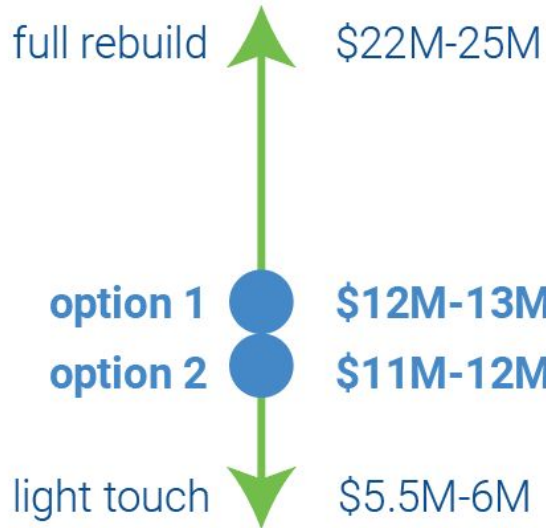

## JR HIGH / HIGH

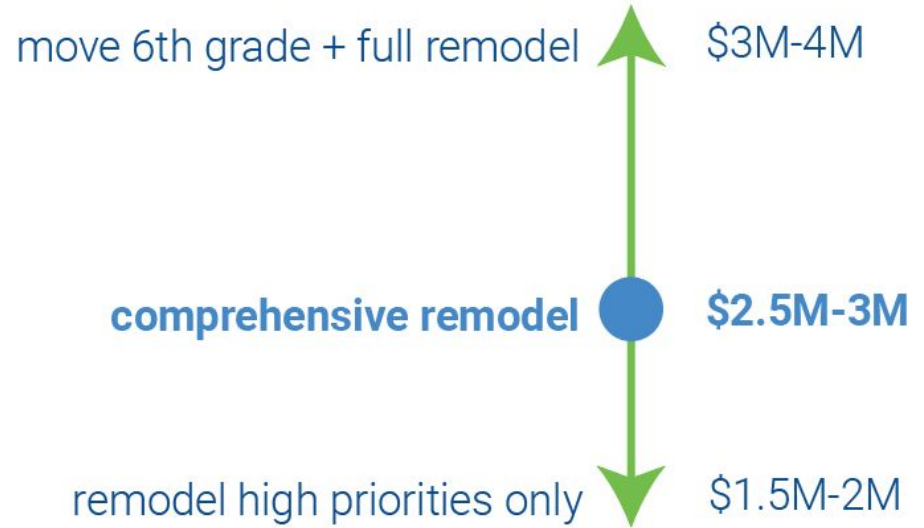

# Elementary Option 1

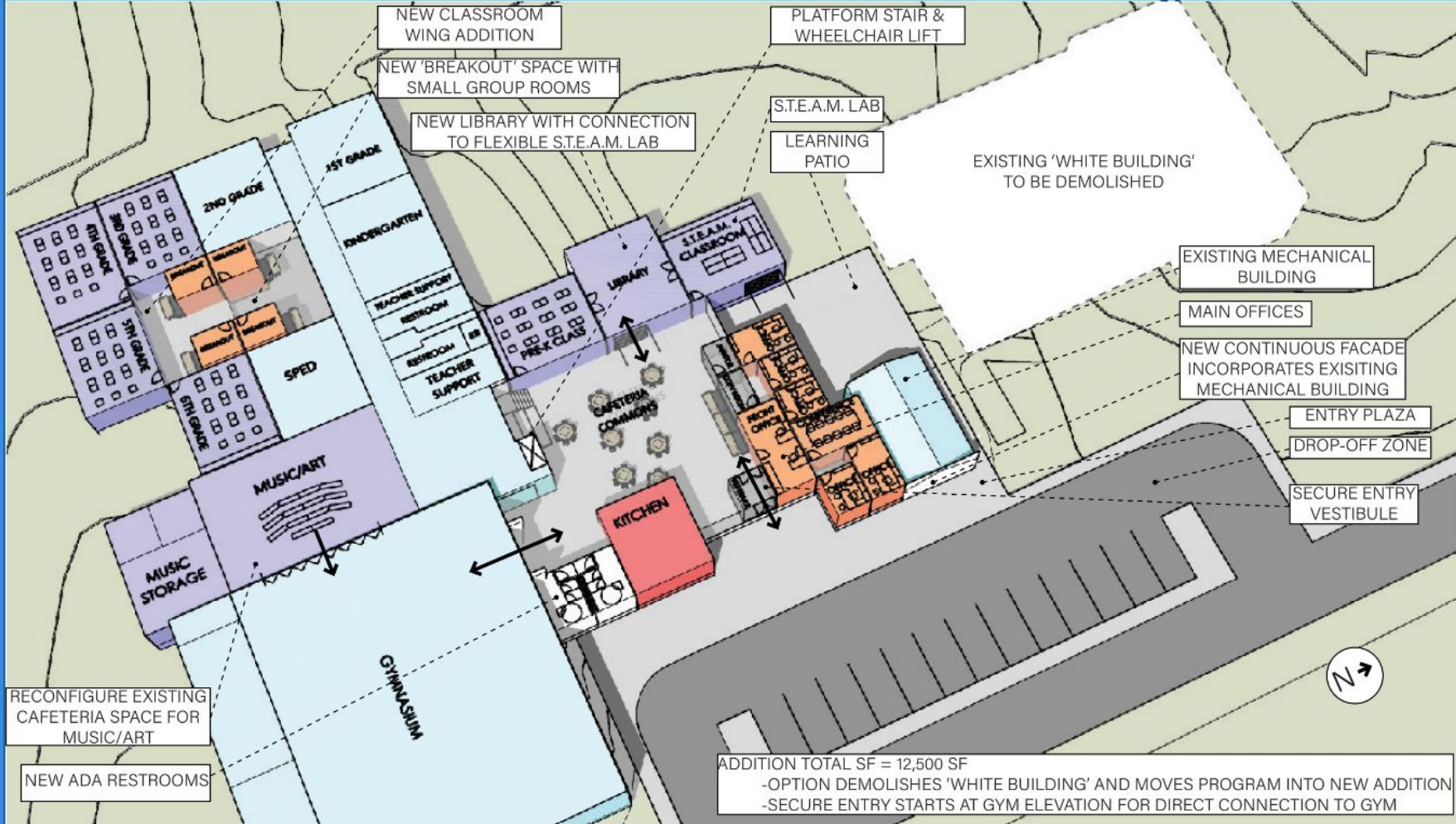



# Elementary Option 2

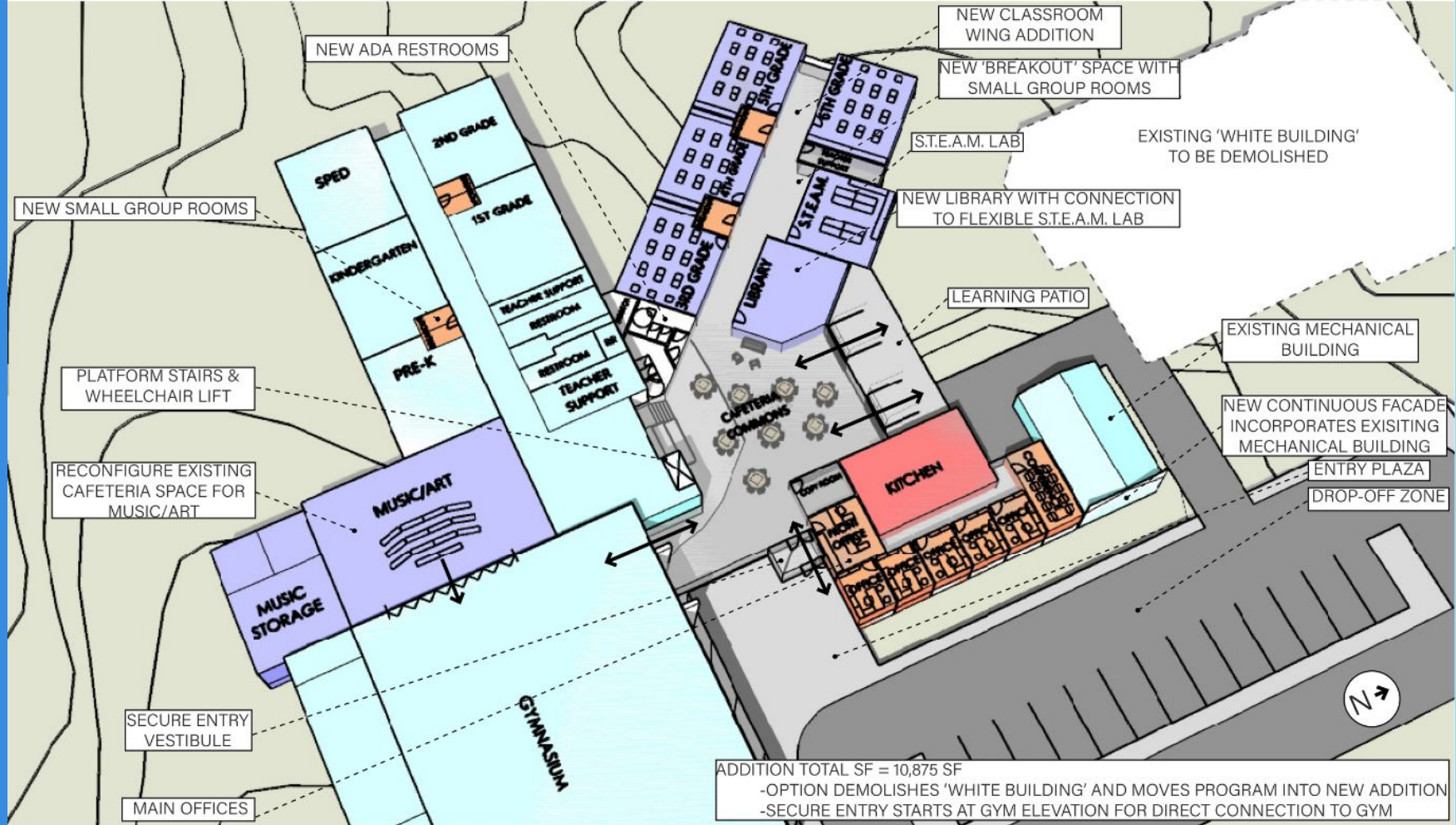

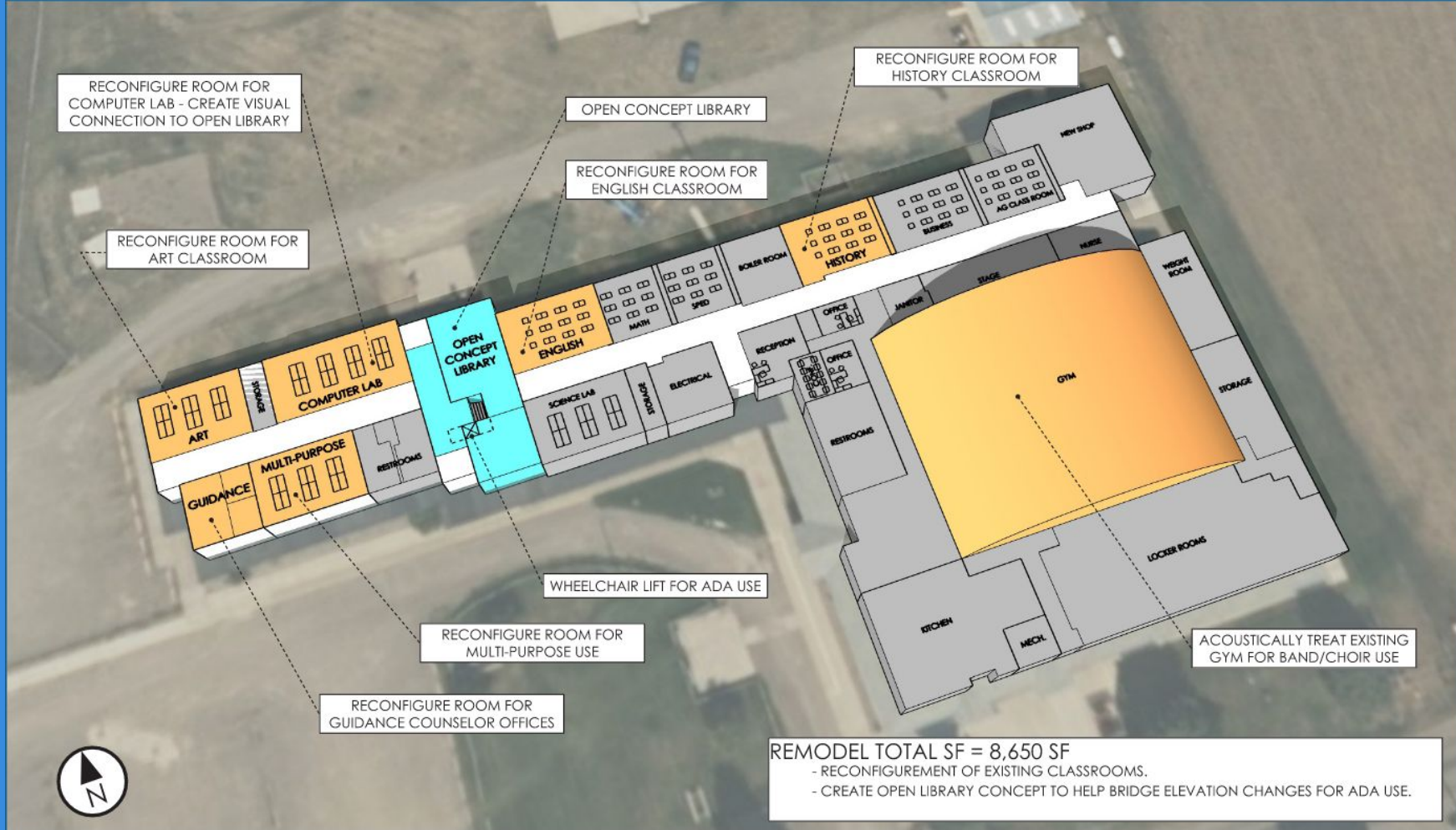



# Thank you

