

# **Update on FCPS Construction / Renovation Projects**

January 2024

# Mary E. Britton Middle School



# Mary E. Britton Middle School



➤ Architect:

JRA Architects

➤ General Contractor:

Rising Sun Developing Co.

➤ GC Contract Sum:

\$69,964,000.00

➤ Total Project Cost:

\$82,680,000.00

➤ Change Orders to Date (4):

(\$2,053,171)

# Mary E. Britton Middle School



## ➤ **Completed Work:**

- ICF at Areas A and C to 95%.
- All hollow core complete.
- Roof joist and decking at Areas A and C.
- CMU continuing at Area E/F behind Cafeteria.
- CMU (4") and top out to deck in Gym and Locker Room Area.
- Continuing fire sprinkler and MEP rough ins above ceiling and floor to floor connections.
- KY American Water completed underground Fire/Domestic line. Currently flush and test.
- Geothermal continuing to install zone piping at field.

## ➤ **Upcoming Work/Look Ahead:**

- Complete ICF Areas A and C.
- Continue ICF at Storm Shelter and Area E.
- Complete masonry at Cafeteria/Gym Wall.
- Test Gym and Locker Room to receive block filler.
- Continue brick veneer work
- Continue roof decking Areas A and C; start roof decking at Cafeteria.
- Continue sprinkler and MEP rough ins all areas.
- Continue geothermal piping underground.
- Start gas line work to building.
- Start field measuring for casework and lockers.

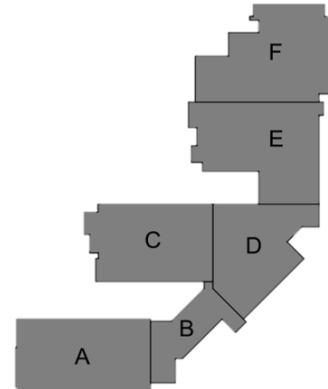

# Mary E. Britton Middle School



## Area A – ICF at End Wall Continues



Week Ending January 5, 2024

# Mary E. Britton Middle School



## Area A – Steel Roof Decking Started



# Mary E. Britton Middle School



## Area C – Mezzanine Topping Slab Poured





# Mary E. Britton Middle School



## Area E – CMU at Stage Continuing



Week Ending January 5, 2024



# Mary E. Britton Middle School



## Area E – Restroom Plumbing Rough In Continues



# Mary E. Britton Middle School



## Area E – Storm Shelter ICF Continues



Week Ending January 5, 2024

# Mary E. Britton Middle School



## Areas F – Brick Continuing Around Gym



# Mary E. Britton Middle School



## Area F – Gym Interior CMU Complete



Week Ending January 5, 2024



# The Hub for Innovative Learning & Leadership (The HILL)



# The Hub for Innovative Learning & Leadership (The HILL)



- Architect:  
EOP Architects
- General Contractor:  
D.W. Wilburn Inc.
- GC Contract Sum:  
\$50,700,288.00
- Total Project Cost:  
\$64,712,240.00
- Change Orders to Date (5):  
\$577,938.97

# The Hub for Innovative Learning & Leadership (The HILL)



## ➤ **Completed Work:**

- CMU work on all floors continued.
- Site retaining walls continued.
- Dock leveler pit completed.
- Window glazing continued on all Levels.
- Ductwork installation continued on all Levels.
- Plumbing above ceiling continued on all floors.

## ➤ **Upcoming Work/Look Ahead:**

- CMU work to continue on all floors.
- Site retaining walls to continue.
- Curtainwalls to start install and glazing to continue.
- Ductwork installation to continue.
- Electrical and plumbing wall rough-ins to continue with masonry.
- Drilling for the geothermal wells is scheduled to continue.



# The Hub for Innovative Learning & Leadership (The HILL)



## Geothermal Well Drilling



# The Hub for Innovative Learning & Leadership (The HILL)



## Curtain Wall Framing & Glazing



# The Hub for Innovative Learning & Leadership (The HILL)



Overhead Door Opening Framed at Main Entrance



Week Ending January 5, 2024

# The Hub for Innovative Learning & Leadership (The HILL)



## Metal Stud and Soffit Work



# The Hub for Innovative Learning & Leadership (The HILL)



## Metal Stud and Soffit Work





# The Hub for Innovative Learning & Leadership (The HILL)



## Metal Stud and Soffit Work



# The Hub for Innovative Learning & Leadership (The HILL)



## Interior Primer on Walls; Ductwork and Other Above-ceiling Items





# The Hub for Innovative Learning & Leadership (The HILL)



Looking into Main Commons Area from above



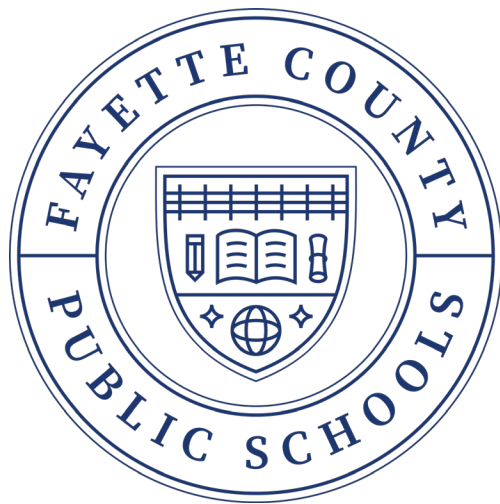

**Thank you!**