



# A Parent's Role in Emergency Situations

February 23, 2023

---

Proud to Partner

**Northwest Suburban  
Council PTA/PTSA**

**PTA<sup>®</sup>**

**PTSA<sup>®</sup>**

*everychild.onevoice.<sup>®</sup>*

**Palatine  
Police  
Department**



# Introductions

# Video



# Difference Between Crisis & Emergency

**EMERGENCY** - An urgent need that calls for immediate action such as a tornado, earthquake, gas leak, or fire.

**CRISIS** - An unfolding situation that has reached a critical phase with the distinct possibility of a highly undesirable outcome such as a school shooting, hostage situation, or terrorism.

# Types of School Emergency and Crisis

- Abduction of a Student
- Aircraft Crash
- Armed Intruder
- Bus Accident
- Civil Demonstration / Protest
- Death on Campus
- Earthquake
- Explosion
- Fire
- Flood
- Hazardous Material Release
- Hostage Situation
- Natural Gas Release
- Sexual Assault
- Structural Failure
- Suicidal Behavior
- Suspicious Object
- Tornado
- Utility Loss
- Winter Storm

## Definition of School Shooting

**A violent act in which someone discharges a firearm to kill or injure teachers, students, and staff inside an education institution.**

*(Wikipedia 2014)*

# Statistics

- **32** School Shootings in 2013 – 2014
- **52** School Shootings 2014 – 2015
  - K-12 Shootings = **31**
  - College Shootings = **21**
- **21** School Shootings in 2015 – 2016
- **31** School Shootings in 2016 – 2017
- **24** School Shootings in 2017 – 2018
- **24** School Shootings in 2018 – 2019
- **12** School Shootings in 2019 – 2020
  - No Shootings March 1st – September 1st, 2020 (COVID-19)
- **10** School Shootings in 2020 – 2021 (E-Learning/Hybrid)
- **34** School Shootings in 2021 – 2022

**Since Sandy Hook the U.S. has experienced 3,500 mass shootings.**

*(Washington Post)*

# Notable Shootings in America

- **Columbine High School Massacre (Littleton, CO) - April 20, 1999**
  - Rapid Deployment
- **Red Lake High School Massacre (Red Lake, MN) - March 1, 2005**
  - Implementation of Lock-Down exercises were introduced nationwide
- **Amish School Shooting (Nickel Mines, PA) - October 2, 2006**
  - Police involvement in parent reunification with school officials
  - Triage forms used for locations of injured parties
- **Virginia Tech Massacre (Blacksburg, VA) - April 16, 2007**
  - “Barricade Busters” placed in squad cars for chained doors and other barricades
- **Northern Illinois University Massacre (DeKalb, IL) - February 14, 2008**
  - First look at the way Law Enforcement deals with the mentally ill
  - Working relationship between psychiatrists and police on mentally ill patients
- **Sandy Hook Elementary Shooting (Newtown, CT) - December 14, 2012**
  - Development of “Safe & Sound Schools”
  - Working relationships of School Districts and Police Agencies Nationwide
- **Stoneman Douglas School Shooting (Parkland, FL) - February 14, 2018**
  - Monitoring and Training on Social Media within Law Enforcement
- **Robb Elementary School Shooting (Uvalde, TX) - May 24, 2022**
  - Federal Gun Reform (Illinois Assault Weapons Ban???)

Deadliest  
Shootings

# Everyone Has a Role in Safety



# Safety Partners

**Safety is the shared responsibility of all members of our community.** District 15 has a longstanding Safety Committee that meets every trimester. This group is composed of school and District administrators as well as both police and fire/first responder teams from all municipalities in which we serve.

Our safety partners assist us with annual safety training exercises that focus on annual drills per Illinois State Board of Education (ISBE) guidelines with staff and students observed by local first responder agencies for both timely and effective implementation. They provide training and serve as members of school safety teams. Additionally, they keep us up-to-date on recommendations from industry experts.



# Visitor Check In

## Visitor Procedures updated 10/2022

- Ring the doorbell at the front office
- Office staff will ask for your name and reason for visiting
- There is a “drop off table” for any items that need to be given to students
- Parents/guardians and visitors are required to bring a drivers license or state ID
- Drivers license/state ID will be put through the Raptor System
- Visitor fills out visitor check in form
- Visitor badge and a red lanyard are to be worn while in the building
- When you leave, return lanyard and the office will return your ID
- Complete the visitor check out form

# **Your Role as a Parent/Guardian**

- **What do you do if you are at the school during an Emergency/Crisis Situation?**
  - Secure & Teach (previously Soft Lockdown)
  - Hard Lockdown
  - Shelter-in-Place
  - Evacuation
  - Relocation
- **What do you do if you are home/at work during an Emergency/Crisis Situation?**

# Defining Emergency Situations

**Secure and Teach Procedures**—Secure and Teach is primarily used in two different scenarios.

1. Conditions exist outside school building that could potentially present a threat to safety of students and staff.
2. Situation inside the building where school or local emergency responders need to keep students and staff in classrooms and away from an incident.

During Secure and Teach, students and staff can continue normal classroom activities, but should not leave classroom or offices until advised to do so.

Additionally, no one is allowed to enter or leave the building until the Secure and Teach has ended.

**Hard Lockdown Procedures**—used when a serious/volatile situation exists that could jeopardize physical safety of students and staff. During a Hard Lockdown, staff members will ignore all bells and fire alarms unless they receive verbal instructions from local emergency responders or the conditions (fire, structural damage, etc.) warrant the evacuation of the area. Additionally, no one will be allowed to enter or leave the building until the Hard Lockdown has ended.

# Defining Emergency Situations Cont.

**Evacuation (Relocation) Procedures**—evacuation may be necessary whenever it's determined that it's safer outside building than inside building. In situations where weather is inclement or students and staff will be required to evacuate for an extended period of time, an off-campus evacuation (Relocation) may be initiated rather than evacuating to the assembly area. Conditions requiring an evacuation may include a fire, an explosion, a hazardous material release within the building, or some type of structural failure in the building.

**Severe Weather Watch**—A tornado watch means that conditions in the area are such that a tornado is *possible*. No siren will be sounded when the National Weather Service issues a tornado watch. During a tornado watch, all activities should continue as usual. Classes should be dismissed at the regular time, etc., but children who ride buses should be kept inside the school until their buses arrive, and students who walk home should be advised to go straight there.

**Severe Weather Warning**—A tornado warning means a tornado has *actually been sighted or has touched down* in District 15 or the surrounding area. When a tornado warning is issued, sirens are activated by Palatine, Rolling Meadows, and Hoffman Estates police departments. This warning will be a three-minute, sustained, steady blast.

# Reasons for a Hard Lockdown

Hard Lockdown is used when a serious/volatile situation exists that could jeopardize physical safety of students and staff.

## **Reasons to call a hard lockdown:**

- Intruder
- Active Shooter
- Unruly Parent / Visitor
- Implied or Use of Weapon on School Grounds
- Hostage Situation
- Sexual Assault on Campus
- Abduction of Student on Campus

**\*\*Anyone can call a hard lockdown.**

# Parent/Guardian Role in a Hard Lockdown

**During a Hard Lockdown – parents/guardians should not come to school.**

## **On School Grounds**

- Visitor, PTA, Program Assistant – important to check into the front office
  - This is how we know who is in our schools – helps with accountability
- Be aware of your surroundings
- Have a plan!
- Run, Hide, Fight (Survive)

## **Parents/Guardians at Home**

- Information will be shared
- Meeting locations shared if they need to be utilized
- *\*TRAFFIC (Barrington H.S.)*

# What Should Parents Do DURING Emergency Situations?

A parent's first instinct may be to go to the school immediately. **Parents are instructed NOT to go to school so Emergency Officers can have full access to school and surrounding area** without extra cars and chaos of parents being there. **Staying clear of the school will help ensure a swift arrival of first responders.**

Stay home/workplace to receive updates via email / text / phone calls, OR **wait to be informed of a location in the community where you can go to receive real-time updates** from law enforcement / district officials / designated liaisons.

**The Palatine Public Library is our offsite information hub.**

Each municipality with schools in District 15 (Hoffman Estates, Palatine, and Rolling Meadows) have a number of locations that can be used to provide in-person information about an emergency to parents and community members. To maintain both flexibility and to ensure security of various sites, additional locations in each community will not be shared until the day of an incident.

# Parent/Guardian Information Site

## Parent Information Site

- First 30 Minutes
- What to expect
  - Staffing
  - School District
  - Law Enforcement

What happens next?

## Example:

[Louisville School Shooting, September 30, 2014](#)

(Student Shot at Fern Creek HS)

# Evacuation / Relocation

- **On School Grounds**
  - Evacuation
  - Assembly Area
  - Busing vs. Walking
  - ***YOU ARE PART OF THE SCHOOL***
- **Parent at Home**
  - Remain calm and patient
  - Information
  - Staging Area
  - Reunification
- **UPDATE EMERGENCY CONTACT INFORMATION!**  
(*Marion Jordan School, St. Theresa School*)

# What Should Parents Do AFTER Emergency Situations?



When the emergency is over, parents will be told where to go to be reunited with their child(ren).

- Wait in car, drive to pick up location, be prepared to tell staff who their child is, show ID, and wait for child to be brought out to car.
- Only those on Emergency Card (approved pick up) would be able to pick up child.
- ID must be shown in order for child to be released to adult.

# Relocation Example

## Marion Jordan's Evacuation

- Water main break left Marion Jordan without running water
- School relocated to pre-arranged offsite location
- District communication
  - Notification of evacuation
  - Notification that students/staff arrived safely
  - Information about pick-up procedures
- Parents/guardians waited patiently and did not rush to the scene (way to go, MJ parents)
- Parents/guardians asked to produce a state ID for verification when picking up their child(ren) did so



## How Can Parents Prepare BEFORE Emergency Situations?

- **Make sure your emergency contact information is up-to-date** in Infinite Campus and includes accurate cell phone numbers and email addresses so that there is not a delay in contacting you in the event of an emergency.
- Make sure you **list trusted adults as emergency contacts** in Infinite Campus who would be able to pick up your child if you are not available. Without exception, students will be released only to their parents, legal guardians, or emergency contacts identified in registration materials during an emergency or crisis situation.
- Remember - social media is a powerful communication tool, but in the event of a crisis or an emergency, **rely on information provided by school officials and law enforcement** via phone, text, and/or email, and refrain from posting incomplete or unconfirmed details that may fuel confusion and/or fear in the community.

## How Can Parents Prepare BEFORE Emergency Situations?

Although there are many safety measures in place at each school in the District, an emergency or crisis situation may still occur. Parents should consider the following actions before, during, or after an emergency or crisis situation:

- Speak regularly with your child(ren) about the importance of reporting any concern(s) that they have about safety to an adult either at school or at home so that their concern can be acted upon.
- Ask your child(ren) questions about school safety.
- Similarly, contact building administration to report any concerns that you have regarding school safety so that your concern(s) can be acted upon.
- Speak with your child(ren) about social media awareness - ***upcoming Parent University on March 16 on Social Media Presented by the Palatine Police Department***

# District 15's Commitment to School Safety

- Secure Entry Vestibules
- Visitor Management System
- Panic Buttons
- 911 and integrated intercoms
- CrisisGo
- Strobe lights
- Signage
- Playgrounds
- School Resource Officers (SRO)
- Surveillance Cameras



# Emergency Communication

## How we will communicate with families:

- Email
- Text message
  - Referencing email
- Website pop-up Banner
  - Message
  - Instructions
  - Next Steps
- Robocall
- *\*Social Media*

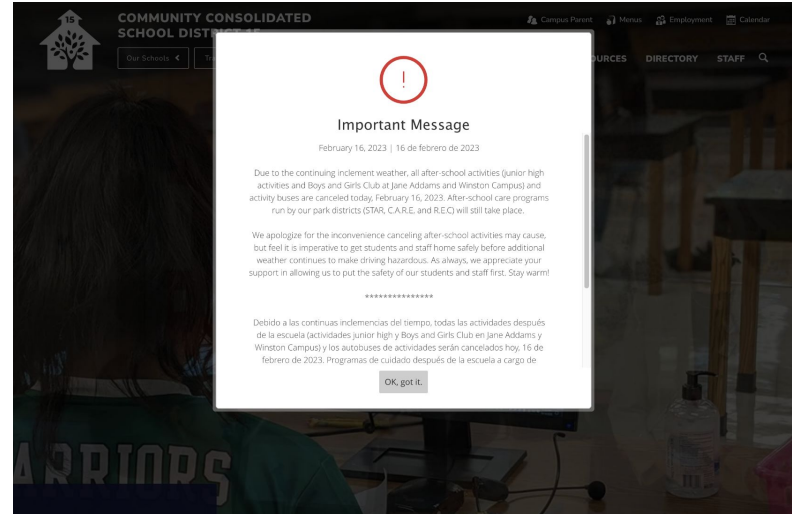

# Make Sure Your Contact Information is Current

- **THIS IS OF THE UTMOST IMPORTANCE!**
- **Ensure your contact information and emergency contact information listed in Infinite Campus' Campus Parent portal is accurate.** If it is not accurate, please contact your child's school office to update your information.
- Make sure you enter a phone number in the "Phone 2" section as well to ensure you receive text messages.
- When you **register and/or re-register your child(ren)**, it is a great time to **review** the information you are sharing with the District.
- District 15 uses the **Blackboard communication system** to notify parents/guardians via phone, text, email, and the D15 mobile app. All parents/guardians and staff are automatically enrolled. Blackboard pulls contact information from Infinite Campus.



What Questions Do You Have?