

**LOUISIANA DEPARTMENT OF ENVIRONMENTAL QUALITY
OES, PUBLIC PARTICIPATION AND PERMIT SUPPORT DIVISION
NOTIFICATIONS AND ACCREDITATIONS SECTION**



**Required Elements for Asbestos Management Plans for School and State Buildings
Form AAC-8
LAC 33:III.Chapter 27**

Directions: Please note that the current AAC-8 form is an interactive Asbestos Management Plan and the information shall be typed or legibly hand written on the form itself, not referencing another document as in the previous AAC-8 form. This form must be completed properly and submitted as the asbestos Management Plan required for a school (Kindergarten through Post-graduate), state owned, leased, or state-used building. **A written explanation must be provided for any incomplete section.** The explanation must be included in the section or if too long, attached behind the corresponding section. You may find the following link useful, complete with Most Frequently Asked Questions, forms, Training Providers, etc: <http://www.deq.louisiana.gov/portal/tabid/2883/Default.aspx>.

Completion of the AAC-8 will ensure that the Management Plan meets federal (40 CFR Part 763.93) and state (*LAC 33:III.Chapter 27*) requirements and will facilitate accurate and timely state review.

All schools must submit their Asbestos Management Plan directly to: **LDEQ, OES, Public Participation and Permit Support Division, Notifications and Accreditations Section, P.O. Box 4313, Baton Rouge, LA 70821-4313.**

Any Asbestos Management Plan for a **state building**, whether it is owned, leased, or otherwise used as a state building must submit the Asbestos Management Plan directly to: **Real Estate Leasing Administrator, Division of Administration, Facility Planning and Control, Real Estate Leasing Section, P.O. Box 94095, Baton Rouge, LA 70804-9095.**

APPLICABILITY:

This building is being used for the following purpose:

- | | |
|---|--|
| <input checked="" type="checkbox"/> School (Kindergarten through Post-Graduate) | <input type="checkbox"/> New School (Constructed after October 12, 1988) |
| <input type="checkbox"/> State building (Owned, Leased, or Used) | <input type="checkbox"/> Other: _____ |

STATE BUILDING EXEMPTION (LAC 33:III.2701.B)

I. If the following exemption applies, complete pages 1, 2, Section A, and provide supporting evidence as applicable.

1. This building is **not** a school building (see definition of school building) used for grades kindergarten through post-graduate; and
2. This state building was built after 1978 and is exempt from the requirements of this Chapter because there is no possibility of the presence of asbestos (**LAC 33:III.2701.B.2**); or
3. This state building was built before 1979 and is exempt from the requirements of this Chapter because an inspection was conducted in accordance with **LAC 33:III.2707.A**, and no asbestos is contained in the building, provided that:
 - a. a copy of the inspection report is submitted within 90 days of the inspection;
 - b. a copy of the report is maintained at the administrative office; and
 - c. no asbestos material was added in a renovation.

II. If an exemption is being requested from the requirements of submitting an asbestos Management Plan as indicated in **LAC 33:III.2701.B.2**, “State buildings built after 1978 are exempt from the requirements of this Chapter unless there is the possibility of the presence of asbestos or the building is used for education of grades kindergarten through post-graduate.”

The undersigned does hereby certify that the building will be used as a state building and there is no possibility of the presence of asbestos in the building as stated above (**LAC 33:III.2701.B.2**).

Responsible Individual (printed/typed name): _____
Responsible Individual Signature: _____
Responsible Individual Contact Information: Phone No: () _____
Fax No: () _____ Email Address: _____

III. If an exemption is being requested from the requirements of submitting an asbestos Management Plan as indicated in **LAC 33:III.2701.B.3**, “This state building was built before 1979 and is exempt from the requirements of this Chapter because an inspection was conducted in accordance with **LAC 33:III.2707.A**, and no asbestos is contained in the building,” attach the inspection report as noted above and a copy of current Louisiana inspector accreditation certificate behind this page. (**LAC 33:III.2707.A.3**)

Name of Louisiana Accredited Inspector: _____
Louisiana Accredited Inspector Signature: _____
Louisiana DEQ Accreditation No: _____
Expiration Date: _____

STATE BUILDING EXEMPTION (Continued) (LAC 33:III.2735.C)

*Please note that, in accordance with LAC 33:III.2735.B, “**If ACBM is subsequently found** in a homogeneous or sampling area of the **state government** [the responsible party for the state building] that had been identified as receiving an exclusion by an accredited inspector under Paragraph A.3, 4, or 5 of this Section, or an architect, project engineer, or accredited inspector under Paragraph A.7 of this Section, the state government [responsible party for the state building] shall have 180 days following the date of identification of ACBM to comply with this Chapter.”

SCHOOL BUILDING EXCLUSIONS (LAC 33:III.2735)

I. If the following exclusions apply, complete pages 1, Section A, and provide supporting evidence as applicable.

- a. An architect or project engineer responsible for the **construction of a new school building built after October 12, 1988**, or an accredited inspector signs a statement that no ACBM was specified as a building material in any construction document for the building or, to the best of his or her knowledge, no ACBM was used as a building material in the building. The local education agency shall submit a copy of the signed statement of the architect, project engineer, or accredited inspector to the Office of Environmental Services and shall include the statement in the management plan for that school.

The signed statement (supporting evidence) shall be placed behind this Section.

*Please note that, in accordance with LAC 33:III.2735.B, “If ACBM is subsequently found in a homogeneous or sampling area of a local education agency or the state government [responsible party for the state building] that had been identified as receiving an exclusion by an accredited inspector under Paragraph A.3, 4, or 5 of this Section, or an architect, project engineer, or accredited inspector under Paragraph A.7 of this Section, the local education agency or the state government [responsible party for the state building] shall have 180 days following the date of identification of ACBM to comply with this Chapter.”

- b. If the school or state bldg has been abated, and a thorough reinspection has confirmed that there is **no friable and nonfriable known or assumed ACBM in each building, further reinspections are no longer required (LAC 33:III.2707.B.1)**.

*Note in the management plan all of the information contained in the reinspection, including the inspection report, sampling and analysis report, inspector’s name, address, contact information, including telephone no and email address, etc.

- c. If the school meets either a. or b. above, periodic surveillance is no longer required.

***There are no exclusions from maintaining an Asbestos Management Plan for schools, which shall be kept in the administrative office for review.** The management plan shall be available, without cost or restriction, for inspection by representatives of EPA and the state, and the public, including parents, teachers, other school or public personnel, and their representatives. The local education agency or the responsible party for the state building may charge a reasonable cost to make copies of management plans. (LAC 33:III.2723.F.1)

Section A

Print Legibly or Type

FACILITY INFORMATION

(LAC 33:III.2723.D.1)

I. Building Information (Required):

Name of Building	Iowa High School		
Building Address	401 West Miller Avenue		
	City: Iowa	State: LA	Zip code: 70647
Date of Construction of Building	1960's era		

A. Mailing Information Required if for a School or School Building:

Responsible Official for School Print/Type Name & Title	Patrick Thomas		
School is Owned by: <input type="checkbox"/> City <input checked="" type="checkbox"/> Parish <input type="checkbox"/> State <input type="checkbox"/> Private	Name of Building Owner (School Board, other)		
	Calcasieu Parish School Board		
Mailing Address	3800 Mallard Cove Drive		
	City: Lake Charles	State: LA	Zip code: 70615

B. Lessor Information (Required if building is leased):

Lessor's Name			
Lessor's Address			
	City:	State:	Zip code:
Lessor's Contact Person			
Lessor's Email Address			
Lessor's Telephone No. ()	Lessor's Fax No. ()		

C. Is Asbestos present in the building?

Yes No

D. Yes, the building contains:

- Friable ACBM
- Nonfriable ACBM
- Friable and Nonfriable suspected ACBM assumed to ACBM

CLIENT: CALCASIEU PARISH SCHOOL BOARD

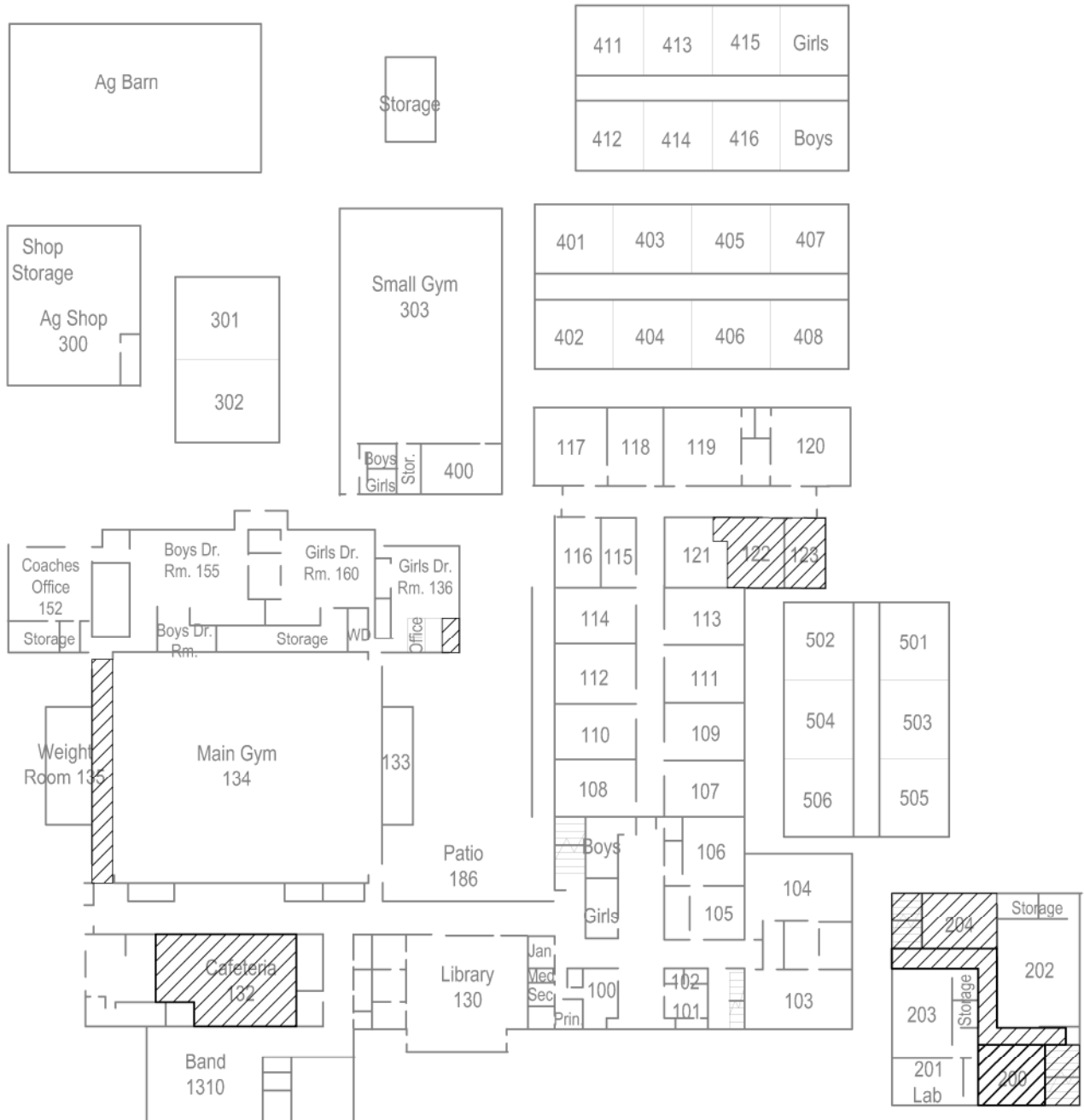

SECOND FLOOR

NOTE: TRANSITE WALL
PANELS IN THE FRONT
HALLWAY

 ASBESTOS FLOOR
TILE/MASTIC

WYNN L. WHITE
CONSULTING
ENGINEERS, INC.

PHONE: (225) 761-9141 / FAX: (225) 761-4450

PROJECT: CPSB REINSPECTIONS

SHEET: IOWA HIGH SCHOOL

PROJECT NO.: 21018 FACILITY NO.: 124

PREPARED BY: JLY DATE: 12/7/2022

CHECKED BY: CMW SHEET: 1 OF 1

Section B

INSPECTIONS CONDUCTED

(Check Appropriate Box)

- Inspections conducted before December 14, 1987 – Complete all Section A and B, Part I. (*LAC 33:III.2723.D.2*)

- Inspections conducted after December 14, 1987 – Complete all Sections A-G, except Section B, Part I. (*LAC 33:III.2723.D.3 and 2707*)

If the inspection report was conducted before December 14, 1987, attach inspection report behind Section B, Part I.

If the inspection report was conducted after December 14, 1987, attach inspection report behind Section B, Part II.

Section B
Part I

A. The following shall be included for each inspection conducted before December 14, 1987:

Date of Inspection (*LAC 33:III.2723.D.2.a*)

Bulk Sampling Location Diagram – (*LAC 33:III.2723.D.2.b*):

Location of Sampling Area	Approx. Square or Linear ft of any Homogeneous or Sampling Areas where Material was Sampled for Asbestos Containing Material (ACM)	Exact Locations where Bulk Samples were Collected	Date of Collection

Attach blueprints, diagrams or written descriptions of all homogeneous or sampling areas behind Section B, Part I.

Section B
Part I

Analysis (*LAC 33:III.2723.D.2.c*):

- Copy of analyses of any bulk samples taken
- Date of Analyses
- Copy of any other lab reports pertaining to the analyses

Response Actions/Preventative Measures (*LAC 33:III.2723.D.2.d*):

- Description of any response actions or preventative measures taken to reduce exposure
- Names and addresses of the contractors involved
- Start and completion dates of the work
- Results of any air samples analyzed during and upon completion of work

A description of assessments, required to be made of material that was identified before December 14, 1987, as friable Asbestos Containing Building Material (ACBM), including all Thermal System Insulation (TSI) or friable suspected ACBM (*LAC 33:III.2723.D.2.e*).

Section B
Part I



Accreditation information for each person making assessment (*LAC 33:III.2723.D.2.e*):

Name	Accreditation No	Expiration Date	Signature

Section B
Part II

B. The following shall be included for each inspection conducted after December 14, 1987:

List the following information for each accredited inspector who performed the inspection and re-inspection(s). (*LAC 33:III.2707.A.2, 2705, 2709, & 2711*). For state owned, leased or otherwise used state buildings only, 3 year re-inspections are not required; however, 6 month surveillance is required. Please attach a copy of each inspector's Louisiana DEQ accreditation certificate behind Section B, Part II.

Inspection/Re-inspection Date	Inspector's Name (Printed or Typed)	Louisiana Accreditation No	Inspector's Signature
9/21/22	Todd Peterson	MI165930	
8/7/19	Todd Peterson	0I165930	
7/1/16	Troy Hawthorne	7I190801	
See archive file data for records prior to 2016			

STATE OF LOUISIANA
DEPARTMENT OF ENVIRONMENTAL QUALITY

certifies that

William T Peterson

Has complied with all requirements of the Louisiana Department of Environmental Quality
and is authorized to perform the duties of

Asbestos Inspector

Accreditation No. MI165930

AI No. 165930

Date of Issuance February 16, 2022

Expiration March 21, 2023

Failure to comply with all applicable provisions of La. R.S. 2025.E. (1)(a) and La. R.S. 2025.F. (2)(a)
may result in civil and/or criminal enforcement actions by the State.

Permit Support Services Division
Office of Environmental Services

Section B
Part IV

A. Laboratory and Analysis Information (LAC 33:III.2711)

In accordance with *LAC 33:I.Chapter 45*, LELAP Accreditation is required by laboratories performing analysis. Attach a copy of the LELAP accreditation certificate behind Section B, Part III.

Attach a copy of the analyses of any bulk samples collected and analyzed. Place analyses report behind Section B, Part IV of the application. The Lab analysis **MUST** include the following:

- Name of Laboratory that analyzed the bulk samples;
- Address of Laboratory;
- Statement that Laboratory meets the requirements of *LAC 33:III.2711.A*;
- Date of Analysis;
- Name of person performing the analysis; and
- Signature of person performing the analysis.

B. Assessment (LAC 33:III.2713)

Within 30 days of the assessment, an accredited inspector shall provide a written assessment required by *LAC 33:III.2713* for **all** ACBM and suspected ACBM assumed to be ACM. Classification shall be given as indicated in *LAC 33:III.2713.B.1-7*, eg. indicate whether the ACM is damaged or significantly damaged thermal system insulation, damaged friable surfacing, etc. Write in space below or attach written statement behind Section B, Part IV.

Check if there is no ACM is in the building:

See archive file information

Name of Louisiana Inspector Collecting Samples:	<u>Todd Peterson</u>
Accredited Inspector's Signature:	<u></u>
Louisiana Accreditation No:	<u>MI165930</u>
Date of Expiration:	<u>3/21/2023</u>

Section C

DESIGNATED PERSON **(LAC 33:III.2705.A.7 and 2705.A.8)**

Name of Designated Person:	Patrick Thomas
Address of Designated Person:	3800 Mallard Cove Drive Lake Charles, LA 70615
Phone Number:	337-217-4350
Fax Number:	337-217-4351
E-mail of Designated Person:	patrick.thomas@cpsb.org

Attach copy of the training certificate received by the Designated Person from a recognized trainer. Place the certificate behind Section C. You may find a list of Training Providers that teach this course on the Asbestos Web page at <http://www.deq.louisiana.gov/portal/tabid/2883/Default.aspx>.

Course Name:	Asbestos Contractor Supervisor Refresher
Date of Training:	1/7/22
Length of Training (hours):	8
Training Organization:	Mendez Environmental
Instructor(s):	Kim D. Chapital

Note: Training must be completed within 6 months of submitting the Management Plan to LDEQ.

CERTIFICATE OF TRAINING

EPA/AHERA Training Program



This is to certify that

PATRICK R. THOMAS

LA. DL. 004 256 235

Has completed 8 hours of training and **PASSED** the test required by LAC 33:III.2799, Appendix A;
Section 206 of TSCA Title II and in accordance with LOUISIANA STATE ASBESTOS REGULATIONS entitled

ASBESTOS CONTRACTOR SUPERVISOR REFRESHER
(English)

Presented by
Mendez Environmental TM
1005 Veterans Memorial Blvd, Suite 101 ~ Kenner, LA 70062
Phone: (504) 468-8858 ~ Fax: (504) 541-0989
www.mendezenvironmental.com

Director:

Josefina Mendez-Rosa

Instructor:

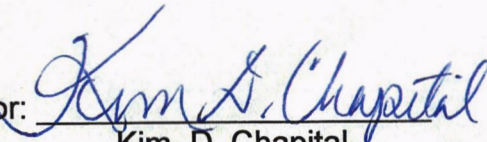
Kim D. Chapital

Course Date: 01/07/2022
Certificate Number: AS0122KLAPPT24383

Test Date: 01/07/2022 Grade: **PASS**
Expiration Date: 01/07/2023





STATE OF LOUISIANA
DEPARTMENT OF ENVIRONMENTAL QUALITY
Permit Support Services -- Asbestos

NAME: Patrick R Thomas
CERT: Contractor/Supervisor
ACCREDITATION #:3S210298
VALID: 1/25/2022 - 1/7/2023
AI #: 210298
MD



1005 Veterans Mem Blvd, Suite 101
Kenner, LA 70062 Tel: 504.468.8858
www.mendezenvironmental.com

PATRICK R. THOMAS

Has successfully completed

ASBESTOS CONT/SUPV REFRESHER
CERT# AS0122KLAPPT24383
EXP DATE: 1/7/2023



Section D

RESPONSE ACTIONS

A. Attach recommendations made to the local education agency (LEA) regarding Response Actions under *LAC 33:III.2717*. Attach recommendations behind Section D.

Check if the building is **NOT** used for Educational purposes.

Check if there is no ACM in the building.

Name of Person Making Recommendation: Chris M. White, P.E.

Recommendation Person's Signature: *Chris White*
Louisiana DEQ Accreditation No: JP095575
Date of Expiration: 1/17/2023

Section D

B. Provide the following written detailed description of preventive measures/response actions to be taken for any friable ACBM, including the following: **(LAC 33:III.2723.D.6)** Recordkeeping Requirements are to be maintained as part of the management plan **(LAC 33:III.2725)**

Methods to be used	The reinspection found non-friable ACBM. The non-friable ACBM floor tile/mastic and transite, is in good general condition and may remain in the facility until condition deteriorates or disturbed by renovation or demolition.
Location where measure or action will be taken	Main Building
Reason for selecting response action or preventive measure	Condition of material
Beginning date	None
Completion date	To be determined

Section D

C. Provide a detailed description in the form of blueprint, diagram, or written location description of ACBM, or assumed ACM, that does or will remain after response action. Attachment, if any should be placed behind Section D. (*LAC 33:III.2723.D.8*)

Check if there is no ACM in the building.

D. The undersigned does hereby certify that he/she is accredited under the provision of Appendix A of *LAC 33:III.2799.Appendix A*. (This applies to the person who inspected for ACBM and who will design or carry out response action, except O & M). (*LAC 33:III.2723.D.7*)

Name of Louisiana Inspector Collecting Samples: Todd Peterson

Accredited Inspector's Signature: *Todd Peterson*

Louisiana Accreditation No: MI165930

Date of Expiration: 3/21/2023

Louisiana Accredited Project Designer's Name: _____

Project Designer's Signature: _____

Louisiana DEQ Accreditation No: _____

Date of Expiration: _____

Section E

ACTIVITY PLANS (LAC 33:III.2723.D.9)

Check if there is no ACM in the building.

If there is ACM in the building, attach the following:

A. Attach a written plan for Re-inspection behind Section E (Required only for schools, including post graduate facilities, i.e. universities, etc. in accordance with **LAC 33:III.2707**).

B. Attach a written plan for Periodic Surveillance behind Section E (Required for all schools and state owned, leased, or otherwise used buildings **LAC 33:III.2721.B**).

C. Attach a copy of the Operations and Maintenance plan behind Section E. The O & M plan must be completed in accordance with **LAC 33:III.2719**.

D. Attach a copy of the Management Planner's recommendation regarding additional cleaning under **LAC 33:III.2719.C.2** as part of an operations, maintenance, and repair program.

E. Attach a copy of the Response to the Management Planner's recommendation by the local education agency (LEA) or owner or responsible party of the state owned, leased or used building.

Section E Additional Data

Periodic Surveillance/Reinspection Plan:

Periodic Surveillance: January 2023

Periodic Surveillance: July 2023

Periodic Surveillance: January 2024

Periodic Surveillance: July 2024

Periodic Surveillance: January 2025

Reinspection: July 2025

Management planner's recommendation regarding additional cleaning: None at this time.

Response to management planner's recommendation regarding additional cleaning: not yet programmed.

Section F

NOTIFICATIONS AND RESOURCES EVALUATION

Attach the following behind Section F:

NOTIFICATION

Attach a copy of the notification letter sent to parents, teachers, and employees concerning the availability of the Management Plan, including any response actions or activities that took place. Attach behind Section F. (*LAC 33:III.2723.F and LAC 33:III.2723.D.10*)

RESOURCES EVALUATION

Attach an evaluation of resources needed to complete response actions successfully and carry out re-inspection(s), operations and maintenance activities, periodic surveillance, and training. Attach behind Section F. (*LAC 33:III.2723.D.11*)

Section F Additional Data

Resource Evaluation:

Reinspection conceptual budget: \$350

Operations and Maintenance conceptual budget: \$500 implementation

Annual Periodic Surveillance conceptual budget: \$300

Annual training conceptual budget: \$300

Asbestos Abatement Conceptual Budget (Construction): \$5,000

TRANSMITTAL LETTER

DATE: September 23, 2015

TO: All Principals and Building supervisors

From: Mitch Trahan

Planning & construction/ AHERA

P.O. Box 800

Lake Charles, La. 70602

We transmit the attached correspondence, directives or documents for your information. If you have any questions or comments feel free to contact me.

DESCRIPTION:

PLEASE POST THE ATTACHED NOTIFICATION FOR THE PUBLIC

This is a requirement of the EP and DEQ offices.



Mitch Trahan, Planning & construction/ AHERA

MT/eg

Enclosures:

Cc: Mr. Karl Bruchhaus

File



Calcasieu Parish School Board
BUILDING FOUNDATIONS FOR THE FUTURE
Karl Bruchhaus, Superintendent

TO: Parents and Staff of Calcasieu Parish Schools

FROM: Mitch Trahan, Planning & construction / AHERA

DATE: September 23, 2015

In compliance with the U.S. Environmental Protection Agency (EPA) Asbestos Hazard Response Act (AHERA), in the fall of 1988 we performed inspections of each of our school buildings for asbestos-containing building materials. The inspection findings and asbestos management plans have been on file in each school administrative office since that time.

The EPA requires us to perform inspections of the asbestos materials every three years. During the month of August 1988, accredited asbestos inspectors performed these inspections. An accredited management planner reviewed the results of the inspections and recommend actions we should take to safely manage each asbestos material in our buildings.

As designated and responsible person for the asbestos program for the Calcasieu Parish Schools, I agree with recommendations of Wynn White, Management Planner, for response actions he has recommended in the reinspections plans. I will follow his guidelines and time table for the removal of asbestos and continue our Operations and Management Program as set forth in the reinspection plan.

The results of the reinspections are on file in the management plan in the school's administrative office. Everyone is welcome to view these anytime during the normal school hours (M-F, 8:00 AM - 3:30 PM). The Asbestos Program Manager, Mitch Trahan, is available to answer any questions you may have about asbestos in our buildings at (337) 217-4350 Ext. 5104.

Sincerely,



Mitch Trahan

Planning & Construction/ AHERA

MT/eg

Cc: File

Building Foundations for the Future



August 10, 2015

PUBLIC NOTICE

Public notice is hereby given that in compliance with the Asbestos Hazard Emergency Response Act (AHERA) of 1986, asbestos management plans for Calcasieu Parish Schools are available at the various schools and facilities upon request.

Gary Anderson
Assistant Superintendent
Human Resources/Auxiliary Services

Publish: American Press and Southwest Daily News
August 14, 21, 28, 2015

Building Foundations for the Future

Friday, August 21, 2015

PUBLIC NOTICE

Public notice is hereby given that the Calcasieu Parish School Board is in compliance with the Asbestos Hazard Emergency Response Act (AHERA) of 1986, asbestos management plans for Calcasieu Parish Schools are available at the various schools and facilities upon request. Garry Anderson Assistant Superintendent

Garry Anderson
Assistant Superintendent
Human Resources/Auxiliary Services
August 21, 2015

PUBLIC NOTICE Public notice is hereby given that in compliance with the Asbestos Hazard Emergency Response Act (AHERA) of 1986, asbestos management plans for Calcasieu Parish Schools are available at the various schools and facilities upon request. Garry Anderson Assistant Superintendent Human Resources/ Auxiliary Services Aug 14,21,28 3t 00925931

D4 AMERICAN PRESS FRIDAY AUGUST 28, 2015

PUBLIC NOTICE

Public notice is hereby given that in compliance with the Asbestos Hazard Emergency Response Act (AHERA) of 1986, asbestos management plans for Calcasieu Parish Schools are available at the various schools and facilities upon request.

Garry Anderson
Assistant Superintendent
Human Resources/
Auxiliary Services

Aug 14,21,28
00925931 3t

LEGALS

NOTICES TO CONTRACTORS

Notice of Commencement: Calcasieu Parish School Board, 201 Calcasieu Drive, Lake Charles, LA 70601. Project: 2015 School Improvements. Estimated Value: \$10,000,000.00. Estimated Date of Completion: 12/31/2015. For information, contact: Garry Anderson, Assistant Superintendent, Human Resources/Auxiliary Services, 201 Calcasieu Drive, Lake Charles, LA 70601, (337) 584-1100.

Contract No. 14-001-0001-0001. The City of Lake Charles, Louisiana, is hereby advertising for the construction of the following project: 2015 School Improvements. The project is located at 201 Calcasieu Drive, Lake Charles, Louisiana. The estimated value of the project is \$10,000,000.00. The estimated date of completion is 12/31/2015. For information, contact: Garry Anderson, Assistant Superintendent, Human Resources/Auxiliary Services, 201 Calcasieu Drive, Lake Charles, LA 70601, (337) 584-1100.

Affidavit of Publication

STATE OF LOUISIANA
Parish of Calcasieu

Before me the undersigned authority, personally came and appeared

Linda Trahan

who being duly sworn, deposes and says:

He/She is a duly authorized agent of
LAKE CHARLES AMERICAN PRESS

a newspaper published daily at 4900 Highway 90 East,
Lake Charles, Louisiana, 70615. (Mail address: P.O. Box 2893
Lake Charles, LA 70602)

The attached Notice was published in said newspaper in its issue(s)
dated:

00925931 - \$25.00

August 14, 2015,
August 21, 2015,
August 28, 2015

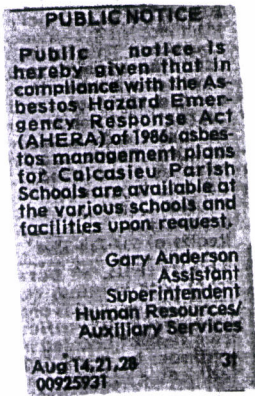

Linda Trahan

Duly Authorized Agent

Subscribed and sworn to before me on this 28th day of August, 2015 at
Lake Charles, LA

Becky R. Venissat

06100179

Notary Public

CALCASIEU PARISH SCHOOL

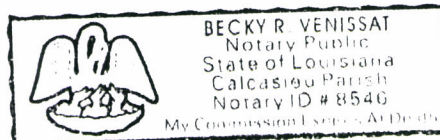



August 10, 2015

PUBLIC NOTICE

Public notice is hereby given that in compliance with the Asbestos Hazard Emergency Response Act (AHERA) of 1986, asbestos management plans for Calcasieu Parish Schools are available at the various schools and facilities upon request.

Gary Anderson
Assistant Superintendent
Human Resources/Auxiliary Services

Publish: American Press and Southwest Daily News
August 14, 21, 28, 2015

Building Foundations for the Future



Calcasieu Parish School Board
BUILDING FOUNDATIONS FOR THE FUTURE
Karl Bruchhaus, Superintendent

August 10, 2015

Mark Hayes, President
Calcasieu Association of Educators
300 East McNeese Street Ste. 4A
Lake Charles, Louisiana 70605

Dear Mr. Hayes,

The Asbestos Hazard Emergency Response Act (AHERA) of 1986 requires that teacher and employee organizations be given written notification by the local education agency of the availability of management plans. This letter serves as our annual notification.

The principals and/or building administrators have the plans at this time and the plans are available upon request.

Please make this announcement available to your membership.

Thanks for your assistance in this matter.

Sincerely,



Gary Anderson
Assistant Superintendent
Auxiliary Services

GA:dv

Building Foundations for the Future

MANAGEMENT PLAN CONTRIBUTORS

A. List the accredited management planner and all other consultants who contributed to the Management Plan. Attach Louisiana accreditation certificate for current asbestos management planner behind Section F. (*LAC 33:III.2723.D.12*)

Name	Accreditation No.	Expiration Date	Signature	Email address
Chris White	JP095575	1/17/23	<i>Chris white</i>	cwhite@wynnwhite.com

STATE OF LOUISIANA
DEPARTMENT OF ENVIRONMENTAL QUALITY

certifies that

Christopher M White

Has complied with all requirements of the Louisiana Department of Environmental Quality
and is authorized to perform the duties of

Asbestos Management Planner

Accreditation No. JP095575

AI No. 95575

Date of Issuance February 4, 2022

Expiration January 17, 2023

Failure to comply with all applicable provisions of La. R.S. 2025.E. (1)(a) and La. R.S. 2025.F. (2)(a)
may result in civil and/or criminal enforcement actions by the State.

Permit Support Services Division
Office of Environmental Services

B. THIRD PARTY ASBESTOS MANAGEMENT PLAN REVIEWER (optional)

A local education agency or the responsible party for the state building may require each management plan to contain a statement signed by a third party accredited management planner as a reviewer to the current accredited management planner, that such person has prepared or assisted in the preparation of such plan or has reviewed such plan, and that such plan is in compliance with **LAC 33:III.Chapter 27. (LAC 33:III.2723.E)**

Statement is Required by LEA or State Statement is NOT Required by LEA or State

The undersigned does hereby certify that they have reviewed the management plan and testify that the plan complies with **LAC 33:III.2723** of the Louisiana Air Quality regulations. (Statement may NOT be signed by a person who, in addition to preparing or assisting in preparing the Management Plan, also implements or will implement the Management Plan). If signed, attach copy of current management planner accreditation certificate behind Section F. **(optional as part of LAC 33:III.2723.E)**

Name of Louisiana Accredited Reviewing Management Planner: _____
Reviewing Management Planner Signature: _____
Louisiana DEQ Accreditation No: _____
Expiration Date: _____

Section G
Part I

RECORDKEEPING

PREVENTATIVE MEASURES/ RESPONSE ACTIONS

For each preventative measure and response action performed after December 14, 1987, the local education agency or responsible party for the state building shall provide the following information:

- A. A detailed written description of the action taken. The description should include the following information. Attach behind Section G, Part I. (*LAC 33:III.2725.B.1*)
- Methods Used
 - Location of Measure or Action
 - Reason for Selection of Action
 - Names and Addresses of all Contractors Involved
 - Louisiana Accreditation Number of Contractor/Supervisor(s)
 - Storage or Disposal Site if ACM was Removed

B. The name and signature of any person collecting air samples required at the completion of response actions. (*LAC 33:III.2725.B.2*) Note that the person conducting air monitoring must be LDEQ accredited as an asbestos Contractor/Supervisor.

Name	Accreditation No	Expiration Date	Signature
See archive file data			

C. A written description of the locations where samples were collected. The following information should be included in the description. Attach behind Section G, Part I. (**LAC 33:III.2725.B.2**) Note that the laboratory conducting analysis of air samples must be a LELAP accredited lab. Attach a copy of the LELAP certificate behind Section G, Part I.

- Date of Collection
- Name and Address of Analyzing Laboratory
- Date of Analysis
- Results of Analysis
- Methods of Analysis
- Name and Signature of Analyst
- LELAP Laboratory Accreditation Certificate

EMPLOYEE TRAINING:

List each person required to be trained under *LAC 33:III.2721.A.1-3* and for supervisors who direct workers who may disturb ACM.

Note: all members of its custodial and maintenance staff who may work in a building that contains ACBM, whether or not they are required to disturb ACBM, shall receive **at least two hours of awareness training** within 60 days after commencement of employment; and staff who conduct any activities that will result in disturbance of 3 square or linear feet of ACBM shall receive **14 hours of additional training**. The following information must be provided for each employee trained. (*LAC 33:III.2725.C*) Attach behind Section G, Part I.

Name	Job Title	Date of Training Completed	Location of Training	Trainer/ Trainer Provider	Number of Hours Completed
See archive file data					

Section G
Part II

SURVEILLANCE

List each time that a periodic surveillance under *LAC 33:III.2721.B* is performed. (*LAC 33:III.2723.D*)

Date of Periodic Surveillance	Name (Printed or Typed)	Louisiana Accreditation No.	Expiration Date	Changes in Conditions
See archive file data				

**Section G
Part III**

CLEANING

List each time that cleaning under *LAC 33:III.2719.C* is performed. (*LAC 33:III.2725.E*)

Date of Cleaning	Name (Printed or Type)	Locations Cleaned	Methods used to perform cleaning
See archive file data			

Section G
Part IV

O & M ACTIVITIES

List the following information for each Operation and Maintenance activity conducted after December 14, 1987: (*LAC 33:III.2725.F*) Attach behind Section G, Part IV.

- Name of Person(s) Performing the Activity
- Start and Completion Dates for each Activity
- Location where Such Activity Occurred
- Description of Activity
- If Asbestos was Removed, the Name and Location of Storage or Disposal Site

MAINTENANCE ACTIVITIES OTHER THAN SMALL SCALE SHORT DURATION (SSSD)

List the following information for each time a major asbestos activity under *LAC 33:III.2719.E* is performed: (*LAC 33:III.2725.G*)
Attach behind Section G, Part IV.

Name of the Person Performing the Activity	Start/Completion Dates	Location	Description of the Activity	If Asbestos was Removed Name and Location of Storage and Disposal Site
See archive file data				

FIBER RELEASE EPISODE

For each fiber release episode that has occurred post December 14, 1987, list the following information: (*LAC 33:III.2725.H*) Attach behind Section G, Part IV.

- Date and Location of Episode
- Method of Repair
- Preventive Measures or Response
- Name of Person Performing the Work
- If Asbestos was Removed, the Name and Location of Storage and Disposal Site

**DESIGNATED PERSON GENERAL RESPONSIBILITIES UNDER
LAC 33:III.Chapter 27**

Pursuant to *LAC 33:III.2705.A* and *LAC 33:III.2723.H* of the Louisiana Air Quality Regulations, (Asbestos-Containing Materials in Schools and State Buildings), each Management Plan must contain a true and correct statement, signed by the Designated Person, that certifies that the general Management Plan responsibilities have been met. This form is provided to assist you in complying with this portion of *LAC 33:III.Chapter 27*.

School/Agency:	Iowa High School	
Building Address:	401 West Miller Avenue, Iowa, LA, 70647	
Designated Person:	Patrick Thomas	
Designated Person's Address:	3800 Mallard Cove Drive	
City: Lake Charles	State: LA	Zip Code: 70615
Phone No: 337-217-4350	Email: patrick.thomas@cpsb.org	

ASSURANCES

This asbestos Management Plan was developed and has been submitted pursuant to *LAC 33:III.Chapter 27* of the Louisiana Air Regulations, Asbestos-Containing Materials in Schools and States Buildings, and the undersigned does hereby certify that the Designated Person has and will ensure the following:

- 1) The activities of any person, who performs inspections, re-inspections, and periodic surveillance, develops and updates Management Plans, and develops and implements response actions, including operations and maintenance, are carried out in accordance with *LAC 33:III.Chapter 27*.
- 2) All custodial and maintenance employees are properly trained as required in *LAC 33:III.Chapter 27* and all other applicable federal and/or state regulations (e.g., the Occupational Safety and Health Administration Asbestos Standard for Construction, the EPA Worker Protection Rule, or applicable state regulations).
- 3) All workers and building occupants, or their legal guardians, are informed annually about inspections, response actions, post-response action activities, including periodic re-inspection, if applicable, and surveillance activities, that are planned or in progress.
- 4) All short-term workers (e.g., telephone repair workers, utility workers, or exterminators etc.) who may come in contact with asbestos in a school are provided information

regarding the locations of ACBM and suspected ACBM assumed to be ACM.

- 5) All warning labels are posted in accordance with **LAC 33:III.2727**.
 - 6) All management plans are available for inspection and that notification of such availability has been provided as specified in the Management Plan under **LAC 33:III.2723.F**.
 - 7) The undersigned Designated Person pursuant to **LAC 33:III.2705.A.7** received adequate training as stipulated in **LAC 33:III.2705.A.8**.
 - 8) The Designated Person will consider whether any conflict of interest may arise from the interrelationship among accredited personnel and whether that should influence the selection of accredited personnel to perform activities under **LAC 33:III.Chapter 27**.
-

Signature: signature unavailable
Designated Person, pursuant
To LAC 33:III.2723.H

Phone No: 337-217-4350

Email Address: patrick.thomas@cpsb.org

Fax No: 337-217-4351