



ANN ARBOR PUBLIC SCHOOLS
LEAD. CARE. INSPIRE.



Civil Engineering & Architectural Services Projects

REPORT TO THE BOARD OF EDUCATION
FEBRUARY 20, 2019

PRESENTED BY:

Emile Lauzzana, Executive Director – Physical Properties



Carpenter Enhancement

SCOPE OF WORK:

- Expansion - Modular Addition
- Enlarge Kitchen
- Add 2nd Cafeteria Line
- New Playground
- Relocate School Garden
- Upgrade Electrical Service
- Transitional Traffic Plan



Carpenter Modular Addition

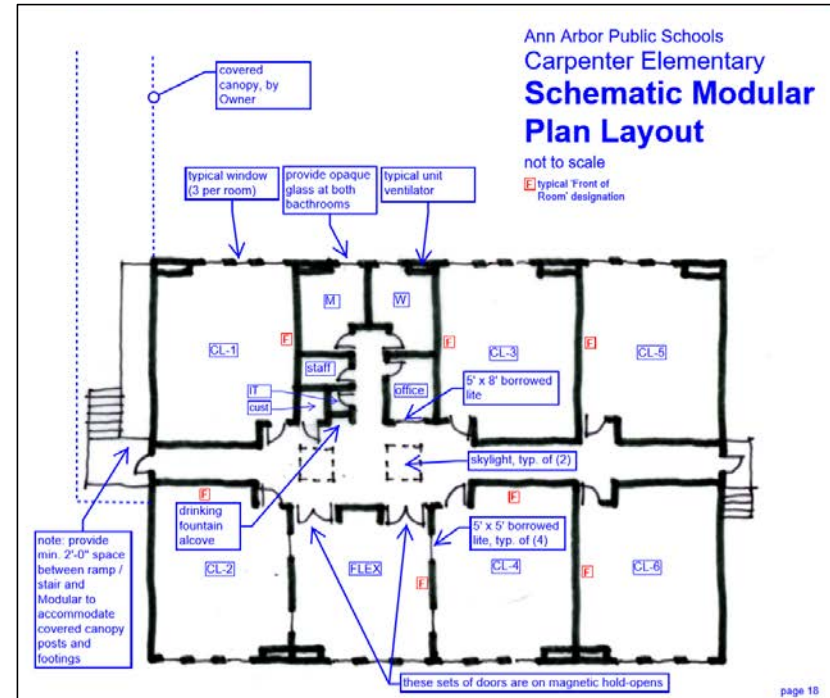

SCOPE OF WORK: Additional 6 Classrooms, Flex Space, Office, and Restrooms

Pioneer Renovation

SCOPE OF WORK:

- **Exterior**
 - Replace lighting ground boxes in parking lot
 - Drainage improvements
- **Entrance**
 - Replace main entry doors
- **Cafeteria and Servery**
 - Flooring, lights, painting, window replacement, and counters
- **E-Wing**
 - Replace sloped glazing and paint interior at new glazing system
- **Stairwells**
 - New lighting



Bryant Renovation

SCOPE OF WORK:

- **Exterior**
 - Landscape improvements
 - New entrance sunshade and sign
- **Lobby**
 - Skylight, lighting, ceiling, painting, and flooring
- **Media Center**
 - New open ceiling, skylights, glass walls, lighting, and painting
- **Collaboration Space**
 - New open ceiling, skylights, glass walls, lighting, wet wall, electrical, furnishings, flooring, and painting
- **Hallways** – remove mid-hallway doors, patch and paint
- **Gymnasium** – acoustical panels and new lighting (completed)



Pattengill Renovation

SCOPE OF WORK:

- **Exterior**
 - Metal roof repair
- **Lobby**
 - Flooring, lights, clean brick, display cases, and painting
- **Cafeteria**
 - Painting to 10' high
- **Collaboration Space**
 - New open ceiling, skylights, glass walls, lighting, wet wall, electrical, furnishings, flooring, and painting
- **Hallways** – clean brick
- **Gymnasium** – refinish floor, paint, and wall pads
- **Media Center** – patch and paint ceiling



Lawton Renovation

SCOPE OF WORK:

- Convert Computer Lab to Classroom
- Create Classroom with portion of Media Center
- Paint, floors, lights, ceilings, and furnishings as needed

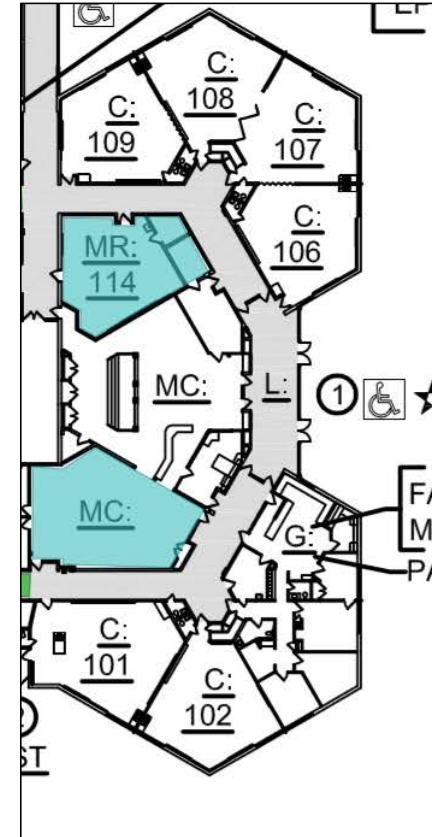

Elementary and K-8 Shade Tree Program

SCOPE OF WORK:

- Install 400 legacy hardwood trees at Elementary and K-8 schools over the next 2 years
- Benefits include:
 - Shade for students and staff
 - Reduced urban heat island effect
 - Reduced Stormwater runoff and SOM permit credit
 - Carbon sequestration
- 7 tree species selected are Native, Native Cultivar, or Regional and on the City of Ann Arbor approved species list



1. Red Sunset Red Maple
Acer rubrum 'Red Sunset'

Elementary and K-8 Shade Tree Program



2. Green Mountain Sugar Maple
Acer saccharum 'Green Mountain'



3. Skyline Honeylocust
Gleditsia tricanthos 'Skyline'



4. Shingle Oak
Quercus imbricaria

Elementary and K-8 Shade Tree Program

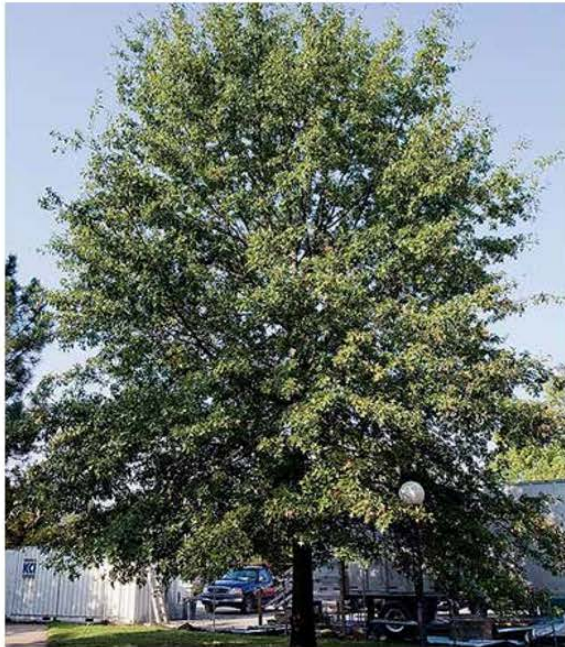

5. Red Oak
Quercus rubra



6. Autumn Blaze Maple
Acer x freeman 'Jeffersred'



7. Bloodgood Planetree
Platanus x acerifolia 'Bloodgood'