

McClymonds High School

PROJECT ADVISORY COMMITTEE (PAC) MEETING 11.07.2023



HONORING HISTORY

CULTURAL REPRESENTATION

ACADEMIC ENRICHMENT

COMMITTMENT

Reference Material

11/7/23 Project Advisory Committee (PAC) Meeting Presentation*

<https://bit.ly/McClymondsHSInfo>

Frequently Asked Questions (FAQs) To be distributed

10/11/23 New McClymond's Alumni Meeting Presentation*

<https://bit.ly/McClymondsHSInfo>

10/4/23 Student Athletes Design Meeting*

<https://www.ousd.org/site/handlers/filedownload.ashx?moduleinstanceid=40092&dataid=44830&FileName=231004%20USD%20McClymonds%20Athletics%20Meeting.pdf>

10/3/23 Community Engagement Presentation*

<https://www.ousd.org/site/handlers/filedownload.ashx?moduleinstanceid=40092&dataid=44770&FileName=Presentation%20-%20McClymonds%20HS%20Community%20Input%20Session%20-%20October%202023.pdf>

Community Engagement Flyer - Design and Focus Group Meetings*

<https://www.dropbox.com/scl/fi/gmwu052hxfoo0aaaa0c2r/McClymonds-High-School-Design-and-Focus-Group-Meetings-09-2023.pdf?rlkey=mf0yajkr2tib39492me800kb&dl=0>

9/5/23 Project Advisory Committee (PAC) Meeting Presentation*

<https://www.dropbox.com/scl/fi/89zu257h4tlozakup2498v/09-2023-OUSD-McClymonds-PAC-Meeting.pdf?rlkey=nvesw1f6hdofye6qgfqhagly&dl=0>

8/1/23 Project Advisory Committee (PAC) Meeting Presentation*

<https://www.dropbox.com/scl/fi/2jg95vi140sxuty9bu8md/08-2023-OUSD-McClymonds-PAC-Meeting.pdf?rlkey=kfzmk8wuaq7gahdhpta5xmgmi&dl=0>



*Also Available on the OUSD Project Site: <https://www.ousd.org/site/Default.aspx?PageID=21390>

Honoring History

Health & Well-Being

Academics

Athletics / Music

Cultural Integrity

Collaboratively identify a design concept that incorporates
5 areas of importance



Agenda

I. Introduction

II. 30-Day Update

III. Design Update

- a. In-person Design Activity
- b. Design Process Timeline / 60 Day Look-Ahead

IV. Community Engagement/ Schedule

- a. Initial Survey Results
- b. Design & Focus Meetings

V. Next Steps

Meet the Team



Project Overview

Modernization Project to Start 7/2025

\$34M Deficit Given Scope of Work Required

Design-Build (80% Schematic Design)

Four Priority Scope Areas

\$91.25M Budget (70% for Construction Costs)

Programs to Support Proposed 650 Students

- *Architects/CRC Conducting Input Sessions*
- *Community Engaged in Site Walks*
- *3D Scanning, Seismic Evaluations, and Review of Existing Conditions Completed*
- *Renderings Being Progressively Updated*
- *Budget Being Refined as Schematic Design is Finalized*

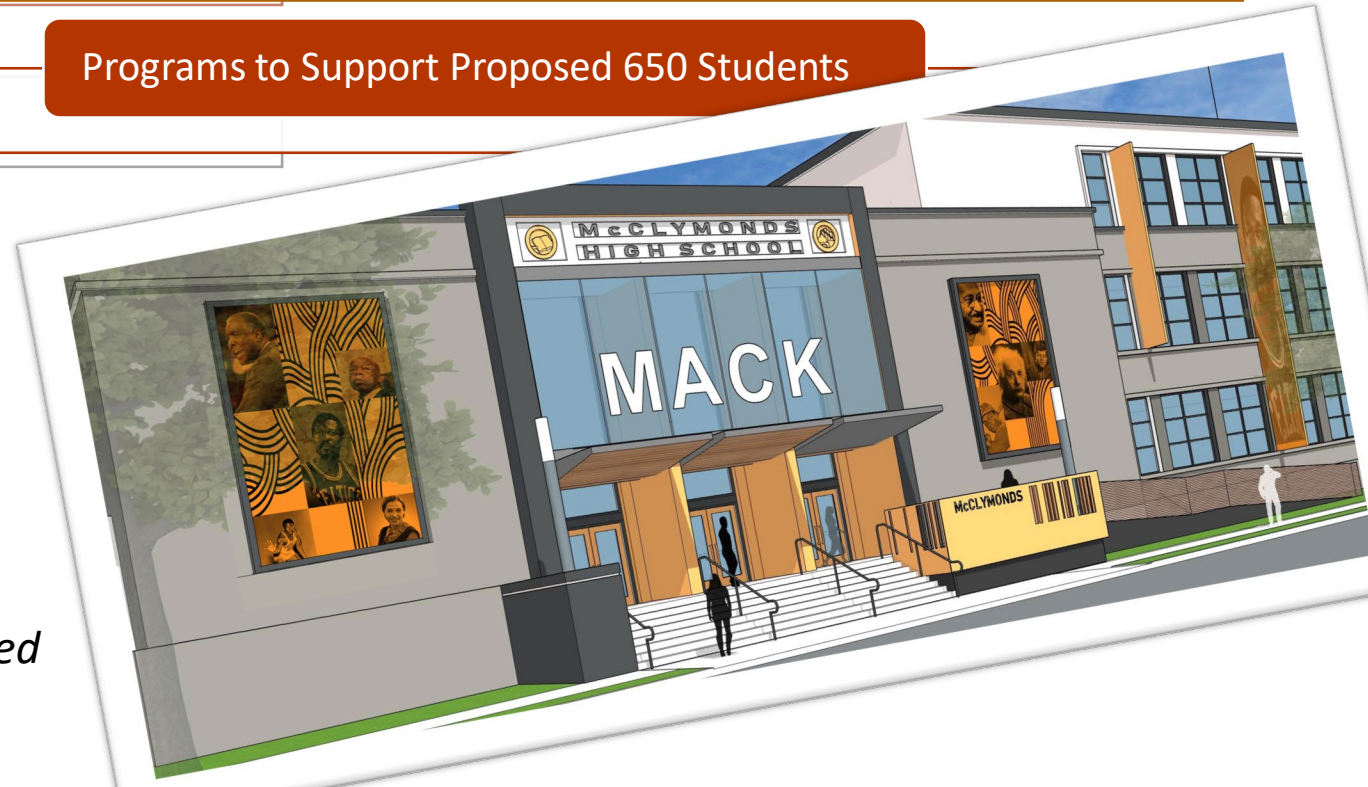



30-Day Update

What Has Occurred Over the Past 30 Days? ---

- 10/04/23 Student Athlete and Families Project Meeting
- 10/12/23 Initial Community Input Survey Distributed at New McClymond's Meeting
- 10/13/23 CRC Distributed Design Concept Survey to Parents/Alumni/Students; CRC & Hood Design Team attend football game
- 10/23/23 Tabling during lunch time to receive feedback from students about the project
- 10/24/23 Tabling during lunch time to receive feedback from students about the project
- 10/27/23 Gym remodel Design meeting with Coaches

Other ongoing activities: Survey, Design Team progress on Schematic Design package



Pending Inquiries



Adult School (Removal from School Grounds)

Relocation is the intention. However, the HS Network Superintendent has not confirmed this can be done at this time.

Community Input

Community has input on various concept designs, colors, materials, and scope. However, when health, safety, and code are in question, all community input will be secondary as these items will be priority.

Consistency of Meeting Content (Facilities vs Community Mtgs)

Project Managers complete a fact sheet in preparation for the Facilities Meeting and Leadership relays this information. Moving forward, we will check for consistency prior to submitting to Leadership for presentation.

Factors Determining 650 Proposed Student Body

The 650 proposed student body was developed by the District to support the “Quality Community School Model” that indicates a specific number of base faculty and specialized departmental staff will support proposed growing enrollment. The goal for 2026-27 was set at 650 if the enrollment increased by ~15.1% every year from 2022 (368)

Define the activity, “Data Collection” on slide 25 of October Community Mtg

Data Collection was Reviewing “Existing Conditions” of the School

Design Update / Timeline

The image shows a spacious, modern interior, possibly a school cafeteria or a community center. The room is filled with long, dark-colored tables and bright red stools. The floor is decorated with a large, colorful geometric pattern in shades of red, orange, and yellow. The ceiling is high and features exposed ductwork and modern, angular light fixtures. Large windows on the left side provide a view of the outdoors. The overall atmosphere is bright and contemporary.



In-person Design Activity

Project Goals – Design Process Timeline

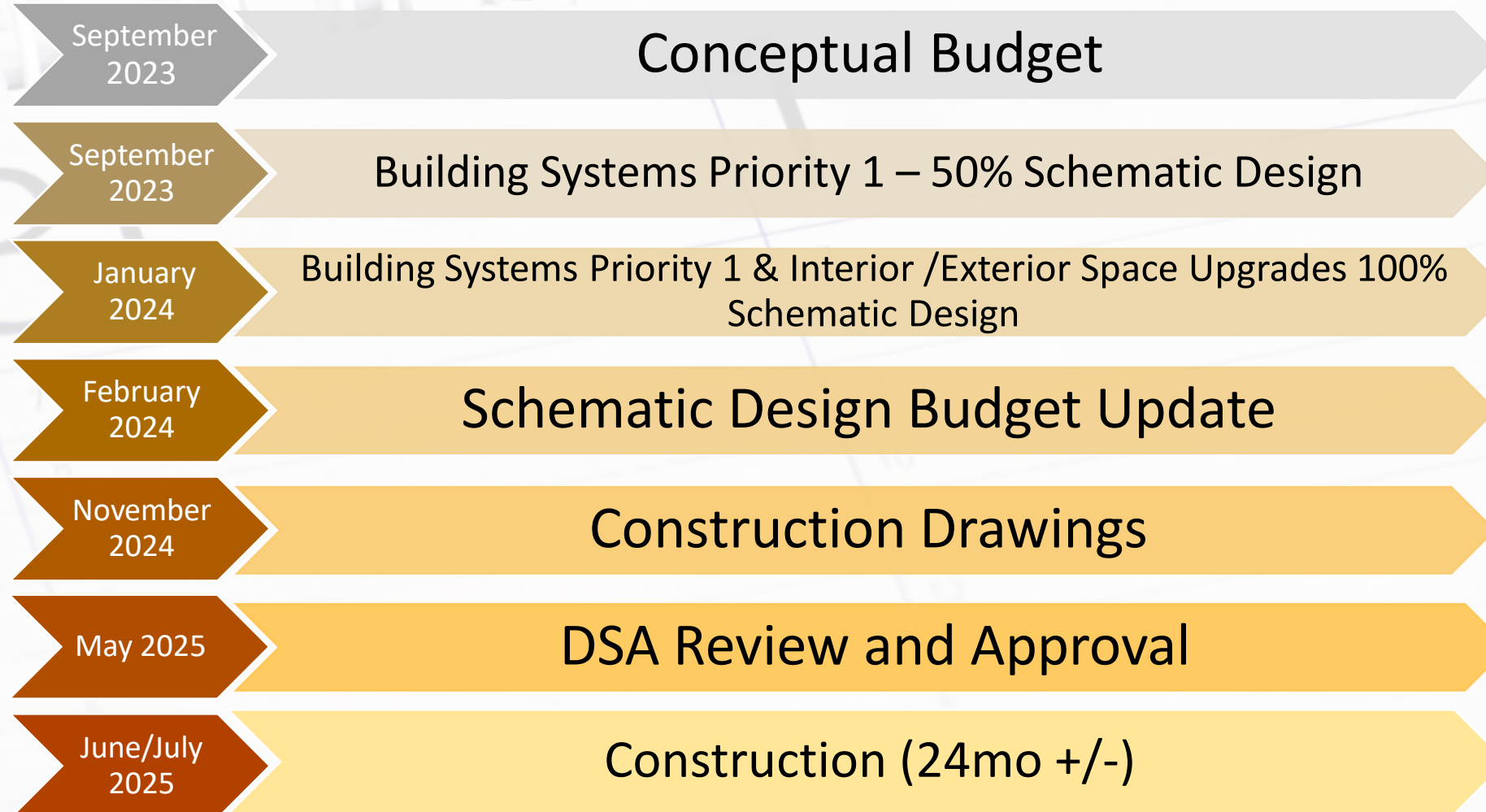

Project Deadlines / 60 Day Look-Ahead

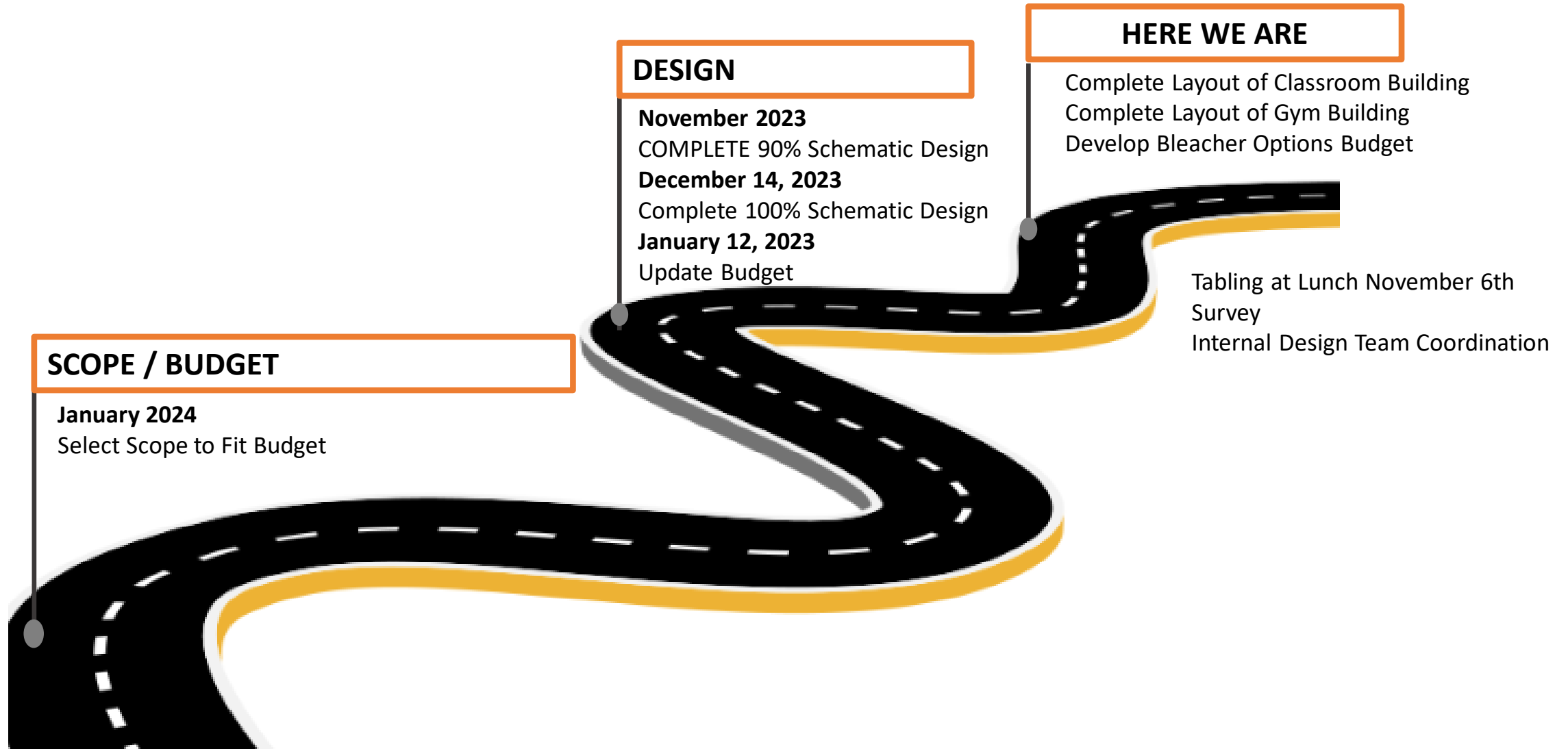

Engagement During the Design Phase

A group of diverse people are gathered on a sidewalk for a community engagement session. In the foreground, a man with a backpack and a woman are looking at a document. A woman in a yellow shirt and a man in a blue shirt are also looking at documents. In the background, a man in a light blue shirt is standing with his hands in his pockets. A woman in a blue jacket is standing near a set of stairs. A man in a light blue shirt is standing near a set of stairs. A woman in a black jacket is standing near a set of stairs. The scene is outdoors with trees and a building in the background. A street sign for '26' is visible. A 'NO PARKING' sign is also visible. A bicycle is parked near the stairs.

Survey/Tabling Results

57 Respondents

Respondent Categories

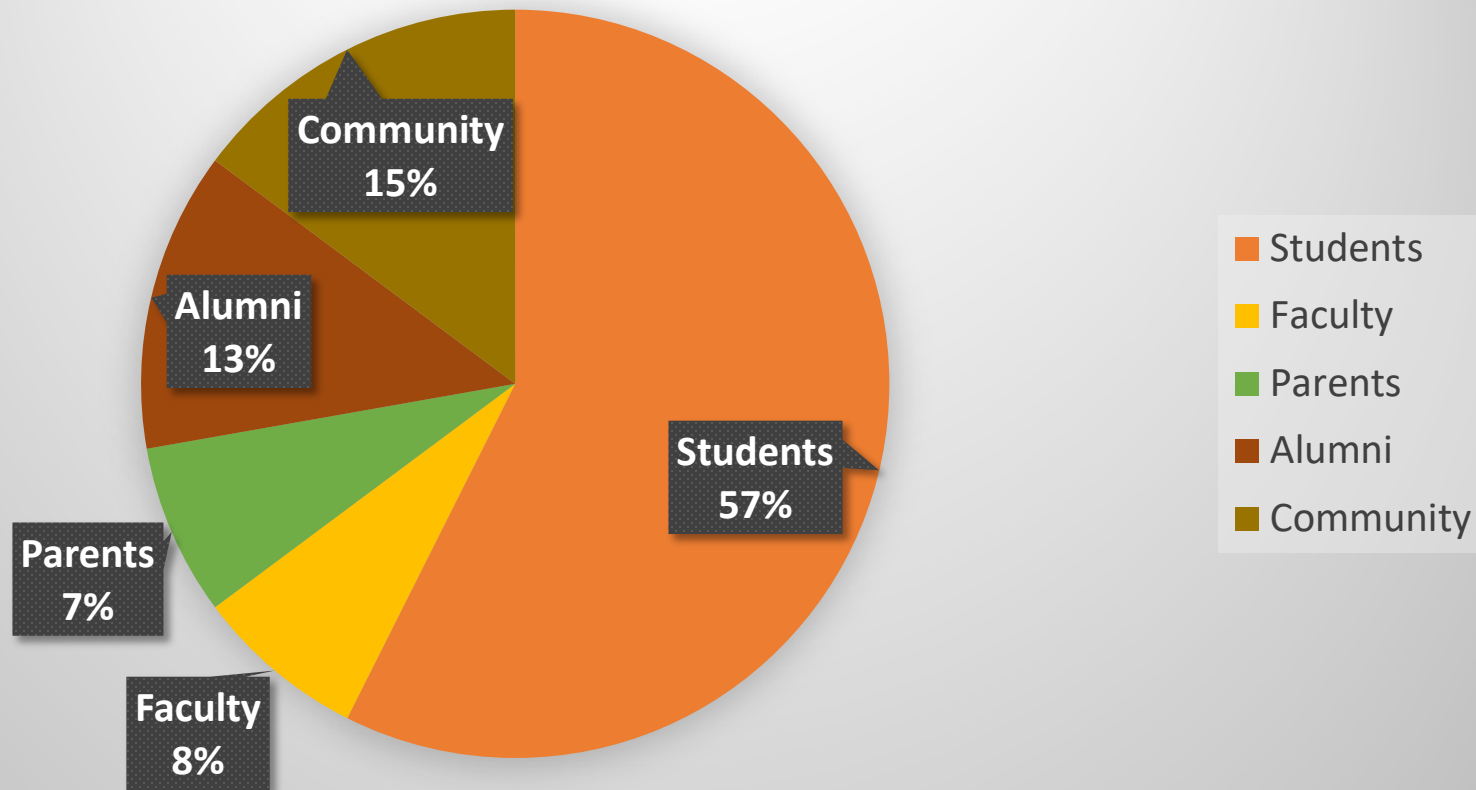

- Distributed at Parent Pick-up
- Distributed at 10/13 Home Football Game
- Distributed at New McClymond's Alumni Meeting
- Placed in Administrative Office
- Posted on McClymond's Parent Square
- Student Engagement/Tabling

Survey/Tabling Results

Main School Entrance

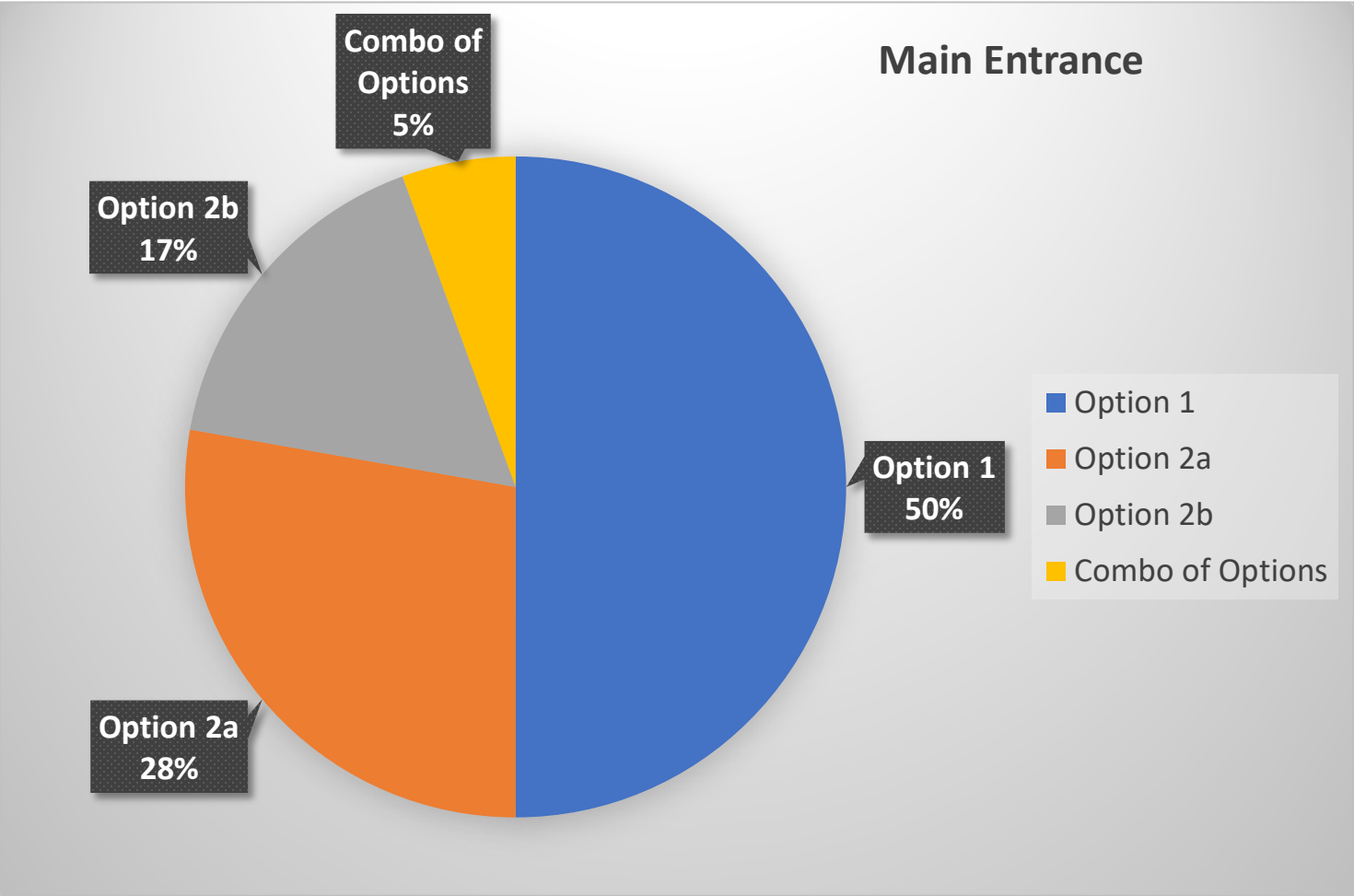

Survey/Tabling Results

General Education Classrooms

General Education Classrooms

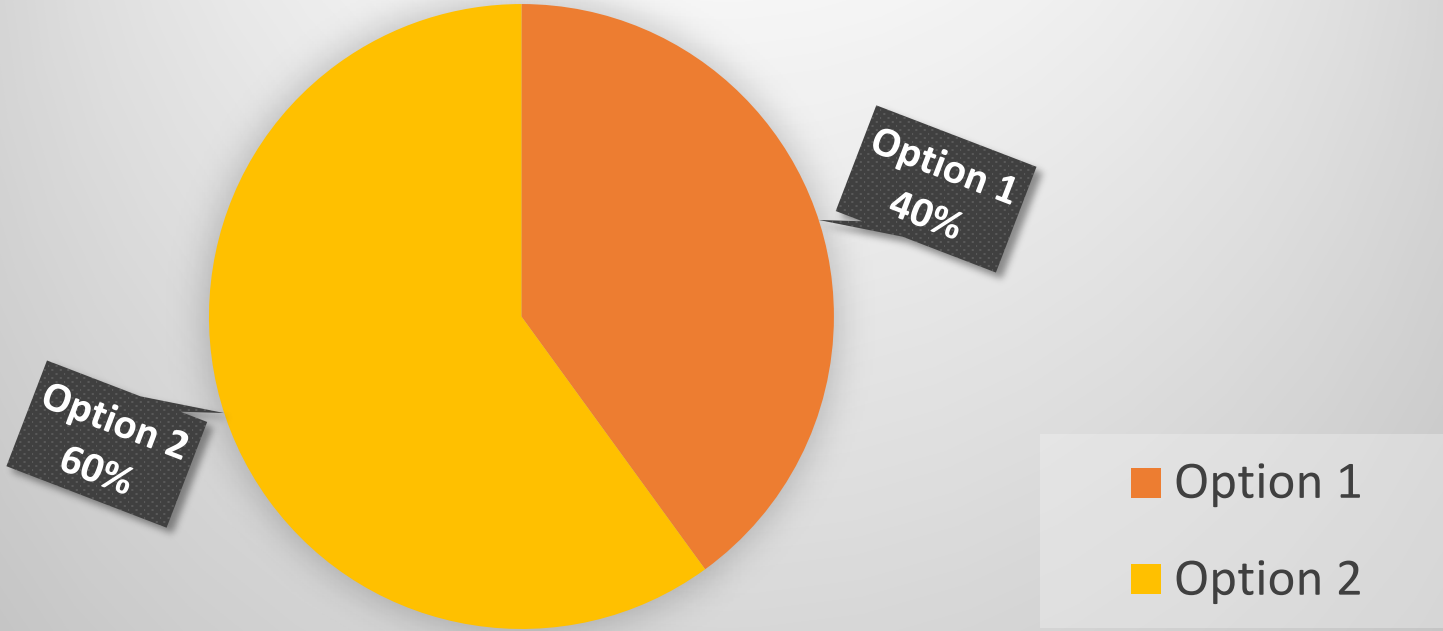

Survey/Tabling Results

Laboratory

Laboratory

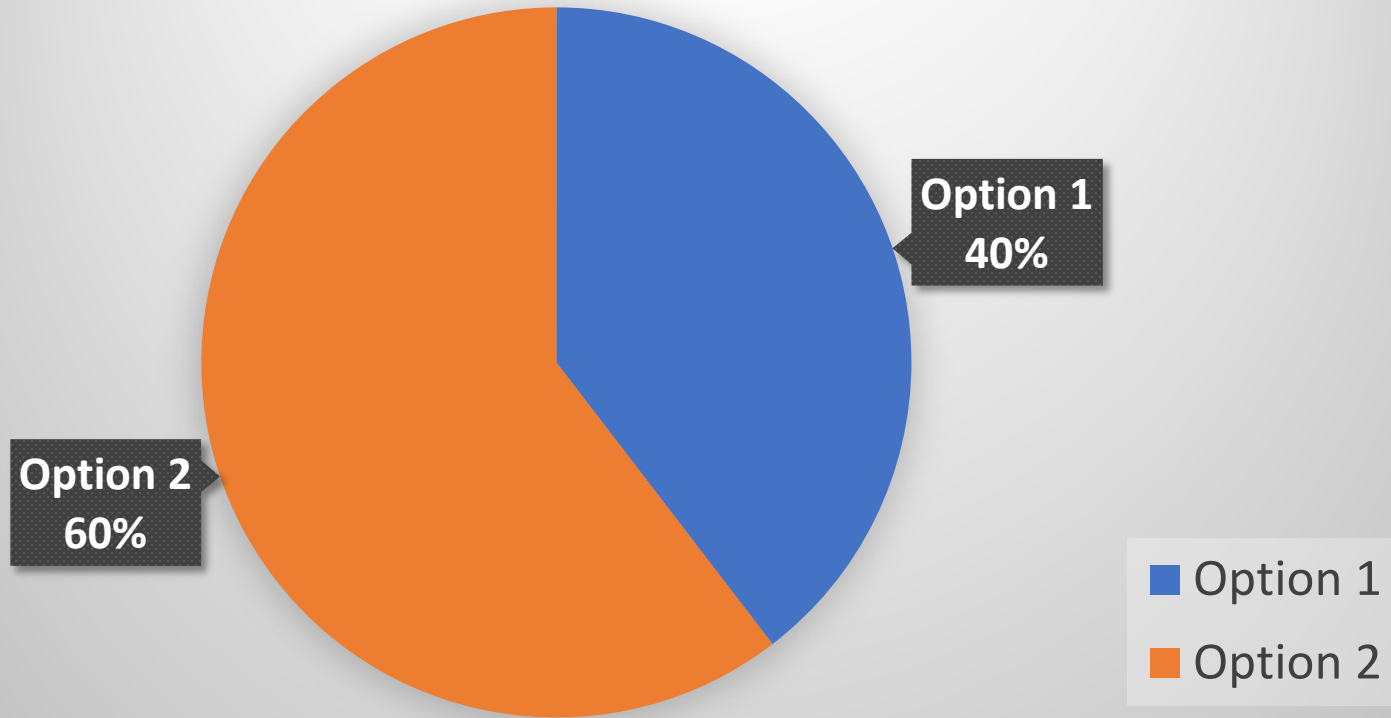

Survey/Tabling Results

Laboratory

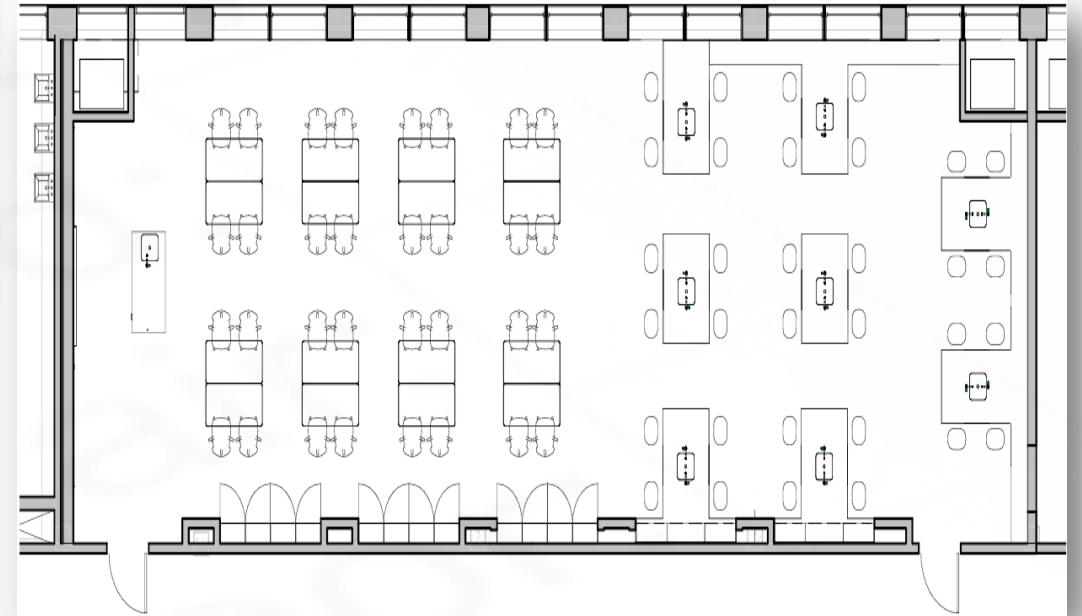

Option 2

Survey/Tabling Results

Cafeteria

Cafeteria

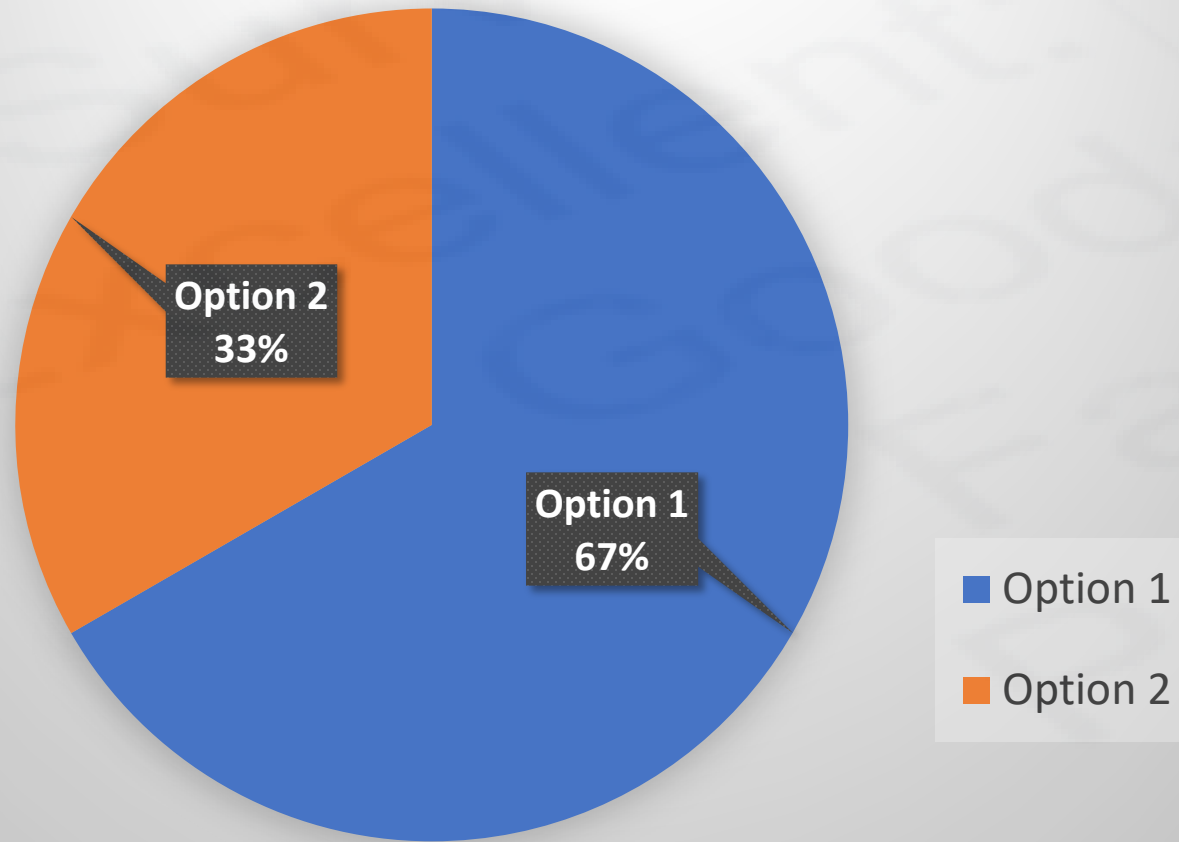

Survey/Tabling Results

Combo of

Student Comments

I like Option 1 because of the pattern.

Great palette, it has a lot of modern looks and colors.

I love both. They are very neutral colors, but we love the orange and black

Campus is loud, empty - nothing going on, and old.

Wants and likes brighter colors, more vibrant, more fun.

Wants more colors, to tell a story, need a middle color.

Wants school to be comfortable.

Wants school to be safe, clean, modern, colorful.

Option 2
30%

10 Respondents Were Students Only

Interior Color Palettes



L



2

Survey/Tabling Results

Favorite Place on Campus

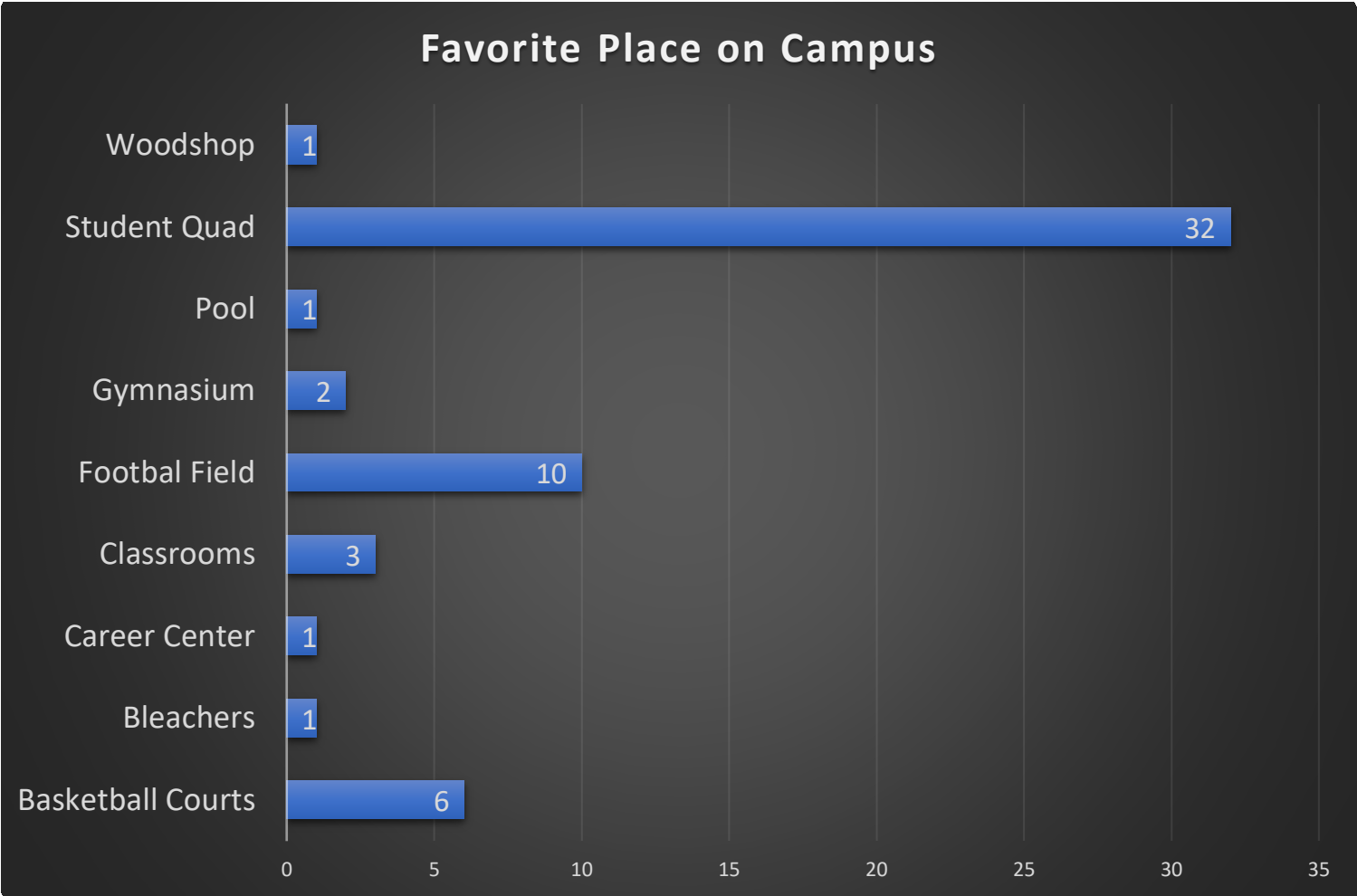

57 Respondents Were Students Only

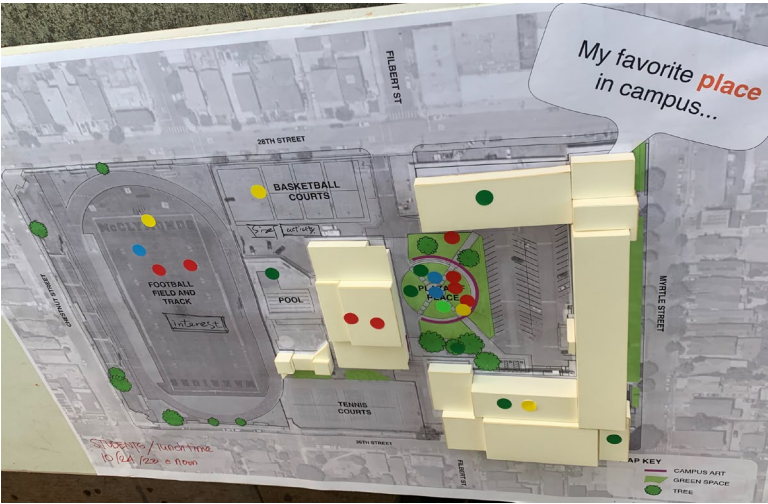
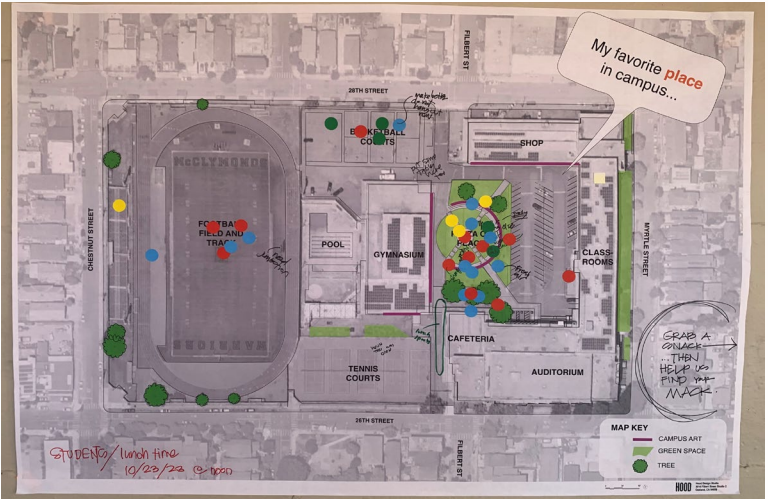

Survey/Tabling Results

Reason for Favorite Place on Campus

Favorite Place on Campus - I like the above place(s) on campus because.....(Select boxes that apply)

15 responses

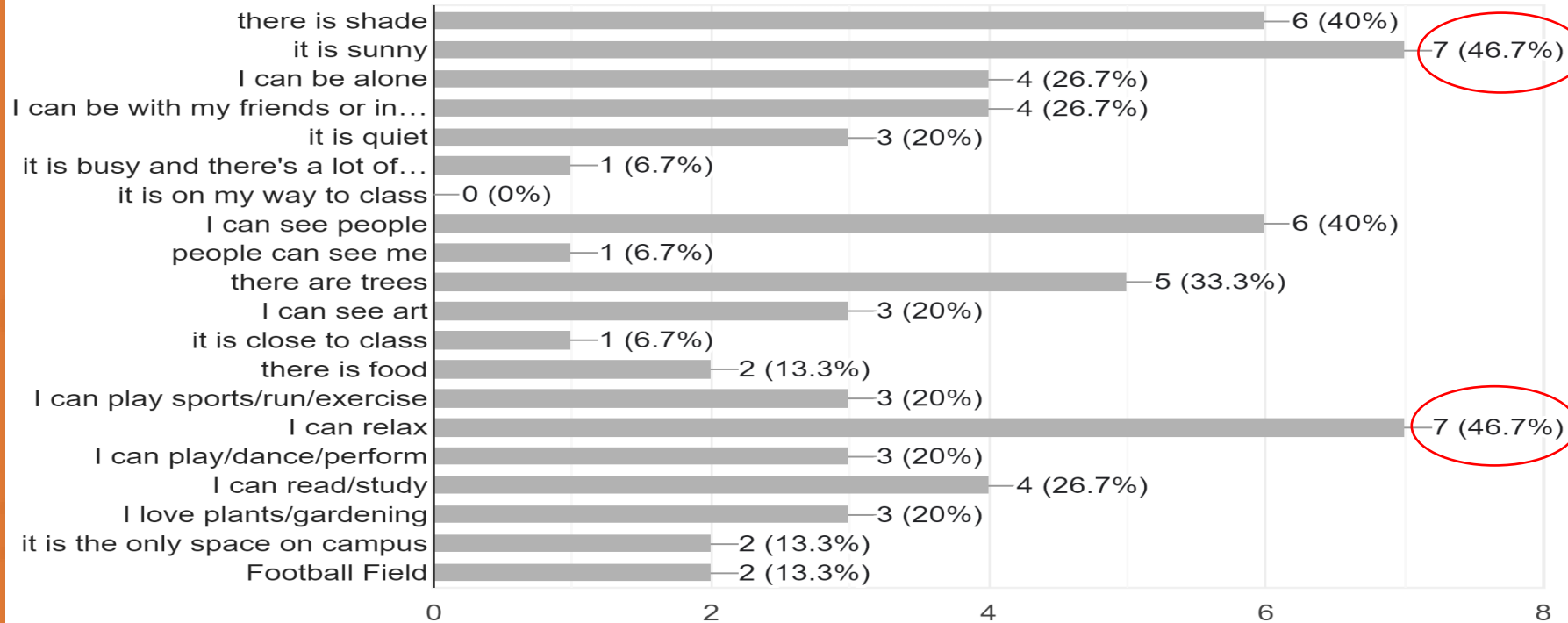

Survey/Tabling Results

Main Entry Points on Campus



- Main Front Entrance – Myrtle Street
- 28th Street Gate Entrance

Survey Results

Alumni Honorees

Alumni Honorees (Select the McClymonds Alumni you would like to see honored in the new school design)

23 responses

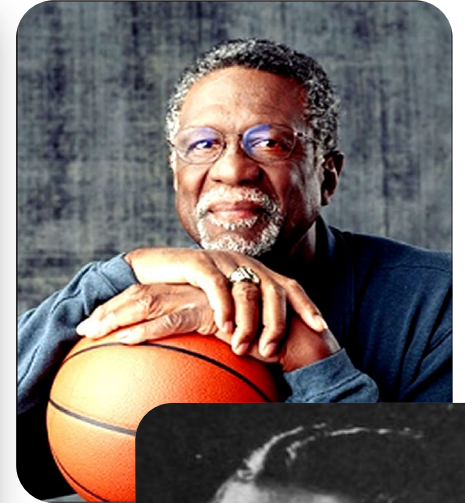
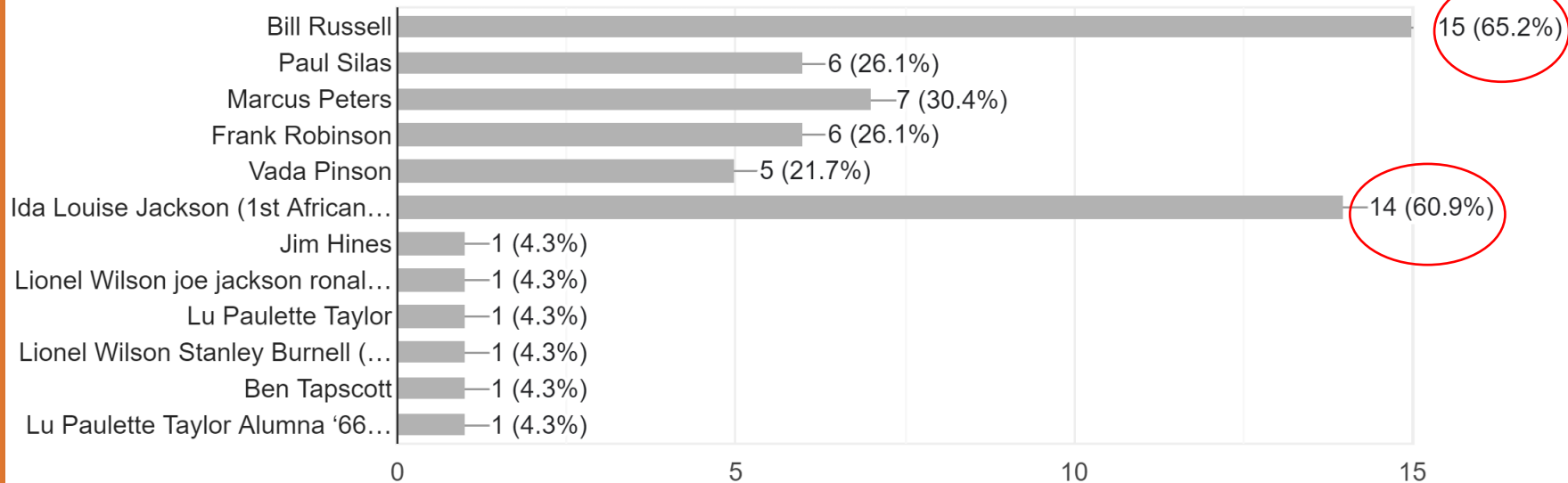

*Repeated Mentions: Ronald Dellums, Lionel Wilson, Lu Paulette Taylor, and Pete Escovedo

Next Steps

a. Continue Community Engagement

b. Schematic Design Updates

Next Project Advisory (PAC) Committee Meeting

Date: Tues, December 5, 2023 (1st Tues/Mo)

Time: 6pm

Location: McClymond's High School (Library) /

Zoom

