



**BOARD OF EDUCATION MEETING  
TUESDAY, SEPTEMBER 1, 2015  
JR./SR. HIGH SCHOOL AUDITORIUM – 5:30 P.M.**

**1. Meeting Call to Order**

- 1.1 Pledge to the Flag
- 1.2 Acceptance of Agenda
- 1.3 Executive Session – to discuss the employment of a particular person(s)
- 1.4 Student Council's 2015-2016 Plans – Ms. Viel with students: Shawn Essafi, Madison Cudhea, Jordyn Keeck-Beach, Brianna Fuccillo, Cassidy Albright
- 1.5 Capital Project Update – Hunt EAS - Jeffery Robbins, Lead architect and Chad Snowburg

**2. Communications**

- 2.1 From the Floor
- 2.2 President's Messages
  - a. Committee Report(s)
    1. Facilities Health & Safety Committee – D. Ross
    2. Policy Committee – J. Wroblecki
    3. Transportation Committee – R. Surprenant
    4. Survey Committee – T. Welch
  - b. Board Calendar – N/A
  - c. BOCES Representative Report – Dr. Porcelli, BOCES Board President

**3. Consent Agenda**

- 3.1 Board of Education Minutes for July 7, 2015
- 3.2 Business Office Reports for Month ending June 2015
- 3.3 CSE Reports
  - a. Minutes of Meeting held 5/28/15
  - b. Minutes of Meetings held 6/22/15
  - c. Minutes of Meeting held 7/1/15
  - d. Minutes of Meeting held 7/15/15
  - e. Minutes of Meeting held 7/23/15
  - f. Minutes of Meetings held 8/1/15
  - g. Minutes of Meeting held 8/13/15
  - h. Minutes of Meeting held 8/15/15
  - i. Minutes of Meetings held 8/20/15
  - j. Minutes of Meetings held 8/21/15

**4. Old Business – N/A**

**5. New Business**

- 5.1 Personnel Report – Action
- 5.2 Resolution to Set Tax Levy - Action
- 5.3 Resolution to Approve Substitute Rates - Action
- 5.4 Resolution to Approve Overnight Field Trip - Action
- 5.5 Building Use Request from PTSO for Craft Fair December 5 – 6, 2015 - Action
- 5.6 Resolution to Repeal June 2, 2015 Bus Acquisition and Purchase Bus – Action
- 5.7 Non-Resident/Non-Tuition Students Withdrawn
- 5.8 1<sup>st</sup> reading of Policy #4600, Use of District Credit Card; Regulation #4600.1, Request for Use of Credit Card; #4600.2, Expense Report for Credit Card
- 5.9 Resolution for Civil Service to Create 3 Temporary School Monitor Positions - Action
- 5.10 Transportation request to transport student to Notre Dame Jr. – Sr. High School - Action

## **6. Building Reports**

- 6.1 Elementary Building Report
  - a. Report Card Guide
  - b. Opening of School
- 6.2 Secondary Building Report
  - a. Opening Days
  - b. Parent Night

## **7. Superintendent's Report**

- 7.1 September 2 & 3, 2015 Superintendent Conference Days
- 7.2 K-12 Enrollment
- 7.3 2013-14 School Report Card
- 7.4 2015 Test Refusal Media Attention

## **8. Board Discussion**

## **9. Visitors Comments**

## **10. Executive Session**

## **11. Adjournment**

HUNT



# New York Mills UFSD Project Update 9/2/15

Hunt Engineers, Architects & Land Surveyors, PC

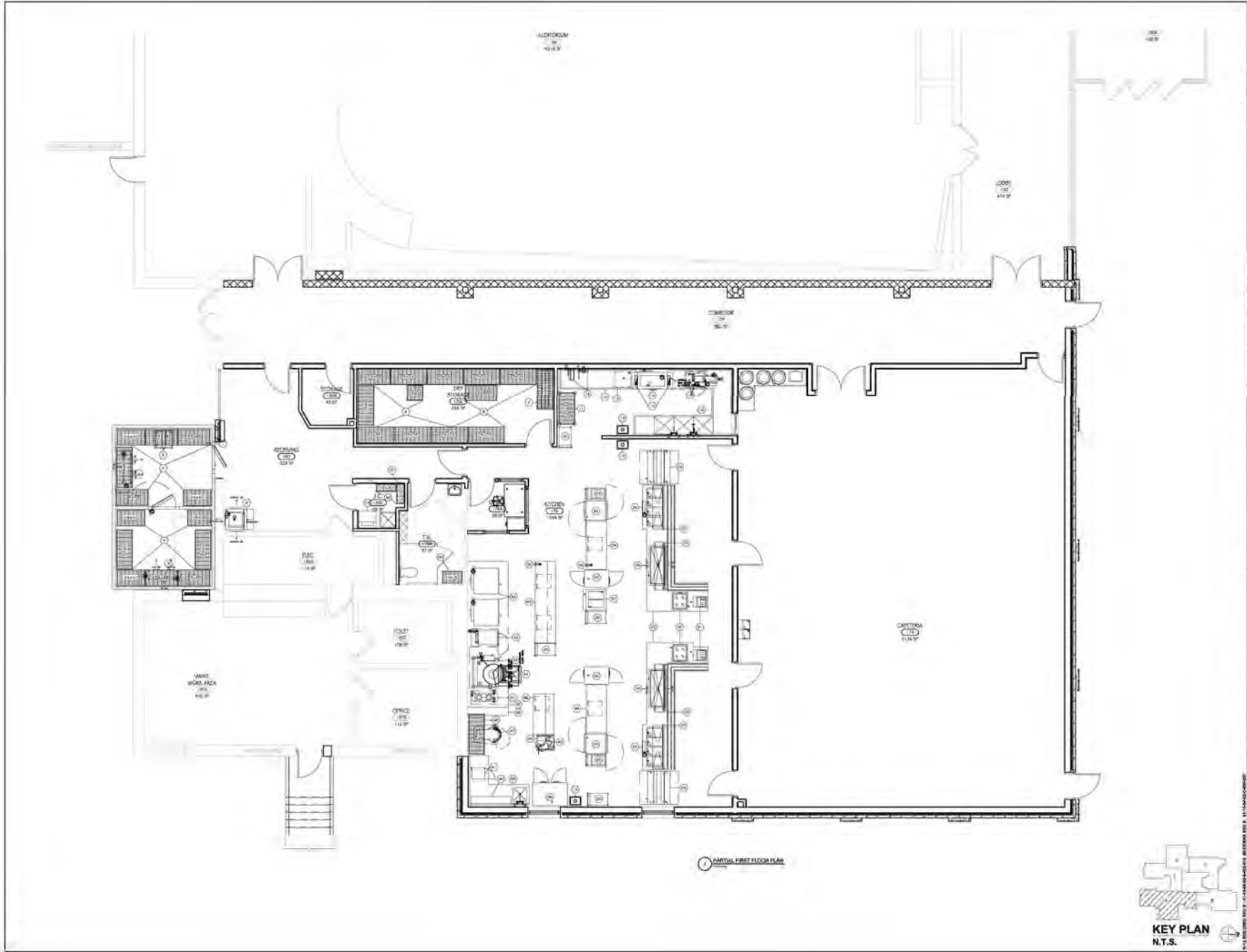

|                  |
|------------------|
| DATE: 01/15/15   |
| BY: JRM          |
| CHK: JRM         |
| APP: JRM         |
| PROJECT: 15-0015 |
| NO. 10-015       |
| SCALE: AS SHOWN  |

**HUNT**  
CONSTRUCTION BY

HUNTSVILLE, AL  
FAX: 205-890-1800  
TUSCALOOSA, AL

**PARTIAL FIRST FLOOR PLAN**  
**NEW YORK MILLS UNION FREE SCHOOL**  
**CAPITAL IMPROVEMENTS PROJECT**  
 NEW YORK MILLS, NEW YORK

**KEY PLAN**  
 N.T.S.

**A1.1**



**HUNT**  
ENGINEERS/ARCHITECTS/SURVEYORS





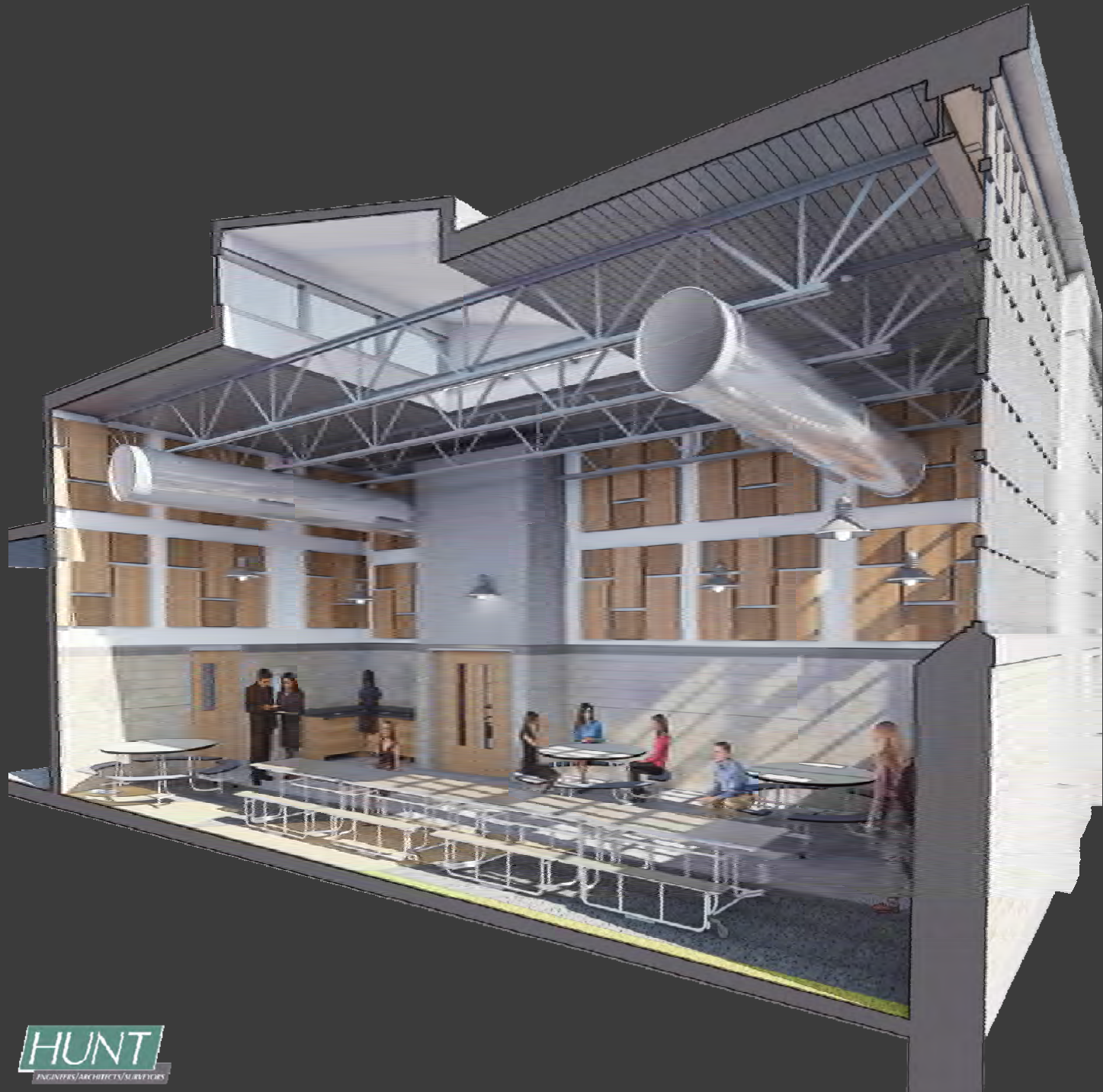











HUNT



HUNT



**BOARD OF EDUCATION**

**REORGANIZATIONAL MEETING MINUTES**

**TUESDAY, JULY 7, 2015**

**JR./SR. HIGH SCHOOL AUDITORIUM – 6:30 P.M.**

**PRESENT:** Ms. Jacqueline Edwards, Mr. Jonathan Fiore (82 Stratford F, 216 Andover Building, West Palm Beach, FL 33417), Mr. Steve King, Mr. Richard Ross, Mr. Rick Surprenant, Mrs. Traci Welch, and Mrs. Janet Wroblecki

**ALSO PRESENT:** Ms. Kathy Houghton, Mr. Michael Spost, Dr. René Wilson, Mrs. Lisa Stamboly, Mr. William Lachut, Mrs. Debbie Price, Mrs. Paula Ann May and 5 visitors and guests

**1. Meeting Call to Order**

Mrs. May called the meeting to order at 6:30 p.m.

**1.1 Pledge to the Flag**

Ms. Edwards led the Pledge of Allegiance.

**1.2 Acceptance of Agenda**

Ms. Edwards made the motion to accept the agenda seconded by Mr. King.

Yes 7 No 0  
Motion Carried.

**2. Reorganization Business**

**2.1 Administer Oath to Superintendent, Kathy Houghton**

**2.2 Administer Oath to new Board Member, Mrs. Janet Wroblecki**

**2.3 Election of Board President**

Mr. Fiore made the motion to nominate Ms. Edwards for Board President. Mr. Ross seconded the motion.

There were no other nominations.

Yes 7 No 0  
Ms. Edwards was declared  
Board President and Oath  
for Board President  
was administered

#### 2.4 Election of Board Vice President

Mr. Surprenant nominated Mr. King for Board Vice President. Mr. King seconded the nomination.

Mr. Fiore nominated Mr. Ross for Board Vice President. Mrs. Welch seconded the nomination.

There were no other nominations.

Roll Call Vote:  
Voting for Mr. Ross: Ms. Edwards,  
Mr. Fiore, Mrs. Welch, Mrs. Wroblecki

Voting for Mr. King:  
Mr. King and Mr. Surprenant

Mr. Ross 5 votes  
Mr. King 2 votes  
Mr. Ross was declared Board  
Vice President and Oath for  
Board Vice President was  
Administered

#### 2.5 2014-15 Internal Claims Auditor Report – Cheryl Radomski

Mrs. Radomski reported on claims she audited since April 2015. She asked to address the Board regarding the credit card payments.

Mr. Ross made the motion to go into Executive Session at 6:37 p.m. to discuss a particular person seconded by Mrs. Welch.

Yes 7 No 0  
Motion carried.

Ms. Edwards called the meeting back into Regular Session at 7:08 p.m.

## 2.6 Annual Board Appointments

Mrs. Wroblecki made the motion to approve 2.6.1 – 2.6.5 seconded by Mrs. Welch.

- 2.6.1 Clerk of the Board - Paula Ann May\*
- 2.6.2 District Treasurer – Lisa Stamboly\*
- 2.6.3 School Attorneys – Ferrara, Fiorenza PC
- 2.6.4 Central Treasurer, Extra Activities Account – Patricia Klimacek
- 2.6.5 Internal Claims Auditor – Cheryl Radomski

Yes 7 No 0  
Motion carried.

Mr. Fiore made the motion to approve 2.6.6 through 2.6.12 seconded by Mr. Ross.

- 2.6.6 Board Sub-Committees
  - a. Audit Committee – the Board As A Whole
  - b. Policy Review Committee: Mrs. Wroblecki Chair, Mr. Fiore and Mr. King
  - c. Facilities Health & Safety Committee: Mr. Ross Chair, Mrs. Welch and Mrs. Wroblecki
  - d. Transportation Committee: Mr. Surprenant Chair, Mr. Fiore and Mr. Ross
  - e. Survey Committee: Mrs. Welch Chair, Ms. Edwards and Mr. King
- 2.6.7 External District Auditor - Moore & Hart
- 2.6.8 403b Service Providers – OMNI Group Renewal Service Agreement
- 2.6.9 Financial Advisors – Bernard P. Donegan
- 2.6.10 Bond Council – Timothy McGill
- 2.6.11 School Physician – BOCES School Physician Service
- 2.6.12 R. Wilson, M. Spost Lead Evaluators for Teachers and K. Houghton Lead Evaluator for Principals and Teachers

Yes 7 No 0  
Motion carried.

Mrs. Wroblecki made the motion to approve 2.6.13 through 2.6.18 seconded by Mr. King.

- 2.6.13 Tax Collectors – Margaret Hardy, Whitestown;  
Oneida County Office of Finance, New Hartford
- 2.6.14 Authorization to Participate in the following Consortiums:
  - a. Central New York School Employees Workers Compensation Plan
  - b. Oneida-Herkimer-Madison Area Schools Property & Casualty Insurance Group

\*See Personnel Report



- c. Madison-Oneida-Herkimer Health Insurance Consortium
- d. Herkimer-Fulton-Hamilton-Otsego BOCES Disability Insurance Consortium
- 2.6.15 Committee on Special Education - Appoint
  - \*Kim Zogby Chairperson, Special Education Teacher
  - Barbara Bowen School Psychologist
  - BOCES School Social Worker
  - Patty Prince Parent Member
  - Barbara Piacenti Parent Member
  - BOCES School Physician Service
  - Child's Guidance Counselor
  - Child's Special Education and Regular Education Teacher(s)
- 2.6.16 Sub-Committee on Special Education for Elementary School and Junior-Senior High School - Appoint
  - Kim Zogby Chairperson, Special Education Teacher
  - Child's Guidance Counselor
  - Child's Special Education and/or Regular Education Teacher(s)
  - BOCES School Social Worker
  - Barbara Bowen - School Psychologist (when a new Psychological report is reviewed, or a more restrictive environment is being considered)
- 2.6.17 Committee on Special Education for Pre-School Education – Appoint
  - Kim Zogby Chairperson, Special Education Teacher
  - Barbara Bowen School Psychologist
  - BOCES School Social Worker
  - Barbara Piacenti Parent Member
  - BOCES School Physician Service
  - Preschool Special Teacher
  - Education Teacher of the child
- 2.6.18 District Specific List for Impartial Hearing Officers as maintained by the New York State Education Department Impartial Hearing Reporting System – On-Line

Yes 7 No 0  
Motion carried.

2.6.19 Resolution - New York Public Officers Law Section 18

Mrs. Wroblecki made the motion to approve the Resolution for the New York public Officers Law Section 18 seconded by Mr. Surprenant.

Yes 7 No 0  
Motion carried.

**2.6.20 Resolution Community/School Organizations: Music, Art and Drama Boosters, Marauder Athletic Booster Club, School District Foundation, and Parent-Teacher-Student Organization**

Mr. Surprenant made the motion to approve the Community/School Organizations seconded by Mrs. Welch. Mr. King will remain the liaison to the Foundation.

Yes 7 No 0  
Motion carried.

**2.6.21 2015-16 Tuition Rate - 100% of the State Education Department Formula (Currently estimated K-6 – \$6,569; 7-12 – \$15,719, subject to change in November)**

Mr. King made the motion to set the Tuition rate currently estimated at K-6 – \$6,569; 7-12 – \$15,719, subject to change in November seconded by Mr. Surprenant.

There was much discussion about changing the tuition rate. Mr. Fiore suggested the Board Members revisit this in November so they would have time to research the topic further but in the meantime use the rate set by the State Education Department.

Yes 7 No 0  
Motion carried.

**2.6.22 Day and Time of Monthly Meetings (see insert)**

Mr. Surprenant made the motion to approve the following dates and time of the 2015-16 Board of Education Meetings seconded by Mr. King:

July 7, 2015 – Reorganizational and Business 6:30 p.m.  
Tuesday, August 18, 2015  
Tuesday, September 1, 2015  
Tuesday, October 6, 2015  
Tuesday, November 3, 2015  
Tuesday, December 1, 2015  
Tuesday, January 5, 2016  
Tuesday, February 2, 2016  
Tuesday, March 1, 2016 – Budget Workshop  
Tuesday, March 15, 2016 – Budget Workshop  
Tuesday, April 5, 2016 – Adopt Budget for Vote  
Tuesday, April 19, 2016 – Vote for BOCES Budget & Board Members  
Tuesday, May 3, 2016 – Public Budget Hearing

Tuesday, May 17, 2016 – Budget Vote and Board Election – Noon – 9:00 p.m.

Tuesday, June 7, 2016

All meetings begin at 6:30 p.m. unless otherwise noted

Yes 7 No 0  
Motion carried.

Mrs. Welch made the motion to approve 2.7.1 through 2.7, seconded by Mrs. Wroblecki.

2.7 Annual Board Designations:

2.7.1 Official Bank Depository – M&T Bank and Citizens Bank

2.7.2 Investment Banks: Any bank deemed profitable by the District Treasurer

2.7.3 Authorized Signatures on Checks: School Treasurer and Superintendent of Schools

2.7.4 Authorize Signatures on Extra-Curricular Activities Account – Jr. Sr. High School Principal, Central Treasurer Extra Activities Account, and Superintendent's Secretary

2.7.5 Authorize Wire Transfers Up To \$2 million with the exception of Serial Bond Payments – District Treasurer

2.7.6 Budget Transfers authorization Superintendent of Schools or Treasurer as their designee

Yes 7 No 0  
Motion carried.

2.7.7 Authorization Use of Credit Cards: Kathy Houghton, Michael Spost, René Wilson, Paula Ann May, Jacqueline Edwards, Jonathan Fiore, Steve King, Rick Surprenant, Richard Ross, Traci Welch, Mrs. Janet Wroblecki

Mr. Ross made the motion for Ms. Houghton to be the only authorized user of the Credit Cards seconded by Mr. Surprenant.

Yes 7 No 0  
Motion carried.

Mr. King made the motion to approve 2.7.8 and 2.7.9 seconded by Mrs. Welch.

2.7.8 Official Newspaper - Utica Observer Dispatch

2.7.9 Medicaid Compliance Officer – Kim Zogby

Yes 7 No 0  
Motion carried.

Mr. King made the motion to approve 2.8.1 through 2.8/9 seconded by Mrs. Wroblecki

2.8 Annual Authorizations

- 2.8.1 Certification of Payroll – Superintendent of Schools
- 2.8.2 Establishment of Petty Cash Funds: High School - \$100, Elementary - \$100, District Office - \$100
- 2.8.3 Purchasing Agent – Lisa Stamboly, School Treasurer
- 2.8.4 Superintendent or his/her designee be authorized to make transfers of appropriations within the budget of each program or service per board policy
- 2.8.5 Authorization for participation and payment of dues:
  - School Boards Institute
  - NYS School Boards Association
  - Association for School Business Organization
  - New York State Council Of School Superintendents
- 2.8.6 Superintendent Conference Approval (local, state and national)
- 2.8.7 Mileage reimbursement rate: IRS reimbursement rate
- 2.8.8 Staff/curriculum Development \$22 per hour and Tutorial and Home Bound Instruction \$25 per hour
- 2.8.9 Substitute Teacher pay Rate: \$80/day for certified teacher and \$60/day for uncertified

Yes 7 No 0  
Motion carried.

- 2.8.10 Fees for Varsity Football and Boys & Girls Basketball Games
  - \$2 per adult
  - Ticket taker/seller \$10/hour
  - Clock/timer \$25/game
  - Announcer \$20/game
  - Site Supervisor \$20/hour
  - Shot Clock \$20/game

Mr. Ross made the motion to approve the fees for Football and Basketball but all students will be free seconded by Mrs. Wroblecki.

There was discussion about not charging students.

Yes 6 No 1  
Mr. Surprenant  
is not in Favor.  
Motion carried.

Mr. King made the motion to approve 2.8.11 through 2.18.17 seconded by Mrs. Welch.

- 2.8.11 Records Retention Officer - Paula Ann May
- 2.8.12 Records Access Officer - Paula Ann May

- 2.8.13 Asbestos LEA Designee – William Lachut
- 2.8.14 Civil Rights, Title IX, ADA Coordinator and Sexual Harassment Compliance Officer – Superintendent of Schools or Designee
- 2.8.15 Elementary Dignity Act Coordinator – R. Wilson
- 2.8.16 Jr. Sr. High School Dignity Act Coordinator – M. Spost
- 2.8.17 Pesticide Application for emergencies

Yes 7 No 0  
Motion carried.

## 2.9 Bonds

Mr. King made the motion to approve 2.9.1 through 2.9.3

- 2.9.1 District Treasurer, Lisa Stamboly - \$1,000,000
- 2.9.2 District Clerk, Paula Ann May - \$100,000
- 2.9.3 Central Treasurer, Patricia Klimacek - \$1,000,000

Yes 7 No 0  
Motion carried.

Mrs. Welch made the motion to approve 2.10 through 2.18 seconded by Mrs. Wroblecki.

- 2.10 Readoption of Board Policies and Code of Ethics
- 2.11 Recertify Shared Decision Making Plan
- 2.12 Board Presidential Appointments
  - 2.12.1 School Board Institute Executive Committee – J. Edwards, and J. Wroblecki
- 2.13 Career & Technical Education Advisory Council - BOCES Council
- 2.14 District Safety Plan
- 2.15 District Strategic Plan
- 2.16 Professional Development Plan
- 2.17 BOCES Cooperative Bids - Authorization for Participation Therein
- 2.18 Mass Care Facility Usage - Authorization for Superintendent to Commit School District
  - 2.18.1 Army Reserve
  - 2.18.2 American Red Cross

Yes 7 No 0  
Motion carried.

## 3. Consent Agenda

Mrs. Welch made the motion to approve the Consent Agenda seconded by Mr. Fiore.

- 3.1 Minutes of Meeting held June 2, 2015
- 3.2 Business Office Reports for Month ending May 2015

**3.3 CSE Reports**

- a. Minutes of meeting held 5/28/15
- b. Minutes of meeting held 6/4/15
- c. Minutes of meeting held 6/8/15
- d. Minutes of meeting held 6/11/15
- e. Minutes of meetings held 6/15/15

Yes 7 No 0  
Motion carried.

**4 Old Business**

- 4.1 2<sup>nd</sup> reading of Policy 1004, Service Animals; 5300, Acceptable Use Policy; Regulation 5300.1, Agreement for Employee Use Of District Information Technology Resources; 5300.2, Agreement For Student Use Of District Information Technology Resources; Policy 5301, Internet Safety Policy; 6200, Fingerprinting and Criminal History Record Checks For Prospective Employees – Action

Mrs. Welch made the motion to approve the second reading of the Policies seconded by Mr. Fiore.

Yes 7 No 0  
Motion carried.

- 4.2 Resolution to Ratify Terms and Conditions of Teacher Assistant Position – Action

Mr. Ross made the motion to approve the following Resolution seconded by Mr. King:

The New York Mills Union Free School District Board of Education ratifies the addition to the 2008-2012 Agreement between New York Mills School District and the New York Mills Teachers Association – Terms and Conditions of Teacher Assistant Position and authorizes the Superintendent of Schools to sign the “Memorandum of Agreement for Amendment of the Parties’ 2012-2016 Collective Bargaining Agreement” ratified by New York Mills Teachers Association on May 7, 2015.

Yes 7 No 0  
Motion carried.

**5. New Business**

- 5.1 Personnel Report –

Mr. Ross made the motion to approve the following Personnel Report seconded by Mr. Surprenant:

**I. Board Appointments**

|                |                                      |             |                     |
|----------------|--------------------------------------|-------------|---------------------|
| May, Paula Ann | District Clerk                       | \$3,500.00  | 2015-16 School Year |
| Zogby, Kim     | Committee on Special Education Chair | \$3,800.00  | 2015-16 School Year |
| Stamboly, Lisa | District Treasurer                   | \$80,766.00 | 2015-16 School Year |

**II. Resignation**

|                  |                            |   |           |
|------------------|----------------------------|---|-----------|
| Millis, Brittney | Teacher Assistant          | Y | 8/31/2015 |
| Ricco, Anthony   | Varsity Football           | C | 6/19/2015 |
| Futscher, James  | Assistant Varsity Football | T | 6/30/2015 |
| Ricco, Ross      | Assistant Varsity Football | C | 6/19/2015 |

**III. Summer Bus Appointments**

|                   |  |                                    |   |
|-------------------|--|------------------------------------|---|
| Kurgan, John      | 1.5 hrs. AM run, 1.75 hrs. PM run<br>Total 16.25 hrs./week | Per CSEA Contract<br>\$17.70/hour  | July 6 - August 14<br>Mon. - Friday                                     |
| Miller, Doug      | 1.5 hrs. AM run, 1.5 hrs. PM run<br>Total 15/week          | Per CSEA Contract<br>\$17.70/hour  | July 13 - August 12<br>Mon. - Thurs                                     |
| Boccardo, Michael | 1.5 hrs. AM run, 1.5 hrs. PM run<br>Total 15 hrs./week     | Per CSEA Contract<br>\$17.69/hour  | July 13 - August 12<br>Mon. - Thurs                                     |
| Furmanski, Tom    | 7.0 hrs. Friday/Sunday<br>Total 14 hours/week              | Per CSEA Contract<br>\$17.87/hour  | July 6 - August 14<br>Friday/Sunday<br>(unless calendar says different) |
| Soja, Lisa        | 1.25 hrs. AM/ 1.5 hrs. PM<br>total 13.75 hrs. /week        | Per CSEA Contract<br>\$12.76/hour  | July 6 - August 14<br>Mon. - Friday                                     |
| Edwards, Bernice  | 6.5 hours Friday   | Per CSEA Contract<br>\$12.68 /hour | July 6 - August 14<br>Friday/Sunday<br>(unless calendar says different) |

|                   |                  |                                      |  |
|-------------------|------------------|--------------------------------------|--|
| Stockton, Ronnell | 6.5 hours Sunday | Per CSEA<br>Contract<br>\$12.68/hour | July 6 - August 14<br>Friday/Sunday<br>(unless calendar<br>says different) |
|-------------------|------------------|--------------------------------------|--|

#### IV. Non-Instructional Long-Term Substitute Appointment

|                         |                        |   |              |                        |
|-------------------------|------------------------|---|--------------|------------------------|
| Fatata, Neil            | Cleaner                |   | \$12.68/hour | 7/1 - 8/31/15          |
| Brockett, Connie        | Spanish 7-12           | Y | \$80.00      | 9/1/2015               |
| Dziekhan, Andrea        | Varsity Club           | Y | \$1,093.00   | 2015-16 School<br>Year |
| Shrey, Steve            | Extra Music Activities | Y | \$11,740.50  | 2015-16 School<br>Year |
| TBD                     | 6th Grade Advisor      |   | \$941.00     | 2015-16 School<br>Year |
| Jennings,<br>Alexandria | JV Field Hockey        | T | \$2,427.00   | 2015-16 School<br>Year |
| Parrish, Ciara          | Football Cheerleading  | T | \$1,504.50   | 2015-16 School<br>Year |

Yes 7 No 0  
Motion carried.

#### 5.2 2015-16 BOCES Contract – Action

Mr. Ross made the motion to approve the 2016-16 BOCES Contract seconded by Mr. Surprenant.

Yes 7 No 0  
Motion carried.

#### 5.3 Resolution to Approve Bus Lease – Action

Mr. Ross made the motion to approve the following resolution seconded by Mr. Surprenant:

**Be It Resolved:** the New York Mills Board of Education has agreed to lease two (2) 70 passenger school buses at a capitalized cost of \$112,341.82 each.



**Whereas:** the New York Mills Board of Education gives the School District Treasurer the authority to make five (5) equal payments of \$16,847.00 each due on the 15<sup>th</sup> day of July from the year 2015 through 2019 to the low bidder, Santander.

**Therefore:** the New York Mills Board of Education authorizes the School District Treasurer to issue checks to cover the cost of these buses

Yes 7 No 0  
Motion carried.

5.4 Request for School Bus for the Summer Recreation Program from the Village of New York Mills – Action

Mrs. Welch made the motion to approve the request for use of a School Bus from the Village of New York Mills for their summer Recreation Program.

Yes 7 No 0  
Motion carried.

5.5 Non-Resident/Non-Tuition Students

Mr. King made the motion to approve the following Non-Resident/Non-tuition students seconded by Mr. Ross:

| <b>NAME</b>    | <b>GRADE</b> | <b>PARENT</b> |
|----------------|--------------|---------------|
| Galime, Lena   | K            | Jody Galime   |
| Clements, Emma | 6            | Mary Clements |

Yes 7 No 0  
Motion carried.

5.6 Excess list for bid, sale, or disposal of – Action

Mr. King made the motion to excess the following non-working items seconded by Mrs. Welch:

Osterizer Blender  
Hamilton Beach Electric Can Opener

Yes 7 No 0  
Motion carried.

**6. Building Reports – N/A**

**7 Superintendent's Report – N/A**

**8. Board Discussion**

Ms. Edwards read a letter from William Miller asking for our support as second vice president for NYSSBA.

Mrs. Wroblecki made the motion to write a letter supporting Mr. Miller to be Second Vice President of NYSSBA seconded by Mr. Fiore.

Yes 7 No  
Motion carried.

Ms. Edwards presented Mr. King with a Certificate from School Boards Institute for 45 hours of Professional Achievement and Ms. Houghton with a Certificate for 75 Hours of Professional Achievement.

**9. Visitors Comments**

Mrs. Porcelli said that Joe Bonamassa will be playing at the Saratoga Perform Arts on August 10<sup>th</sup>.

Mr. Lachut said regarding the ticket sales his spouse is a ticket taker and she always would tell him that the only people that complain are the people from other districts. There are never complaints from our parents or students. He said he was interested as to why we collect for basketball and football but not for Field Hockey, Bowling or Golf. He likes the idea of our students going free.

IDs will be needed to identify our students.

Mrs. Price said that she paid \$5 for her children's ID. It comes in handy for when they get their Learner's Permit.

Mrs. Wroblecki suggested maybe we could work something out with the Sheriff's Office.

**10. Executive Session**

Mr. Ross made the motion to go into Executive Session to discuss a particular person at 8:02 p.m. after taking a 5-minute break seconded by Mrs. Welch.

Yes 7 No 0  
Motion carried.

Ms. Edwards appointed Ms. Houghton the Clerk Pro-tem.

Respectfully submitted,



Paula Ann May  
District Clerk

Ms. Edwards called the meeting back into regular session at 9:09 p.m. stating that Mr. Fiore exited the meeting at 8:31 p.m.

#### **11. Adjournment**

Mr. King made the motion at 9:10 p.m. to adjourn seconded by Mrs. Welch.

Yes 6 No 0  
Meeting Adjourned.

Respectfully submitted,

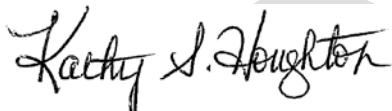

Kathy Houghton  
Clerk Pro-tem

Clicking on the **X** will export the data to Excel. Clicking on the Graph Icon  will display the bar graph below.

| Statistics   |            |
|--|------------|
| Student Type  | # Students |
| School-age Special Ed  | <u>85</u>  |
| Preschool Special Ed   | <u>6</u>   |
| 504 Student  | <u>34</u>  |
| Total  | <u>125</u> |

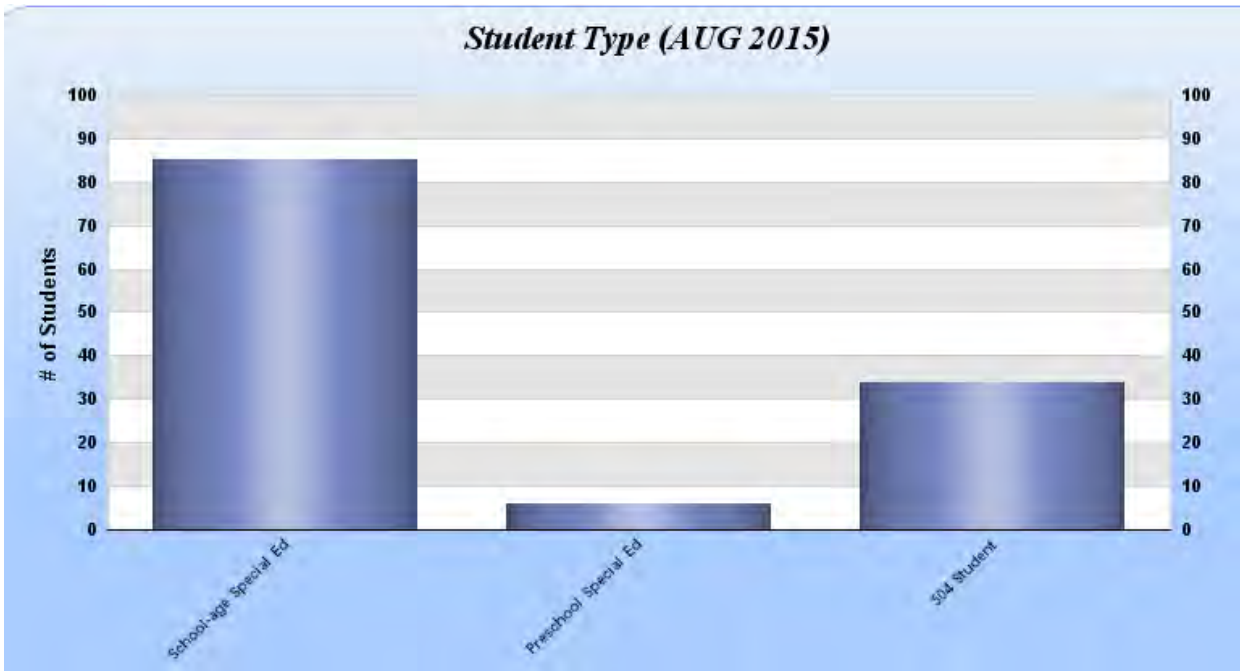



**RESOLUTION TO SET TAX LEVY**

**BE IT RESOLVED** that the New York Mills Board of Education authorizes the School Business Official to collect taxes in the amount of \$3,835,899.31 from the town of New Hartford and \$3,645,275.69 from the town of Whitestown totaling \$7,481,175.00

**THEREFORE**, the tax rate for the 2015-16 school year will be \$27.36 per one thousand dollar of assessed value for the Town of New Hartford and \$32.44 per one thousand dollar of assessed value for the Town of Whitestown.

- Motion:
- Second:
- Yes:
- No:

~~~~~

*This represents 2.93% increase for the Town of New Hartford and a -.02% decrease in Whitestown*



## **Resolution to Approve Substitute Rates**

**Be It Resolved** that the New York Mills Union Free School District Board of Education approve the following substitute rates:

Teachers: Certified \$80.00/day  
                  Uncertified \$60.00/day  
Curriculum: \$22.00/hour  
Tutor: \$25.00/hour  
Teaching Assistant: \$60.00/day  
Nurse: \$16.00/hour  
Bus Drivers: \$13.00/hour  
Clerical: \$10.50/hour  
School Monitors: \$8.75/hour  
Maintenance: \$8.75/hour

Motion\_\_\_\_\_

Second\_\_\_\_\_

Vote\_\_\_\_\_



**RESOLUTION TO APPROVE OVERNIGHT FIELD TRIP**

**BE IT RESOLVED** upon the recommendation of the Superintendent of Schools, the New York Mills School District approves an Overnight Field Trip for the Boys & Girls Varsity Basketball Teams to attend and play in the Coaches vs Cancer in Glens Falls/Lake George, New York on December 4-5, 2015.

Motion  
Second  
Vote

55

NEW YORK MILLS UNION FREE SCHOOL DISTRICT  
BUILDING USE APPLICATION FORM  
By Community Groups

Organization PTSO Date Desired Dec 4<sup>th</sup> 5<sup>th</sup> 6<sup>th</sup> 2015

Room(s) of building desired (including dressing rooms, etc.)  
Entire Building including Kitchen and Cafeteria

Which building Main Building Expected Attendance 2000  
Friday Dec 4<sup>th</sup> 2pm until Sun Dec 6<sup>th</sup> @ 8pm

Duration of use from \_\_\_\_\_ A.M./P.M. to A.M./P.M. (cross out A.M., P.M.)  
(If time is needed in getting ready for activity, include that in above)

Are Lights To Be Used yes

Purpose of Use CRAFT FAIR

Please check the following you will need supplied:

\_\_\_\_\_ Microphone \_\_\_\_\_ Footlights \_\_\_\_\_ Spotlight

Other - List: \_\_\_\_\_

The undersigned agrees to accept responsibility to repair or replace any damage to equipment.

[Signature]  
Signature of Responsible Person

7/14/15  
Date

413 CALDWAY AVE YONKVILLE  
Address

520-4869  
Telephone Number

Admission Charge X Yes \_\_\_\_\_ No

Insurance Liability Form Provided \_\_\_\_\_ Yes \_\_\_\_\_ No

NOTE: FILLING OUT THIS APPLICATION DOES NOT MEAN THAT YOU ARE ENTITLED TO THE USE OF THE BUILDING. DO NOT ADVERTISE OR PLAN DEFINITELY ON USING THE BUILDING UNTIL THIS APPLICATION HAS BEEN APPROVED AND RETURNED TO YOU.

(OVER)





### **Resolution to Repeal Bus Acquisition and Purchase Bus**

The expenditure of \$116,680.57 from General Fund for the purchase of bus is hereby authorized, and the previously approved Board authorization for such purpose, adopted by bond resolution, dated June 2, 2015 is hereby rescinded and repealed and is supplanted by this authorization.

**NEW YORK MILLS SCHOOL DISTRICT  
2015-16  
NON-RESIDENT/NON-TUITION STUDENTS**

| <b>NAME</b>       | <b>GRADE</b> | <b>PARENT</b> |
|-------------------|--------------|---------------|
| Camello, Angelina | 3            | Lisa Camello  |
| Camello, John     | 9            | Lisa Camello  |

*Language in both contracts allows the privilege for employees' children to attend our school district tuition free when they are non-residents.*

FISCAL MANAGEMENT

USE OF DISTRICT CREDIT CARD

- I. District issued credit cards shall be used prudently and **only** for official school business. Credit cards are District property.
- II. The Superintendent shall be issued a District credit cards. In limited circumstances, the Superintendent may designate ~~the issuance of a credit card to a user of the credit card~~ other employees or Board of Education Members to assist with their job responsibilities. No individual is authorized to utilize the District credit card without the prior authorization of the Superintendent (Regulation 4600.1).
- III. The District shall establish an annual credit line maximum not to exceed \$25,000.
- IV. Accountability
  - A. Credit card users must submit expense reports (Regulation 4600.2) timely immediately so that expenses incurred on each credit card shall be paid in such a manner as to avoid interest charges. All credit cards are to be stored in a secure manner.
  - B. Any expense paid with the credit card shall be documented by both a vendor receipt, describing in reasonable detail the good or service received, and a credit card receipt. In the case of an online purchase, a confirmation or receipt must be printed at the time of purchase and provided to the Business Office.
- V. Use of the school credit cards signifies acceptance of and adherence to all school policies.
  - A. Unauthorized, unreasonable, or personal use of the credit card will require that the user repay to the District the amount charged in full, and any resulting fees and charges.
  - B. Unauthorized, unreasonable or personal use of the credit card may result in the credit card being revoked and/or disciplinary action up to and including legal action.

---

New York Mills Union Free School District

Cross Ref: 4600.1, Request Form to Use Credit Card  
4600.2, Expense Report for Credit Card

Adopted: 02/07/06  
Revised: 01/03/12, \_\_\_\_\_  
Reviewed: 09/02/14

# New York Mills Union Free School District

## REGULATION

Draft 08/27/2015

FISCAL MANAGEMENT

4600.1

### REQUEST FORM TO USE CREDIT CARD

Name: \_\_\_\_\_

Title: \_\_\_\_\_

Date(s): \_\_\_\_\_

Purpose: \_\_\_\_\_

Estimated expenses:

Expense

Amount

\_\_\_\_\_  
\_\_\_\_\_  
\_\_\_\_\_  
\_\_\_\_\_

\_\_\_\_\_  
\_\_\_\_\_  
\_\_\_\_\_  
\_\_\_\_\_

Total Estimated Expenses: \_\_\_\_\_

Budget Code: \_\_\_\_\_

\_\_\_\_\_  
Signature

\_\_\_\_\_  
Date

\*\*\*\*\*

Approved: \_\_\_\_\_

Disapproved: \_\_\_\_\_

\_\_\_\_\_  
Superintendent Signature

\_\_\_\_\_  
Date

Approved by the Superintendent OR Adopted:

Comments:

# New York Mills Union Free School District

## REGULATION Draft 08/27/2015

FISCAL MANAGEMENT

4600.2

### EXPENSE REPORT FOR CREDIT CARD

Name: \_\_\_\_\_

Title: \_\_\_\_\_

Address: \_\_\_\_\_

Budget Code: \_\_\_\_\_

### **EXPENSES (Itemized receipts must be attached)**

| Date | Description/Reason/Location( Be specific) | Total \$ |
|------|-------------------------------------------|----------|
|      |                                           |          |
|      |                                           |          |
|      |                                           |          |
|      |                                           |          |
|      |                                           |          |

Grand Total \_\_\_\_\_

I certify that the above claim is accurate and that these charges were incurred in the performance of New York Mills Union Free School District responsibilities. I further certify that any claims submitted herein are in conformance with the criteria established by policy #4600.

Date: \_\_\_\_\_

Signature \_\_\_\_\_

\*\*\*\*\*

Approved: \_\_\_\_\_

Disapproved: \_\_\_\_\_

\_\_\_\_\_  
Superintendent Signature

\_\_\_\_\_  
Date

Approved by the Superintendent OR Adopted: \_\_\_\_\_

Comments:



**Resolution to Create Three Temporary School Monitor Positions**

Be it resolved that the New York Mills U.F.S.D. Board of Education create three (3) temporary School Monitor positions not to exceed 7 hours per day from September 1, 2015 through October 7, 2016 for Oneida County Department of Civil Service.

## Purpose of Elementary Report Card



- To communicate your child's achievement in relation to learning standards. Now each of the subject areas is further expanded by a list of skills and knowledge students are responsible for learning.
- Feedback is more detailed to parents regarding your child's progress giving a clearer picture of your child's strengths and weaknesses.
- It is a step toward more authentic assessment and reporting

Note: performance level is based on the units of study and concepts and skills taught for that trimester. It is quite possible for a child to achieve a 3 or 4 the first trimester and then a 2 the next.



## New York Mills Union Free School District

1 Marauder Blvd  
New York Mills, NY 13417  
Phone: 315.768.8129

## New York Mills Elementary School

### Report Card Guide



## Encouraging Students to Pursue Excellence

## NYM Report Card Guide

### New This Year

The New York Mills Elementary School faculty and staff are thankful to our families and the community for their support which allows us to provide a quality academic experience for students. We are committed to ensuring that students are well prepared for the future. Providing a clear, complete communication tool is the main goal of our 2015-2016 report card, which is a hybrid of a standards based and traditional grading model. The new report cards will include information in all academic areas in a trimester system. It is our hope that new report cards, together with teacher conferences, will provide a more comprehensive and meaningful way for you to understand and support your child's learning. If you have any questions please do not hesitate to contact me.

-René Wilson

Elementary Principal

### What's Different?

Our new report card is aligned to the New York State Learning Standards and reflects updates in our curriculum and instruction.

Parents will find:

- Category titles and descriptors reflecting the NYS and district learning standards
- Grading keys for K-6<sup>th</sup> grades reflecting student progress towards the standards (4-1 scale)
- For grades 2-6 an overall percentage in core content areas ranging from 0-100 percent.
- Learning behaviors reflecting student skills necessary to be a successful learner
- Reporting Periods: you will receive your child's report card in December, March, and June. Parent-Teacher conferences are held in December. Please refer to the district calendar for specific dates.

### Performance Levels

4: Exceeds the learning standard. Consistently demonstrates a thorough in-depth knowledge and understanding and application of extended concepts, skills and standards. Performance is characterized by self-motivation and ability to apply skills with consistent accuracy and independence and high level of quality.

3: Meets the learning standards. Student performance demonstrates an understanding of the knowledge and skills expected. Student demonstrates consistent application of skill. Student independently applies the standards.

2: Partially meets the learning standards. Student performance demonstrates a partial understanding of knowledge and skills expected. Student is progressing toward understanding; however the skills are not yet mastered. Student needs assistance to use standards.

1: Does not meet the learning standards. Student performance does not demonstrate an understanding of the knowledge or skills expected. Student is working below expectation. Student needs continued support and struggles even with assistance, needs intervention.





71

1 Marauder Boulevard  
New York Mills, NY 13417

Kathy S. Houghton  
Superintendent of Schools

Tel: (315) 768-8127  
Fax: (315) 768-3521  
E-mail: [khoughton@newyorkmills.org](mailto:khoughton@newyorkmills.org)

August 21, 2015

Dear Faculty and Staff,

I hope that you have been enjoying this beautiful summer with your family and friends. As usual, many people have been hard at work in the district during the last eight weeks; interviewing and recommending new staff to the Board, attending trainings, completing curriculum work, attending CSE meetings, finalizing schedules, checking in supplies and textbooks, beginning athletic practices for fall sports, and preparing the buildings and grounds for the new school year. I have enjoyed seeing and talking to some of you as you attended meetings, workshops, Computer Camp, worked in your classrooms, or when you just stopped in to say hello (some of you with your beautiful children in tow!). Thank you for all you do in the summer to set the stage for student success when September comes. Many people have no idea that teachers and staff are still focused on education during the summer months; we know better!

My summer learning included a Leadership Research Institute with area superintendents, and a subsequent workshop with our building principals. Our time together included small and large group discussions about The Coming Jobs War, a book by Jim Clifton, the Chairman of Gallup. The main premise of the book is that everyone hopes for a good job more than anything else in this world; therefore, countries, cities, communities, and schools must focus their efforts on the creation of good jobs as a top priority if the U.S. is to maintain its place as a world leader. Chapter 10 of the book is titled, "K-12 Schools – Where Entrepreneurs are Created." It includes a Gallup student poll that can be used to assess grades 5-12 economic behavioral metric, i.e. their personal levels of hope for their future. I encourage you to explore the book (or at least chapter 10), the student poll, and the general concepts for yourself to see if they resonate for you; they certainly captured my attention. If you are interested in reading The Coming Jobs War, your principals and I each have a copy.

I also spoke with the media multiple times this summer; including The New York Times, The Syracuse Post-Standard, and our own Utica Observer-Dispatch, WKTV, and WUTR on behalf of the Board of Education and school district. The majority of these interviews centered on our high percentage of test refusals, the grades 3-8 New York State assessment results, and the Board's "Resolution to Oppose High Stakes Testing". If you are interested in reading The New York Times or Syracuse stories, I've provided the links to them below:

<http://www.nytimes.com/2015/08/15/nyregion/new-york-state-exam-refusals-make-analyzing-data-difficult.html?ref=education>

[http://www.syracuse.com/schools/index.ssf/2015/08/why\\_did\\_nys\\_test\\_opt\\_out\\_numbers\\_vary\\_so\\_much\\_it\\_came\\_down\\_to\\_parents\\_organizing.html](http://www.syracuse.com/schools/index.ssf/2015/08/why_did_nys_test_opt_out_numbers_vary_so_much_it_came_down_to_parents_organizing.html)

Our new Commissioner of Education, MaryEllen Elia visited Utica earlier this week and I was asked to take part in a group meeting with her to discuss current educational issues: the

Common Core Curriculum, NYS assessments, test refusals, APPR (Annual Professional Performance Review Plan), requests for hardship waivers, the effectiveness of the Special Education inclusionary model, and the impact of the tax cap were some of the topics we covered. I will share more about this meeting at our upcoming Superintendent's Conference Days in a few weeks.

Attached are general agendas for our Wednesday, September 2<sup>nd</sup> and Thursday, September 3<sup>rd</sup> Superintendent Conference Days. Please see your building principal or immediate supervisor for specific instructions if you are unsure of which meeting(s) you should attend. All faculty and staff will attend the first day; the second day is for faculty only as we will focus on instructional planning and required changes to our Annual Professional Performance Review Plan for teachers and principals. On both mornings, a continental breakfast will be available at 7:30 a.m. and we will start promptly at 8:00 a.m. in the auditorium. Lunch will be provided on both days as well so that we may continue the flow of work and learning throughout both days. Following the completion of our required trainings and organizational meetings on September 2<sup>nd</sup> and 3<sup>rd</sup>, school will begin for students on the following Tuesday, September 8<sup>th</sup>. Have a wonderful Labor Day weekend prior to the big day!

I look forward to seeing you on the morning of Wednesday, September 2<sup>nd</sup> for our first Superintendent's Conference Day. In the meantime, enjoy the remainder of your summer and feel free to call or e-mail us if you have questions or need additional information prior to the opening of school.

Sincerely,

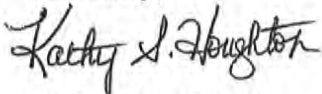

Kathy Houghton  
Superintendent of Schools

Cc: Board of Education



SUPERINTENDENT'S CONFERENCE DAY AGENDA  
WEDNESDAY, SEPTEMBER 2, 2015 (FACULTY & STAFF)

|                        |                                                                                                            |
|------------------------|------------------------------------------------------------------------------------------------------------|
| 7:30 – 8:00 a.m.       | Continental Breakfast, Cafeteria<br>Auditorium                                                             |
| 8:00 – 8:15 a.m.       | Welcome, Kathy Houghton                                                                                    |
| 8:15 – 8:30 a.m.       | Aesop Training – Kim Casselman                                                                             |
| 8:30 – 9:00 a.m.       | DASA Training, Mark Zalocha                                                                                |
| 9:00 – 9:30 a.m.       | Right to Know & Emergency Procedures – Mike Colangelo, BOCES Safety Office                                 |
| 9:30 – 10:00 a.m.      | Building Safety – Officer Nancy Nicholl, SRO                                                               |
| 10:15 -10:45 a.m.      | Non-Instructional Meetings                                                                                 |
| 10:45 – 11:15 a.m.     | Blood Borne Pathogens - Debbie Price                                                                       |
| 10:15 – 12:15 p.m.     | Faculty Meetings (see building agenda)                                                                     |
| 11:00 a.m. – 1:00 p.m. | Lunch Available in Cafeteria <i>Unpaid</i>                                                                 |
| 1:00 – 1:45 p.m.       | Special Education Training for all K-12 Special Education Faculty, Aides, TAs, Drivers – Kim Zogby         |
| 1:45 p.m. – 2:00 p.m.  | Training for Special Education Specific Student – Kim Zogby (Kuhn, Sacco, Galime, Pierce, Pylman, Keating) |



SUPERINTENDENT'S CONFERENCE DAY AGENDA  
THURSDAY, SEPTEMBER 3, 2015 (FACULTY)

- 7:30 – 8:00 a.m. Continental Breakfast, Cafeteria
- 8:00 – 9:00 a.m. District Update/APPR Changes - K. Houghton, Auditorium
- 9:00 – 11:00 a.m. Elementary ELA Committee Meeting  
Elementary Grade Level Meetings  
Jr. – Sr. High School Department Meetings
- 11:00 a.m. – 1:00 p.m. Lunch Available in Cafeteria
- 11:45 a.m. – 1:45 p.m. K-2 PLC (Professional Learning Community):  
Listening & Learning Strand  
Gr. 3-6 Grade Level Meetings  
Gr, 7-12 Teacher SLO Development
- 12:30 – 2:00 p.m. 7<sup>th</sup> Grade Orientation  
  
Faculty – Refer to Building Agendas for other specific afternoon responsibilities  
(Grade Level/Department Meetings, SLO Development, Data Meetings, Curriculum Work, etc.)

**NY Mills UFSD : 2015-2016 (8/26/2015)**

|     |
|-----|
| 7.2 |
|-----|

| <b>Grade</b>                            | <b>Male</b> | <b>Female</b> | <b>Total</b> |
|-----------------------------------------|-------------|---------------|--------------|
| <b>Elementary</b>                       |             |               |              |
| K                                       | 15          | 24            | 39           |
| 1                                       | 17          | 18            | 35           |
| 2                                       | 17          | 18            | 35           |
| 3                                       | 20          | 24            | 44           |
| 4                                       | 21          | 18            | 39           |
| 5                                       | 21          | 16            | 37           |
| 6                                       | 24          | 27            | 51           |
| <b>Elementary Total:</b>                | <b>137</b>  | <b>147</b>    | <b>280</b>   |
| <b>High School</b>                      |             |               |              |
| 7                                       | 31          | 24            | 55           |
| 8                                       | 25          | 26            | 51           |
| 9                                       | 21          | 26            | 47           |
| 10                                      | 18          | 14            | 32           |
| 11                                      | 21          | 26            | 47           |
| 12                                      | 22          | 21            | 43           |
| <b>High School Total:</b>               | <b>138</b>  | <b>137</b>    | <b>275</b>   |
| <b>NY Mills UFSD Total:</b>             | <b>275</b>  | <b>284</b>    | <b>555</b>   |
| <b>Outside Sp. Ed (K-6) Placements</b>  |             | <b>10</b>     |              |
| <b>Outside Sp. Ed (7-12) Placements</b> |             | <b>6</b>      |              |
| <b>House of Good Shepard</b>            |             | <b>0</b>      |              |
| <b>Alternative Ed. Placements</b>       |             | <b>1</b>      |              |
| <b>Grand Total K-12 Enrollment</b>      |             |               | <b>572</b>   |

***TEACHERLOAD 2015-2016 SCHOOL YEAR***

| <u>Teacher</u> | <u>Grade</u> | <u># of Students</u> | <u>Grade Total</u> |
|----------------|--------------|----------------------|--------------------|
| Davis          | K            | 19                   |                    |
| Kohn           | K            | 20                   | 39                 |
| Pearsall       | 1            | 18                   |                    |
| Robertson      | 1            | 17                   | 35                 |
| Goodfriend     | 2            | 18                   |                    |
| Zbytniewski    | 2            | 17                   | 35                 |
| Massoud        | 3            | 22                   |                    |
| Steffen        | 3            | 22                   | 44                 |
| Schmidt        | 4            | 19                   |                    |
| Sroka          | 4            | 20                   | 39                 |
| Grogan         | 5            | 20                   |                    |
| Kehrli         | 5            | 17                   | 37                 |
| Kuhn           | 6            | 26                   |                    |
| Sacco          | 6            | 25                   | 51                 |

Total Students:

280

8/26/15



## The New York State School Report Card [2013 - 14]

**NAME:** NY MILLS UFSD

**BEDS Code:** 411504020000

**ADDRESS:** 1 MARAUDER BLVD, NEW YORK MILLS, NY 13417

**PHONE:** (315) 768-8127

**The New York State Report Card is an important part of the Board of Regents' effort to raise learning standards for all students. It provides information to the public on school/district enrollment and staff, student performance, and other measures of school and district performance. Knowledge gained from the report card on a school's or district's strengths and weaknesses can be used to improve instruction and services to students.**

## NY MILLS UFSD Enrollment (2013 - 14)

**K-12 Enrollment: 577**

These enrollment data are collected as part of NYSED's Student Information Repository System (SIRS). These counts are as of "BEDS Day" which is typically the first Wednesday in October. Available are enrollment counts for public and charter school students by various demographics for the 2013 - 14 school year. For nonpublic school enrollment data please see the [Non-Public School Enrollment and Staff](#) information on our Information and Reporting Services webpage

### Students by Gender

| Male |     | Female |     |
|------|-----|--------|-----|
| 289  | 50% | 288    | 50% |

### Students by Ethnicity

| American Indian or Alaska Native | Black or African American | Hispanic or Latino | Asian or Native Hawaiian/Other Pacific Islander | White | Multiracial |
|----------------------------------|---------------------------|--------------------|-------------------------------------------------|-------|-------------|
| 0                                | 4                         | 22                 | 15                                              | 520   | 16          |
| 0%                               | 1%                        | 4%                 | 3%                                              | 90%   | 3%          |

### Other Groups

| Limited English Proficient Students |    | Students with Disabilities |     | Economically Disadvantaged Students |     |
|-------------------------------------|----|----------------------------|-----|-------------------------------------|-----|
| 6                                   | 1% | 63                         | 11% | 215                                 | 37% |

### Students by Grade

| Kindergarten (Full Day) | 1st Grade | 2nd Grade | 3rd Grade | 4th Grade  | 5th Grade  |
|-------------------------|-----------|-----------|-----------|------------|------------|
| 43                      | 45        | 36        | 47        | 45         | 53         |
| 6th Grade               | 7th Grade | 8th Grade | 9th Grade | 10th Grade | 11th Grade |
| 48                      | 55        | 27        | 48        | 45         | 46         |
| 12th Grade              |           |           |           |            |            |
| 39                      |           |           |           |            |            |



### Average Class Size (2013 - 14)

Common Branch

23

Grade 8 English

14

Grade 8 Mathematics

17

Grade 8 Science

14

Grade 10 English

25

Grade 10 Mathematics

3

Grade 10 Science

25

Grade 10 Social Studies

16

### Free and Reduced-Price Lunch (2013 - 14)

Eligible for Free Lunch

142

25%

Eligible for Reduced-Price Lunch

55

10%

### Attendance and Suspensions (2012 - 13)

Annual Attendance Rate

96%

Student Suspensions

18

3%

### Teacher Turnover Rate (2012 - 13)

Turnover Rate of Teachers with Fewer Than Five Years of Experience

20%

Turnover Rate of All Teachers

12%

### Staff Counts (2013 - 14)

Principals

2

Assistant Principals

0

Other Professional Staff

6

Paraprofessionals

15

### Teacher Qualifications (2011-12 through 2013-14)

|                                                                                   | 2011 - 12 | 2012 - 13 | 2013 - 14 |
|-----------------------------------------------------------------------------------|-----------|-----------|-----------|
| Total Number of Teachers                                                          | 49        | 49        | 49        |
| Percent with No Valid Teaching Certificate                                        | 0%        | 0%        | 0%        |
| Percent Teaching Out of Certification                                             | 0%        | 0%        | 0%        |
| Percent with Fewer Than Three Years of Experience                                 | 6%        | 2%        | 8%        |
| Percentage with Master's Degree Plus 30 Hours or Doctorate                        | 31%       | 31%       | 29%       |
| Total Number of Core Classes                                                      | 138       | 139       | 138       |
| Percent Not Taught by Highly Qualified Teachers in This District                  | 0%        | 0%        | 0%        |
| Percent Not Taught by Highly Qualified Teachers Statewide                         | 2%        | 3%        | 4%        |
| Percent Not Taught by Highly Qualified Teachers in High-Poverty Schools Statewide | 4%        | 6%        | 9%        |
| Percent Not Taught by Highly Qualified Teachers in Low-Poverty Schools Statewide  | 1%        | 1%        | 1%        |
| Total Number of Classes                                                           | 210       | 210       | 207       |
| Percent Taught by Teachers Without Appropriate Certification                      | 0%        | 0%        | 0%        |

### High School Completers (2013 - 14)

| Results by Student Group   | Completers<br>(Graduates + IEP<br>Diplomas) | Graduates<br>(Regents + Local<br>Diplomas) | Regents Diploma       |                         | Regents with Advanced<br>Designation |                         |
|----------------------------|---------------------------------------------|--------------------------------------------|-----------------------|-------------------------|--------------------------------------|-------------------------|
|                            | Number of<br>Students                       | Number of<br>Students                      | Number of<br>Students | Percent of<br>Graduates | Number of<br>Students                | Percent of<br>Graduates |
| All Students               | 36                                          | 35                                         | 34                    | 97%                     | 13                                   | 37%                     |
| General Education          | -                                           | -                                          | -                     | -                       | -                                    | -                       |
| Students with Disabilities | -                                           | -                                          | -                     | -                       | -                                    | -                       |

| Results by Student Group   | Regents with CTE Endorsement |                         | Local Diplomas        |                         | Commencement Credentials |                          |
|----------------------------|------------------------------|-------------------------|-----------------------|-------------------------|--------------------------|--------------------------|
|                            | Number of<br>Students        | Percent of<br>Graduates | Number of<br>Students | Percent of<br>Graduates | Number of<br>Students    | Percent of<br>Completers |
| All Students               | 1                            | 3%                      | 1                     | 3%                      | 1                        | 3%                       |
| General Education          | -                            | -                       | -                     | -                       | -                        | -                        |
| Students with Disabilities | -                            | -                       | -                     | -                       | -                        | -                        |

## High School Non-completers (2013 - 14)

### Results by Student Group

|                            | Dropped Out           |                        | Entered Approved High School<br>Equivalency Preparation Program |                        | Total Noncompleters   |                        |
|----------------------------|-----------------------|------------------------|-----------------------------------------------------------------|------------------------|-----------------------|------------------------|
|                            | Number of<br>Students | Percent of<br>Students | Number of<br>Students                                           | Percent of<br>Students | Number of<br>Students | Percent of<br>Students |
| All Students               | 4                     | 2%                     | 1                                                               | 1%                     | 5                     | 3%                     |
| General Education          | -                     | -                      | -                                                               | -                      | -                     | -                      |
| Students with Disabilities | -                     | -                      | -                                                               | -                      | -                     | -                      |

### Post-graduation Plans of Completers (2013 - 14)

**Results by Student Group**

|                            | To Four-Year College |                       | To Two-Year College |                       | To Other Post-Secondary |                       | To the Military    |                       |
|----------------------------|----------------------|-----------------------|---------------------|-----------------------|-------------------------|-----------------------|--------------------|-----------------------|
|                            | Number of Students   | Percent of Completers | Number of Students  | Percent of Completers | Number of Students      | Percent of Completers | Number of Students | Percent of Completers |
| All Students               | 21                   | 58%                   | 13                  | 36%                   | 0                       | 0%                    | 1                  | 3%                    |
| General Education          | -                    | -                     | -                   | -                     | -                       | -                     | -                  | -                     |
| Students with Disabilities | -                    | -                     | -                   | -                     | -                       | -                     | -                  | -                     |

**Results by Student Group**

|                            | To Employment      |                       | To Adult Services  |                       | To Other Known Plans |                       | Plan Unknown       |                       |
|----------------------------|--------------------|-----------------------|--------------------|-----------------------|----------------------|-----------------------|--------------------|-----------------------|
|                            | Number of Students | Percent of Completers | Number of Students | Percent of Completers | Number of Students   | Percent of Completers | Number of Students | Percent of Completers |
| All Students               | 0                  | 0%                    | 1                  | 3%                    | 0                    | 0%                    | 0                  | 0%                    |
| General Education          | -                  | -                     | -                  | -                     | -                    | -                     | -                  | -                     |
| Students with Disabilities | -                  | -                     | -                  | -                     | -                    | -                     | -                  | -                     |

### Grade 3 English Language Arts

60

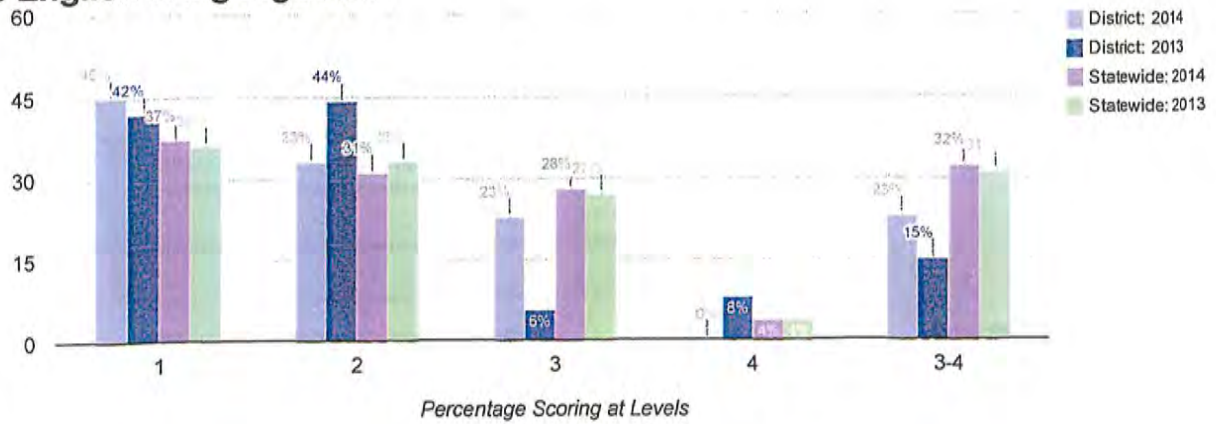

### Mean Score

2014

2013

292

295

| Results by Student Group                        | 2014         |                             |    |    |   |                               | 2013         |                             |    |    |    |                               |
|-------------------------------------------------|--------------|-----------------------------|----|----|---|-------------------------------|--------------|-----------------------------|----|----|----|-------------------------------|
|                                                 | Total Tested | Percent Scoring at Level(s) |    |    |   | % Proficient (Levels 3 and 4) | Total Tested | Percent Scoring at Level(s) |    |    |    | % Proficient (Levels 3 and 4) |
|                                                 |              | 1                           | 2  | 3  | 4 |                               |              | 1                           | 2  | 3  | 4  |                               |
| All Students                                    | 40           | 45                          | 33 | 23 | 0 | 23                            | 48           | 42                          | 44 | 6  | 8  | 15                            |
| General Education                               | 37           | -                           | -  | -  | - | -                             | 41           | 34                          | 49 | 7  | 10 | 17                            |
| Students with Disabilities                      | 3            | -                           | -  | -  | - | -                             | 7            | 86                          | 14 | 0  | 0  | 0                             |
| Asian or Native Hawaiian/Other Pacific Islander | 3            | -                           | -  | -  | - | -                             | 0            | 0                           | 0  | 0  | 0  | 0                             |
| Black or African American                       | 1            | -                           | -  | -  | - | -                             | 0            | 0                           | 0  | 0  | 0  | 0                             |
| Hispanic or Latino                              | 2            | -                           | -  | -  | - | -                             | 2            | -                           | -  | -  | -  | -                             |
| White                                           | 32           | 50                          | 28 | 22 | 0 | 22                            | 44           | -                           | -  | -  | -  | -                             |
| Multiracial                                     | 2            | -                           | -  | -  | - | -                             | 2            | -                           | -  | -  | -  | -                             |
| Small Group Total                               | 8            | 25                          | 50 | 25 | 0 | 25                            | 48           | 42                          | 44 | 6  | 8  | 15                            |
| Female                                          | 17           | 47                          | 24 | 29 | 0 | 29                            | 24           | 50                          | 38 | 4  | 8  | 13                            |
| Male                                            | 23           | 43                          | 39 | 17 | 0 | 17                            | 24           | 33                          | 50 | 8  | 8  | 17                            |
| English Proficient                              | 39           | -                           | -  | -  | - | -                             | 48           | 42                          | 44 | 6  | 8  | 15                            |
| Limited English Proficient                      | 1            | -                           | -  | -  | - | -                             | 0            | 0                           | 0  | 0  | 0  | 0                             |
| Economically Disadvantaged                      | 19           | 53                          | 32 | 16 | 0 | 16                            | 22           | 45                          | 50 | 0  | 5  | 5                             |
| Not Economically Disadvantaged                  | 21           | 38                          | 33 | 29 | 0 | 29                            | 26           | 38                          | 38 | 12 | 12 | 23                            |
| Not Migrant                                     | 40           | 45                          | 33 | 23 | 0 | 23                            | 48           | 42                          | 44 | 6  | 8  | 15                            |

# Grade 4 English Language Arts

60

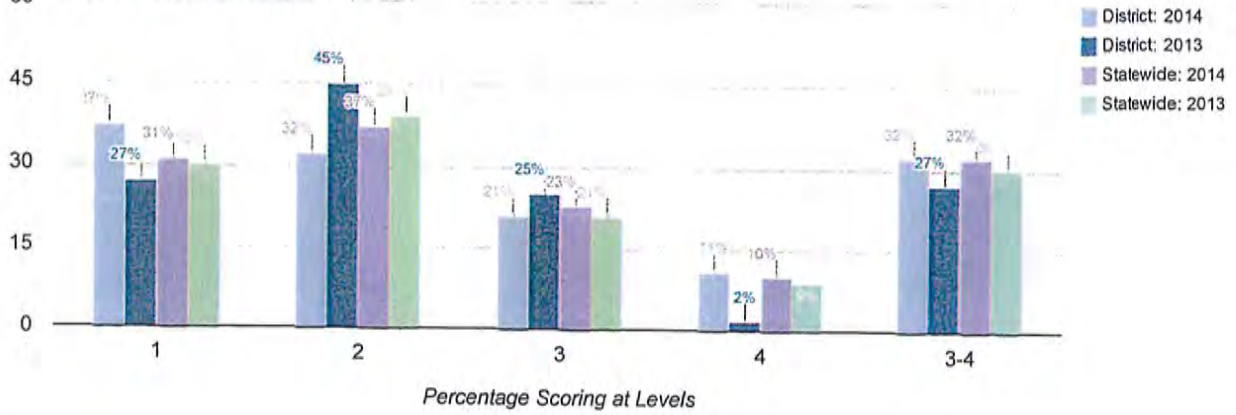

## Mean Score

2014

2013

298

300

| Results by Student Group                        | 2014         |                             |    |    |    |                               | 2013         |                             |    |    |   |                               |
|-------------------------------------------------|--------------|-----------------------------|----|----|----|-------------------------------|--------------|-----------------------------|----|----|---|-------------------------------|
|                                                 | Total Tested | Percent Scoring at Level(s) |    |    |    | % Proficient (Levels 3 and 4) | Total Tested | Percent Scoring at Level(s) |    |    |   | % Proficient (Levels 3 and 4) |
|                                                 |              | 1                           | 2  | 3  | 4  |                               |              | 1                           | 2  | 3  | 4 |                               |
| All Students                                    | 38           | 37                          | 32 | 21 | 11 | 32                            | 51           | 27                          | 45 | 25 | 2 | 27                            |
| General Education                               | 34           | -                           | -  | -  | -  | -                             | 46           | 22                          | 48 | 28 | 2 | 30                            |
| Students with Disabilities                      | 4            | -                           | -  | -  | -  | -                             | 5            | 80                          | 20 | 0  | 0 | 0                             |
| Asian or Native Hawaiian/Other Pacific Islander | 0            | 0                           | 0  | 0  | 0  | 0                             | 2            | -                           | -  | -  | - | -                             |
| Hispanic or Latino                              | 2            | -                           | -  | -  | -  | -                             | 2            | -                           | -  | -  | - | -                             |
| White                                           | 34           | -                           | -  | -  | -  | -                             | 45           | 29                          | 42 | 27 | 2 | 29                            |
| Multiracial                                     | 2            | -                           | -  | -  | -  | -                             | 2            | -                           | -  | -  | - | -                             |
| Small Group Total                               | 38           | 37                          | 32 | 21 | 11 | 32                            | 6            | 17                          | 67 | 17 | 0 | 17                            |
| Female                                          | 18           | 39                          | 22 | 22 | 17 | 39                            | 26           | 23                          | 46 | 27 | 4 | 31                            |
| Male                                            | 20           | 35                          | 40 | 20 | 5  | 25                            | 25           | 32                          | 44 | 24 | 0 | 24                            |
| English Proficient                              | 38           | 37                          | 32 | 21 | 11 | 32                            | 51           | 27                          | 45 | 25 | 2 | 27                            |
| Economically Disadvantaged                      | 20           | 45                          | 30 | 25 | 0  | 25                            | 18           | 50                          | 44 | 6  | 0 | 6                             |
| Not Economically Disadvantaged                  | 18           | 28                          | 33 | 17 | 22 | 39                            | 33           | 15                          | 45 | 36 | 3 | 39                            |
| Not Migrant                                     | 38           | 37                          | 32 | 21 | 11 | 32                            | 51           | 27                          | 45 | 25 | 2 | 27                            |

### Grade 5 English Language Arts

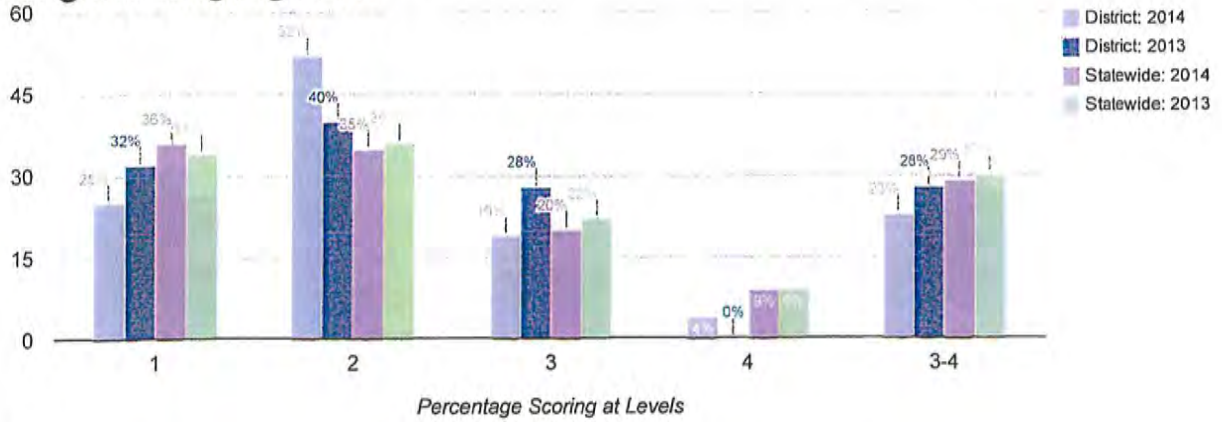

### Mean Score

|                                                 | 2014         |                             |    |    |    |                               | 2013         |                             |    |    |   |                               |
|-------------------------------------------------|--------------|-----------------------------|----|----|----|-------------------------------|--------------|-----------------------------|----|----|---|-------------------------------|
|                                                 | 298          |                             |    |    |    |                               | 297          |                             |    |    |   |                               |
| Results by Student Group                        | Total Tested | Percent Scoring at Level(s) |    |    |    | % Proficient (Levels 3 and 4) | Total Tested | Percent Scoring at Level(s) |    |    |   | % Proficient (Levels 3 and 4) |
|                                                 |              | 1                           | 2  | 3  | 4  |                               |              | 1                           | 2  | 3  | 4 |                               |
| All Students                                    | 48           | 25                          | 52 | 19 | 4  | 23                            | 53           | 32                          | 40 | 28 | 0 | 28                            |
| General Education                               | 40           | 10                          | 63 | 23 | 5  | 28                            | 45           | 24                          | 42 | 33 | 0 | 33                            |
| Students with Disabilities                      | 8            | 100                         | 0  | 0  | 0  | 0                             | 8            | 75                          | 25 | 0  | 0 | 0                             |
| Asian or Native Hawaiian/Other Pacific Islander | 2            | -                           | -  | -  | -  | -                             | 0            | 0                           | 0  | 0  | 0 | 0                             |
| Hispanic or Latino                              | 3            | -                           | -  | -  | -  | -                             | 2            | -                           | -  | -  | - | -                             |
| White                                           | 42           | 29                          | 52 | 14 | 5  | 19                            | 48           | 27                          | 42 | 31 | 0 | 31                            |
| Multiracial                                     | 1            | -                           | -  | -  | -  | -                             | 3            | -                           | -  | -  | - | -                             |
| Small Group Total                               | 6            | 0                           | 50 | 50 | 0  | 50                            | 5            | 80                          | 20 | 0  | 0 | 0                             |
| Female                                          | 21           | 19                          | 57 | 14 | 10 | 24                            | 28           | 14                          | 50 | 36 | 0 | 36                            |
| Male                                            | 27           | 30                          | 48 | 22 | 0  | 22                            | 25           | 52                          | 28 | 20 | 0 | 20                            |
| English Proficient                              | 48           | 25                          | 52 | 19 | 4  | 23                            | 53           | 32                          | 40 | 28 | 0 | 28                            |
| Economically Disadvantaged                      | 19           | 32                          | 58 | 11 | 0  | 11                            | 21           | 43                          | 43 | 14 | 0 | 14                            |
| Not Economically Disadvantaged                  | 29           | 21                          | 48 | 24 | 7  | 31                            | 32           | 25                          | 38 | 38 | 0 | 38                            |
| Not Migrant                                     | 48           | 25                          | 52 | 19 | 4  | 23                            | 53           | 32                          | 40 | 28 | 0 | 28                            |



### Grade 6 English Language Arts

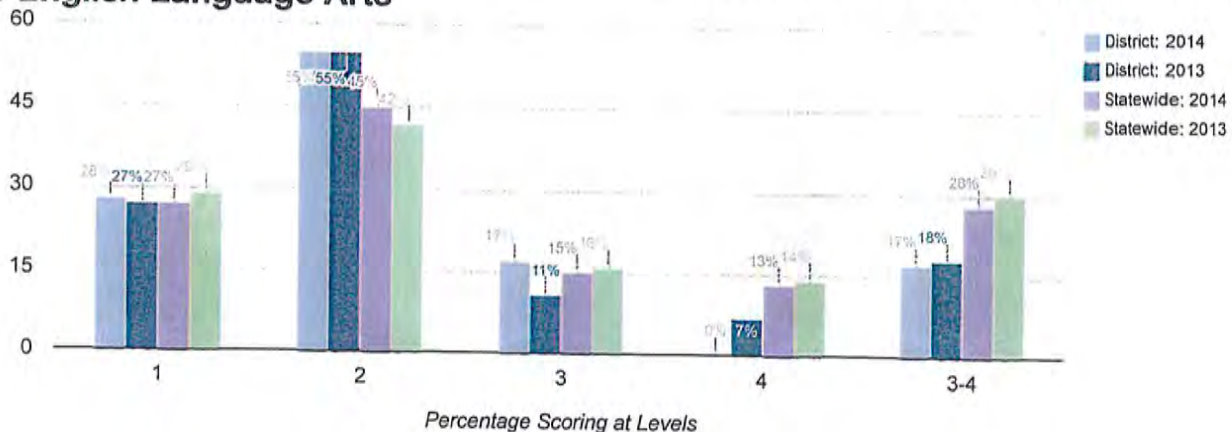

### Mean Score

|                                                 | 2014         |                             |    |    |   |                               | 2013         |                             |    |    |   |                               |
|-------------------------------------------------|--------------|-----------------------------|----|----|---|-------------------------------|--------------|-----------------------------|----|----|---|-------------------------------|
|                                                 | 297          |                             |    |    |   |                               | 295          |                             |    |    |   |                               |
| Results by Student Group                        | 2014         |                             |    |    |   |                               | 2013         |                             |    |    |   |                               |
|                                                 | Total Tested | Percent Scoring at Level(s) |    |    |   | % Proficient (Levels 3 and 4) | Total Tested | Percent Scoring at Level(s) |    |    |   | % Proficient (Levels 3 and 4) |
|                                                 | 1            | 2                           | 3  | 4  |   | 1                             | 2            | 3                           | 4  |    |   |                               |
| All Students                                    | 47           | 28                          | 55 | 17 | 0 | 17                            | 56           | 27                          | 55 | 11 | 7 | 18                            |
| General Education                               | 40           | 18                          | 63 | 20 | 0 | 20                            | 49           | 18                          | 61 | 12 | 8 | 20                            |
| Students with Disabilities                      | 7            | 86                          | 14 | 0  | 0 | 0                             | 7            | 86                          | 14 | 0  | 0 | 0                             |
| Asian or Native Hawaiian/Other Pacific Islander | 0            | 0                           | 0  | 0  | 0 | 0                             | 1            | -                           | -  | -  | - | -                             |
| Hispanic or Latino                              | 2            | -                           | -  | -  | - | -                             | 2            | -                           | -  | -  | - | -                             |
| White                                           | 43           | -                           | -  | -  | - | -                             | 52           | -                           | -  | -  | - | -                             |
| Multiracial                                     | 2            | -                           | -  | -  | - | -                             | 1            | -                           | -  | -  | - | -                             |
| Small Group Total                               | 47           | 28                          | 55 | 17 | 0 | 17                            | 56           | 27                          | 55 | 11 | 7 | 18                            |
| Female                                          | 26           | 15                          | 54 | 31 | 0 | 31                            | 32           | 25                          | 56 | 13 | 6 | 19                            |
| Male                                            | 21           | 43                          | 57 | 0  | 0 | 0                             | 24           | 29                          | 54 | 8  | 8 | 17                            |
| English Proficient                              | 47           | 28                          | 55 | 17 | 0 | 17                            | 56           | 27                          | 55 | 11 | 7 | 18                            |
| Economically Disadvantaged                      | 19           | 26                          | 63 | 11 | 0 | 11                            | 26           | 31                          | 62 | 0  | 8 | 8                             |
| Not Economically Disadvantaged                  | 28           | 29                          | 50 | 21 | 0 | 21                            | 30           | 23                          | 50 | 20 | 7 | 27                            |
| Not Migrant                                     | 47           | 28                          | 55 | 17 | 0 | 17                            | 56           | 27                          | 55 | 11 | 7 | 18                            |

### Grade 7 English Language Arts

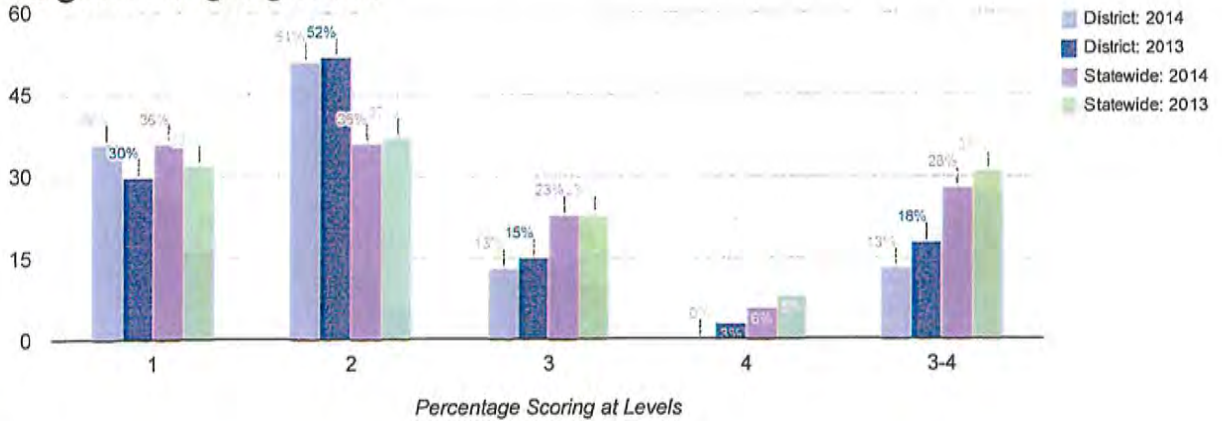

### Mean Score

2014

2013

289

301

| Results by Student Group                        | 2014         |                             |    |    |   |                               | 2013         |                             |    |    |   |                               |
|-------------------------------------------------|--------------|-----------------------------|----|----|---|-------------------------------|--------------|-----------------------------|----|----|---|-------------------------------|
|                                                 | Total Tested | Percent Scoring at Level(s) |    |    |   | % Proficient (Levels 3 and 4) | Total Tested | Percent Scoring at Level(s) |    |    |   | % Proficient (Levels 3 and 4) |
|                                                 |              | 1                           | 2  | 3  | 4 |                               |              | 1                           | 2  | 3  | 4 |                               |
| All Students                                    | 45           | 36                          | 51 | 13 | 0 | 13                            | 33           | 30                          | 52 | 15 | 3 | 18                            |
| General Education                               | 39           | 26                          | 59 | 15 | 0 | 15                            | 31           | -                           | -  | -  | - | -                             |
| Students with Disabilities                      | 6            | 100                         | 0  | 0  | 0 | 0                             | 2            | -                           | -  | -  | - | -                             |
| Asian or Native Hawaiian/Other Pacific Islander | 1            | -                           | -  | -  | - | -                             | 0            | 0                           | 0  | 0  | 0 | 0                             |
| Black or African American                       | 1            | -                           | -  | -  | - | -                             | 0            | 0                           | 0  | 0  | 0 | 0                             |
| Hispanic or Latino                              | 2            | -                           | -  | -  | - | -                             | 0            | 0                           | 0  | 0  | 0 | 0                             |
| White                                           | 40           | 33                          | 55 | 13 | 0 | 13                            | 31           | -                           | -  | -  | - | -                             |
| Multiracial                                     | 1            | -                           | -  | -  | - | -                             | 2            | -                           | -  | -  | - | -                             |
| Small Group Total                               | 5            | 60                          | 20 | 20 | 0 | 20                            | 33           | 30                          | 52 | 15 | 3 | 18                            |
| Female                                          | 23           | 22                          | 61 | 17 | 0 | 17                            | 14           | 21                          | 64 | 14 | 0 | 14                            |
| Male                                            | 22           | 50                          | 41 | 9  | 0 | 9                             | 19           | 37                          | 42 | 16 | 5 | 21                            |
| English Proficient                              | 45           | 36                          | 51 | 13 | 0 | 13                            | 33           | 30                          | 52 | 15 | 3 | 18                            |
| Economically Disadvantaged                      | 19           | 37                          | 53 | 11 | 0 | 11                            | 13           | 31                          | 46 | 23 | 0 | 23                            |
| Not Economically Disadvantaged                  | 26           | 35                          | 50 | 15 | 0 | 15                            | 20           | 30                          | 55 | 10 | 5 | 15                            |
| Not Migrant                                     | 45           | 36                          | 51 | 13 | 0 | 13                            | 33           | 30                          | 52 | 15 | 3 | 18                            |

# Grade 8 English Language Arts

60

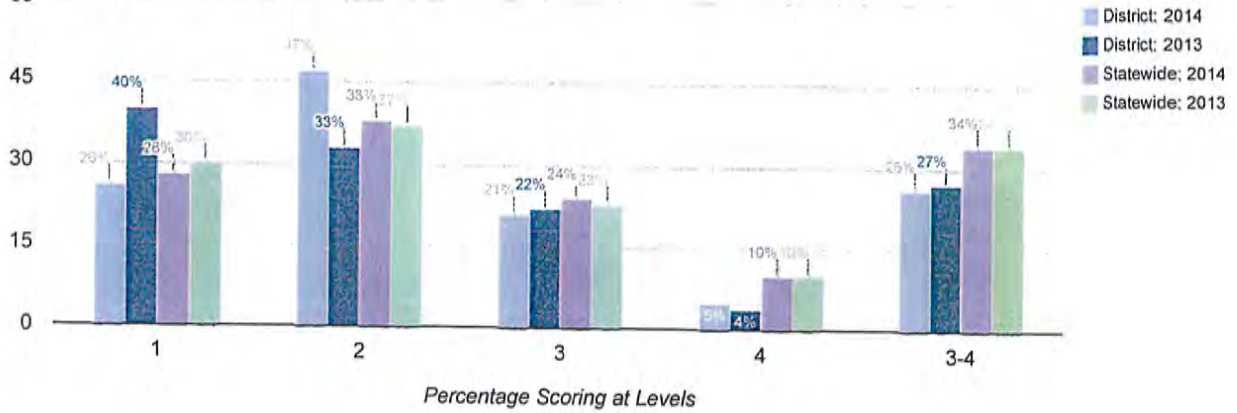

## Mean Score

2014

2013

293

290

| Results by Student Group       | 2014         |                             |    |    |    |                               | 2013         |                             |    |    |   |                               |
|--------------------------------|--------------|-----------------------------|----|----|----|-------------------------------|--------------|-----------------------------|----|----|---|-------------------------------|
|                                | Total Tested | Percent Scoring at Level(s) |    |    |    | % Proficient (Levels 3 and 4) | Total Tested | Percent Scoring at Level(s) |    |    |   | % Proficient (Levels 3 and 4) |
|                                |              | 1                           | 2  | 3  | 4  |                               |              | 1                           | 2  | 3  | 4 |                               |
| All Students                   | 19           | 26                          | 47 | 21 | 5  | 26                            | 45           | 40                          | 33 | 22 | 4 | 27                            |
| General Education              | 16           | -                           | -  | -  | -  | -                             | 39           | 31                          | 38 | 26 | 5 | 31                            |
| Students with Disabilities     | 3            | -                           | -  | -  | -  | -                             | 6            | 100                         | 0  | 0  | 0 | 0                             |
| Hispanic or Latino             | 0            | 0                           | 0  | 0  | 0  | 0                             | 3            | -                           | -  | -  | - | -                             |
| White                          | 18           | -                           | -  | -  | -  | -                             | 42           | -                           | -  | -  | - | -                             |
| Multiracial                    | 1            | -                           | -  | -  | -  | -                             | 0            | 0                           | 0  | 0  | 0 | 0                             |
| Small Group Total              | 19           | 26                          | 47 | 21 | 5  | 26                            | 45           | 40                          | 33 | 22 | 4 | 27                            |
| Female                         | 10           | 20                          | 50 | 30 | 0  | 30                            | 26           | 38                          | 23 | 35 | 4 | 38                            |
| Male                           | 9            | 33                          | 44 | 11 | 11 | 22                            | 19           | 42                          | 47 | 5  | 5 | 11                            |
| English Proficient             | 19           | 26                          | 47 | 21 | 5  | 26                            | 45           | 40                          | 33 | 22 | 4 | 27                            |
| Economically Disadvantaged     | 6            | 50                          | 33 | 17 | 0  | 17                            | 20           | 40                          | 30 | 30 | 0 | 30                            |
| Not Economically Disadvantaged | 13           | 15                          | 54 | 23 | 8  | 31                            | 25           | 40                          | 36 | 16 | 8 | 24                            |
| Not Migrant                    | 19           | 26                          | 47 | 21 | 5  | 26                            | 45           | 40                          | 33 | 22 | 4 | 27                            |

### Grade 3 Mathematics

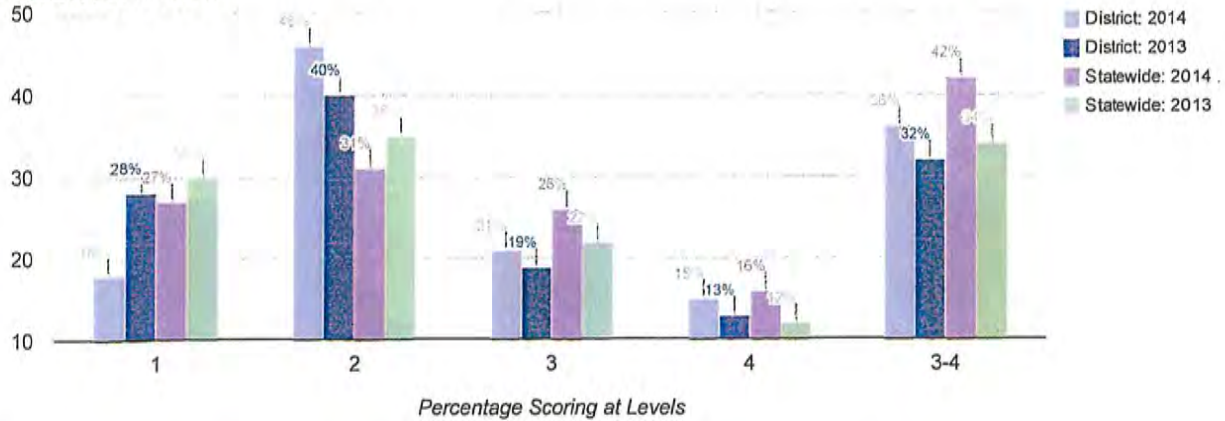

### Mean Score

|                                                 | 2014         |                             |    |    |    |                               | 2013         |                             |    |    |    |                               |
|-------------------------------------------------|--------------|-----------------------------|----|----|----|-------------------------------|--------------|-----------------------------|----|----|----|-------------------------------|
|                                                 | 304          |                             |    |    |    |                               | 303          |                             |    |    |    |                               |
| Results by Student Group                        | Total Tested | Percent Scoring at Level(s) |    |    |    | % Proficient (Levels 3 and 4) | Total Tested | Percent Scoring at Level(s) |    |    |    | % Proficient (Levels 3 and 4) |
|                                                 |              | 1                           | 2  | 3  | 4  |                               |              | 1                           | 2  | 3  | 4  |                               |
| All Students                                    | 39           | 18                          | 46 | 21 | 15 | 36                            | 47           | 28                          | 40 | 19 | 13 | 32                            |
| General Education                               | 36           | -                           | -  | -  | -  | -                             | 41           | 22                          | 41 | 22 | 15 | 37                            |
| Students with Disabilities                      | 3            | -                           | -  | -  | -  | -                             | 6            | 67                          | 33 | 0  | 0  | 0                             |
| Asian or Native Hawaiian/Other Pacific Islander | 3            | -                           | -  | -  | -  | -                             | 0            | 0                           | 0  | 0  | 0  | 0                             |
| Black or African American                       | 1            | -                           | -  | -  | -  | -                             | 0            | 0                           | 0  | 0  | 0  | 0                             |
| Hispanic or Latino                              | 2            | -                           | -  | -  | -  | -                             | 2            | -                           | -  | -  | -  | -                             |
| White                                           | 31           | 16                          | 52 | 16 | 16 | 32                            | 43           | -                           | -  | -  | -  | -                             |
| Multiracial                                     | 2            | -                           | -  | -  | -  | -                             | 2            | -                           | -  | -  | -  | -                             |
| Small Group Total                               | 8            | 25                          | 25 | 38 | 13 | 50                            | 47           | 28                          | 40 | 19 | 13 | 32                            |
| Female                                          | 17           | 24                          | 35 | 18 | 24 | 41                            | 23           | 39                          | 39 | 9  | 13 | 22                            |
| Male                                            | 22           | 14                          | 55 | 23 | 9  | 32                            | 24           | 17                          | 42 | 29 | 13 | 42                            |
| English Proficient                              | 38           | -                           | -  | -  | -  | -                             | 47           | 28                          | 40 | 19 | 13 | 32                            |
| Limited English Proficient                      | 1            | -                           | -  | -  | -  | -                             | 0            | 0                           | 0  | 0  | 0  | 0                             |
| Economically Disadvantaged                      | 18           | 33                          | 28 | 22 | 17 | 39                            | 22           | 36                          | 45 | 14 | 5  | 18                            |
| Not Economically Disadvantaged                  | 21           | 5                           | 62 | 19 | 14 | 33                            | 25           | 20                          | 36 | 24 | 20 | 44                            |
| Not Migrant                                     | 39           | 18                          | 46 | 21 | 15 | 36                            | 47           | 28                          | 40 | 19 | 13 | 32                            |

### Grade 4 Mathematics

60

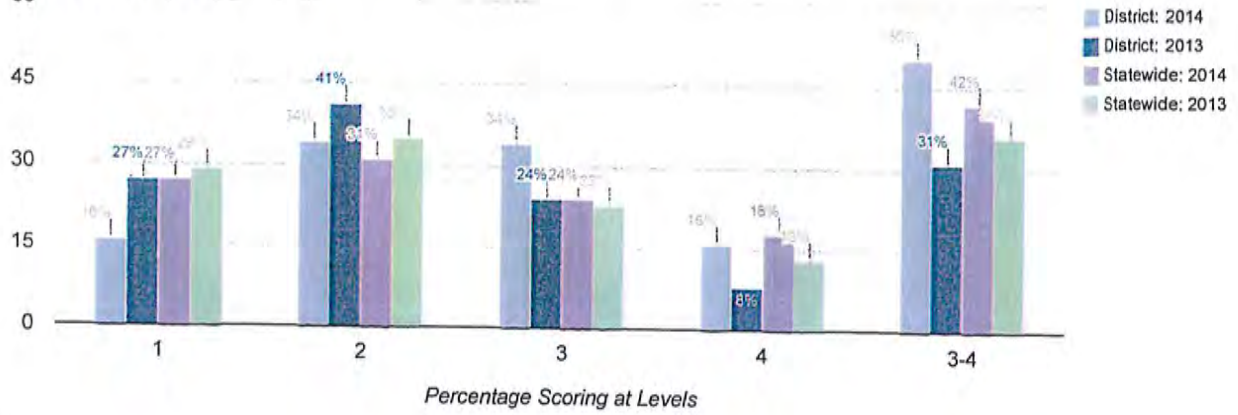

### Mean Score

2014

2013

314

300

| Results by Student Group                        | 2014         |                             |    |    |    |                               | 2013         |                             |    |    |    |                               |
|-------------------------------------------------|--------------|-----------------------------|----|----|----|-------------------------------|--------------|-----------------------------|----|----|----|-------------------------------|
|                                                 | Total Tested | Percent Scoring at Level(s) |    |    |    | % Proficient (Levels 3 and 4) | Total Tested | Percent Scoring at Level(s) |    |    |    | % Proficient (Levels 3 and 4) |
|                                                 |              | 1                           | 2  | 3  | 4  |                               |              | 1                           | 2  | 3  | 4  |                               |
| All Students                                    | 38           | 16                          | 34 | 34 | 16 | 50                            | 51           | 27                          | 41 | 24 | 8  | 31                            |
| General Education                               | 34           | -                           | -  | -  | -  | -                             | 46           | 20                          | 46 | 26 | 9  | 35                            |
| Students with Disabilities                      | 4            | -                           | -  | -  | -  | -                             | 5            | 100                         | 0  | 0  | 0  | 0                             |
| Asian or Native Hawaiian/Other Pacific Islander | 0            | 0                           | 0  | 0  | 0  | 0                             | 2            | -                           | -  | -  | -  | -                             |
| Hispanic or Latino                              | 2            | -                           | -  | -  | -  | -                             | 2            | -                           | -  | -  | -  | -                             |
| White                                           | 34           | -                           | -  | -  | -  | -                             | 45           | 31                          | 40 | 20 | 9  | 29                            |
| Multiracial                                     | 2            | -                           | -  | -  | -  | -                             | 2            | -                           | -  | -  | -  | -                             |
| Small Group Total                               | 38           | 16                          | 34 | 34 | 16 | 50                            | 6            | 0                           | 50 | 50 | 0  | 50                            |
| Female                                          | 18           | 22                          | 39 | 33 | 6  | 39                            | 26           | 23                          | 42 | 27 | 8  | 35                            |
| Male                                            | 20           | 10                          | 30 | 35 | 25 | 60                            | 25           | 32                          | 40 | 20 | 8  | 28                            |
| English Proficient                              | 38           | 16                          | 34 | 34 | 16 | 50                            | 51           | 27                          | 41 | 24 | 8  | 31                            |
| Economically Disadvantaged                      | 20           | 20                          | 40 | 35 | 5  | 40                            | 18           | 39                          | 33 | 28 | 0  | 28                            |
| Not Economically Disadvantaged                  | 18           | 11                          | 28 | 33 | 28 | 61                            | 33           | 21                          | 45 | 21 | 12 | 33                            |
| Not Migrant                                     | 38           | 16                          | 34 | 34 | 16 | 50                            | 51           | 27                          | 41 | 24 | 8  | 31                            |

### Grade 5 Mathematics

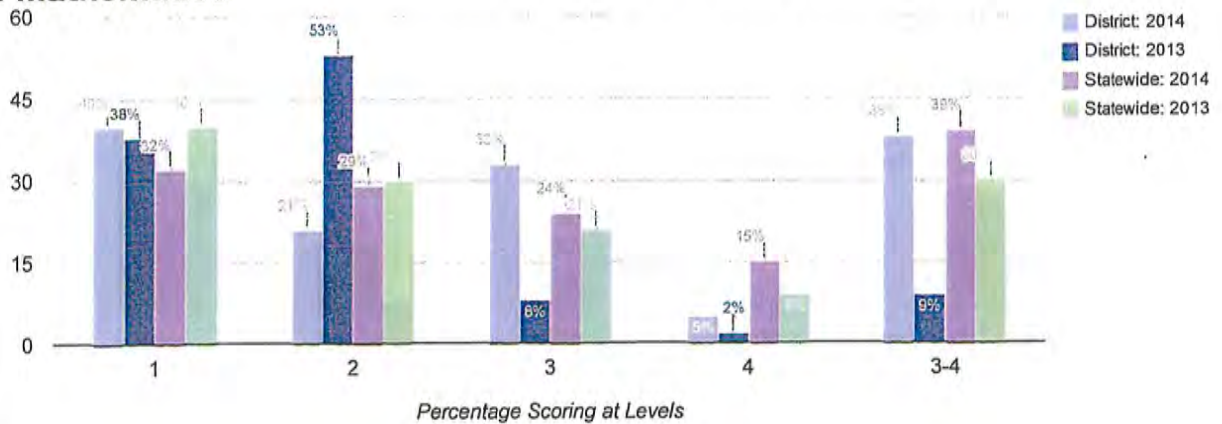

### Mean Score

2014

2013

300

294

| Results by Student Group                        | 2014         |                             |    |    |   |                               | 2013         |                             |    |    |   |                               |
|-------------------------------------------------|--------------|-----------------------------|----|----|---|-------------------------------|--------------|-----------------------------|----|----|---|-------------------------------|
|                                                 | Total Tested | Percent Scoring at Level(s) |    |    |   | % Proficient (Levels 3 and 4) | Total Tested | Percent Scoring at Level(s) |    |    |   | % Proficient (Levels 3 and 4) |
|                                                 |              | 1                           | 2  | 3  | 4 |                               |              | 1                           | 2  | 3  | 4 |                               |
| All Students                                    | 42           | 40                          | 21 | 33 | 5 | 38                            | 53           | 38                          | 53 | 8  | 2 | 9                             |
| General Education                               | 36           | 31                          | 25 | 39 | 6 | 44                            | 45           | 29                          | 60 | 9  | 2 | 11                            |
| Students with Disabilities                      | 6            | 100                         | 0  | 0  | 0 | 0                             | 8            | 88                          | 13 | 0  | 0 | 0                             |
| Asian or Native Hawaiian/Other Pacific Islander | 2            | -                           | -  | -  | - | -                             | 0            | 0                           | 0  | 0  | 0 | 0                             |
| Hispanic or Latino                              | 3            | -                           | -  | -  | - | -                             | 2            | -                           | -  | -  | - | -                             |
| White                                           | 36           | 42                          | 22 | 31 | 6 | 36                            | 48           | 40                          | 50 | 8  | 2 | 10                            |
| Multiracial                                     | 1            | -                           | -  | -  | - | -                             | 3            | -                           | -  | -  | - | -                             |
| Small Group Total                               | 6            | 33                          | 17 | 50 | 0 | 50                            | 5            | 20                          | 80 | 0  | 0 | 0                             |
| Female                                          | 18           | 33                          | 17 | 44 | 6 | 50                            | 28           | 25                          | 68 | 4  | 4 | 7                             |
| Male                                            | 24           | 46                          | 25 | 25 | 4 | 29                            | 25           | 52                          | 36 | 12 | 0 | 12                            |
| English Proficient                              | 42           | 40                          | 21 | 33 | 5 | 38                            | 53           | 38                          | 53 | 8  | 2 | 9                             |
| Economically Disadvantaged                      | 15           | 47                          | 13 | 40 | 0 | 40                            | 21           | 57                          | 43 | 0  | 0 | 0                             |
| Not Economically Disadvantaged                  | 27           | 37                          | 26 | 30 | 7 | 37                            | 32           | 25                          | 59 | 13 | 3 | 16                            |
| Not Migrant                                     | 42           | 40                          | 21 | 33 | 5 | 38                            | 53           | 38                          | 53 | 8  | 2 | 9                             |

### Grade 6 Mathematics

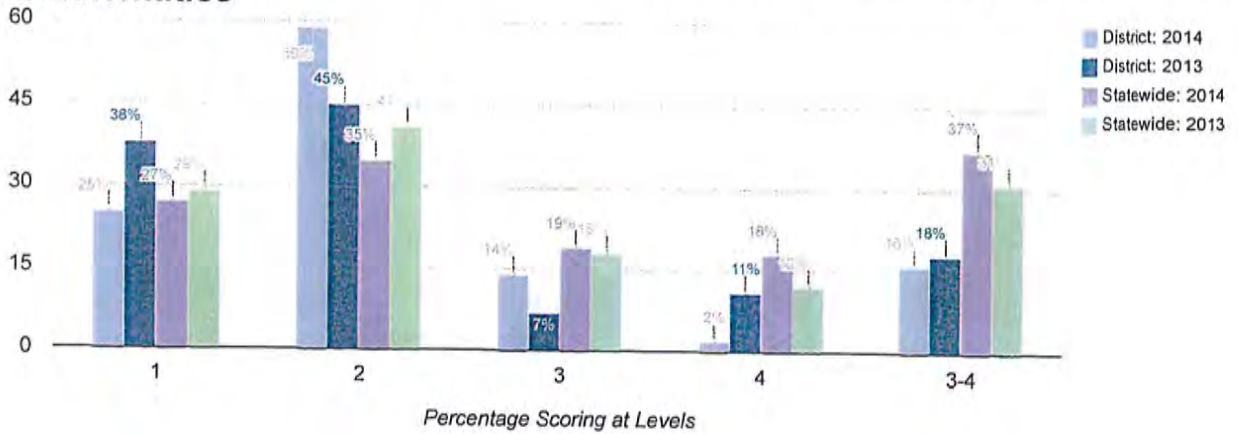

### Mean Score

2014

2013

294

294

| Results by Student Group                        | 2014         |                             |    |    |   |                               | 2013         |                             |    |   |    |                               |
|-------------------------------------------------|--------------|-----------------------------|----|----|---|-------------------------------|--------------|-----------------------------|----|---|----|-------------------------------|
|                                                 | Total Tested | Percent Scoring at Level(s) |    |    |   | % Proficient (Levels 3 and 4) | Total Tested | Percent Scoring at Level(s) |    |   |    | % Proficient (Levels 3 and 4) |
|                                                 |              | 1                           | 2  | 3  | 4 |                               |              | 1                           | 2  | 3 | 4  |                               |
| All Students                                    | 44           | 25                          | 59 | 14 | 2 | 16                            | 56           | 38                          | 45 | 7 | 11 | 18                            |
| General Education                               | 38           | 16                          | 66 | 16 | 3 | 18                            | 49           | 29                          | 51 | 8 | 12 | 20                            |
| Students with Disabilities                      | 6            | 83                          | 17 | 0  | 0 | 0                             | 7            | 100                         | 0  | 0 | 0  | 0                             |
| Asian or Native Hawaiian/Other Pacific Islander | 0            | 0                           | 0  | 0  | 0 | 0                             | 1            | -                           | -  | - | -  | -                             |
| Hispanic or Latino                              | 2            | -                           | -  | -  | - | -                             | 2            | -                           | -  | - | -  | -                             |
| White                                           | 40           | -                           | -  | -  | - | -                             | 52           | -                           | -  | - | -  | -                             |
| Multiracial                                     | 2            | -                           | -  | -  | - | -                             | 1            | -                           | -  | - | -  | -                             |
| Small Group Total                               | 44           | 25                          | 59 | 14 | 2 | 16                            | 56           | 38                          | 45 | 7 | 11 | 18                            |
| Female                                          | 23           | 17                          | 61 | 17 | 4 | 22                            | 32           | 34                          | 47 | 9 | 9  | 19                            |
| Male                                            | 21           | 33                          | 57 | 10 | 0 | 10                            | 24           | 42                          | 42 | 4 | 13 | 17                            |
| English Proficient                              | 44           | 25                          | 59 | 14 | 2 | 16                            | 56           | 38                          | 45 | 7 | 11 | 18                            |
| Economically Disadvantaged                      | 17           | 29                          | 59 | 12 | 0 | 12                            | 26           | 46                          | 38 | 8 | 8  | 15                            |
| Not Economically Disadvantaged                  | 27           | 22                          | 59 | 15 | 4 | 19                            | 30           | 30                          | 50 | 7 | 13 | 20                            |
| Not Migrant                                     | 44           | 25                          | 59 | 14 | 2 | 16                            | 56           | 38                          | 45 | 7 | 11 | 18                            |

### Grade 7 Mathematics

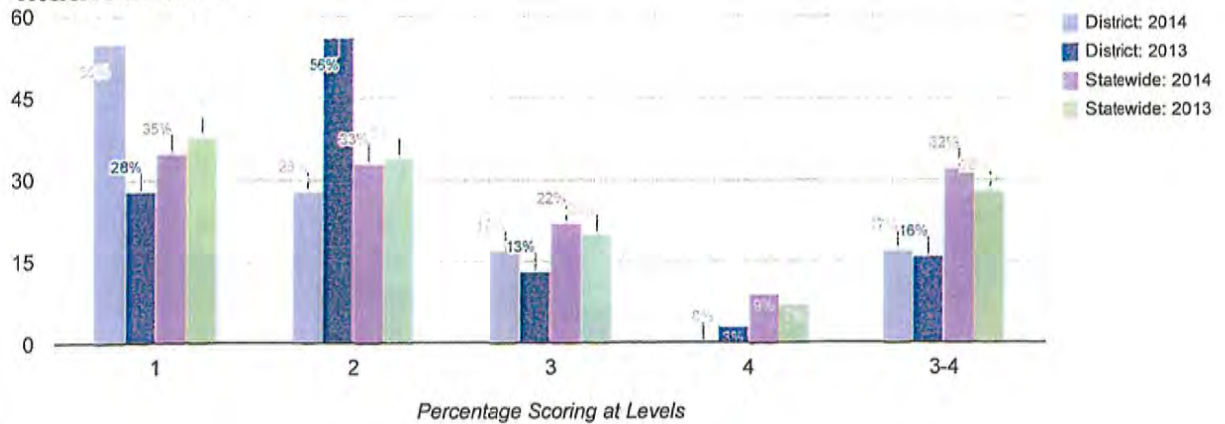

### Mean Score

2014

2013

287

301

| Results by Student Group       | 2014         |                             |    |    |   |                               | 2013         |                             |    |    |   |                               |
|--------------------------------|--------------|-----------------------------|----|----|---|-------------------------------|--------------|-----------------------------|----|----|---|-------------------------------|
|                                | Total Tested | Percent Scoring at Level(s) |    |    |   | % Proficient (Levels 3 and 4) | Total Tested | Percent Scoring at Level(s) |    |    |   | % Proficient (Levels 3 and 4) |
|                                |              | 1                           | 2  | 3  | 4 |                               |              | 1                           | 2  | 3  | 4 |                               |
| All Students                   | 29           | 55                          | 28 | 17 | 0 | 17                            | 32           | 28                          | 56 | 13 | 3 | 16                            |
| General Education              | 24           | 46                          | 33 | 21 | 0 | 21                            | 30           | -                           | -  | -  | - | -                             |
| Students with Disabilities     | 5            | 100                         | 0  | 0  | 0 | 0                             | 2            | -                           | -  | -  | - | -                             |
| Black or African American      | 1            | -                           | -  | -  | - | -                             | 0            | 0                           | 0  | 0  | 0 | 0                             |
| White                          | 27           | -                           | -  | -  | - | -                             | 31           | -                           | -  | -  | - | -                             |
| Multiracial                    | 1            | -                           | -  | -  | - | -                             | 1            | -                           | -  | -  | - | -                             |
| Small Group Total              | 29           | 55                          | 28 | 17 | 0 | 17                            | 32           | 28                          | 56 | 13 | 3 | 16                            |
| Female                         | 17           | 41                          | 41 | 18 | 0 | 18                            | 13           | 23                          | 77 | 0  | 0 | 0                             |
| Male                           | 12           | 75                          | 8  | 17 | 0 | 17                            | 19           | 32                          | 42 | 21 | 5 | 26                            |
| English Proficient             | 29           | 55                          | 28 | 17 | 0 | 17                            | 32           | 28                          | 56 | 13 | 3 | 16                            |
| Economically Disadvantaged     | 13           | 69                          | 15 | 15 | 0 | 15                            | 12           | 33                          | 42 | 25 | 0 | 25                            |
| Not Economically Disadvantaged | 16           | 44                          | 38 | 19 | 0 | 19                            | 20           | 25                          | 65 | 5  | 5 | 10                            |
| Not Migrant                    | 29           | 55                          | 28 | 17 | 0 | 17                            | 32           | 28                          | 56 | 13 | 3 | 16                            |



### Grade 8 Mathematics

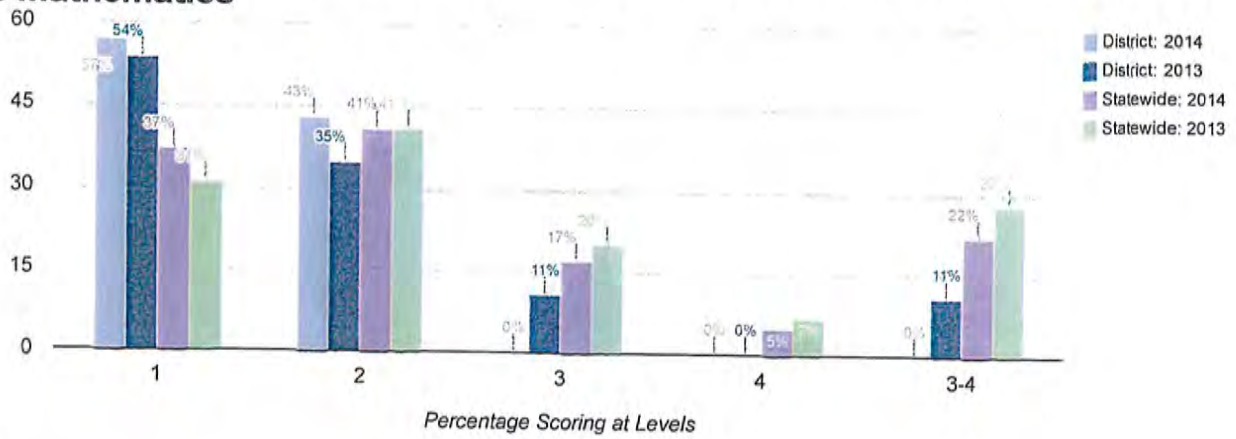

### Mean Score

| 2014 | 2013 |
|------|------|
| 259  | 285  |

| Results by Student Group       | 2014         |                             |    |   |   |                               | 2013         |                             |    |    |   |                               |
|--------------------------------|--------------|-----------------------------|----|---|---|-------------------------------|--------------|-----------------------------|----|----|---|-------------------------------|
|                                | Total Tested | Percent Scoring at Level(s) |    |   |   | % Proficient (Levels 3 and 4) | Total Tested | Percent Scoring at Level(s) |    |    |   | % Proficient (Levels 3 and 4) |
|                                |              | 1                           | 2  | 3 | 4 |                               |              | 1                           | 2  | 3  | 4 |                               |
| All Students                   | 7            | 57                          | 43 | 0 | 0 | 0                             | 46           | 54                          | 35 | 11 | 0 | 11                            |
| General Education              | 4            | -                           | -  | - | - | -                             | 38           | 47                          | 39 | 13 | 0 | 13                            |
| Students with Disabilities     | 3            | -                           | -  | - | - | -                             | 8            | 88                          | 13 | 0  | 0 | 0                             |
| Hispanic or Latino             | 0            | 0                           | 0  | 0 | 0 | 0                             | 4            | -                           | -  | -  | - | -                             |
| White                          | 7            | 57                          | 43 | 0 | 0 | 0                             | 42           | -                           | -  | -  | - | -                             |
| Small Group Total              | 0            | 0                           | 0  | 0 | 0 | 0                             | 46           | 54                          | 35 | 11 | 0 | 11                            |
| Female                         | 2            | -                           | -  | - | - | -                             | 26           | 58                          | 27 | 15 | 0 | 15                            |
| Male                           | 5            | -                           | -  | - | - | -                             | 20           | 50                          | 45 | 5  | 0 | 5                             |
| English Proficient             | 7            | 57                          | 43 | 0 | 0 | 0                             | 46           | 54                          | 35 | 11 | 0 | 11                            |
| Economically Disadvantaged     | 3            | -                           | -  | - | - | -                             | 20           | 55                          | 40 | 5  | 0 | 5                             |
| Not Economically Disadvantaged | 4            | -                           | -  | - | - | -                             | 26           | 54                          | 31 | 15 | 0 | 15                            |
| Not Migrant                    | 7            | 57                          | 43 | 0 | 0 | 0                             | 46           | 54                          | 35 | 11 | 0 | 11                            |

### Grade 4 Science

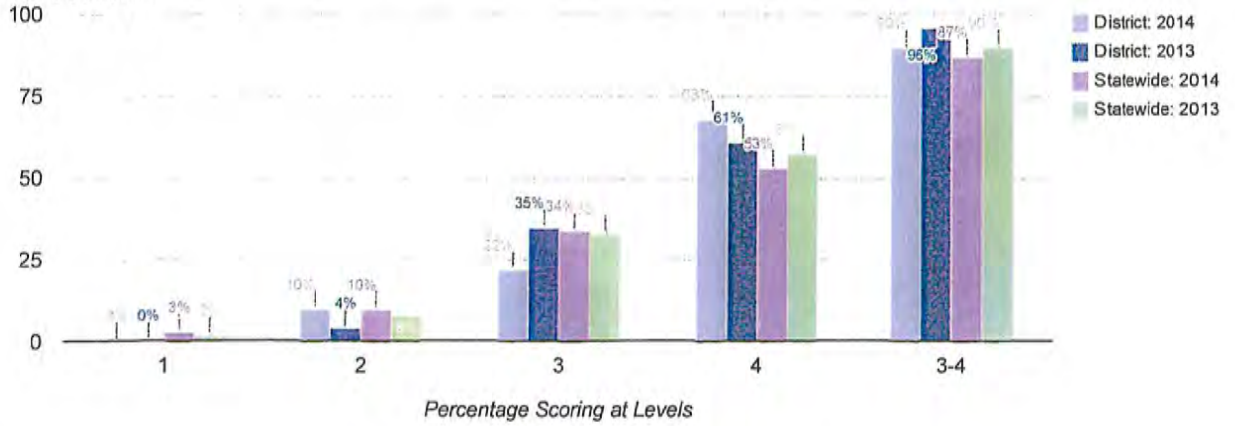

### Mean Score

2014

2013

86

86

| Results by Student Group                        | 2014         |                             |    |    |    |                               | 2013         |                             |    |    |    |                               |
|-------------------------------------------------|--------------|-----------------------------|----|----|----|-------------------------------|--------------|-----------------------------|----|----|----|-------------------------------|
|                                                 | Total Tested | Percent Scoring at Level(s) |    |    |    | % Proficient (Levels 3 and 4) | Total Tested | Percent Scoring at Level(s) |    |    |    | % Proficient (Levels 3 and 4) |
|                                                 |              | 1                           | 2  | 3  | 4  |                               |              | 1                           | 2  | 3  | 4  |                               |
| All Students                                    | 41           | 0                           | 10 | 22 | 68 | 90                            | 51           | 0                           | 4  | 35 | 61 | 96                            |
| General Education                               | 35           | 0                           | 9  | 14 | 77 | 91                            | 46           | 0                           | 2  | 35 | 63 | 98                            |
| Students with Disabilities                      | 6            | 0                           | 17 | 67 | 17 | 83                            | 5            | 0                           | 20 | 40 | 40 | 80                            |
| Asian or Native Hawaiian/Other Pacific Islander | 0            | 0                           | 0  | 0  | 0  | 0                             | 2            | -                           | -  | -  | -  | -                             |
| Hispanic or Latino                              | 2            | -                           | -  | -  | -  | -                             | 2            | -                           | -  | -  | -  | -                             |
| White                                           | 37           | -                           | -  | -  | -  | -                             | 45           | 0                           | 4  | 38 | 58 | 96                            |
| Multiracial                                     | 2            | -                           | -  | -  | -  | -                             | 2            | -                           | -  | -  | -  | -                             |
| Small Group Total                               | 41           | 0                           | 10 | 22 | 68 | 90                            | 6            | 0                           | 0  | 17 | 83 | 100                           |
| Female                                          | 19           | 0                           | 16 | 21 | 63 | 84                            | 26           | 0                           | 4  | 38 | 58 | 96                            |
| Male                                            | 22           | 0                           | 5  | 23 | 73 | 95                            | 25           | 0                           | 4  | 32 | 64 | 96                            |
| English Proficient                              | 41           | 0                           | 10 | 22 | 68 | 90                            | 51           | 0                           | 4  | 35 | 61 | 96                            |
| Economically Disadvantaged                      | 20           | 0                           | 10 | 20 | 70 | 90                            | 18           | 0                           | 11 | 56 | 33 | 89                            |
| Not Economically Disadvantaged                  | 21           | 0                           | 10 | 24 | 67 | 90                            | 33           | 0                           | 0  | 24 | 76 | 100                           |
| Not Migrant                                     | 41           | 0                           | 10 | 22 | 68 | 90                            | 51           | 0                           | 4  | 35 | 61 | 96                            |

### Grade 8 Science

Data in the bar charts include those for grade 8 students who took the New York State Grade 8 Science Test and grade 8 students who took a Regents science test in lieu of this test. Mean scores and data in the table for grade 8 science include only those for grade 8 students who took the New York State Grade 8 Science Test.

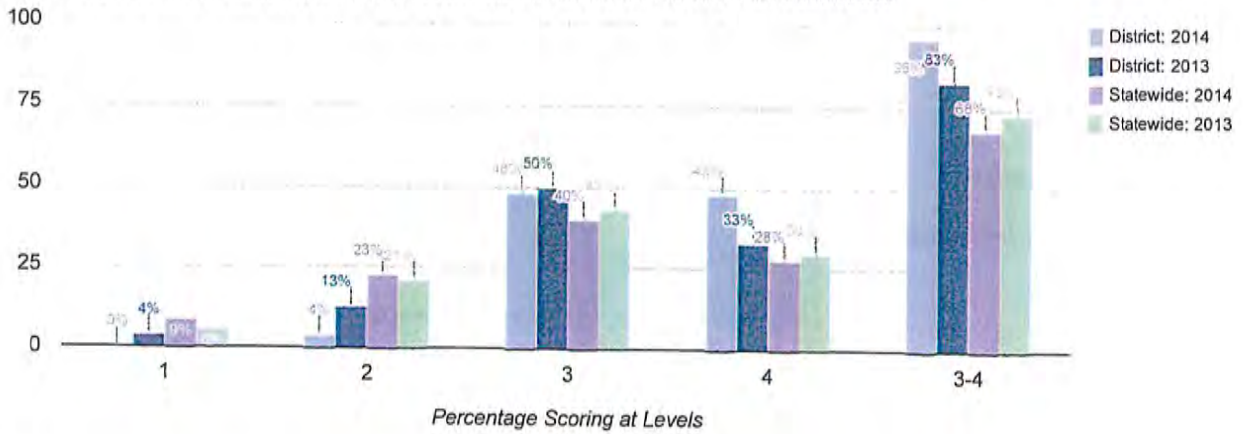

### Mean Score

2014

2013

82

77

| Results by Student Group       | 2014         |                             |   |    |    | 2013                          |              |                             |    |    |    |                               |
|--------------------------------|--------------|-----------------------------|---|----|----|-------------------------------|--------------|-----------------------------|----|----|----|-------------------------------|
|                                | Total Tested | Percent Scoring at Level(s) |   |    |    | % Proficient (Levels 3 and 4) | Total Tested | Percent Scoring at Level(s) |    |    |    | % Proficient (Levels 3 and 4) |
|                                |              | 1                           | 2 | 3  | 4  |                               |              | 1                           | 2  | 3  | 4  |                               |
| All Students                   | 27           | 0                           | 4 | 48 | 48 | 96                            | 48           | 4                           | 13 | 50 | 33 | 83                            |
| General Education              | 24           | -                           | - | -  | -  | -                             | 40           | 0                           | 8  | 55 | 38 | 93                            |
| Students with Disabilities     | 3            | -                           | - | -  | -  | -                             | 8            | 25                          | 38 | 25 | 13 | 38                            |
| Hispanic or Latino             | 0            | 0                           | 0 | 0  | 0  | 0                             | 4            | -                           | -  | -  | -  | -                             |
| White                          | 26           | -                           | - | -  | -  | -                             | 44           | -                           | -  | -  | -  | -                             |
| Multiracial                    | 1            | -                           | - | -  | -  | -                             | 0            | 0                           | 0  | 0  | 0  | 0                             |
| Small Group Total              | 27           | 0                           | 4 | 48 | 48 | 96                            | 48           | 4                           | 13 | 50 | 33 | 83                            |
| Female                         | 12           | 0                           | 0 | 58 | 42 | 100                           | 28           | 0                           | 14 | 57 | 29 | 86                            |
| Male                           | 15           | 0                           | 7 | 40 | 53 | 93                            | 20           | 10                          | 10 | 40 | 40 | 80                            |
| English Proficient             | 27           | 0                           | 4 | 48 | 48 | 96                            | 48           | 4                           | 13 | 50 | 33 | 83                            |
| Economically Disadvantaged     | 7            | 0                           | 0 | 57 | 43 | 100                           | 21           | 0                           | 19 | 48 | 33 | 81                            |
| Not Economically Disadvantaged | 20           | 0                           | 5 | 45 | 50 | 95                            | 27           | 7                           | 7  | 52 | 33 | 85                            |
| Not Migrant                    | 27           | 0                           | 4 | 48 | 48 | 96                            | 48           | 4                           | 13 | 50 | 33 | 83                            |

## Statewide Results on the National Assessment of Educational Progress: NAEP (2012 - 13)

### NAEP Grade 4 Reading

|                                                 | % Below Basic | % Basic | % Proficient | % Advanced |
|-------------------------------------------------|---------------|---------|--------------|------------|
| All Students                                    | 30            | 33      | 28           | 9          |
| American Indian or Alaska Native                | *             | *       | *            | *          |
| Asian or Native Hawaiian/Other Pacific Islander | 19            | 27      | 36           | 18         |
| Black or African American                       | 45            | 34      | 18           | 3          |
| Hispanic or Latino                              | 44            | 35      | 17           | 4          |
| White                                           | 20            | 33      | 35           | 12         |
| Multiracial                                     | *             | *       | *            | *          |
| Students with Disabilities                      | 69            | 22      | 7            | 2          |
| Limited English Proficient                      | 75            | 21      | 4            | *          |
| Economically Disadvantaged                      | 43            | 34      | 19           | 4          |

### NAEP Grade 4 Mathematics

|                                                 | % Below Basic | % Basic | % Proficient | % Advanced |
|-------------------------------------------------|---------------|---------|--------------|------------|
| All Students                                    | 18            | 42      | 33           | 7          |
| American Indian or Alaska Native                | *             | *       | *            | *          |
| Asian or Native Hawaiian/Other Pacific Islander | 6             | 25      | 48           | 21         |
| Black or African American                       | 33            | 50      | 16           | 1          |
| Hispanic or Latino                              | 27            | 49      | 22           | 2          |
| White                                           | 9             | 41      | 42           | 8          |
| Multiracial                                     | *             | *       | *            | *          |
| Students with Disabilities                      | 43            | 42      | 14           | 1          |
| Limited English Proficient                      | 54            | 36      | 10           | *          |
| Economically Disadvantaged                      | 26            | 48      | 23           | 3          |

\*Reporting standards not met.

# Statewide Results on the National Assessment of Educational Progress: NAEP (2012 - 13)

## NAEP Grade 8 Reading

|                                                 | % Below Basic | % Basic | % Proficient | % Advanced |
|-------------------------------------------------|---------------|---------|--------------|------------|
| All Students                                    | 24            | 41      | 30           | 5          |
| American Indian or Alaska Native                | *             | *       | *            | *          |
| Asian or Native Hawaiian/Other Pacific Islander | 17            | 33      | 38           | 12         |
| Black or African American                       | 37            | 45      | 17           | 1          |
| Hispanic or Latino                              | 36            | 45      | 18           | 1          |
| White                                           | 14            | 40      | 40           | 6          |
| Multiracial                                     | *             | *       | *            | *          |
| Students with Disabilities                      | 56            | 36      | 8            | *          |
| Limited English Proficient                      | 80            | 19      | 1            | *          |
| Economically Disadvantaged                      | 35            | 44      | 20           | 1          |

## NAEP Grade 8 Mathematics

|                                                 | % Below Basic | % Basic | % Proficient | % Advanced |
|-------------------------------------------------|---------------|---------|--------------|------------|
| All Students                                    | 28            | 40      | 24           | 8          |
| American Indian or Alaska Native                | *             | *       | *            | *          |
| Asian or Native Hawaiian/Other Pacific Islander | 14            | 27      | 33           | 26         |
| Black or African American                       | 50            | 38      | 11           | 1          |
| Hispanic or Latino                              | 44            | 42      | 12           | 2          |
| White                                           | 15            | 41      | 34           | 10         |
| Multiracial                                     | *             | *       | *            | *          |
| Students with Disabilities                      | 66            | 27      | 6            | 1          |
| Limited English Proficient                      | 75            | 21      | 3            | 1          |
| Economically Disadvantaged                      | 42            | 39      | 15           | 4          |

\*Reporting standards not met.

# Statewide Results on the National Assessment of Educational Progress: NAEP (2012 - 13)

## NAEP Participation Rates

### Grade 4 Reading

#### Participation Rate

Students with Disabilities

94

Limited English Proficient

93

### Grade 4 Mathematics

#### Participation Rate

Students with Disabilities

94

Limited English Proficient

93

### Grade 8 Reading

#### Participation Rate

Students with Disabilities

97

Limited English Proficient

91

### Grade 8 Mathematics

#### Participation Rate

Students with Disabilities

89

Limited English Proficient

94

# Total Cohort Results in Secondary-Level English Language Arts after Four Years of Instruction

Total cohort results are those for New York State Regents and alternatives to Regents examinations only.

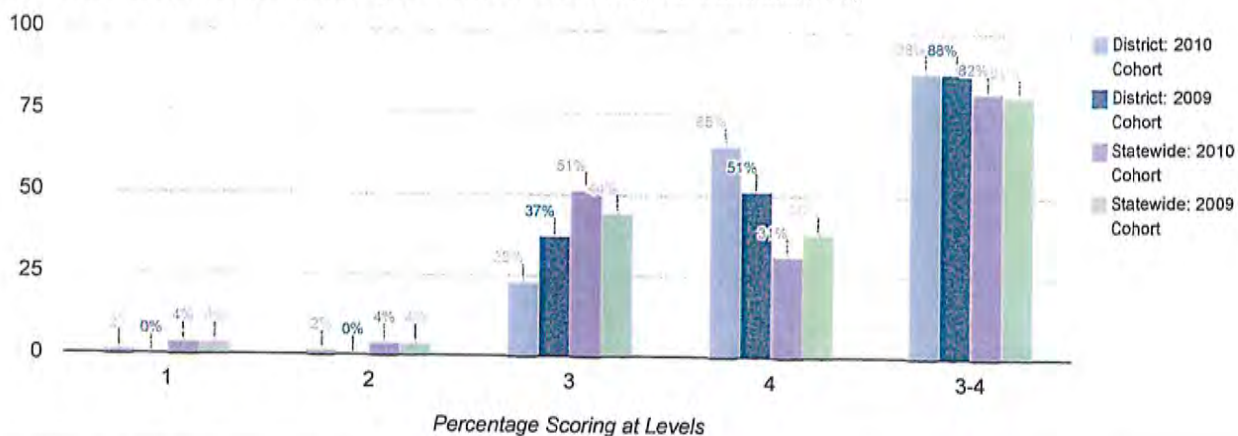

| Results by Student Group                        | 2010 Cohort        |                             |    |    |           |                                 | 2009 Cohort        |                             |   |    |    |                               |
|-------------------------------------------------|--------------------|-----------------------------|----|----|-----------|---------------------------------|--------------------|-----------------------------|---|----|----|-------------------------------|
|                                                 | Number of Students | Percent Scoring at Level(s) |    |    |           | % Proficient (Levels 3 & above) | Number of Students | Percent Scoring at Level(s) |   |    |    | % Proficient (Levels 3 and 4) |
|                                                 |                    | 1                           | 2  | 3  | 4 & above |                                 |                    | 1                           | 2 | 3  | 4  |                               |
| All Students                                    | 43                 | 2                           | 2  | 23 | 65        | 88                              | 51                 | 0                           | 0 | 37 | 51 | 88                            |
| General Education                               | 38                 | 0                           | 0  | 24 | 68        | 92                              | 43                 | 0                           | 0 | 37 | 58 | 95                            |
| Students with Disabilities                      | 5                  | 20                          | 20 | 20 | 40        | 60                              | 8                  | 0                           | 0 | 38 | 13 | 50                            |
| American Indian or Alaska Native                | 0                  | 0                           | 0  | 0  | 0         | 0                               | 1                  | -                           | - | -  | -  | -                             |
| Asian or Native Hawaiian/Other Pacific Islander | 3                  | -                           | -  | -  | -         | -                               | 0                  | 0                           | 0 | 0  | 0  | 0                             |
| Black or African American                       | 2                  | -                           | -  | -  | -         | -                               | 0                  | 0                           | 0 | 0  | 0  | 0                             |
| Hispanic or Latino                              | 0                  | 0                           | 0  | 0  | 0         | 0                               | 1                  | -                           | - | -  | -  | -                             |
| White                                           | 38                 | 3                           | 3  | 21 | 68        | 89                              | 49                 | -                           | - | -  | -  | -                             |
| Small Group Total                               | 5                  | 0                           | 0  | 40 | 40        | 80                              | 51                 | 0                           | 0 | 37 | 51 | 88                            |
| Female                                          | 19                 | 0                           | 5  | 26 | 58        | 84                              | 27                 | 0                           | 0 | 33 | 59 | 93                            |
| Male                                            | 24                 | 4                           | 0  | 21 | 71        | 92                              | 24                 | 0                           | 0 | 42 | 42 | 83                            |
| English Proficient                              | 43                 | 2                           | 2  | 23 | 65        | 88                              | 51                 | 0                           | 0 | 37 | 51 | 88                            |
| Economically Disadvantaged                      | 6                  | 0                           | 0  | 33 | 50        | 83                              | 11                 | 0                           | 0 | 45 | 36 | 82                            |
| Not Economically Disadvantaged                  | 37                 | 3                           | 3  | 22 | 68        | 89                              | 40                 | 0                           | 0 | 35 | 55 | 90                            |
| Not Migrant                                     | 43                 | 2                           | 2  | 23 | 65        | 88                              | 51                 | 0                           | 0 | 37 | 51 | 88                            |

## Total Cohort Results in Secondary-Level Mathematics after Four Years of Instruction

Total cohort results are those for New York State Regents and alternatives to Regents examinations only.

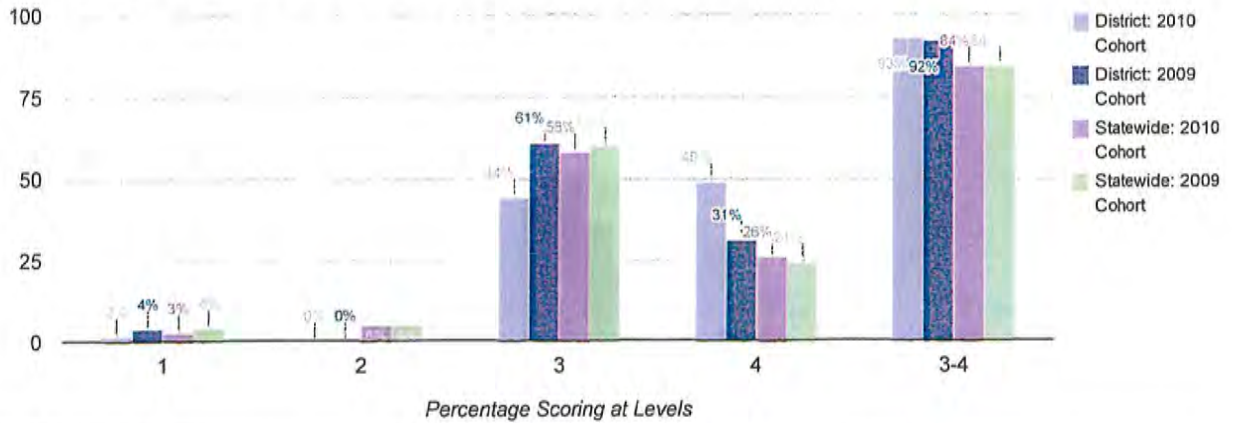

| Results by Student Group                        | 2010 Cohort        |                             |   |    |           | 2009 Cohort                     |                    |                             |   |    |    |                               |
|-------------------------------------------------|--------------------|-----------------------------|---|----|-----------|---------------------------------|--------------------|-----------------------------|---|----|----|-------------------------------|
|                                                 | Number of Students | Percent Scoring at Level(s) |   |    |           | % Proficient (Levels 3 & above) | Number of Students | Percent Scoring at Level(s) |   |    |    | % Proficient (Levels 3 and 4) |
|                                                 |                    | 1                           | 2 | 3  | 4 & above |                                 | 1                  | 2                           | 3 | 4  |    |                               |
| All Students                                    | 43                 | 2                           | 0 | 44 | 49        | 93                              | 51                 | 4                           | 0 | 61 | 31 | 92                            |
| General Education                               | 38                 | 0                           | 0 | 45 | 55        | 100                             | 43                 | 0                           | 0 | 63 | 37 | 100                           |
| Students with Disabilities                      | 5                  | 20                          | 0 | 40 | 0         | 40                              | 8                  | 25                          | 0 | 50 | 0  | 50                            |
| American Indian or Alaska Native                | 0                  | 0                           | 0 | 0  | 0         | 0                               | 1                  | -                           | - | -  | -  | -                             |
| Asian or Native Hawaiian/Other Pacific Islander | 3                  | -                           | - | -  | -         | -                               | 0                  | 0                           | 0 | 0  | 0  | 0                             |
| Black or African American                       | 2                  | -                           | - | -  | -         | -                               | 0                  | 0                           | 0 | 0  | 0  | 0                             |
| Hispanic or Latino                              | 0                  | 0                           | 0 | 0  | 0         | 0                               | 1                  | -                           | - | -  | -  | -                             |
| White                                           | 38                 | 3                           | 0 | 45 | 47        | 92                              | 49                 | -                           | - | -  | -  | -                             |
| Small Group Total                               | 5                  | 0                           | 0 | 40 | 60        | 100                             | 51                 | 4                           | 0 | 61 | 31 | 92                            |
| Female                                          | 19                 | 5                           | 0 | 63 | 32        | 95                              | 27                 | 0                           | 0 | 48 | 48 | 96                            |
| Male                                            | 24                 | 0                           | 0 | 29 | 63        | 92                              | 24                 | 8                           | 0 | 75 | 13 | 88                            |
| English Proficient                              | 43                 | 2                           | 0 | 44 | 49        | 93                              | 51                 | 4                           | 0 | 61 | 31 | 92                            |
| Economically Disadvantaged                      | 6                  | 0                           | 0 | 33 | 50        | 83                              | 11                 | 0                           | 0 | 82 | 9  | 91                            |
| Not Economically Disadvantaged                  | 37                 | 3                           | 0 | 46 | 49        | 95                              | 40                 | 5                           | 0 | 55 | 38 | 93                            |
| Not Migrant                                     | 43                 | 2                           | 0 | 44 | 49        | 93                              | 51                 | 4                           | 0 | 61 | 31 | 92                            |



## Total Cohort Results in Secondary-Level Global History and Geography after Four Years of Instruction

Total cohort results are those for New York State Regents and alternatives to Regents examinations only.

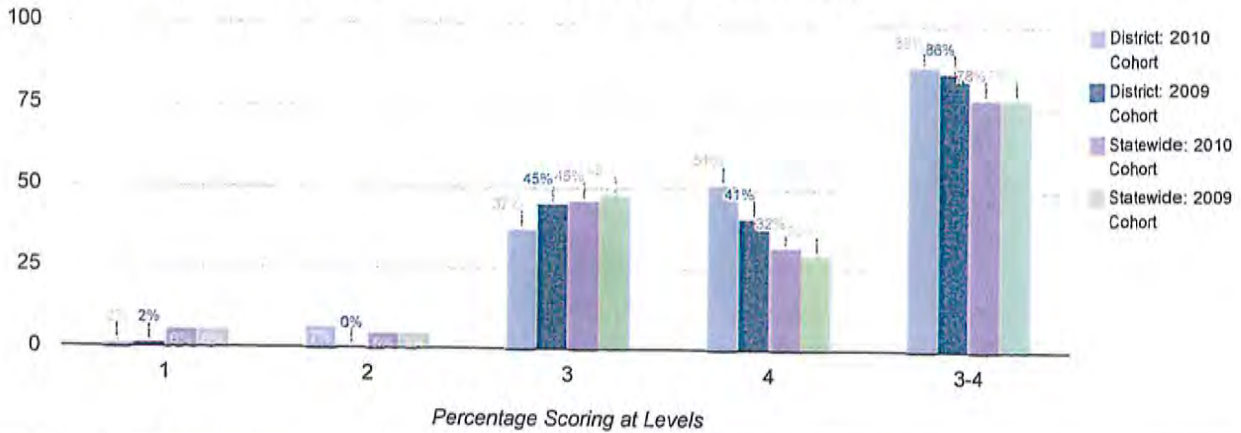

| Results by Student Group                        | 2010 Cohort        |                             |    |    |    | % Proficient (Levels 3 and 4) | 2009 Cohort        |                             |   |    |    | % Proficient (Levels 3 and 4) |
|-------------------------------------------------|--------------------|-----------------------------|----|----|----|-------------------------------|--------------------|-----------------------------|---|----|----|-------------------------------|
|                                                 | Number of Students | Percent Scoring at Level(s) |    |    |    |                               | Number of Students | Percent Scoring at Level(s) |   |    |    |                               |
|                                                 |                    | 1                           | 2  | 3  | 4  |                               | 1                  | 2                           | 3 | 4  |    |                               |
| All Students                                    | 43                 | 2                           | 7  | 37 | 51 | 88                            | 51                 | 2                           | 0 | 45 | 41 | 86                            |
| General Education                               | 38                 | 0                           | 3  | 39 | 55 | 95                            | 43                 | 0                           | 0 | 47 | 47 | 93                            |
| Students with Disabilities                      | 5                  | 20                          | 40 | 20 | 20 | 40                            | 8                  | 13                          | 0 | 38 | 13 | 50                            |
| American Indian or Alaska Native                | 0                  | 0                           | 0  | 0  | 0  | 0                             | 1                  | -                           | - | -  | -  | -                             |
| Asian or Native Hawaiian/Other Pacific Islander | 3                  | -                           | -  | -  | -  | -                             | 0                  | 0                           | 0 | 0  | 0  | 0                             |
| Black or African American                       | 2                  | -                           | -  | -  | -  | -                             | 0                  | 0                           | 0 | 0  | 0  | 0                             |
| Hispanic or Latino                              | 0                  | 0                           | 0  | 0  | 0  | 0                             | 1                  | -                           | - | -  | -  | -                             |
| White                                           | 38                 | 3                           | 5  | 39 | 50 | 89                            | 49                 | -                           | - | -  | -  | -                             |
| Small Group Total                               | 5                  | 0                           | 20 | 20 | 60 | 80                            | 51                 | 2                           | 0 | 45 | 41 | 86                            |
| Female                                          | 19                 | 0                           | 16 | 53 | 32 | 84                            | 27                 | 0                           | 0 | 41 | 56 | 96                            |
| Male                                            | 24                 | 4                           | 0  | 25 | 67 | 92                            | 24                 | 4                           | 0 | 50 | 25 | 75                            |
| English Proficient                              | 43                 | 2                           | 7  | 37 | 51 | 88                            | 51                 | 2                           | 0 | 45 | 41 | 86                            |
| Economically Disadvantaged                      | 6                  | 0                           | 0  | 50 | 50 | 100                           | 11                 | 0                           | 0 | 55 | 27 | 82                            |
| Not Economically Disadvantaged                  | 37                 | 3                           | 8  | 35 | 51 | 86                            | 40                 | 3                           | 0 | 43 | 45 | 88                            |
| Not Migrant                                     | 43                 | 2                           | 7  | 37 | 51 | 88                            | 51                 | 2                           | 0 | 45 | 41 | 86                            |

### Total Cohort Results in Secondary-Level U.S. History and Government after Four Years of Instruction

Total cohort results are those for New York State Regents and alternatives to Regents examinations only.

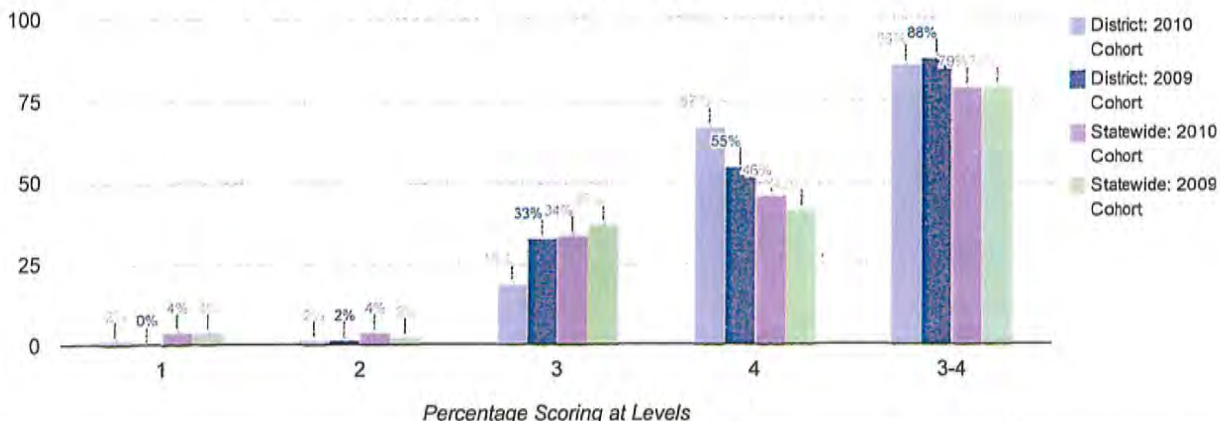

| Results by Student Group                        | 2010 Cohort        |                             |   |    |    | 2009 Cohort                   |                    |                             |    |    |    |                               |
|-------------------------------------------------|--------------------|-----------------------------|---|----|----|-------------------------------|--------------------|-----------------------------|----|----|----|-------------------------------|
|                                                 | Number of Students | Percent Scoring at Level(s) |   |    |    | % Proficient (Levels 3 and 4) | Number of Students | Percent Scoring at Level(s) |    |    |    | % Proficient (Levels 3 and 4) |
|                                                 |                    | 1                           | 2 | 3  | 4  |                               | 1                  | 2                           | 3  | 4  |    |                               |
| All Students                                    | 43                 | 2                           | 2 | 19 | 67 | 86                            | 51                 | 0                           | 2  | 33 | 55 | 88                            |
| General Education                               | 38                 | 0                           | 3 | 16 | 74 | 89                            | 43                 | 0                           | 0  | 35 | 60 | 95                            |
| Students with Disabilities                      | 5                  | 20                          | 0 | 40 | 20 | 60                            | 8                  | 0                           | 13 | 25 | 25 | 50                            |
| American Indian or Alaska Native                | 0                  | 0                           | 0 | 0  | 0  | 0                             | 1                  | -                           | -  | -  | -  | -                             |
| Asian or Native Hawaiian/Other Pacific Islander | 3                  | -                           | - | -  | -  | -                             | 0                  | 0                           | 0  | 0  | 0  | 0                             |
| Black or African American                       | 2                  | -                           | - | -  | -  | -                             | 0                  | 0                           | 0  | 0  | 0  | 0                             |
| Hispanic or Latino                              | 0                  | 0                           | 0 | 0  | 0  | 0                             | 1                  | -                           | -  | -  | -  | -                             |
| White                                           | 38                 | 3                           | 3 | 21 | 66 | 87                            | 49                 | -                           | -  | -  | -  | -                             |
| Small Group Total                               | 5                  | 0                           | 0 | 0  | 80 | 80                            | 51                 | 0                           | 2  | 33 | 55 | 88                            |
| Female                                          | 19                 | 0                           | 5 | 32 | 53 | 84                            | 27                 | 0                           | 0  | 30 | 63 | 93                            |
| Male                                            | 24                 | 4                           | 0 | 8  | 79 | 88                            | 24                 | 0                           | 4  | 38 | 46 | 83                            |
| English Proficient                              | 43                 | 2                           | 2 | 19 | 67 | 86                            | 51                 | 0                           | 2  | 33 | 55 | 88                            |
| Economically Disadvantaged                      | 6                  | 0                           | 0 | 0  | 67 | 67                            | 11                 | 0                           | 0  | 36 | 45 | 82                            |
| Not Economically Disadvantaged                  | 37                 | 3                           | 3 | 22 | 68 | 89                            | 40                 | 0                           | 3  | 33 | 58 | 90                            |
| Not Migrant                                     | 43                 | 2                           | 2 | 19 | 67 | 86                            | 51                 | 0                           | 2  | 33 | 55 | 88                            |

### Total Cohort Results in Secondary-Level Science after Four Years of Instruction

Total cohort results are those for New York State Regents and alternatives to Regents examinations only.

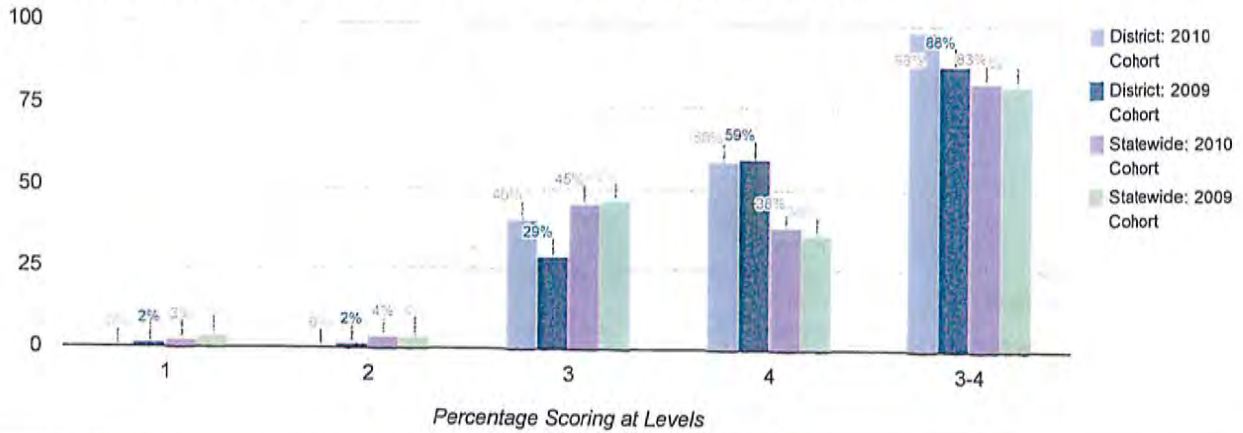

| Results by Student Group                        | 2010 Cohort        |                             |   |    |    | 2009 Cohort                   |                    |                             |    |    |    |                               |
|-------------------------------------------------|--------------------|-----------------------------|---|----|----|-------------------------------|--------------------|-----------------------------|----|----|----|-------------------------------|
|                                                 | Number of Students | Percent Scoring at Level(s) |   |    |    | % Proficient (Levels 3 and 4) | Number of Students | Percent Scoring at Level(s) |    |    |    | % Proficient (Levels 3 and 4) |
|                                                 |                    | 1                           | 2 | 3  | 4  |                               |                    | 1                           | 2  | 3  | 4  |                               |
| All Students                                    | 43                 | 0                           | 0 | 40 | 58 | 98                            | 51                 | 2                           | 2  | 29 | 59 | 88                            |
| General Education                               | 38                 | 0                           | 0 | 37 | 63 | 100                           | 43                 | 0                           | 0  | 28 | 67 | 95                            |
| Students with Disabilities                      | 5                  | 0                           | 0 | 60 | 20 | 80                            | 8                  | 13                          | 13 | 38 | 13 | 50                            |
| American Indian or Alaska Native                | 0                  | 0                           | 0 | 0  | 0  | 0                             | 1                  | -                           | -  | -  | -  | -                             |
| Asian or Native Hawaiian/Other Pacific Islander | 3                  | -                           | - | -  | -  | -                             | 0                  | 0                           | 0  | 0  | 0  | 0                             |
| Black or African American                       | 2                  | -                           | - | -  | -  | -                             | 0                  | 0                           | 0  | 0  | 0  | 0                             |
| Hispanic or Latino                              | 0                  | 0                           | 0 | 0  | 0  | 0                             | 1                  | -                           | -  | -  | -  | -                             |
| White                                           | 38                 | 0                           | 0 | 39 | 58 | 97                            | 49                 | -                           | -  | -  | -  | -                             |
| Small Group Total                               | 5                  | 0                           | 0 | 40 | 60 | 100                           | 51                 | 2                           | 2  | 29 | 59 | 88                            |
| Female                                          | 19                 | 0                           | 0 | 53 | 47 | 100                           | 27                 | 0                           | 0  | 26 | 70 | 96                            |
| Male                                            | 24                 | 0                           | 0 | 29 | 67 | 96                            | 24                 | 4                           | 4  | 33 | 46 | 79                            |
| English Proficient                              | 43                 | 0                           | 0 | 40 | 58 | 98                            | 51                 | 2                           | 2  | 29 | 59 | 88                            |
| Economically Disadvantaged                      | 6                  | 0                           | 0 | 33 | 67 | 100                           | 11                 | 0                           | 0  | 64 | 27 | 91                            |
| Not Economically Disadvantaged                  | 37                 | 0                           | 0 | 41 | 57 | 97                            | 40                 | 3                           | 3  | 20 | 68 | 88                            |
| Not Migrant                                     | 43                 | 0                           | 0 | 40 | 58 | 98                            | 51                 | 2                           | 2  | 29 | 59 | 88                            |

### Regents Examination Results (2013 - 14)

Results by Student Group

Comprehensive English

Integrated Algebra

|                                                 | Total Tested | Percent of students scoring at or above |    |    | Total Tested | Percent of students scoring at or above |    |    |
|-------------------------------------------------|--------------|-----------------------------------------|----|----|--------------|-----------------------------------------|----|----|
|                                                 |              | 55                                      | 65 | 85 |              | 55                                      | 65 | 85 |
|                                                 |              |                                         |    |    |              |                                         |    |    |
| All Students                                    | 52           | 94                                      | 88 | 48 | 57           | 82                                      | 74 | 25 |
| General Education                               | 42           | 100                                     | 98 | 57 | 45           | 87                                      | 82 | 31 |
| Students with Disabilities                      | 10           | 70                                      | 50 | 10 | 12           | 67                                      | 42 | 0  |
| American Indian or Alaska Native                | 1            | -                                       | -  | -  | 1            | -                                       | -  | -  |
| Asian or Native Hawaiian/Other Pacific Islander | 0            | 0                                       | 0  | 0  | 0            | 0                                       | 0  | 0  |
| Black or African American                       | 0            | 0                                       | 0  | 0  | 0            | 0                                       | 0  | 0  |
| Hispanic or Latino                              | 0            | 0                                       | 0  | 0  | 3            | -                                       | -  | -  |
| White                                           | 51           | -                                       | -  | -  | 52           | 85                                      | 75 | 23 |
| Multiracial                                     | 0            | 0                                       | 0  | 0  | 1            | -                                       | -  | -  |
| Small Group Total                               | 52           | 94                                      | 88 | 48 | 5            | 60                                      | 60 | 40 |
| Female                                          | 22           | 95                                      | 91 | 64 | 29           | 76                                      | 76 | 31 |
| Male                                            | 30           | 93                                      | 87 | 37 | 28           | 89                                      | 71 | 18 |
| English Proficient                              | 52           | 94                                      | 88 | 48 | 57           | 82                                      | 74 | 25 |
| Economically Disadvantaged                      | 12           | 100                                     | 92 | 33 | 20           | 85                                      | 80 | 15 |
| Not Economically Disadvantaged                  | 40           | 93                                      | 88 | 53 | 37           | 81                                      | 70 | 30 |
| Not Migrant                                     | 52           | 94                                      | 88 | 48 | 57           | 82                                      | 74 | 25 |

# Regents Examination Results (2013 - 14)

## Results by Student Group

### English Language Arts (Common Core)

### Algebra I (Common Core)

|                                                 | Total Tested | Percent of students scoring at |         |         |         |         | Total Tested | Percent of students scoring at |         |         |         |         |
|-------------------------------------------------|--------------|--------------------------------|---------|---------|---------|---------|--------------|--------------------------------|---------|---------|---------|---------|
|                                                 |              | Level 1                        | Level 2 | Level 3 | Level 4 | Level 5 |              | Level 1                        | Level 2 | Level 3 | Level 4 | Level 5 |
|                                                 |              |                                |         |         |         |         |              |                                |         |         |         |         |
| All Students                                    | 38           | 11                             | 3       | 45      | 21      | 21      | 36           | 8                              | 25      | 61      | 6       | 0       |
| General Education                               | 35           | -                              | -       | -       | -       | -       | 32           | -                              | -       | -       | -       | -       |
| Students with Disabilities                      | 3            | -                              | -       | -       | -       | -       | 4            | -                              | -       | -       | -       | -       |
| American Indian or Alaska Native                | 0            | 0                              | 0       | 0       | 0       | 0       | 0            | 0                              | 0       | 0       | 0       | 0       |
| Asian or Native Hawaiian/Other Pacific Islander | 0            | 0                              | 0       | 0       | 0       | 0       | 0            | 0                              | 0       | 0       | 0       | 0       |
| Black or African American                       | 0            | 0                              | 0       | 0       | 0       | 0       | 0            | 0                              | 0       | 0       | 0       | 0       |
| Hispanic or Latino                              | 0            | 0                              | 0       | 0       | 0       | 0       | 2            | -                              | -       | -       | -       | -       |
| White                                           | 38           | 11                             | 3       | 45      | 21      | 21      | 33           | -                              | -       | -       | -       | -       |
| Multiracial                                     | 0            | 0                              | 0       | 0       | 0       | 0       | 1            | -                              | -       | -       | -       | -       |
| Small Group Total                               | 0            | 0                              | 0       | 0       | 0       | 0       | 36           | 8                              | 25      | 61      | 6       | 0       |
| Female                                          | 13           | 8                              | 0       | 38      | 15      | 38      | 20           | 10                             | 30      | 55      | 5       | 0       |
| Male                                            | 25           | 12                             | 4       | 48      | 24      | 12      | 16           | 6                              | 19      | 69      | 6       | 0       |
| English Proficient                              | 38           | 11                             | 3       | 45      | 21      | 21      | 36           | 8                              | 25      | 61      | 6       | 0       |
| Economically Disadvantaged                      | 11           | 0                              | 0       | 64      | 18      | 18      | 13           | 0                              | 15      | 77      | 8       | 0       |
| Not Economically Disadvantaged                  | 27           | 15                             | 4       | 37      | 22      | 22      | 23           | 13                             | 30      | 52      | 4       | 0       |
| Not Migrant                                     | 38           | 11                             | 3       | 45      | 21      | 21      | 36           | 8                              | 25      | 61      | 6       | 0       |

### Regents Examination Results (2013 - 14)

Results by Student Group

Geometry

Algebra 2/Trigonometry

|                                                 | Total Tested | Percent of students scoring at or above |    |    | Total Tested | Percent of students scoring at or above |    |    |
|-------------------------------------------------|--------------|-----------------------------------------|----|----|--------------|-----------------------------------------|----|----|
|                                                 |              | 55                                      | 65 | 85 |              | 55                                      | 65 | 85 |
| All Students                                    | 41           | 93                                      | 88 | 46 | 40           | 50                                      | 33 | 5  |
| General Education                               | 40           | -                                       | -  | -  | 39           | -                                       | -  | -  |
| Students with Disabilities                      | 1            | -                                       | -  | -  | 1            | -                                       | -  | -  |
| American Indian or Alaska Native                | 0            | 0                                       | 0  | 0  | 0            | 0                                       | 0  | 0  |
| Asian or Native Hawaiian/Other Pacific Islander | 1            | -                                       | -  | -  | 0            | 0                                       | 0  | 0  |
| Black or African American                       | 0            | 0                                       | 0  | 0  | 1            | -                                       | -  | -  |
| Hispanic or Latino                              | 0            | 0                                       | 0  | 0  | 0            | 0                                       | 0  | 0  |
| White                                           | 40           | -                                       | -  | -  | 39           | -                                       | -  | -  |
| Multiracial                                     | 0            | 0                                       | 0  | 0  | 0            | 0                                       | 0  | 0  |
| Small Group Total                               | 41           | 93                                      | 88 | 46 | 40           | 50                                      | 33 | 5  |
| Female                                          | 21           | 90                                      | 90 | 57 | 21           | 57                                      | 38 | 10 |
| Male                                            | 20           | 95                                      | 85 | 35 | 19           | 42                                      | 26 | 0  |
| English Proficient                              | 41           | 93                                      | 88 | 46 | 40           | 50                                      | 33 | 5  |
| Economically Disadvantaged                      | 12           | 92                                      | 92 | 42 | 11           | 55                                      | 27 | 0  |
| Not Economically Disadvantaged                  | 29           | 93                                      | 86 | 48 | 29           | 48                                      | 34 | 7  |
| Not Migrant                                     | 41           | 93                                      | 88 | 46 | 40           | 50                                      | 33 | 5  |

# Regents Examination Results (2013 - 14)

## Results by Student Group

### Global History and Geography

### U.S. History & Government

| Results by Student Group                        | Total Tested | Percent of students scoring at or above |    |    | Total Tested | Percent of students scoring at or above |     |    |
|-------------------------------------------------|--------------|-----------------------------------------|----|----|--------------|-----------------------------------------|-----|----|
|                                                 |              | 55                                      | 65 | 85 |              | 55                                      | 65  | 85 |
|                                                 |              |                                         |    |    |              |                                         |     |    |
| All Students                                    | 53           | 91                                      | 81 | 49 | 52           | 98                                      | 92  | 58 |
| General Education                               | 44           | 100                                     | 93 | 59 | 43           | 100                                     | 98  | 70 |
| Students with Disabilities                      | 9            | 44                                      | 22 | 0  | 9            | 89                                      | 67  | 0  |
| American Indian or Alaska Native                | 0            | 0                                       | 0  | 0  | 1            | -                                       | -   | -  |
| Asian or Native Hawaiian/Other Pacific Islander | 1            | -                                       | -  | -  | 0            | 0                                       | 0   | 0  |
| Black or African American                       | 1            | -                                       | -  | -  | 0            | 0                                       | 0   | 0  |
| Hispanic or Latino                              | 1            | -                                       | -  | -  | 0            | 0                                       | 0   | 0  |
| White                                           | 50           | -                                       | -  | -  | 51           | -                                       | -   | -  |
| Multiracial                                     | 0            | 0                                       | 0  | 0  | 0            | 0                                       | 0   | 0  |
| Small Group Total                               | 53           | 91                                      | 81 | 49 | 52           | 98                                      | 92  | 58 |
| Female                                          | 26           | 96                                      | 88 | 54 | 21           | 100                                     | 90  | 62 |
| Male                                            | 27           | 85                                      | 74 | 44 | 31           | 97                                      | 94  | 55 |
| English Proficient                              | 53           | 91                                      | 81 | 49 | 52           | 98                                      | 92  | 58 |
| Economically Disadvantaged                      | 16           | 100                                     | 88 | 50 | 13           | 100                                     | 100 | 62 |
| Not Economically Disadvantaged                  | 37           | 86                                      | 78 | 49 | 39           | 97                                      | 90  | 56 |
| Not Migrant                                     | 53           | 91                                      | 81 | 49 | 52           | 98                                      | 92  | 58 |

### Regents Examination Results (2013 - 14)

Results by Student Group

Living Environment

Physical Setting/Earth Science

|                                                 | Living Environment |                                         |     | Physical Setting/Earth Science |              |                                         |    |    |
|-------------------------------------------------|--------------------|-----------------------------------------|-----|--------------------------------|--------------|-----------------------------------------|----|----|
|                                                 | Total Tested       | Percent of students scoring at or above |     |                                | Total Tested | Percent of students scoring at or above |    |    |
|                                                 |                    | 55                                      | 65  | 85                             |              | 55                                      | 65 | 85 |
| All Students                                    | 43                 | 95                                      | 93  | 51                             | 53           | 85                                      | 66 | 34 |
| General Education                               | 40                 | -                                       | -   | -                              | 45           | 89                                      | 73 | 38 |
| Students with Disabilities                      | 3                  | -                                       | -   | -                              | 8            | 63                                      | 25 | 13 |
| American Indian or Alaska Native                | 0                  | 0                                       | 0   | 0                              | 0            | 0                                       | 0  | 0  |
| Asian or Native Hawaiian/Other Pacific Islander | 1                  | -                                       | -   | -                              | 0            | 0                                       | 0  | 0  |
| Black or African American                       | 1                  | -                                       | -   | -                              | 0            | 0                                       | 0  | 0  |
| Hispanic or Latino                              | 0                  | 0                                       | 0   | 0                              | 3            | -                                       | -  | -  |
| White                                           | 41                 | -                                       | -   | -                              | 50           | -                                       | -  | -  |
| Multiracial                                     | 0                  | 0                                       | 0   | 0                              | 0            | 0                                       | 0  | 0  |
| Small Group Total                               | 43                 | 95                                      | 93  | 51                             | 53           | 85                                      | 66 | 34 |
| Female                                          | 23                 | 100                                     | 100 | 52                             | 28           | 89                                      | 68 | 39 |
| Male                                            | 20                 | 90                                      | 85  | 50                             | 25           | 80                                      | 64 | 28 |
| English Proficient                              | 43                 | 95                                      | 93  | 51                             | 53           | 85                                      | 66 | 34 |
| Economically Disadvantaged                      | 13                 | 100                                     | 100 | 46                             | 20           | 80                                      | 65 | 40 |
| Not Economically Disadvantaged                  | 30                 | 93                                      | 90  | 53                             | 33           | 88                                      | 67 | 30 |
| Not Migrant                                     | 43                 | 95                                      | 93  | 51                             | 53           | 85                                      | 66 | 34 |



# Regents Examination Results (2013 - 14)

## Results by Student Group

|                                                 | Physical Setting/Chemistry |                                         |    |    | Physical Setting/Physics |                                         |    |    |
|-------------------------------------------------|----------------------------|-----------------------------------------|----|----|--------------------------|-----------------------------------------|----|----|
|                                                 | Total Tested               | Percent of students scoring at or above |    |    | Total Tested             | Percent of students scoring at or above |    |    |
|                                                 |                            | 55                                      | 65 | 85 |                          | 55                                      | 65 | 85 |
| All Students                                    | 31                         | 84                                      | 45 | 6  | 18                       | 89                                      | 83 | 39 |
| General Education                               | 31                         | 84                                      | 45 | 6  | 18                       | 89                                      | 83 | 39 |
| Students with Disabilities                      | 0                          | 0                                       | 0  | 0  | 0                        | 0                                       | 0  | 0  |
| American Indian or Alaska Native                | 0                          | 0                                       | 0  | 0  | 0                        | 0                                       | 0  | 0  |
| Asian or Native Hawaiian/Other Pacific Islander | 0                          | 0                                       | 0  | 0  | 3                        | -                                       | -  | -  |
| Black or African American                       | 1                          | -                                       | -  | -  | 0                        | 0                                       | 0  | 0  |
| Hispanic or Latino                              | 0                          | 0                                       | 0  | 0  | 0                        | 0                                       | 0  | 0  |
| White                                           | 30                         | -                                       | -  | -  | 15                       | -                                       | -  | -  |
| Multiracial                                     | 0                          | 0                                       | 0  | 0  | 0                        | 0                                       | 0  | 0  |
| Small Group Total                               | 31                         | 84                                      | 45 | 6  | 18                       | 89                                      | 83 | 39 |
| Female                                          | 15                         | 73                                      | 47 | 7  | 4                        | -                                       | -  | -  |
| Male                                            | 16                         | 94                                      | 44 | 6  | 14                       | -                                       | -  | -  |
| English Proficient                              | 31                         | 84                                      | 45 | 6  | 18                       | 89                                      | 83 | 39 |
| Economically Disadvantaged                      | 6                          | 100                                     | 50 | 0  | 3                        | -                                       | -  | -  |
| Not Economically Disadvantaged                  | 25                         | 80                                      | 44 | 8  | 15                       | -                                       | -  | -  |
| Not Migrant                                     | 31                         | 84                                      | 45 | 6  | 18                       | 89                                      | 83 | 39 |

### Regents Competency Test Results (2013 - 14)

| Results by Student Group       | Reading      |                 | Writing      |                 | Math         |                 |
|--------------------------------|--------------|-----------------|--------------|-----------------|--------------|-----------------|
|                                | Total Tested | Percent Passing | Total Tested | Percent Passing | Total Tested | Percent Passing |
|                                | All Students | 1               | -            | 1               | -            | 1               |
| Students with Disabilities     | 1            | -               | 1            | -               | 1            | -               |
| White                          | 1            | -               | 1            | -               | 1            | -               |
| Small Group Total              | 1            | -               | 1            | -               | 1            | -               |
| Female                         | 0            | 0               | 0            | 0               | 1            | -               |
| Male                           | 1            | -               | 1            | -               | 0            | 0               |
| English Proficient             | 1            | -               | 1            | -               | 1            | -               |
| Not Economically Disadvantaged | 1            | -               | 1            | -               | 1            | -               |
| Not Migrant                    | 1            | -               | 1            | -               | 1            | -               |

### Regents Competency Test Results (2013 - 14)

| Results by Student Group       | Global Studies |                 | U.S. History & Government |                 | Science      |                 |
|--------------------------------|----------------|-----------------|---------------------------|-----------------|--------------|-----------------|
|                                | Total Tested   | Percent Passing | Total Tested              | Percent Passing | Total Tested | Percent Passing |
|                                | All Students   | 1               | -                         | 1               | -            | 0               |
| Students with Disabilities     | 1              | -               | 1                         | -               | 0            | 0               |
| White                          | 1              | -               | 1                         | -               | 0            | 0               |
| Small Group Total              | 1              | -               | 1                         | -               | 0            | 0               |
| Female                         | 0              | 0               | 0                         | 0               | 0            | 0               |
| Male                           | 1              | -               | 1                         | -               | 0            | 0               |
| English Proficient             | 1              | -               | 1                         | -               | 0            | 0               |
| Not Economically Disadvantaged | 1              | -               | 1                         | -               | 0            | 0               |
| Not Migrant                    | 1              | -               | 1                         | -               | 0            | 0               |

## New York State English as a Second Language Achievement Test (NYSESLAT) Results (2013 - 14)

| Grade 1           | Total Tested | Percent of Students Scoring at Level(s) |              |          |            |
|-------------------|--------------|-----------------------------------------|--------------|----------|------------|
|                   |              | Beginning                               | Intermediate | Advanced | Proficient |
| All Students      | 2            | -                                       | -            | -        | -          |
| General Education | 2            | -                                       | -            | -        | -          |

| Grade 2           | Total Tested | Percent of Students Scoring at Level(s) |              |          |            |
|-------------------|--------------|-----------------------------------------|--------------|----------|------------|
|                   |              | Beginning                               | Intermediate | Advanced | Proficient |
| All Students      | 1            | -                                       | -            | -        | -          |
| General Education | 1            | -                                       | -            | -        | -          |

| Grade 3           | Total Tested | Percent of Students Scoring at Level(s) |              |          |            |
|-------------------|--------------|-----------------------------------------|--------------|----------|------------|
|                   |              | Beginning                               | Intermediate | Advanced | Proficient |
| All Students      | 1            | -                                       | -            | -        | -          |
| General Education | 1            | -                                       | -            | -        | -          |

### Elementary/Middle-Level English Language Arts Results for Accountability

All accountability groups made AYP: NO

| Student Group                                   | Made AYP | Tested 95% | Students Enrolled During the Test Administration Period | Percent of Enrolled Students with Valid Test Scores | PI >= EAMO or Safe Harbor Target | Tested Students Enrolled on BEDS Day | PI | EAMO | Safe Harbor Target |
|-------------------------------------------------|----------|------------|---------------------------------------------------------|-----------------------------------------------------|----------------------------------|--------------------------------------|----|------|--------------------|
| All Students                                    | x        | x          | 569*                                                    | 92%*                                                | ✓                                | 227                                  | 93 | 82   | 82                 |
| American Indian or Alaska Native                | —        | —          | 0                                                       | —                                                   | —                                | 0                                    | —  | —    | —                  |
| Black or African American                       | —        | —          | 2                                                       | —                                                   | —                                | 2                                    | —  | —    | —                  |
| Hispanic or Latino                              | —        | —          | 11                                                      | —                                                   | —                                | 10                                   | —  | —    | —                  |
| Asian or Native Hawaiian/Other Pacific Islander | —        | —          | 6                                                       | —                                                   | —                                | 6                                    | —  | —    | —                  |
| White                                           | x        | x          | 514*                                                    | 92%*                                                | x                                | 201                                  | 94 | 101  | 101                |
| Multiracial                                     | —        | —          | 11                                                      | —                                                   | —                                | 8                                    | —  | —    | —                  |
| Students With Disabilities                      | x        | x          | 81*                                                     | 84%*                                                | —                                | 29                                   | —  | —    | —                  |
| Limited English Proficient                      | —        | —          | 1                                                       | —                                                   | —                                | 1                                    | —  | —    | —                  |
| Economically Disadvantaged                      | x        | x          | 236*                                                    | 94%*                                                | ✓                                | 95                                   | 78 | 65   | 65                 |

Results for the following groups are NOT used to determine AYP.

| Student Group                                       | Students Enrolled During the Test Administration Period | Percent of Enrolled Students with Valid Test Scores | Tested Students Enrolled on BEDS Day | PI  |
|-----------------------------------------------------|---------------------------------------------------------|-----------------------------------------------------|--------------------------------------|-----|
| Not American Indian or Alaska Native                | 569*                                                    | 92%*                                                | 227                                  | 93  |
| Not Black or African American                       | 567*                                                    | 92%*                                                | 225                                  | 94  |
| Not Hispanic or Latino                              | 546*                                                    | 92%*                                                | 217                                  | 94  |
| Not Asian or Native Hawaiian/Other Pacific Islander | 560*                                                    | 92%*                                                | 221                                  | 92  |
| Not White                                           | 30                                                      | —                                                   | 26                                   | —   |
| Not Multiracial                                     | 548*                                                    | 92%*                                                | 219                                  | 93  |
| General Education                                   | 488*                                                    | 94%*                                                | 198                                  | 106 |
| English Proficient                                  | 568*                                                    | 92%*                                                | 226                                  | 93  |
| Not Economically Disadvantaged                      | 333*                                                    | 91%*                                                | 132                                  | 104 |
| Male                                                | 279*                                                    | 93%*                                                | 118                                  | 81  |
| Female                                              | 290*                                                    | 91%*                                                | 109                                  | 106 |
| Migrant                                             | 0                                                       | —                                                   | 0                                    | —   |
| Not Migrant                                         | 569*                                                    | 92%*                                                | 227                                  | 93  |

✓ Yes

x No

— There were fewer than 40 students enrolled during the test administration period, so the Percent of Enrolled Students with Valid Test Scores data are suppressed OR there were fewer than 30 tested students enrolled on BEDS day and during the test administration period, so the PI, EAMO, and Safe Harbor Target data are suppressed.

\*The percentage of students tested in the current year fell below 95 percent, so the numbers of enrolled and tested students in the current year and previous year were combined to provide the school/district with another opportunity to meet the participation rate criterion.

### Elementary/Middle-Level Mathematics Results for Accountability

All accountability groups made AYP: NO

| Student Group                                   | Made AYP | Tested 95% | Students Enrolled During the Test Administration Period | Percent of Enrolled Students with Valid Test Scores | PI >= EAMO or Safe Harbor Target | Tested Students Enrolled on BEDS Day | PI  | EAMO | Safe Harbor Target |
|-------------------------------------------------|----------|------------|---------------------------------------------------------|-----------------------------------------------------|----------------------------------|--------------------------------------|-----|------|--------------------|
| All Students                                    | x        | x          | 567*                                                    | 86%*                                                | ✓                                | 192                                  | 102 | 78   | 78                 |
| American Indian or Alaska Native                | —        | —          | 0                                                       | —                                                   | —                                | 0                                    | —   | —    | —                  |
| Black or African American                       | —        | —          | 2                                                       | —                                                   | —                                | 2                                    | —   | —    | —                  |
| Hispanic or Latino                              | —        | —          | 11                                                      | —                                                   | —                                | 8                                    | —   | —    | —                  |
| Asian or Native Hawaiian/Other Pacific Islander | —        | —          | 6                                                       | —                                                   | —                                | 5                                    | —   | —    | —                  |
| White                                           | x        | x          | 512*                                                    | 86%*                                                | ✓                                | 169                                  | 102 | 97   | 97                 |
| Multiracial                                     | —        | —          | 11                                                      | —                                                   | —                                | 8                                    | —   | —    | —                  |
| Students With Disabilities                      | x        | x          | 79*                                                     | 82%*                                                | —                                | 25                                   | —   | —    | —                  |
| Limited English Proficient                      | —        | —          | 1                                                       | —                                                   | —                                | 1                                    | —   | —    | —                  |
| Economically Disadvantaged                      | x        | x          | 234*                                                    | 88%*                                                | ✓                                | 79                                   | 94  | 61   | 61                 |

Results for the following groups are NOT used to determine AYP.

| Student Group                                       | Students Enrolled During the Test Administration Period | Percent of Enrolled Students with Valid Test Scores | Tested Students Enrolled on BEDS Day | PI  |
|-----------------------------------------------------|---------------------------------------------------------|-----------------------------------------------------|--------------------------------------|-----|
| Not American Indian or Alaska Native                | 567*                                                    | 86%*                                                | 192                                  | 102 |
| Not Black or African American                       | 565*                                                    | 86%*                                                | 190                                  | 103 |
| Not Hispanic or Latino                              | 544*                                                    | 86%*                                                | 184                                  | 102 |
| Not Asian or Native Hawaiian/Other Pacific Islander | 558*                                                    | 86%*                                                | 187                                  | 102 |
| Not White                                           | 30                                                      | —                                                   | 23                                   | —   |
| Not Multiracial                                     | 546*                                                    | 86%*                                                | 184                                  | 102 |
| General Education                                   | 488*                                                    | 87%*                                                | 167                                  | 116 |
| English Proficient                                  | 566*                                                    | 86%*                                                | 191                                  | 103 |
| Not Economically Disadvantaged                      | 333*                                                    | 85%*                                                | 113                                  | 108 |
| Male                                                | 277*                                                    | 88%*                                                | 103                                  | 99  |
| Female                                              | 290*                                                    | 84%*                                                | 89                                   | 106 |
| Migrant                                             | 0                                                       | —                                                   | 0                                    | —   |
| Not Migrant                                         | 567*                                                    | 86%*                                                | 192                                  | 102 |

✓ Yes  
x No

— There were fewer than 40 students enrolled during the test administration period, so the Percent of Enrolled Students with Valid Test Scores data are suppressed OR there were fewer than 30 tested students enrolled on BEDS day and during the test administration period, so the PI, EAMO, and Safe Harbor Target data are suppressed.

\*The percentage of students tested in the current year fell below 95 percent, so the numbers of enrolled and tested students in the current year and previous year were combined to provide the school/district with another opportunity to meet the participation rate criterion.

## Elementary/Middle-Level Science Results for Accountability

All accountability groups made AYP: YES

| Student Group                                   | Made AYP | Tested 80% | Students Enrolled During the Test Administration Period | Percent of Enrolled Students with Valid Test Scores | PI >= EAMO or Progress Target | Tested Students Enrolled on BEDS Day | PI  | EAMO | Progress Target |
|-------------------------------------------------|----------|------------|---------------------------------------------------------|-----------------------------------------------------|-------------------------------|--------------------------------------|-----|------|-----------------|
| All Students                                    | ✓        | ✓          | 76                                                      | 89%                                                 | ✓                             | 62                                   | 195 | 171  | 171             |
| American Indian or Alaska Native                | —        | —          | 0                                                       | —                                                   | —                             | 0                                    | —   | —    | —               |
| Black or African American                       | —        | —          | 0                                                       | —                                                   | —                             | 0                                    | —   | —    | —               |
| Hispanic or Latino                              | —        | —          | 2                                                       | —                                                   | —                             | 2                                    | —   | —    | —               |
| Asian or Native Hawaiian/Other Pacific Islander | —        | —          | 0                                                       | —                                                   | —                             | 0                                    | —   | —    | —               |
| White                                           | ✓        | ✓          | 71                                                      | 89%                                                 | ✓                             | 57                                   | 196 | 179  | 179             |
| Multiracial                                     | —        | —          | 3                                                       | —                                                   | —                             | 3                                    | —   | —    | —               |
| Students With Disabilities                      | —        | —          | 13                                                      | —                                                   | —                             | 6                                    | —   | —    | —               |
| Limited English Proficient                      | —        | —          | 0                                                       | —                                                   | —                             | 0                                    | —   | —    | —               |
| Economically Disadvantaged                      | —        | —          | 29                                                      | —                                                   | —                             | 22                                   | —   | —    | —               |

Results for the following groups are NOT used to determine AYP.

| Student Group                                       | Students Enrolled During the Test Administration Period | Percent of Enrolled Students with Valid Test Scores | Tested Students Enrolled on BEDS Day | PI  |
|-----------------------------------------------------|---------------------------------------------------------|-----------------------------------------------------|--------------------------------------|-----|
| Not American Indian or Alaska Native                | 76                                                      | 89%                                                 | 62                                   | 195 |
| Not Black or African American                       | 76                                                      | 89%                                                 | 62                                   | 195 |
| Not Hispanic or Latino                              | 74                                                      | 89%                                                 | 60                                   | 195 |
| Not Asian or Native Hawaiian/Other Pacific Islander | 76                                                      | 89%                                                 | 62                                   | 195 |
| Not White                                           | 5                                                       | —                                                   | 5                                    | —   |
| Not Multiracial                                     | 73                                                      | 89%                                                 | 59                                   | 197 |
| General Education                                   | 63                                                      | 94%                                                 | 56                                   | 196 |
| English Proficient                                  | 76                                                      | 89%                                                 | 62                                   | 195 |
| Not Economically Disadvantaged                      | 47                                                      | 87%                                                 | 40                                   | 195 |
| Male                                                | 37                                                      | —                                                   | 34                                   | 197 |
| Female                                              | 39                                                      | —                                                   | 28                                   | —   |
| Migrant                                             | 0                                                       | —                                                   | 0                                    | —   |
| Not Migrant                                         | 76                                                      | 89%                                                 | 62                                   | 195 |

✓ Yes

✗ No

— There were fewer than 40 students enrolled during the test administration period, so the Percent of Enrolled Students with Valid Test Scores data are suppressed OR there were fewer than 30 tested students enrolled on BEDS day and during the test administration period, so the PI, EAMO, and Progress Target data are suppressed.

## Secondary-Level English Language Arts Results for Accountability

All accountability groups made AYP: YES

| Student Group                                   | Made AYP | Tested 95% | 12th Graders | Percent of 12th Graders with Valid Test Scores | PI >= EAMO or Safe Harbor Target | 2010 Accountability Cohort Members | PI  | EAMO | Safe Harbor Target |
|-------------------------------------------------|----------|------------|--------------|------------------------------------------------|----------------------------------|------------------------------------|-----|------|--------------------|
| All Students                                    | ✓        | ✓          | 40           | 100%                                           | ✓                                | 40                                 | 170 | 151  | 151                |
| American Indian or Alaska Native                | —        | —          | 0            | —                                              | —                                | 0                                  | —   | —    | —                  |
| Black or African American                       | —        | —          | 1            | —                                              | —                                | 1                                  | —   | —    | —                  |
| Hispanic or Latino                              | —        | —          | 0            | —                                              | —                                | 0                                  | —   | —    | —                  |
| Asian or Native Hawaiian/Other Pacific Islander | —        | —          | 3            | —                                              | —                                | 3                                  | —   | —    | —                  |
| White                                           | ✓        | —          | 36           | —                                              | ✓                                | 36                                 | 169 | 162  | 162                |
| Multiracial                                     | —        | —          | 0            | —                                              | —                                | 0                                  | —   | —    | —                  |
| Students With Disabilities                      | —        | —          | 4            | —                                              | —                                | 5                                  | —   | —    | —                  |
| Limited English Proficient                      | —        | —          | 0            | —                                              | —                                | 0                                  | —   | —    | —                  |
| Economically Disadvantaged                      | —        | —          | 6            | —                                              | —                                | 5                                  | —   | —    | —                  |

Results for the following groups are NOT used to determine AYP.

| Student Group                                       | 12th Graders | Percent of 12th Graders with Valid Test Scores | 2010 Accountability Cohort Members | PI  |
|-----------------------------------------------------|--------------|------------------------------------------------|------------------------------------|-----|
| Not American Indian or Alaska Native                | 40           | 100%                                           | 40                                 | 170 |
| Not Black or African American                       | 39           | —                                              | 39                                 | 172 |
| Not Hispanic or Latino                              | 40           | 100%                                           | 40                                 | 170 |
| Not Asian or Native Hawaiian/Other Pacific Islander | 37           | —                                              | 37                                 | 168 |
| Not White                                           | 4            | —                                              | 4                                  | —   |
| Not Multiracial                                     | 40           | 100%                                           | 40                                 | 170 |
| General Education                                   | 36           | —                                              | 35                                 | 180 |
| English Proficient                                  | 40           | 100%                                           | 40                                 | 170 |
| Not Economically Disadvantaged                      | 34           | —                                              | 35                                 | 169 |
| Male                                                | 23           | —                                              | 23                                 | —   |
| Female                                              | 17           | —                                              | 17                                 | —   |
| Migrant                                             | 0            | —                                              | 0                                  | —   |
| Not Migrant                                         | 40           | 100%                                           | 40                                 | 170 |

✓ Yes  
 x No

— There were fewer than 40 12th graders, so the Percent of 12th Graders with Valid Test Scores data are suppressed OR there were fewer than 30 students in the 2010 accountability cohort, so PI, EAMO, and Safe Harbor Target data are suppressed.



## Secondary-Level Mathematics Results for Accountability

All accountability groups made AYP: YES

| Student Group                                   | Made AYP | Tested 95% | 12th Graders | Percent of 12th Graders with Valid Test Scores | PI >= EAMO or Safe Harbor Target | 2010 Accountability Cohort Members | PI  | EAMO | Safe Harbor Target |
|-------------------------------------------------|----------|------------|--------------|------------------------------------------------|----------------------------------|------------------------------------|-----|------|--------------------|
| All Students                                    | ✓        | ✓          | 40           | 95%                                            | ✓                                | 40                                 | 168 | 133  | 133                |
| American Indian or Alaska Native                | —        | —          | 0            | —                                              | —                                | 0                                  | —   | —    | —                  |
| Black or African American                       | —        | —          | 1            | —                                              | —                                | 1                                  | —   | —    | —                  |
| Hispanic or Latino                              | —        | —          | 0            | —                                              | —                                | 0                                  | —   | —    | —                  |
| Asian or Native Hawaiian/Other Pacific Islander | —        | —          | 3            | —                                              | —                                | 3                                  | —   | —    | —                  |
| White                                           | ✓        | —          | 36           | —                                              | ✓                                | 36                                 | 164 | 146  | 146                |
| Multiracial                                     | —        | —          | 0            | —                                              | —                                | 0                                  | —   | —    | —                  |
| Students With Disabilities                      | —        | —          | 4            | —                                              | —                                | 5                                  | —   | —    | —                  |
| Limited English Proficient                      | —        | —          | 0            | —                                              | —                                | 0                                  | —   | —    | —                  |
| Economically Disadvantaged                      | —        | —          | 6            | —                                              | —                                | 5                                  | —   | —    | —                  |

Results for the following groups are NOT used to determine AYP.

| Student Group                                       | 12th Graders | Percent of 12th Graders with Valid Test Scores | 2010 Accountability Cohort Members | PI  |
|-----------------------------------------------------|--------------|------------------------------------------------|------------------------------------|-----|
| Not American Indian or Alaska Native                | 40           | 95%                                            | 40                                 | 168 |
| Not Black or African American                       | 39           | —                                              | 39                                 | 167 |
| Not Hispanic or Latino                              | 40           | 95%                                            | 40                                 | 168 |
| Not Asian or Native Hawaiian/Other Pacific Islander | 37           | —                                              | 37                                 | 165 |
| Not White                                           | 4            | —                                              | 4                                  | —   |
| Not Multiracial                                     | 40           | 95%                                            | 40                                 | 168 |
| General Education                                   | 36           | —                                              | 35                                 | 186 |
| English Proficient                                  | 40           | 95%                                            | 40                                 | 168 |
| Not Economically Disadvantaged                      | 34           | —                                              | 35                                 | 171 |
| Male                                                | 23           | —                                              | 23                                 | —   |
| Female                                              | 17           | —                                              | 17                                 | —   |
| Migrant                                             | 0            | —                                              | 0                                  | —   |
| Not Migrant                                         | 40           | 95%                                            | 40                                 | 168 |

✓ Yes

✗ No

— There were fewer than 40 12th graders, so the Percent of 12th Graders with Valid Test Scores data are suppressed OR there were fewer than 30 students in the 2010 accountability cohort, so PI, EAMO, and Safe Harbor Target data are suppressed.

### Unweighted Combined ELA and Math PIs

| Student Group                                      | Elementary/<br>Middle-Level ELA PI | Elementary/<br>Middle-Level Math<br>PI | Secondary-Level<br>ELA PI | Secondary-Level<br>Math PI | Unweighted Combined<br>PI |
|----------------------------------------------------|------------------------------------|----------------------------------------|---------------------------|----------------------------|---------------------------|
| All Students                                       | 93                                 | 102                                    | 170                       | 168                        | 133                       |
| American Indian or Alaska Native                   | —                                  | —                                      | —                         | —                          | —                         |
| Black or African American                          | —                                  | —                                      | —                         | —                          | —                         |
| Hispanic or Latino                                 | —                                  | —                                      | —                         | —                          | —                         |
| Asian or Native Hawaiian/Other<br>Pacific Islander | —                                  | —                                      | —                         | —                          | —                         |
| White                                              | 94                                 | 102                                    | 169                       | 164                        | 132                       |
| Multiracial                                        | —                                  | —                                      | —                         | —                          | —                         |
| Students With Disabilities                         | —                                  | —                                      | —                         | —                          | —                         |
| Limited English Proficient                         | —                                  | —                                      | —                         | —                          | —                         |
| Economically Disadvantaged                         | 78                                 | 94                                     | —                         | —                          | 86                        |

— There were not enough students to determine a Performance Index.

## Overall Graduation Rate for Accountability

All accountability groups made AYP: YES

| Student Group                                   | Made AYP |
|-------------------------------------------------|----------|
| All Students                                    | ✓        |
| American Indian or Alaska Native                | —        |
| Black or African American                       | —        |
| Hispanic or Latino                              | —        |
| Asian or Native Hawaiian/Other Pacific Islander | —        |
| White                                           | ✓        |
| Multiracial                                     | —        |
| Students With Disabilities                      | —        |
| Limited English Proficient                      | —        |
| Economically Disadvantaged                      | —        |

✓ Made AYP

✗ Did not make AYP

— There were not enough students to make an AYP determination.

### Four-Year Graduation-Rate Total Cohort for Accountability

| Student Group                                   | Met Graduation-Rate Criterion | 2009 Four-Year Graduation-Rate Total Cohort | Graduation Rate | State Standard | Progress Target |
|-------------------------------------------------|-------------------------------|---------------------------------------------|-----------------|----------------|-----------------|
| All Students                                    | ✓                             | 51                                          | 84%             | 80%            | 80%             |
| American Indian or Alaska Native                | —                             | 1                                           | —               | —              | —               |
| Black or African American                       | —                             | 0                                           | —               | —              | —               |
| Hispanic or Latino                              | —                             | 1                                           | —               | —              | —               |
| Asian or Native Hawaiian/Other Pacific Islander | —                             | 0                                           | —               | —              | —               |
| White                                           | ✓                             | 49                                          | 84%             | 80%            | 80%             |
| Multiracial                                     | —                             | 0                                           | —               | —              | —               |
| Students With Disabilities                      | —                             | 8                                           | —               | —              | —               |
| Limited English Proficient                      | —                             | 0                                           | —               | —              | —               |
| Economically Disadvantaged                      | —                             | 11                                          | —               | —              | —               |

✓ Graduation rate is equal to or greater than the State Standard or the group's Progress Target.

✗ Graduation rate is less than the State Standard and the group's Progress Target.

— There were fewer than 30 students in the cohort.

### Five-Year Graduation-Rate Total Cohort for Accountability

| Student Group                                   | Met Graduation-Rate Criterion | 2008 Five-Year Graduation-Rate Total Cohort | Graduation Rate | State Standard | Progress Target |
|-------------------------------------------------|-------------------------------|---------------------------------------------|-----------------|----------------|-----------------|
| All Students                                    | ✓                             | 51                                          | 94%             | 80%            | 80%             |
| American Indian or Alaska Native                | —                             | 0                                           | —               | —              | —               |
| Black or African American                       | —                             | 1                                           | —               | —              | —               |
| Hispanic or Latino                              | —                             | 2                                           | —               | —              | —               |
| Asian or Native Hawaiian/Other Pacific Islander | —                             | 0                                           | —               | —              | —               |
| White                                           | ✓                             | 46                                          | 93%             | 80%            | 80%             |
| Multiracial                                     | —                             | 2                                           | —               | —              | —               |
| Students With Disabilities                      | —                             | 8                                           | —               | —              | —               |
| Limited English Proficient                      | —                             | 0                                           | —               | —              | —               |
| Economically Disadvantaged                      | —                             | 14                                          | —               | —              | —               |

✓ Graduation rate is equal to or greater than the State Standard or the group's Progress Target.  
 ✗ Graduation rate is less than the State Standard and the group's Progress Target.  
 — There were fewer than 30 students in the cohort.

## Graduation Rates for Non-AYP Groups for Accountability

Results for the following groups are NOT used to determine AYP.

| Student Group                                       | Four-Year Graduation-Rate Total Cohort      |                 | Five-Year Graduation-Rate Total Cohort      |                 |
|-----------------------------------------------------|---------------------------------------------|-----------------|---------------------------------------------|-----------------|
|                                                     | 2009 Four-Year Graduation-Rate Total Cohort | Graduation Rate | 2008 Five-Year Graduation-Rate Total Cohort | Graduation Rate |
| Not American Indian or Alaska Native                | 50                                          | 84%             | 51                                          | 94%             |
| Not Black or African American                       | 51                                          | 84%             | 50                                          | 94%             |
| Not Hispanic or Latino                              | 50                                          | 84%             | 49                                          | 94%             |
| Not Asian or Native Hawaiian/Other Pacific Islander | 51                                          | 84%             | 51                                          | 94%             |
| Not White                                           | 2                                           | —               | 5                                           | —               |
| Not Multiracial                                     | 51                                          | 84%             | 49                                          | 94%             |
| General Education                                   | 43                                          | 91%             | 43                                          | 100%            |
| English Proficient                                  | 51                                          | 84%             | 51                                          | 94%             |
| Not Economically Disadvantaged                      | 40                                          | 90%             | 37                                          | 92%             |
| Male                                                | 24                                          | —               | 30                                          | 97%             |
| Female                                              | 27                                          | —               | 21                                          | —               |
| Migrant                                             | 0                                           | —               | 0                                           | —               |
| Not Migrant                                         | 51                                          | 84%             | 51                                          | 94%             |

— There were fewer than 30 students in the cohort.

## Graduation Rates for Regents with Advanced Designation and CTE Endorsement for Accountability

Percentage of 2009 Graduation-Rate Total Cohort members who graduated as of August 31, 2013 with:

| Regents Diploma with an Advanced Designation (This District) | Regents Diploma with an Advanced Designation (Statewide) | Percentage in This District Exceeded Statewide |
|--------------------------------------------------------------|----------------------------------------------------------|------------------------------------------------|
| 39%                                                          | 31%                                                      | YES                                            |
| Regents Diploma with CTE Endorsement (This District)         | Regents Diploma with CTE Endorsement (Statewide)         | Percentage in This District Exceeded Statewide |
| 8%                                                           | 4%                                                       | YES                                            |