

**Springfield Township Board of Education
Jobstown, NJ 08041
Wednesday, September 9, 2015
Minutes – Work Session**

Call to Order: A Work Session of the Springfield Township Board of Education was held on Wednesday, September 9, 2015 at 6:30 p.m. in the school library.

Roll Call of Members:

Andrew Eaton, President-Present
Gregory Madia, Vice President-Present
Joseph Bucs- Present
Christopher Corbo- Absent
Wade Hale- Present
Kristen Lippincott- Present
Michael Ramalho-Arrived at 6:33 pm
Dennis Schmieder-Departed at 9:41 pm
James Specca- Present

Others present:

Craig Vaughn; Christina Moskal; Anthony Catana, Spiezele Architectural Group; Chuck Romanoli, New Road Construction Management; Dr. James Sarruda, NBC Regional School District Superintendent; Mrs. Marie Goodwin, NBC Regional School District Board of Education Member

Public Notice:

As per the Open Public Meetings Act, NJSA 10:4-6, notice of this work session of the Springfield Township Board of Education was held in the school library, in Jobstown, New Jersey. Formal action will be taken.

Sent to: Burlington County Times
Board of Education Members
Springfield Township Clerk

Posted: Springfield Township School
Board of Education Office
Springfield Township Municipal Building, Jobstown, NJ

Pledge of Allegiance:

The President led the Board and the assemblage in the Pledge of Allegiance.

Public Comment #1: *(Not to exceed 30 minutes)*

Before a matter is placed on the agenda, Administration has thoroughly reviewed it. Board Members preview the agenda items five days prior to the meeting and discuss questionable items with the Superintendent.

The Springfield Township BOE welcomes public comment during our public meetings. Public comment is not a question and answer session. Notwithstanding, members of the Administration and/or Board members may, with approval, choose to answer questions raised during public comment periods. If a response is requested, please provide your contact information on the sign-in sheet or contact the Administration separately.

Statements are limited to two, three minute time periods for a total of six minutes on any one topic. Public Comment #1 is reserved for agenda specific comments or statements. Public Comment #2 is for general comments or statements.

**Springfield Township Board of Education
Jobstown, NJ 08041
Wednesday, September 9, 2015
Minutes – Work Session**

1. Mr. T. Pantano welcomed Mr. Vaughn and wished Ms. Moskal the best in her future endeavors.
2. Mr. T. Pantano made comments related to public comment policy, referendum construction summary updates, and the upcoming NBC Regional School District referendum.
3. Mr. W. Smith made comments regarding curriculum reform, STEM, external consultants, and the design of facilities related to the NBC Regional referendum.

Northern Burlington County Regional School District Referendum Presentation:

(Estimated time: 15 minutes)

Superintendent Dr. James Sarruda made a presentation regarding the upcoming referendum. Dr. Sarruda answered questions from the board and members of the audience.

ACTION ITEM:

PERSONNEL:

Based on the recommendation of the Superintendent, I move that the following action items be approved:

a. Student Teacher Placement

It is recommended that the Board of Education approve the placement of the following student teacher from The College of New Jersey for the period of September 9, 2015 through December 15, 2015, pending successful completion of the proper criminal history background check: Ms. Morgan Gerber

Cooperating Teacher: Mrs. Alisa Palazzi

Motion: Bucs

Second: Schmieder

Roll Call Vote: 8-0 (Corbo-absent)

Approval: All yes

Referendum Update: *(Estimated time: 15 minutes)*

Anthony Catana of Spiegle Architectural Group and Chuck Romanoli of New Road Construction Management were present to provide an update regarding the status of the referendum projects.

Work Session Topics: *(Estimated time: 60 minutes)*

- District Goals Discussion
- Mission and Vision Statements Discussion

Preparation of September 15, 2015 Agenda: *(Estimated time: 60 minutes)*

Public Comment #2: *(Not to exceed 30 minutes)*

1. Mr. W. Smith commented on the educational focus of the current referendum, the Home and School Association, and he thanked those who participated in the selection of Mr. Vaughn.

**Springfield Township Board of Education
Jobstown, NJ 08041
Wednesday, September 9, 2015
Minutes – Work Session**

2. Mr. R Lippincott commented that the board meets the needs of the community.

Motion to adjourn: _____ **Time:** 10:07 pm

Motion: Specca

Second: Bucs

Approval: All yes (Corbo-Absent)

Respectfully submitted,

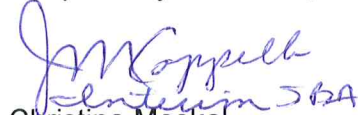

Christina Moskal

School Board Administrator/Board Secretary

BUILDING EXCELLENCE

September 29, 2015

#NorthernMatters...



NORTHERN BURLINGTON COUNTY REGIONAL BOARD OF EDUCATION

“Building Excellence”

Objective (s):

To Inspire Positive Energy for the “Building Excellence” project.

“Building Excellence”

#Northern Matters

To Share Information, Answer Questions, and Encourage All to Cast an Informed Vote on September 29th

BUILDING EXCELLENCE

- **WHY:** **GOOD TIME: FISCAL & FACILITIES PLANNING**
- **WHAT:** ***BUILDING EXCELLENCE:*** **PROGRAM DETAILS**
- **WHEN:** **SEPTEMBER 29, 2015**



NORTHERN BURLINGTON COUNTY REGIONAL HIGH SCHOOL *BUILDING EXCELLENCE*



Start With A Vision

NEW HIGH SCHOOL SITE AERIAL RENDERING



BUILDING EXCELLENCE

WHY: GOOD TIME

FISCAL PLANNING

- **BONDS EXPIRING**
- **STATE AID AVAILABLE (vs ROD Grants)**
- **INTEREST RATES AT HISTORIC LOWS (3.10% - 3.60%)**

IT'S A GOOD TIME

- **The NB High School facilities were originally constructed in 1960's. Although the School Board has maintained these facilities over the years, core facilities like roofs, boilers, electric, and HVAC are in need of maintenance and upgrades that simply cannot be absorbed in our regular operating budget.**
- **The state is offering to fund approximately 29% for this very purpose now—not later—and interest rates are at near-historic lows. We must consider our future.**
- **State aid and low interest rates combined with our needs make this a time to invest in our communities.**

BUILDING EXCELLENCE

STRATEGIC PLANNING PROCESS:

ACADEMIC NEEDS DICTATE FACILITY CHANGES

- **LONG-RANGE FACILITIES PLANNING & ANNUAL COMPREHENSIVE MAINTENANCE PLAN**
 - (2000-2005) Middle School Construction
 - (2005-2010)
 - (2010-2015)
 - (2015-2020) High School Renovation
- **STRATEGIC PLANNING: BOARD OF EDUCATION**
 - **EDUCATIONAL SPECIFICATIONS DEVELOPMENT (Strategic Planning Began Summer 2013)**
 - **DEMOGRAPHIC STUDIES (FY'2010 & FY' 2015)**
 - **EDUCATIONAL OPPORTUNITIES & THE 'PERFECT STORM' (#NBExBD)**
 - **IMMEDIATE CORE FACILITY NEEDS**
 - **IMMEDIATE ACADEMIC FACILITY NEEDS**
 - **FISCAL RESPONSIBILITY**
 - **PRODUCTION VS PRODUCTION CAPABILITY**



Future Elementary
School

Future Middle
School

Future Connecting
Wing

LONG RANGE FACILITIES PLANNING

BUILDING EXCELLENCE

Ten Year Facilities Master Plan



Growing from a “Community School” to a “School Community”

Future Middle School Site

COMPOSITE 7 THRU 12 SITE PLAN

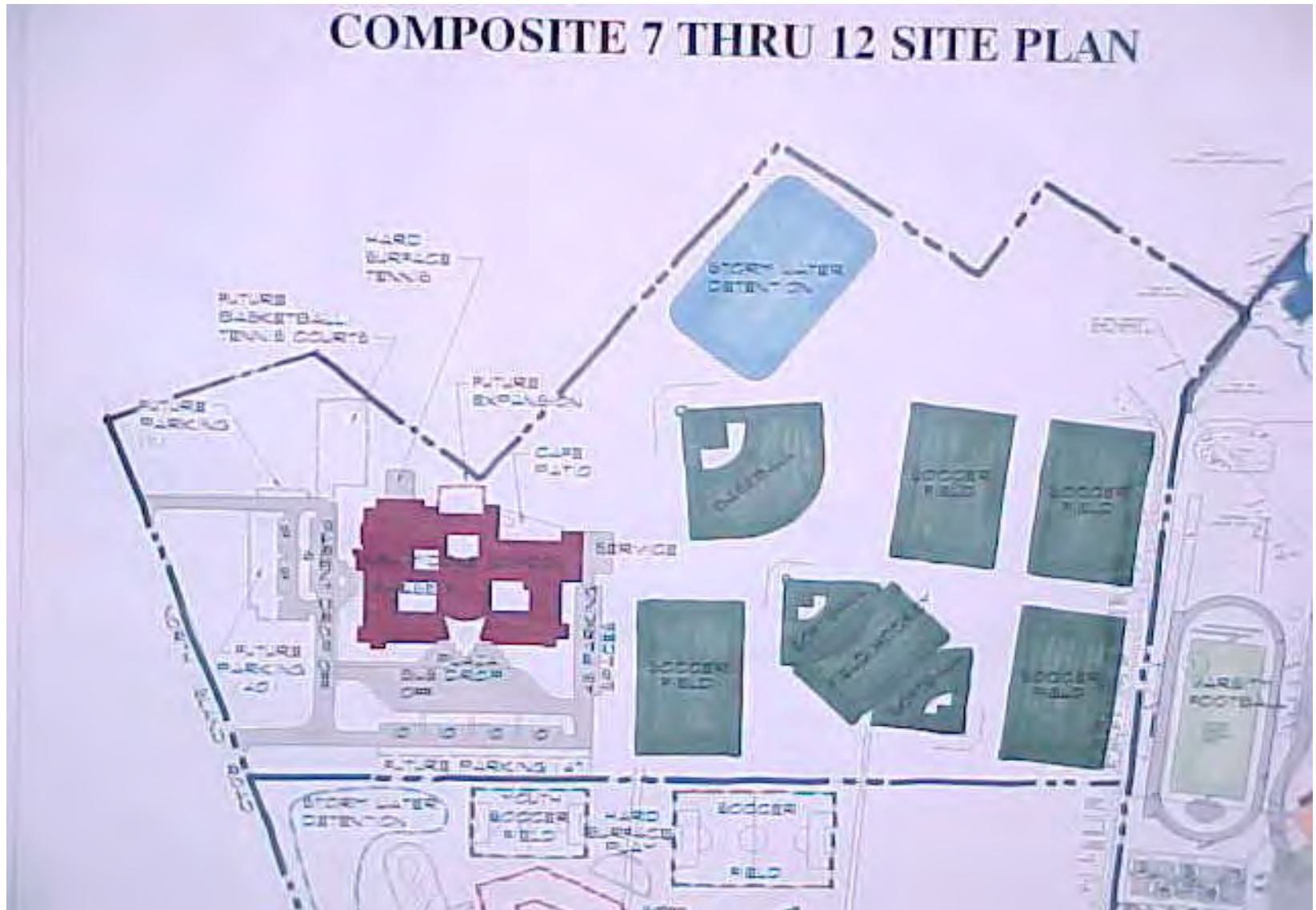

BUILDING EXCELLENCE

WHY: GOOD TIME

- **ANNUAL COMPREHENSIVE MAINTENANCE PLAN**
- **Model Classrooms, Painting, HVAC and etc**



BUILDING EXCELLENCE

WHY: GOOD TIME

LONG-RANGE FACILITIES PLANNING



2010



1998

BUILDING EXCELLENCE

WHY: GOOD TIME

- LONG RANGE FACILITIES PLANNING**

MIDDLE SCHOOL CONSTRUCTION



TRANSPORTATION CENTER CONSTRUCTION



BUILDING EXCELLENCE

Program Details

LONG RANGE FACILITIES PLANNING 2015

- **ACADEMIC PROGRAM NEEDS** (S.T.E.M., AGRISCIENCE , TECHNOLOGY, AND ETC.)
- **HEIGHTENED SAFETY & SECURITY CONCERNS**
- **CRITICAL CORE FACILITY NEEDS** (MEDIA CENTER, AUDITORIUM, AND GYMNASIUM)
- **STEADY COMMUNITY GROWTH: PAST, PRESENT, AND FUTURE** (Approximately 200 students in next 5 years)

ACADEMIC HIGHLIGHTS

Core Academic Area Highlights

- Media Center
 - **Expand and more centrally locate the media center** to support expanded classroom use
 - **Enable community access** technology and resources
 - Provide increased access, space, and supplies for school and community use
- Teaching & Learning
 - Position core departments to **foster collaboration and support across common academic initiatives.**
 - Substantiate preparation and effectiveness by **providing areas for collaboration and shared innovation.**
 - **Update science labs and classrooms** as multi-purpose locations to increase course offerings such as forensics or meteorology.
 - **Create a large group instructional space** to simulate higher education environments and support cross-disciplinary activities
 - **Endorse the Visual and Performing Arts programs** to showcase student talent in the proposed auditorium

ACADEMIC HIGHLIGHTS

Career and Technology Programs:

Extensive Renovation & Relocation of Instructional Spaces

- Business
 - **Create adjacent and connected instructional and lab spaces** (i.e. Floral shop & floral classroom and school store & business marketing classroom)
- Applied Technology
 - **Increase interdisciplinary project-based learning** using STEM (Science Technology Engineering Math) principles. Collaboration among students in Engineering, Architectural Design, Construction, Manufacturing, and Graphic Arts
- Agriscience
 - **Provide for additional instruction in areas of occupational growth - aquaculture, hydroponics, landscape design, nursery production, turf grass, animal science, veterinary science, and floriculture**

Additions/ Renovations Layout

- MAJOR - Renovation Area
- MEDIUM - Renovation Area
- SMALL - Renovation Area
- NEW ADDITION AREAS
- TRACTOR BARN ADDITION

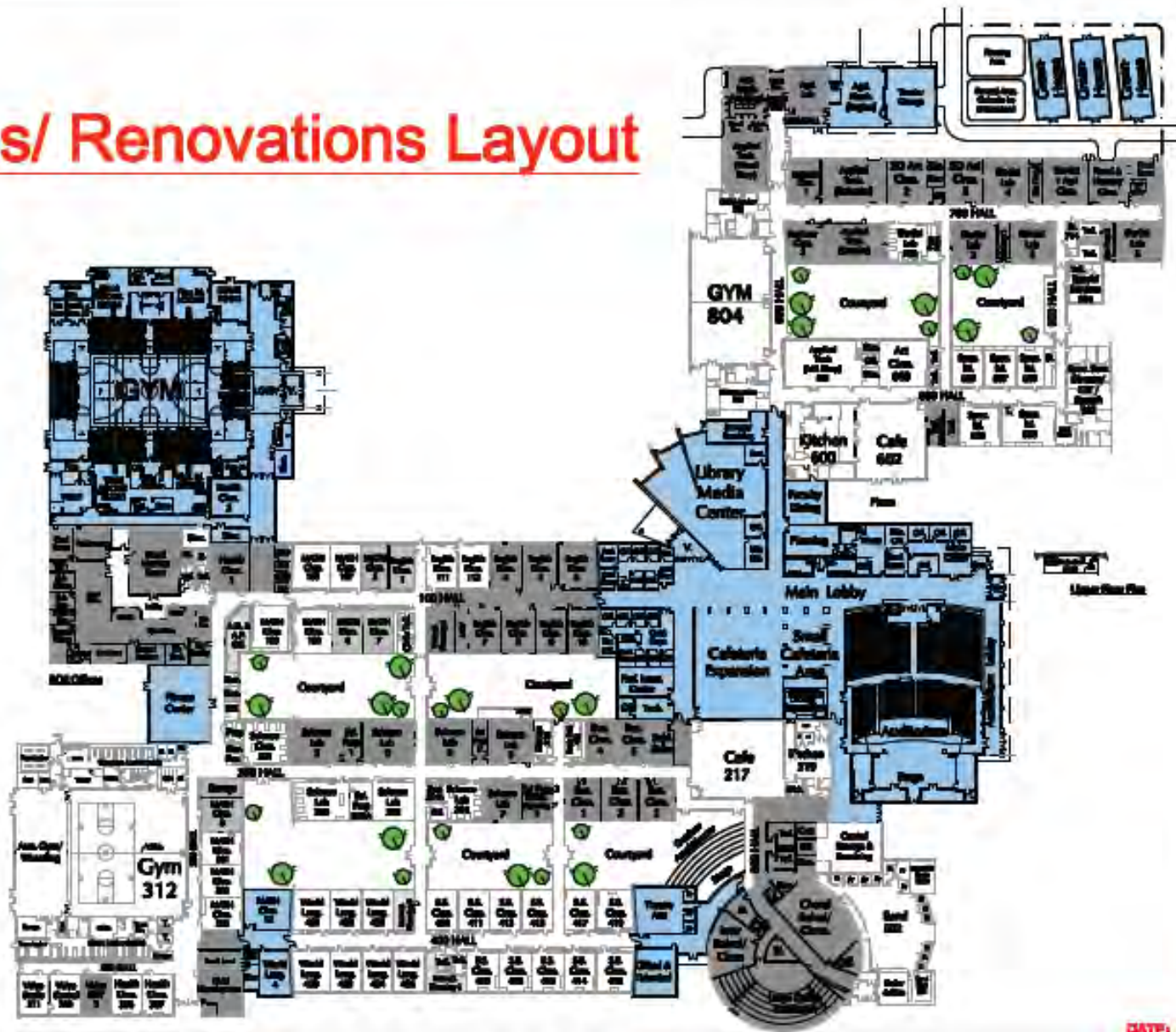

DATE: 7-29-2015

IMMEDIATE SAFETY & SECURITY NEEDS

- **Traffic**
 - **Separated Traffic Patterns For Buses & Parent Drop-off and Pick-up**
 - **Parking for Students, Staff, Visitors**
 - **Improved Access for Emergency Responders**
- **Building Access**
 - **Identified Main Point of Entrance**
 - **ADA Compliance for wheelchairs and etc.,**
 - **Secure Entrances and Exits**
 - **Students & Staff, Visitor Screening, Deliveries**

IMMEDIATE FACILITY NEEDS

Traffic/ Parking/ Security

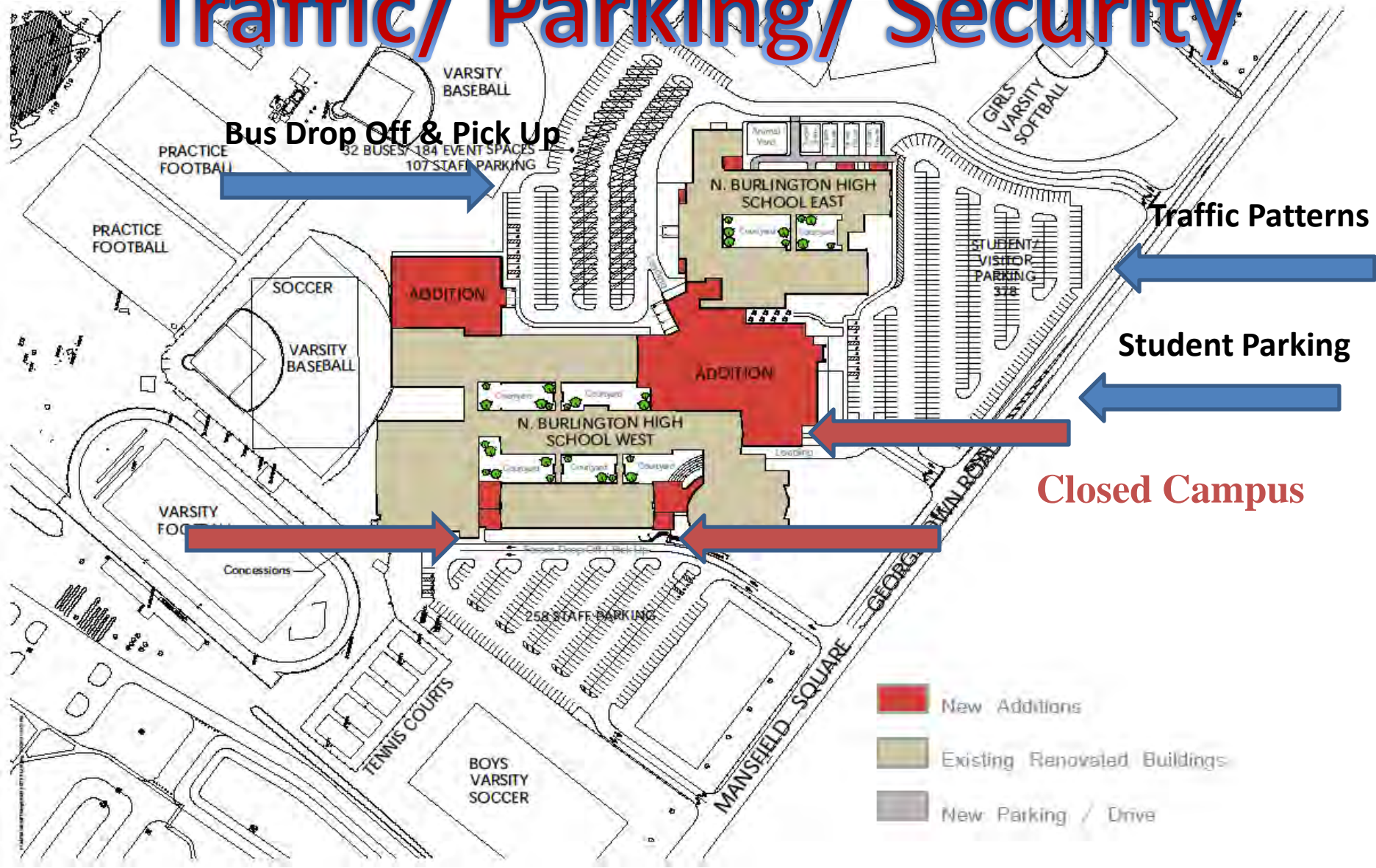

STUDENT SAFETY AND SECURITY



IMMEDIATE FACILITY NEEDS

Safety and Security



IMMEDIATE FACILITY NEEDS

Traffic Safety



IMMEDIATE FACILITY NEEDS

Safety & Security: Traffic Control



IMMEDIATE FACILITY NEEDS

Safety & Security: Parking Needs



*Parking Lots at Capacity Result in Student
Parking on Island & Mansfield Road*

IMMEDIATE FACILITY NEEDS

Parking Plans

Population	Current Parking Spaces	Proposed Parking Spaces
Students/Visitors	151	378
Staff	216	365
Event/Overflow	NA	184
Total	367	927

ACADEMIC PROGRAM NEEDS

HIGH SCHOOL AUDITORIUM



Proposed project costs of Capital and Renovation Projects



Grand Total Renovation/Rehabilitation Costs- **\$27,635,085**

IMMEDIATE CORE FACILITY NEEDS

HVAC Systems

replacement cost aprox. \$3,627,500

<u>Description</u>	<u>Equipment Age</u>	<u>Equipment Life</u>
Gas Fired Boilers (3)	over 50 yrs.	25 yrs.
Expansion Tank	56 yrs.	40 yrs.
Classroom finned Tube radiation (100 units)	52-56 yrs.	25-35 yrs.
Heating & Ventilators Units (64 units)	52-56 yrs.	20-25 yrs.
Heating Hot Water Piping and Valves	52-56 yrs.	40-50 yrs.
Packaged Terminal Air Conditioning(58+ units)	19 yrs.	15 yrs.
Convectors	56 yrs.	25-30 yrs.

IMMEDIATE CORE FACILITY NEEDS

This Boiler is 56 Years Old – Twice Its Expected Life:
Congratulations Maintenance Staff For Keeping It Running



Capital Projects – West Building

Immediate Core Facility Needs

1. Interior Door and Hardware Replacement - \$60,500
2. ADA upgrades and renovations to (2) toilet rooms \$181,500
3. Roof Replacement, selected areas - \$2,037,500
4. Technology upgrades, including replacement of existing fiber optic backbone CAT 5 wiring for CAT 6 wiring - \$169,400
5. Replacement of HVAC equipment, as shown in drawings - \$2,429,780
6. Replacement of drinking fountains and electric coolers - \$12,000
7. Replacement of Electrical Components, as listed in drawings - \$180,532
8. Replacement of original existing phone system - \$254,100
9. Replacement of original existing PA system - \$169,400
10. Replacement of access controls at exterior doors - \$84,700

Total **Eligible** Costs, Capital Projects - \$5,579,412

Capital Projects – East Building

Immediate Core Facility Needs

1. ADA upgrades and renovations to (2) toilet rooms- \$181,500
2. Roof replacement, selected areas- \$1,512,500
3. Technology upgrades, including replacement of existing fiber optic backbone and CAT 5 wiring for CAT 6 wiring- \$72,600
4. Replacement of HVAC equipment, as shown on drawings- \$1,149,600
5. Replacement of Drinking Fountains and Elec Coolers- \$12,000
6. Replacement of Electrical components, as listed on drawings- \$219,010
7. Replacement of original existing phone system- \$108,900
8. Replacement of original existing PA system- \$72,600
9. Replacement of access controls at exterior doors - \$36,300

Total **Eligible** Costs, East Capital Projects- \$3,365,010

Renovation Costs – West Building

1. Area of connection to New Gymnasium and Locker Area, including health classroom 2 - **\$502,000**
2. Math classroom 3 and adjacent English classroom 1 - **\$243,000**
3. Area of renovation adjacent to major connection to Addition, English classrooms and Instruction planning - **\$2,630,000**
4. Business classrooms, school store & corridor- **\$1,326,000**
5. Science labs with preparation instruction planning areas - **\$1,716,000**
6. Math classrooms and storage 6/7- **\$502,000**
7. Athletic Director and Assistant Principal's office- **\$116,000**
8. Child Development and corridor - **\$505,000**
9. Health classrooms 3/4, and TV Video Production- **\$355,000**
10. Instructional planning 3 & 4 - **\$173,000**
11. Old Auditorium, new choral music, music classroom, Large Group Instruction - **\$2,943,000**
12. Old Library, new board offices - 58% of area eligible for funding - **\$1,652,710**

Total **Eligible** Costs, West Building Renovations- **\$ 12,663,710**

Renovation costs - East Building

1. Agriculture Mech(welding), Agriculture Lab and Applied Tech(wood shop)- **-\$1,640,000**
2. Engineering 1 Lab, Applied Tech (robotics), 2D and 3D art, Bio Sci and clrm, Floral Nursery, floral store-**\$2,808,000**
3. Engineering classroom 2, Graphic Design- **\$620,000**
4. BioScience Labs with preparation instruction planning areas - **\$958,953**

Total **Eligible** Costs, East Building Renovations-**\$ 6,026,953**

Summary of Questions 1 & 2

Interpretative Statement

- If both bond proposals are approved, the Board of Education will be authorized to undertake \$65,496,075 of building additions, renovations, and site improvements as well as issue bonds of the School District in the amount of \$65,496,075. Both bond proposals have a total final eligible costs amount of \$32,984,564 and total ineligible costs amount of \$10,556,376.**

Tax Impact At-a-Glance

30 Year Bond (based on 4.25%)

Average Assessed Home Value 2/1/15:	<u>Chesterfield</u> \$391,716	<u>Mansfield</u> \$240,490	<u>North Hanover</u> \$308,520	<u>Springfield</u> \$275,530
Question 1 Only - \$53.9 MM	\$243.48	\$255.34	\$220.73	\$288.86
Reduction in Tax Impact for Current Debt Service in 2017-2018	(\$69.45)	(\$72.82)	(\$62.94)	(\$82.38)
Net - Annual Impact	\$174.03	\$182.52	\$157.79	\$206.48
Net - Monthly Impact	\$14.50	\$15.21	\$13.15	\$17.21
Net - Daily Impact	\$0.48	\$0.50	\$0.43	\$0.57
Net Average Annual Impact (per 100 of A.V.)	\$0.044	\$0.076	\$0.051	\$0.075
Question 1 & 2 - \$65.5 MM	\$316.90	\$332.34	\$287.30	\$375.96
Reduction in Tax Impact for Current Debt Service in 2017-2018	(\$69.45)	(\$72.82)	(\$62.94)	(\$82.38)
Net Impact	\$247.45	\$259.52	\$224.36	\$293.58
Net - Monthly Impact	\$20.62	\$21.63	\$18.70	\$24.47
Net - Daily Impact	\$0.68	\$0.71	\$0.61	\$0.80
Net Average Annual Impact (per 100 of A.V.)	\$0.063	\$0.108	\$0.073	\$0.107

Start With A Vision

NEW HIGH SCHOOL SITE AERIAL RENDERING



Start With A Vision

Front Entrance



Start With A Vision Auditorium



Start With A Vision



Information Centers

#northernmatters

www.nburlington.com (School)

@nbcsuper (Superintendent)

www.northernmatters.com (Community)

The screenshot shows the homepage of the Northern Burlington County Regional School District website. The header features the district's name, a celebratory message for 50 years, and contact information. Below the header is a navigation bar with links to the district, middle school, and high school. A large banner image displays three school buildings. The main content area is titled 'NEWS and ANNOUNCEMENTS' and features a news item about a referendum. A sidebar on the right includes a search bar, social media links, and quick links to various school programs.

NORTHERN BURLINGTON COUNTY REGIONAL SCHOOL DISTRICT
Celebrating 50 Years of Inspiration and Excellence
160 Mansfield Road East • Columbus, NJ 08022 • Tel: (609) 298-3900 Fax: (609) 298-3154
Wednesday, August 12, 2015 - CEEB 310-252

NBC Regional School District | NBC Middle School | NBC High School

NEWS and ANNOUNCEMENTS

■ [NB's Building Excellence Referendum on September 29](#)
Dear Parents and Friends,
For the last five months, the Board of Education and this administration has been working diligently to 'get the word out' on the pending Building Excellence plans. In May and June, our PTSC hosted presentations in the High School 500 building where Superintendent, Dr. James Sarruda, presented a comprehensive overview of the project. In fact, all the information and the PowerPoint presentations are available for your review on this web page.

Also, please note that presentations are being scheduled in each municipality. Administration and Board members will be visiting the elementary PTA's, school boards,

Search Text Search
☒ Site ☐ Web

[Follow @nbcsuper](#)

[Building Excellence](#)

[ALUMNI](#)

[AP/HONORS PROGRAM](#)

[ATHLETIC SCHEDULE](#)

[BOARD OF EDUCATION](#)



NORTHERN BURLINGTON COUNTY REGIONAL SCHOOL DISTRICT

Celebrating 50 Years of Inspiration and Excellence



160 Mansfield Road East • Columbus, NJ 08022 • Tel: (609) 298-3900 Fax: (609) 298-3154

Wednesday, August 12, 2015 - CEEB 310-252

NBC Regional School District

NBC Middle School

NBC High School



NEWS and ANNOUNCEMENTS

■ NB's Building Excellence Referendum on September 29

Dear Parents and Friends,

For the last five months, the Board of Education and this administration has been working diligently to 'get the word out' on the pending Building Excellence plans. In May and June, our PTSC hosted presentations in the High School 500 building where Superintendent, Dr. James Sarruda, presented a comprehensive overview of the project. In fact, all the information and the PowerPoint presentations are available for your review on this web page.

Also, please note that presentations are being scheduled in each municipality. Administration and Board members will be visiting the elementary PTA's, school boards,

Search Text

Search



Site



Web



Follow @nbcuper



Building Excellence



ALUMNI



AP/HONORS PROGRAM



ATHLETIC SCHEDULE



BOARD OF EDUCATION

Start With A Vision

Q & A

