



**Date:** 2/11/20

**Performed by:** Andrew Tinklenberg

**Location:** Marcy School

**RE:** Radon Testing

## INTRODUCTION

From February 3 – 6, 2020, radon testing was performed within Marcy School. The testing was performed in frequently-occupied ground contact rooms and rooms immediately above unoccupied spaces (crawl spaces and tunnels) that are in contact with the ground per the Environmental Protection Agency (EPA) and Minnesota Department of Health (MDH) guidelines.

## SUMMARY OF FINDINGS

All of the areas that were tested were found to have radon gas levels below 4.0 picocuries per liter of air (pCi/L), which is the EPA and MDH action level. The test kits in Offices 117B, 123B and 143A were moved/tampered with, but were still submitted for analysis since they were open at the time of collection. The test kits in Classrooms 105 and 121 were lost/removed and could not be submitted for analysis. Since the radon levels throughout the building were all found to be very low, re-testing in the spaces is not necessary. (Note: Rooms B & BB were the blank samples.)

Please refer to the attached AirChek radon testing report and sample diagrams for further information concerning the radon testing, areas that were tested, and the radon levels that were found to be present. Per MDH requirements, this information will be shared with the local regulatory agency (MDH). The information will also be posted on the EH&S webpage available through the main MPS website and maintained on file by EH&S.

If you have any questions regarding this information, please feel free to contact me. Thank you,

Andrew Tinklenberg  
Safety Specialist, Environmental Health & Safety  
Minneapolis Public Schools  
Environmental Health & Safety - Facilities Dept.  
[andrew.tinklenberg@mpls.k12.mn.us](mailto:andrew.tinklenberg@mpls.k12.mn.us)  
612-668-0306 Phone  
612-668-0310 EH & S General Office  
612-668-0275 Fax



## I5554 / ANDREW TINKLENBERG / MINNEAPOLIS PUBLIC SCHOOLS

Kit Number	Start Date	Start Time	End Date	End Time	Temp.	Facility	Building	Room	Project ID	Floor	Result
9360356	2020-02-03	7:00 am	2020-02-06	3:00 pm	72	MARCY	MARCY	CUSTODIAN OFFICE	MARCY	1	< 0.3
9360357	2020-02-03	7:00 am	2020-02-06	3:00 pm	68	MARCY	MARCY	GYM 140	MARCY	1	0.5
9360358	2020-02-03	7:00 am	2020-02-06	3:00 pm	68	MARCY	MARCY	OFFICE 140A	MARCY	1	0.9
9360359	2020-02-03	7:00 am	2020-02-06	3:00 pm	70	MARCY	MARCY	CAFETERIA 126B	MARCY	1	< 0.3
9360360	2020-02-03	7:00 am	2020-02-06	3:00 pm	68	MARCY	MARCY	OFFICE 128G	MARCY	1	< 0.3
9360361	2020-02-03	7:00 am	2020-02-06	3:00 pm	72	MARCY	MARCY	THEATER 120	MARCY	1	0.8
9360362	2020-02-03	7:00 am	2020-02-06	3:00 pm	69	MARCY	MARCY	OFFICE 116	MARCY	1	0.8
9360363	2020-02-03	7:00 am	2020-02-06	3:00 pm	72	MARCY	MARCY	CLASS 118	MARCY	1	1.0
9360364	2020-02-03	7:00 am	2020-02-06	3:00 pm	71	MARCY	MARCY	OFFICE 118E	MARCY	1	< 0.3
9360365	2020-02-03	7:00 am	2020-02-06	3:00 pm	70	MARCY	MARCY	CLASS 110	MARCY	1	< 0.3
9360366	2020-02-03	7:00 am	2020-02-06	3:00 pm	70	MARCY	MARCY	CLASS 108	MARCY	1	0.8
9360367	2020-02-03	7:00 am	2020-02-06	3:00 pm	70	MARCY	MARCY	CLASS 106	MARCY	1	0.9
9360368	2020-02-03	7:00 am	2020-02-06	3:00 pm	70	MARCY	MARCY	CLASS 102	MARCY	1	0.7
9360369	2020-02-03	7:00 am	2020-02-06	3:00 pm	69	MARCY	MARCY	CLASS 100	MARCY	1	0.9
9360370	2020-02-03	8:00 am	2020-02-06	3:00 pm	69	MARCY	MARCY	CLASS 101	MARCY	1	0.7
9360371	2020-02-03	8:00 am	2020-02-06	3:00 pm	68	MARCY	MARCY	OFFICE 103	MARCY	1	0.6
9360373	2020-02-03	8:00 am	2020-02-06	3:00 pm	70	MARCY	MARCY	CLASS 107	MARCY	1	0.6
9360374	2020-02-03	8:00 am	2020-02-06	3:00 pm	70	MARCY	MARCY	CLASS 109	MARCY	1	< 0.3
9360375	2020-02-03	8:00 am	2020-02-06	3:00 pm	70	MARCY	MARCY	OFFICE 111	MARCY	1	0.6
9360376	2020-02-03	8:00 am	2020-02-06	3:00 pm	69	MARCY	MARCY	CLASS 115	MARCY	1	0.7
9360377	2020-02-03	8:00 am	2020-02-06	3:00 pm	70	MARCY	MARCY	OFFICE 117A	MARCY	1	0.9
9360378	2020-02-03	8:00 am	2020-02-06	3:00 pm	70	MARCY	MARCY	OFFICE 117C	MARCY	1	1.8
9360379	2020-02-03	8:00 am	2020-02-06	3:00 pm	70	MARCY	MARCY	OFFICE 117D	MARCY	1	0.8
9360380	2020-02-03	8:00 am	2020-02-06	3:00 pm	70	MARCY	MARCY	OFFICE 117E	MARCY	1	1.9
9360381	2020-02-03	8:00 am	2020-02-06	3:00 pm	72	MARCY	MARCY	OFFICE 117B	MARCY	1	0.6
9360383	2020-02-03	8:00 am	2020-02-06	3:00 pm	68	MARCY	MARCY	OFFICE 123A	MARCY	1	1.2
9360384	2020-02-03	8:00 am	2020-02-06	3:00 pm	68	MARCY	MARCY	MEDIA CENTER 123	MARCY	1	< 0.3
9360385	2020-02-03	8:00 am	2020-02-06	3:00 pm	68	MARCY	MARCY	OFFICE 123C	MARCY	1	0.8
9360386	2020-02-03	8:00 am	2020-02-06	3:00 pm	68	MARCY	MARCY	OFFICE 123B	MARCY	1	0.8
9360387	2020-02-03	8:00 am	2020-02-06	3:00 pm	70	MARCY	MARCY	CLASS 125A	MARCY	1	< 0.3
9360388	2020-02-03	8:00 am	2020-02-06	3:00 pm	70	MARCY	MARCY	CLASS 125B	MARCY	1	0.6
9360389	2020-02-03	8:00 am	2020-02-06	3:00 pm	72	MARCY	MARCY	OFFICE 143	MARCY	1	0.5
9360390	2020-02-03	8:00 am	2020-02-06	3:00 pm	70	MARCY	MARCY	ROOM B	MARCY	1	< 0.3
9360391	2020-02-03	8:00 am	2020-02-06	3:00 pm	70	MARCY	MARCY	ROOM BB	MARCY	1	< 0.3

# DIAGRAM #1 - RADON SAMPLE LOCATIONS

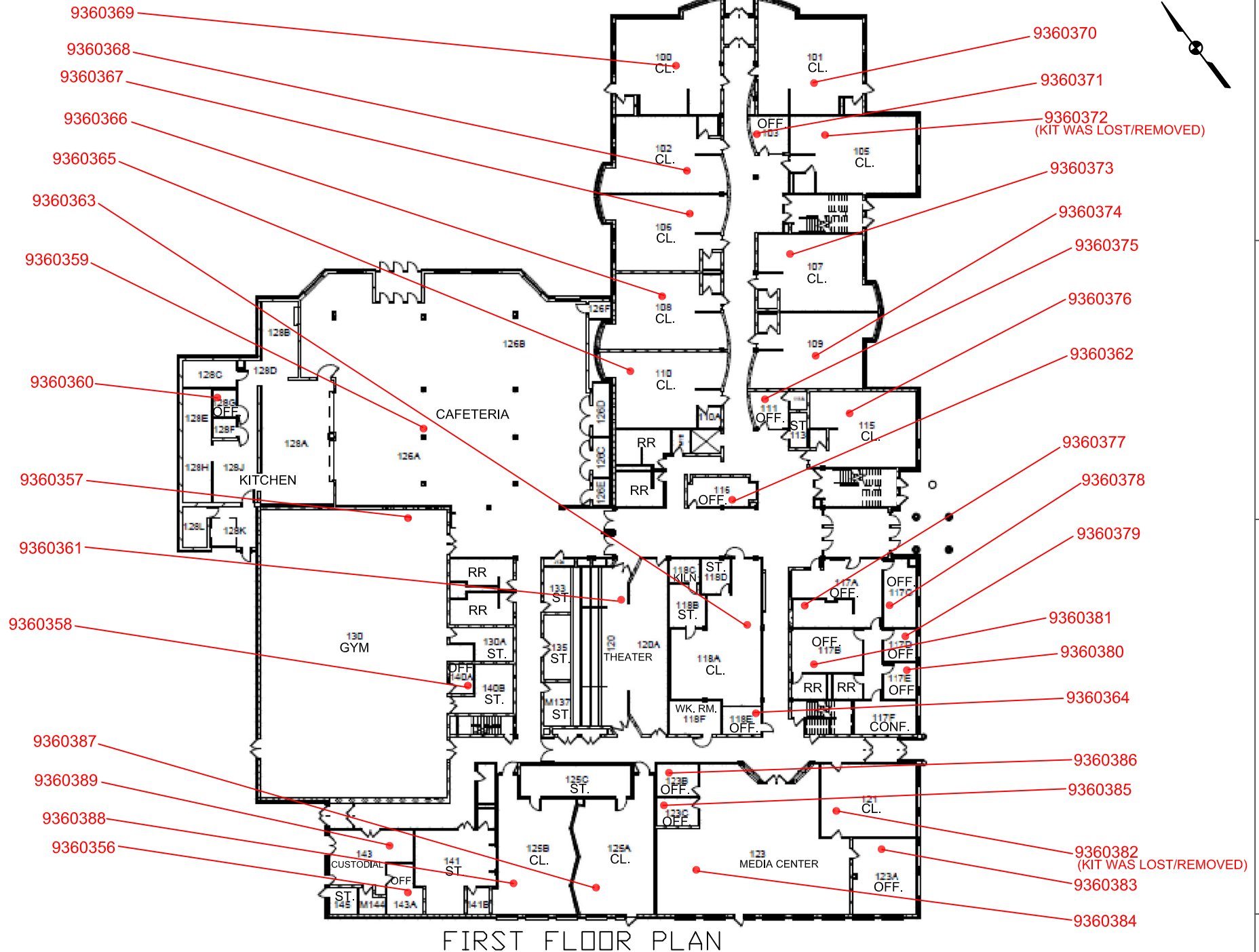
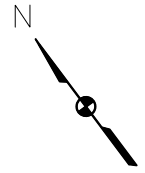

PREPARED ON: 2/3/20  
 BY: ANDREW TINKLENBERG  
 EH&S SAFETY SPECIALIST

MARCY OPEN SCHOOL  
 415 4TH AVE. SE  
 MINNEAPOLIS, MN 55414

MINNEAPOLIS  
 PUBLIC SCHOOLS  
 Urban Education. Global Citizens.

