



**Date:** 2/19/20  
**Performed by:** Andrew Tinklenberg  
**Location:** Northeast Middle School  
**RE:** Radon Testing

## INTRODUCTION

From February 11 – 14, 2020, radon testing was performed within Northeast Middle School. The testing was performed in frequently-occupied ground contact rooms and rooms immediately above unoccupied spaces (crawl spaces and tunnels) that are in contact with the ground per the Environmental Protection Agency (EPA) and Minnesota Department of Health (MDH) guidelines.

## SUMMARY OF FINDINGS

All of the areas that were tested were found to have radon gas levels below 4.0 picocuries per liter of air (pCi/L), which is the EPA and MDH action level. (Note: Rooms B & BB were the blank samples.)

Please refer to the attached AirChek radon testing report and sample diagrams for further information concerning the radon testing, areas that were tested, and the radon levels that were found to be present. Per MDH requirements, this information will be shared with the local regulatory agency (MDH). The information will also be posted on the EH&S webpage available through the main MPS website and maintained on file by EH&S.

If you have any questions regarding this information, please feel free to contact me. Thank you,

Andrew Tinklenberg  
Safety Specialist, Environmental Health & Safety  
Minneapolis Public Schools  
Environmental Health & Safety - Facilities Dept.  
[andrew.tinklenberg@mpls.k12.mn.us](mailto:andrew.tinklenberg@mpls.k12.mn.us)  
612-668-0306 Phone  
612-668-0310 EH & S General Office  
612-668-0275 Fax



## I5554 / ANDREW TINKLENBERG / MINNEAPOLIS PUBLIC SCHOOLS

Kit Number	Start Date	Start Time	End Date	End Time	Temp.	Facility	Building	Room	Project ID	Floor	Result
9360517	2020-02-11	7:00 am	2020-02-14	7:00 am	70	NORTHEAST	NORTHEAST	COMPUTER 14	NORTHEAST	0	< 0.3
9360518	2020-02-11	7:00 am	2020-02-14	7:00 am	70	NORTHEAST	NORTHEAST	COMPUTER 15	NORTHEAST	0	< 0.3
9360519	2020-02-11	7:00 am	2020-02-14	7:00 am	70	NORTHEAST	NORTHEAST	CLASS 16	NORTHEAST	0	0.7
9360520	2020-02-11	7:00 am	2020-02-14	7:00 am	70	NORTHEAST	NORTHEAST	COMPUTER 17	NORTHEAST	0	< 0.3
9360521	2020-02-11	7:00 am	2020-02-14	7:00 am	70	NORTHEAST	NORTHEAST	COMPUTER 18	NORTHEAST	0	0.8
9360522	2020-02-11	7:00 am	2020-02-14	7:00 am	70	NORTHEAST	NORTHEAST	CLASS 10	NORTHEAST	0	< 0.3
9360523	2020-02-11	7:00 am	2020-02-14	7:00 am	70	NORTHEAST	NORTHEAST	CLASS 12	NORTHEAST	0	< 0.3
9360524	2020-02-11	7:00 am	2020-02-14	7:00 am	70	NORTHEAST	NORTHEAST	CLASS 13	NORTHEAST	0	< 0.3
9360525	2020-02-11	8:00 am	2020-02-14	7:00 am	70	NORTHEAST	NORTHEAST	MEDIA CENTER 101C	NORTHEAST	1	< 0.3
9360526	2020-02-11	8:00 am	2020-02-14	7:00 am	70	NORTHEAST	NORTHEAST	OFFICE 119	NORTHEAST	1	< 0.3
9360527	2020-02-11	8:00 am	2020-02-14	7:00 am	70	NORTHEAST	NORTHEAST	OFFICE 105	NORTHEAST	1	< 0.3
9360528	2020-02-11	8:00 am	2020-02-14	8:00 am	70	NORTHEAST	NORTHEAST	CLASS 102	NORTHEAST	1	< 0.3
9360529	2020-02-11	8:00 am	2020-02-14	8:00 am	70	NORTHEAST	NORTHEAST	CLASS B103	NORTHEAST	1	< 0.3
9360530	2020-02-11	8:00 am	2020-02-14	8:00 am	70	NORTHEAST	NORTHEAST	CLASS B104	NORTHEAST	1	< 0.3
9360531	2020-02-11	8:00 am	2020-02-14	8:00 am	70	NORTHEAST	NORTHEAST	OFFICE B105	NORTHEAST	1	< 0.3
9360532	2020-02-11	8:00 am	2020-02-14	8:00 am	70	NORTHEAST	NORTHEAST	OFFICE B105B	NORTHEAST	1	< 0.3
9360533	2020-02-11	8:00 am	2020-02-14	8:00 am	70	NORTHEAST	NORTHEAST	CLASS B106	NORTHEAST	1	< 0.3
9360534	2020-02-11	8:00 am	2020-02-14	8:00 am	70	NORTHEAST	NORTHEAST	CLASS B107A	NORTHEAST	1	< 0.3
9360535	2020-02-11	8:00 am	2020-02-14	8:00 am	70	NORTHEAST	NORTHEAST	CLASS B107B	NORTHEAST	1	< 0.3
9360536	2020-02-11	8:00 am	2020-02-14	8:00 am	70	NORTHEAST	NORTHEAST	SHOP B109	NORTHEAST	1	< 0.3
9360537	2020-02-11	8:00 am	2020-02-14	8:00 am	70	NORTHEAST	NORTHEAST	OFFICE B110D	NORTHEAST	1	< 0.3
9360538	2020-02-11	8:00 am	2020-02-14	8:00 am	70	NORTHEAST	NORTHEAST	BOILER ROOM OFFICE	NORTHEAST	1	< 0.3
9360539	2020-02-11	8:00 am	2020-02-14	8:00 am	70	NORTHEAST	NORTHEAST	CLASS B110B	NORTHEAST	1	< 0.3
9360540	2020-02-11	8:00 am	2020-02-14	8:00 am	70	NORTHEAST	NORTHEAST	CLASS B110	NORTHEAST	1	< 0.3
9360541	2020-02-11	8:00 am	2020-02-14	8:00 am	70	NORTHEAST	NORTHEAST	B111 CLINIC	NORTHEAST	1	< 0.3
9360542	2020-02-11	8:00 am	2020-02-14	8:00 am	70	NORTHEAST	NORTHEAST	CLASS B113D	NORTHEAST	1	0.5
9360543	2020-02-11	8:00 am	2020-02-14	8:00 am	70	NORTHEAST	NORTHEAST	CLASS B113	NORTHEAST	1	< 0.3
9360544	2020-02-11	8:00 am	2020-02-14	8:00 am	70	NORTHEAST	NORTHEAST	CLASS B114	NORTHEAST	1	0.9
9360545	2020-02-11	8:00 am	2020-02-14	8:00 am	70	NORTHEAST	NORTHEAST	CLASS B115	NORTHEAST	1	< 0.3
9360546	2020-02-11	8:00 am	2020-02-14	8:00 am	70	NORTHEAST	NORTHEAST	CLASS B116	NORTHEAST	1	0.6
9360547	2020-02-11	9:00 am	2020-02-14	8:00 am	70	NORTHEAST	NORTHEAST	CAFETERIA	NORTHEAST	1	< 0.3
9360548	2020-02-11	9:00 am	2020-02-14	8:00 am	70	NORTHEAST	NORTHEAST	KITCHEN OFFICE	NORTHEAST	1	< 0.3
9360549	2020-02-11	9:00 am	2020-02-14	8:00 am	70	NORTHEAST	NORTHEAST	CLASS B123	NORTHEAST	1	< 0.3
9360550	2020-02-11	9:00 am	2020-02-14	8:00 am	70	NORTHEAST	NORTHEAST	OFFICE B119E	NORTHEAST	1	< 0.3
9360551	2020-02-11	9:00 am	2020-02-14	8:00 am	70	NORTHEAST	NORTHEAST	WEIGHT RM. B120	NORTHEAST	1	< 0.3

**I5554 / ANDREW TINKLENBERG / MINNEAPOLIS PUBLIC SCHOOLS**

---

<b>Kit Number</b>	<b>Start Date</b>	<b>Start Time</b>	<b>End Date</b>	<b>End Time</b>	<b>Temp.</b>	<b>Facility</b>	<b>Building</b>	<b>Room</b>	<b>Project ID</b>	<b>Floor</b>	<b>Result</b>
9360552	2020-02-11	9:00 am	2020-02-14	8:00 am	70	NORTHEAST	NORTHEAST	OFFICE B118E	NORTHEAST	1	< 0.3
9360553	2020-02-11	9:00 am	2020-02-14	8:00 am	70	NORTHEAST	NORTHEAST	ROOM B	NORTHEAST	1	< 0.3
9360554	2020-02-11	9:00 am	2020-02-14	8:00 am	70	NORTHEAST	NORTHEAST	ROOM BB	NORTHEAST	1	< 0.3

---

Air Chek 1936 Butler Bridge Rd, Mills River, NC 28759-3892 Phone: (828) 684-0893 Fax: (828) 684-8498

# DIAGRAM #1 - RADON SAMPLE LOCATIONS

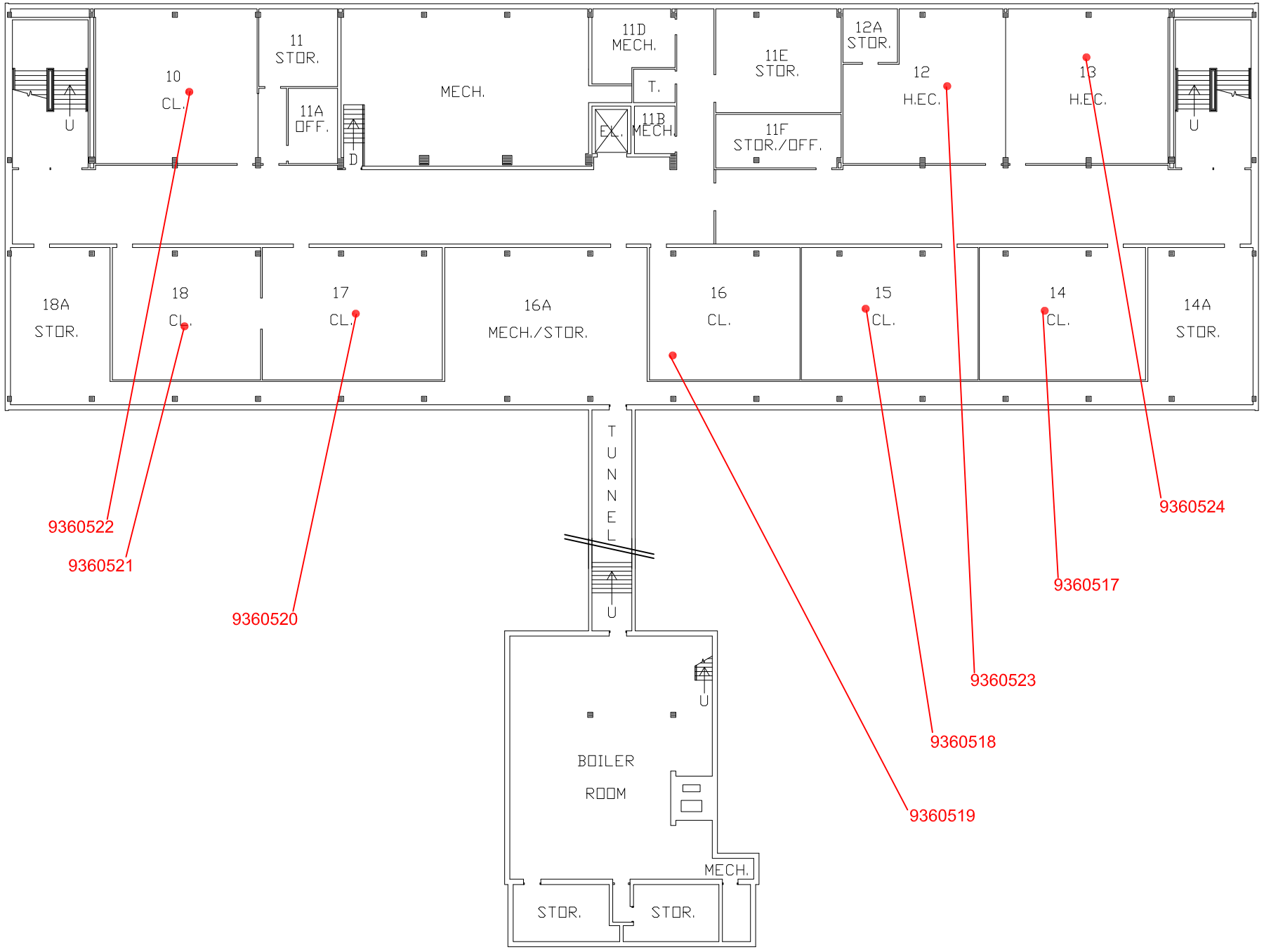

BASEMENT FLOOR PLAN

PREPARED ON: 2/11/20  
 BY: ANDREW TINKLENBERG  
 EH&S SAFETY SPECIALIST

NORTHEAST SCHOOL  
 2955 HAYES AVE. NE  
 MINNEAPOLIS, MN 55418

MINNEAPOLIS  
 PUBLIC SCHOOLS  
 Urban Education. Global Citizens.



# DIAGRAM #2 - RADON SAMPLE LOCATION

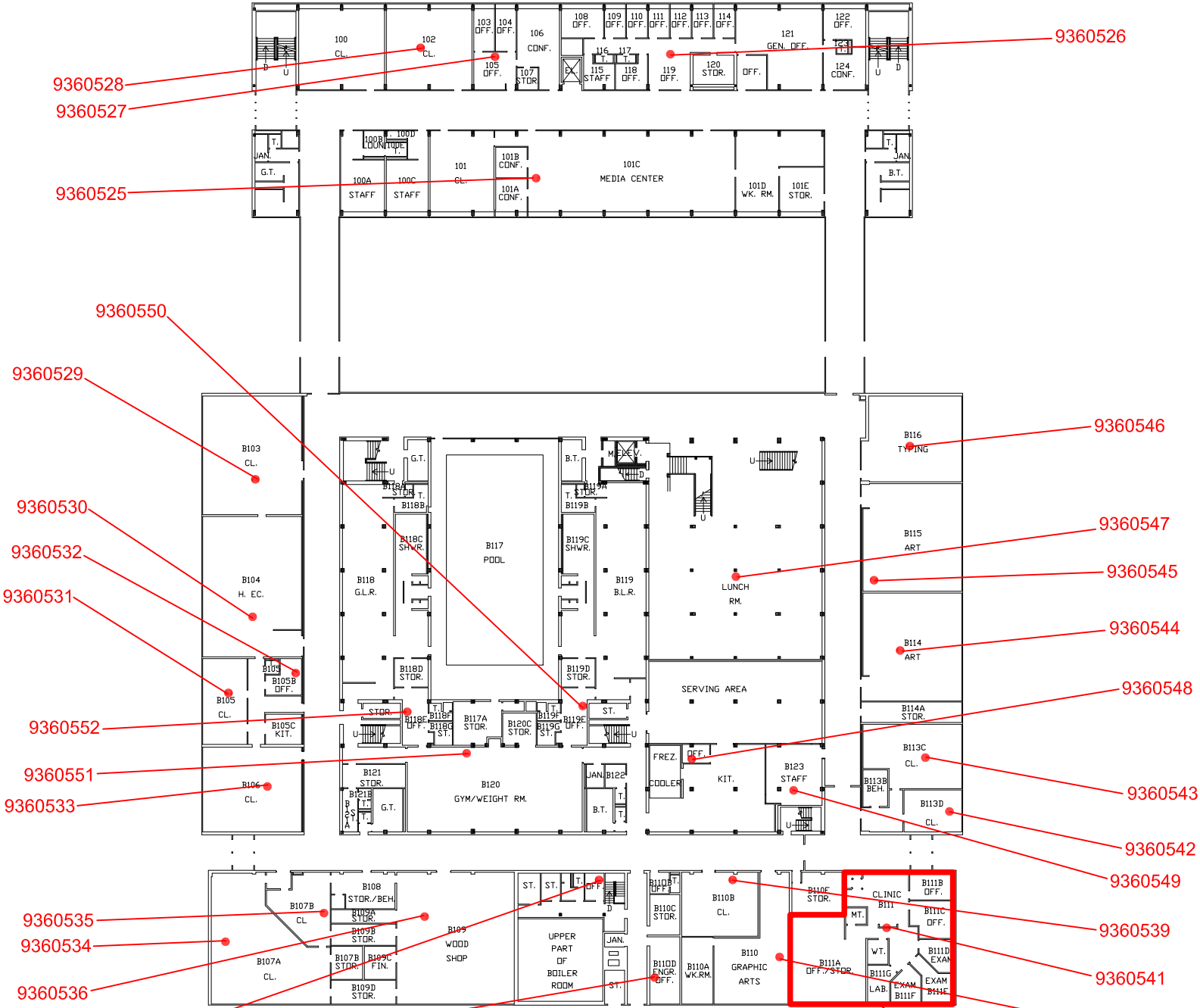

FIRST FLOOR PLAN

DENTAL CLINIC/RESOURCE CENTER

PREPARED ON: 2/11/20  
 BY: ANDREW TINKLENBERG  
 EH&S SAFETY SPECIALIST

NORTHEAST SCHOOL  
 2955 HAYES AVE. NE  
 MINNEAPOLIS, MN 55418

