



**Date:** 12/15/20

**Performed by:** Andrew Tinklenberg

**Location:** Harrison School

**RE:** Radon Testing

## INTRODUCTION

From December 8 – 11, 2020, radon testing was performed within Harrison School. The testing was performed in frequently-occupied ground contact rooms and rooms immediately above unoccupied spaces (crawl spaces and tunnels) that are in contact with the ground per the Environmental Protection Agency (EPA) and Minnesota Department of Health (MDH) guidelines.

## SUMMARY OF FINDINGS

All of the areas that were tested were found to have radon gas levels below 4.0 picocuries per liter of air (pCi/L), which is the EPA and MDH action level. (Note: Duplicate (side-by-side) sampling was conducted in select areas at a rate of 10% of areas tested, and Rooms A & B were the blank samples.)

Please refer to the attached AirChek radon testing report and sample diagrams for further information concerning the radon testing, areas that were tested, and the radon levels that were found to be present. Per MDH requirements, this information will be shared with the local regulatory agency (MDH). The information will also be posted on the EH&S webpage available through the main MPS website and maintained on file by EH&S.

If you have any questions regarding this information, please feel free to contact me. Thank you,

Andrew Tinklenberg  
NRPP ID# 111389 RT



Safety Specialist - Environmental Health & Safety

Minneapolis Public Schools

Environmental Health & Safety - Facilities Dept.

[andrew.tinklenberg@mpls.k12.mn.us](mailto:andrew.tinklenberg@mpls.k12.mn.us)

612-668-0306 Phone

612-668-0310 EH & S General Office

612-668-0275 Fax



**I5554 / ANDREW TINKLENBERG / MINNEAPOLIS PUBLIC SCHOOLS**

Kit Number	Start Date	Start Time	End Date	End Time	Temp.	Facility	Building	Room	Project ID	Floor	Result
9512715	2020-12-08	7:00 am	2020-12-11	7:00 am	70	MPS HARRISON	HARRISON	CUSTODIAN 134B	HARRISON	1	< 0.3
9512716	2020-12-08	7:00 am	2020-12-11	7:00 am	70	MPS HARRISON	HARRISON	CUSTODIAN 134B	HARRISON	1	0.5
9512717	2020-12-08	7:00 am	2020-12-11	7:00 am	70	MPS HARRISON	HARRISON	KITCHEN 152A	HARRISON	1	< 0.3
9512718	2020-12-08	7:00 am	2020-12-11	7:00 am	67	MPS HARRISON	HARRISON	OFFICE 150	HARRISON	1	< 0.3
9512719	2020-12-08	8:00 am	2020-12-11	7:00 am	67	MPS HARRISON	HARRISON	OFFICE 148	HARRISON	1	< 0.3
9512720	2020-12-08	8:00 am	2020-12-11	7:00 am	67	MPS HARRISON	HARRISON	OFFICE 148B	HARRISON	1	< 0.3
9512721	2020-12-08	8:00 am	2020-12-11	7:00 am	67	MPS HARRISON	HARRISON	GYM 111	HARRISON	1	< 0.3
9512722	2020-12-08	8:00 am	2020-12-11	7:00 am	67	MPS HARRISON	HARRISON	OFFICE 111A	HARRISON	1	< 0.3
9512723	2020-12-08	8:00 am	2020-12-11	7:00 am	68	MPS HARRISON	HARRISON	CAFETERIA 141	HARRISON	1	< 0.3
9512724	2020-12-08	8:00 am	2020-12-11	7:00 am	68	MPS HARRISON	HARRISON	STAFF 156	HARRISON	1	< 0.3
9512725	2020-12-08	8:00 am	2020-12-11	7:00 am	68	MPS HARRISON	HARRISON	CLASS 160	HARRISON	1	< 0.3
9512727	2020-12-08	8:00 am	2020-12-11	7:00 am	70	MPS HARRISON	HARRISON	OFFICE 160A	HARRISON	1	< 0.3
9512728	2020-12-08	8:00 am	2020-12-11	7:00 am	70	MPS HARRISON	HARRISON	OFFICE 161	HARRISON	1	< 0.3
9512729	2020-12-08	8:00 am	2020-12-11	7:00 am	70	MPS HARRISON	HARRISON	OFFICE 161C	HARRISON	1	1.0
9512730	2020-12-08	8:00 am	2020-12-11	7:00 am	70	MPS HARRISON	HARRISON	OFFICE 161B	HARRISON	1	0.6
9512731	2020-12-08	8:00 am	2020-12-11	7:00 am	70	MPS HARRISON	HARRISON	OFFICE 161B	HARRISON	1	< 0.3
9512732	2020-12-08	8:00 am	2020-12-11	8:00 am	67	MPS HARRISON	HARRISON	CLASS 167	HARRISON	1	0.7
9512733	2020-12-08	8:00 am	2020-12-11	8:00 am	67	MPS HARRISON	HARRISON	CLASS 173	HARRISON	1	1.0
9512734	2020-12-08	8:00 am	2020-12-11	8:00 am	67	MPS HARRISON	HARRISON	CLASS 174	HARRISON	1	< 0.3
9512735	2020-12-08	8:00 am	2020-12-11	8:00 am	67	MPS HARRISON	HARRISON	CLASS 172	HARRISON	1	< 0.3
9512736	2020-12-08	8:00 am	2020-12-11	8:00 am	67	MPS HARRISON	HARRISON	OFFICE 170A	HARRISON	1	0.5
9512737	2020-12-08	8:00 am	2020-12-11	8:00 am	67	MPS HARRISON	HARRISON	OFFICE 170B	HARRISON	1	0.6
9512738	2020-12-08	8:00 am	2020-12-11	8:00 am	67	MPS HARRISON	HARRISON	OFFICE 170C	HARRISON	1	< 0.3
9512739	2020-12-08	8:00 am	2020-12-11	8:00 am	67	MPS HARRISON	HARRISON	OFFICE 170D	HARRISON	1	0.8
9512740	2020-12-08	8:00 am	2020-12-11	8:00 am	67	MPS HARRISON	HARRISON	OFFICE 166	HARRISON	1	0.7
9512741	2020-12-08	8:00 am	2020-12-11	7:00 am	70	MPS HARRISON	HARRISON	OFFICE 162	HARRISON	1	0.7
9512742	2020-12-08	8:00 am	2020-12-11	8:00 am	66	MPS HARRISON	HARRISON	CLASS 210	HARRISON	1	< 0.3
9512743	2020-12-08	8:00 am	2020-12-11	8:00 am	66	MPS HARRISON	HARRISON	CLASS 210	HARRISON	1	< 0.3
9512744	2020-12-08	8:00 am	2020-12-11	8:00 am	70	MPS HARRISON	HARRISON	ROOM A	HARRISON	1	< 0.3
9512745	2020-12-08	8:00 am	2020-12-11	8:00 am	70	MPS HARRISON	HARRISON	ROOM B	HARRISON	1	< 0.3

# DIAGRAM #1 - RADON SAMPLE LOCATIONS



MPLS. PARK & REC. BOARD

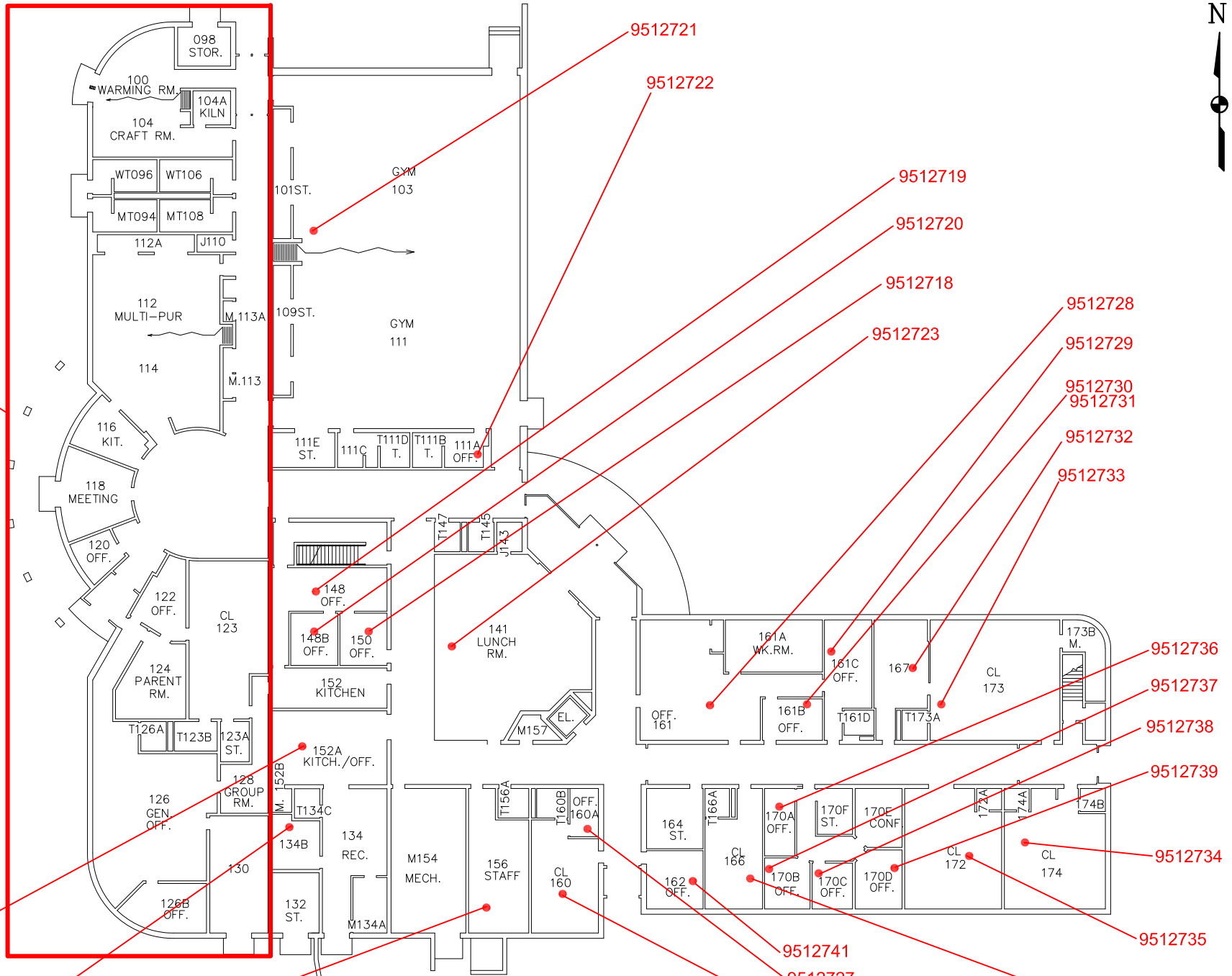

9512717

9512715  
9512716

95127124

9512721

9512722

9512719

9512720

9512718

9512723

9512728

9512729

9512730  
9512731

9512732

9512733

141 LUNCH RM.

9512736

9512737

9512738

9512739

9512734

9512735

9512741

9512727

9512725

9512740

FIRST FLOOR PLAN

PREPARED ON: 12/8/20  
BY: ANDREW TINKLENBERG  
EH&S SAFETY SPECIALIST

HARRISON SCHOOL  
501 IRVING AVE. N.  
MINNEAPOLIS, MN 55405



# DIAGRAM #2 - RADON SAMPLE LOCATIONS

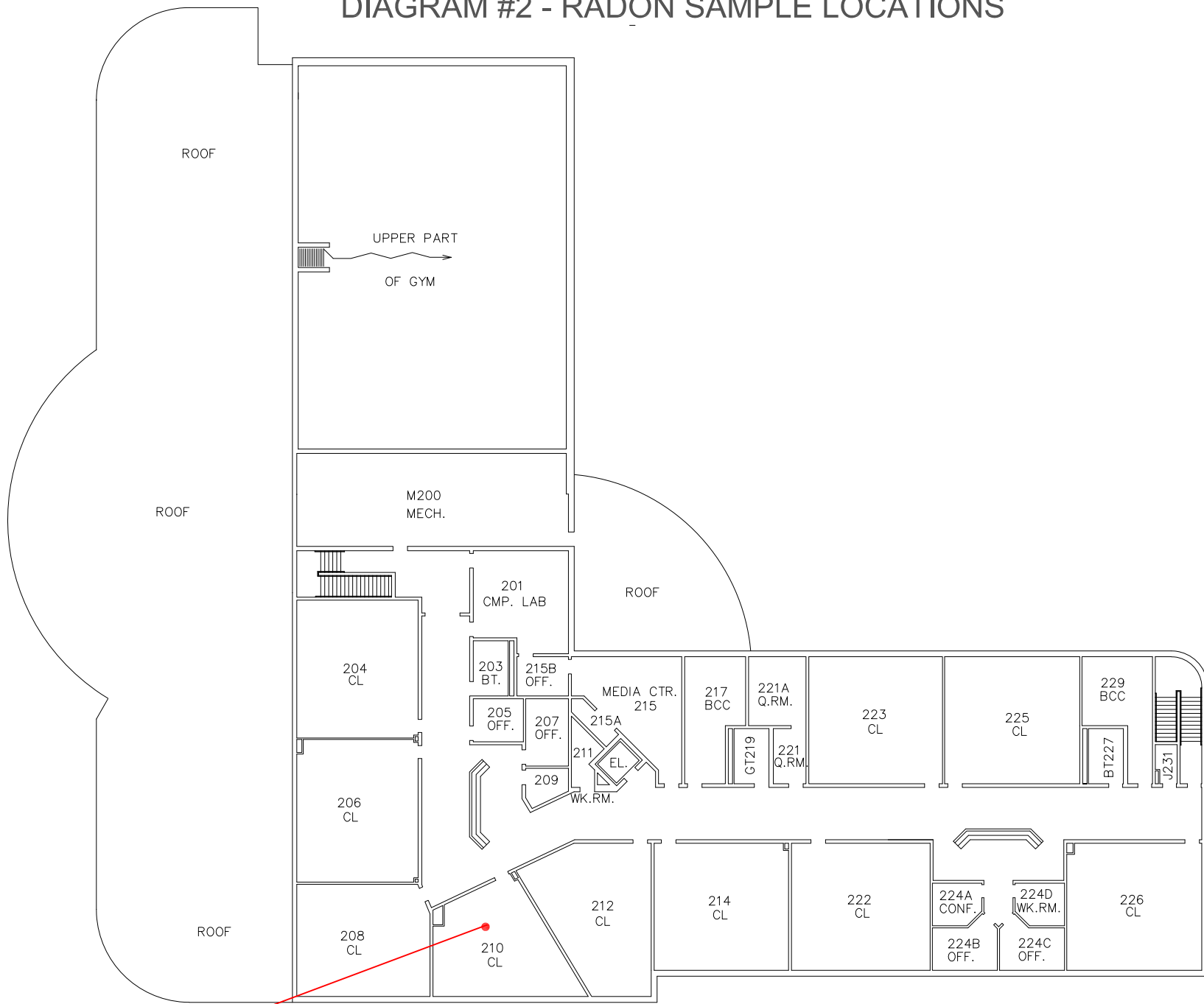

9512742  
9512743

SECOND FLOOR PLAN

PREPARED ON: 12/8/20  
BY: ANDREW TINKLENBERG  
EH&S SAFETY SPECIALIST

HARRISON SCHOOL  
501 IRVING AVE. N.  
MINNEAPOLIS, MN 55405

MINNEAPOLIS  
PUBLIC SCHOOLS  
Urban Education. Global Citizens.

