



Date: 2/11/20
Performed by: Andrew Tinklenberg
Location: Anwatin School
RE: Radon Testing

INTRODUCTION

From January 28 – 31, 2020, radon testing was performed within Anwatin School. The testing was performed in frequently-occupied ground contact rooms and rooms immediately above unoccupied spaces (crawl spaces and tunnels) that are in contact with the ground per the Environmental Protection Agency (EPA) and Minnesota Department of Health (MDH) guidelines.

SUMMARY OF FINDINGS

The test kits in Gym 506 and Auditorium 547 were lost/removed, and so the areas were retested from February 4 – 7, 2020. All of the areas that were tested throughout the building were found to have radon gas levels below 4.0 picocuries per liter of air (pCi/L), which is the EPA and MDH action level. (Note: Rooms A, B, C & D were the blank samples.)

Please refer to the attached AirChek radon testing report and sample diagrams for further information concerning the radon testing, areas that were tested, and the radon levels that were found to be present. Per MDH requirements, this information will be shared with the local regulatory agency (MDH). The information will also be posted on the EH&S webpage available through the main MPS website and maintained on file by EH&S.

If you have any questions regarding this information, please feel free to contact me. Thank you,

Andrew Tinklenberg
Safety Specialist, Environmental Health & Safety
Minneapolis Public Schools
Environmental Health & Safety - Facilities Dept.
andrew.tinklenberg@mpls.k12.mn.us
612-668-0306 Phone
612-668-0310 EH & S General Office
612-668-0275 Fax



I5554 / ANDREW TINKLENBERG / MINNEAPOLIS PUBLIC SCHOOLS

Kit Number	Start Date	Start Time	End Date	End Time	Temp.	Facility	Building	Room	Project ID	Floor	Result
7264577	2020-01-28	7:00 am	2020-01-31	7:00 am	72	MPS	ANWATIN	CUSTODIAL AREA 1	ANWATIN	0	< 0.3
7264578	2020-01-28	7:00 am	2020-01-31	7:00 am	72	MPS	ANWATIN	CAFETERIA 505	ANWATIN	1	< 0.3
7264579	2020-01-28	7:00 am	2020-01-31	7:00 am	72	MPS	ANWATIN	KITCHEN, OFFICE 504A	ANWATIN	1	< 0.3
7264581	2020-01-28	7:00 am	2020-01-31	7:00 am	70	MPS	ANWATIN	BAND 545	ANWATIN	1	0.8
7264582	2020-01-28	7:00 am	2020-01-31	7:00 am	70	MPS	ANWATIN	OFFICE 545A	ANWATIN	1	2.3
7264584	2020-01-28	8:00 am	2020-01-31	7:00 am	70	MPS	ANWATIN	OFFICE 541	ANWATIN	1	0.8
7264585	2020-01-28	8:00 am	2020-01-31	7:00 am	70	MPS	ANWATIN	OFFICE 540	ANWATIN	1	0.7
7264586	2020-01-28	8:00 am	2020-01-31	7:00 am	70	MPS	ANWATIN	OFFICE 538	ANWATIN	1	1.1
7264587	2020-01-28	8:00 am	2020-01-31	7:00 am	70	MPS	ANWATIN	STUDIO 532	ANWATIN	1	0.9
7264588	2020-01-28	8:00 am	2020-01-31	7:00 am	70	MPS	ANWATIN	CLASS 531	ANWATIN	1	1.0
7264589	2020-01-28	8:00 am	2020-01-31	7:00 am	70	MPS	ANWATIN	CLASS 530	ANWATIN	1	0.9
7264590	2020-01-28	8:00 am	2020-01-31	7:00 am	70	MPS	ANWATIN	CLASS 529	ANWATIN	1	0.8
7264591	2020-01-28	8:00 am	2020-01-31	7:00 am	70	MPS	ANWATIN	CLASS 528	ANWATIN	1	< 0.3
7264592	2020-01-28	8:00 am	2020-01-31	8:00 am	70	MPS	ANWATIN	OFFICE 515	ANWATIN	1	0.6
7264593	2020-01-28	8:00 am	2020-01-31	8:00 am	70	MPS	ANWATIN	CLASS 514B	ANWATIN	1	0.8
7264594	2020-01-28	8:00 am	2020-01-31	8:00 am	70	MPS	ANWATIN	CLASS 514	ANWATIN	1	0.7
7264595	2020-01-28	8:00 am	2020-01-31	8:00 am	70	MPS	ANWATIN	CLASS 513	ANWATIN	1	0.6
7264596	2020-01-28	8:00 am	2020-01-31	8:00 am	70	MPS	ANWATIN	CLASS 512	ANWATIN	1	< 0.3
7264597	2020-01-28	8:00 am	2020-01-31	8:00 am	70	MPS	ANWATIN	OFFICE 511	ANWATIN	1	0.8
7264598	2020-01-28	8:00 am	2020-01-31	8:00 am	70	MPS	ANWATIN	OFFICE 510	ANWATIN	1	0.6
7264599	2020-01-28	8:00 am	2020-01-31	8:00 am	70	MPS	ANWATIN	OFFICE 519	ANWATIN	1	< 0.3
7264600	2020-01-28	8:00 am	2020-01-31	8:00 am	70	MPS	ANWATIN	OFFICE 520	ANWATIN	1	< 0.3
7264601	2020-01-28	8:00 am	2020-01-31	8:00 am	69	MPS	ANWATIN	CLASS 509	ANWATIN	1	< 0.3
7264602	2020-01-28	8:00 am	2020-01-31	8:00 am	70	MPS	ANWATIN	OFFICE 509A	ANWATIN	1	< 0.3
7264603	2020-01-28	8:00 am	2020-01-31	8:00 am	70	MPS	ANWATIN	OFFICE 502	ANWATIN	1	< 0.3
7264604	2020-01-28	8:00 am	2020-01-31	8:00 am	70	MPS	ANWATIN	CLASS 422	ANWATIN	1	0.7
7264605	2020-01-28	9:00 am	2020-01-31	8:00 am	70	MPS	ANWATIN	CLASS 423	ANWATIN	1	0.8
9360301	2020-01-28	9:00 am	2020-01-31	8:00 am	70	MPS	ANWATIN	CLASS 421	ANWATIN	1	0.5
9360302	2020-01-28	9:00 am	2020-01-31	8:00 am	70	MPS	ANWATIN	CLASS 406	ANWATIN	1	< 0.3
9360303	2020-01-28	9:00 am	2020-01-31	8:00 am	70	MPS	ANWATIN	CLASS 405	ANWATIN	1	0.8
9360304	2020-01-28	9:00 am	2020-01-31	8:00 am	70	MPS	ANWATIN	CLASS 404	ANWATIN	1	< 0.3
9360305	2020-01-28	9:00 am	2020-01-31	8:00 am	70	MPS	ANWATIN	CLASS 401	ANWATIN	1	1.0
9360306	2020-01-28	9:00 am	2020-01-31	8:00 am	70	MPS	ANWATIN	CLASS 402	ANWATIN	1	< 0.3
9360307	2020-01-28	9:00 am	2020-01-31	8:00 am	70	MPS	ANWATIN	CLASS 408	ANWATIN	1	0.6
9360308	2020-01-28	9:00 am	2020-01-31	8:00 am	70	MPS	ANWATIN	CLASS 409	ANWATIN	1	0.9

I5554 / ANDREW TINKLENBERG / MINNEAPOLIS PUBLIC SCHOOLS

Kit Number	Start Date	Start Time	End Date	End Time	Temp.	Facility	Building	Room	Project ID	Floor	Result
9360309	2020-01-28	9:00 am	2020-01-31	8:00 am	70	MPS	ANWATIN	CLASS 411	ANWATIN	1	0.7
9360310	2020-01-28	9:00 am	2020-01-31	8:00 am	70	MPS	ANWATIN	CLASS 412	ANWATIN	1	1.0
9360311	2020-01-28	9:00 am	2020-01-31	8:00 am	70	MPS	ANWATIN	CLASS 413	ANWATIN	1	0.7
9360312	2020-01-28	9:00 am	2020-01-31	8:00 am	70	MPS	ANWATIN	CLASS 414	ANWATIN	1	0.6
9360313	2020-01-28	9:00 am	2020-01-31	8:00 am	70	MPS	ANWATIN	CLASS 415	ANWATIN	1	0.6
9360314	2020-01-28	9:00 am	2020-01-31	8:00 am	70	MPS	ANWATIN	CLASS 309	ANWATIN	1	0.6
9360315	2020-01-28	9:00 am	2020-01-31	8:00 am	70	MPS	ANWATIN	CLASS 308	ANWATIN	1	1.0
9360316	2020-01-28	9:00 am	2020-01-31	8:00 am	70	MPS	ANWATIN	CLASS 307	ANWATIN	1	< 0.3
9360317	2020-01-28	9:00 am	2020-01-31	8:00 am	70	MPS	ANWATIN	CLASS 313	ANWATIN	1	1.5
9360318	2020-01-28	9:00 am	2020-01-31	8:00 am	70	MPS	ANWATIN	CLASS 303	ANWATIN	1	0.9
9360319	2020-01-28	9:00 am	2020-01-31	8:00 am	70	MPS	ANWATIN	CLASS 302	ANWATIN	1	0.9
9360320	2020-01-28	9:00 am	2020-01-31	8:00 am	70	MPS	ANWATIN	CLASS 301	ANWATIN	1	1.3
9360321	2020-01-28	9:00 am	2020-01-31	8:00 am	70	MPS	ANWATIN	CLASS 304	ANWATIN	1	0.7
9360322	2020-01-28	9:00 am	2020-01-31	8:00 am	70	MPS	ANWATIN	MEDIA CENTER 305	ANWATIN	1	0.9
9360323	2020-01-28	9:00 am	2020-01-31	8:00 am	70	MPS	ANWATIN	OFFICE 305E	ANWATIN	1	< 0.3
9360324	2020-01-28	9:00 am	2020-01-31	8:00 am	70	MPS	ANWATIN	CLASS 211	ANWATIN	1	< 0.3
9360325	2020-01-28	9:00 am	2020-01-31	8:00 am	70	MPS	ANWATIN	CLASS 217	ANWATIN	1	< 0.3
9360326	2020-01-28	9:00 am	2020-01-31	8:00 am	70	MPS	ANWATIN	CLASS 218	ANWATIN	1	0.7
9360327	2020-01-28	9:00 am	2020-01-31	8:00 am	70	MPS	ANWATIN	CLASS 215	ANWATIN	1	0.7
9360328	2020-01-28	9:00 am	2020-01-31	8:00 am	70	MPS	ANWATIN	CLASS 214	ANWATIN	1	< 0.3
9360329	2020-01-28	9:00 am	2020-01-31	8:00 am	70	MPS	ANWATIN	CLASS 213	ANWATIN	1	0.6
9360330	2020-01-28	9:00 am	2020-01-31	8:00 am	70	MPS	ANWATIN	CLASS 206	ANWATIN	1	< 0.3
9360331	2020-01-28	9:00 am	2020-01-31	8:00 am	70	MPS	ANWATIN	CLASS 205	ANWATIN	1	0.7
9360332	2020-01-28	9:00 am	2020-01-31	8:00 am	70	MPS	ANWATIN	CLASS 204	ANWATIN	1	< 0.3
9360333	2020-01-28	9:00 am	2020-01-31	8:00 am	70	MPS	ANWATIN	CLASS 201	ANWATIN	1	0.9
9360334	2020-01-28	9:00 am	2020-01-31	9:00 am	70	MPS	ANWATIN	CLASS 202	ANWATIN	1	< 0.3
9360335	2020-01-28	10:00 am	2020-01-31	9:00 am	70	MPS	ANWATIN	CLASS 208	ANWATIN	1	0.9
9360336	2020-01-28	10:00 am	2020-01-31	9:00 am	70	MPS	ANWATIN	OFFICE 127	ANWATIN	1	0.6
9360337	2020-01-28	10:00 am	2020-01-31	9:00 am	70	MPS	ANWATIN	CLASS 114	ANWATIN	1	< 0.3
9360338	2020-01-28	10:00 am	2020-01-31	9:00 am	70	MPS	ANWATIN	HEALTH OFFICE 112	ANWATIN	1	0.7
9360339	2020-01-28	10:00 am	2020-01-31	9:00 am	70	MPS	ANWATIN	OFFICE 119	ANWATIN	1	1.0
9360340	2020-01-28	10:00 am	2020-01-31	9:00 am	70	MPS	ANWATIN	OFFICE 120A	ANWATIN	1	0.6
9360341	2020-01-28	10:00 am	2020-01-31	9:00 am	70	MPS	ANWATIN	OFFICE 120B	ANWATIN	1	1.1
9360342	2020-01-28	10:00 am	2020-01-31	9:00 am	70	MPS	ANWATIN	OFFICE 121	ANWATIN	1	1.2
9360343	2020-01-28	10:00 am	2020-01-31	9:00 am	70	MPS	ANWATIN	OFFICE 123	ANWATIN	1	0.6

I5554 / ANDREW TINKLENBERG / MINNEAPOLIS PUBLIC SCHOOLS

Kit Number	Start Date	Start Time	End Date	End Time	Temp.	Facility	Building	Room	Project ID	Floor	Result
9360344	2020-01-28	10:00 am	2020-01-31	9:00 am	70	MPS	ANWATIN	OFFICE 101	ANWATIN	1	0.8
9360345	2020-01-28	10:00 am	2020-01-31	9:00 am	70	MPS	ANWATIN	CLASS 103	ANWATIN	1	1.1
9360346	2020-01-28	10:00 am	2020-01-31	9:00 am	70	MPS	ANWATIN	STAFF 104	ANWATIN	1	0.9
9360347	2020-01-28	10:00 am	2020-01-31	9:00 am	70	MPS	ANWATIN	CLASS 107	ANWATIN	1	0.6
9360348	2020-01-28	10:00 am	2020-01-31	9:00 am	70	MPS	ANWATIN	OFFICE 109	ANWATIN	1	1.0
9360349	2020-01-28	10:00 am	2020-01-31	9:00 am	70	MPS	ANWATIN	OFFICE 102	ANWATIN	1	0.8
9360350	2020-01-28	10:00 am	2020-01-31	9:00 am	70	MPS	ANWATIN	OFFICE 110	ANWATIN	1	0.6
9360351	2020-01-28	10:00 am	2020-01-31	9:00 am	70	MPS	ANWATIN	OFFICE 110A	ANWATIN	1	< 0.3
9360352	2020-01-28	10:00 am	2020-01-31	9:00 am	70	MPS	ANWATIN	ROOM A	ANWATIN	1	< 0.3
9360353	2020-01-28	11:00 am	2020-01-31	9:00 am	70	MPS	ANWATIN	ROOM B	ANWATIN	1	< 0.3
9360354	2020-01-28	11:00 am	2020-01-31	9:00 am	70	MPS	ANWATIN	ROOM C	ANWATIN	1	< 0.3
9360355	2020-01-28	11:00 am	2020-01-31	9:00 am	70	MPS	ANWATIN	ROOM D	ANWATIN	1	< 0.3

I5554 / ANDREW TINKLENBERG / MINNEAPOLIS PUBLIC SCHOOLS

Kit Number	Start Date	Start Time	End Date	End Time	Temp.	Facility	Building	Room	Project ID	Floor	Result
9360428	2020-02-04	10:00 am	2020-02-07	9:00 am	70	ANWATIN	ANWATIN	GYM 506 (SOUTH)	ANWATIN (2)	1	0.8
9360429	2020-02-04	10:00 am	2020-02-07	9:00 am	70	ANWATIN	ANWATIN	GYM 506 (NORTH)	ANWATIN (2)	1	1.3
9360430	2020-02-04	10:00 am	2020-02-07	9:00 am	70	ANWATIN	ANWATIN	AUDITORIUM STAGE	ANWATIN (2)	1	0.9
9360431	2020-02-04	10:00 am	2020-02-07	9:00 am	70	ANWATIN	ANWATIN	AUDITORIUM 547	ANWATIN (2)	1	0.7

Air Chek 1936 Butler Bridge Rd, Mills River, NC 28759-3892 Phone: (828) 684-0893 Fax: (828) 684-8498

DIAGRAM #1 - RADON SAMPLE LOCATIONS

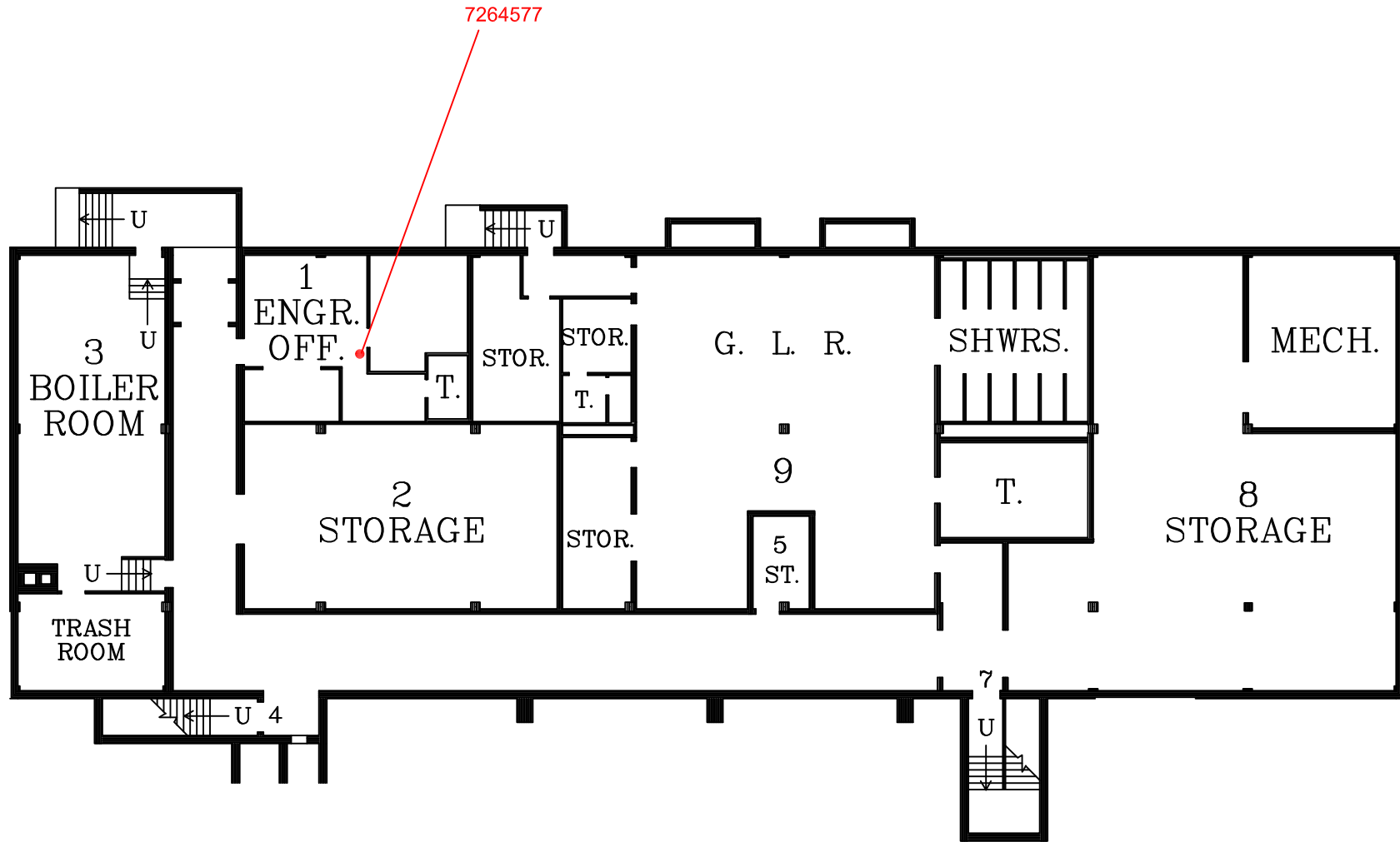

BASEMENT FLOOR PLAN

PREPARED ON: 2/4/20
BY: ANDREW TINKLENBERG
EH&S SAFETY SPECIALIST

ANWATIN SCHOOL
256 UPTON AVE. S.
MINNEAPOLIS, MN 55405

MINNEAPOLIS
PUBLIC SCHOOLS
Urban Education. Global Citizens.



DIAGRAM #2 - RADON SAMPLE LOCATIONS

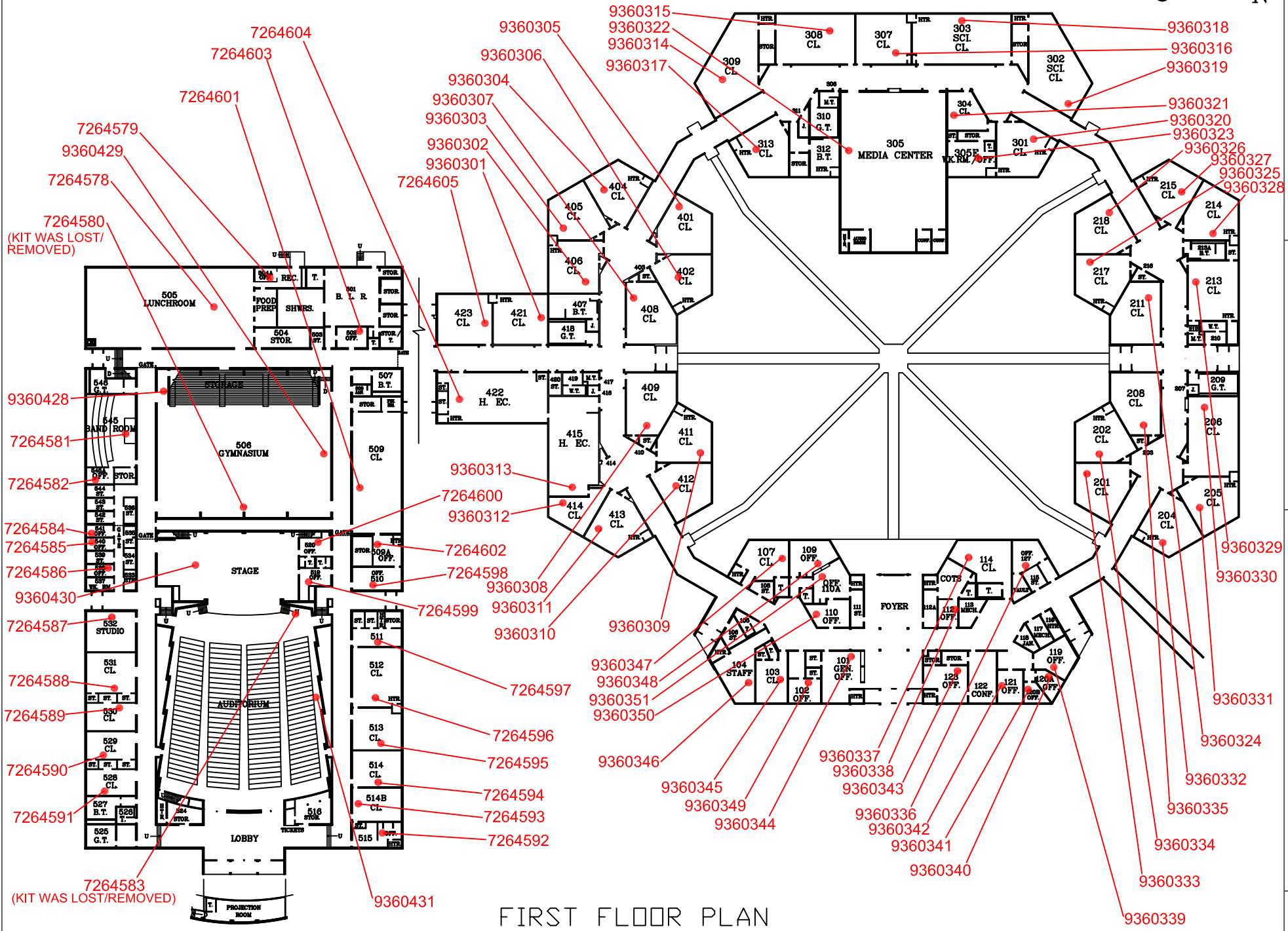
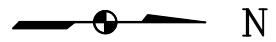

FIRST FLOOR PLAN

PREPARED ON: 2/4/20
 BY: ANDREW TINKLENBERG
 EH&S SAFETY SPECIALIST

ANWATIN SCHOOL
 256 UPTON AVE. S.
 MINNEAPOLIS, MN 55405

MINNEAPOLIS
 PUBLIC SCHOOLS
 Urban Education. Global Citizens.

