



Finance Advisory Committee

November 29, 2023





We prepare every student to achieve their personal best, engage in lifelong learning, and be a thoughtful and responsible citizen.



Agenda



OPEB Trust Quarterly Update



Capital Projects - Long Term Facility Maintenance -
Summer 2023 review and 10-year plan



ECCS Enrollment Report



Discussion / Questions

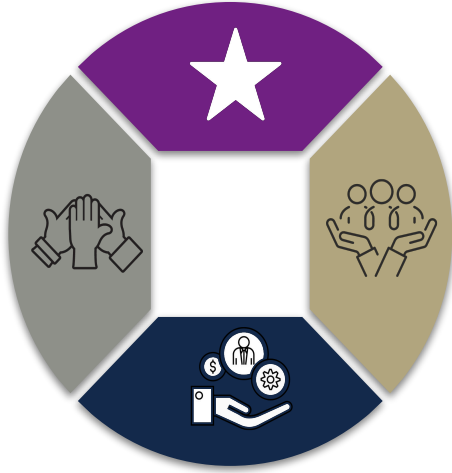

Other Post Employment Benefits (OPEB)

Quarterly Update - PFM Asset Management, LLC

Danny Nelson, Director

Brian Johnson, Director

Other Post Employment Benefits

OPEB - Other Post Employment Benefits

- Irrevocable Trust
- Refers to benefits other than pensions, that are paid in the period after employment
- Healthcare benefits include medical, dental, vision, hearing, etc.
- Used to account for both direct and implicit costs
- Expenses are implicit and direct costs as calculated from our last actuarial report which came out in January 2022
- Revenue is any interest

Report available [here](#)



Long Term Facility Maintenance

Jim Muenzenmeyer, Director of Building and Grounds

LTFM Revenue Sources

- Pay as you go - Annual Levy based on per-pupil funding
- Bond proceeds specifically for projects

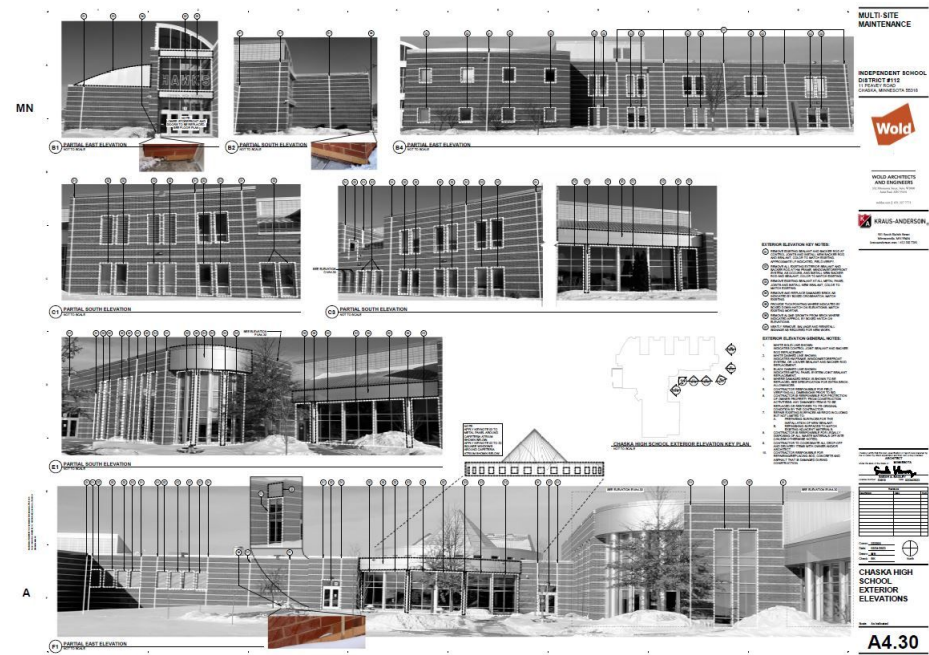

Facility Condition Assessment- What do we investigate?



SUBSTRUCTURES



SHELL/EXTERIOR



MEP SYSTEMS



EQUIPMENT



INTERIORS



CONVEYANCE



**SPECIALTY
CONSTRUCTION**



**BUILDING
SITWORK**

Facility Drift- Sorted by FCI Priority 1- No Investment

Facility	Priority 1- FCI Years 0-5	Priority 2- FCI Years 6-8	Priority 3- FCI Years 9-10	Priority 4- FCI Years 11-20
Chanhassen Elementary	0.7034	0.7187	0.7341	0.8520
East Union Elementary	0.6047	0.6308	0.6329	0.7829
Chaska Middle School - East	0.4452	0.4806	0.4920	0.6041
Chaska LaAcademia	0.4041	0.4194	0.4687	0.6608
Transportation	0.3183	0.3391	0.3183	0.3527
Chaska Middle School - West	0.2385	0.4302	0.4364	0.5843
Jonathan Elementary	0.2138	0.2515	0.5949	0.7824
Clover Ridge Elementary	0.2046	0.2307	0.2534	0.3923
Victoria Recreation Center	0.1883	0.2200	0.2200	0.3546
Family Learning Center	0.1882	0.2160	0.2711	0.4123
District Education Center	0.1229	0.1503	0.1428	0.2396
Chaska High School	0.1087	0.1081	0.1939	0.2426
Star	0.1066	0.1066	0.1193	0.2939
Bluff Creek Elementary	0.1059	0.1387	0.1644	0.3258
Pioneer Ridge Middle	0.0888	0.1954	0.2031	0.3305
Victoria Elementary	0.0631	0.0864	0.2180	0.3283
Chanhassen High School	0.0406	0.1310	0.1356	0.2454
Carver Elementary	0.0144	0.0238	0.0238	0.3066
Carver Sports Dome	0.0019	0.0028	0.0223	0.0891

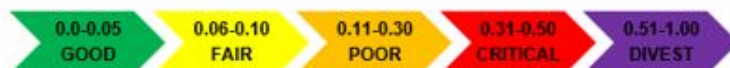

Time Frames

- 11 weeks - summers
- 1 week Holiday break
- 1 week Spring Break

General
Blue

2023

United States

January						
S	M	T	W	T	F	S
1	2	3	4	5	6	7
8	9	10	11	12	13	14
15	16	17	18	19	20	21
22	23	24	25	26	27	28
29	30	31				

February						
S	M	T	W	T	F	S
			1	2	3	4
5	6	7	8	9	10	11
12	13	14	15	16	17	18
19	20	21	22	23	24	25
26	27	28				

March						
S	M	T	W	T	F	S
						1
2	3	4	5	6	7	8
9	10	11	12	13	14	15
16	17	18	19	20	21	22
23	24	25	26	27	28	29
30	31					

April						
S	M	T	W	T	F	S
						1
2	3	4	5	6	7	8
9	10	11	12	13	14	15
16	17	18	19	20	21	22
23	24	25	26	27	28	29
30						

May						
S	M	T	W	T	F	S
	1	2	3	4	5	6
7	8	9	10	11	12	13
14	15	16	17	18	19	20
21	22	23	24	25	26	27
28	29	30	31			

June						
S	M	T	W	T	F	S
						1
2	3	4	5	6	7	8
9	10	11	12	13	14	15
16	17	18	19	20	21	22
23	24	25	26	27	28	29
30						

July						
S	M	T	W	T	F	S
						1
2	3	4	5	6	7	8
9	10	11	12	13	14	15
16	17	18	19	20	21	22
23	24	25	26	27	28	29
30	31					

August						
S	M	T	W	T	F	S
						1
2	3	4	5	6	7	8
9	10	11	12	13	14	15
16	17	18	19	20	21	22
23	24	25	26	27	28	29
30	31					

September						
S	M	T	W	T	F	S
						1
2	3	4	5	6	7	8
9	10	11	12	13	14	15
16	17	18	19	20	21	22
23	24	25	26	27	28	29
30						

October						
S	M	T	W	T	F	S
1	2	3	4	5	6	7
8	9	10	11	12	13	14
15	16	17	18	19	20	21
22	23	24	25	26	27	28
29	30	31				

November						
S	M	T	W	T	F	S
						1
2	3	4	5	6	7	8
9	10	11	12	13	14	15
16	17	18	19	20	21	22
23	24	25	26	27	28	29
30						

December						
S	M	T	W	T	F	S
						1
2	3	4	5	6	7	8
9	10	11	12	13	14	15
16	17	18	19	20	21	22
23	24	25	26	27	28	29
30	31					

2023 Holidays for United States

Jan 1	New Year's Day
Jan 2	New Year's Day (substitute day)
Jan 16	Martin Luther King Jr. Day
Feb 14	Valentine's Day
Feb 20	Washington's Birthday
Mar 17	St. Patrick's Day
Apr 9	Easter Sunday
Apr 18	Tax Day

Apr 26	Administrative Professionals Day
May 14	Mother's Day
May 29	Memorial Day
Jun 18	Father's Day
Jun 19	Juneteenth
Jul 4	Independence Day
Sep 4	Labor Day
Oct 9	Columbus Day

Oct 31	Halloween
Nov 10	Veterans Day (substitute day)
Nov 11	Veterans Day
Nov 23	Thanksgiving Day
Nov 24	Day after Thanksgiving Day
Dec 24	Christmas Eve
Dec 25	Christmas Day
Dec 31	New Year's Eve

Long-Term Facilities Maintenance

Uses of Revenue

- Deferred Maintenance – a district or co-operative can **restore facilities** it owns to a like new condition (replacement and deferred maintenance to prevent further erosion).
- Accessibility – **architectural barriers to accessibility** can be removed to meet the needs of persons with a disability.
- Health and Safety – **remove or correct school hazards identified by legislature** in Minnesota Statutes 123B.57, Subd. 6.

Health & Safety



- Physical Hazard Control
- Hazardous Substances
- Health, Safety, and & Environmental Management
- Asbestos
- Fire and Life Safety Expenditures
- Indoor Air Quality





21 Management Plans

Deferred Maintenance

- Accessibility
- Building Envelope (Excluding roof)
- Building Hardware and equipment
- Electrical
- Interior surfaces
- Mechanical systems
- Plumbing
- Professional Services and Salary
- Roofing Systems
- Site projects

●

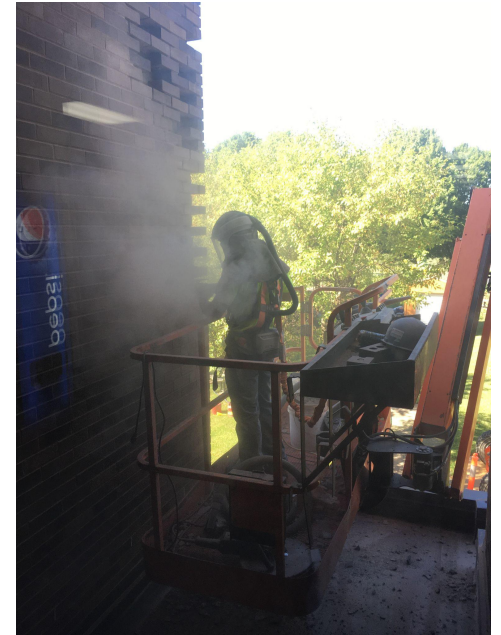

Major Projects FY 2023-24

- Chaska Middle School East
- STAR restroom renovation
- IAA lunchroom renovation
- Roof Replacement - Victoria Recreation Center
- Carpeting replacement - Chaska High School
- Exterior Door replacement - Chaska High School Phase
- Repair stucco and re-paint - Family Learning Center
- Replacement parking lot - Pioneer Ridge Middle School
- Re-key - Chaska High School and Clover Ridge Elementary School
- Replace all sky-lights - Clover Ridge Elementary
- Complete interior repaint - Victoria Elementary School



Major Projects FY 2024-25

- Phase II - Chaska Middle School East
- Phase I - Chaska Middle School West
- Replace roof - Clover Ridge Elementary School
- Replace carpeting - Bluff Creek Elementary School
- Re-key - Jonathan Elementary School
- Replace pedestrian asphalt paths - Chaska High School and Pioneer Ridge Elementary Schools
- Replace entrance doors - Phase II - Chaska High School
- Planning for a two-phase major remodeling of La Academia

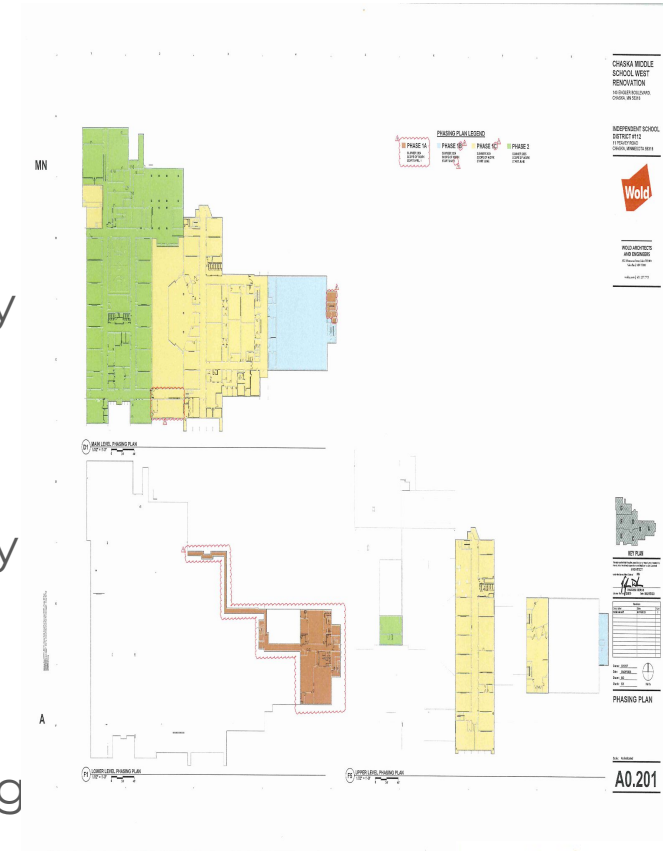



Enrollment Update

Knowing the Past | Understanding the Present | Predicting the Future

David Brecht, Student Services Manager

Purpose of this Presentation - Budget Planning

- Historical and Current Enrollment Update
- Resident Student Capture Rate
- Preliminary Enrollment Projections to Inform 24-25 Budgeting

STRATEGIC DIRECTION



Improving **TEACHING AND PERSONALIZED LEARNING** for the development of each learner



Fostering a **SAFE, WELCOMING, AND INCLUSIVE** environment



Developing **STRONG PARTNERSHIPS** within the communities we serve



Optimizing our management of **RESOURCES** to support student learning

Key Data Takeaways

1

2019-20 school year disrupted previously reliable enrollment trends in ECCS. We are now three years removed and finding new trends.

2

Large graduating classes and smaller incoming kindergarten classes impact overall enrollment. Grade 1-12 enrollment is stable.

3

New homes have not led to significant increase in school aged resident population in last five years.

4

Initial enrollment projections show slightly declining enrollment near term, which will impact revenue and create budget constraints.

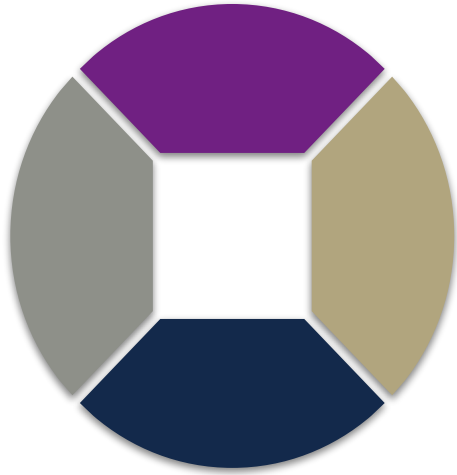

Historical and Current Enrollment

Student Enrollment

Historical, Current, and Projected Enrollment

- Annual report to Board to inform upcoming budget cycle
- Focus of this report: K-12 student headcount as of October 1
- Initial Board report of complete 22-23 data and preliminary data for current year
- Updated annual enrollment projection

Capture Rate Terminology

- **Resident Capture Rate:** percent of resident students enrolled in ECCS
- **ADM Capture Rate:** percent of state revenue generated by ECCS residents at public schools allocated to ECCS
- **Marketing Capture Rate:** Return on investment measure for marketing communication to prospective students

Average Daily Membership (ADM)

- End of school year
- Full time equivalent of student
- Part of funding formulas



K-12 Enrollment by Year - Historical and Current Year - October 1 data

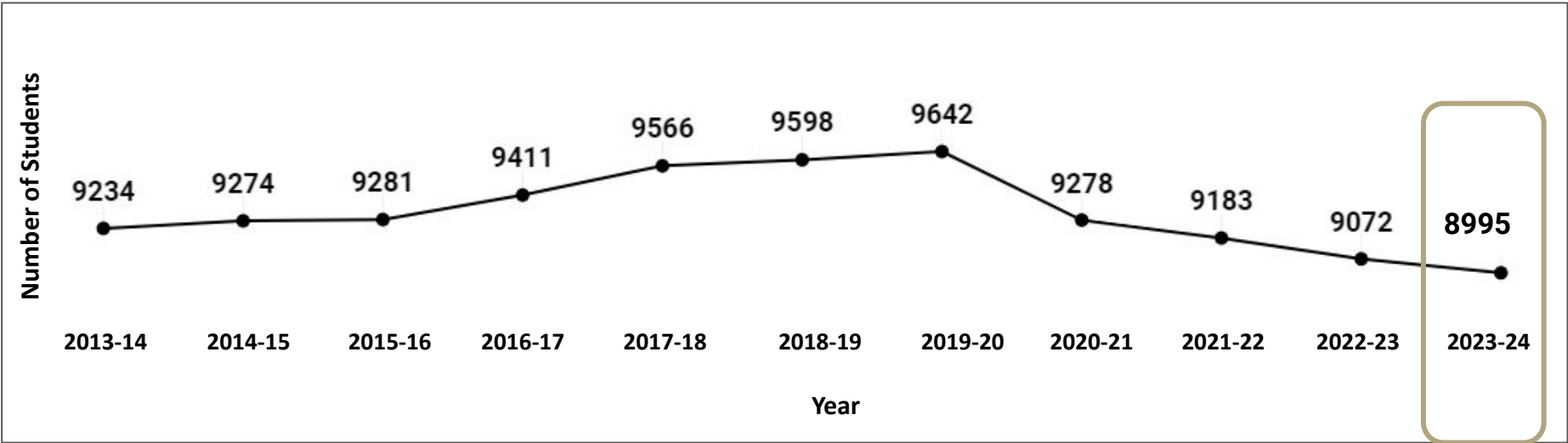

KEY POINTS

- Public school enrollment in the state of MN has declined by over 22,000 students since 2019-20
- ECCS Enrollment has declined each year since 2019-20 and a decline in enrollment impacts revenue and creates budget restraints

Enrollment Impact of Graduating Grade 12 and Incoming Grade K

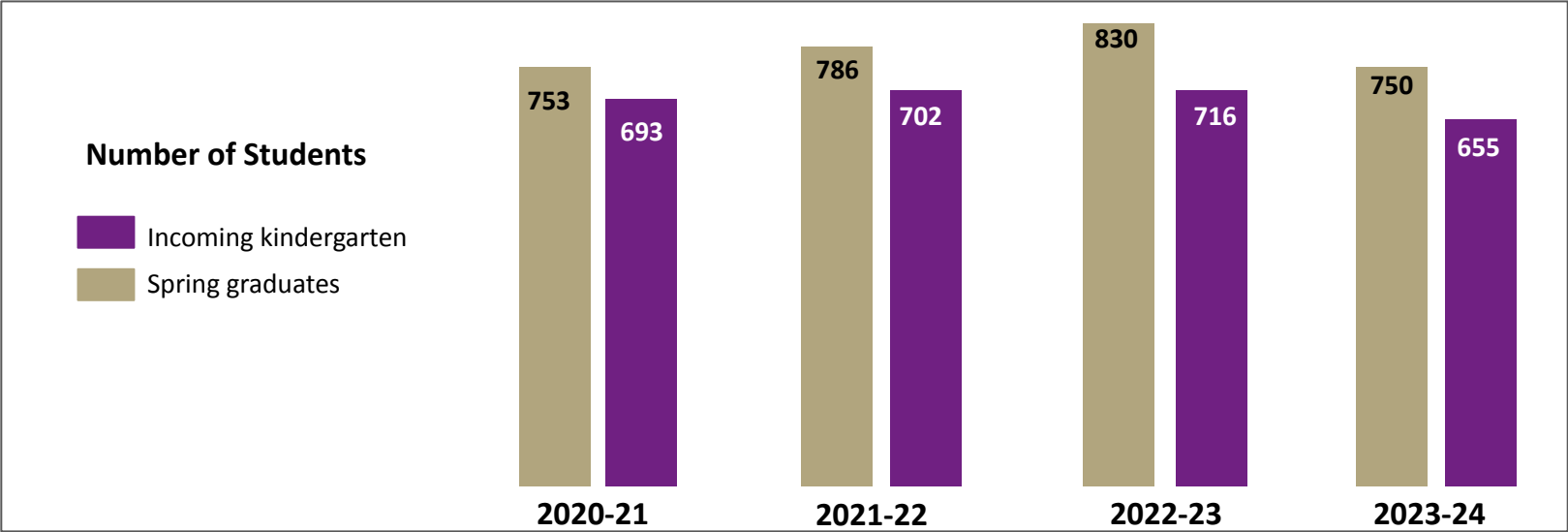

KEY POINTS

- Large graduating classes with smaller incoming kindergarten classes have impacted overall district enrollment the last four years. Projections indicate this will continue to impact enrollment the next few years
- Grade to grade enrollment has been stable aside from the enrollment change due to difference in graduating class and incoming kindergarten class

K-12 Resident and Non-Resident Enrollment by Year - October 1 Data

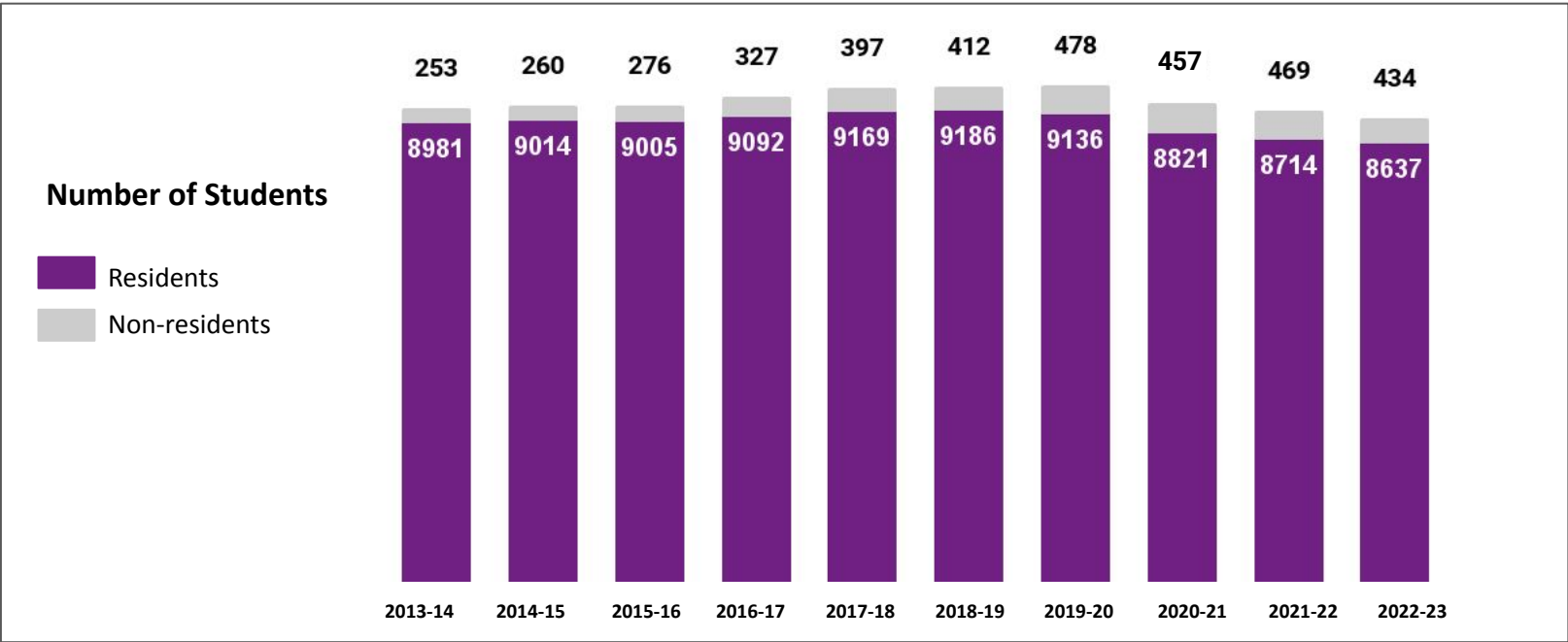

KEY POINTS

- ECCS enrollment is made up of resident students and nonresident students who open enroll with ECCS
- Non-resident enrollment into ECCS has declined after 2019-20 but is still higher than any school year before 2019-20
- In 2022-23, grades 9, 10, 11 and 12 had the highest number of non-resident students

K-12 Total Residents by Year - October 1 Data

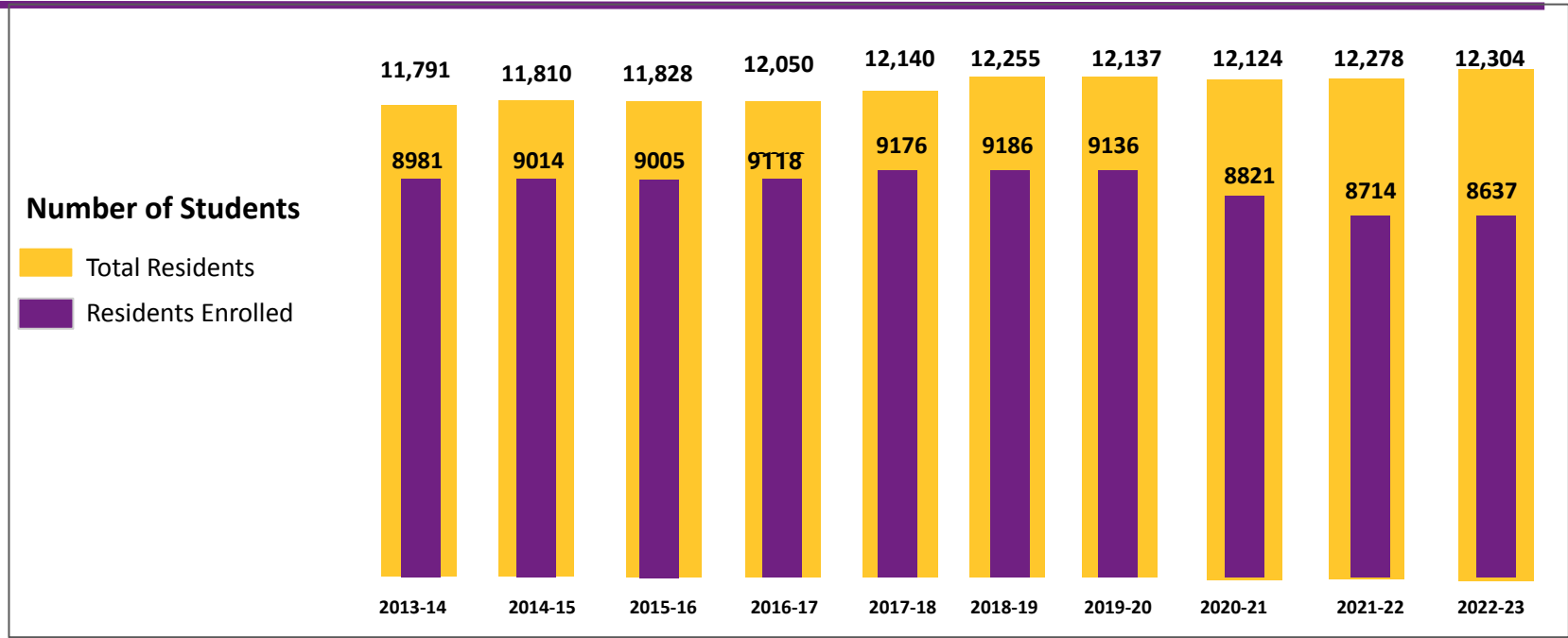

KEY POINTS

- School aged residents increased by 349 between the 2013-14 school year and the 2017-18 school year
- School aged residents increased by only 49 between the 2018-19 school year and the 2022-23 school year

Resident Student Capture Rate

K-12 Resident Student Capture Rate by Year - October 1 Data

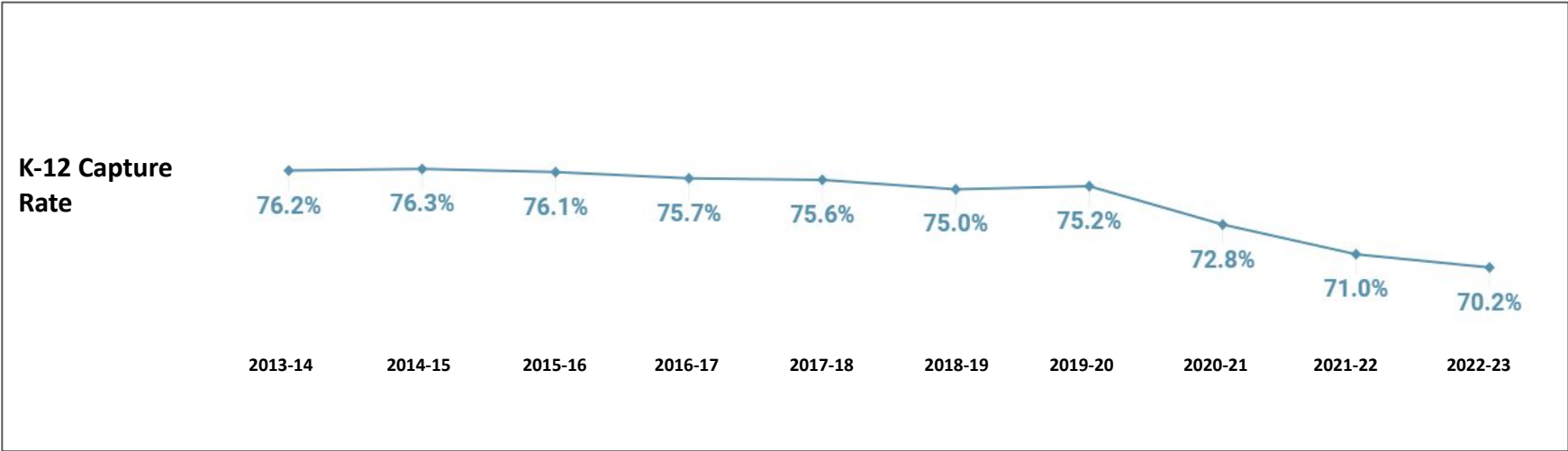

KEY POINTS

- Overall resident student capture rate was in a tight range of 75% and 76.35% between 2013-14 and 2019-20
- Overall resident student capture rate has declined each of the three years following 2019-20

K-12 Residents Enrolled Out of District by Year

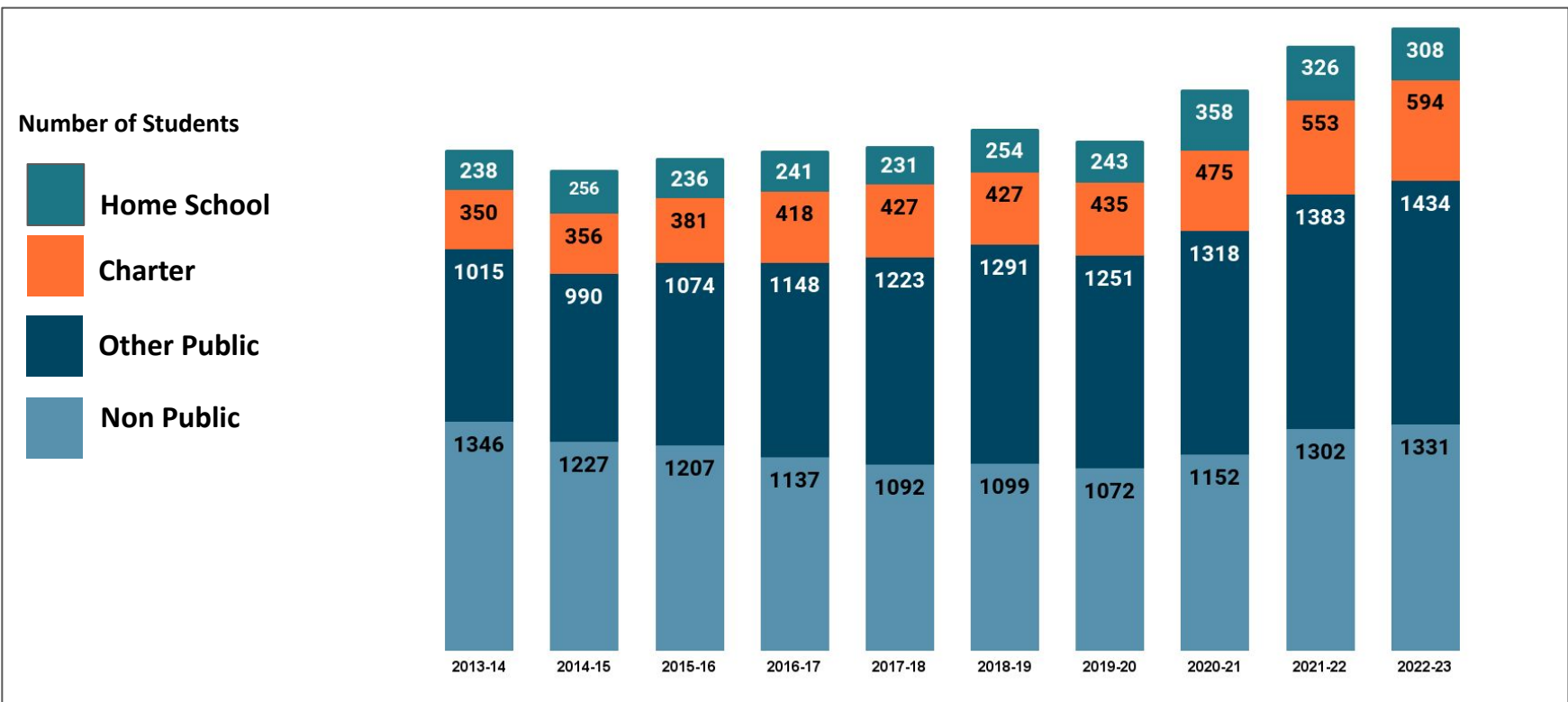

KEY POINTS

- School aged residents not attending ECCS attend home school, charter schools, non public schools or other public schools

Source: ECCS Capture Rate Data

District Charter and Non Public Options

	Total non-publics
Wayzata	11
North St. Paul-Maplewood-Oakdale	10
Hopkins	9
Eastern Carver County Schools	9
Elk River	7
Bloomington	5
Stillwater Area	5
White Bear Lake Area	5
Lakeville	4
Minnetonka	4
Mounds View	4
Eden Prairie	3
Edina	3
Shakopee	2
Farmington	0



Non Public

- Breakaway Academy
- Chapel Hill Academy
- Holy Family High School
- Southwest Christian High School
- St. Hubert Catholic School
- St. John’s Lutheran School



Charter

- Cologne Academy
- Jonathan Montessori
- World Learner

KEY POINTS

- There are double the options for families who live within ECCS district boundaries than our surrounding districts.

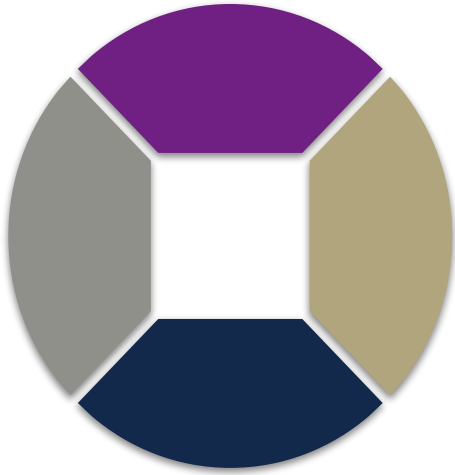

Preliminary Enrollment Projections

ECCS Enrollment Projection Methodology

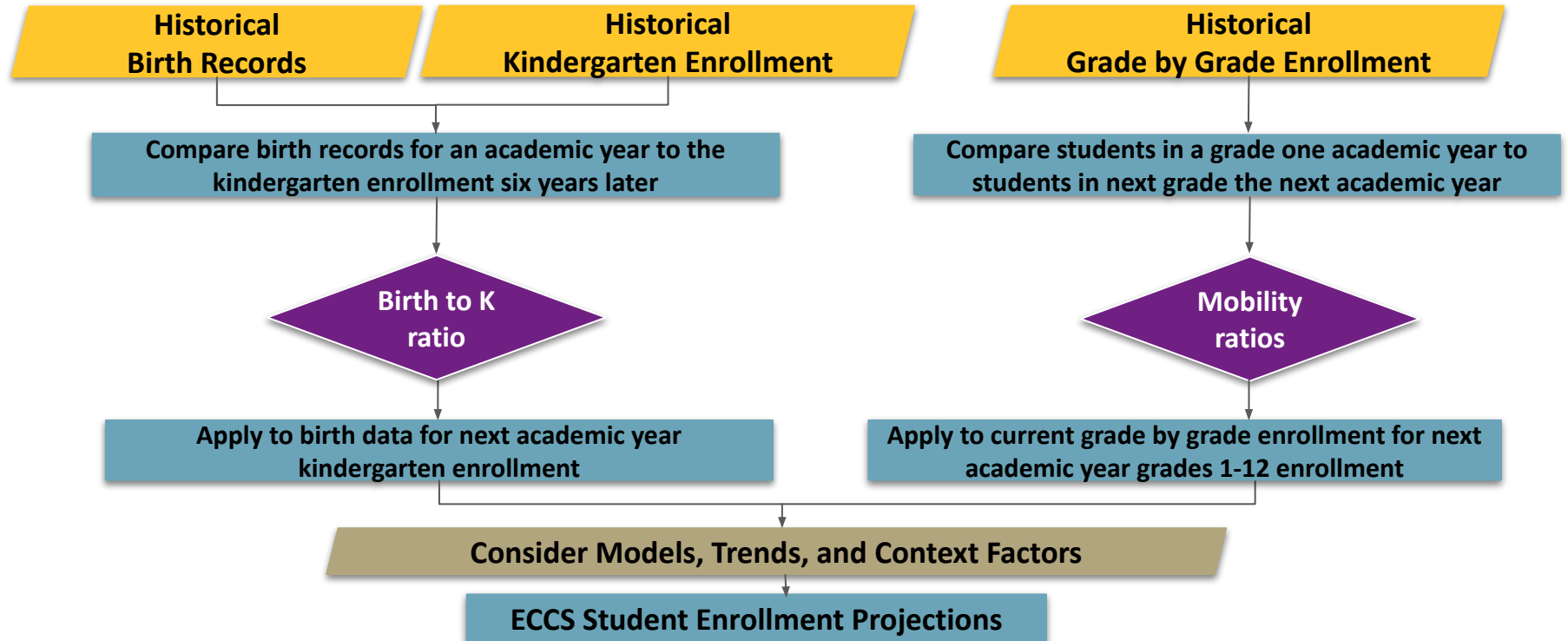

2023-24 Projection to Actual

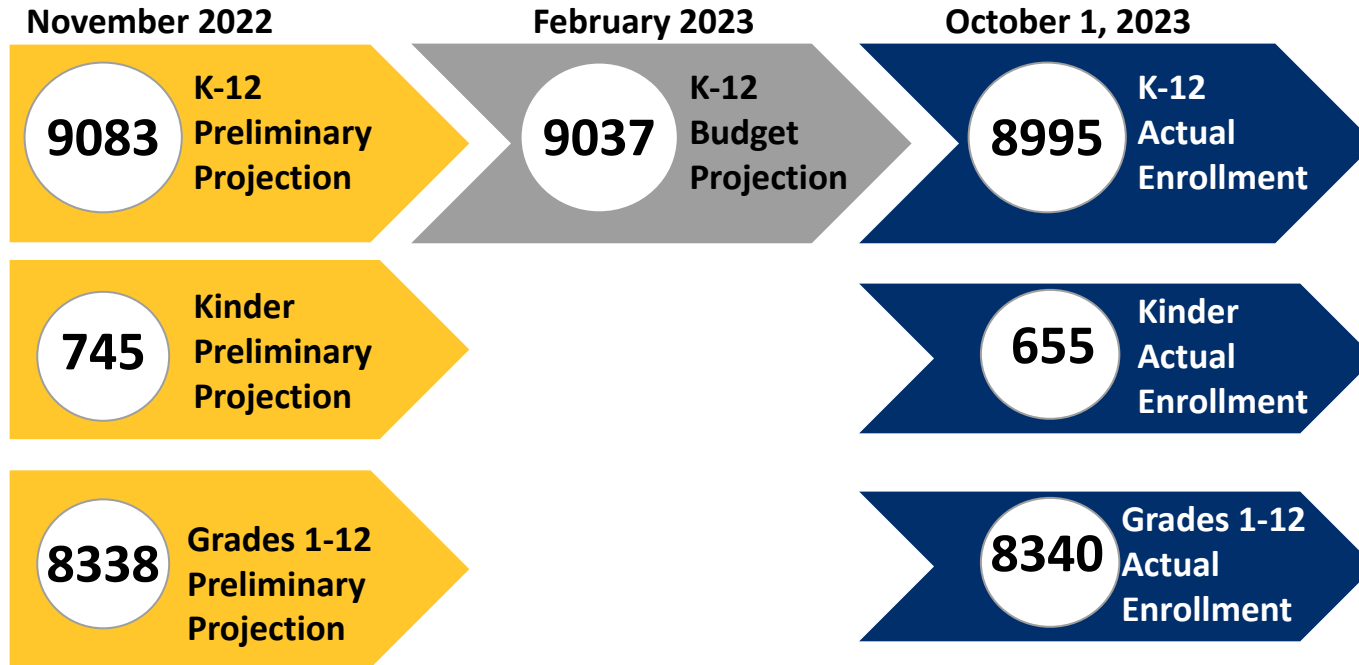

KEY POINTS

- Overall enrollment projection was 99% accurate, grades 1-12 projection was 99.98% accurate

Preliminary 5-Year Projection

Number of Students

Modeling two year average birth to K and three year average grade to grade mobility ratios

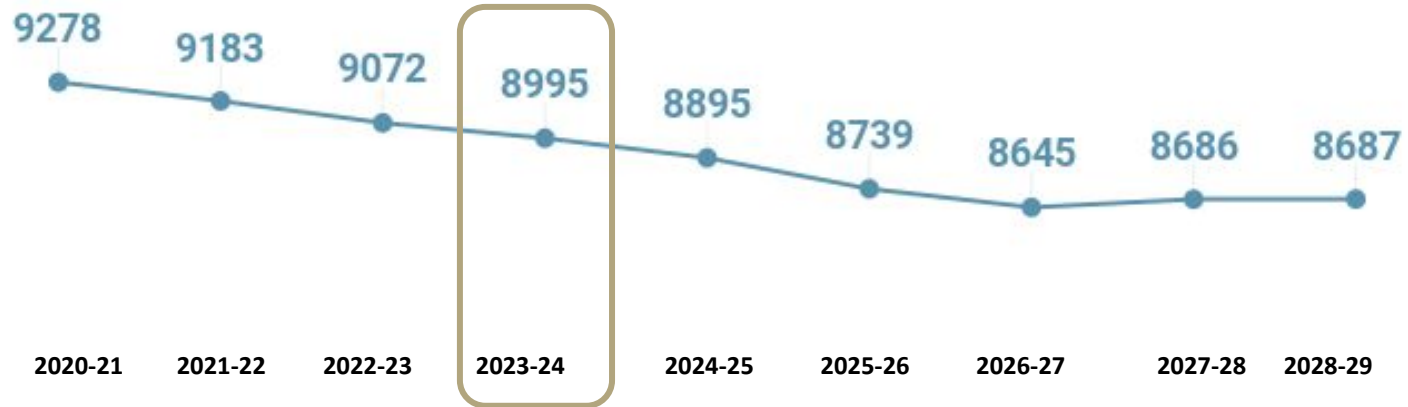

KEY POINTS

- Current 5-year projection shows slightly declining enrollment each of the next three years which will impact revenue and create budget constraints.

Key Data Takeaways

1

2019-20 school year disrupted previously reliable enrollment trends in ECCS. We are now three years removed and finding new trends.

2

Large graduating classes and smaller incoming kindergarten classes impact overall enrollment. Grade 1-12 enrollment is stable.

3

New homes have not led to significant increase in school aged resident population in last five years.

4

Initial enrollment projections show slightly declining enrollment near term, which will impact revenue and create budget constraints.

Next Steps

1

Solidify overall enrollment projections as basis for budget and 5 year financial projection

2

Develop detailed enrollment by building by grade to utilize as we consider staffing, enrollment, and building capacity

3

Board will engage with enrollment projections again when reviewing 24-25 budget beginning in February

4

Continue work aligned to the strategic plan to grow enrollment

Discussion

