

NOVEMBER 2023



What's UP

The Greenheck Turner Community Center is committed to meeting community needs by providing opportunities for all in areas of recreation, wellness, athletics, and social activities.



Greenheck Turner Community Center

GTCC

PROVIDING CARE



"I know my children are in a safe and caring place after school." ~Mary~

The Adventure Care program offers activity-based care, mentorship, and nutritious snacks for students after school. The initiative was launched to establish a stronger connection with families and address the needed childcare void in the area.

The ADVENTURE CARE program is currently offered in every elementary school in the D.C. Everest District, and staff is provided by the Community Services department of Greenheck Turner Community Center. Before school care begins at 6:30 am at most schools and ends at 6:00 pm. This daycare option is offered at a reasonable cost and provides a safe place for students outside of the regular school day.

VACATION FUN DAYS are also offered on occasional no-school days at the Greenheck Turner Community Center. These fun days are filled with activity-based care providing children with opportunities to ice skate, use the bounce houses, and run and play in the gyms. Breakfast, lunch and an afternoon snack are also provided.

WESTON CONNECT, in its fifth grant year cycle, is specifically at Weston Elementary, and funded by the Nita M Lowey 21st Century Community Learning Center Grant. This before and after school care is provided at no cost for families at Weston Elementary and includes activity-based care, gym time, STEAM activities and meals. On a weekly basis, program activities are structured around themes and involve community field trips, guest speakers, and community partnerships.

The program encourages academic enrichment activities and provides staff mentors who help students engage after school. Additionally, activity play allows children to expend their energy after school in a safe environment, either in the gym or outside on the playground. [Learn more about all of these programs and for availability.](https://gtcc.dce.k12.wi.us/quick-links/adventure-care)

<https://gtcc.dce.k12.wi.us/quick-links/adventure-care>

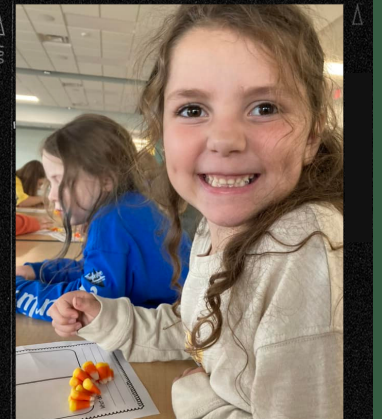
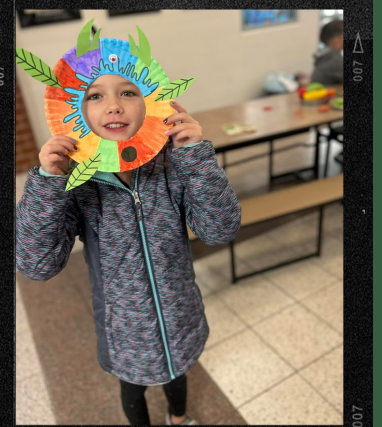

TOPPING OFF

On October 30, 2023, one year after ground breaking, our construction project celebrated a milestone known as the Topping Off Ceremony.

This marked the last piece of structural steel to be installed at the Greenheck Turner Community Center. The ceremony is a respected tradition with tradespeople as the last beam is painted white and signed. A small evergreen tree was placed on top of the beam signifying the skeleton of the building is complete.

Dr. Casey Nye thanked the hundreds of tradesman on site throughout this project, along with the DCE School Board and DCE Education Foundation Board members who have supported this project from the beginning. The Boldt Company and Somerville architects were onsite to see this milestone celebrated along with donors, staff, and family members.

The first week of November, glass windows were installed across the front of the building allowing natural light throughout the arena. The front pre-cast cement walls were completed and the front half of the roof was also completed. With favorable weather in the next week, the building should be enclosed soon allowing the next phase of construction to begin inside.

The Greenheck Turner Community Center is a project built for the community and will be open in the Fall 2024. The Greenheck Turner Community Center is committed to meeting community needs by providing opportunities for all in areas of recreation, wellness, athletics, and social activities.



COMMUNITY legacy WALL

GREENHECK TURNER COMMUNITY CENTER

DC EVEREST EDUCATION
FOUNDATION

The Legacy Wall offers a unique opportunity to honor your family, team or your company. Contributions of \$500 and up will be acknowledged on this wall located on the main floor of the new Greenheck Turner Community Center. This is a significant way to show appreciation for donor gifts, and donations can be made anonymously or in memory of your loved one as this display will be in the building forever. There are hundreds of names ready to be added to wall- make one of them yours! The facility is expected to open in Fall 2024, hosting games, leagues, tournaments, camps, and various community events. If you have questions about the Legacy Wall, please email:

dceverestfoundation@gmail.com

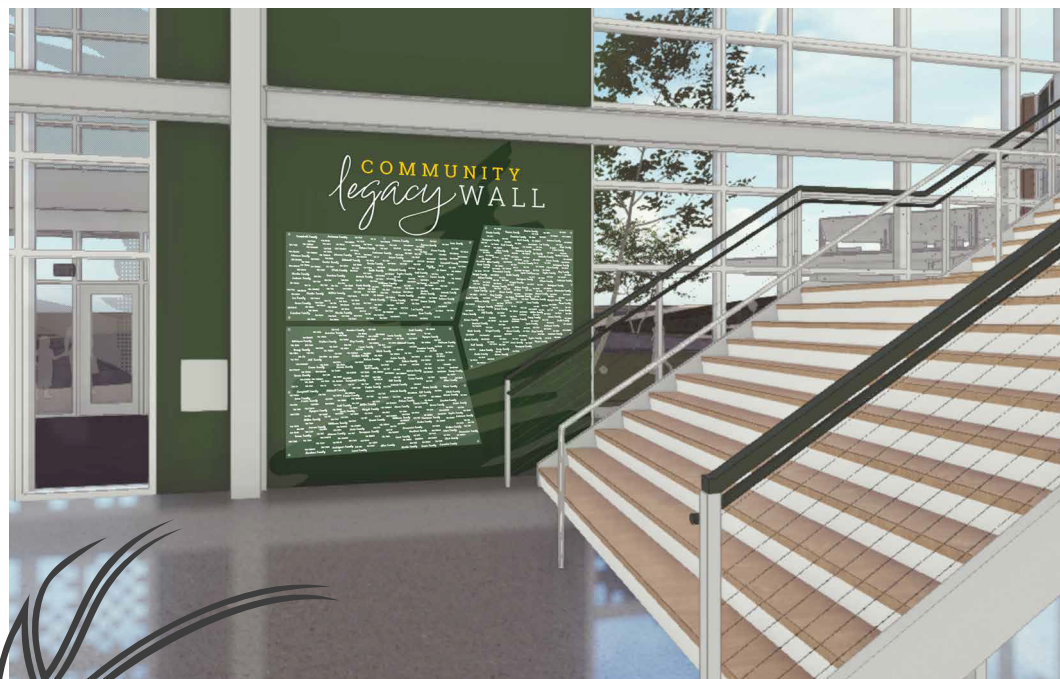

BASKETBALL
BASKETBALL
BASKETBALL

Kudos to our amazing Youth Recreational Basketball program that came to a conclusion this past Saturday! We tip our hats to the youngsters, coaches, leaders, mentors, families, and role models who made it a roaring success. It's been an action-packed 11-weeks of youth sports, including soccer, flag football, and basketball, leaving us all a little breathless. But hey, don't hit pause just yet! Registration is now open for the winter/spring season. Get ready for indoor soccer, volleyball, lacrosse, and golf to keep the fun going!  <https://gtcc.dce.k12.wi.us/quick-links/rec-sports>





Upcoming Events



Thanksgiving

Thursday, November 23, 2023

Free Group Fitness Classes

We are thankful for you! Join us for Free Fitness Classes on Thanksgiving morning with Sara Pinsonneault and Doug Jenkin.

7:00 am - Cycling and 8:00 am - Zumba

Please donate a nonperishable food item as we celebrate together Thanksgiving morning. Items will be donated to Peyton's Promise, a nonprofit dedicated to fighting hunger in our area by supporting food pantries. Some of the most needed items include peanut butter, rice, soup, spices, canned chicken, tuna, and low-sugar cereal.



Public Skate, Bounce House Nights & Climbing Wall

Please check the most updated activity calendar online for public skate, bounce house dates, and open climb events. Most events are \$4-5 and on a variety of days and times.

★ Special Events

Bounce House Day November 22, 1:30-3:30 pm
Two 4 One Skate & Climb November 25, 7:00 pm
Santa's Workshop December 23, 7:00 pm
Family Series December 26-27-28 6:00 pm
Youth Open Gyms December 26-27-28
New Year's Bash December 30 7:00 pm

December

Sunday	Monday	Tuesday	Wednesday	Thursday	Friday	Saturday
			29			1 2
			Bounce House Night 5:30-7:30 pm			Ice Skate 7:00-8:20 pm Climbing Wall 7:30-9:00 pm
3	4	5	6	7	8	9
			Bounce House Night 5:30-7:30 pm			Ice Skate 7:00-8:20 pm Climbing Wall 7:30-9:00 pm
10	11	12	13	14	15	16
			Bounce House Night 5:30-7:30 pm			Ice Skate 7:00-8:20 pm Climbing Wall 7:30-9:00 pm
17	18	19	20	21	22	23
			Bounce House Night 5:30-7:30 pm			Santa's Workshop Public Skate & Climbing Wall 7:00-9:00 pm
24	25	26	27	28	29	30
		Bounce House Day 1:30-3:30 pm Youth Open Gym 1:30-4:00 pm Family Series Open Games 5:00-6:00 pm	Ice Skate 7:00-8:20 pm Youth Open Gym 1:30-2:30 pm Youth Open Gym 3:00-4:00 pm Family Series Open Games 6:00-7:30 pm	Youth Open Gym 1:30-4:00 pm Family Series Open Games 6:00-7:30 pm	Ice Skating 1:30-3:00 pm	New Year's Bash Public Skate & Climbing Wall 7:00-9:00 pm

Girls Basketball Skills & Drills Clinic

REGISTER NOW

Saturdays in January & February. Each session will be run as a skills & drills clinic. This is a wonderful way to introduce your daughter to the sport of basketball, where our focus is on the FUNDamentals! There will be three different groups, based on grade.
 Age 4-Kindergarten – 9:00-9:45 am
 1-2nd grade – 10:00-10:45 am
 3-5th grade – 11:00-11:45 am
 Saturdays, January 13, 20, 27, February 3, 2024 (No clinic January 6)

Starting New at Golf (SNAG)

SNAG contains all the elements of golf but in a modified form. Lessons will be taught by PGA Professional Buck Welsh. SNAG has its own unique set of equipment, suitable for indoor play, and all equipment is provided as part of the lessons. Register for whichever session fits your schedule. Max of 10 participants per session.

Session #1: Tuesdays, January 9, 16, 23, 30, February 6. \$45/participant.

Session #2: Mondays, February 12, 19, 26, March 4, 11. \$45/participant.

Open to boys & girls in 3rd - 5th Grade. Both sessions will be held at Evergreen Elementary from 6:00-7:00 pm

Youth Open Gyms December 26-27-28

For youth age 11-17 1:00-4:00 pm
 Only \$7- open gym space for basketball or volleyball.



Intro to Lacrosse

Sundays in February & March. For boys and girls grades 3-8. Each session will be run as a clinic with coaches & players from the Wausau Wolfpack Lacrosse teaching the fundamentals. February 18, 25, March 3, 10, 17, 2024.



Indoor Youth Soccer

Sundays in February & March. For boys and girls age 4K though 5th grade on Sundays. No soccer experience is necessary. All participants are required to wear shin guards. We are always in need of volunteer coaches to help make this program successful. February 18, 25, March 3, 10, 17, 2024. Greenheck Turner Community Center Gyms
 Between Noon-6:00 pm

Girls Volleyball Skills & Drills Clinic

Sundays in April. This introductory program is open to girls in 3-6th grade who wish to develop their volleyball skills, include serving, passing, setting, blocking, and defensive strategies. Instruction will be provided by the DC Everest Volleyball coaching staff and players.
 3-4th Grade – 1:00-2:15 pm
 5-6th Grade – 2:30-4:00 pm
 Sundays, April 7, 14, 21, 28, May 5
 DC Everest Junior High Gym