

NOTE: EXISTING CONDITIONS OF CONSTRUCTION SHOWN ON THIS DRAWING ARE BASED ON DRAWINGS PREPARED BY "RUSSELL, GIBSON, vandoHLEN INC." ARCHITECTS DATED 3-15-78 AND ARE FOR REFERENCE ONLY (NOT AS-BUILT DRAWINGS), AS PROVIDED TO F&D, BY THE OWNER. ALL EXISTING CONDITIONS AND DIMENSIONS ARE TO BE FIELD VERIFIED.

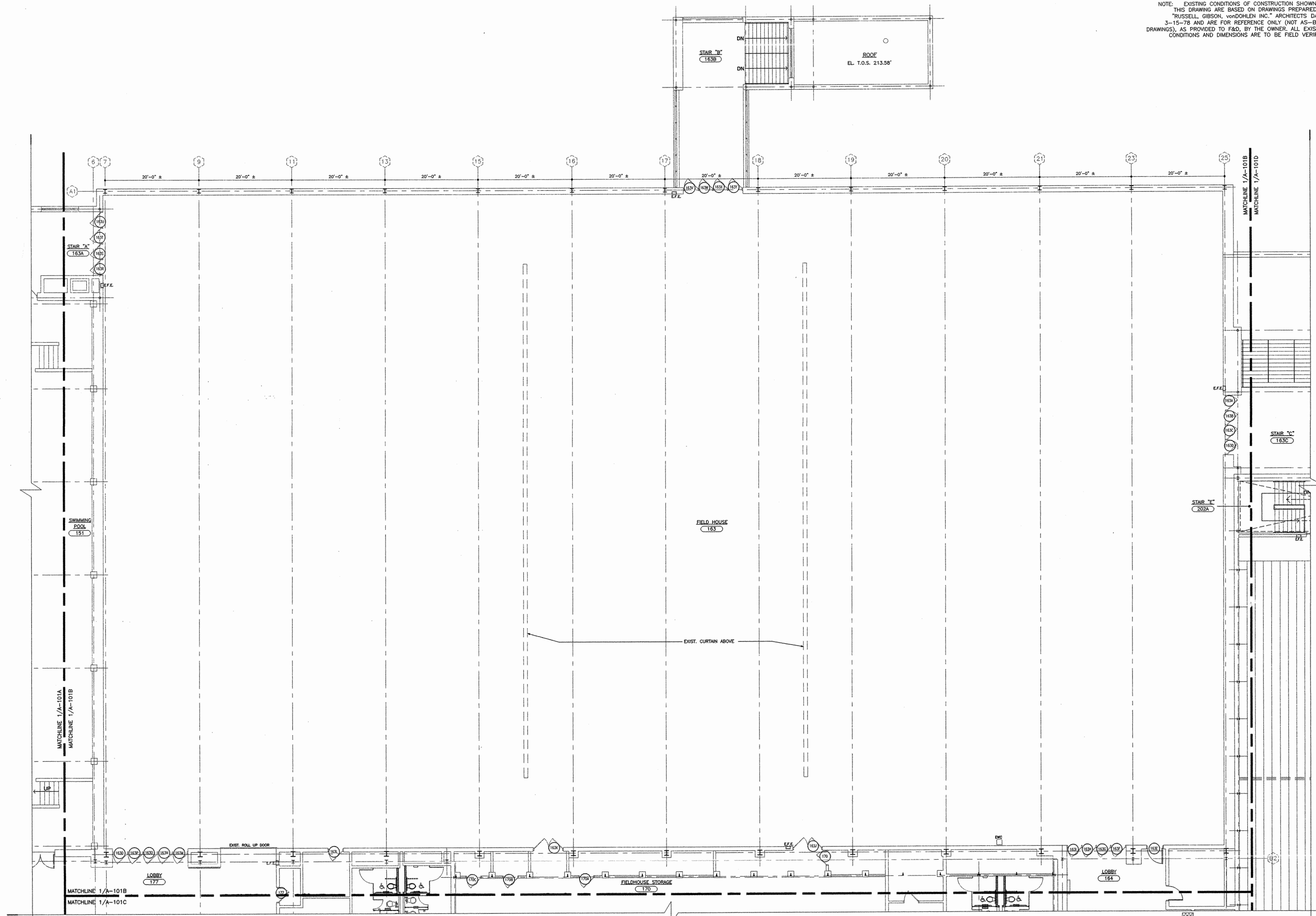

1 PART. PLAN - UNIT "B" - LEVEL 1
SCALE: 1/8" = 1'-0"
ELEV. 208.32' U.O.N.

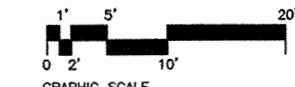

AS PER USA CONGRESS ARCHITECTURAL WORKS ACT OF 1991, ALL ARCHITECTS, ENGINEERS, AND DESIGNERS INCLUDING DERIVATIVES THEREOF, ALL DRAWINGS AND SPECIFICATIONS CONSTITUTE THE PROPERTY OF THE ARCHITECT AND ENGINEER AND D'ANGELO P.C. (F&D). THE DRAWINGS AND SPECIFICATIONS AS INSTRUMENTS OF SERVICE BY F&D TO THE ARCHITECT AND ENGINEER ARE THE PROPERTY OF F&D. ANY REPRODUCTION OR PRODUCT OF F&D, ANY REPRODUCTION WITHOUT THE PRIOR CONSENT OF F&D IS PROHIBITED.

FULLER AND D'ANGELO P.C. ARCHITECTS AND PLANNERS
1000 NEW YORK AVENUE
NEW YORK, NEW YORK 10023
TELEPHONE 914-592-4444
FAX 914-592-4444

ORIGINAL SIGNATURE & SEAL ARE BLUE

ORIGINAL SIGNATURE & SEAL ARE BLUE

PROJECT TITLE: **ALTERATIONS AND EXPANSION TO STAPLES HIGH SCHOOL**
70 NORTH AVENUE
WESTPORT, CONNECTICUT 06880

DRAWING TITLE: **PART. PLAN - UNIT "B" - LEVEL 1**

DATE: 09/02/03
SCALE: AS NOTED
DRAWN BY: F & D
CHECKED BY: F & D

DRAWING NO.: **A-101B**
FILE NO.: 00006.00

WESTPORT PUBLIC SCHOOLS

WALK-THRU SIGN IN

BID/RFP NO: 24-006-RFP SHS Field House Floor Replacement Design

DATE: Tuesday, November 14, 2023 @3:30PM, Staples High School

PLEASE SUBMIT BUSINESS CARD

| PLEASE PRINT LEGIBLY NAME | COMPANY/FIRM | E-MAIL | MOBILE/FAX# |
|------------------------------------|----------------------------|---------------------------------------|---------------|
| KIRBY FORRY | DYNAMIC SPORTS CONST. INC. | KFORRY@DYNAMICSPORTS.CONSTRUCTION.COM | 732-978-9641 |
| GORDON GRUNDEN | DAIGEN | GGRUNDEN@DAIGENFLOORING.COM | 866-883-5710 |
| Michael D. Nafle | HERCULAN/ACTION FLOORS | miked@actionfloors.com | 781-956-5522 |
| DAVID STEIN | SILVER PETRUCCI + ASSOC | dsteind@silverpetrucci.com | 203 230 9007 |
| ANA LEAL WILSON HUNTER CASSELLA | LONG WOOD LLC | LONGWOODUSA@GMAIL.COM | (405) 2594787 |
| JOHN KOPLAS | CONVERS | JOHN.KOPLAS@CONVERSING.COM | 860-250-3769 |
| Ted Tio | Hygienix. Div Pennoni | ttio@Pennoni.com | 203 324-2222 |
| | | | |
| | | | |



49 Woodside Street Stamford, CT 06902

March 6, 2019

Westport Public Schools
District Maintenance
One Canal Street
Westport, CT 06880

RE: Staples High School Field House
70 North Avenue
Westport, CT

Dear Sir or Madam:

Westport Public Schools hired HYGENIX, Inc. to perform hazardous materials sampling in the field house at the above referenced site. The purpose of the inspection was to determine if the existing floor covering in the field house would require removal and proper disposal/recycling prior to proposed floor replacement project.

Representatives from HYGENIX, Inc. collected two samples of the rubber flooring system in school's field house. Mercury rubber flooring systems were widely used in school gymnasiums from the 1970's until their use was stopped in 1985. These floors can release mercury vapors above the levels recommended by the Agency for Toxic Substances and Disease Registry (ATSDR). In addition, these rubber flooring systems must be treated as hazardous waste if they fail the RCRA Toxicity Characteristic Leaching Procedure (TCLP).

Samples of the flooring were collected and submitted to Phoenix Environmental Laboratories, Inc. in Manchester, CT. The samples were analyzed for total Mercury content and Mercury by TCLP method. The results of the sampling were as follows:

| SAMPLE | SAMPLE TYPE | SAMPLE RESULT | STANDARD |
|--------|---------------|---------------|---------------------------------|
| SHS01 | Total Mercury | 73.8 mg/kg | >20 mg/kg is extremely elevated |
| SHS02 | Total Mercury | 257 mg/kg | >20 mg/kg is extremely elevated |
| SHS03 | TCLP Mercury | 1.35 mg/L | 0.2 mg/L for Hazardous Waste |
| SHS04 | TCLP Mercury | 0.844 mg/L | 0.2 mg/L for Hazardous Waste |

Based on the sample results of the flooring, the material is considered Mercury containing and is classified as hazardous waste for disposal. This flooring must be removed and properly disposed of as part of this floor replacement project.

Thank you for using HYGENIX for your environmental concerns. Please contact me if you have any further questions or comments ttio@hygenix.com or 203-324-2222.

Sincerely,

Ted Tio
HYGENIX, Inc.

STAPLES HIGH SCHOOL FIELD HOUSE
70 NORTH AVENUE, WESTPORT, CT

MARCH 2019

MERCURY SAMPLE RESULTS

STAPLES HIGH SCHOOL FIELD HOUSE
70 NORTH AVENUE, WESTPORT, CT

MARCH 2019

STAPLES HIGH SCHOOL FIELD HOUSE
70 NORTH AVENUE, WESTPORT, CT

MARCH 2019



Thursday, February 28, 2019

Attn: Mr. Ted Tio
Hygenix
49 Woodside St.
Stamford, CT 06902

Project ID: WPS
SDG ID: GCC56736
Sample ID#s: CC56736 - CC56737

This laboratory is in compliance with the NELAC requirements of procedures used except where indicated.

This report contains results for the parameters tested, under the sampling conditions described on the Chain Of Custody, as received by the laboratory. This report is incomplete unless all pages indicated in the pagination at the bottom of the page are included.

All soils, solids and sludges are reported on a dry weight basis unless otherwise noted in the sample comments.

A scanned version of the COC form accompanies the analytical report and is an exact duplicate of the original.

If you have any questions concerning this testing, please do not hesitate to contact Phoenix Client Services at ext. 200.

Sincerely yours,

Phyllis Shiller
Laboratory Director

NELAC - #NY11301
CT Lab Registration #PH-0618
MA Lab Registration #M-CT007
ME Lab Registration #CT-007
NH Lab Registration #213693-A,B

NJ Lab Registration #CT-003
NY Lab Registration #11301
PA Lab Registration #68-03530
RI Lab Registration #63
UT Lab Registration #CT00007
VT Lab Registration #VT11301

STAPLES HIGH SCHOOL FIELD HOUSE
70 NORTH AVENUE, WESTPORT, CT

MARCH 2019



Environmental Laboratories, Inc.
587 East Middle Turnpike, P.O. Box 370, Manchester, CT 06045
Tel. (860) 645-1102 Fax (860) 645-0823

Sample Id Cross Reference

February 28, 2019

SDG I.D.: GCC56736

Project ID: WPS

| Client Id | Lab Id | Matrix |
|-----------|---------|--------|
| SHS01 | CC56736 | BULK |
| SHS02 | CC56737 | BULK |

MARCH 2019



Environmental Laboratories, Inc.
587 East Middle Turnpike, P.O. Box 370, Manchester, CT 06045
Tel. (860) 645-1102 Fax (860) 645-0823

Analysis Report
February 28, 2019

FOR: Attn: Mr. Ted Tio
Hygenix
49 Woodside St.
Stamford, CT 06902

Sample Information

Matrix: BULK
Location Code: HYGENIX
Rush Request: Standard
P.O.#:

Custody Information

Collected by: TT
Received by: LB
Analyzed by: see "By" below

Date Time
02/22/19
02/22/19 14:50

Laboratory Data

SDG ID: GCC56736
Phoenix ID: CC56736

Project ID: WPS
Client ID: SHS01

| Parameter | Result | RL/ PQL | Units | Dilution | Date/Time | By | Reference |
|----------------------------|-----------|------------|-------|----------|-----------|-------|-----------|
| Mercury | 73.8 | 2.6 | mg/Kg | 1 | 02/25/19 | RS | SW7471B |
| TCLP Mercury | 1.35 | 0.02 | mg/L | 1 | 02/25/19 | RS | SW7470A |
| Mercury Digestion | Completed | | | | 02/24/19 | EV/EV | SW7471B |
| TCLP Digestion Mercury | Completed | | | | 02/25/19 | VEV/I | SW7470A |
| TCLP Extraction for Metals | Completed | | | | 02/22/19 | I | SW1311 |

RL/PQL=Reporting/Practical Quantitation Level ND=Not Detected BRL=Below Reporting Level

Comments:

TCLP Non-Volatile Extraction:
Sample weight was < 100 grams (the minimum requirement of the method to insure homogeneity).

Results are reported on an "as received" basis, and are not corrected for dry weight.

All soils, solids and sludges are reported on a dry weight basis unless otherwise noted in the sample comments.

If there are any questions regarding this data, please call Phoenix Client Services.
This report must not be reproduced except in full as defined by the attached chain of custody.

Phyllis Shiller, Laboratory Director

February 28, 2019

Reviewed and Released by: Phyllis Shiller, Laboratory Director

MARCH 2019



Environmental Laboratories, Inc.
587 East Middle Turnpike, P.O. Box 370, Manchester, CT 06045
Tel. (860) 645-1102 Fax (860) 645-0823

Analysis Report
February 28, 2019

FOR: Attn: Mr. Ted Tio
Hygenix
49 Woodside St.
Stamford, CT 06902

Sample Information

Matrix: BULK
Location Code: HYGENIX
Rush Request: Standard
P.O.#:

Custody Information

Collected by: TT
Received by: LB
Analyzed by: see "By" below

Date Time
02/22/19
02/22/19 14:50

Laboratory Data

SDG ID: GCC56736
Phoenix ID: CC56737

Project ID: WPS
Client ID: SHS02

| Parameter | Result | RL/ PQL | Units | Dilution | Date/Time | By | Reference |
|----------------------------|-----------|------------|-------|----------|-----------|-------|-----------|
| Mercury | 257 | 12 | mg/Kg | 1 | 02/25/19 | RS | SW7471B |
| TCLP Mercury | 0.844 | 0.02 | mg/L | 1 | 02/25/19 | RS | SW7470A |
| Mercury Digestion | Completed | | | | 02/24/19 | EV/EV | SW7471B |
| TCLP Digestion Mercury | Completed | | | | 02/25/19 | VEV/I | SW7470A |
| TCLP Extraction for Metals | Completed | | | | 02/22/19 | I | SW1311 |

RL/PQL=Reporting/Practical Quantitation Level ND=Not Detected BRL=Below Reporting Level

Comments:

TCLP Non-Volatile Extraction:
Sample weight was < 100 grams (the minimum requirement of the method to insure homogeneity).

Results are reported on an "as received" basis, and are not corrected for dry weight.

All soils, solids and sludges are reported on a dry weight basis unless otherwise noted in the sample comments.

If there are any questions regarding this data, please call Phoenix Client Services
This report must not be reproduced except in full as defined by the attached chain of custody

Phyllis Shiller, Laboratory Director

February 28, 2019

Reviewed and Released by: Phyllis Shiller, Laboratory Director



Environmental Laboratories, Inc.
587 East Middle Turnpike, P.O. Box 370, Manchester, CT 06045
Tel. (860) 645-1102 Fax (860) 645-0823

QA/QC Report

February 28, 2019

QA/QC Data

SDG I.D.: GCC56736

| Parameter | Blank | Blk RL | Sample Result | Dup Result | Dup RPD | LCS % | LCSD % | LCS RPD | MS % | MSD % | MS RPD | % Rec Limits | % RPD Limits |
|---|-------|-----------|------------------|---------------|------------|----------|-----------|------------|---------|----------|-----------|--------------------|--------------------|
| QA/QC Batch 468071 (mg/kg), QC Sample No: CC56700 (CC56736, CC56737) | | | | | | | | | | | | | |
| Mercury - Soil | BRL | 0.03 | 3.70 | 5.52 | 39.5 | 99.8 | 112 | 11.5 | NC | | | 70 - 130 | 30 |
| Comment: | | | | | | | | | | | | | |
| Additional Mercury criteria: LCS acceptance range for waters is 80-120% and for soils is 70-130%. MS acceptance range is 75-125%. | | | | | | | | | | | | | |
| QA/QC Batch 468103 (mg/L), QC Sample No: CC57179 (CC56736, CC56737) | | | | | | | | | | | | | |
| Mercury - Water | BRL | 0.0002 | <0.0002 | <0.0002 | NC | 94.6 | | | 98.4 | | | 80 - 120 | 20 |
| Comment: | | | | | | | | | | | | | |
| Additional Mercury criteria: LCS acceptance range for waters is 80-120% and for soils is 70-130%. MS acceptance range is 75-125%. | | | | | | | | | | | | | |

r = This parameter is outside laboratory RPD specified recovery limits.

If there are any questions regarding this data, please call Phoenix Client Services at extension 200.

RPD - Relative Percent Difference

LCS - Laboratory Control Sample

LCSD - Laboratory Control Sample Duplicate

MS - Matrix Spike

MS Dup - Matrix Spike Duplicate

NC - No Criteria

Intf - Interference

Phyllis Shiller, Laboratory Director
February 28, 2019

Sample Criteria Exceedances Report
GCC56736 - HYGENIX

Thursday, February 28, 2019

Criteria: None

State: CT

| Sample No | Acode | Phoenix Analyte | Criteria | Result | RL | Criteria | RL | Analysis Units |
|-----------|--------|-----------------|--|--------|------|----------|-----|----------------|
| CC56736 | TCLPHG | TCLP Mercury | EPA / 40 CFR 261.24 / Toxicity Characteristics | 1.35 | 0.02 | 0.2 | 0.2 | mg/L |
| CC56737 | TCLPHG | TCLP Mercury | EPA / 40 CFR 261.24 / Toxicity Characteristics | 0.844 | 0.02 | 0.2 | 0.2 | mg/L |

Phoenix Laboratories does not assume responsibility for the data contained in this exceedance report. It is provided as an additional tool to identify requested criteria exceedances. All efforts are made to ensure the accuracy of the data (obtained from appropriate agencies). A lack of exceedance information does not necessarily suggest conformance to the criteria. It is ultimately the site professional's responsibility to determine appropriate compliance.



Environmental Laboratories, Inc.
587 East Middle Turnpike, P.O.Box 370, Manchester, CT 06045
Tel. (860) 645-1102 Fax (860) 645-0823



Analysis Comments

February 28, 2019

SDG I.D.: GCC56736

The following analysis comments are made regarding exceptions to criteria not already noted in the Analysis Report or QA/QC Report: None.

Page 8 of 8

LOCATIONS

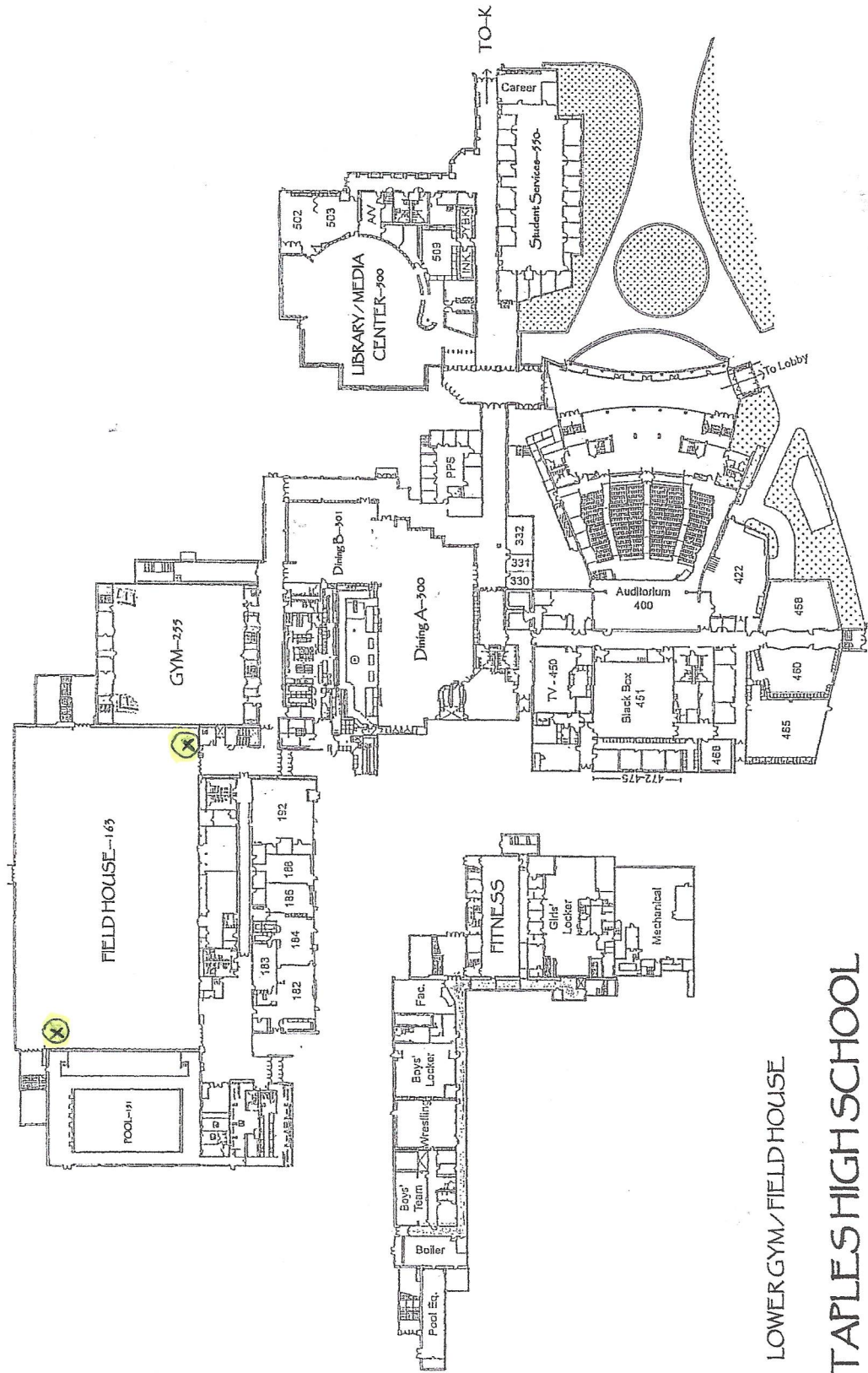

LOWER GYM/FIELD HOUSE

STAPLES HIGH SCHOOL





KIRBY FORAY

102 MEADOW POINT ROAD REGIONAL VICE PRESIDENT
POINT PLEASANT, NJ 08742
CELL: 732-948-9641
PH: 732-701-9100
FAX: 732-701-9101
CORPORATE: 800-517-0015

EMAIL: [KFORAY@DYNAMICSPORTSCONSTRUCTION.COM](mailto:kforay@dynamicssportsconstruction.com)

WEB: WWW.DYNAMICSPORTSCONSTRUCTION.COM