



Crabtree, Rohrbaugh & Associates

**PEQUEA VALLEY  
SCHOOL DISTRICT  
COMMITTEE MEETING**  
JANUARY 5<sup>th</sup>, 2021

- **DESIGN TEAM**

- ARCHITECT: CRABTREE, ROHRBAUGH & ASSOCIATES
- MEP: MOORE ENGINEERING COMPANY
- STRUCTURAL: BAKER, INGRAM & ASSOCIATES
- CIVIL: DERCK & EDSON
- PUBLIC SEWER / WATER: ARRO GROUP
- FOOD SERVICE: NYIKOS-GARCIA FOODSERVICE DESIGN

- **SURVEY UPDATE:**

- FLY-OVER COMPLETED
- SITE SURVEY COMPLETED
- DRAWING PREPARATION IN PROCESS
- SURVEY DATA AND DRAWINGS AVAILABLE FOR REVIEW EARLY NEXT WEEK.

Summer 2024 Open Design Timeline

IS/HS New Construction | Existing IS & HS Renovations

TASK

Board Committee Meeting  
School Board Meeting

Civil / Land Development

Survey Site  
Site Analysis  
Schematic Site Design  
Developed Site Design  
Construction Document

Schematic Design

Program Verification  
Student / Staff / Leadership Design Collab.  
Preliminary Floor Plans / Elevations  
Preliminary MEP Design  
Probable cost of construction  
Community Meeting  
Board Presentations

Design Development:

Structural Design  
Develop MEP Design  
Develop Kitchen Design  
Develop Interior Design - Teacher / Staff  
Probable Cost of Construction  
Community Meeting  
Board Presentation  
Finalize Code Review  
Act 34 Hearing

Construction Documents

Finalize Civil / Landscape Design  
Finalize Interior Design  
Finalize Structural Design  
Finalize Mechanical Selections  
Finalize Major Electrical Elements  
Finalize Major Plumbing Elements  
Finalize Major Fire Protection Elements  
Finalize Interior Elevations  
Board Presentation  
Finalize Specifications

Bidding / Construction

Bidding / Post Bidding  
Construction - New IS / HS  
Construction - Existing IS / HS

TASK	2020			2021												2022			
	OCT	NOV	DEC	JAN	FEB	MAR	APR	MAY	JUN	JUL	AUG	SEPT	OCT	NOV	DEC	JAN	FEB	MAR	APR
Board Committee Meeting		3-Nov	1-Dec	4-Jan	2-Feb	2-Mar	30-Mar	4-May	1-Jun	N/A	N/A								
School Board Meeting		12-Nov	10-Dec	14-Jan	11-Feb	11-Mar	8-Apr	13-May	10-Jun	N/A	N/A								
<b>Civil / Land Development</b>																			
Survey Site																			
Site Analysis																			
Schematic Site Design																			
Developed Site Design																			
Construction Document																			
<b>Schematic Design</b>		SD's			19-Feb														
Program Verification				13-Jan															
Student / Staff / Leadership Design Collab.																			
Preliminary Floor Plans / Elevations																			
Preliminary MEP Design																			
Probable cost of construction																			
Community Meeting				5-Jan	1-Feb														
Board Presentations																			
<b>Design Development:</b>						DD's			29-Jun										
Structural Design																			
Develop MEP Design																			
Develop Kitchen Design																			
Develop Interior Design - Teacher / Staff																			
Probable Cost of Construction																			
Community Meeting																			
Board Presentation						2-Mar	6-Apr	4-May	1-Jun										
Finalize Code Review																			
Act 34 Hearing																			
<b>Construction Documents</b>										CD's				19-Nov					
Finalize Civil / Landscape Design																			
Finalize Interior Design																			
Finalize Structural Design																			
Finalize Mechanical Selections																			
Finalize Major Electrical Elements																			
Finalize Major Plumbing Elements																			
Finalize Major Fire Protection Elements																			
Finalize Interior Elevations																			
Board Presentation										6-Jul	3-Aug	7-Sep	5-Oct	2-Nov					
Finalize Specifications																			
<b>Bidding / Construction</b>																			
Bidding / Post Bidding																			
Construction - New IS / HS																			
Construction - Existing IS / HS																			

NEW IS / HS  
COMPLETION  
SUMMER 2024

MILESTONES

- PROGRAMMING
  - JANUARY 2021
- SCHEMATIC DESIGN
  - FEBRUARY 2021
- DESIGN DEVELOPMENT
  - JUNE / JULY 2021
- CONSTRUCTION DOC'S
  - NOVEMBER 2021
- BIDDING
  - JANUARY 2022
- PHASE 1 CONSTRUCTION
  - SUMMER 2024
- PHASE 2 CONSTRUCTION
  - SUMMER 2025

# **MEEITNG UPDATES**

- **SINCE LAST BOARD COMMITTEE MEETING:**

- **12/1/2020 STEERING COMMITTEE PROGRAMING**
- **12/9/2020 BUILDING SCHEDULE ANALYSIS**
- **12/16/2020 STEERING COMMITTEE PROGRAMING**

- **UPCOMING MEETINGS:**

- **1/6/2020 STEERING COMMITTEE SITE / CIVIL**
- **1/13/2020 FOCUS GROUP PROGRAMMING**
  - **ADMINISTRATIVE SUITE**
  - **ATHLETICS (BUILDING & SITE)**
  - **AGRICULTURAL**
  - **SHOP / CORE**
  - **PERFORMING ARTS / THEATER / MUSIC**
  - **DISTRICT OFFICE**
  - **3<sup>RD</sup> PARTY DAYCARE**
- **1/20/2020 STEERING COMMITTEE SITE / CIVIL / SCHEMATIC**

# BUILDING PROGRAM UPDATES

- CLASSROOM WING:

- FOCUS ON VERIFYING QUANTITY AND TYPES OF SPACES
- PROGRAMMING FOCUSES ON ADJACENCIES
- REVIEW THE STUDY FLOOR PLAN
- **BUILDING SCHEDULE ANALYSIS**
- GRADE GROUPINGS
- SPECIAL EDUCATION COMPONENT CENTRALIZED
- **FACULTY PLANNING CENTERS & CLASSROOMS**
- **SMALL GROUP INSTRUCTION / SOCIAL WORKER USE**

- BUILDING CORE:

- CAFETERIA – 2 SERVING PERIODS
- PRAISE CLUB
- ANNEX / STUDENT UNION
- MEDIA CENTER / TESTING

EVALUATE BOUNDARIES,  
OVERLAPPING USES,  
MAXIMIZING  
OPPORTUNITIES AND  
UTILIZATION

# AGENDA FOR JANUARY 2<sup>ND</sup> MEETING

- PROGRAM OVERVIEW
  - BUILDING PROGRAM
  - BUILDING PROGRAM DIAGRAM
  - SITE PROGRAM
- SITE / CIVIL UPDATE:
  - SURVEY RESULTS
  - SITE ANALYSIS
  - BUILDING SITING



Pequea Valley School District

*Where Each Learner Counts*



Crabtree, Rohrbaugh & Associates

[www.cra-architects.com](http://www.cra-architects.com)

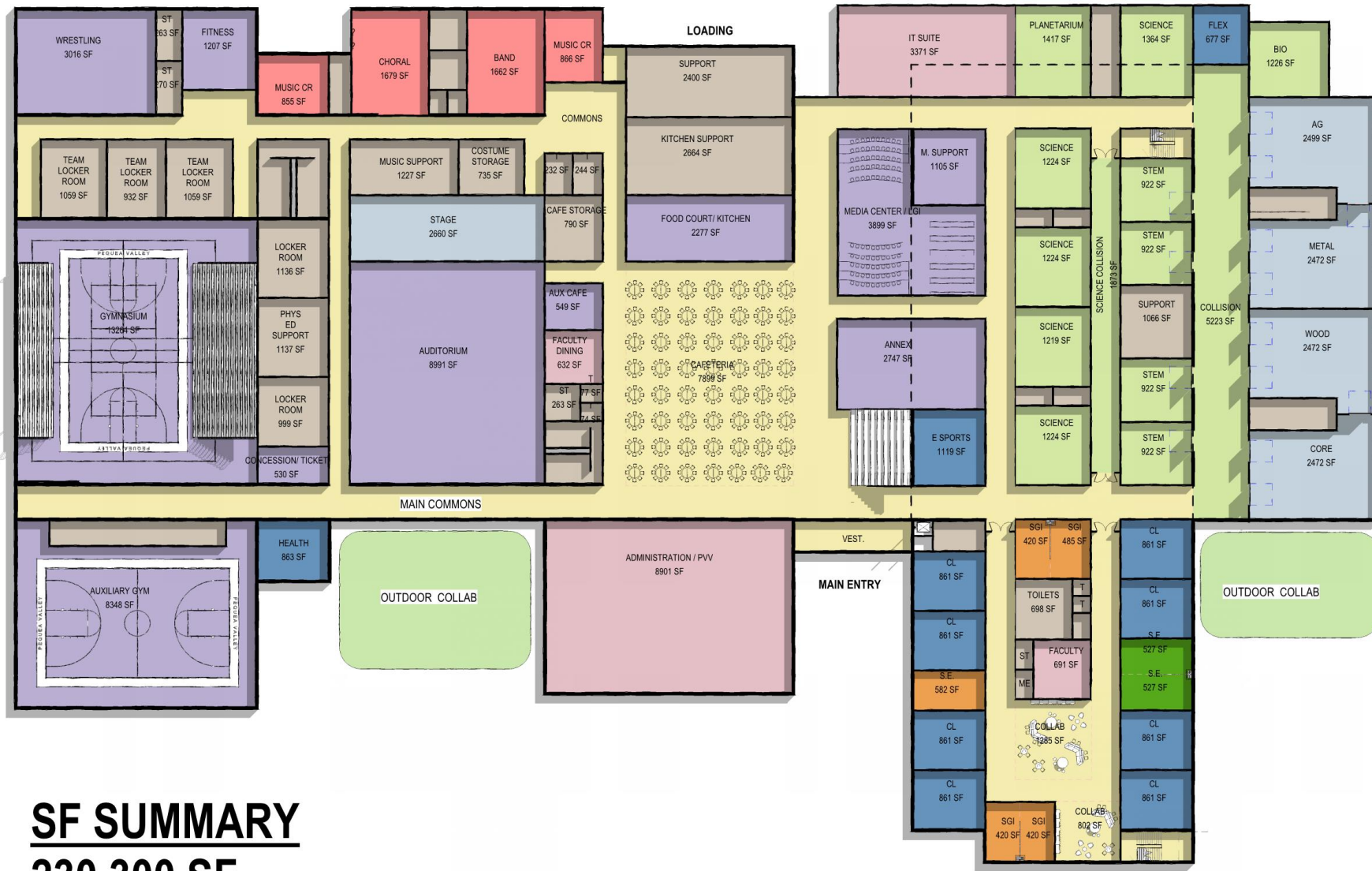

**SF SUMMARY**  
**230,300 SF**

**7TH & 8TH**

**11TH & 12TH**



**9TH & 10TH**