



Crabtree, Rohrbaugh & Associates

**PEQUEA VALLEY
SCHOOL DISTRICT
BOARD MEETING**

February 1st, 2022

- **MEETING UPDATES**
- **SCHEDULE UPDATES**
- **INTERIOR ARCHITECTURE**

AGENDA

MEETING UPDATES

- SINCE LAST BOARD COMMITTEE MEETING:
 - 1/26/2022 – STEERING COMMITTEE – INTERIOR ARCHITECTURE REVIEW
 - INTERMEDIATE SCHOOL REPLACEMENT PROGRAM MEETING
- UPCOMING MEETINGS:
 - 2/9/2022 – SAFETY & SECURITY / CPTED REVIEW
 - 2/10/2022 – INTERMEDIATE SCHOOL REPLACEMENT REVIEW
 - FEBRUARY 2022 – ROUND 3 EDUCATOR MEETINGS
- ACT 34:
 - FEBRUARY 2022 – Booklet to Board and PDE
 - MARCH 2022 – Public Hearing
 - MAY 2022 – Board Vote & PDE Submission



February 2022 (revised)

Land Development SCHEDULE

Zoning and Sketch Plan Review

Sketch Plan meeting with Township Planning Comm.	June 22, 2021	completed
Zoning Variance (building height) Application to Twp	July 30, 2021	completed
Zoning Hearing Board Meeting	September 21, 2021	completed

Land Development

Submit Plans to PPL R.O.W. Department	completed
Submit Land Development Plans– County/Twp.	September 21, 2021 completed
County Conservation District NPDES Submission	November 5, 2021 completed

Planning Commission Meeting February 22, 2022

Land Development Conditional Approval April 5, 2022

****Conservation District Approval June 2022**

Plan Recordation August / September 2022

Out to Bid **TBD** (confirm with CRA)

Start Project Construction **TBD**

**** NPDES reviews are delayed at Lancaster County Conservation District**

**NEW IS / HS
COMPLETION
SUMMER 2024**

MILESTONES

- **PROGRAMMING**
 - JANUARY 2021
- **SCHEMATIC DESIGN**
 - FEBRUARY 2021
- **DESIGN DEVELOPMENT**
 - OCTOBER 2021
- **CONSTRUCTION DOC'S**
 - APRIL 2022
- **BIDDING**
 - UTILITIES JAN. 2022
 - MS/HS JUNE 2022
- **PHASE 1 – NEW HS/MS**
 - JULY 2022
 - SUMMER 2024
- **PHASE 2 – RENO HS**
 - SUMMER 2025
- **PHASE 3 – RENO IS**
 - SUMMER 2026

PROPOSED SITE PLAN & RENDERED VIEWS



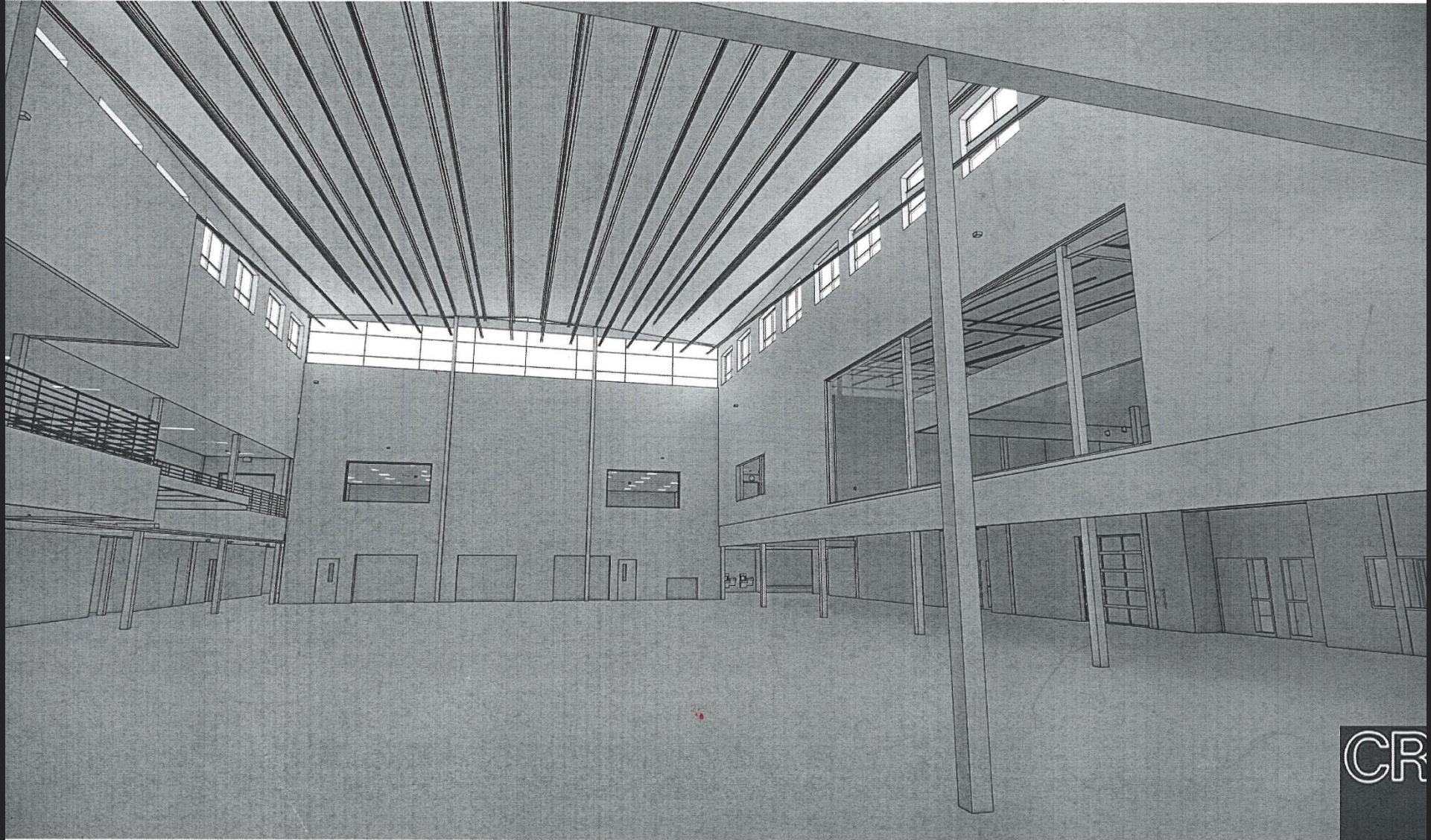

CR

INTERIOR ARCHITECTURE – CONCEPT SKETCH

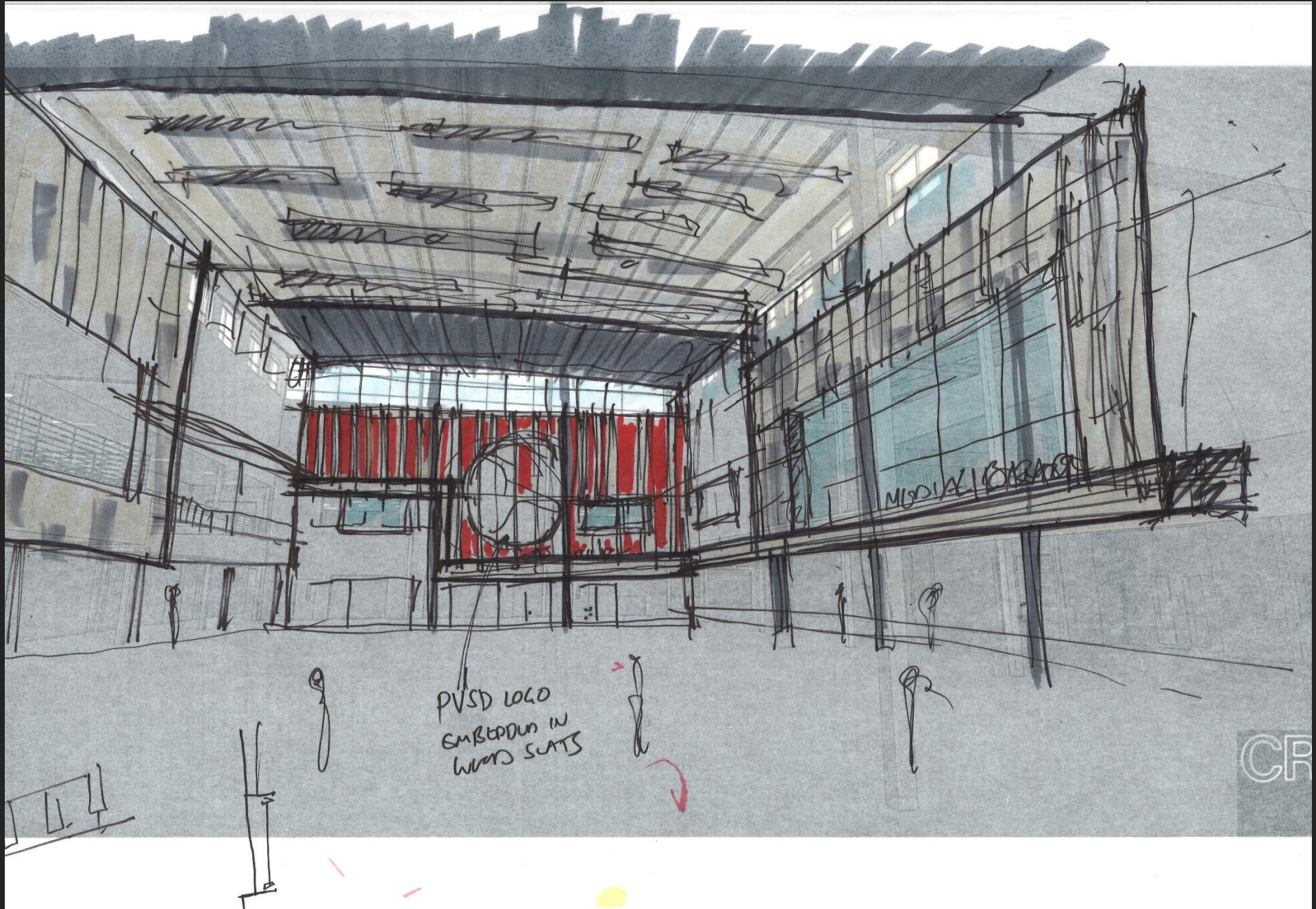

INTERIOR ARCHITECTURE – STUDENT COMMONS



INTERIOR ARCHITECTURE – STUDENT COMMONS



INTERIOR ARCHITECTURE – SOCIAL STAIR





INTERIOR ARCHITECTURE – AUDITORIUM / GYM



INTERIOR ARCHITECTURE – LARGE H.S. CLA











INTERIOR ARCHITECTURE – MEDIA CENTER ENTRY



INTERIOR ARCHITECTURE – MEDIA CENTER



INTERIOR ARCHITECTURE – MEDIA CENTER





Pequea Valley School District

Where Each Learner Counts



Crabtree, Rohrbaugh & Associates

www.cra-architects.com