



THE
GIFT
OF PLAY

A Campaign for NPS





**At National Presbyterian School,
we focus on the foundational decade of childhood
to launch lives of purpose and compassion.**

We are delighted to announce an exciting, transformational initiative to strengthen teaching and learning at NPS and bring joy, discovery and adventure to students for decades to come: a new playground! A direct reflection of the NPS Mission and the school's focus on the Decade of Childhood, this innovative, intentional design strategically and creatively increases our play footprint and will be a playground for every grade and every child at NPS.







Jean Piaget, a pioneer in the field of child development, said,

“Play is the work of childhood.”

At NPS, with our keen focus on the decade of childhood, we value play and appreciate its lasting and life-long benefits.



The construction of a new and inspiring playground will enable generations of NPS students to joyfully engage in the “work of childhood” in meaningful and impactful ways—allowing them to maximize their decade of childhood as they continue on their journey of creating lives of purpose and compassion.

MALCOLM LESTER, HEAD OF SCHOOL



The Gift of Play: A Campaign for NPS

will raise **4.5 million dollars** over **3 years** to:

Build a completely redesigned outdoor space
for our students and families to enjoy for decades



Fund our Annual Giving program, which
provides essential funds to support the
operational needs of our school





As an NPS teacher and the parent of two
NPS alumnae, I cannot overemphasize
the importance of play.

Young minds can't learn if they don't have a chance to run around and get fresh air.



This new playground will provide
a wonderful new space for our
students to explore and challenge
themselves through new and
different play choices.



ROBIN WESTERBERG, 3RD GRADE TEACHER,
FACULTY REPRESENTATIVE TO THE BOARD OF TRUSTEES



New Outdoor Space

The NPS playground has served the school community for over 25 years. Over that time, the school's enrollment has grown, as have the needs of our students.

Inspired by nature (and our Cardinal mascot), the innovative design provides a blend of numerous dynamic play equipment, along with ample open areas, for both active and imaginary play. Whether our Cardinals want to take a stroll on the playground's elevated walkway, gather with friends in the Nest, reach for the sky on the swings or play basketball with friends, the new playground will have it all.



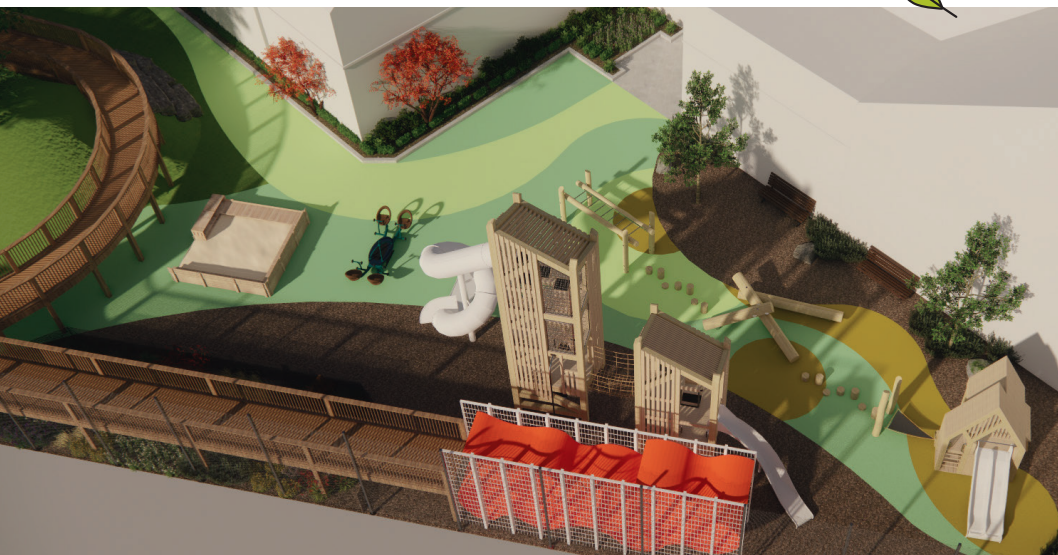

The centerpiece of the playground—the Nest—is inspired by the school's mascot, Spirit the Cardinal.

The playground features structures that replicate treehouses and treetops—including climbing towers that reach 30 feet at their peak.

The intentional and thoughtful architectural design incorporates extensive input from NPS teachers all grade levels.







Annual Giving

An important component of the campaign is the NPS Annual Giving program. It is important that we continue to meet our operating expenses even as we make exciting improvements to our campus. During the duration of the campaign, we will continue to prioritize Annual Giving, which provides critical funds to support the immediate needs of our school, including competitive salaries and benefits for our talented faculty, security measures to safeguard the NPS community, technology upgrades in all of our classrooms, and professional development.

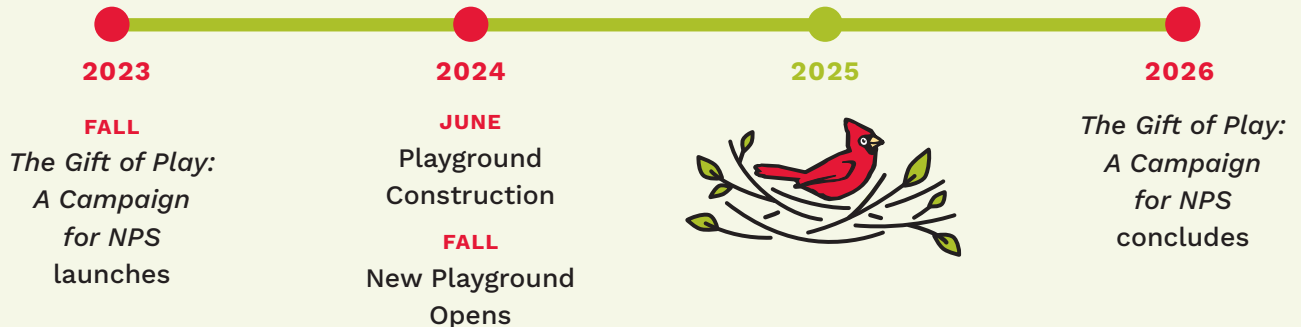
Campaign Timeline





“As many of us can attest from our own childhoods, recess is often a favorite part of the day for students. Recess offers the opportunity to run around with friends or simply recharge. No matter how children spend their time outside, this purposefully designed space will meet all their needs and provide the important foundation that play affords. We are proud to help NPS build a fantastic new playground and hope you will join us!”

AUSTIN & MAISIE BRANSON
CO-CHAIRS OF THE GIFT OF PLAY CAMPAIGN

PARENTS OF DOROTHY '25, TAYLOR '27
AND MILLIE (CARDINAL IN TRAINING)



NPS

For more information,
please contact Development Director
Mary Marra at mmarra@nps-dc.org