

# Phalen Lake Hmong Studies Magnet

## 1089 Cypress Street

### Project Summary:

Phalen Lake offers all students the opportunity to develop skills to actively contribute to today’s multicultural society. Our students explore the culture, language, history, folklore, art, literature and traditions of many cultures with a special focus on the Hmong people. Phalen Lake students and staff incorporate personalized learning through technology into daily lessons, projects and curriculum. Phalen Lake believes students must use, learn and interact with technology to positively contribute to our growing digital world and become global citizens.

It was originally constructed in 1930 at 21,187 square feet. Later additions were completed in 1973 and 2004. It is now 77,899 square feet.

### Issues Identified By School Community In 2015

- 1. Clarify Entry with Signage
- 2. Expand Parking
- 3. Improve Visibility from Office
- 4. Create Expanded Cafeteria Space with Access to Playground
- 5. Create Appropriate PK-K Classrooms with Restrooms and Day Lighting
- 6. Improve Acoustics and Interior Environment of Classrooms with Day Lighting
- 7. Create Additional Muli Purpose Space
- 8. Plan in Collaborative and Small Group Learning Opportunities
- 9. Increase Staff Resource Space
- 10. Expand Media Center

### General Notes:

Existing utilization shown is for School Year 2014-2015

The Conceptual Utilization Plans are exploratory rather than actual construction plans and represent the design at one moment in time, which will change as the design and funding process progress.

The Conceptual Plans are included as a way to organize scopes of work into logical, efficient and meaningful projects. There is no prioritization implied in a work scope title (e.g. “Work Scope A” is not necessarily the most critical work to be done).

The plans in this document are not comprehensive of the entire building’s needs as maintenance and replacement of existing building systems such as roofs and mechanical systems are omitted to maintain graphic clarity of the overall vision generated during the Facilities Master Plan Process.

Formal zoning reviews have not been undertaken for the proposed work shown in these plans. A review with zoning and building code authorities will occur once the funding is secured.



Grade Levels:	PreK-5
SY 2014/15 Enrollment:	685
Design Enrollment:	726

# Phalen Lake Hmong Studies Magnet

## Site Concept



**Legend:**

S1.	Welcoming Main Entry	
S2.	Additional Parking	9,050 SF
S3.	Service/Kitchen Delivery	5,125 SF
S4.	Secure Site with Fencing	
S5.	Landscape Buffer	3,525 SF
S6.	Outdoor Learning	2,325 SF
C1.	Classroom Expansion	

- Property Line
  - Main Entry
  - Secondary Entry
  - Service Entry
- 
- New Landscape and Playground
  - Parking and Hardscape
  - New Building Construction

# Phalen Lake Hmong Studies Magnet

## Existing Utilization

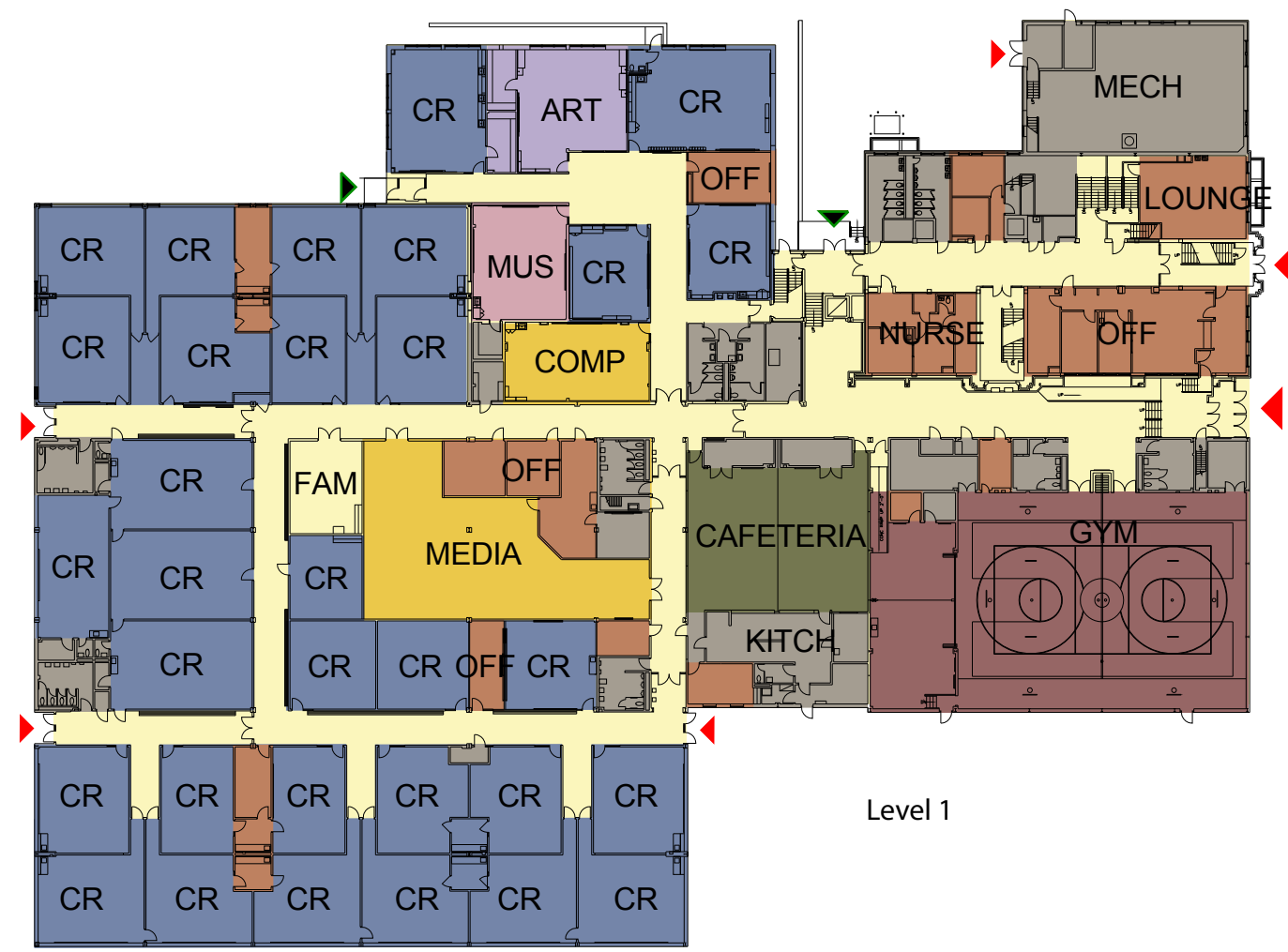

Level 1

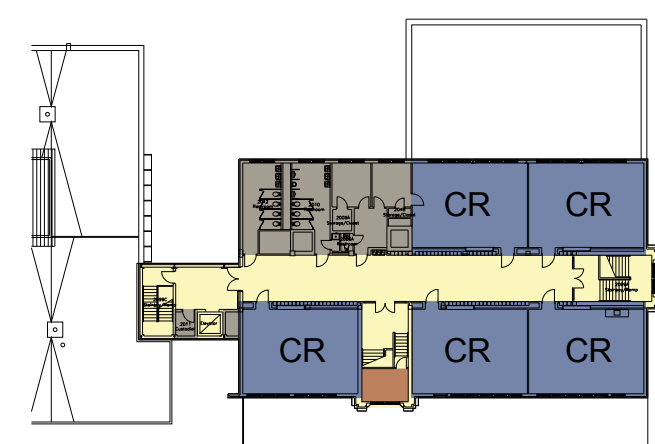

Level 2

- ▲ Main Entry
- ▲ Secondary Entry
- ▲ Service Entry

- General Learning
- Science
- Performing Arts
- Career & Tech Education
- Media Center
- Dining
- Athletics
- Circulation
- Facilities Support
- Administration
- Art

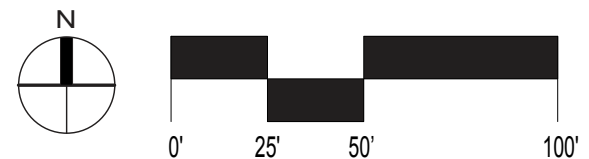

# Phalen Lake Hmong Studies Magnet

## Conceptual Utilization Plan Flr 1



### Legend:

- C1. Welcoming and Secure Entry with Visual Control from Administration
- C2. Improved Bathroom Facilities
- C3. New Cafeteria/Multi-Use Space with Daylighting
- C4. New Vertical Circulation
- C5. Appropriate Learning Space for Early Education with Restrooms
- C6. Safe Path from Building to Playground
- C7. Flexible Space with Movable Walls
- C8. Expand Gym for Large Group Space
- C9. Expanded Media
- C10. New Restrooms
- C11. Personalized/Adaptive Collaborative Learning Areas with Shared Daylight
- C12. Staff Resource/PLC
- C13. Repurpose Staff Resources and Administrative Space

- Demolition/Removal
- New/Existing
- Property Line
- Main Entry
- Secondary Entry
- Service Entry

- General Learning
- Science
- Performing Arts
- Career & Tech Education
- Media Center
- Dining
- Athletics
- Circulation
- Facilities Support
- Administration
- Art

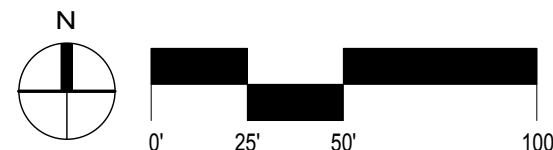



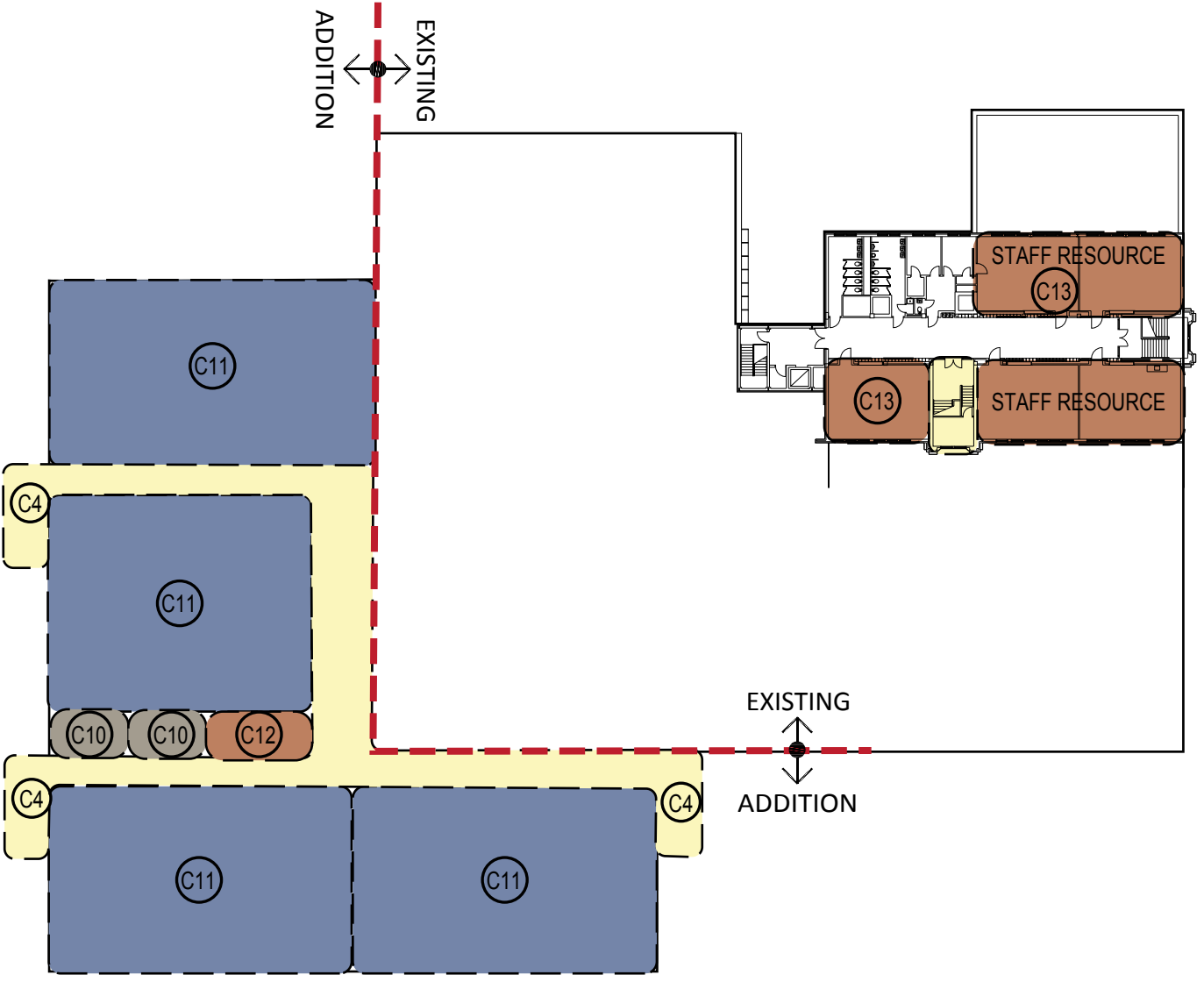

# Phalen Lake Hmong Studies Magnet

## Conceptual Utilization Plan Flr 2





- Legend:**
- C1. Welcoming and Secure Entry with Visual Control from Administration
  - C2. Improved Bathroom Facilities
  - C3. New Cafeteria/Multi-Use Space with Daylighting
  - C4. New Vertical Circulation
  - C5. Appropriate Learning Space for Early Education with Restrooms
  - C6. Safe Path from Building to Playground
  - C7. Flexible Space with Movable Walls
  - C8. Expand Gym for Large Group Space
  - C9. Expanded Media
  - C10. New Restrooms
  - C11. Personalized/Adaptive Collaborative Learning Areas with Shared Daylight
  - C12. Staff Resource/PLC
  - C13. Repurpose Staff Resources and Administrative Space

 Demolition/Removal

 New/Existing

 Property Line

 Main Entry

 Secondary Entry

 Service Entry

 General Learning

 Science

 Performing Arts

 Career & Tech Education

 Media Center

 Dining

 Athletics

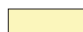
 Circulation

 Facilities Support

 Administration

 Art

# Phalen Lake Hmong Studies Magnet

## Conceptual Construction Plan

### Flr 1



Scope Package	New Construction	Heavy Remodel	Medium Remodel	Light Remodel	Finishes Only
A	1,300 SF	22,725 SF			
B			9,450 SF	4,225 SF	
C				2,625 SF	
D					6,025 SF
E					
TOTAL	1,300 SF	22,725 SF	9,450 SF	6,850 SF	6,025 SF

Line Items	New Construction	Heavy Remodel	Medium Remodel	Light Remodel	Finishes Only

- Demolition/Removal
- New/Existing
- New Construction
- Heavy Remodel
- Medium Remodel
- Light Remodel
- Finishes Only
- No Work

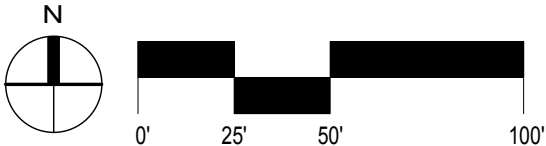

# Phalen Lake Hmong Studies Magnet

## Conceptual Construction Plan

### Flr 2

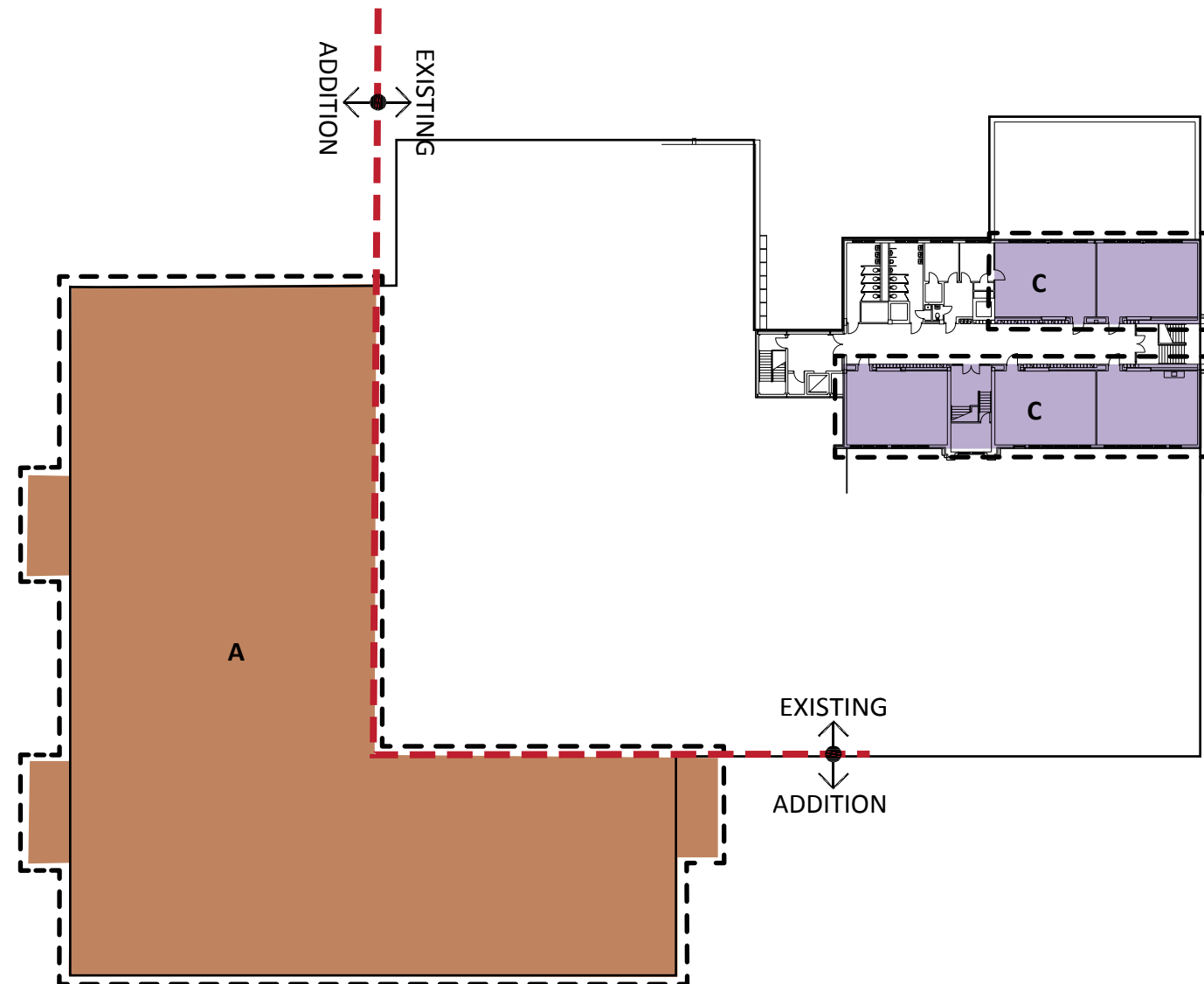

Scope Package	New Construction	Heavy Remodel	Medium Remodel	Light Remodel	Finishes Only
A	25,700 SF				4,225 SF
B					
C					
D					
E					
TOTAL	25,700 SF				4,225 SF

Line Items	New Construction	Heavy Remodel	Medium Remodel	Light Remodel	Finishes Only

