

IEA, INC.

2023 - 2024 Ventilation Assessment



Contact Us:

BROOKLYN PARK OFFICE

9201 W. BROADWAY, #600
BROOKLYN PARK, MN 55445
763-315-7900

MANKATO OFFICE

610 N. RIVERFRONT DRIVE
MANKATO, MN 56001
507-345-8818

ROCHESTER OFFICE

210 WOOD LAKE DRIVE SE
ROCHESTER, MN 55904
507-281-6664

BRAINERD OFFICE

601 NW 5TH STREET SUITE #4
BRAINERD, MN 56401
218-454-0703

MARSHALL OFFICE

1420 EAST COLLEGE DRIVE
MARSHALL, MN 56258
507-476-3599

VIRGINIA OFFICE

5525 EMERALD AVENUE
MOUNTAIN IRON, MN 55768
218-410-9521

www.ieasafety.com

info@ieasafety.com

800-233-9513

Saint Paul Public Schools Ramsey Middle School

Assessment Date:
Thursday, April 6, 2023

Project Description

IEA conducted a ventilation inspection in Ramsey Middle School by IEA representative, Jack Skluzacek, with the intent of gathering visual observations and overall ventilation information which will assist the District in making informed and proactive decisions to improve and maintain acceptable air quality in the building. This inspection is based upon the Environmental Protection Agency's (EPA's) Tools for Schools IAQ guidelines and the recommended Minnesota Department of Education (MDE) portion of a school district's IAQ management plan. Ventilation verification is also recommended by American Society of Heating, Refrigerating and Air-Conditioning Engineers (ASHRAE).

Some observations gathered during the inspection may identify issues which may require additional testing, evaluation, further investigation, or maintenance on the ventilation systems.

The findings, conclusions and recommendations presented herein are believed to be accurate and representative of the building on the date and time of the inspection.

GENERAL COMMENTS

The analysis and opinions expressed in this report are based upon data obtained from Saint Paul Public Schools at the indicated locations. This report does not reflect variations in conditions that may occur across the site, property, or facility. Actual conditions may vary and may not become evident without further assessment.

The report is prepared for the exclusive use of our client for specific application to the project discussed and has been prepared in accordance with generally accepted indoor air quality practices. Other than as provided in the preceding sentence, no warranties are extended or made.

Building Information

General information regarding the building was collected by IEA during an interview with building maintenance staff. The information gathered during this process is a vital component, as it is helpful in determining how these items may play a role in possible IAQ related issues.

Below is a summary of the information gathered during the interview:

- Automation controls are managed internally.
- A Building Automation System is present. The automation control software program is Tridium and controls can not be accessed remotely.
- Schedules:

Ventilation operation:

Day:	Occupied?	Start Time:	End Time:
Monday-Friday	Yes	6:00 AM	10:00 PM
Saturday	No	7:00 AM	8:00 PM
Sunday	No	8:00 AM	4:00 PM
Holiday	No		
Notes: Holiday has no special schedule so it normally adheres to whatever day the holiday falls on			

Typical occupancy:

Day:	Occupied?	Start Time:	End Time:
Monday-Friday	Yes	7:00 AM	9:00 PM
Saturday	Yes	8:00 AM	12:00 PM
Sunday	No		
Holiday	No		

- CO2 sensors are not associated with the ventilation system.
- VAVs are not present.
- Building does not have variable frequency drives (VFD).
- The heating system is a steam boiler.
- A cooling system is not present.
- Filters used are:

Filter Type	MERV Rating
Pleated	MERV 11
- Filters are changed quarterly.
- Energy Recovery Units are not present.
- Units do not contain system Enhancements.
- Personal air purifiers are supplied for individual rooms. They are Filtrete/Air Purifier Model Series (FAP-T02 OR FAP-T03).
 - Location: Custodial office, 2nd floor classroom, and nurse's office
- It is not known whether or not the building was commissioned during the original construction.

Air Handling Unit Designations & Service Zones: 2nd Floor

Ramsey Jr. High
Second Floor Plan

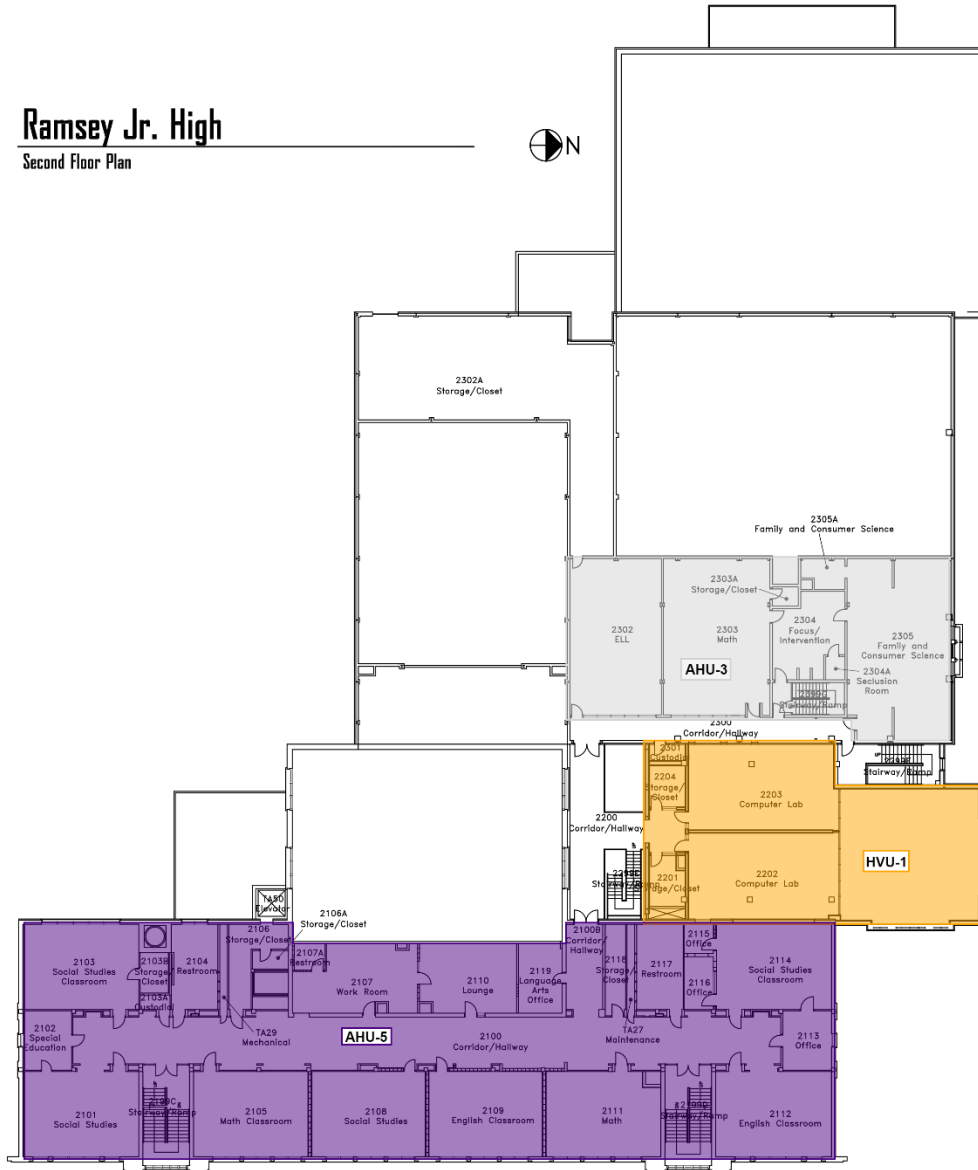

Air Handling Unit Designations & Service Zones: 3rd Floor

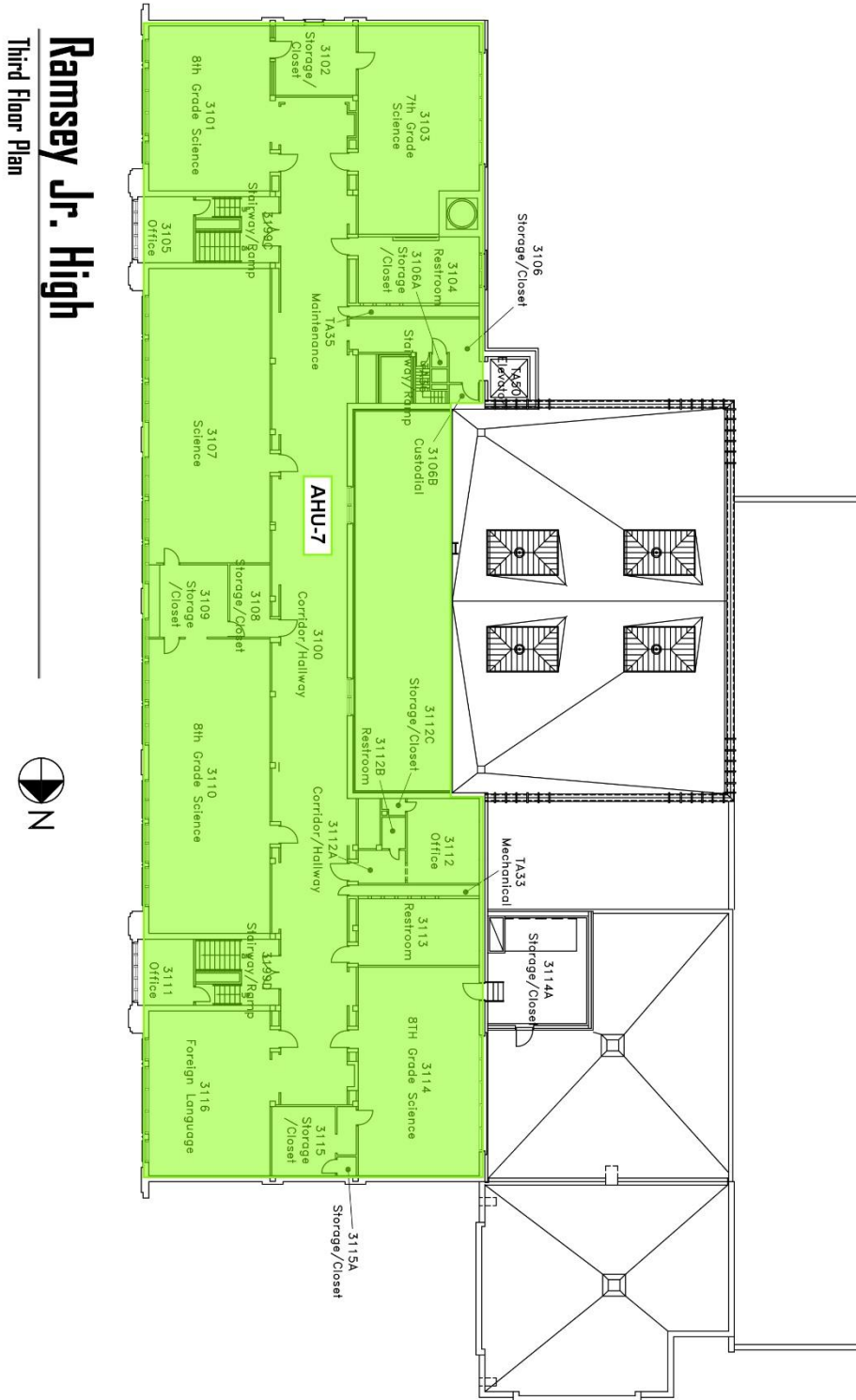

Assessment

Ventilation System

The following information was gathered by IEA on Thursday, April 6, 2023 with support from the district building representative during the on-site interview. The type of heating, ventilating and air-conditioning (HVAC) system and its assessment is included for each unit below:

Unit Designation:	AHU 01	
Location of Unit:	Mechanical room 2302A	
Areas Served:	1302 cafe See attached map	
System Enhancements:	None	
Supply System	Outdoor Air	Cleanliness and Observations
Type <ul style="list-style-type: none"> Supply System - Constant Volume Heating - Hot Water Cooling - None Energy Recovery Unit (ERU) - None 	Outdoor air intake is accessible Outdoor air intake is located in an unknown location. No nearby pollution sources were found. Outdoor air intake is in good condition.	Outdoor air filters are not present. Return air filters are not present. Mixed air pre-filters are not present. Mixed air main filters are clean and not in need of replacement (scoring 1 out of 5) and fit well. Mixed air main filters are installed correctly. Drain pans are not applicable or not present. Drain pan condition is not known. Heating coils are clean. Heat wheels are not present. Exterior ducting is visible. Exterior ducting insulation is in good condition. Interior ducting is visible. Interior ducting insulation is in good condition. Interior ducting is clean. Air handling room is free of trash/chemicals. Outside damper is open, and its condition is good. Return damper is open, and its condition is good. The general condition of the unit is good.
Filter Type - Mixed <ul style="list-style-type: none"> Pre-filter: None Main filter: Pleated, MERV 11 		

Unit Designation:	AHU 02	
Location of Unit:	Mechanical room 2302A	
Areas Served:	1205/1212 See attached map	
System Enhancements:	None	
Supply System	Outdoor Air	Cleanliness and Observations
Type <ul style="list-style-type: none"> • Supply System - Constant Volume • Heating - Hot Water • Cooling - None • Energy Recovery Unit (ERU) - None Filter Type - Mixed <ul style="list-style-type: none"> • Pre-filter: None • Main filter: Pleated, MERV 11 	<p>Outdoor air intake is accessible</p> <p>Outdoor air intake is located in an unknown location.</p> <p>No nearby pollution sources were found.</p> <p>Outdoor air intake is in good condition.</p>	<p>Outdoor air filters are not present.</p> <p>Return air filters are not present.</p> <p>Mixed air pre-filters are not present. Mixed air main filters are clean and not in need of replacement (scoring 1 out of 5) and fit well. Mixed air main filters are installed correctly.</p> <p>Drain pans are not applicable or not present. Drain pan condition is not known.</p> <p>Heating coils are clean.</p> <p>Heat wheels are not present.</p> <p>Exterior ducting is visible. Exterior ducting insulation is in good condition.</p> <p>Interior ducting is visible. Interior ducting insulation is in good condition. Interior ducting is clean.</p> <p>Air handling room is free of trash/chemicals.</p> <p>Outside damper is open, and its condition is good.</p> <p>Return damper is open, and its condition is good.</p> <p>The general condition of the unit is good.</p>

Unit Designation:	AHU 03	
Location of Unit:	Mechanical room 2302A	
Areas Served:	2nd Floor West Wing See attached map	
System Enhancements:	None	
Supply System	Outdoor Air	Cleanliness and Observations
Type <ul style="list-style-type: none"> • Supply System - Constant Volume • Heating - Hot Water • Cooling - None • Energy Recovery Unit (ERU) - None Filter Type - Mixed <ul style="list-style-type: none"> • Pre-filter: None • Main filter: Pleated, MERV 11 	<p>Outdoor air intake is accessible</p> <p>Outdoor air intake is located in an unknown location.</p> <p>No nearby pollution sources were found.</p> <p>Outdoor air intake is in good condition.</p>	<p>Outdoor air filters are not present.</p> <p>Return air filters are not present.</p> <p>Mixed air pre-filters are not present. Mixed air main filters are clean and not in need of replacement (scoring 1 out of 5) and fit well. Mixed air main filters are installed correctly.</p> <p>Drain pans are not applicable or not present. Drain pan condition is not known.</p> <p>Heating coils are clean.</p> <p>Heat wheels are not present.</p> <p>Exterior ducting is visible. Exterior ducting insulation is in good condition.</p> <p>Interior ducting is visible. Interior ducting insulation is in good condition. Interior ducting is clean.</p> <p>Air handling room is free of trash/chemicals.</p> <p>Outside damper is open, and its condition is good.</p> <p>Return damper is open, and its condition is good.</p> <p>The general condition of the unit is good.</p>

Unit Designation:	AHU 04	
Location of Unit:	Mechanical room 2302A	
Areas Served:	1306 East Gym See attached map	
System Enhancements:	None	
Supply System	Outdoor Air	Cleanliness and Observations
Type <ul style="list-style-type: none"> • Supply System - Constant Volume • Heating - Hot Water • Cooling - None • Energy Recovery Unit (ERU) - None Filter Type - Mixed <ul style="list-style-type: none"> • Pre-filter: None • Main filter: Pleated, MERV 11 	<p>Outdoor air intake is accessible</p> <p>Outdoor air intake is located in an unknown location.</p> <p>No nearby pollution sources were found.</p> <p>Outdoor air intake is in good condition.</p>	<p>Outdoor air filters are not present.</p> <p>Return air filters are not present.</p> <p>Mixed air pre-filters are not present. Mixed air main filters are clean and not in need of replacement (scoring 1 out of 5) and fit well. Mixed air main filters are installed correctly.</p> <p>Drain pans are not applicable or not present. Drain pan condition is not known.</p> <p>Heating coils are clean.</p> <p>Heat wheels are not present.</p> <p>Exterior ducting is visible. Exterior ducting insulation is in good condition.</p> <p>Interior ducting is visible. Interior ducting insulation is in good condition. Interior ducting is clean.</p> <p>Air handling room is free of trash/chemicals.</p> <p>Outside damper is open, and its condition is good.</p> <p>Return damper is open, and its condition is good.</p> <p>The general condition of the unit is good.</p>

Unit Designation:	AHU 05	
Location of Unit:	Mechanical room O104 Basement	
Areas Served:	Old Building See attached map	
System Enhancements:	None	
Supply System	Outdoor Air	Cleanliness and Observations
Type <ul style="list-style-type: none"> • Supply System - Constant Volume • Heating - Hot Water • Cooling - None • Energy Recovery Unit (ERU) - None Filter Type - Mixed <ul style="list-style-type: none"> • Pre-filter: None • Main filter: Pleated, MERV 11 	<p>Outdoor air intake is accessible</p> <p>Outdoor air intake is located in an unknown location.</p> <p>No nearby pollution sources were found.</p> <p>Outdoor air intake is in good condition.</p>	<p>Outdoor air filters are not present.</p> <p>Return air filters are not present.</p> <p>Mixed air pre-filters are not present. Mixed air main filters are clean and not in need of replacement (scoring 1 out of 5) and fit well. Mixed air main filters are installed correctly.</p> <p>Drain pans are not applicable or not present. Drain pan condition is not known.</p> <p>Heating coils are clean.</p> <p>Heat wheels are not present.</p> <p>Exterior ducting is visible. Exterior ducting insulation is in an unknown condition.</p> <p>Interior ducting is visible. Interior ducting insulation is in an unknown condition. Interior ducting is clean.</p> <p>Air handling room is free of trash/chemicals.</p> <p>Outside damper is open, and its condition is good.</p> <p>Return damper is open, and its condition is good.</p> <p>The general condition of the unit is good.</p>

Unit Designation:	AHU 06	
Location of Unit:	Mechanical room O104 Basement	
Areas Served:	Basement See attached map	
System Enhancements:	None	
Supply System	Outdoor Air	Cleanliness and Observations
Type <ul style="list-style-type: none"> • Supply System - Constant Volume • Heating - Hot Water • Cooling - None • Energy Recovery Unit (ERU) - None Filter Type - Mixed <ul style="list-style-type: none"> • Pre-filter: None • Main filter: Pleated, MERV 11 	<p>Outdoor air intake is accessible</p> <p>Outdoor air intake is located in an unknown location.</p> <p>No nearby pollution sources were found.</p> <p>Outdoor air intake is in good condition.</p>	<p>Outdoor air filters are not present.</p> <p>Return air filters are not present.</p> <p>Mixed air pre-filters are not present. Mixed air main filters are clean and not in need of replacement (scoring 1 out of 5) and fit well. Mixed air main filters are installed correctly.</p> <p>Drain pans are not applicable or not present. Drain pan condition is not known.</p> <p>Heating coils are clean.</p> <p>Heat wheels are not present.</p> <p>Exterior ducting is visible. Exterior ducting insulation is in good condition.</p> <p>Interior ducting is visible. Interior ducting insulation is in good condition. Interior ducting is clean.</p> <p>Air handling room is free of trash/chemicals.</p> <p>Outside damper is open, and its condition is good.</p> <p>Return damper is open, and its condition is good.</p> <p>The general condition of the unit is good.</p>

Unit Designation:	AHU 07	
Location of Unit:	Mechanical room 3109 Ceiling	
Areas Served:	3107-3110 Science See attached map	
System Enhancements:	None	
Supply System	Outdoor Air	Cleanliness and Observations
Type <ul style="list-style-type: none"> • Supply System - Constant Volume • Heating - Hot Water • Cooling - None • Energy Recovery Unit (ERU) - None Filter Type - Mixed <ul style="list-style-type: none"> • Pre-filter: None • Main filter: Pleated, MERV 11 	<p>Outdoor air intake is accessible</p> <p>Outdoor air intake is located in an unknown location.</p> <p>No nearby pollution sources were found.</p> <p>Outdoor air intake is in good condition.</p>	<p>Outdoor air filters are not present.</p> <p>Return air filters are not present.</p> <p>Mixed air pre-filters are not present. Mixed air main filters are clean and not in need of replacement (scoring 1 out of 5) and fit well. Mixed air main filters are installed correctly.</p> <p>Drain pans are not applicable or not present. Drain pan condition is not known.</p> <p>Heating coils are clean.</p> <p>Heat wheels are not present.</p> <p>Exterior ducting is visible. Exterior ducting insulation is in good condition.</p> <p>Interior ducting is visible. Interior ducting insulation is not present. Interior ducting is clean.</p> <p>Air handling room is free of trash/chemicals.</p> <p>Outside damper is open, and its condition is good.</p> <p>Return damper is open, and its condition is good.</p> <p>The general condition of the unit is good.</p>

Unit Designation:	RTU 01	
Location of Unit:	Mechanical room 1305 roof	
Areas Served:	1305 West Gym See attached map	
System Enhancements:	None	
Supply System	Outdoor Air	Cleanliness and Observations
Type <ul style="list-style-type: none"> Supply System - Constant Volume Heating - Hot Water Cooling - None Energy Recovery Unit (ERU) - None 	Outdoor air intake is accessible Outdoor air intake is located on the roof. No nearby pollution sources were found.	Outdoor air filters are not present. Return air filters are not present. Mixed air pre-filters are not present. Mixed air main filters are clean and not in need of replacement (scoring 1 out of 5) and fit well. Mixed air main filters are installed correctly. Drain pans are not applicable or not present. Drain pan condition is not known.
Filter Type - Mixed <ul style="list-style-type: none"> Pre-filter: None Main filter: Pleated, MERV 11 	Outdoor air intake is in good condition.	Heating coils are clean. Heat wheels are not present. Exterior ducting is visible. Exterior ducting insulation is not present. Interior ducting is visible. Interior ducting insulation is in an unknown condition. Interior ducting is of unknown cleanliness. Air handling room is free of trash/chemicals. Outside damper is open, and its condition is good. Return damper is open, and its condition is good. The general condition of the unit is good.

Unit Designation:	HVU 01	
Location of Unit:	Mechanical room 3114A fan rm	
Areas Served:	1213 library See attached map	
System Enhancements:	None	
Supply System	Outdoor Air	Cleanliness and Observations
Type <ul style="list-style-type: none"> Supply System - Constant Volume Heating - Hot Water Cooling - None Energy Recovery Unit (ERU) - None 	Outdoor air intake is accessible Outdoor air intake is located on the roof. No nearby pollution sources were found.	Outdoor air filters are not present. Return air filters are not present. Mixed air pre-filters are not present. Mixed air main filters are clean and not in need of replacement (scoring 1 out of 5) and fit well. Mixed air main filters are installed correctly. Drain pans are not applicable or not present. Drain pan condition is not known.
Filter Type - Mixed <ul style="list-style-type: none"> Pre-filter: None Main filter: Pleated, MERV 11 	Outdoor air intake is in good condition.	Heating coils are dirty. Heat wheels are not present. Exterior ducting is visible. Exterior ducting insulation is in good condition. Interior ducting is visible. Interior ducting insulation is in good condition. Interior ducting is clean. Air handling room is free of trash/chemicals. Outside damper is open, and its condition is good. Return damper is open, and its condition is good. The general condition of the unit is good.

Unit Designation:	UNINVENT 0107	
Location of Unit:	Classroom 0107	
Areas Served:	Room 0107	
System Enhancements:	None	
Supply System	Outdoor Air	Cleanliness and Observations
Type <ul style="list-style-type: none"> • Supply System - Constant Volume • Heating - Hot Water • Cooling - None • Energy Recovery Unit (ERU) - None Filter Type - Mixed <ul style="list-style-type: none"> • Pre-filter: None • Main filter: Pleated, MERV 11 	Outdoor air intake is accessible Outdoor air intake is located on an exterior wall. No nearby pollution sources were found. Outdoor air intake is in good condition.	Outdoor air filters are not present. Return air filters are not present. Mixed air pre-filters are not present. Mixed air main filters are clean and not in need of replacement (scoring 1 out of 5) and fit well. Mixed air main filters are installed correctly. Drain pans are not applicable or not present. Drain pan condition is not known. Heating coils are clean. Heat wheels are not present. Exterior ducting is visible. Exterior ducting insulation is not present. Interior ducting is visible. Interior ducting insulation is not present. Interior ducting is clean. Air handling room is free of trash/chemicals. Outside damper is open, and its condition is good. Return damper is open, and its condition is good. The general condition of the unit is good.

Unit Designation:	UNINVENT 0105	
Location of Unit:	Classroom 0105	
Areas Served:	Room 0105	
System Enhancements:	None	
Supply System	Outdoor Air	Cleanliness and Observations
Type <ul style="list-style-type: none"> • Supply System - Constant Volume • Heating - Hot Water • Cooling - None • Energy Recovery Unit (ERU) - None 	<p>Outdoor air intake is accessible</p> <p>Outdoor air intake is located on an exterior wall.</p> <p>Outdoor air intake has a nearby pollution source:</p>	<p>Outdoor air filters are not present.</p> <p>Return air filters are not present.</p> <p>Mixed air pre-filters are not present. Mixed air main filters are clean and not in need of replacement (scoring 1 out of 5) and fit well. Mixed air main filters are installed correctly.</p> <p>Drain pans are not applicable or not present. Drain pan condition is not known.</p>
Filter Type - Mixed <ul style="list-style-type: none"> • Pre-filter: None • Main filter: Pleated, MERV 11 	<p>Outdoor air intake is in good condition.</p>	<p>Heating coils are clean.</p> <p>Heat wheels are not present.</p> <p>Exterior ducting is visible. Exterior ducting insulation is not present.</p> <p>Interior ducting is visible. Interior ducting insulation is not present. Interior ducting is clean.</p> <p>Air handling room is free of trash/chemicals.</p> <p>Outside damper is open, and its condition is good.</p> <p>Return damper is open, and its condition is good.</p> <p>The general condition of the unit is good.</p>

Recommendations

Dirty Coils were observed on unit HVU 01 during the ventilation inspection.

Recommendation: Impacted/dirty coils can result in poor ventilation air supply as well as be a source for mold and bacterial growth on the coils. Coils should be cleaned annually, or as needed, as identified in the operations and maintenance program.

Appendix A

Photo Documentation



HVU 01
Heating Coils