

IEA, INC.

2023 - 2024 Ventilation Assessment



Contact Us:

BROOKLYN PARK OFFICE

9201 W. BROADWAY, #600
BROOKLYN PARK, MN 55445
763-315-7900

MANKATO OFFICE

610 N. RIVERFRONT DRIVE
MANKATO, MN 56001
507-345-8818

ROCHESTER OFFICE

210 WOOD LAKE DRIVE SE
ROCHESTER, MN 55904
507-281-6664

BRAINERD OFFICE

601 NW 5TH STREET SUITE #4
BRAINERD, MN 56401
218-454-0703

MARSHALL OFFICE

1420 EAST COLLEGE DRIVE
MARSHALL, MN 56258
507-476-3599

VIRGINIA OFFICE

5525 EMERALD AVENUE
MOUNTAIN IRON, MN 55768
218-410-9521

www.ieasafety.com

info@ieasafety.com

800-233-9513

Saint Paul Public Schools District Service Facility

Assessment Date:
Monday, April 10, 2023

Project Description

IEA conducted a ventilation inspection in District Service Facility by IEA representative, Sashya Wandmaker, with the intent of gathering visual observations and overall ventilation information which will assist the District in making informed and proactive decisions to improve and maintain acceptable air quality in the building. This inspection is based upon the Environmental Protection Agency's (EPA's) Tools for Schools IAQ guidelines and the recommended Minnesota Department of Education (MDE) portion of a school district's IAQ management plan. Ventilation verification is also recommended by American Society of Heating, Refrigerating and Air-Conditioning Engineers (ASHRAE).

Some observations gathered during the inspection may identify issues which may require additional testing, evaluation, further investigation, or maintenance on the ventilation systems.

The findings, conclusions and recommendations presented herein are believed to be accurate and representative of the building on the date and time of the inspection.

GENERAL COMMENTS

The analysis and opinions expressed in this report are based upon data obtained from Saint Paul Public Schools at the indicated locations. This report does not reflect variations in conditions that may occur across the site, property, or facility. Actual conditions may vary and may not become evident without further assessment.

The report is prepared for the exclusive use of our client for specific application to the project discussed and has been prepared in accordance with generally accepted indoor air quality practices. Other than as provided in the preceding sentence, no warranties are extended or made.

Building Information

General information regarding the building was collected by IEA during an interview with building maintenance staff. The information gathered during this process is a vital component, as it is helpful in determining how these items may play a role in possible IAQ related issues.

Below is a summary of the information gathered during the interview:

- Automation controls are managed internally.
- A Building Automation System is present. The automation control software program is Tridium and controls can not be accessed remotely.
- Schedules:

Ventilation operation:

Day:	Occupied?	Start Time:	End Time:
Monday-Friday	Yes	5:30 AM	6:00 PM
Monday-Friday	Yes	5:00 AM	8:00 PM

Typical occupancy:

Day:	Occupied?	Start Time:	End Time:
Monday-Friday	Yes	3:30 AM	10:00 PM
Saturday	Yes		
Sunday	Yes		
Holiday	Yes		

Notes: Only AHU 4 runs for room occupied on weekends and holidays, not sure of hours they are in.

- CO2 sensors are associated with the ventilation system. Their location is unknown. The highest CO2 setpoint is unknown.
- VAVs are present. It is not known whether or not they are fan powered.
- Building has variable frequency drives (VFD).
- The heating system is a boiler and gas-fired.
- A cooling system is present and is a chilled water (air cooled) type system.
- Filters used are:

Filter Type	MERV Rating
Metal Mesh	N/A
Pleated	MERV 11

- Filters are changed 3-4 times a year.
- Energy Recovery Units are not present.
- Units contain system Enhancements:
 - **Humidification:** AHU_02
- Personal air purifiers are supplied for individual rooms. They are Winix /Plasmawave 2.0.
 - Location: vary throughout building, most have been taken out due to pandemic being over
- It is not known whether or not the building was commissioned during the original construction.

Air Handling Unit Designations & Service Zones: 1st Floor



SECOND FLOOR PLAN

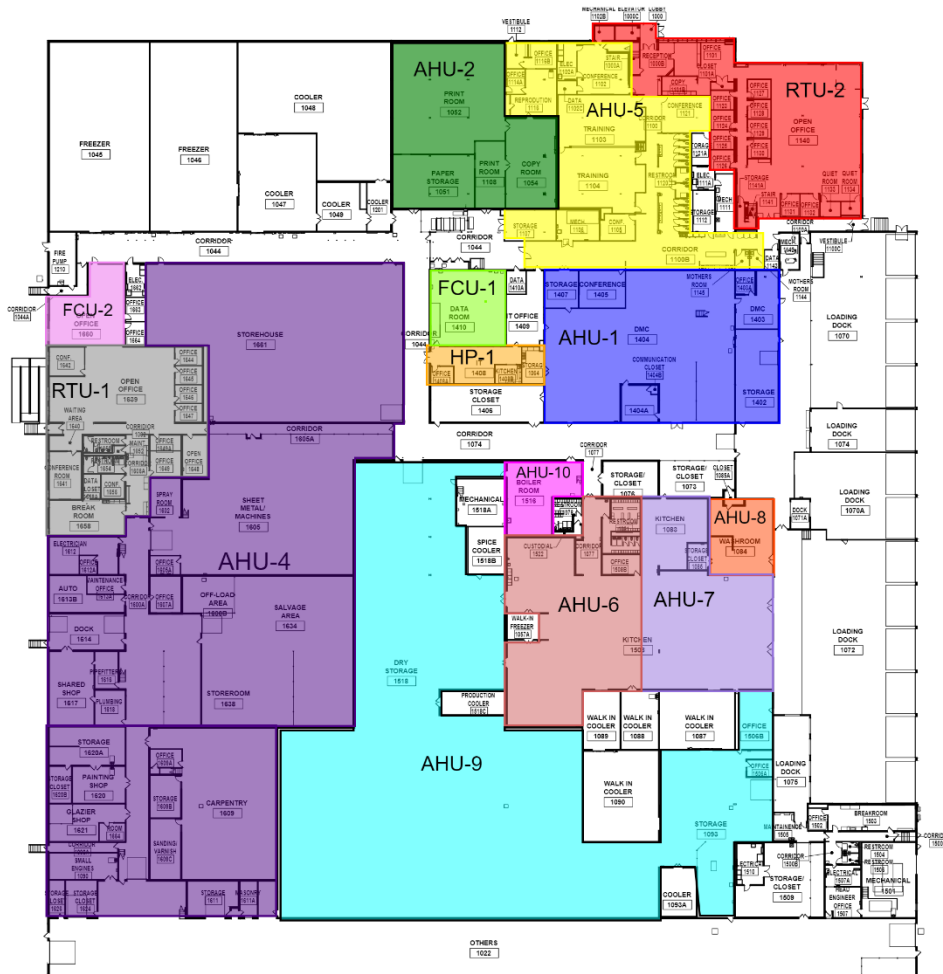

FIRST FLOOR - OVERALL PLAN



Assessment

Ventilation System

The following information was gathered by IEA on Monday, April 10, 2023 with support from the district building representative during the on-site interview. The type of heating, ventilating and air-conditioning (HVAC) system and its assessment is included for each unit below:

Unit Designation:	AHU_01	
Location of Unit:	Mechanical room 1064 above room	
Areas Served:	DMC See attached map	
System Enhancements:	None	
Supply System	Outdoor Air	Cleanliness and Observations
Type <ul style="list-style-type: none"> • Supply System - Constant Volume • Heating - Hot Water • Cooling - Dx • Energy Recovery Unit (ERU) - None Filter Type - Mixed <ul style="list-style-type: none"> • Pre-filter: None • Main filter: Pleated, MERV 11 	<p>Outdoor air intake is accessible</p> <p>Outdoor air intake is located on the roof.</p> <p>It is not known if there are nearby pollution sources.</p> <p>Outdoor air intake is in good condition.</p>	<p>Outdoor air filters are not present.</p> <p>Return air filters are not present.</p> <p>Mixed air pre-filters are not present. Mixed air main filters are clean and not in need of replacement (scoring 2 out of 5) and fit well. Mixed air main filters are installed correctly.</p> <p>Drain pan plugged status is not known. Drain pan condition is good.</p> <p>Heating coils are clean and cooling coils are inaccessible.</p> <p>Heat wheels are not present.</p> <p>Exterior ducting is visible. Exterior ducting insulation is not present.</p> <p>Interior ducting is not visible. Interior ducting insulation is in an unknown condition. Interior ducting is of unknown cleanliness.</p> <p>Air handling room is free of trash/chemicals.</p> <p>Outside damper is open, and its condition is good.</p> <p>Return damper is open, and its condition is good.</p> <p>The general condition of the unit is good.</p>

Unit Designation:	AHU_02	
Location of Unit:	Mechanical room North Hallway, hanging from ceiling.	
Areas Served:	Print Shop See attached map	
System Enhancements:	Humidification	
Supply System	Outdoor Air	Cleanliness and Observations
Type <ul style="list-style-type: none"> Supply System - Constant Volume Heating - Hot Water Cooling - Dx Energy Recovery Unit (ERU) - None 	Outdoor air intake is accessible Outdoor air intake is located on the roof. No nearby pollution sources were found.	Outdoor air filters are not present. Return air filters are not present. Mixed air pre-filters are not present. Mixed air main filters are clean and not in need of replacement (scoring 1 out of 5) and fit well. Mixed air main filters are installed correctly. Drain pan plugged status is not known. Drain pan condition is good.
Filter Type - Mixed <ul style="list-style-type: none"> Pre-filter: None Main filter: Pleated, MERV 11 	Outdoor air intake is in good condition.	Heating coils are clean and cooling coils are inaccessible. Heat wheels are not present. Exterior ducting is visible. Exterior ducting insulation is in good condition. Interior ducting is not visible. Interior ducting insulation is in an unknown condition. Interior ducting is of unknown cleanliness. Air handling room is free of trash/chemicals. Outside damper is open, and its condition is good. Return damper is open, and its condition is good. The general condition of the unit is good.

Unit Designation:	AHU_04	
Location of Unit:	Mechanical room NW Mezzanine	
Areas Served:	Shops Area See attached map	
System Enhancements:	None	
Supply System	Outdoor Air	Cleanliness and Observations
Type <ul style="list-style-type: none"> Supply System - VAV Heating - Hot Water Cooling - Dx Energy Recovery Unit (ERU) - None 	Outdoor air intake is accessible Outdoor air intake is located on the roof. No nearby pollution sources were found.	Outdoor air filters are not present. Return air filters are not present. Mixed air pre-filters are not present. Mixed air main filters are somewhat dirty and on the border of needing replacement (scoring 3 out of 5) and fit well. Mixed air main filters are installed correctly. Drain pans are not applicable or not present. Drain pan condition is not known.
Filter Type - Mixed <ul style="list-style-type: none"> Pre-filter: None Main filter: Pleated, MERV 11 	Outdoor air intake is in good condition.	Heating coils are clean and cooling coils are clean. Heat wheels are not present. Exterior ducting is visible. Exterior ducting insulation is in good condition. Interior ducting is not visible. Interior ducting insulation is in an unknown condition. Interior ducting is of unknown cleanliness. Air handling room is free of trash/chemicals. Outside damper is open, and its condition is good. Return damper is open, and its condition is good. The general condition of the unit is good.

Unit Designation:	AHU_05	
Location of Unit:	Mechanical room 1106 in North Hallway	
Areas Served:	1st Floor I.T. & 2nd Floor North Offices See attached map	
System Enhancements:	None	
Supply System	Outdoor Air	Cleanliness and Observations
Type <ul style="list-style-type: none"> • Supply System - VAV • Heating - Hot Water • Cooling - Chilled Water • Energy Recovery Unit (ERU) - None 	Outdoor air intake is accessible Outdoor air intake is located on the roof. No nearby pollution sources were found.	Outdoor air filters are not present. Return air filters are not present. Mixed air pre-filters are not present. Mixed air main filters are clean and not in need of replacement (scoring 2 out of 5) and fit well. Mixed air main filters are installed correctly. Drain pans are not plugged. Drain pan condition is good. Heating coils are clean and cooling coils are clean.
Filter Type - Mixed <ul style="list-style-type: none"> • Pre-filter: None • Main filter: Pleated, MERV 11 	Outdoor air intake is in good condition.	Heat wheels are not present. Exterior ducting is visible. Exterior ducting insulation is in good condition. Interior ducting is not visible. Interior ducting insulation is in an unknown condition. Interior ducting is of unknown cleanliness. Air handling room is free of trash/chemicals. Outside damper is open, and its condition is good. Return damper is open, and its condition is good. The general condition of the unit is good.

Unit Designation:	AHU_06	
Location of Unit:	Mechanical room 1516 Mezzanine	
Areas Served:	Kitchen-West See attached map	
System Enhancements:	None	
Supply System	Outdoor Air	Cleanliness and Observations
Type <ul style="list-style-type: none"> Supply System - Constant Volume Heating - Hot Water Cooling - Chilled Water Energy Recovery Unit (ERU) - None 	<p>Outdoor air intake is accessible</p> <p>Outdoor air intake is located on the roof.</p> <p>It is not known if there are nearby pollution sources.</p> <p>Outdoor air intake is in good condition.</p>	<p>Outdoor air pre-filters are not present. Outdoor air main filters are clean and not in need of replacement (scoring 1 out of 5) and fit well. Outdoor air main filters are installed correctly.</p> <p>Return air pre-filters are not present. Return air main filters are not present.</p> <p>Mixed air pre-filters are not present. Mixed air main filters are clean and not in need of replacement (scoring 2 out of 5) and fit well. Mixed air main filters are installed correctly.</p> <p>Drain pans are not applicable or not present. Drain pan condition is not known.</p> <p>Heating coils are clean.</p> <p>Heat wheels are not present.</p> <p>Exterior ducting is visible. Exterior ducting insulation is not present.</p> <p>Interior ducting is visible. Interior ducting insulation is not present. Interior ducting is clean.</p> <p>Air handling room is free of trash/chemicals.</p> <p>Outside damper is open, and its condition is good.</p> <p>Return damper is open, and its condition is good.</p> <p>The general condition of the unit is good.</p>
Filter Type - Outdoor <ul style="list-style-type: none"> Pre-filter: None Main filter: Pleated, MERV 11 		
Filter Type - Mixed <ul style="list-style-type: none"> Pre-filter: None Main filter: Pleated, MERV 11 		

Unit Designation:	AHU_07	
Location of Unit:	Mechanical room 1516 Mezzanine	
Areas Served:	Kitchen-East See attached map	
System Enhancements:	None	
Supply System	Outdoor Air	Cleanliness and Observations
Type <ul style="list-style-type: none"> Supply System - Constant Volume Heating - Hot Water Cooling - Chilled Water Energy Recovery Unit (ERU) - None 	<p>Outdoor air intake is accessible</p> <p>Outdoor air intake is located on the roof.</p> <p>It is not known if there are nearby pollution sources.</p> <p>Outdoor air intake is in good condition.</p>	<p>Outdoor air pre-filters are not present. Outdoor air main filters are clean and not in need of replacement (scoring 2 out of 5) and fit well. Outdoor air main filters are installed correctly.</p> <p>Return air filters are not present.</p> <p>Mixed air pre-filters are not present. Mixed air main filters are clean and not in need of replacement (scoring 2 out of 5) and fit well. Mixed air main filters are installed correctly.</p> <p>Drain pans are not applicable or not present. Drain pan condition is not known.</p> <p>Heating coils are clean.</p> <p>Heat wheels are not present.</p> <p>Exterior ducting is visible. Exterior ducting insulation is not present.</p> <p>Interior ducting is visible. Interior ducting insulation is not present. Interior ducting is clean.</p> <p>Air handling room is free of trash/chemicals.</p> <p>Outside damper is open, and its condition is good.</p> <p>Return damper is open, and its condition is good.</p> <p>The general condition of the unit is good.</p>
Filter Type - Outdoor <ul style="list-style-type: none"> Pre-filter: None Main filter: Pleated, MERV 11 		
Filter Type - Mixed <ul style="list-style-type: none"> Pre-filter: None Main filter: Pleated, MERV 11 		

Unit Designation:	AHU_08	
Location of Unit:	Mechanical room 1083 In Ceiling	
Areas Served:	Washroom 1084 See attached map	
System Enhancements:	None	
Supply System	Outdoor Air	Cleanliness and Observations
Type <ul style="list-style-type: none"> • Supply System - Constant Volume • Heating - • Cooling - • Energy Recovery Unit (ERU) - None 	<p>Accessibility of outdoor air intake is not known</p> <p>Outdoor air intake is located in an unknown location.</p> <p>It is not known if there are nearby pollution sources.</p> <p>Condition of the outdoor air intake is not known.</p>	<p>Outdoor air filters are not present.</p> <p>Return air filters are not present.</p> <p>Drain pan plugged status is not known. Drain pan condition is not known.</p> <p>Heating coil cleanliness is not known and cooling coil cleanliness is not known.</p> <p>Heat wheels are not present.</p> <p>Exterior ducting is not examined.</p> <p>Interior ducting is not examined.</p> <p>Air handling room is free of trash/chemicals.</p> <p>Outside damper position is not known, and its condition is not known.</p> <p>Return damper position is not known, and its condition is not known.</p>

Unit Designation:	AHU_09	
Location of Unit:	Mechanical room Roof fans	
Areas Served:	Dry Storage 1518 See attached map	
System Enhancements:	None	
Supply System	Outdoor Air	Cleanliness and Observations
Type <ul style="list-style-type: none"> Supply System - Constant Volume Heating - None Cooling - None Energy Recovery Unit (ERU) - None 	Outdoor air intake is accessible Outdoor air intake is located on the roof. No nearby pollution sources were found.	Outdoor air pre-filters are not present. Outdoor air main filters are clean and not in need of replacement (scoring 2 out of 5) and fit well. Outdoor air main filters are installed correctly. Return air filters are not present. Drain pans are not applicable or not present. Drain pan condition is good. Heat wheels are not present.
Filter Type - Outdoor <ul style="list-style-type: none"> Pre-filter: None Main filter: Metal Mesh, N/A 	Outdoor air intake is in good condition.	Exterior ducting is not visible. Exterior ducting insulation is in an unknown condition. Interior ducting is not visible. Interior ducting insulation is in an unknown condition. Interior ducting is of unknown cleanliness. Air handling room is free of trash/chemicals. Outside damper is open, and its condition is good. Return damper is inaccessible, and its condition is good. The general condition of the unit is good.

Unit Designation:	AHU_10	
Location of Unit:	Mechanical room 1516	
Areas Served:	Boiler Room 1516 See attached map	
System Enhancements:	None	
Supply System	Outdoor Air	Cleanliness and Observations
Type <ul style="list-style-type: none"> • Supply System - Constant Volume • Heating - None • Cooling - None • Energy Recovery Unit (ERU) - None 	<p>Outdoor air intake is accessible</p> <p>Outdoor air intake is located on the roof.</p> <p>No nearby pollution sources were found.</p> <p>Outdoor air intake is in good condition.</p>	<p>Outdoor air filters are not present.</p> <p>Return air filters are not present.</p> <p>Drain pan plugged status is not known. Drain pan condition is not known.</p> <p>Heat wheels are not present.</p> <p>Exterior ducting is not visible. Exterior ducting insulation is in an unknown condition.</p> <p>Interior ducting is not visible. Interior ducting insulation is in an unknown condition. Interior ducting is of unknown cleanliness.</p> <p>Air handling room is free of trash/chemicals.</p> <p>Outside damper is open, and its condition is good.</p> <p>Return damper is open, and its condition is good.</p> <p>The general condition of the unit is good.</p>

Unit Designation:	AHU_11 (100% OA)	
Location of Unit:	Mechanical room 1518 Mezzanine	
Areas Served:	Kitchen Mechanical Room See attached map	
System Enhancements:	None	
Supply System	Outdoor Air	Cleanliness and Observations
Type <ul style="list-style-type: none"> Supply System - Constant Volume Heating - None Cooling - None Energy Recovery Unit (ERU) - None 	<p>Outdoor air intake is accessible</p> <p>Outdoor air intake is located on the roof.</p> <p>It is not known if there are nearby pollution sources.</p>	<p>Outdoor air filters are not present.</p> <p>Return air filters are not present.</p> <p>Mixed air pre-filters are not present. Mixed air main filters are clean and not in need of replacement (scoring 2 out of 5) and fit well. Mixed air main filters are installed correctly.</p> <p>Drain pans are not applicable or not present. Drain pan condition is not known.</p>
Filter Type - Mixed <ul style="list-style-type: none"> Pre-filter: None Main filter: Pleated, MERV 11 	<p>Outdoor air intake is in good condition.</p>	<p>Heat wheels are not present.</p> <p>Exterior ducting is not visible. Exterior ducting insulation is in an unknown condition.</p> <p>Interior ducting is not visible. Interior ducting insulation is in an unknown condition. Interior ducting is of unknown cleanliness.</p> <p>Air handling room is free of trash/chemicals.</p> <p>Outside damper is open, and its condition is good.</p> <p>Return damper is open, and its condition is good.</p> <p>The general condition of the unit is good.</p>

Unit Designation:	RTU_01	
Location of Unit:	Mechanical room Roof NW Corner	
Areas Served:	Facilities Planning Dept See attached map	
System Enhancements:	None	
Supply System	Outdoor Air	Cleanliness and Observations
Type <ul style="list-style-type: none"> • Supply System - VAV • Heating - Hot Water • Cooling - Dx • Energy Recovery Unit (ERU) - None 	Outdoor air intake is accessible Outdoor air intake is located on the roof. No nearby pollution sources were found.	Outdoor air filters are not present. Return air filters are not present. Mixed air pre-filters are not present. Mixed air main filters are somewhat dirty and on the border of needing replacement (scoring 3 out of 5) and fit well. Mixed air main filters are installed correctly. Drain pans are not applicable or not present. Drain pan condition is not known.
Filter Type - Mixed <ul style="list-style-type: none"> • Pre-filter: None • Main filter: Pleated, MERV 11 	Outdoor air intake is in good condition.	Heating coils are clean and cooling coils are clean. Heat wheels are not present. Exterior ducting is not visible. Exterior ducting insulation is in an unknown condition. Interior ducting is not visible. Interior ducting insulation is in an unknown condition. Interior ducting is of unknown cleanliness. Air handling room is free of trash/chemicals. Outside damper is open, and its condition is good. Return damper is open, and its condition is good. The general condition of the unit is good.

Unit Designation:	RTU_02	
Location of Unit:	Mechanical room Roof SE Corner	
Areas Served:	2021 Addition See attached map	
System Enhancements:	None	
Supply System	Outdoor Air	Cleanliness and Observations
Type <ul style="list-style-type: none"> • Supply System - VAV • Heating - Hot Water • Cooling - Chilled Water • Energy Recovery Unit (ERU) - None 	Outdoor air intake is accessible Outdoor air intake is located on the roof. No nearby pollution sources were found.	Outdoor air filters are not present. Return air filters are not present. Mixed air pre-filters are not present. Mixed air main filters are clean and not in need of replacement (scoring 2 out of 5) and fit well. Mixed air main filters are installed correctly. Drain pans are not plugged. Drain pan condition is good. Heating coils are clean and cooling coils are clean.
Filter Type - Mixed <ul style="list-style-type: none"> • Pre-filter: None • Main filter: Pleated, MERV 11 	Outdoor air intake is in good condition.	Heat wheels are not present. Exterior ducting is visible. Exterior ducting insulation is not present. Interior ducting is not visible. Interior ducting insulation is in an unknown condition. Interior ducting is of unknown cleanliness. Air handling room is free of trash/chemicals. Outside damper is open, and its condition is good. Return damper is open, and its condition is good. The general condition of the unit is good.

Recommendations

Appendix A

Photo Documentation



RTU_01

Mixed Main Filter Cleanliness

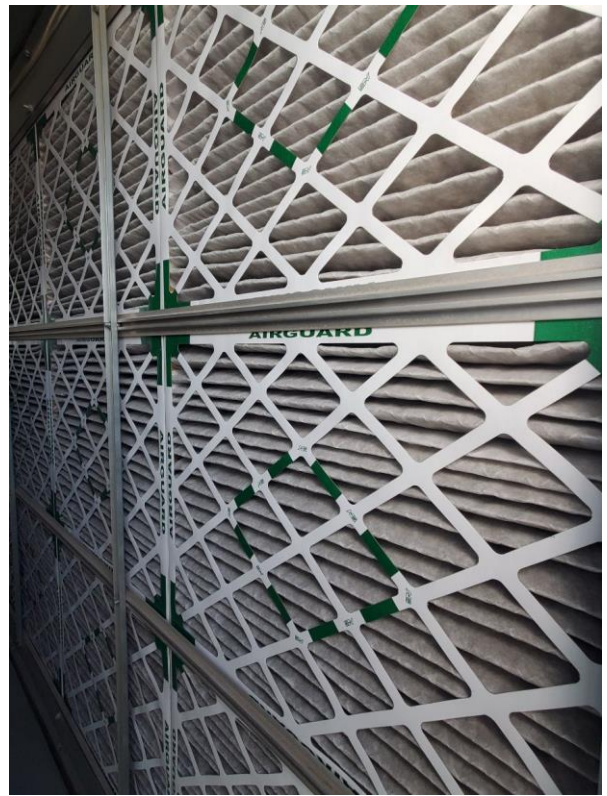

RTU_02

Mixed Main Filter Cleanliness