

IEA, INC.

## 2023 - 2024 Ventilation Assessment



### Contact Us:

#### BROOKLYN PARK OFFICE

9201 W. BROADWAY, #600  
BROOKLYN PARK, MN 55445  
763-315-7900

#### MANKATO OFFICE

610 N. RIVERFRONT DRIVE  
MANKATO, MN 56001  
507-345-8818

#### ROCHESTER OFFICE

210 WOOD LAKE DRIVE SE  
ROCHESTER, MN 55904  
507-281-6664

#### BRAINERD OFFICE

601 NW 5TH STREET SUITE #4  
BRAINERD, MN 56401  
218-454-0703

#### MARSHALL OFFICE

1420 EAST COLLEGE DRIVE  
MARSHALL, MN 56258  
507-476-3599

#### VIRGINIA OFFICE

5525 EMERALD AVENUE  
MOUNTAIN IRON, MN 55768  
218-410-9521

[www.ieasafety.com](http://www.ieasafety.com)

[info@ieasafety.com](mailto:info@ieasafety.com)

800-233-9513

## Saint Paul Public Schools AGAPE High School

Assessment Date:  
Monday, April 24, 2023

---

## Project Description

---

IEA conducted a ventilation inspection in AGAPE High School by IEA representative, Eddie Anderson, with the intent of gathering visual observations and overall ventilation information which will assist the District in making informed and proactive decisions to improve and maintain acceptable air quality in the building. This inspection is based upon the Environmental Protection Agency's (EPA's) Tools for Schools IAQ guidelines and the recommended Minnesota Department of Education (MDE) portion of a school district's IAQ management plan. Ventilation verification is also recommended by American Society of Heating, Refrigerating and Air-Conditioning Engineers (ASHRAE).

Some observations gathered during the inspection may identify issues which may require additional testing, evaluation, further investigation, or maintenance on the ventilation systems.

The findings, conclusions and recommendations presented herein are believed to be accurate and representative of the building on the date and time of the inspection.

### **GENERAL COMMENTS**

The analysis and opinions expressed in this report are based upon data obtained from Saint Paul Public Schools at the indicated locations. This report does not reflect variations in conditions that may occur across the site, property, or facility. Actual conditions may vary and may not become evident without further assessment.

The report is prepared for the exclusive use of our client for specific application to the project discussed and has been prepared in accordance with generally accepted indoor air quality practices. Other than as provided in the preceding sentence, no warranties are extended or made.

## Building Information

General information regarding the building was collected by IEA during an interview with building maintenance staff. The information gathered during this process is a vital component, as it is helpful in determining how these items may play a role in possible IAQ related issues.

**Below is a summary of the information gathered during the interview:**

- Automation controls are managed internally.
- A Building Automation System is present. The automation control software program is Tridum and controls can not be accessed remotely.
- Schedules:

Ventilation operation:

Day:	Occupied?	Start Time:	End Time:
Monday-Friday	Yes	6:00 AM	6:00 PM
Saturday	No		
Sunday	No		
Holiday	No		

Typical occupancy:

Day:	Occupied?	Start Time:	End Time:
Monday-Friday	Yes	7:00 AM	5:30 PM
Saturday	No		
Sunday	No		
Holiday	No		

- It is not known whether or not CO2 sensors are associated with the ventilation system.
- VAVs are present. It is not known whether or not they are fan powered.
- Building has variable frequency drives (VFD).
- The heating system is a hot water boiler.
- A cooling system is present and is a chilled water (air cooled) type system.
- Filters used are:

Filter Type	MERV Rating
Pleated	MERV 11
Pleated	N/A

- Filters are changed Twice a year.
- Energy Recovery Units are not present.
- Units do not contain system Enhancements.
- Personal air purifiers are supplied for individual rooms. They are 3M/Winix.
  - Location: Various classrooms
- It is not known whether or not the building was commissioned during the original construction.

# Air Handling Unit Designations & Service Zones: 1st Floor

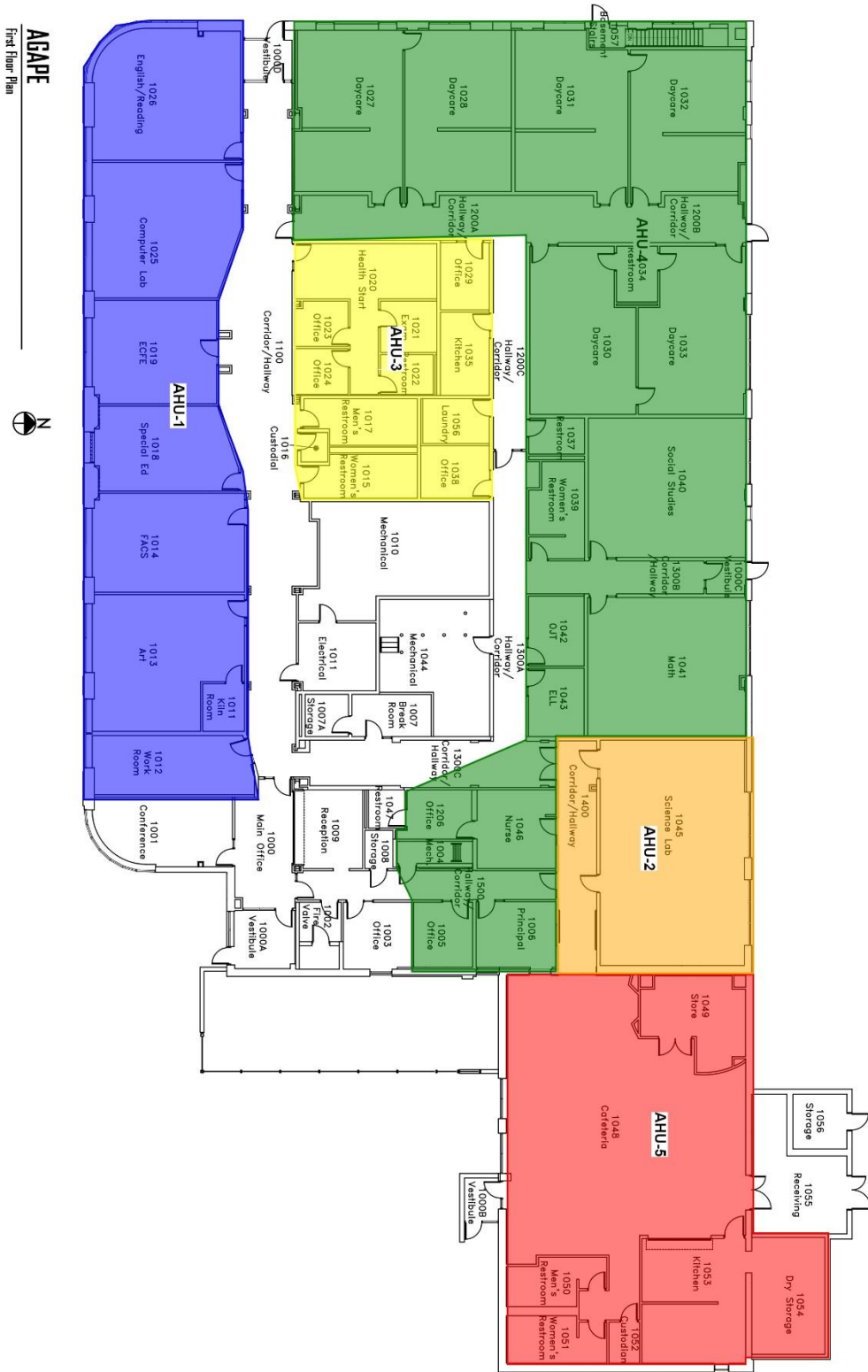

# Assessment

## Ventilation System

The following information was gathered by IEA on Monday, April 24, 2023 with support from the district building representative during the on-site interview. The type of heating, ventilating and air-conditioning (HVAC) system and its assessment is included for each unit below:

<b>Unit Designation:</b>	AHU_01	
<b>Location of Unit:</b>	Mech. room 1010	
<b>Areas Served:</b>	Serves South Dual Duct Units See attached map	
<b>System Enhancements:</b>	None	
<b>Supply System</b>	<b>Outdoor Air</b>	<b>Cleanliness and Observations</b>
<b>Type</b> <ul style="list-style-type: none"> <li>• Supply System - Constant Volume</li> <li>• Heating - Hot Water</li> <li>• Cooling - Dx</li> <li>• Energy Recovery Unit (ERU) - None</li> </ul> <b>Filter Type - Mixed</b> <ul style="list-style-type: none"> <li>• Pre-filter: None</li> <li>• Main filter: Pleated, MERV 11</li> </ul>	<p>Outdoor air intake is inaccessible</p> <p>Outdoor air intake is located on the roof.</p> <p>It is not known if there are nearby pollution sources.</p> <p>Outdoor air intake is in good condition.</p>	<p>Outdoor air filters are not present.</p> <p>Return air filters are not present.</p> <p>Mixed air pre-filters are not present. Mixed air main filters are somewhat dirty and on the border of needing replacement (scoring 3 out of 5) and fit well. Mixed air main filters are installed correctly.</p> <p>Drain pans are not plugged. Drain pan condition is good.</p> <p>Heating coils are clean and cooling coils are clean.</p> <p>Heat wheels are not present.</p> <p>Exterior ducting is not visible. Exterior ducting insulation is in good condition.</p> <p>Interior ducting is not visible. Interior ducting insulation is in an unknown condition. Interior ducting is of unknown cleanliness.</p> <p>Air handling room is free of trash/chemicals.</p> <p>Outside damper is open, and its condition is good.</p> <p>Return damper is open, and its condition is good.</p> <p>The general condition of the unit is good.</p>

<b>Unit Designation:</b>	AHU_02	
<b>Location of Unit:</b>	Mechanical room Unit loc. 1004	
<b>Areas Served:</b>	Serves Science & Admin Reheat Coils See attached map	
<b>System Enhancements:</b>	None	
<b>Supply System</b>	<b>Outdoor Air</b>	<b>Cleanliness and Observations</b>
<b>Type</b> <ul style="list-style-type: none"> <li>• Supply System - Constant Volume</li> <li>• Heating - Hot Water</li> <li>• Cooling - Dx</li> <li>• Energy Recovery Unit (ERU) - None</li> </ul> <b>Filter Type - Mixed</b> <ul style="list-style-type: none"> <li>• Pre-filter: None</li> <li>• Main filter: Pleated, N/A</li> </ul>	<p>Outdoor air intake is inaccessible</p> <p>Outdoor air intake is located on the roof.</p> <p>It is not known if there are nearby pollution sources.</p> <p>Outdoor air intake is in good condition.</p>	<p>Outdoor air filters are not present.</p> <p>Return air filters are not present.</p> <p>Mixed air pre-filters are not present. Mixed air main filters are clean and not in need of replacement (scoring 2 out of 5) and fit well. Mixed air main filters are installed correctly.</p> <p>Drain pans are not plugged. Drain pan condition is good.</p> <p>Heating coils are clean and cooling coils are clean.</p> <p>Heat wheels are not present.</p> <p>Exterior ducting is visible. Exterior ducting insulation is in good condition.</p> <p>Interior ducting is not visible. Interior ducting insulation is in an unknown condition. Interior ducting is of unknown cleanliness.</p> <p>Air handling room is free of trash/chemicals.</p> <p>Outside damper is open, and its condition is good.</p> <p>Return damper is open, and its condition is good.</p> <p>The general condition of the unit is good.</p>

<b>Unit Designation:</b>	AHU_04	
<b>Location of Unit:</b>	Mechanical room 1044	
<b>Areas Served:</b>	Serves Northwest VAV Boxes See attached map	
<b>System Enhancements:</b>	None	
<b>Supply System</b>	<b>Outdoor Air</b>	<b>Cleanliness and Observations</b>
<b>Type</b> <ul style="list-style-type: none"> <li>• Supply System - VAV</li> <li>• Heating - Hot Water</li> <li>• Cooling - Dx</li> <li>• Energy Recovery Unit (ERU) - None</li> </ul>	Outdoor air intake is inaccessible  Outdoor air intake is located on the roof.  It is not known if there are nearby pollution sources.	Outdoor air filters are not present.  Return air filters are not present.  Mixed air pre-filters are not present. Mixed air main filters are clean and not in need of replacement (scoring 2 out of 5) and fit well. Mixed air main filters are installed correctly.  Drain pans are not plugged. Drain pan condition is poor.  Heating coils are clean and cooling coils are clean.  Heat wheels are not present.  Exterior ducting is visible. Exterior ducting insulation is in good condition.  Interior ducting is not visible. Interior ducting insulation is in an unknown condition. Interior ducting is of unknown cleanliness.  Air handling room is free of trash/chemicals.  Outside damper is inaccessible, and its condition is good.  Return damper is inaccessible, and its condition is good.  The general condition of the unit is good.
<b>Filter Type - Mixed</b> <ul style="list-style-type: none"> <li>• Pre-filter: None</li> <li>• Main filter: Pleated, MERV 11</li> </ul>	Outdoor air intake is in good condition.	

<b>Unit Designation:</b>	AHU_05	
<b>Location of Unit:</b>	Mechanical room Unit loc. 1055	
<b>Areas Served:</b>	Serves Cafeteria & Kitchen See attached map	
<b>System Enhancements:</b>	None	
<b>Supply System</b>	<b>Outdoor Air</b>	<b>Cleanliness and Observations</b>
<b>Type</b> <ul style="list-style-type: none"> <li>Supply System - Constant Volume</li> <li>Heating - Hot Water</li> <li>Cooling - Dx</li> <li>Energy Recovery Unit (ERU) - None</li> </ul> <b>Filter Type - Mixed</b> <ul style="list-style-type: none"> <li>Pre-filter: None</li> <li>Main filter: Pleated, MERV 11</li> </ul>	<p>Outdoor air intake is inaccessible</p> <p>Outdoor air intake is located on the roof.</p> <p>It is not known if there are nearby pollution sources.</p> <p>Outdoor air intake is in good condition.</p>	<p>Outdoor air filters are not present.</p> <p>Return air filters are not present.</p> <p>Mixed air pre-filters are not present. Mixed air main filters are clean and not in need of replacement (scoring 2 out of 5) and fit well. Mixed air main filters are installed correctly.</p> <p>Drain pans are not plugged. Drain pan condition is good.</p> <p>Heating coils are clean and cooling coils are clean.</p> <p>Heat wheels are not present.</p> <p>Exterior ducting is visible. Exterior ducting insulation is in good condition.</p> <p>Interior ducting is not visible. Interior ducting insulation is in an unknown condition. Interior ducting is of unknown cleanliness.</p> <p>Air handling room is free of trash/chemicals.</p> <p>Outside damper is open, and its condition is good.</p> <p>Return damper is open, and its condition is good.</p> <p>The general condition of the unit is good.</p>



---

## Recommendations

---

The drain pan for unit AHU\_04 was plugged or damaged at the time of the site inspection.

**Recommendation:** Damage to the drain pan should be repaired, or the drain pan should be inspected more frequently to ensure that it does not become plugged.

# **Appendix A**

## Photo Documentation

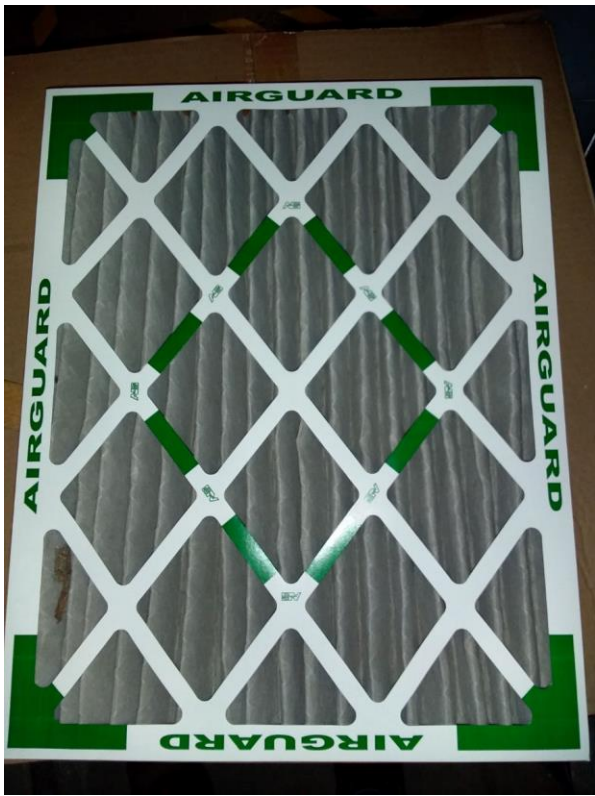

AHU\_01  
Mixed Main Filter Cleanliness



AHU\_04  
Drain Pans