

Capital Projects Update

Measure X, T & Additional Sources

October 26th, 2023



Teaching
& Learning

Status Update

- Solar projects submitted to DSA, construction scheduled to begin Winter Break
- Parkside MPR and Bowditch Academic Core + Gym bidding with a January 2024 start
- Abbott, Laurel and North Shoreview fields opened this month



82,827 Square Feet (SF) Flooring



505,000 SF Paving

Replaced or slurry coated

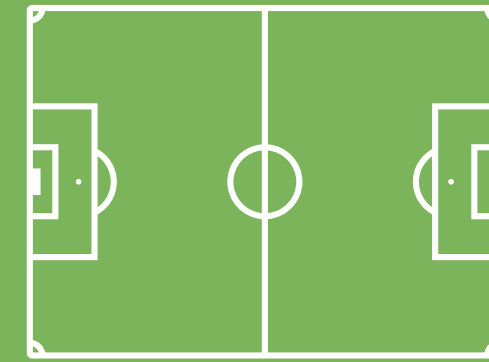

100,000 SF Turf

Under construction or completed

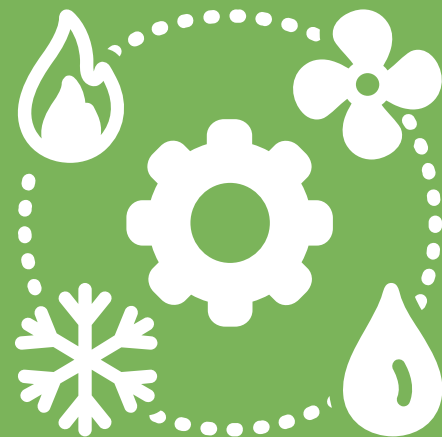

63 HVAC UNITS

Installed at Beresford, Foster City ES, LEAD, & San Mateo Park



53,407 SF

Buildings under construction at Bowditch, George Hall, Highlands, Lead, Sunnybrae, Pre K



1 MultiPurpose Room

George Hall opened Aug '23

Measure X & Additional Funding Sources - Oct 2023

Budget vs. Commitments and Expenditures MEASURE X & Additional Funding Sources

Active Project Name	Budget	Commitments		Expenditures		Status	Construction Start Date Anticipated	Completion Date Anticipated
	Total Budget	Total Commitments	% Budget Committed	Total Expenditures	% Budget Spent			
Bayside EV BUS Charging - EV Bus Charging at Bayside	6,000,000	6,200	0.1%	-	0.0%	Planning	2021	Aug-25
Borel Middle School - New Shade Structure	2,000,000	1,661,558	83.1%	1,558,234	77.9%	Closeout	Summer 2023	Fall 2023
Bowditch Middle School - Renovation Ph I: Drama & Science Bldgs	19,500,000	20,459,866	104.9%	13,677,035	70.1%	Construction	Oct-22	Spring 2024
George Hall Elementary School - New Multi Purpose Room	12,300,000	11,789,111	95.8%	11,515,165	93.6%	Closeout	22-Feb	Summer 2023
Fiesta Gardens North	36,000,000	2,823,257	7.8%	827,804	2.3%	Design	2024	Summer 2026
Sunnybrae Elementary School - New Multi Purpose Room	16,200,000	16,215,630	100.1%	11,021,344	68.0%	Construction	Jan-23	Summer 2024
X Program - MX Non Project Specific Expenses	5,000,000	2,032,000	40.6%	1,464,709	29.3%	Ongoing	n/a	Duration of Bond
Totals	97,000,000	54,987,622	56.7%	40,064,290	41.3%			

Phase 1 - Completed Projects

Abbott Middle School - New Gym & Classrooms DONE	21,100,000	21,041,028	99.7%	21,011,851	99.6%	Complete
Abbott Middle School - New Shade Structure DONE (1) (4)	37,680	37,679	100.0%	37,679	100.0%	Complete
Bayside S.T.E.M. - New Gym DONE	12,188,502	12,141,719	99.6%	12,131,841	99.5%	Complete
Beach Park Elementary - Beach Park (Charter Sq) DONE	24,012,396	23,753,556	98.9%	23,679,952	98.6%	Complete
Borel Middle School - New Gym & Classrooms DONE	22,835,891	22,745,407	99.6%	22,738,949	99.6%	Complete
Totals	80,174,469	79,719,389	99.4%	79,600,272	99.3%	

Funding Sources

M X Issuance A	73,755,000
M X Issuance B	44,865,000
M X Issuance C	28,800,000
Interest	1,080,910
Developer Fees	6,364,505
Fund 40	16,000,000
Transportation Funds AB181	6,000,000
State Funding Mod Eligibility (2)	5,000,000
Totals	181,865,415

Funds Not Allocated 4,690,946

Measure T - Oct 2023

Budget vs. Commitments and Expenditures MEASURE T

Active Project Name	Budget	Commitments		Expenditures		Status	Construction Start Date Anticipated	Construction Completion Date Anticipated
	Total Budget	Total Commitments	% Budget Committed	Total Expenditures	% Budget Spent			
Bowditch - Renov Ph II-IV: Academic Core, Gym	67,200,000	22,386,132	33.3%	12,681,598	18.9%	Bidding	Winter 2023	Summer 2026
District Wide - Solar	15,000,000	15,225,713	101.5%	2,994,483	20.0%	DSA Review	Late 2023	Summer 2024
District Wide - Flooring Ph 3 (FY 23-24)	14,600,000	1,403,282	9.6%	969,357	6.6%	Design/Construction	Summer 2023	Summer 2026
District Wide - District Wide HVAC II	59,744,200	45,073,860	75.4%	19,762,411	33.1%	Construction	Spring 2023	Fall 2024
District Wide - Paving	40,000,000	53,770	0.1%	53,770	0.1%	Scoped	Summer 2023	Summer 2026
District Wide - Restroom Modernization	61,993,000	4,161,032	6.7%	914,613	1.5%	Design/Construction	Summer 2023	Summer 2026
District Wide - Turf Phase 2	17,700,000	16,876,686	95.3%	8,536,971	48.2%	Construction	Summer 2023	Dec 2023
District Wide - Underground Infrastructure	9,000,000	-	0.0%	-	0.0%		Summer 2023	Summer 2026
District Wide SMFCSD - Bond Sale expense	94,000	94,000	100.0%	94,000	100.0%	Completed	Spring 2023	Spring 2023
Highlands Elementary School - MPR	15,000,000	14,706,429	98.0%	3,499,983	23.3%	Construction	Spring 2023	Summer 2024
LEAD Elementary School - MPR	17,000,000	13,653,873	80.3%	3,137,639	18.5%	Construction	Spring 2023	Summer 2024
Meadow Heights Elementary School - MPR	14,940,000	3,286,099	22.0%	2,809,686	18.8%	PH I Comp PH II DSA	Winter 2024	Summer 2025
Parkside Elementary School - MPR	15,375,000	1,622,163	10.6%	893,153	5.8%	Bidding	Winter 2023	Summer 2025
Program - MT Non Project Specific Expenses	5,000,000	2,287,581	45.8%	1,517,796	30.4%	Ongoing		Duration of Bond
Totals	352,646,200	140,830,619	39.9%	57,865,460	16.4%			

Completed Projects

CO2 Detect for Sites	312,000	284,321	91.1%	282,284	90.5%	Completed	Winter 2022	Spring 2022
District Wide - Flooring Ph 1 (FY 21-22)	817,713	817,713	100.0%	815,372	99.7%	Completed	Summer 2021	Summer 2022
District Wide - Flooring Ph 2 (FY 22-23)	2,410,510	2,410,510	100.0%	1,845,172	76.5%	Completed	Summer 2022	Summer 2023
Laurel - Portables	600,000	537,882	89.6%	535,111	89.2%	Completed	Fall 2021	Spring 2022
Middle School Sites - Vape Detect Restrooms	194,000	187,601	96.7%	187,601	96.7%	Completed	Fall 2021	Feb 2022
Multiple Sites - Water Bottle Fillers	451,541	583,251	129.2%	572,070	126.7%	Completed	Fall 2021	Fall 2022
District Wide - District Wide HVAC I	38,000,000	37,111,552	97.7%	36,832,324	96.9%	Completed	Spring 2022	Fall 2022
District Wide - Turf Phase I	12,302,500	10,235,847	83.2%	10,166,526	82.6%	Completed	Summer 2022	Spring 2023
Foster City ES Turf Field	1,550,000	1,436,296	92.7%	1,436,296	92.7%	Completed	Feb 2022	Summer 2022
Totals	56,638,264	53,604,972	93.0%	52,672,756	93.0%			

Grand Total 409,284,464

Funding Sources

Interest	1,239,221
M T Issuance A	100,000,000
M T Issuance B	150,000,000
M T Remaining Issuances	159,000,000
Totals	410,239,221.34

Funds Not Allocated 954,757.34



Funded By:
Measure X

GEORGE HALL MULTI-PURPOSE ROOM



Funded By:
Measure X

BOWDITCH SCIENCE & DRAMA



Funded By:
Measure X

SUNNYBRAE MULTI-PURPOSE ROOM



Funded By:
Measure X

BOREL SHADE STRUCTURES



Funded By:
Measure T

LEAD MULTI-PURPOSE ROOM



Funded By:
Measure T

HIGHLANDS MULTI-PURPOSE ROOM

Abbott MS



Funded By:
Measure T

FIELDS AND PAVING PROJECTS



Funded By:
Measure T & CSPP

PRESCHOOL CLASSROOMS & RESTROOMS

FIESTA GARDENS CAMPUS EXPANSION



Rendering - Main Entry

Funded By: Measure X, Dev. Fees, Fund 40

HMC Architects

FIESTA GARDENS CAMPUS EXPANSION

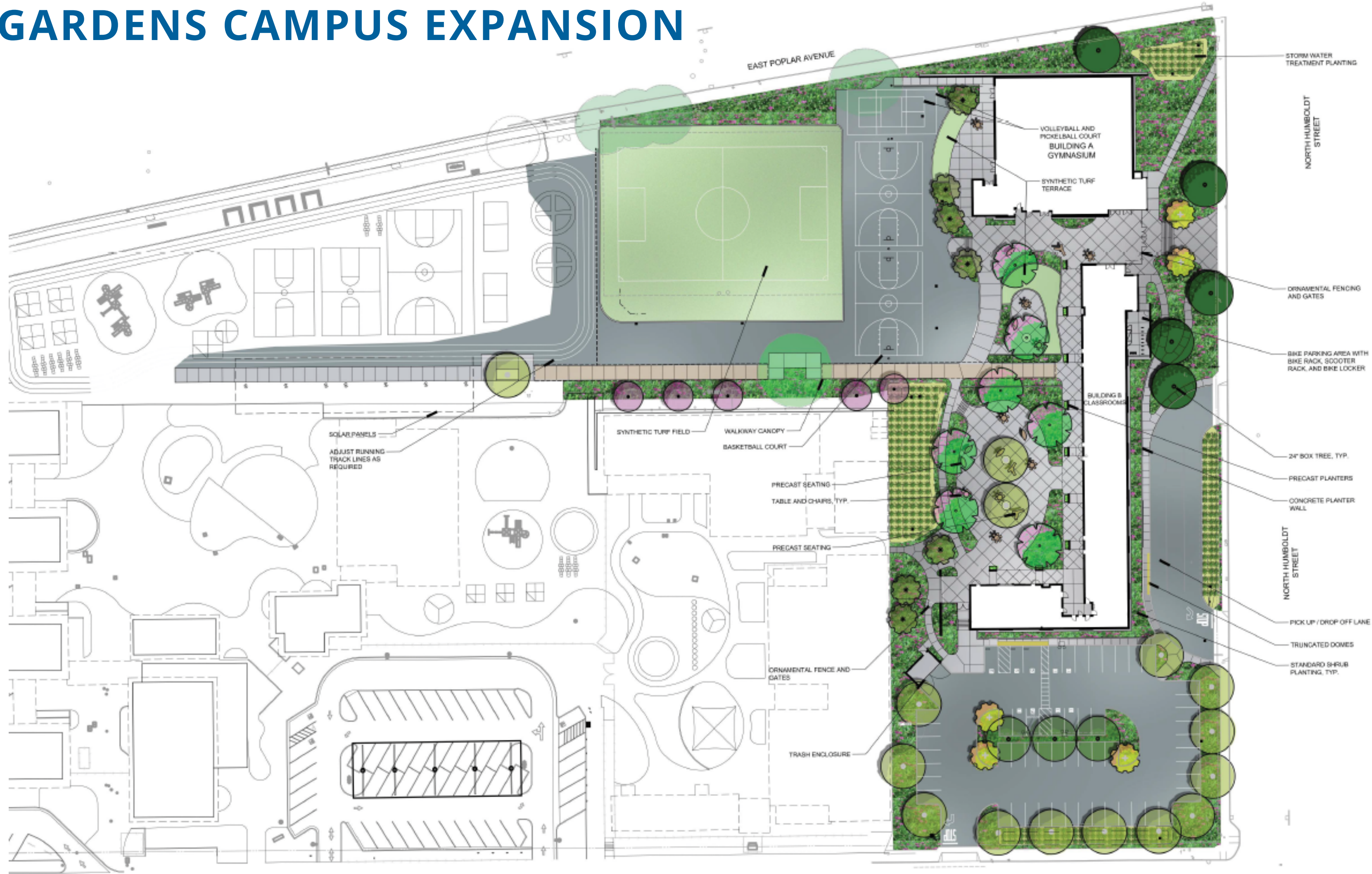

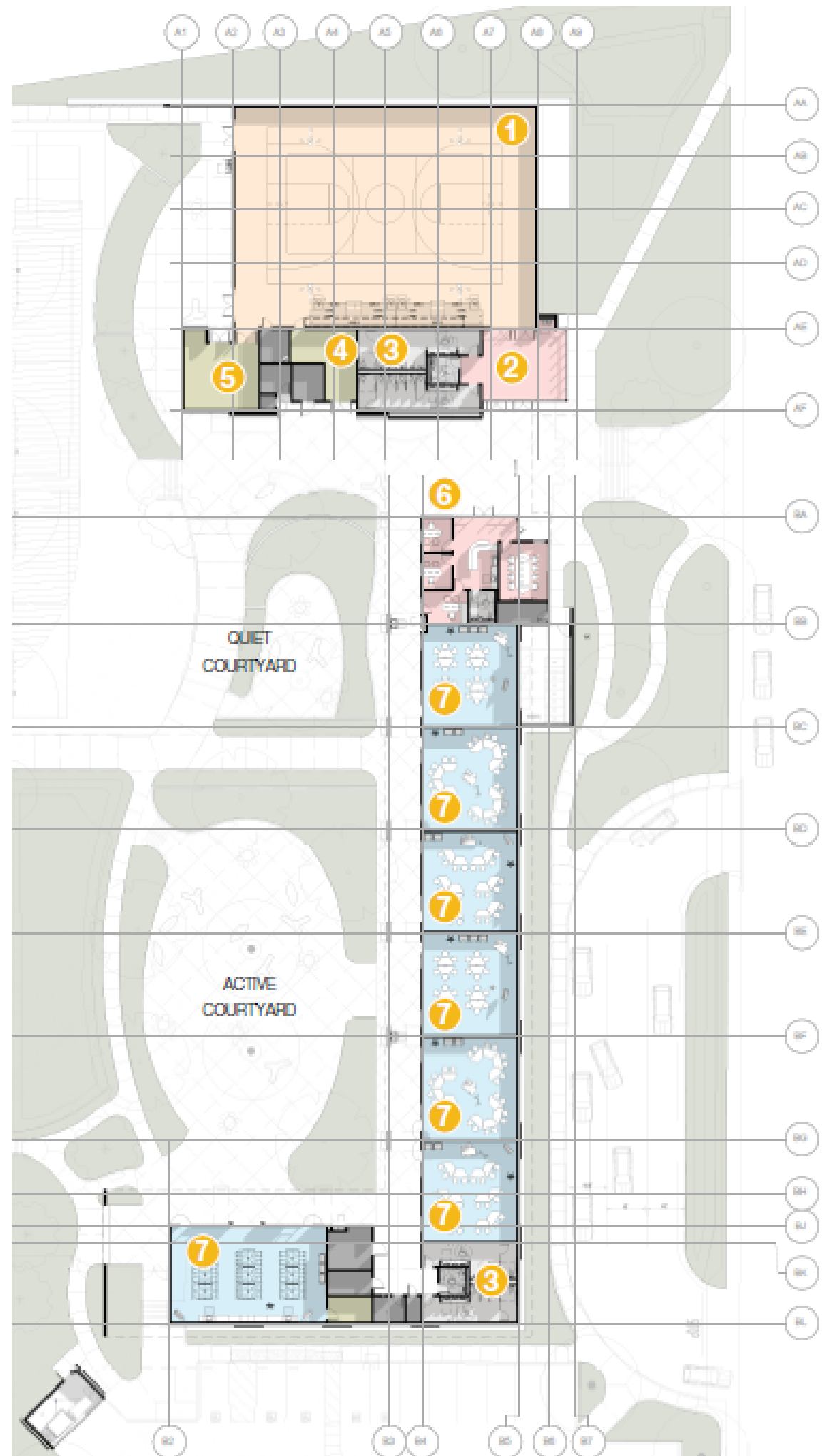

Overall Floor plan

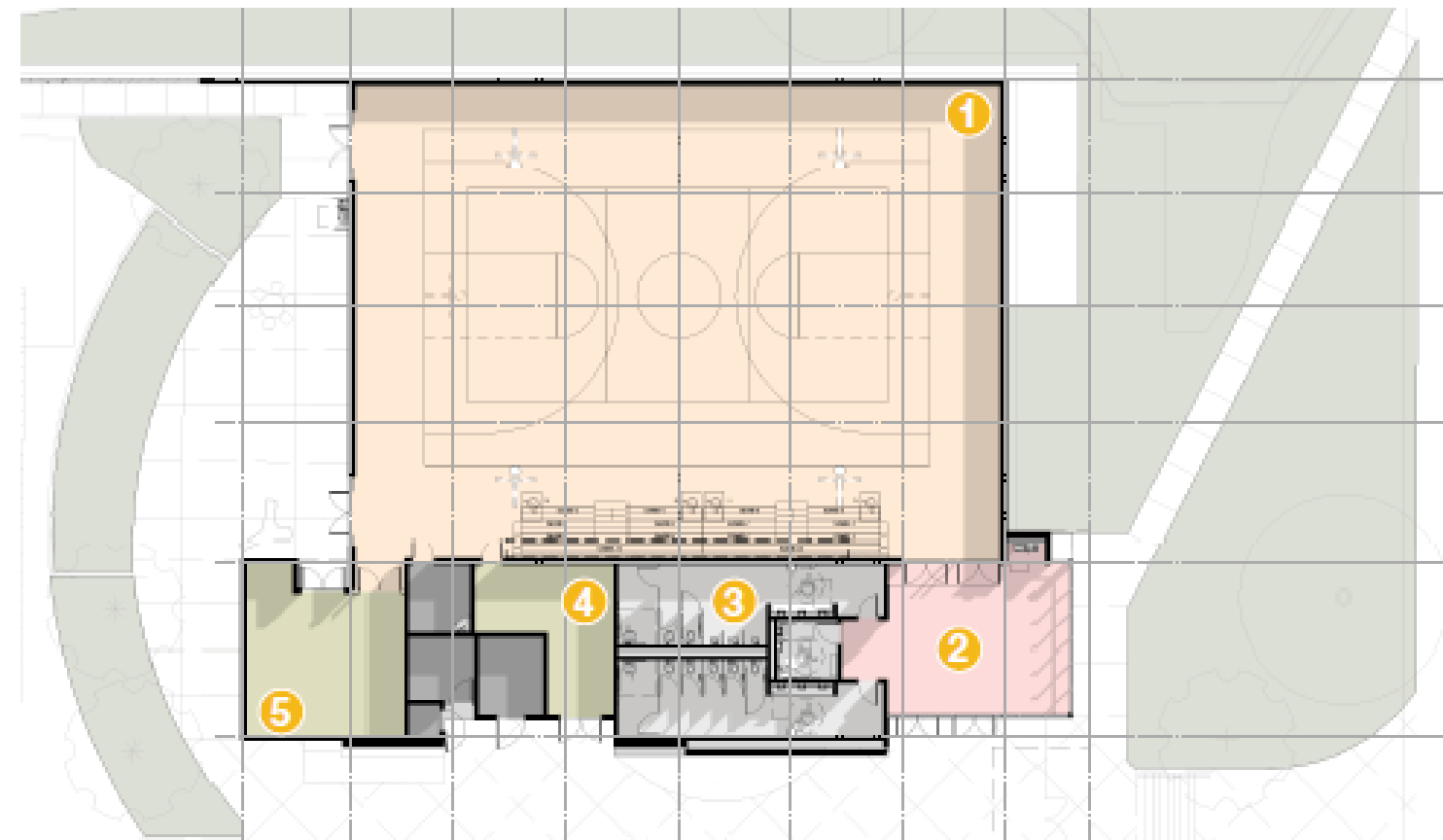
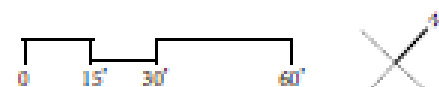

Gymnasium Floor plan

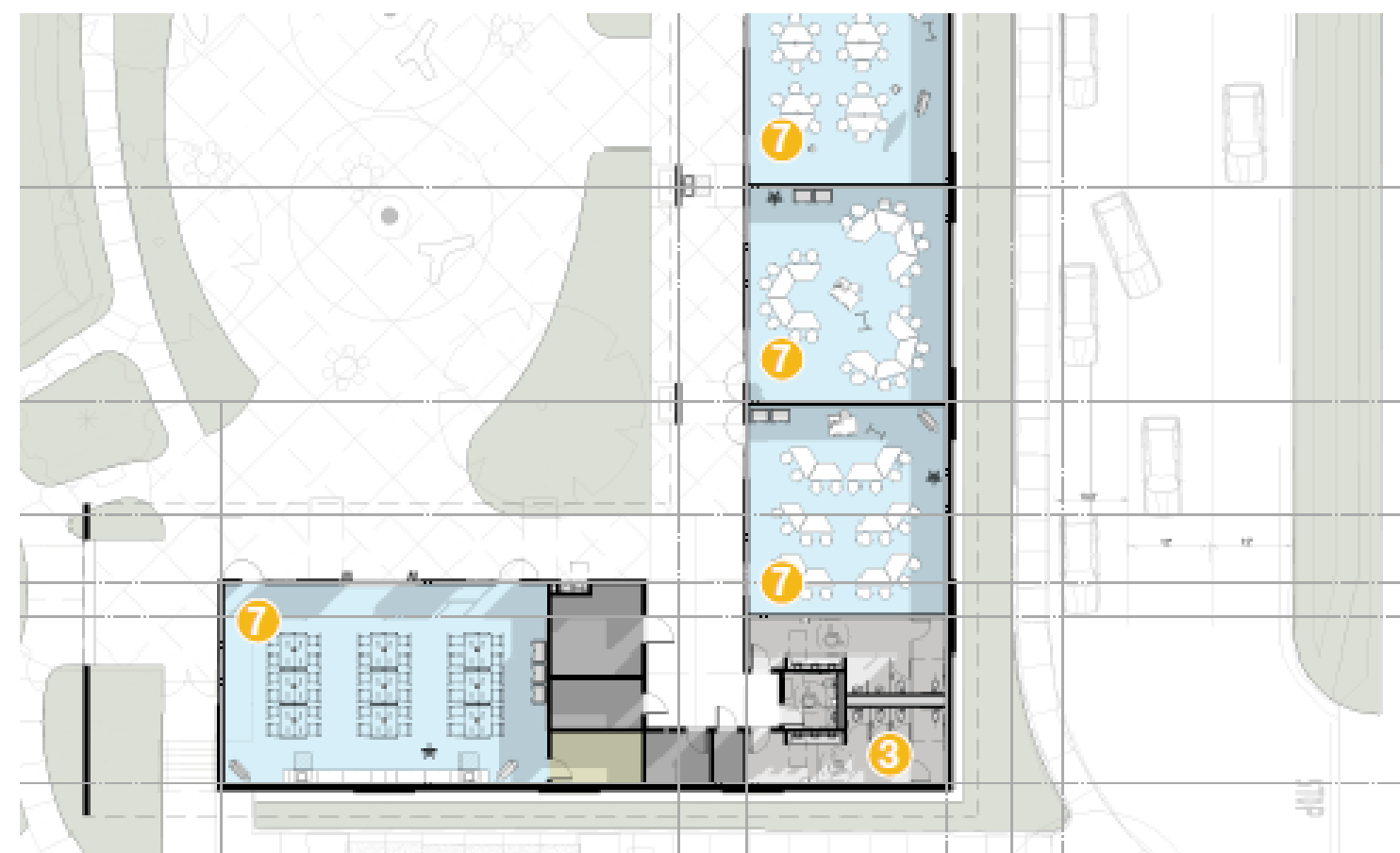
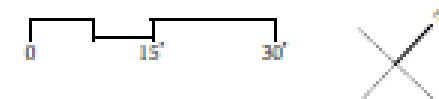

Classroom Floor plan

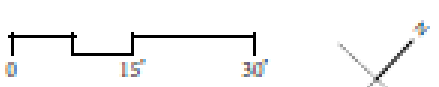

GENERAL LEGEND

- 1 Gymnasium
- 2 Community Foyer
- 3 Restrooms
- 4 Community Storage
- 5 Gym Storage
- 6 Administration Annex
- 7 Classrooms
- 8 STEM Lab.

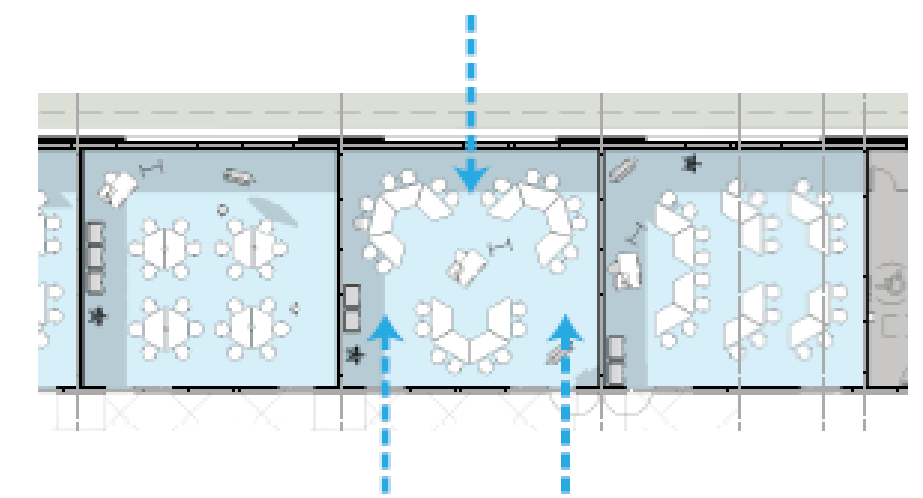

Type A Type B Type C

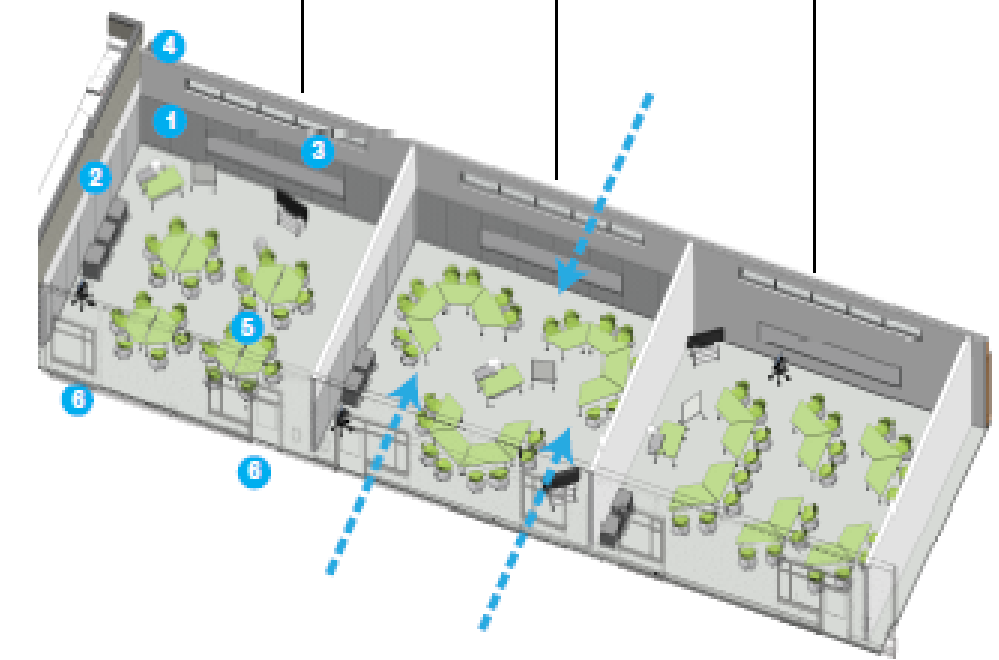

LEGEND

- 1 10' High Tackable Wall Panels
- 2 Portable Storage Units on Casters
- 3 Magnetic Marker Boards
- 4 Clostrory Windows
- 5 Portable Furniture on Casters
- 6 Windows to the Courtyard

Flexible Classroom 3D View

FIESTA GARDENS CAMPUS EXPANSION



FIESTA GARDENS CAMPUS EXPANSION



FIESTA GARDENS CAMPUS EXPANSION



Capital Projects Update

Measure X, T & Additional Sources

October 26th, 2023



Teaching
& Learning