



# UNION ATHLETIC TRAINING

## MEDICAL EMERGENCY ACTION PLAN

**Facility:** UMAC

**Year:** 2020-2021

**Address:** 6836 S Mingo Road, Tulsa 74133

### Emergency Protocol:

- First person to arrive on scene provides initial care.
- Send for AED.
  - ✓ Location: **Arena, north wall/2<sup>nd</sup> floor west wall/on floor during games w/Athletic Trainer**
- Send a coach, manager, or uninjured student-athlete to notify the Athletic Trainer if not on site.
- If the Athletic Trainer cannot be located, the head coach will become the leader.

### Leader:

- This person will be in charge of the emergency and will instruct others on the emergency team accordingly.

### Leader's assistant:

- Will assist the leader in the primary evaluation of the injured athlete.

### Phone caller (a designated adult with access to phone):

- Call EMS (911) and communicate the following information
  - ✓ The nature of injury
  - ✓ Level of consciousness
  - ✓ Age / sex of injured
  - ✓ Caller will not hang up until EMS operator until advised to do so.

### Person to meet EMS:

- Ambulance entrance: **Loading Dock, southeast corner of UMAC**
- Will contact necessary staff to assure full access for ambulance
- Will meet ambulance at the designated entrance and lead to injured athlete

### Person to accompany athlete to hospital:

- Ride with the athlete in the ambulance in the event the parent / guardian cannot be contacted
- Will have athletes physical and emergency information in hand.

**It is the responsibility of the Athletic Trainer to inform Athletic Director of the incident**

**It is the responsibility of the Athletic Trainer or head coach to inform athlete's parent / guardian**

**It is the responsibility of the Athletic Trainer to document incident and all actions taken**

<b>Head Athletic Trainer:</b>	<b>Dan Newman</b>	<b>918-852-2066</b>	
<b>Assistant Athletic Trainer:</b>	<b>Meagan DeShane</b>	<b>918-521-4940</b>	
<b>Assistant Athletic Trainer:</b>	<b>Jacob Newby</b>	<b>918-607-1437</b>	<b>EMS: 911</b>
<b>Athletic Training Facility:</b>	<b>UMAC</b>	<b>918-357-7493</b>	<b>fire, police, or ambulance</b>
<b>Athletic Department:</b>	<b>6836 S Mingo Rd Tulsa, 74133</b>	<b>918-357-7410</b>	

UMAC Arena  
6836 S. Mingo Rd.

UMAC Arena Level  
(ground floor)

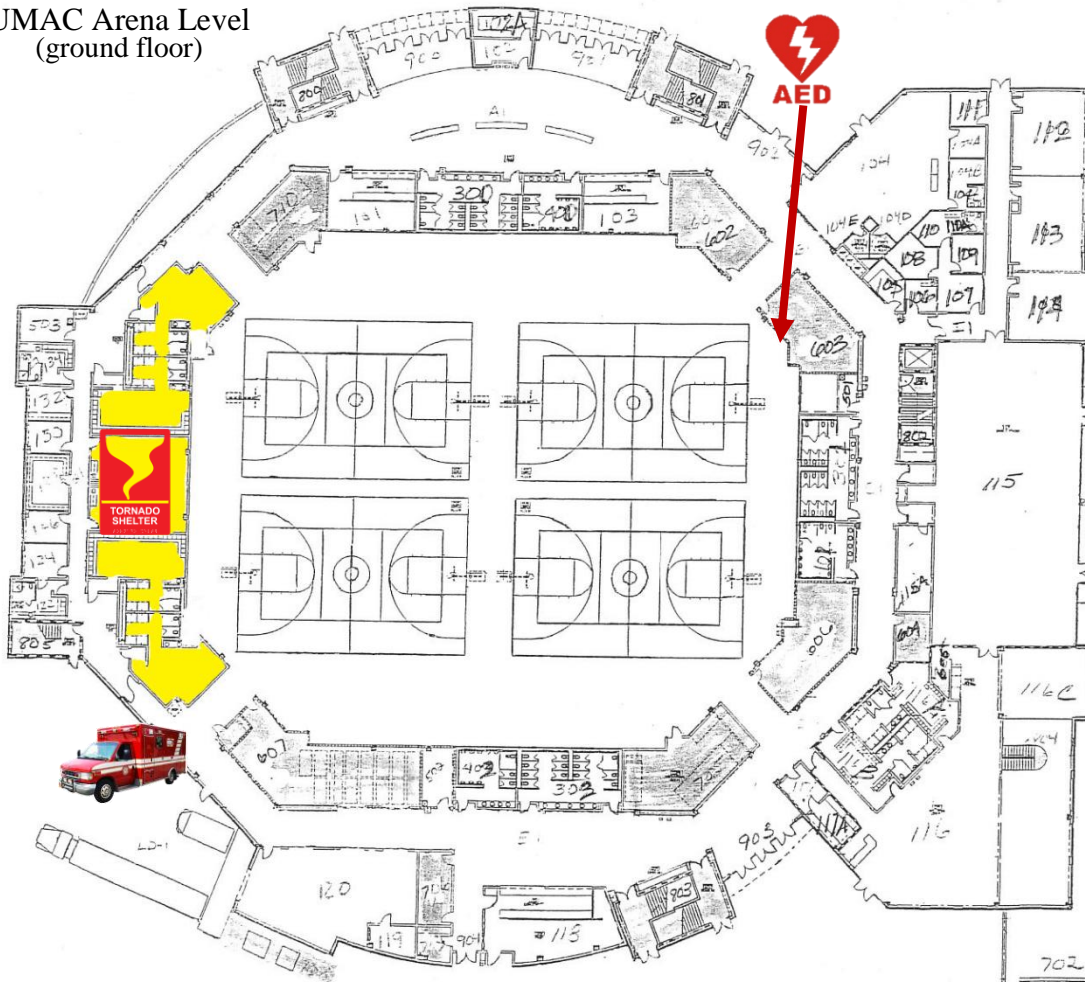

**AED Locations:**

- Arena Level-northwest wall inside arena
- Concourse Level-west wall near concession stand

Ambulance enter via loading dock, southeast corner

Tornado Shelter in highlighted areas

UMAC Field Level

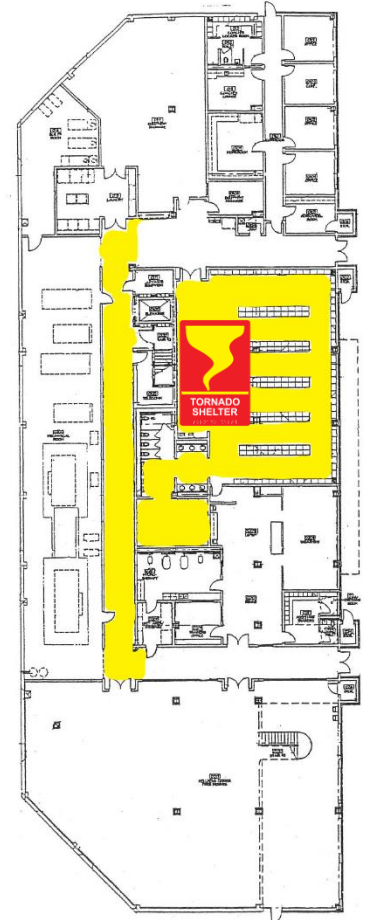

UMAC Concourse Level  
(2nd floor)

