



Career & Technical Education (CTE) Presentation Bond Planning Committee

October 18, 2023

**Presented by: Rachel Behnke,
NBISD Director of Career & Technical Education (CTE)**



[VIDEO: CTE in NBISD](#)

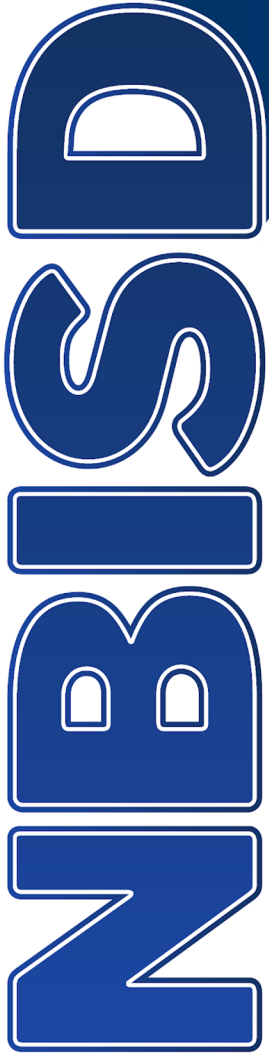

CTE specific requests for information:

What
have we
done?

What
are we
doing?

What is
getting
done now?

What still
needs to
be done?

Partnerships
with CTTC

Workforce
Needs

CTE in
current bond
programs

Updated or
additional Ag
facility



Partnerships with CTTC

- Central Texas Technology Center
 - In 2003, the New Braunfels 4B Economic Development Board and Seguin 4A Economic Development Board worked together to bring the CTTC to the residents of Comal and Guadalupe Counties. The CTTC provides higher education and technical skills training to promote employment opportunities in high-demand occupations in the region.

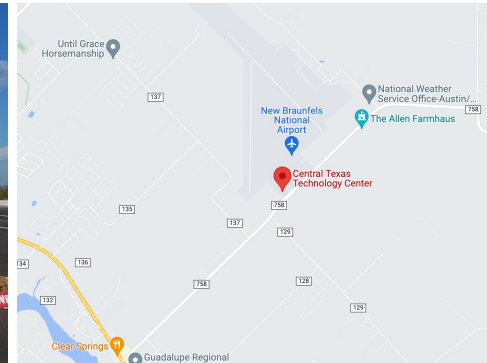



Partnerships with CTTC

Historical information:

- Offered select programs through the Alamo Academy through May of 2021 until Alamo Colleges closed the programs hosted at CTTC due to low enrollment and inability to staff instructor positions
- Lack of drivers is a barrier to providing transportation to programs offered at St. Phillips

New Opportunities:

- Northeast Lakeview College and TSTC TxFAME opened their doors at the CTTC this August and we are working closely with both partners to expand programming



Workforce Needs

- Federal funding requires a Comprehensive Local Needs Assessment for CTE programs every two years; this includes analysis of local labor market information

What Information Should Locals Collect: Labor Market Alignment

What does the law say?

The comprehensive local needs assessment will include a description of how CTE programs offered by the eligible recipient are aligned to State, regional, Tribal, or local in-demand industry sectors or occupations identified by the State workforce development board or local workforce development board, including career pathways, where appropriate. The CLNA may also identify programs designed to meet local education or economic needs not identified by State boards or local workforce development boards.

What does the law mean?

The law requires an analysis of how CTE programs are meeting workforce needs, and provides eligible recipients with multiple ways to demonstrate labor market demand, from a combination of state and local sources.

Workforce Needs

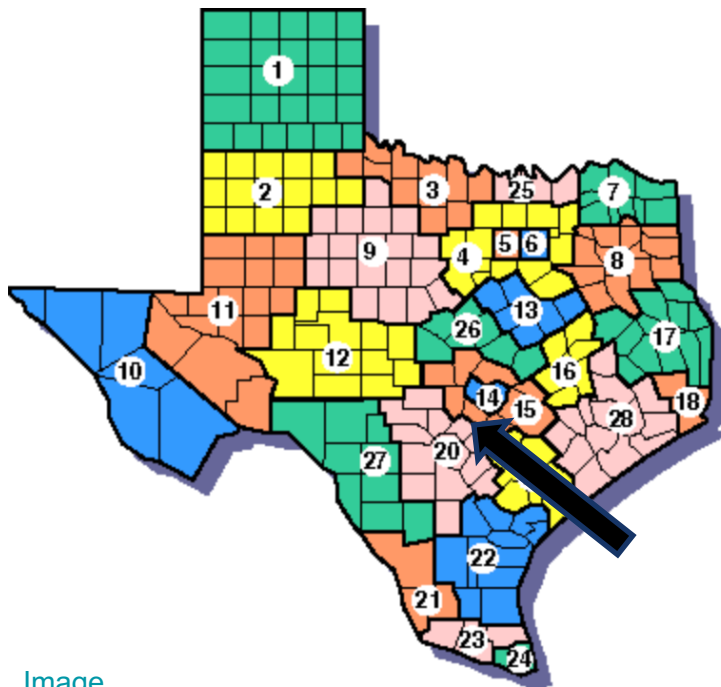

This [Labor Market Information](#) was provided for the Texas Education Agency

Workforce Development Areas relevant to NBISD:

- WDA statewide
- WDA 20 (Alamo)
- WDA 15 (Rural Capital)



Alamo Workforce Development Area (20) Labor Market Information, 2020 - 2030

State Career Cluster ▾	Program of Study ▾	SOC ▾	Occupational Title ▾	Growth Rate ▾	Median Annual Wage ▾	Growth Wage Category ▾	Annual Average Employment 2020 ▾	Annual Average Employment 2030 ▾	Total Annual Opening ▾	Competitive Education Requireme ▾
Health Science	Healthcare Diagnostics	31-9097	Phlebotomists	11%	\$34,421	LOW/LOW	1,187	1,318	158	Recognized Industry Credential
Health Science	Healthcare Diagnostics, Healthcare Therapeutic	29-1292	Dental Hygienists	25%	\$73,644	HIGH/HIGH	1,281	1,599	122	Associate's degree
Health Science	Healthcare Therapeutic	29-1071	Physician Assistants	33%	\$95,685	HIGH/HIGH	716	951	69	Master's degree
Health Science	Healthcare Therapeutic	29-1022	Oral and Maxillofacial Surgeons	28%	\$198,137	HIGH/HIGH	11	14	1	Doctoral or professional
Health Science	Healthcare Therapeutic	19-1041	Epidemiologists	23%	\$80,939	HIGH/HIGH	71	88	7	Doctoral or professional
Health Science	Healthcare Therapeutic	29-1021	Dentists, General	19%	\$140,567	HIGH/HIGH	965	1,152	48	Doctoral or professional
Health Science	Healthcare Therapeutic	29-1223	Psychiatrists	18%	\$211,064	HIGH/HIGH	145	172	7	Doctoral or professional degree
Health Science		31-1131	Nursing Assistants	3%	\$28,481	LOW/LOW	7,611	7,812	964	Recognized Industry Credential



Workforce Needs

- After Labor Market Information Data review and consultation with Advisory Committee members, it was determined:
 - Three of the most aligned CTE programs of study are:
 - Healthcare Therapeutic
 - Information Technology
 - Animal Science
 - Three of the least aligned CTE programs of study are:
 - Early Learning
 - Law Enforcement
 - Digital Communications
 - Areas where there is minimal or no programming and there is a need:
 - Advanced Manufacturing
 - Culinary Arts
 - Architecture/Construction



CTE in current bond program



Long Creek High School

- Adding/replacing CTE classrooms and facilities in the new addition
- Adding Culinary Arts and Industrial Trades (Construction) facilities and programming
- Expanding Advanced Manufacturing space and program offerings



New Braunfels High School

- Replacing all CTE classrooms and facilities



Enrollment by CTE Career Cluster (Grades 8-12)

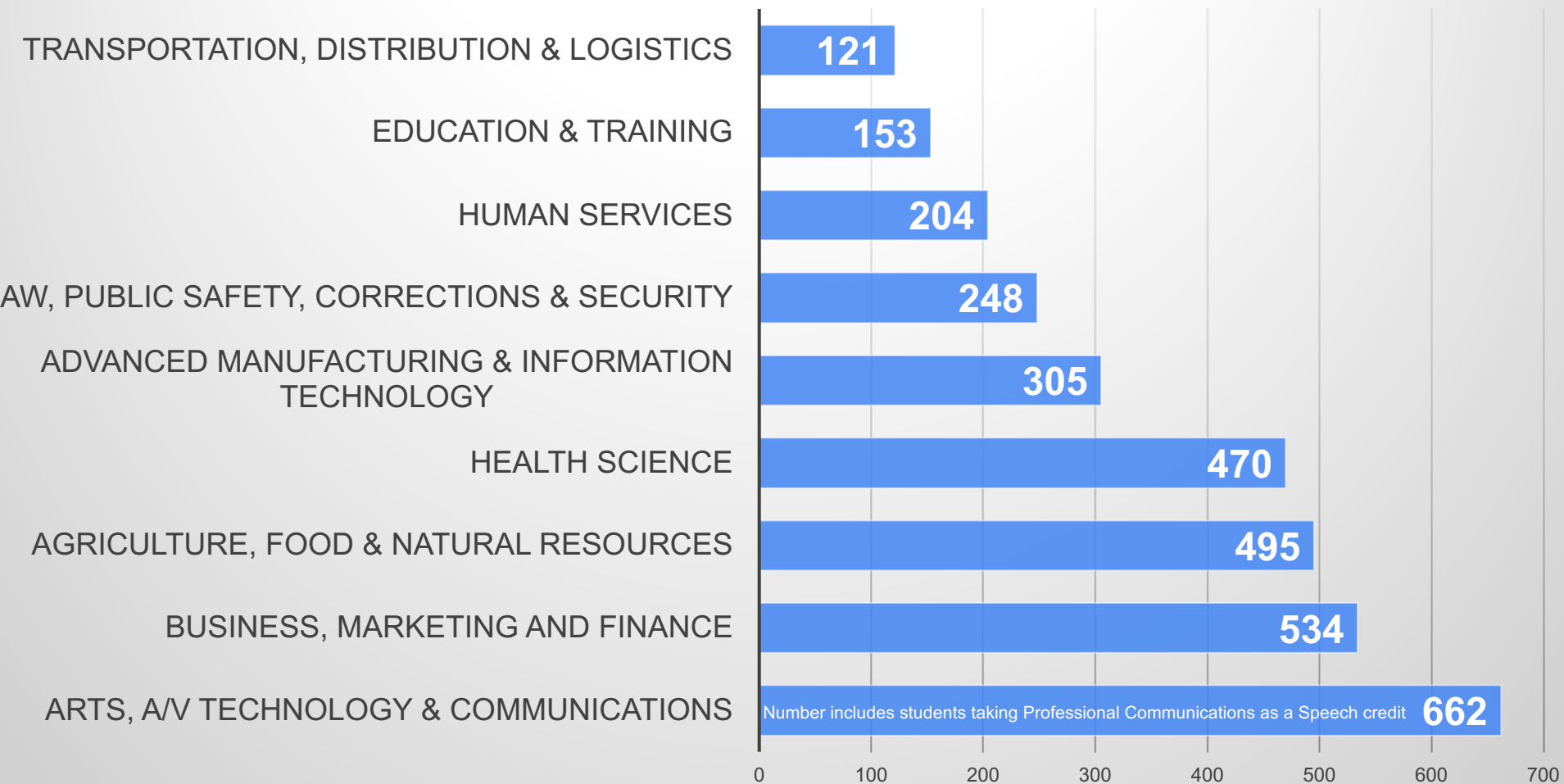



Grades 9-12 Currently Enrolled in CTE (unique students)

Campus	Grade Level	CTE	Total	% CTE
001 NEW BRAUNFELS H S	09	0	1	0.0%
	10	649	749	86.6%
	11	580	638	90.9%
	12	434	565	76.8%
	Total:	1663	1953	85.2%
002 NEW BRAUNFELS H S NINTH GRADE CENTER	09	572	767	74.6%
	Total:	572	767	74.6%
038 THE NBISD LEARNING CENTER	10	0	3	0.0%
	11	13	52	25.0%
	12	11	33	33.3%
	Total:	24	88	27.3%
District Totals	09	572	768	74.5%
	10	649	752	86.3%
	11	593	690	85.9%
	12	445	598	74.4%
	Total:	2259	2808	80.4%

Agricultural Sciences Facility

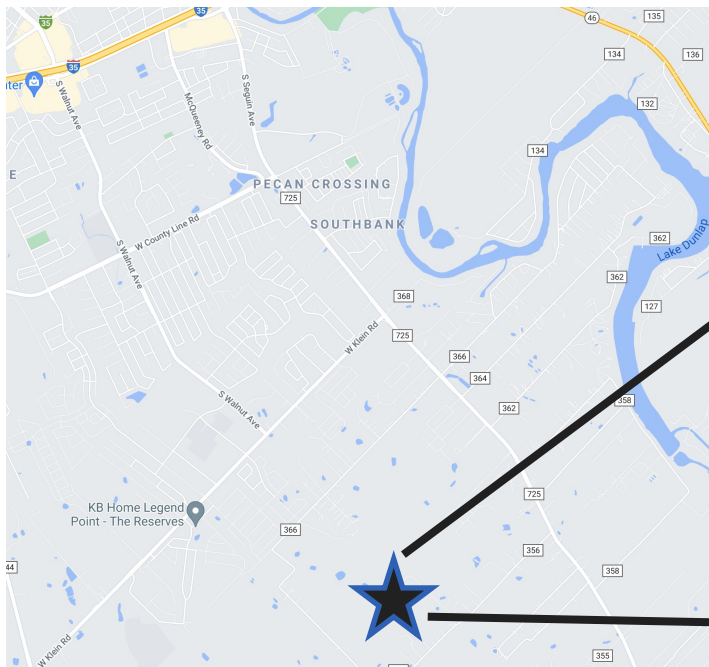



#StrongerTogether





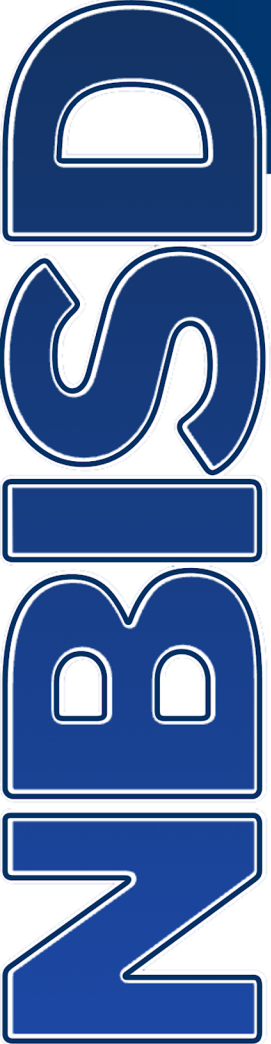

#StrongerTogether



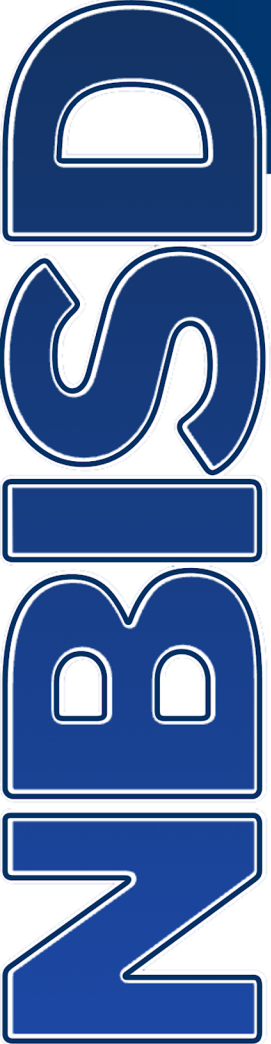

#StrongerTogether





#StrongerTogether



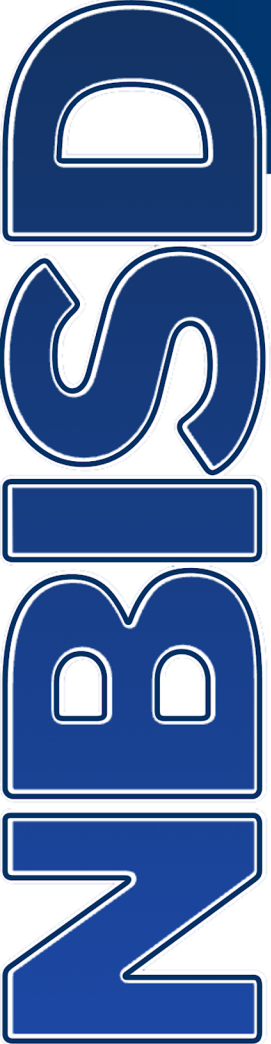



September 2021

October 2023







State Career Cluster ▾	Program of Study ▾	SO ▾	Occupational Title ▾	Growth Rate ▾	Median Annual Wage ▾	Growth Wage Category ▾	Annual Average Employment 2020 ▾	Annual Average Employment 2030 ▾	Total Annual Opening ▾	Competitive Education Requirement ▾
Agriculture, Food, and Natural Resources	Animal Science	29-1131	Veterinarians	22%	\$104,359	HIGH/HIGH	6,339	7,754	370	Doctoral or professional degree
Agriculture, Food, and Natural Resources	Agribusiness, Applied Agricultural Engineering, Plant Science	11-9013	Farmers, Ranchers, and Other Agricultural Managers	8%	\$34,262	LOW/LOW	42,547	45,927	4,886	Bachelor's degree
Agriculture, Food, and Natural Resources		29-2056	Veterinary Technologists and Technicians	18%	\$31,321	HIGH/LOW	12,957	15,263	1,246	Associate's degree

Statewide Labor Market

Agriculture, Food, and Natural Resources	Animal Science	29-1131	Veterinarians	18%	\$107,140	HIGH/HIGH	750	887	40	Doctoral or professional degree
Agriculture, Food, and Natural Resources	Agribusiness, Applied Agricultural Engineering, Plant Science	11-9013	Farmers, Ranchers, and Other Agricultural Managers	10%	\$34,374	LOW/LOW	2,070	2,278	240	Bachelor's degree

Alamo Labor Market

Agriculture, Food, and Natural Resources	Animal Science	29-1131	Veterinarians	19%	\$98,505	LOW/HIGH	303	359	17	Doctoral or professional degree
Agriculture, Food, and Natural Resources	Agribusiness, Applied Agricultural Engineering, Plant Science	11-9013	Farmers, Ranchers, and Other Agricultural Managers	24%	\$34,418	LOW/LOW	1,452	1,800	195	Bachelor's degree

Rural Capital Labor Market



#StrongerTogether

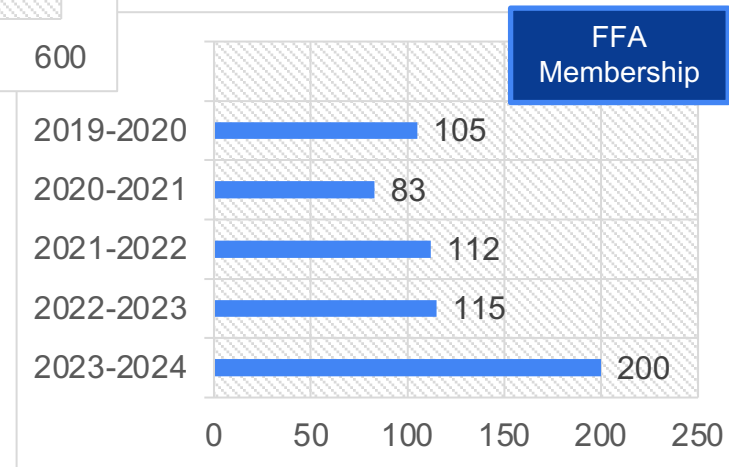
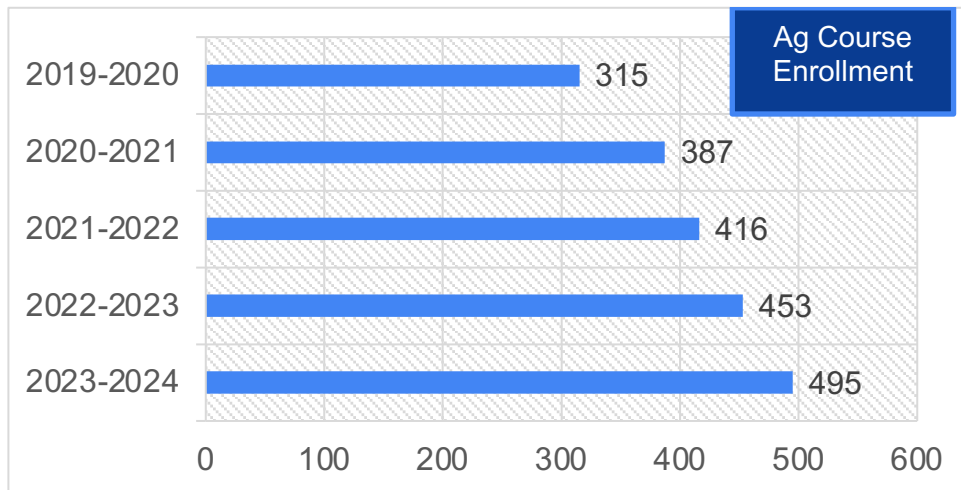



For your consideration

- When the current bond program is complete, all CTE spaces (with the exception of the Ag Facility) will be appropriate and allow for industry-standard instruction; No CTE spaces would need attention in a new bond program
- Options for Ag Facility might include any combination:
 - No action taken at this time
 - Addition of Steer Barn at the current Districtwide Ag Facility
 - Upgrades to current Districtwide Ag Facility
 - Complete overhaul of entire Districtwide Ag Facility
 - Addition of an Ag Facility in the NBHS attendance zone so that there is an Ag Facility on both sides of the district (keeping equitable facilities in mind)
 - Request for more specific information

CTE PREPARES THE
WORKFORCE ACROSS A
WIDE RANGE OF INDUSTRIES
AND OCCUPATIONS.



Agriculture, Food &
Natural Resources

Architecture &
Construction



Arts, A/V Technology &
Communications

Business Management
& Administration



Education & Training

Finance



Government &
Public Administration

Health Science



Hospitality & Tourism

Human Services



Information Technology

Law, Public Safety,
Corrections & Security



Marketing



Science, Technology,
Engineering &
Mathematics (STEM)

Transportation,
Distribution & Logistics





Thank you!

**Presented by: Rachel Behnke,
NBISD Director of Career & Technical Education (CTE)**

rbehnke@nbisd.org

830-626-5677