



K-8 STRATEGIC SOLUTION AND UNIFIED PRIMARY SCHOOL

www.ScarboroughSchoolSolution.org

LOWER SCHOOL ENTRY
PRELIMINARY RENDERING

Watch our video about the school design via the QR Code!



SCHOOL-WITHIN-A-SCHOOL A PROVEN SCARBOROUGH MODEL

Community-Developed Design Statement:
"An intimate community of innovative, flexible, and inspirational learning neighborhoods that fosters inclusivity, collaboration, and hands-on learning."

UNIFIED PRIMARY SCHOOL BUILDING ORGANIZATIONAL DIAGRAM

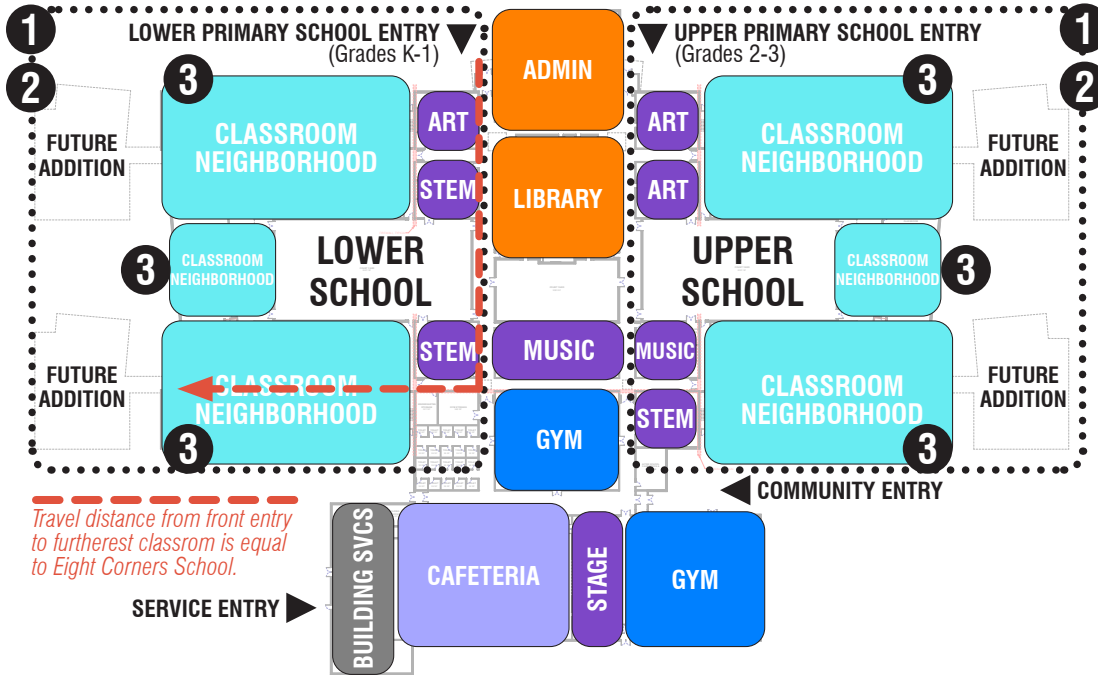

- Guiding Principles for Design:*
- Student-Centered Learning
 - Learning Communities
 - Adaptable/Flexible Learning Spaces
 - School as a Community Resource
 - Outdoor/Nature
 - Connections
 - Sustainability
 - Fiscally Responsible/Operationally Efficient

The "School Within A School" design breaks down the scale of the building into **3 layers of community for students**

- 1** The two-story school is organized into a "Lower School" (Grades K-1 on the left) and an "Upper School" (Grades 2-3 on the right), with flexible spaces running down the spine of the school that can be shared or assigned to each school.
- 2** Within each "school-within-a school," there is **one grade level per floor**. For example, in the "Lower School," Kindergarten is on the first floor and 1st Grade is on the 2nd floor.
- 3** Grade levels are further broken down into 3 "Classroom Neighborhoods," consisting of 3-6 classrooms each, providing an intimate learning community.

REMEMBER TO VOTE NOVEMBER 7TH, 2023!



K-8 STRATEGIC SOLUTION AND UNIFIED PRIMARY SCHOOL

www.ScarboroughSchoolSolution.org

UNIFIED PRIMARY SCHOOL SITE PLAN

Site Plan that supports the School-Within-A-School Model

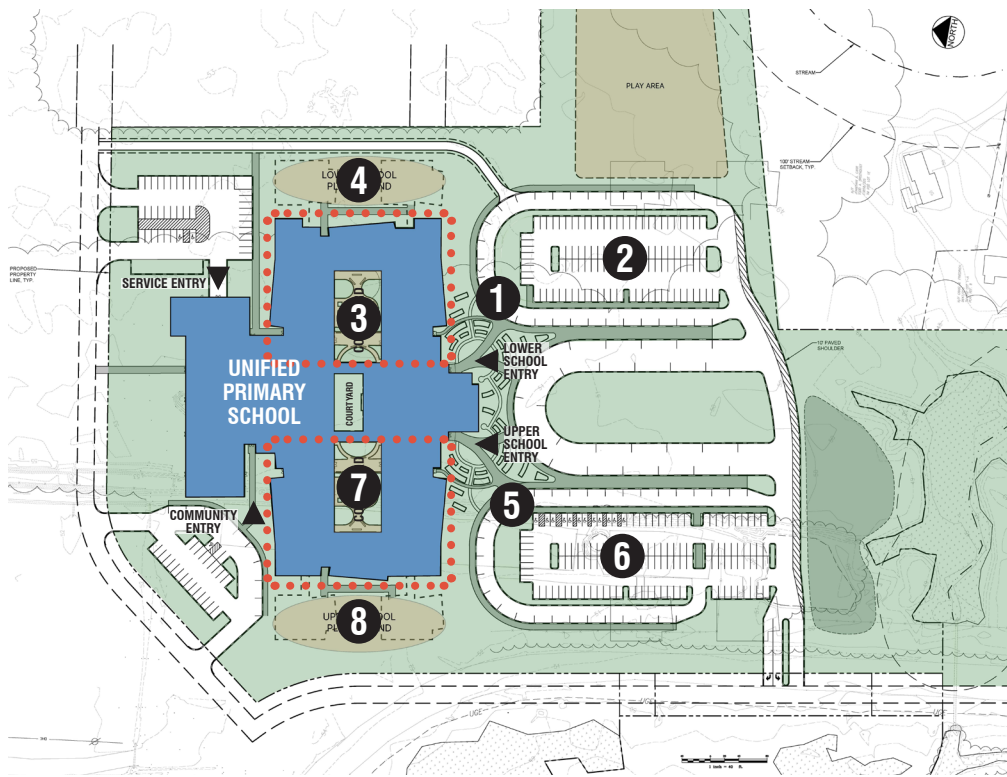

- 1 Lower Primary School (Grades K-1)
- 2 Lower Primary School Parent Drop-off and Parking
- 3 Lower Primary School Secure Outdoor Learning Courtyard
- 4 Lower Primary School Playground
- 5 Upper Primary School (Grades 2-3)
- 6 Upper Primary School Parent Drop-off and Parking
- 7 Upper Primary School Secure Outdoor Learning Courtyard
- 8 Upper Primary School Playground

SIZE OF SCHOOL IS DRIVEN BY PROGRAM NEEDS, NOT “WANTS”

The size of the school was determined by taking inventory of all programs offered, the spaces they need to operate, the projected population through 2033, and how spaces would be scheduled. Many recent schools go beyond the State guidelines in order to accommodate their student-to-teacher ratios, programming needs unique to their district (such as special education), changes in the way education is delivered, and community programs.

NEW BUILDING DESIGN PRIORITIZES SAFETY & SECURITY

Layers of safety and security are embedded throughout the design of the new unified school, addressing concerns within the primary schools.

FUTURE PROOFING

PROVIDING ADEQUATE SPACE FOR TODAY'S & TOMORROW'S LEARNERS

We designed the school to absorb the projected enrollment growth and accommodate future additions if necessary. This was a lesson learned after the Middle School (a State-funded school) was over capacity on the day it opened its doors for the first time, and 20 years later the entire 6th grade resides in portable classrooms.

REMEMBER TO VOTE NOVEMBER 7TH, 2023!