

Facilities, Planning and Construction

October 9, 2023





existing and proposed
site plans

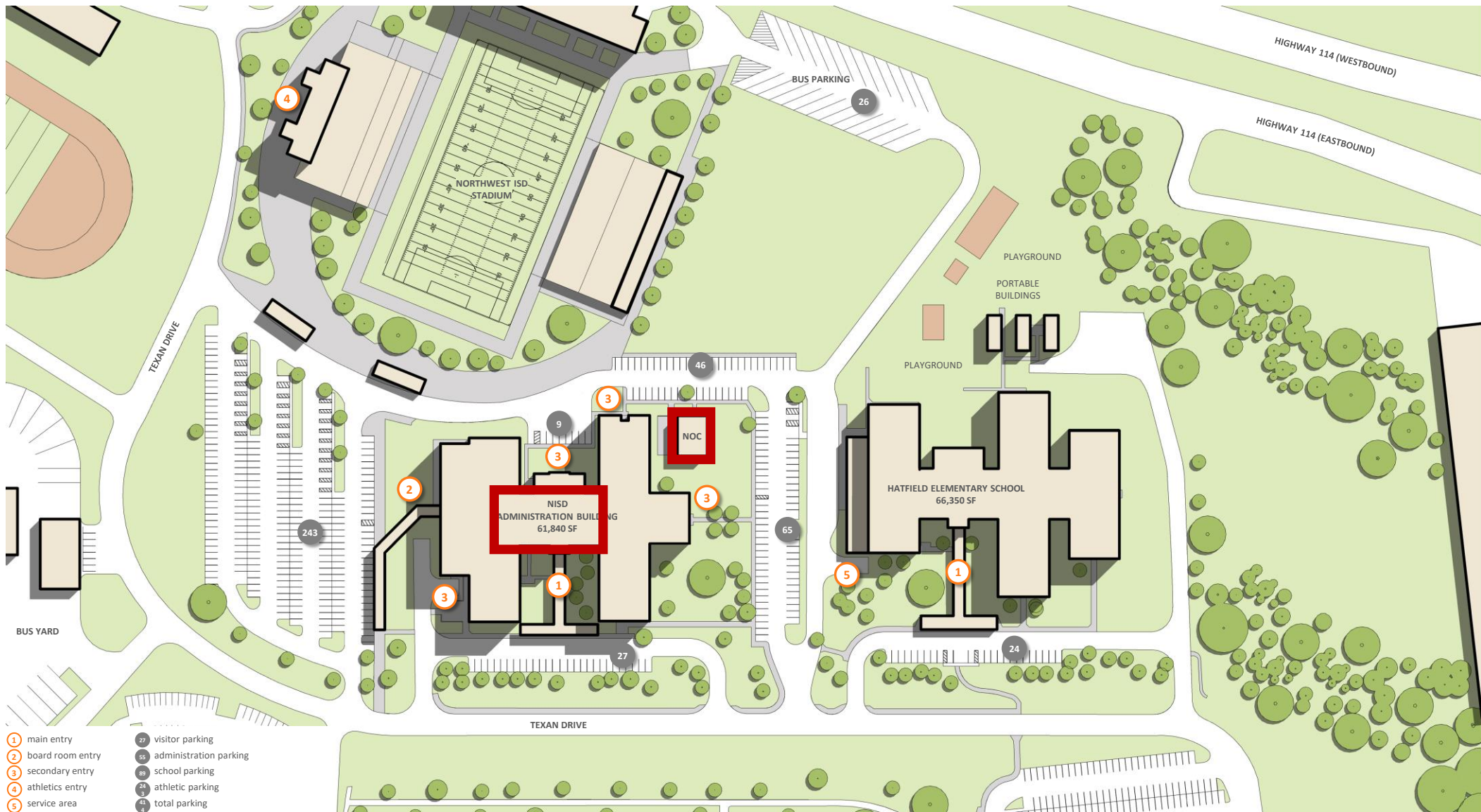

existing site plan

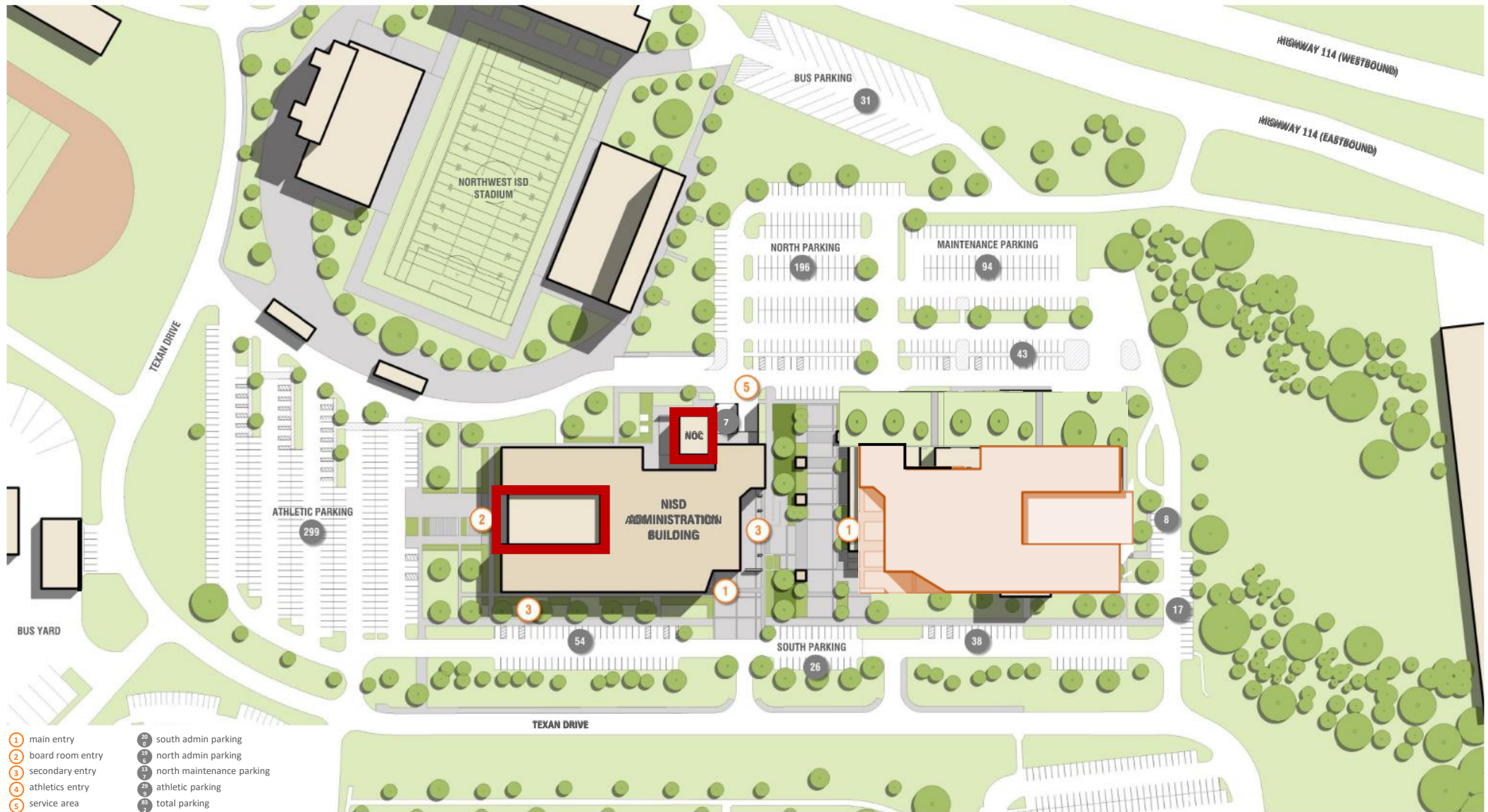

proposed site plan





exterior and interior
rendering



Primary Entry



West Entry



1st Floor Boardroom Entry



Boardroom



Board Conference Room



1st Floor Middle Area



Professional Development Center



2nd Floor above Primary Entry



Entry Area



1st Floor Primary Entry



Questions



Construction Update:

- Northwest HS – Renovations & Additions
- Pike Replacement Middle School
- Perrin Elementary School #23 (no photos)
- Former Hatfield ES Remodel to Temp Admin Bldg (no photos)
- Legacy Learning Center – Parking Lot Expansion (no photos)
- NISD Distribution Center HVAC Renovation (no photos)

Northwest HS – Renovations & Additions



Pike Replacement Middle School



10/03/2023





www.nisdtxconstruction.org

Questions?