

# WJ MURPHY ELEMENTARY SCHOOL

## 2023 SITE IMPROVEMENTS

### ROUND LAKE PARK, ILLINOIS

## STANDARD SYMBOLS

FEATURE	EXISTING	PROPOSED
BUFFALO BOX		
BUSH/SHRUB		
CATCH BASIN		
CLEANOUT		
COMBINE SEWER LINE		
CONTOUR		
CULVERT		
DITCH/SWALE		
ELECTRIC LINE		
ELECTRIC MANHOLE		
FENCE		
FIRE HYDRANT		
FLARED END SECTION		
GAS LINE		
GAS MANHOLE		
GAS VALVE		
INLET		
LIGHT POLE		
OVERHEAD WIRES		
POWER POLE		
R.O.W LINE		
R.O.W MARKER		
SANITARY FORCEMAIN LINE		
SANITARY SEWER LINE		
SANITARY SEWER MANHOLE		
SIGN		
SPOT ELEVATION		
STORM SEWER LINE		
STORM SEWER MANHOLE		
TELEPHONE LINE		
TELEPHONE MANHOLE		
TELEPHONE BOX/PEDESTAL		
TREE-CONIFEROUS (SIZE/TAG#)		
TREE-DECIDUOUS (SIZE/TAG#)		
VALVE BOX		
VALVE VAULT		
WATER VALVE		
WATERMAIN LINE		

EXISTING UTILITIES. WHEN THE PLANS OR SPECIAL PROVISIONS INCLUDE INFORMATION PERTAINING TO THE LOCATION OF UNDERGROUND UTILITY FACILITIES, SUCH INFORMATION REPRESENTS ONLY THE OPINION OF THE ENGINEER AS TO THE LOCATION OF SUCH UTILITIES AND IS ONLY INCLUDED FOR THE CONVENIENCE OF THE BIDDER. THE ENGINEER AND OWNER ASSUME NO RESPONSIBILITY WHATEVER IN RESPECT TO THE SUFFICIENCY OR ACCURACY OF THE INFORMATION SHOWN ON THE PLANS RELATIVE TO THE LOCATION OF UNDERGROUND UTILITY FACILITIES OR THE MANNER IN WHICH THEY ARE TO BE REMOVED OR ADJUSTED. IT SHALL BE THE CONTRACTOR'S RESPONSIBILITY TO DETERMINE THE ACTUAL LOCATION OF ALL SUCH FACILITIES. HE SHALL ALSO OBTAIN FROM THE RESPECTIVE UTILITY COMPANIES, DETAILED INFORMATION RELATIVE TO THE LOCATION OF THEIR FACILITIES AND THE WORKING SCHEDULES OF THE UTILITY COMPANIES FOR REMOVING OR ADJUSTING THEM.

CONTRACTOR IS RESPONSIBLE FOR CONTACTING J.U.L.I.E. AT 1-800-892-0123 AND MUST ACQUIRE A DIG NUMBER A MINIMUM OF 72 HOURS PRIOR TO ANY WORK BEING DONE.

**NOTE: CONSTRUCTION MEANS, METHODS AND JOB SITE SAFETY IS THE SOLE AND EXCLUSIVE RESPONSIBILITY OF THE CONTRACTOR**

**J.U.L.I.E**

JOINT  
UTILITY  
LOCATION  
INFORMATION FOR  
EXCAVATION  
CALL 811



Know what's **below**.  
**Call** before you dig.

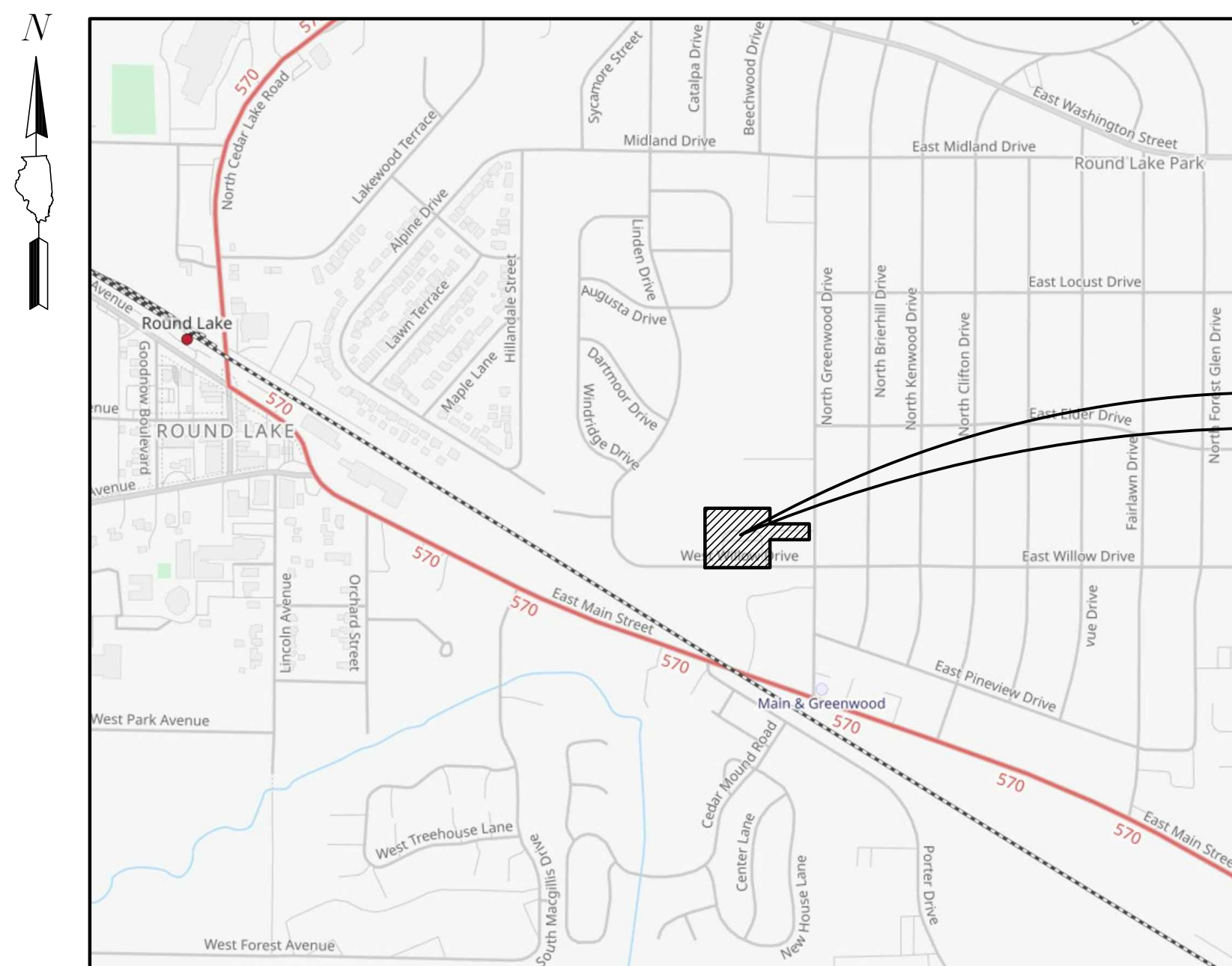

**LOCATION MAP**  
(Not to Scale)

## PROJECT LOCATION

220 NORTH GREENWOOD DRIVE  
ROUND LAKE PARK, ILLINOIS

**TOPOGRAPHIC SURVEY BY.**

JORGENSEN & ASSOCIATES INC.  
120 PARK AVENUE  
LAKE VILLA, ILLINOIS 60046  
TELEPHONE: 847-356-3371

**PROFESSIONAL DESIGN FIRM LICENSE:**

GEWALT HAMILTON ASSOCIATES, INC.  
DESIGN FIRM — LAND SURVEYOR/PROF ENG  
LICENSE NUMBER: 184.000922-0010  
EXPIRES: 4/30/2023

SIGNED: \_\_\_\_\_ P.E.  
GEOFFREY L. PERRY

DATE: \_\_\_\_\_

ILLINOIS LICENSE NO.: 062-060412

EXPIRATION DATE: NOVEMBER 30, 2023

**ISSUED FOR PERMIT**

**GHA GEWALT HAMILTON**  
**ASSOCIATES, INC.**

625 Forest Edge Drive ■ Vernon Hills, IL. 60061  
TEL 847.478.9700 ■ FAX 847.478.9701

COPYRIGHT NOTICE

This drawing is the property of Gewalt-Hamilton Assoc., Inc. and is not to be used for any purpose other than the specific project and site named herein, and cannot be reproduced in any manner without the express written permission from Gewalt-Hamilton Associates, Inc.

# TITLE SHEET

**WJ MURPHY ELEMENTARY SCHOOL  
2022 SITE IMPROVEMENTS  
ROUND LAKE PARK, ILLINOIS**

[illegible]











S:\5903\5903.005 ROUND LAKE AREA SCHOOLS CUSD 118\5903.005 WJ MURPHY 2023 SITE IMPROVEMENTS\5903.005-PR.dwg 1/27/2023 9:16 AM

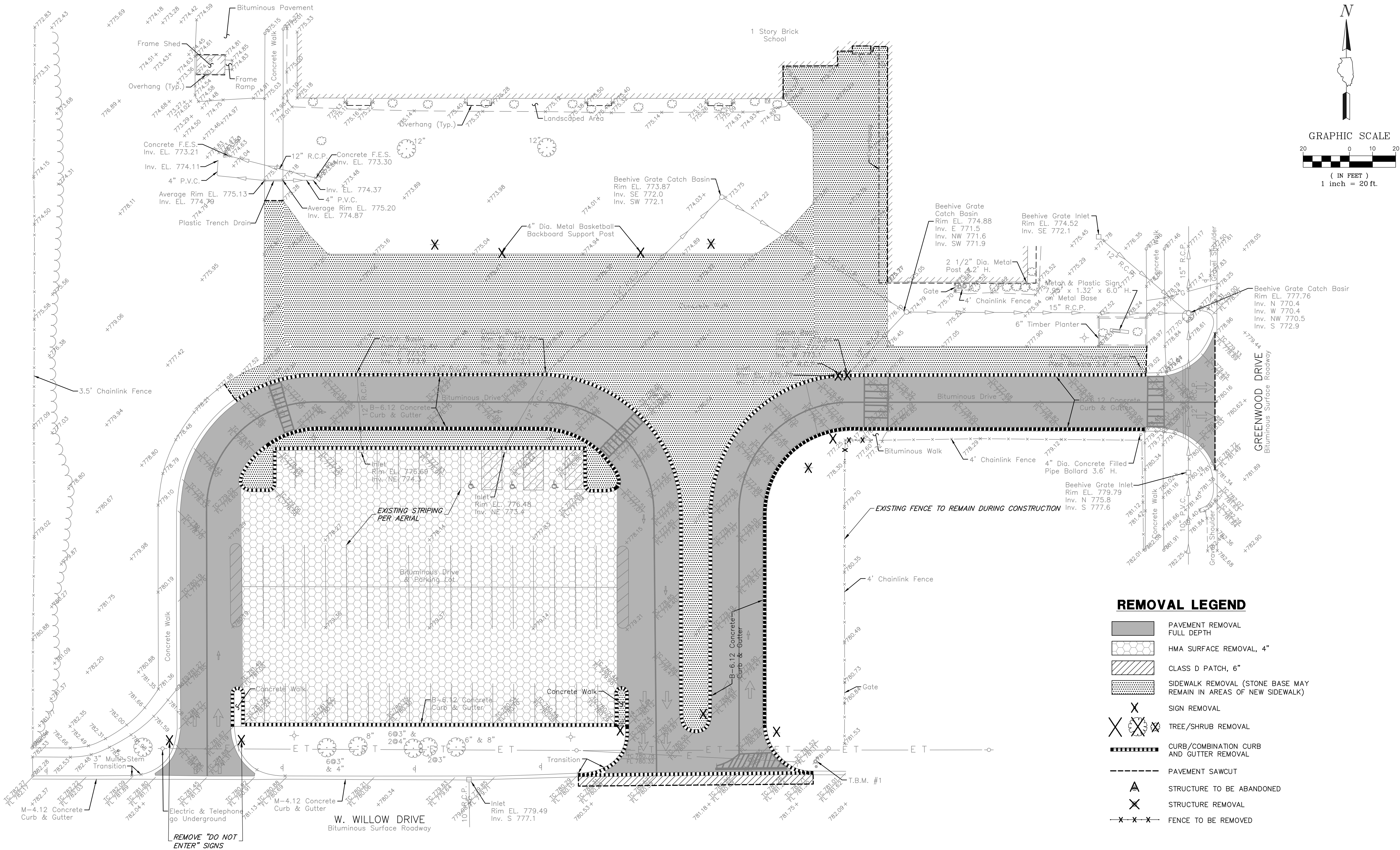

**REMOVAL LEGEND**

- PAVEMENT REMOVAL FULL DEPTH
- HMA SURFACE REMOVAL, 4"
- CLASS D PATCH, 6"
- SIDEWALK REMOVAL (STONE BASE MAY REMAIN IN AREAS OF NEW SIDEWALK)
- SIGN REMOVAL
- TREE/SHRUB REMOVAL
- CURB/COMBINATION CURB AND GUTTER REMOVAL
- PAVEMENT SAWCUT
- STRUCTURE TO BE ABANDONED
- STRUCTURE REMOVAL
- FENCE TO BE REMOVED

**GHA GEWALT HAMILTON ASSOCIATES, INC.**  
625 Forest Edge Drive ■ Vernon Hills, IL. 60061  
TEL 847.478.9700 ■ FAX 847.478.9701

**COPYRIGHT NOTICE**  
This drawing is the property of Gewalt-Hamilton Assoc., Inc. and is not to be used for any purpose other than the specific project and site named herein, and cannot be reproduced in any manner without the express written permission from Gewalt-Hamilton Associates, Inc.

**EXISTING CONDITIONS/DEMOLITION PLAN**

**WJ MURPHY ELEMENTARY SCHOOL**  
**2023 SITE IMPROVEMENTS**  
**ROUND LAKE PARK, ILLINOIS**

NO.	BY	DATE	REVISION

FILE: 5903.005-PR.dwg	
DRAWN BY: JRF	GHA PROJECT #
DATE: 1.11.23	5903.005
CHECKED BY: GLP	SCALE: 1"=20'
DATE: 1.11.23	

SHEET NUMBER:  
**4**  
OF 10 SHEETS



S:\5903\5903.005-PR.dwg 1/27/2023 9:16 AM 1/27/2023 9:16 AM WJ MURPHY 2023 SITE IMPROVEMENTS\5903.005-PR.dwg

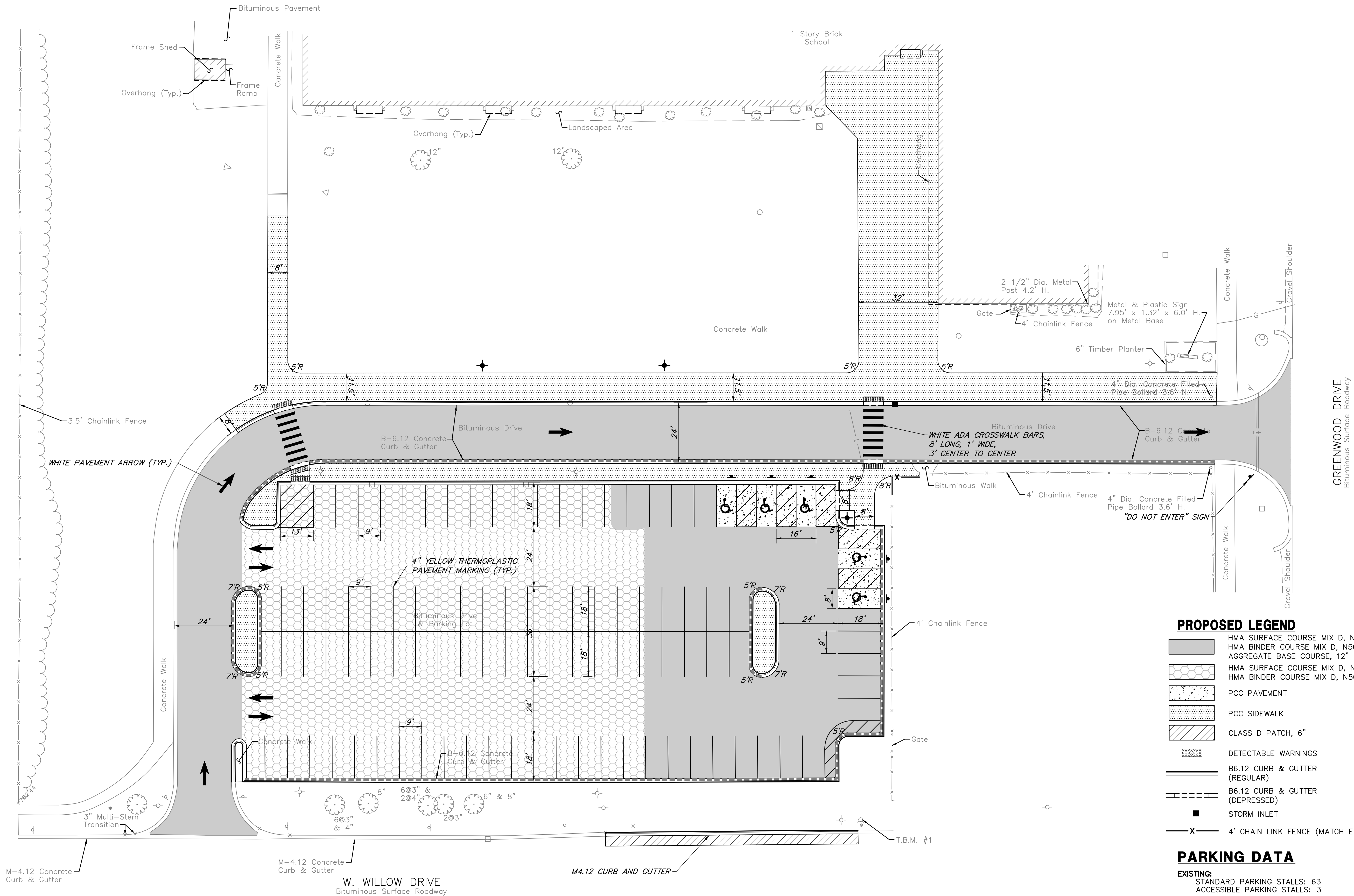
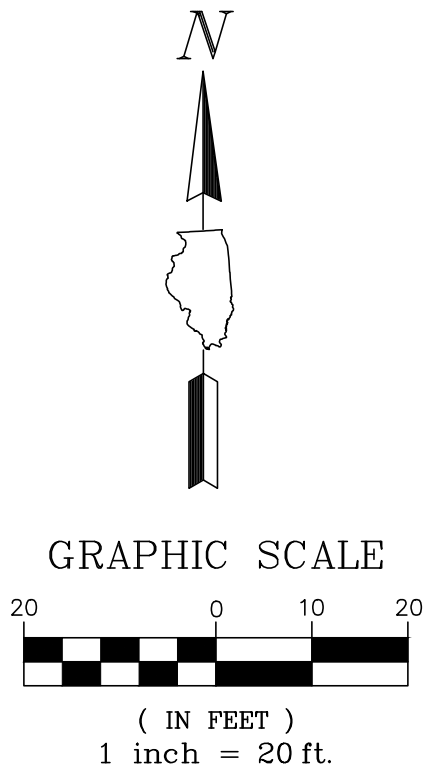

#### PROPOSED LEGEND

- HMA SURFACE COURSE MIX D, N50, 1.75"
- HMA BINDER COURSE MIX D, N50, 3.25"
- AGGREGATE BASE COURSE, 12"
- HMA SURFACE COURSE MIX D, N50, 1.75"
- HMA BINDER COURSE MIX D, N50, 2.25"
- PCC PAVEMENT
- PCC SIDEWALK
- CLASS D PATCH, 6"
- DETECTABLE WARNINGS
- B6.12 CURB & GUTTER (REGULAR)
- B6.12 CURB & GUTTER (DEPRESSED)
- STORM INLET
- 4' CHAIN LINK FENCE (MATCH EXISTING)

#### PARKING DATA

- EXISTING:**
- STANDARD PARKING STALLS: 63
  - ACCESSIBLE PARKING STALLS: 3
- PROPOSED:**
- STANDARD PARKING STALLS: 94
  - ACCESSIBLE PARKING STALLS: 5
- REQUIRED:**
- ACCESSIBLE PARKING STALLS: 4

**GHA GEWALT HAMILTON ASSOCIATES, INC.**

625 Forest Edge Drive ■ Vernon Hills, IL. 60061  
TEL 847.478.9700 ■ FAX 847.478.9701

**COPYRIGHT NOTICE**

This drawing is the property of Gewalt-Hamilton Assoc., Inc. and is not to be used for any purpose other than the specific project and site named herein, and cannot be reproduced in any manner without the express written permission from Gewalt-Hamilton Associates, Inc.

### GEOMETRIC PLAN

#### WJ MURPHY ELEMENTARY SCHOOL 2023 SITE IMPROVEMENTS ROUND LAKE PARK, ILLINOIS

										FILE: 5903.005-PR.dwg		SHEET NUMBER:  <b>5</b>  OF 10 SHEETS				
										DRAWN BY: JRF	GHA PROJECT #					
										DATE: 1.11.23	5903.005					
										CHECKED BY: GLP	SCALE:					
NO.	BY	DATE	REVISION							NO.	BY	DATE	REVISION		DATE: 1.11.23	1"=20'



S:\5903\5903.005 ROUND LAKE AREA SCHOOLS CUSD 118\5903.005 WJ MURPHY 2023 SITE IMPROVEMENTS\5903.005-PR.dwg 1/27/2023 9:16 AM

**GRADING AND UTILITY PLAN**  
**WJ MURPHY ELEMENTARY SCHOOL**  
**2023 SITE IMPROVEMENTS**  
**ROUND LAKE PARK, ILLINOIS**

										FILE: 5903.005--PR.dwg		SHEET NUMBER:  <b>6</b>  OF 10 SHEETS		
										DRAWN BY: JRF			GHA PROJECT # 5903.005	
										DATE: 1.11.23				
										CHECKED BY: GLP			SCALE: 1"=20'	
										DATE: 1.11.23				
NO.	BY	DATE	REVISION							NO.	BY	DATE	REVISION	



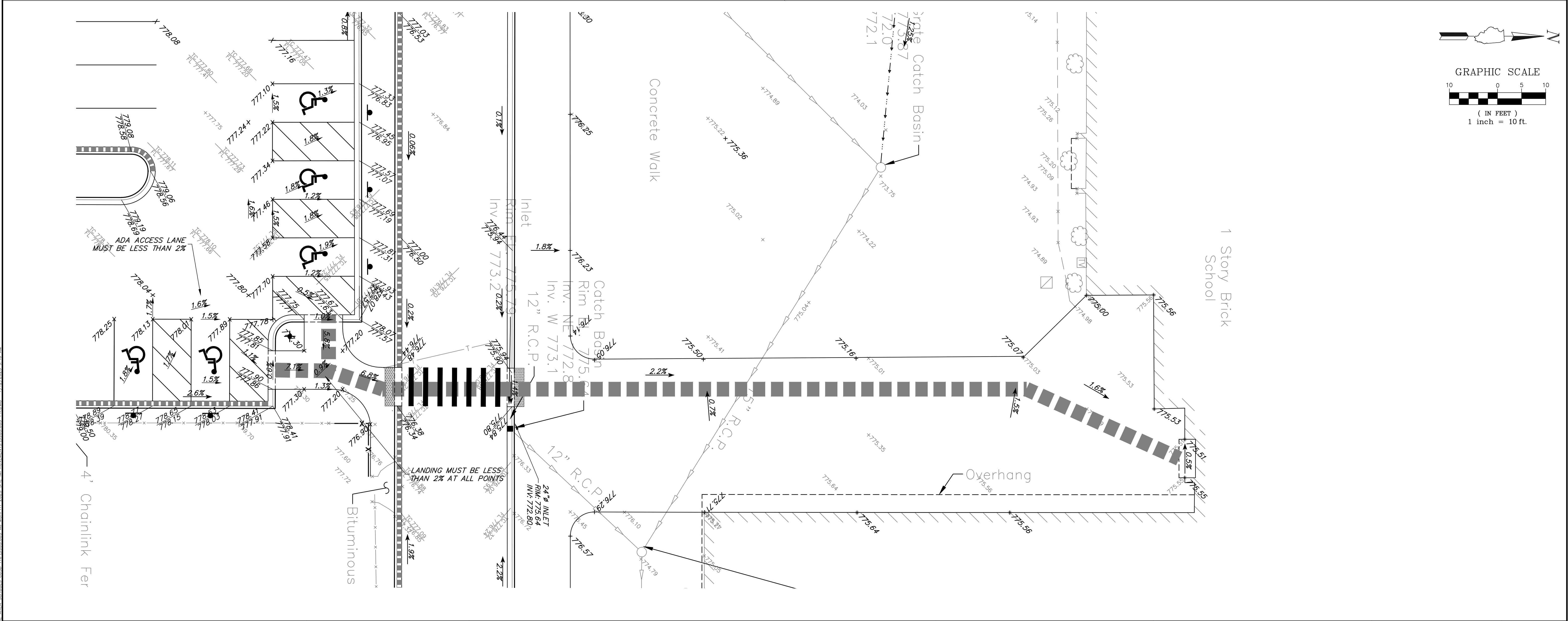
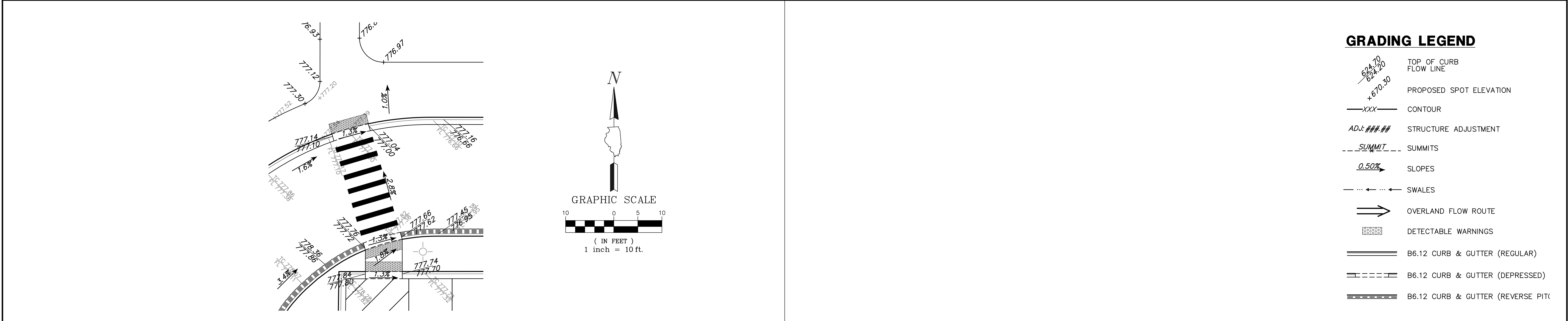

**GEWALT HAMILTON ASSOCIATES, INC.**  
625 Forest Edge Drive ■ Vernon Hills, IL. 60061  
TEL 847.478.9700 ■ FAX 847.478.9701

COPYRIGHT NOTICE

This drawing is the property of Gewalt-Hamilton Assoc., Inc. and is not to be used for any purpose other than the specific project and site named herein, and cannot be reproduced in any manner without the express written permission from Gewalt-Hamilton Associates, Inc.

## ADA GRADING PLAN

### WJ MURPHY ELEMENTARY SCHOOL 2023 SITE IMPROVEMENTS ROUND LAKE PARK, ILLINOIS

NO.	BY	DATE	REVISION

NO.	BY	DATE	REVISION

FILE: 5903.005-PR.dwg

DRAWN BY: JRF	GHA PROJECT #
DATE: 1.11.23	5903.005

CHECKED BY: GLP	SCALE:
DATE: 1.11.23	1"=10'

SHEET NUMBER:

# 7

OF 10 SHEETS



S:\5903\5903.005-ROUND LAKE AREA SCHOOLS.CU5D-118\5903.005-WJ MURPHY 2023 SITE IMPROVEMENTS\5903.005-PR.DWG 1/27/2023 9:16 AM

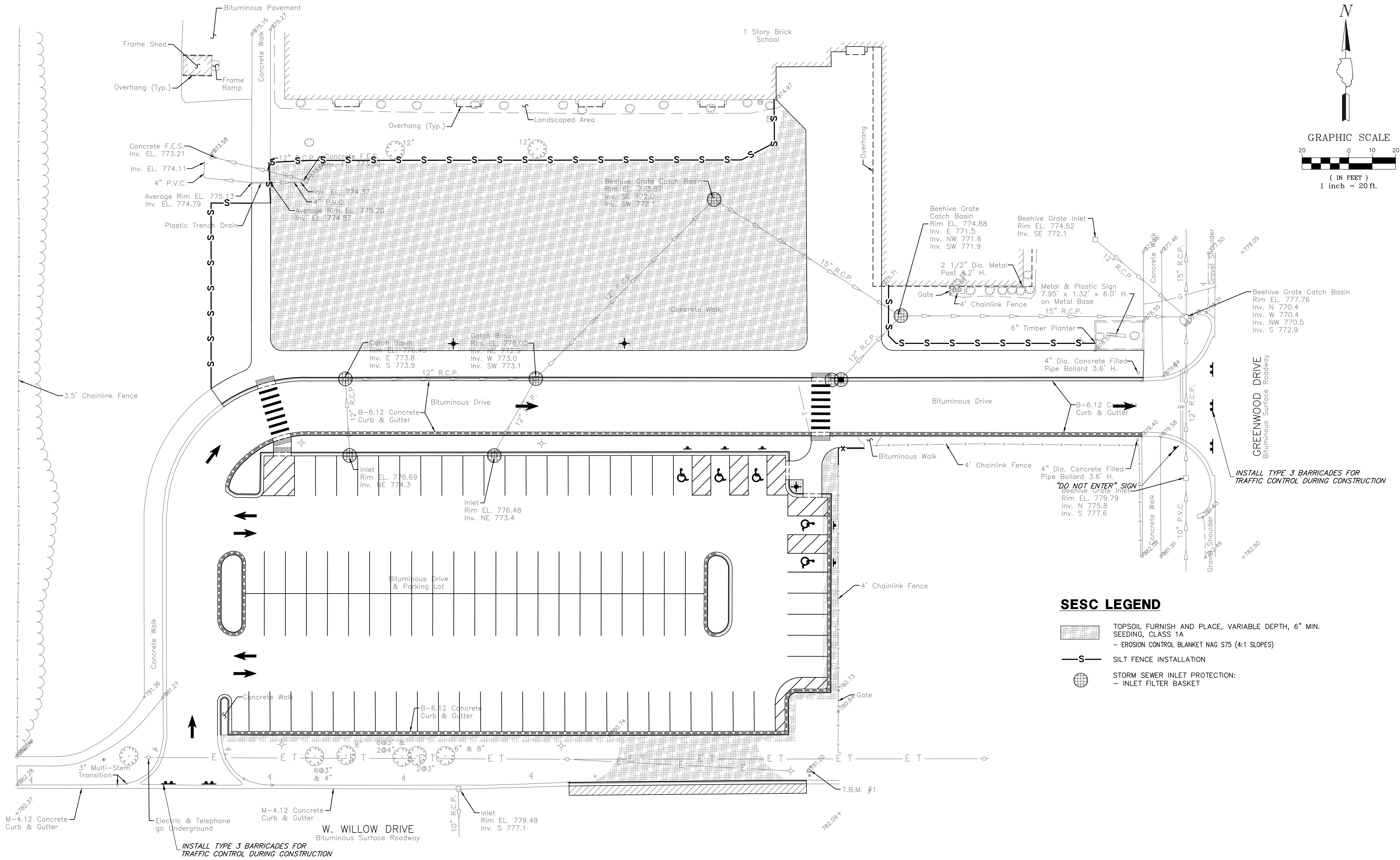
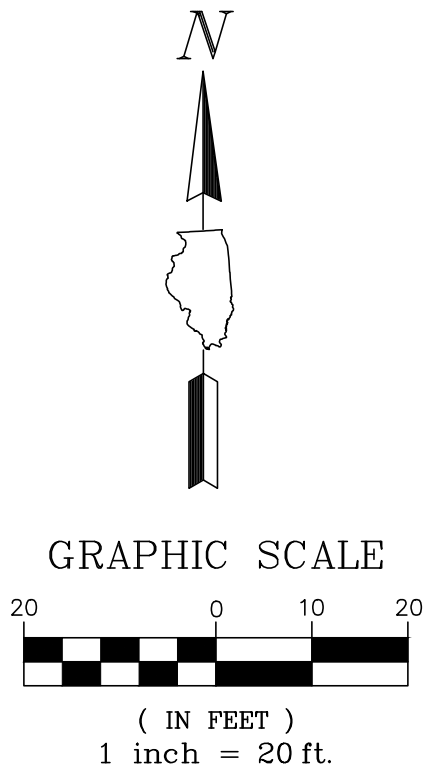

**SESC LEGEND**

- TOPSOIL FURNISH AND PLACE, VARIABLE DEPTH, 6" MIN.
- SEEDING, CLASS 1A
- EROSION CONTROL BLANKET NAG S75 (4:1 SLOPES)
- SILT FENCE INSTALLATION
- STORM SEWER INLET PROTECTION:
  - INLET FILTER BASKET

**GHA GEWALT HAMILTON ASSOCIATES, INC.**  
625 Forest Edge Drive ■ Vernon Hills, IL. 60061  
TEL 847.478.9700 ■ FAX 847.478.9701

**COPYRIGHT NOTICE**  
This drawing is the property of Gewalt-Hamilton Assoc., Inc. and is not to be used for any purpose other than the specific project and site named herein, and cannot be reproduced in any manner without the express written permission from Gewalt-Hamilton Associates, Inc.

**SOIL EROSION & SEDIMENT CONTROL PLAN**

**WJ MURPHY ELEMENTARY SCHOOL**  
**2023 SITE IMPROVEMENTS**  
**ROUND LAKE PARK, ILLINOIS**

NO.	BY	DATE	REVISION	NO.	BY	DATE	REVISION

FILE: 5903.005-PR.dwg	GHA PROJECT #
DRAWN BY: JRF	5903.005
DATE: 1.11.23	
CHECKED BY: GLP	SCALE: 1"=20'
DATE: 1.11.23	

SHEET NUMBER:  
**8**  
OF 10 SHEETS



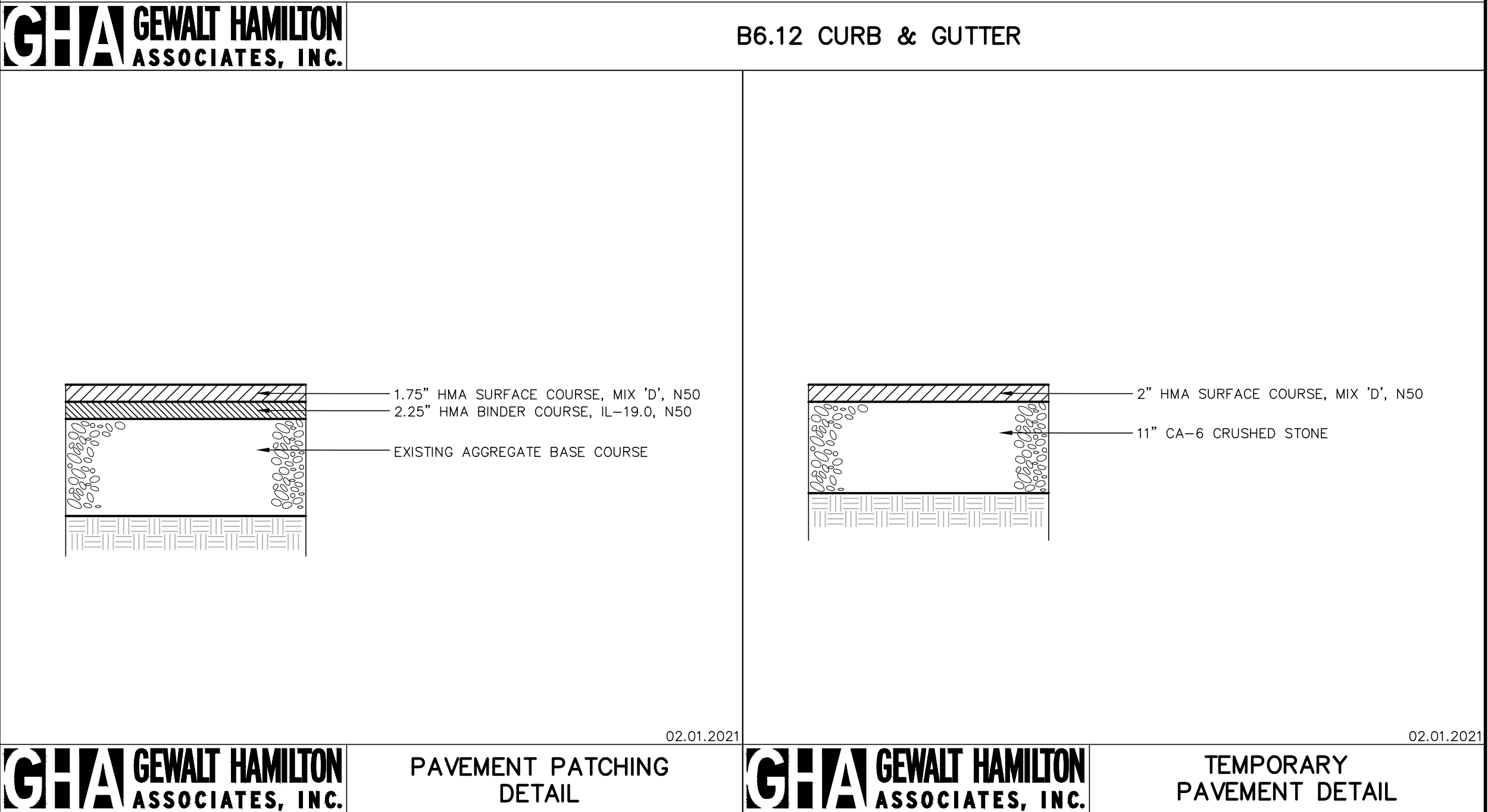
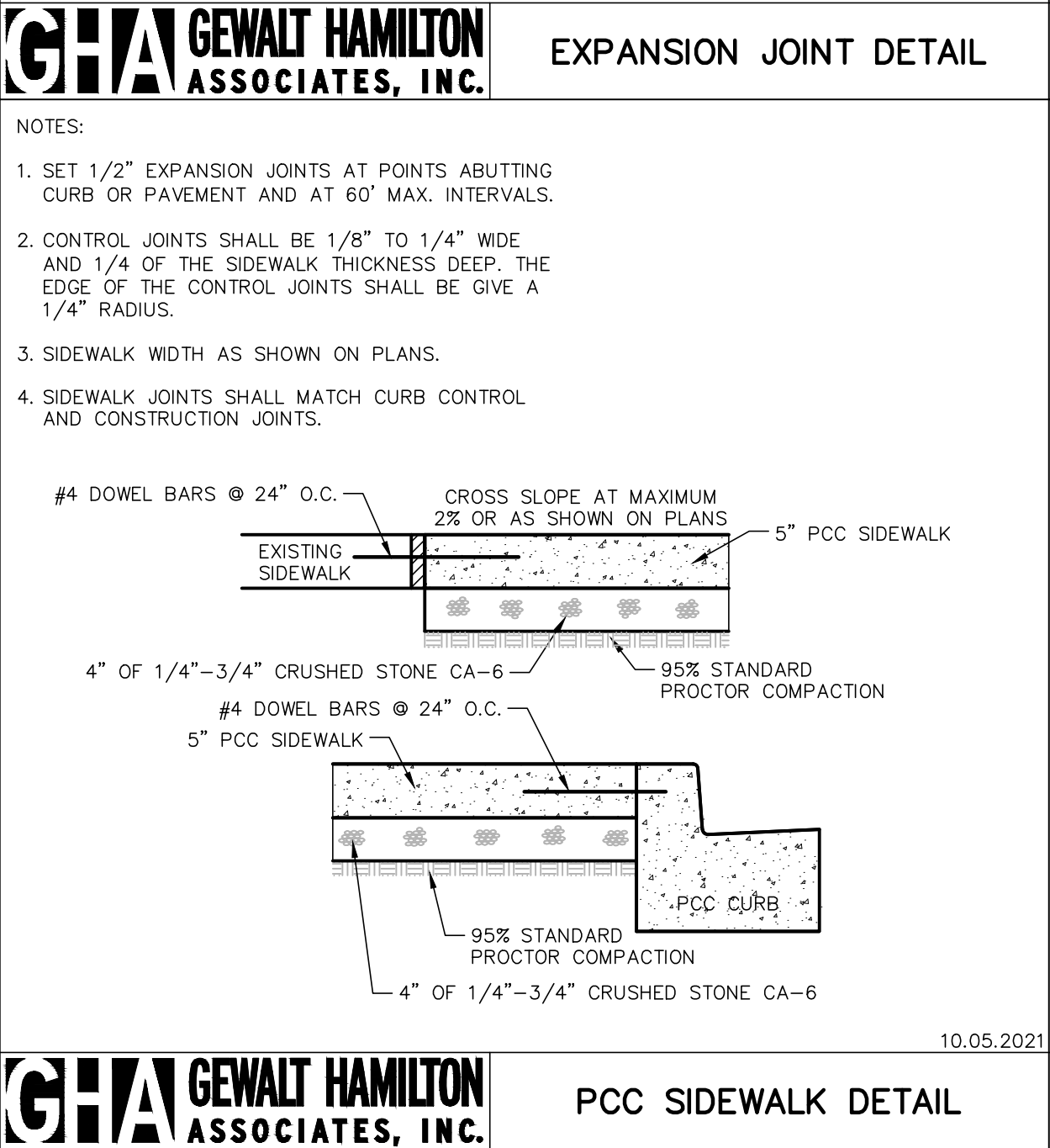
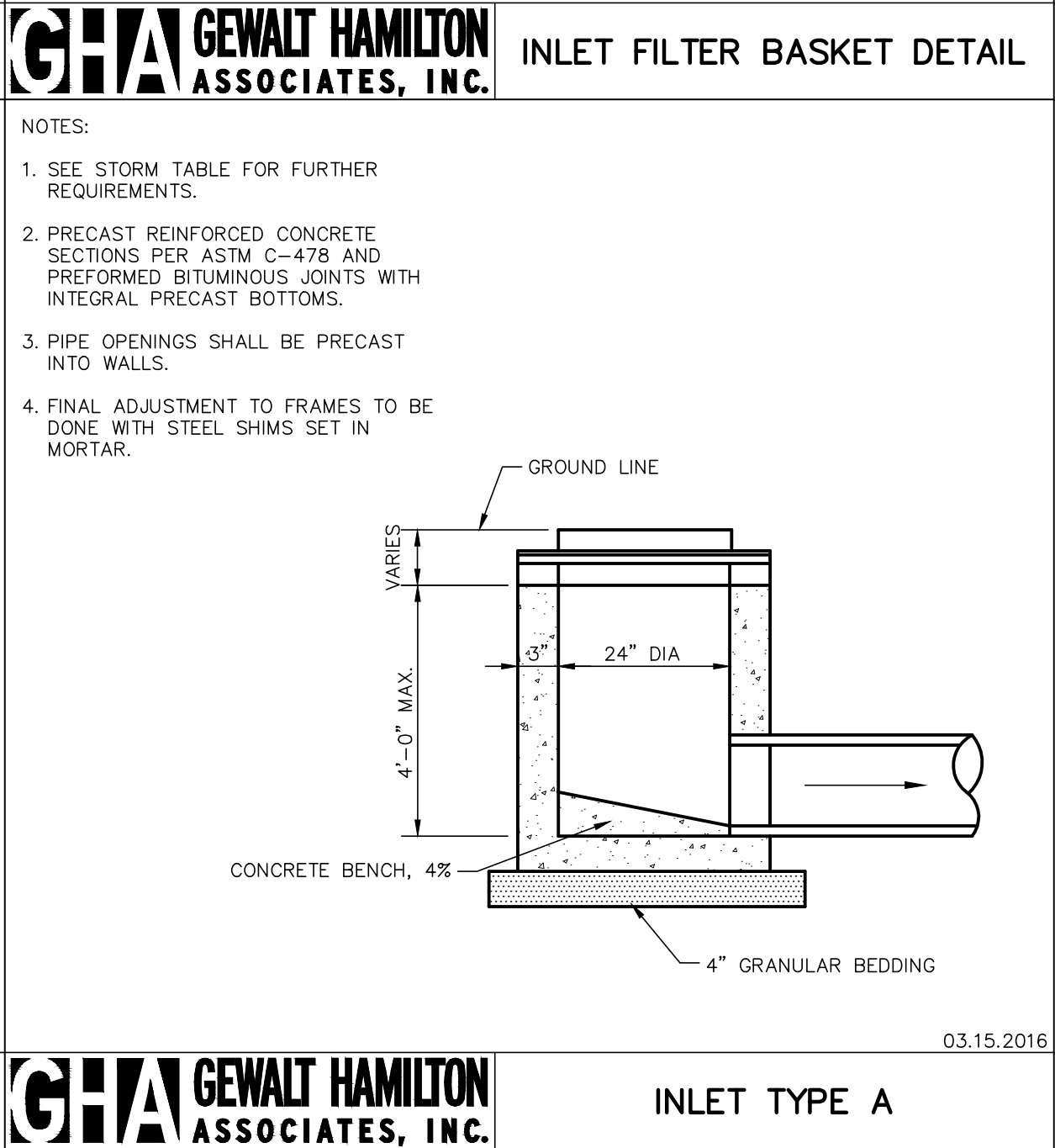
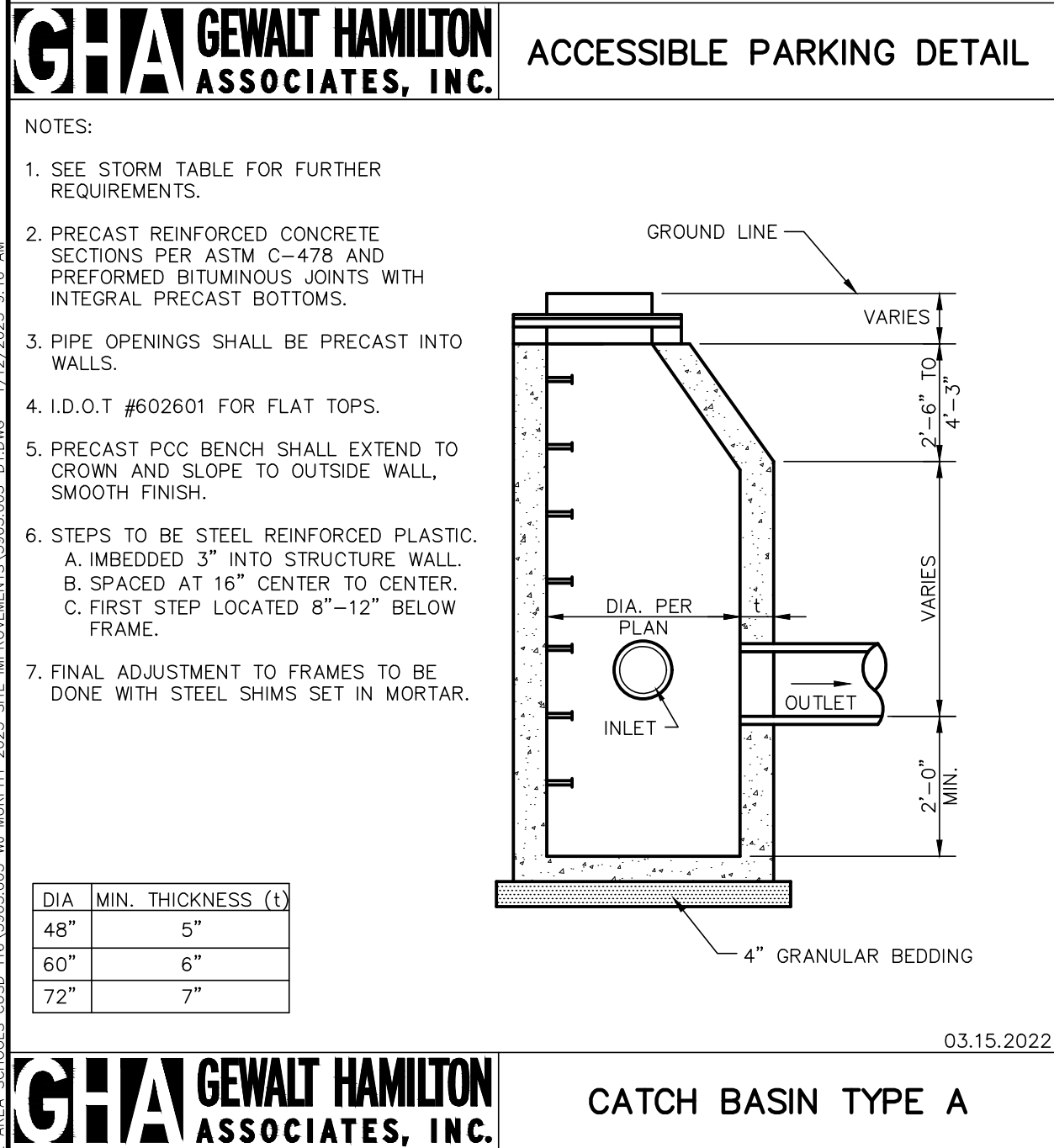
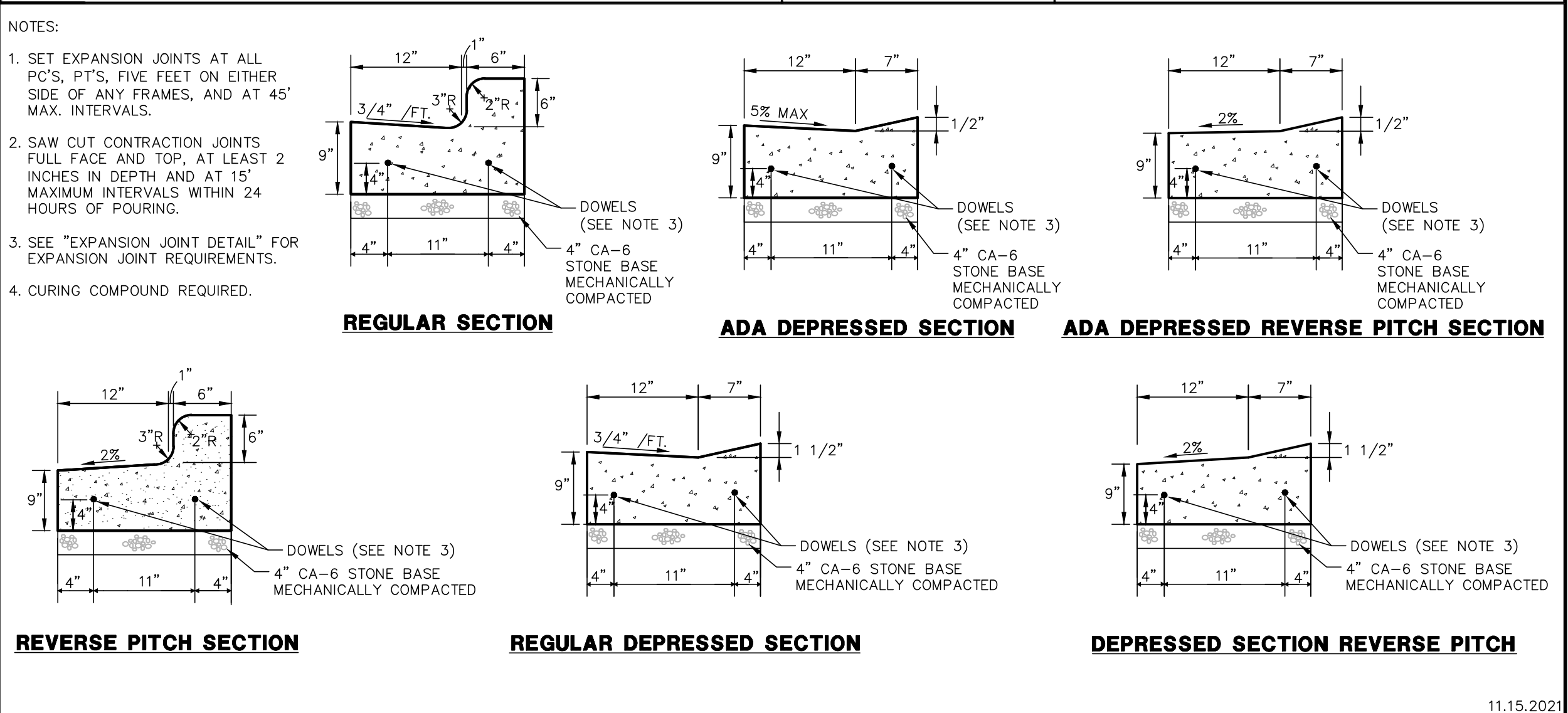
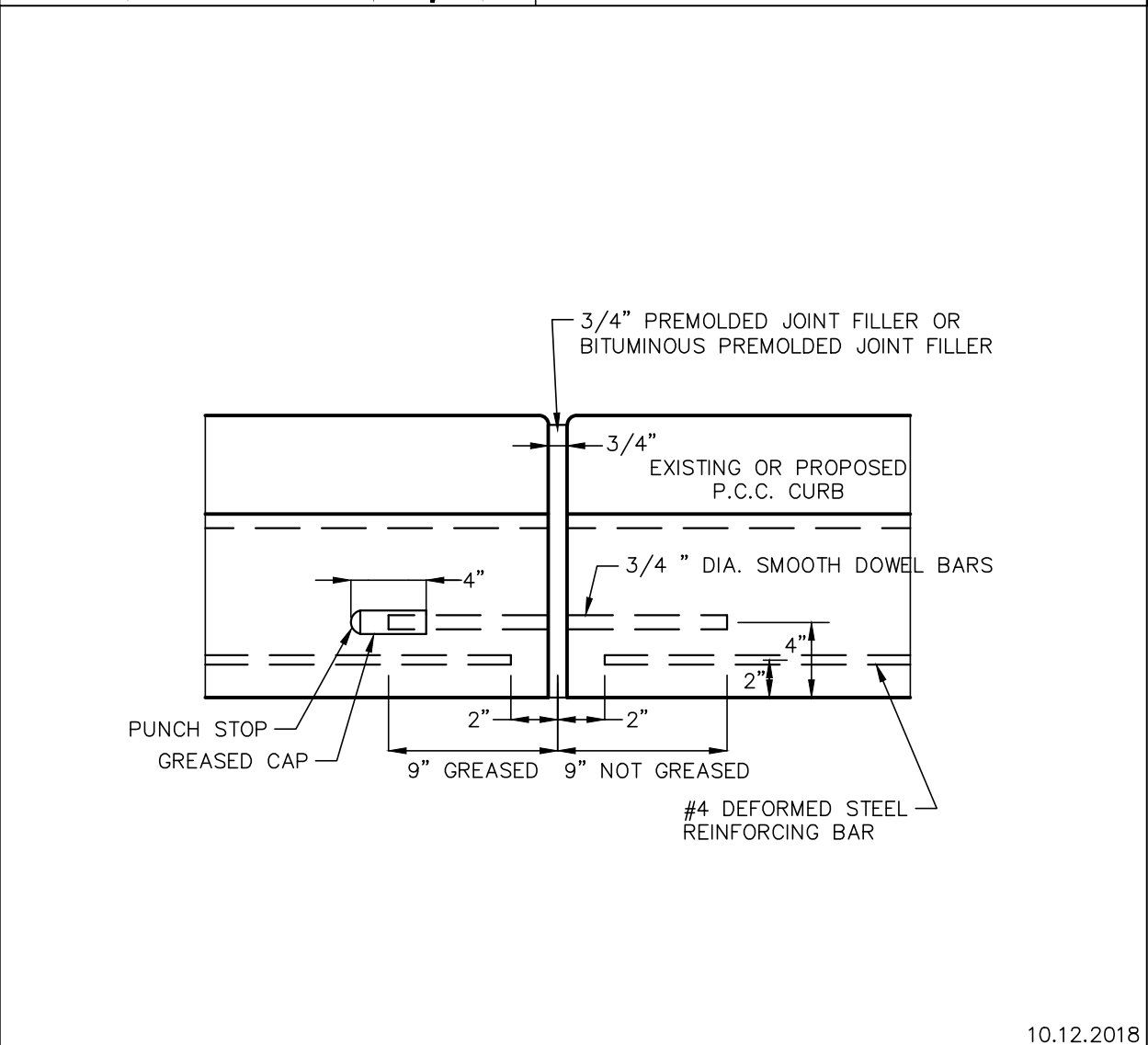
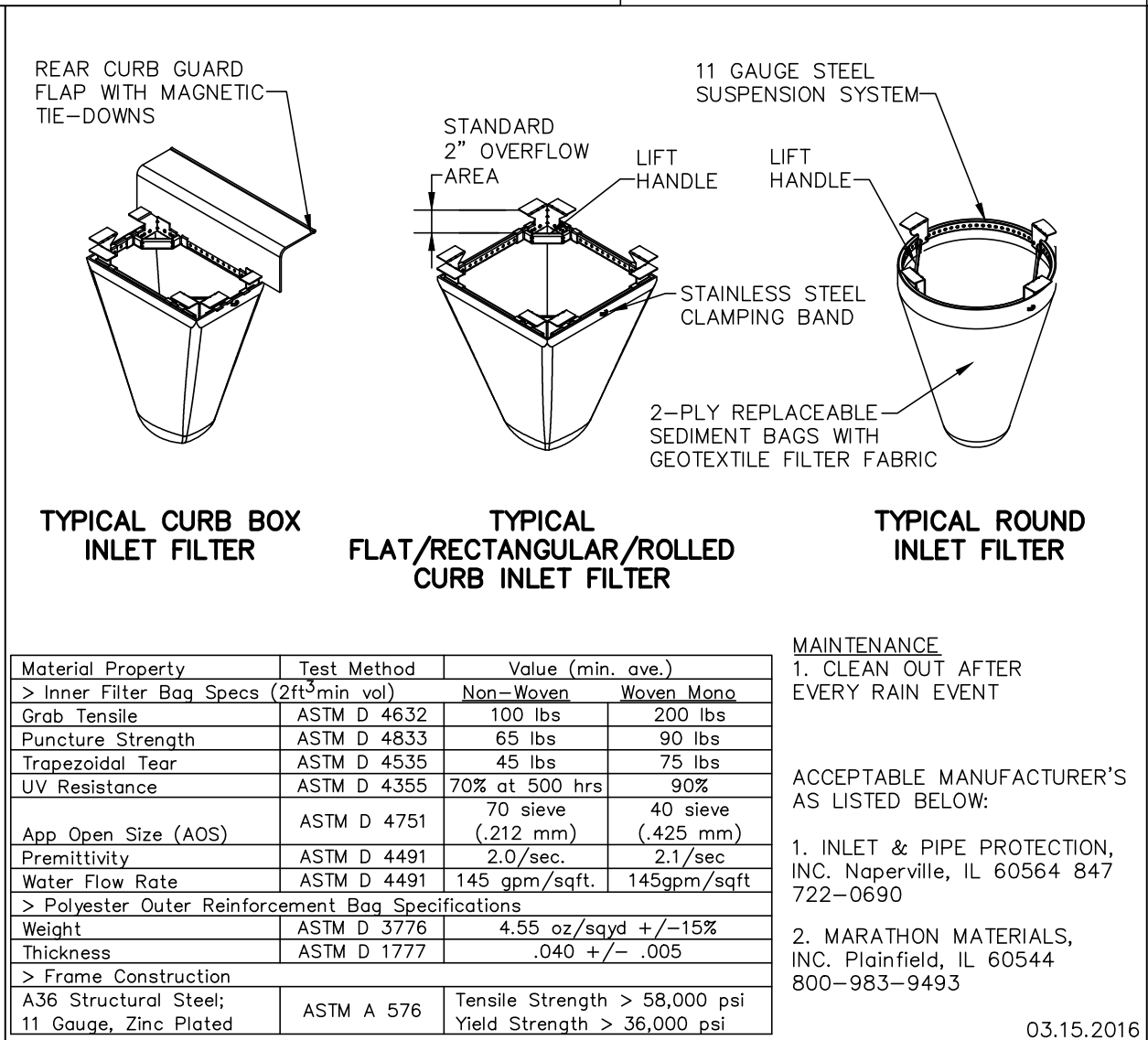
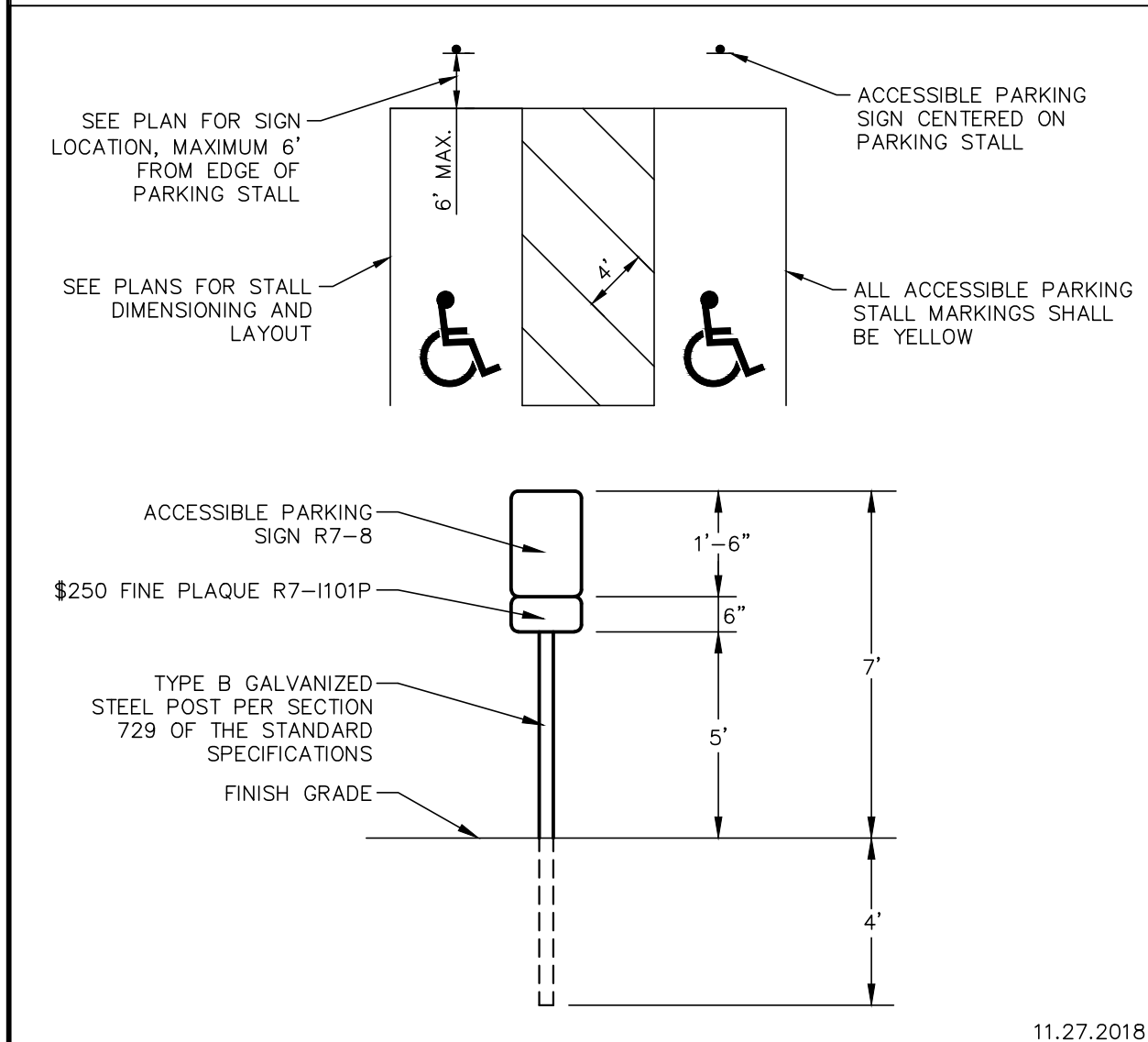
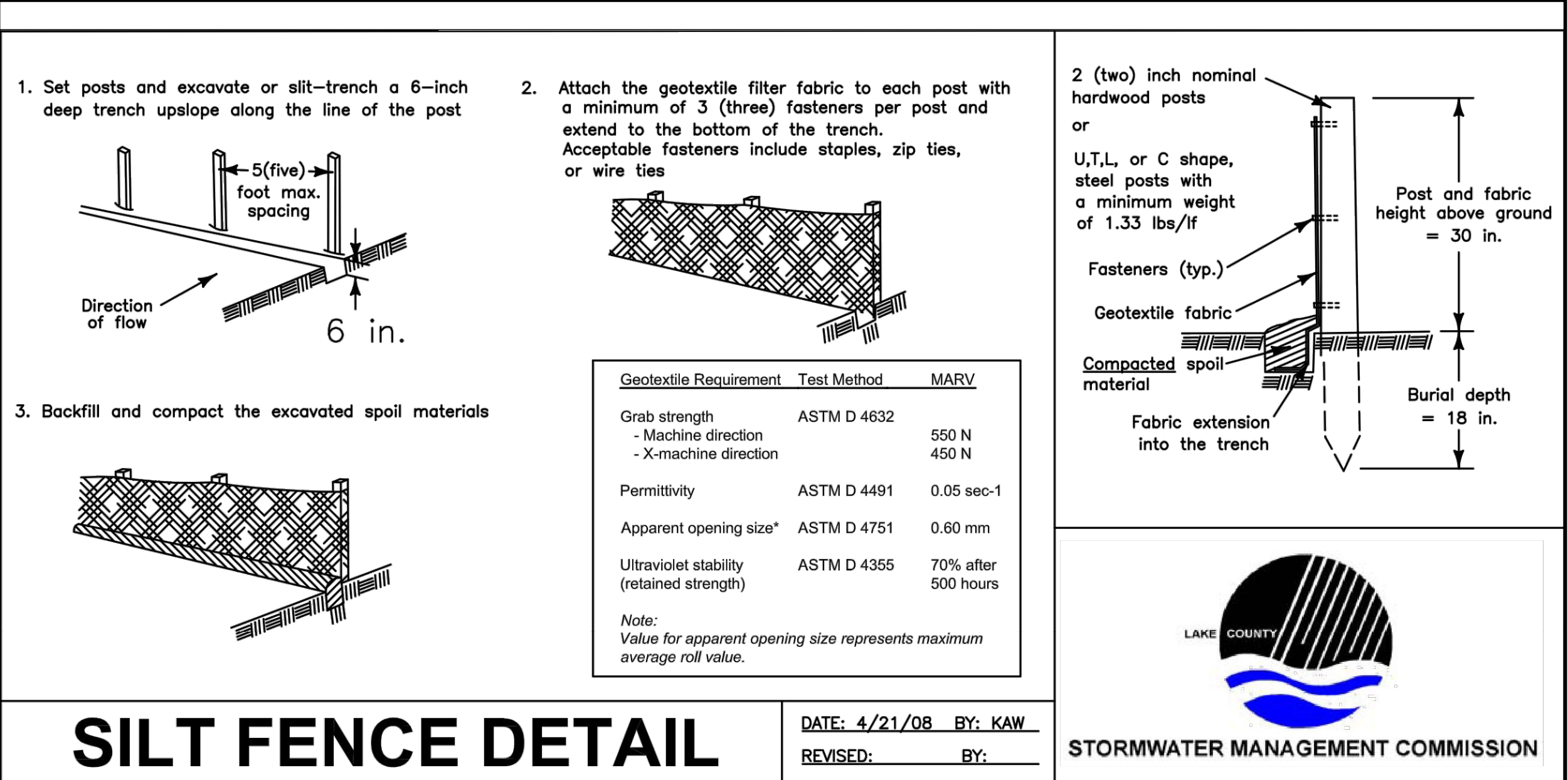
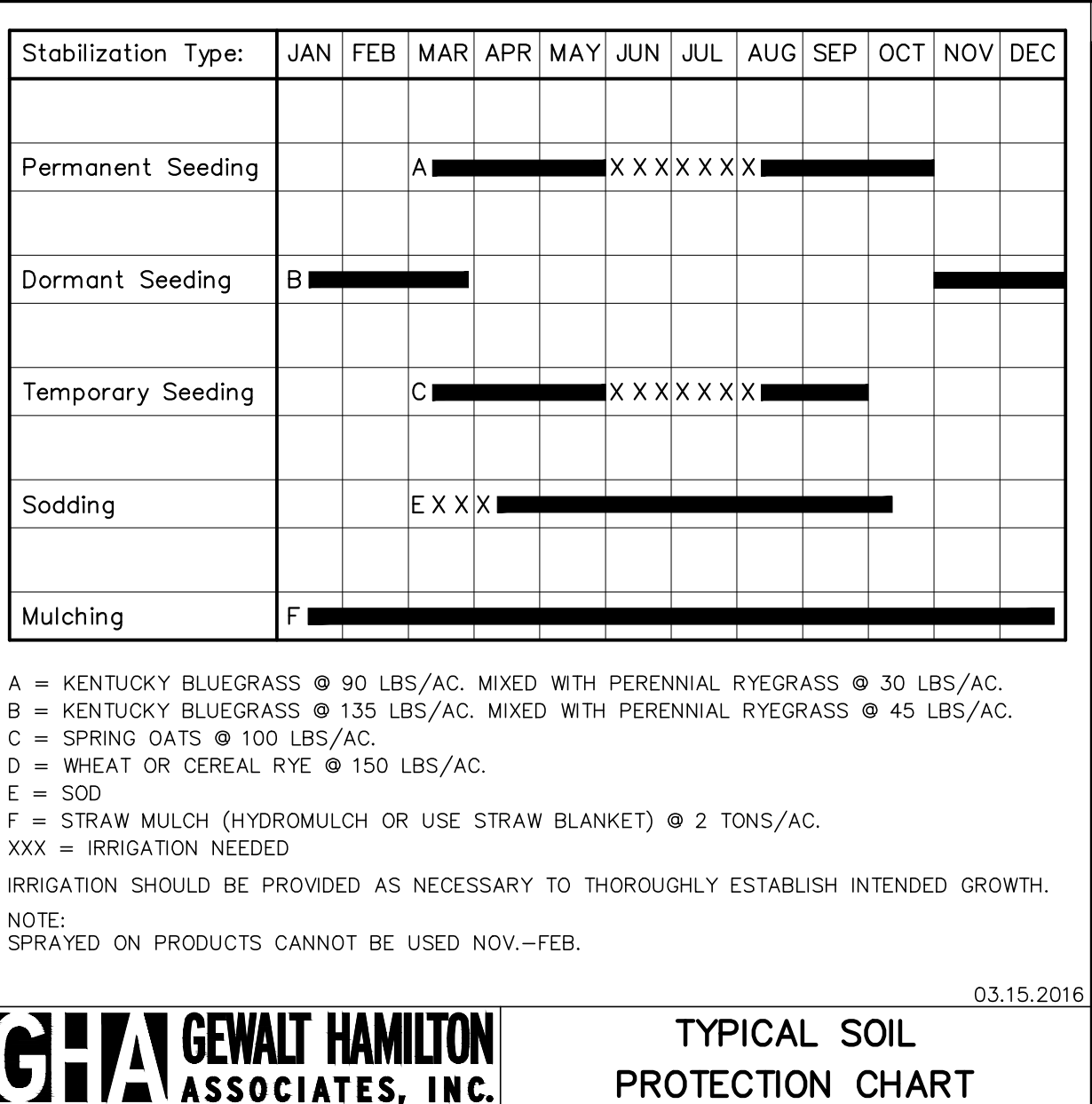
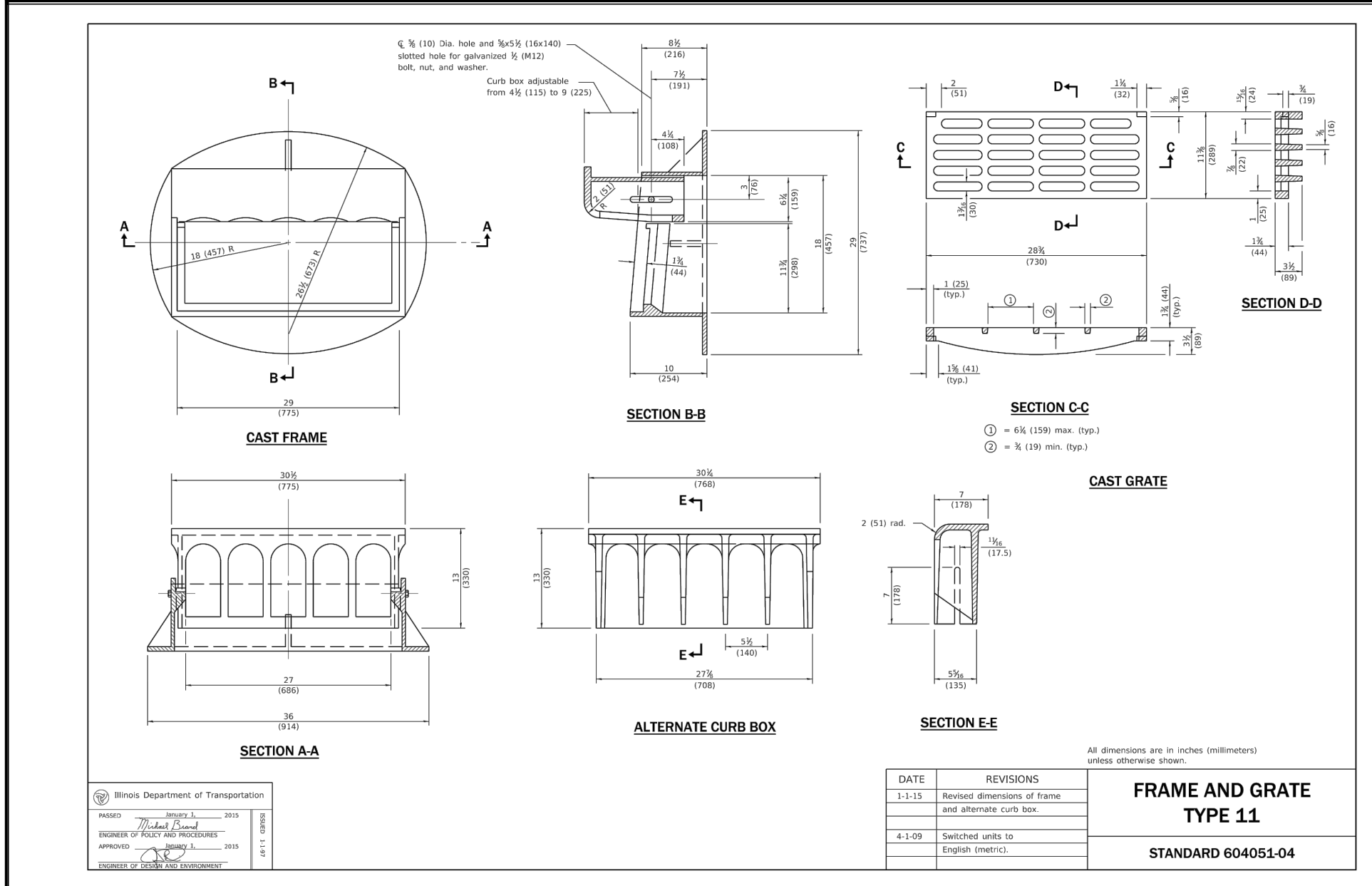



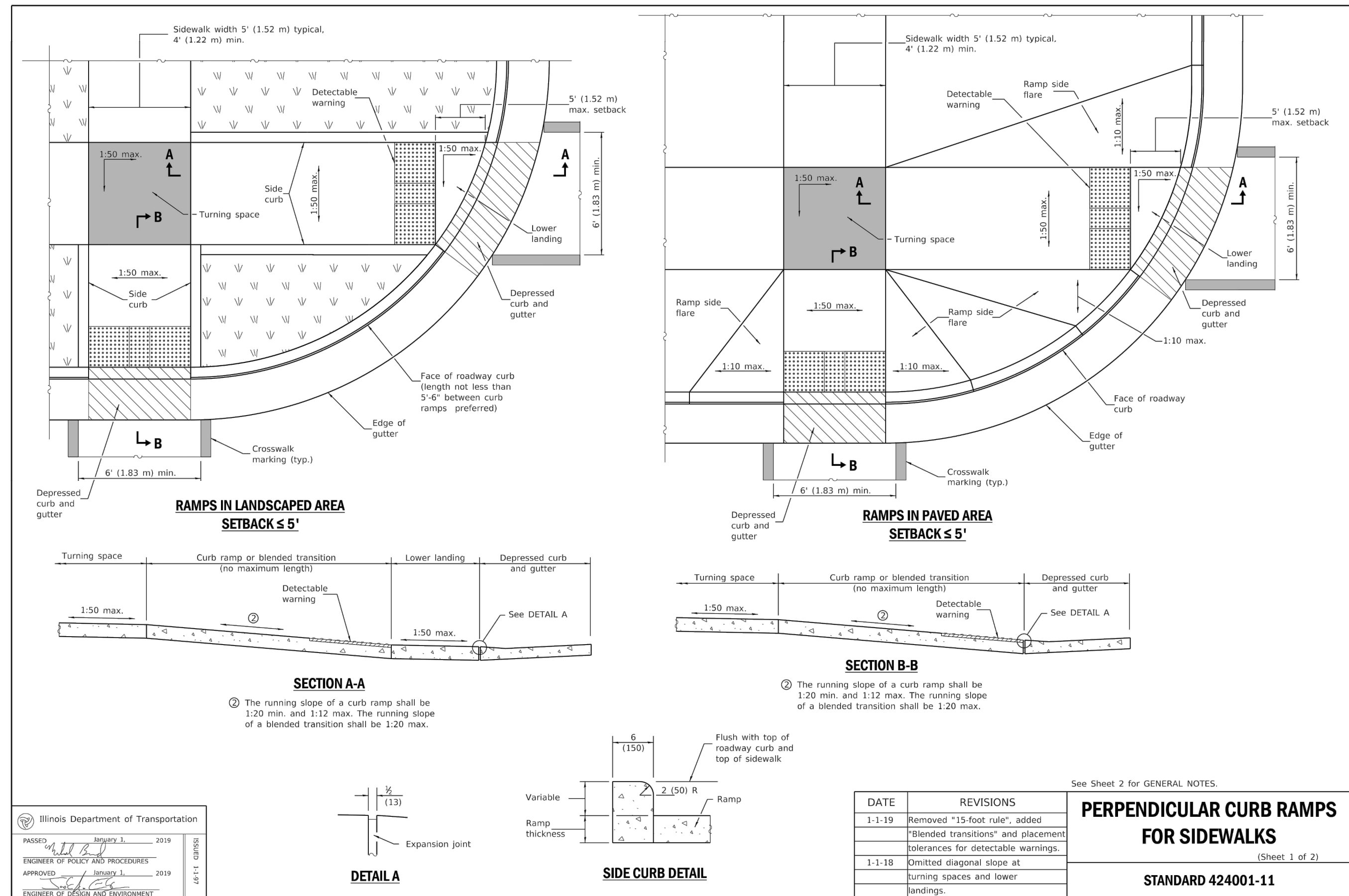
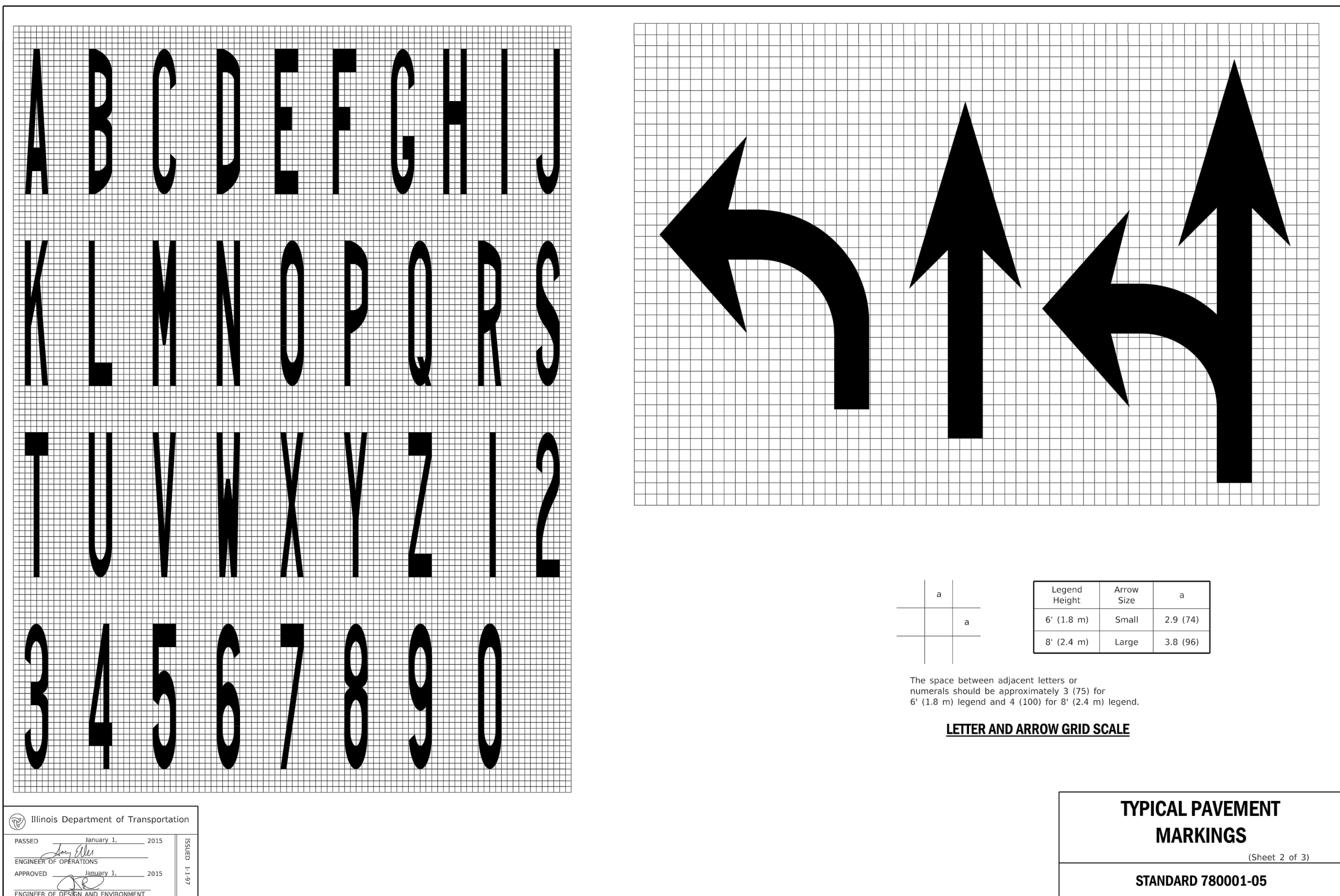
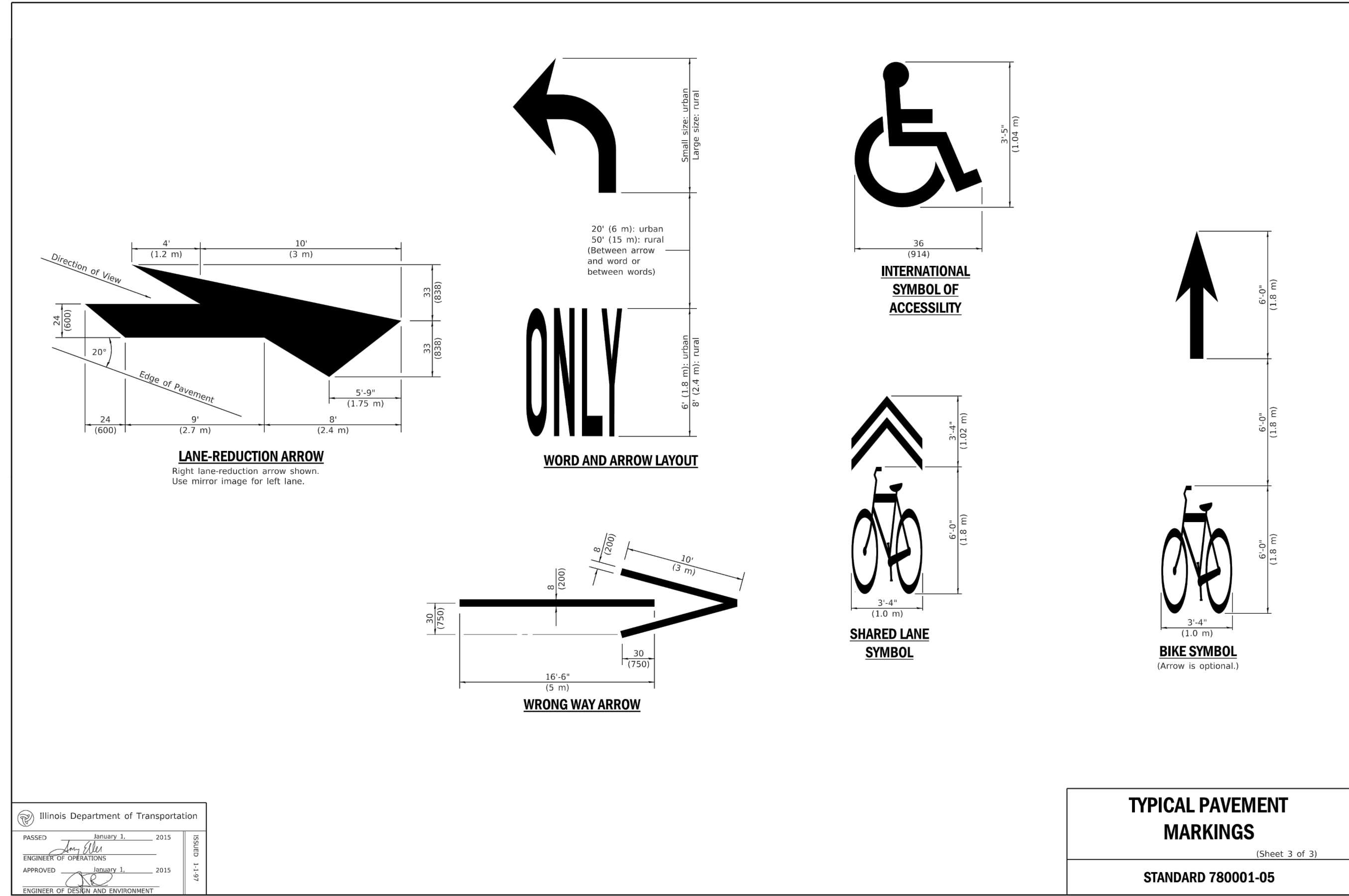
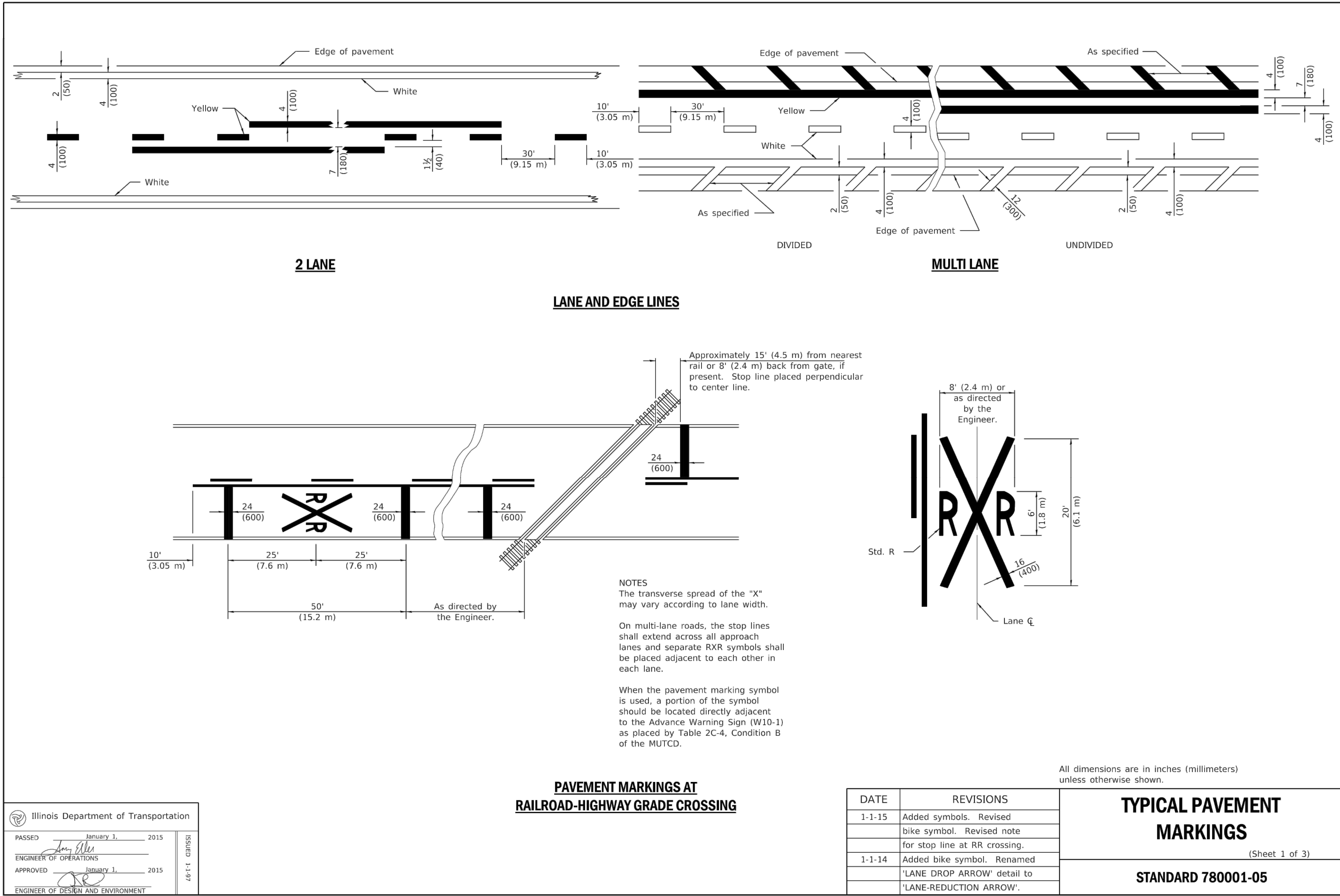









DEMOLITION NOTES:

5. THE CONTRACTOR SHALL COORDINATE WITH THE OWNER TO DETERMINE WHAT EQUIPMENT SHALL BE SALVAGED. ANY EQUIPMENT THAT ISN'T SALVAGED, SHALL BECOME PROPERTY OF THE CONTRACTOR AND REMOVED FROM THE JOBSITE WITHIN THREE (3) WORKING DAYS.

6. THE CONTRACTOR SHALL MAINTAIN THE EXISTING LIGHTING SYSTEM AND ALL LIGHTS SHALL REMAIN OPERATIONAL UNTIL THEY INTERFERE WITH THE PROPOSED IMPROVEMENTS. ONCE A CONFLICT EXISTS, THE CONTRACTOR SHALL DISCONNECT AND REMOVE THE LIGHTING AS IDENTIFIED ON THE PLAN SHEETS.

7. THE REMOVAL OF ELECTRICAL CABLE AND CONDUIT, NECESSARY TO REESTABLISH CONNECTIONS, SHALL NOT BE PAID FOR SEPARATELY, AND SHALL BE INCLUDED IN THE CONTRACT UNIT PRICE OF THE APPLICABLE PAY ITEMS.

## LEGEND



EXISTING LIGHTING UNIT, TO REMOVE

EXISTING STREET LIGHT CONDUIT, TO ABANDON IN PLACE



EXISTING HANDHOLE, REMOVE AND RELOCATE

CKT B/A-#  
CONTACTOR 'A'  
EXISTING 'A#'

CKT B/A-# - DENOTES ELECTRICAL PANEL AND CIRCUIT BREAKER  
CONTACTOR 'A' - DENOTES LIGHTING CONTACTOR ID  
EXISTING 'A#' - DENOTES EXISTING/PROPOSED & FIXTURE NUMBER ON GIVEN CIRCUIT



EXISTING FLOOD LIGHT, TO REMAIN



EXISTING BOLLARD, TO REMAIN



EXISTING STREET LIGHT CONDUIT, TO REMAIN

**COPYRIGHT NOTICE**  
This drawing is the property of Gewalt-Hamilton Assoc., Inc. and is not to be used for any purpose other than the specific project and site named herein, and cannot be reproduced in any manner without the express written permission from Gewalt-Hamilton Associates, Inc.

## EXISTING/DEMOLITION LIGHTING PLAN

WJ MURPHY ELEMENTARY SCHOOL  
2023 SITE IMPROVEMENTS  
ROUND LAKE PARK, ILLINOIS

				FILE:5903.005-EL.dwg				SHEET NUMBER:  <b>E2</b>  OF E4 SHEETS
				DRAWN BY: GHA		GHA PROJECT #		
				DATE: 01-13-23		5903.005		
				CHECKED BY: GLP		SCALE:		
NO.	BY	DATE	REVISION	NO.	BY	DATE	REVISION	DATE: 01-13-23
								1"=30'



( IN FEET )  
1 inch = 30 ft.

7. THE CONTRACTOR SHALL MAINTAIN THE PARKING LOT SITE LIGHTING THROUGHOUT THE DURATION OF CONSTRUCTION.

1. THE CONTRACTOR SHALL INSTALL A NEW RECEPTACLE ON LIGHT POLE 'B3'. THE POLE SHALL INCLUDE AN INTEGRATED FESTOON BOX, MANUFACTURED WITH THE POLE AND PAINTED BLACK TO MATCH. ALL COSTS ASSOCIATED WITH THIS WORK SHALL BE INCLUDED IN THE CONTRACT UNIT PRICE FOR THE PROPOSED LIGHTING UNIT. (REFER TO RECEPTACLE REQUIREMENTS IN GENERAL LIGHTING NOTES FOR MORE DETAILS).

2. TO RECONNECT THE PROPOSED LIGHT POLES TO THE EXISTING ELECTRICAL SYSTEM (INCLUDING THE EXISTING BOLLARDS AND FLOOD LIGHTS), THE CONTRACTOR SHALL SPLICE A NEW SECTION OF CONDUIT TO THE EXISTING UNDERGROUND CONDUIT (MATCH SIZE AND MATERIAL), AND REMOVE AND REPLACE THE EXISTING ELECTRICAL CABLE WITHIN THE CONDUIT TO THE NEAREST JUNCTION POINT. (IF THERE IS ADEQUATE SLACK THE CONTRACTOR CAN REUSE THE EXISTING CABLE WITH THE APPROVAL OF THE ENGINEER). ALL COSTS TO COMPLETE THIS WORK SHALL BE INCLUDED IN THE CONTRACT UNIT PRICES OF THE APPLICABLE PAY ITEMS.

PROPOSED PARKING LOT LIGHT  
25-FT SQUARE STRAIGHT STEEL LIGHT POLE  
SINGLE ARM ARRANGEMENT  
LED LUMINAIRE, 208V (PHASE TO PHASE)

 PROPOSED PARKING LOT LIGHT  
 15-FT SQUARE STRAIGHT STEEL LIGHT POLE  
 SINGLE ARM ARRANGEMENT  
 LED LUMINAIRE, 208V (PHASE TO PHASE)



PROPOSED PARKING LOT LIGHT  
25-FT SQUARE STRAIGHT STEEL LIGHT POLE  
DUAL ARM ARRANGEMENT  
LED LUMINAIRES, 208V (PHASE TO PHASE)



PROPOSED BEACON LIGHT  
30-FT SQUARE STRAIGHT STEEL LIGHT POLE  
SINGLE ARM ARRANGEMENT  
LED LUMINAIRE, 208V (PHASE TO PHASE)

CKT B/A-#  
CONTACTOR 'A'  
PROPOSED 'A' #

CKT B/A-# - DENOTES ELECTRICAL PANEL AND CIRCUIT BREAKER  
 CONTACTOR 'A' - DENOTES LIGHTING CONTACTOR ID  
 PROPOSED 'A#' - DENOTES EXISTING/PROPOSED & FIXTURE NUMBER ON GIVEN CIRCUIT

— — — — — UNDERGROUND CONDUIT, 1" UNIT DUCT  
2-1/C #8 AWG PHASE & 1/C #8 GROUND CONDUCTORS  
600V (TYPE XLP-RHW). (OR AS SPECIFIED)  
2.5" GRC SLEEVE AT ALL CROSSINGS UNDER PAVEMENT

PROPOSED/RELOCATED HANDHOLE  
(SIZE AS SPECIFIED)

 EXISTING PARKING LOT LIGHT, TO REMAIN

WJ MURPHY ELEMENTARY SCHOOL  
2023 SITE IMPROVEMENTS  
ROUND LAKE PARK, ILLINOIS

										FILE:5903.005-EL.dwg	SHEET NUMBER:  E3  OF E4 SHEETS	
										DRAWN BY: GHA DATE: 01-13-23		GHA PROJECT # 5903.005
										CHECKED BY: GLP DATE: 01-13-23		SCALE: 1"=30'
NO.	BY	DATE		REVISION		NO.	BY	DATE		REVISION		

**GHA** **GEWALT HAMILTON**  
**ASSOCIATES, INC.**

625 Forest Edge Drive ■ Vernon Hills, IL. 60061  
TEL 847.478.9700 ■ FAX 847.478.9701

This drawing is the property of Gewalt-Hamilton Assoc., Inc. and is not to be used for any purpose other than the specific project and site named herein, and cannot be reproduced in any manner without the express written permission from Gewalt-Hamilton Associates, Inc.



