

Educational Facility Master Plan Update

Bowling Green City School District Board of Education
October 04, 2023



 **DLR GROUP**

emersion
DESIGN

Introductions

Your Team



Dusty Lake, AIA, ALEP
K-12 Client Leader, Design Lead



Troy Glover, ALEP, LE Fellow
K-12 Education Planner



Christie Boron, ALEP, RA, LEED AP
K-12 Educational Planner, Programmer
Emersion DESIGN



Jennifer Davy, AIA
Project Manager



Tim Shimp, Ed.D.
Teaching and Learning
Designer



George Rishmawi, AIA, NCARB
Architect, Project Designer



Laura Beth Cochran, AIA
Architect, Master Planning



Coral Pais, PE, BEMP
High-Performance Designer



Kyle Waymeyer, LEED AP BD+C, CEM
Engineering Lead
CMTA

WELCOME

Agenda

- 01 Timeline
- 02 District Wide Educational FMP
- 03 Program and Cost
- 04 The New BG HS



Timeline

TIMELINE

Outlining Our Process

June 1 – June 11

1 Discover

Kick-Off June 1:

- » BG School Site Visits
- » OFCC Planning

Meetings:

- » Bi-weekly meetings scheduled with core team (every other Thursday)

District Data

- » Collect
- » Review
- » Organize

June 12 – June 30

2 Launch

Workshops and Focus Groups:

Weeks of June 12 and 19

- » District wide BOLD and VALUES Workshops
- » Virtual HS Focus Group Meetings (9 total)

Meetings:

- » Bi-Weekly meeting check in with core team – POR and Bond alignment
- » **June 29** POR approval meeting with Dan Black

July 1 – August 8

3 Synthesize

HS Visioning Presentation:

July 14

- » Development of HS story, concepts, program, siting, massing and materials

Sustainability Presentation:

July 20

HS Plan Presentation:

July 28

- » HS conceptual floor plan

HS Exterior Presentation:

August 8

- » HS exterior concepts (2)

Meetings:

- » Bi-Weekly meeting check in with core team

August 9 – August 31

4 Report

- » Refinement of exterior HS concept and conceptual floor plan
- » Development of the EFMP

Special Session Board Meeting:

Aug 30

- » Presentation of EFMP process and HS design

Meetings:

- » Bi-Weekly meeting check in with core team and updates regarding EFMP template and messaging

September 1 – October 4

5 Recommend

Final Draft of EFMP for review by Core Team Sept. 1

Final EFMP deliverable on Sept. 19

- » Additional renderings
- » Video fly over – 360 view of new HS and site

Special Session Board Meeting: Oct 04

- » **Presentation of Final EFMP and HS design**

Meetings:

- » Bi-Weekly meeting check in with core team

TIMELINE

What Comes Next?

- Engagement and Meetings – BGCSD Stakeholders
- Documentation Review and Approvals, Cost Estimate Reviews
- Reviews: BGCSD, Construction Manager, and City Site/Building

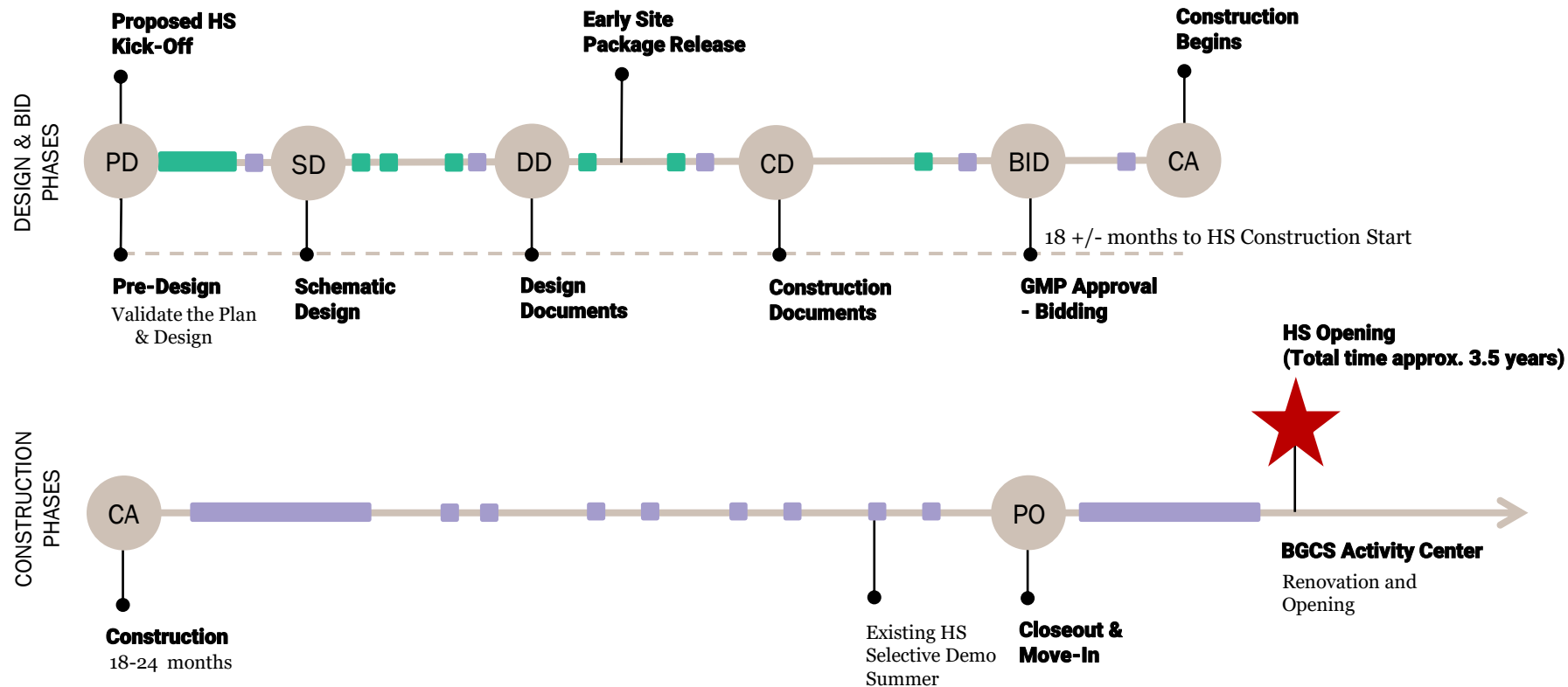

District Wide Educational FMP

A District-Wide Educational Focus

BGS EDUCATIONAL FACILITY MASTER PLAN FALL 2023	
TABLE OF CONTENTS	
I. INTRODUCTION Message from the Superintendent District Overview Acknowledgments	5 6 10
II. TIMELINE AND PROCESS Phases of Design and Engagement	12
III. BOWLING GREEN Establishing Sense of Place Drivers of Change	16 18
IV. VISION FOR TEACHING AND LEARNING Teaching and Learning Visioning, VALUES, and Focus Groups	22
V. PLANNING AND DESIGN STRATEGIES Spatial Possibilities, Academic Spatial Alignment, and Design Components	27
VI. CLIMATE ACTION PLANNING Considerations for High Performance Design	34
VII. DATA-DRIVEN DESIGN Ohio Facilities Construction Commission, Facility Condition Assessments, and Projected Enrollment	40
VIII. MASTER PLAN RECOMMENDATIONS High School, Middle School, and Elementary Schools	42
IX. EXPANDED RECOMMENDATIONS Bowling Green High School	48
X. APPENDIX Focus Groups Meeting Notes Teaching and Learning Visioning Report VALUES Visioning Report	78

VIII.

MASTER PLAN RECOMMENDATIONS

High School,
Middle School, and
Elementary Schools

42



BGCS Elementary Schools

Considerations

- Equitable experiences
- Elevated opportunities
- Expanded District Resources
- Universally Beneficial
- Support the Families and Students they Serve

“Bowling Green City Schools is dedicated to the planning of all district school facilities. Our work has only begun with conversations stemming from the Educational Facility Master Plan. As a community, WE MUST work together to build the future for our elementary students that will provide equitable opportunities and resources.”

- Ted Haselman, Superintendent



BGCS Middle School

Opportunities

Continue to expand upon the forward-facing pedagogical approach of the current teaching and learning. Design Components can be used to strategize priorities.

- Accommodate student choice
- Increase utilization
- Increase learning on display
- Provide flexible furnishings
- Share more connections with proposed new Bowling Green High School

Opportunity to Connect



Variety of Venue



Space

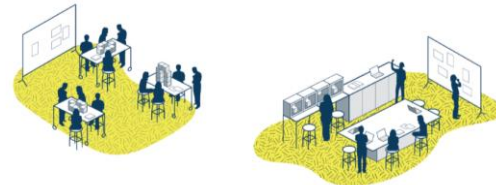

- Family Services
- Indoor Sports and Esports events
- Adult Education
- BG Community band practice and events
- Wood County Football Officials training
- BGCS' Food Pantry
- BG Bobcats Youth Sports Teams practice and events

The cost to renovate the 54,000 SF of the new Activity Center would only afford the District about 14,000 SF at the new high school.

- Our team is saving the newer portions of the building resulting in lower impact on cost.

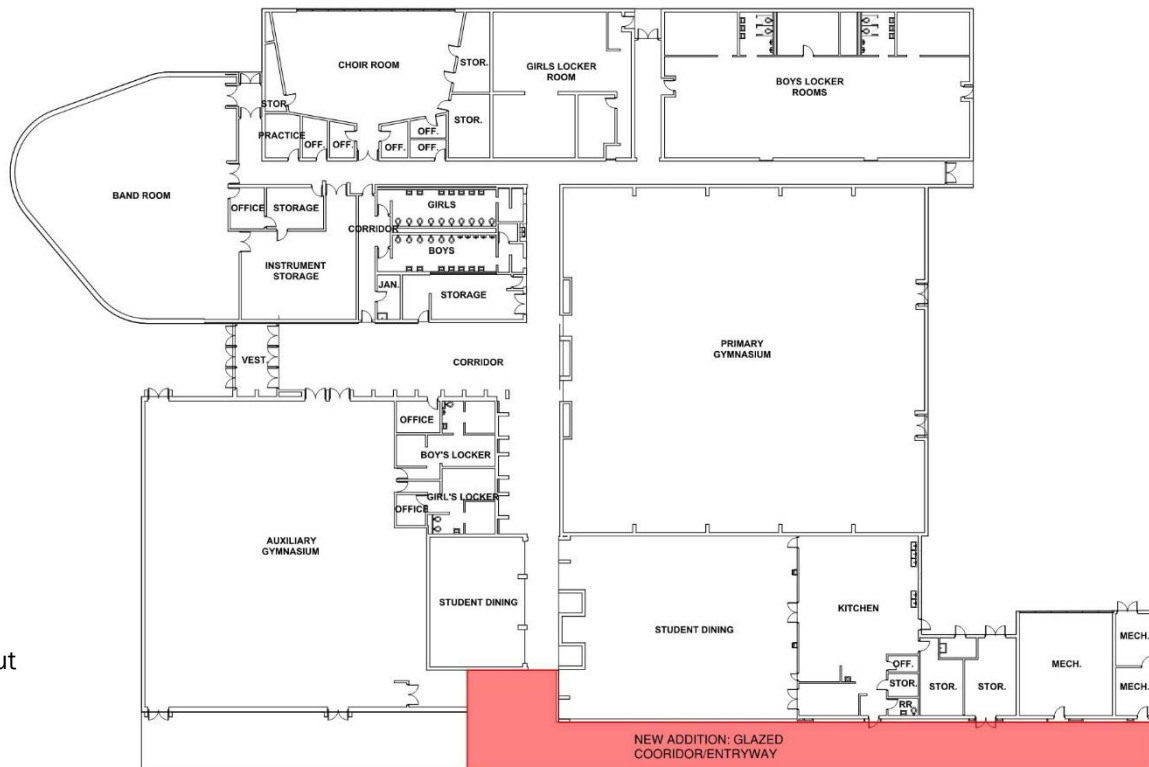

BG HS and BGCS Activity Center Program and Cost

HS Program and Cost



\$1,238,492

Demo/Abatement of existing High School Core Academic

\$4,981,118

Conversion of remaining existing HS into BGCS Activity Center (approx. 54,000 SF)

\$824,739

New BGCS Activity Center Entrance (approx. 2,000 SF)

\$62,319,332

New High School Development

\$3,436,320

5% Contingency

\$72,800,000

TOTAL

The New BG HS

Site Plan

- a** New BG High School
- b** New BGCS Activity Center
- c** BG Middle School
- d** Performing Arts Center
- e** Existing Athletic Fields
- f** Relocated Athletic Field
- g** New parking and geothermal well field
- h** New parking for activity center
- i** Existing MS/HS bus loop
- j** New city bike path

North



Not to Scale

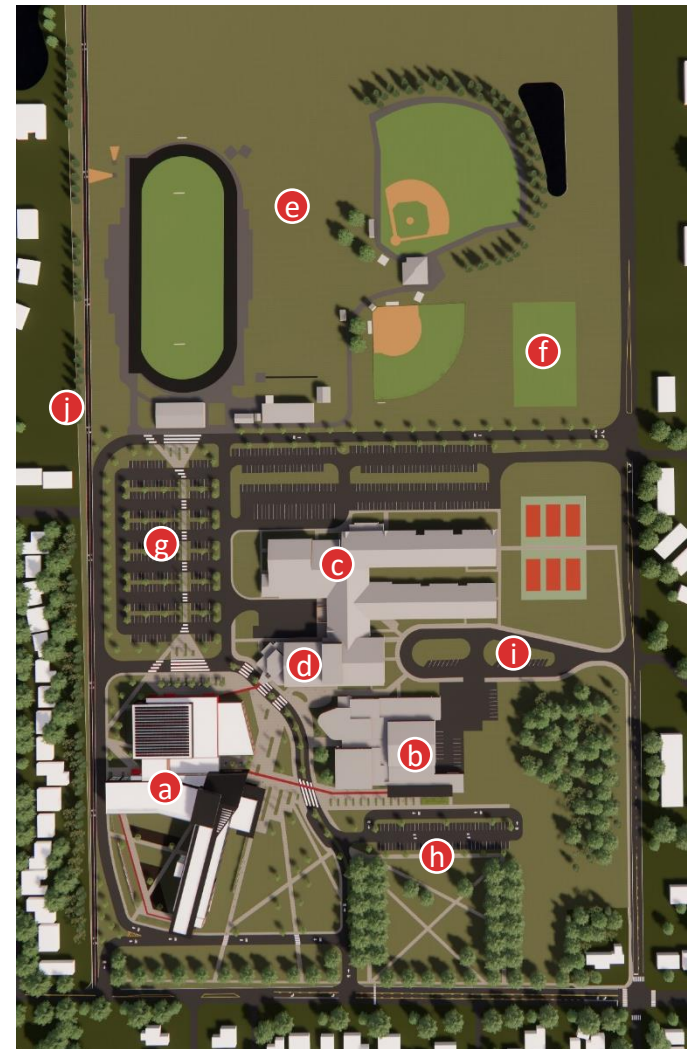

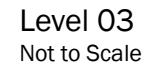
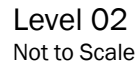
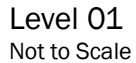

- Admin
- Athletics
- Commons
- The Learning Hub
- Learning Neighborhood
- Science
- Vo-Ag, DECA, and Family & Consumer Sciences
- SPED
- Fine Arts
- Service

Interior Rendering

The New BG HS



Exterior Rendering

The New BG HS



Exterior Rendering

The New BG HS

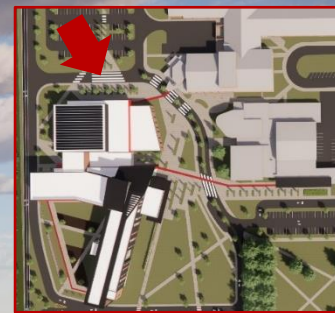

Exterior Rendering

The New BG HS



Exterior Rendering

The New BG HS



Exterior Rendering

The New BG HS





 **DLR**GROUP

+

eMERsion
DESIGN

Discussion

